

This setout is provided as a guide only. It is the responsibility of the concreter/erector to confirm that all dimensions are correct.

Left End

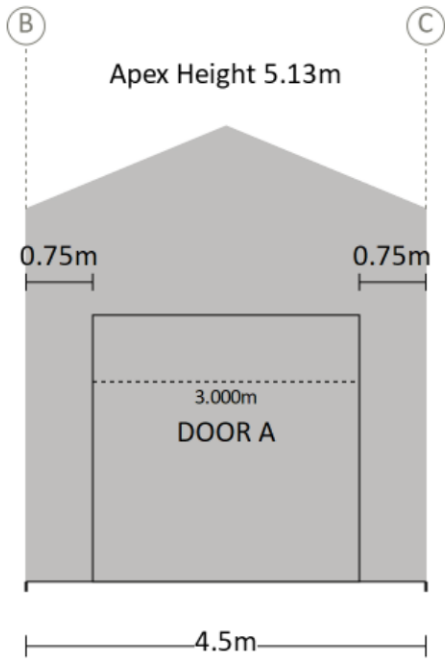

Measurements are from the outside of side girts to the inside of component opening size.

Left Leanto Left End

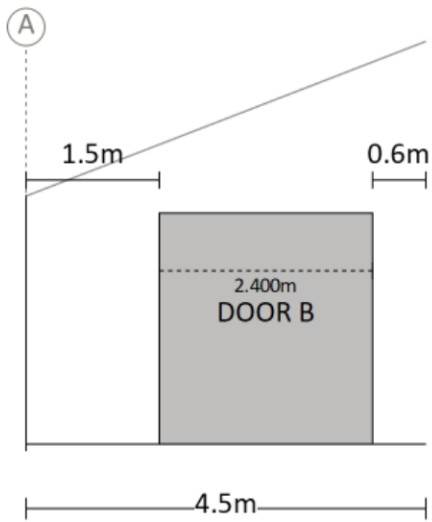

Measurements are from the outside of side girts to the inside of component opening size.

Purchaser Name: Robert Stutsel

Site Address: 426 The Driftway Londonderry NSW 2753 Australia

Drawing # WSS212462 - 10

Print Date: 26/06/21

**Component Position**  
**NOT FOR CONSTRUCTION**  
 Not to Scale  
 Page 1 of 2  
 © Copyright SteelxIP Pty Ltd

Seller: Wide Span Sheds Pty Ltd  
 Wide Span Sheds Pty Ltd  
 Phone: 07 5657 8888  
 Fax: 07 5657 8899  
 Email: admin@sheds.com.au

Apex Engineering Group PTY LTD  
 ACN 632 588 562  
 ME Aust. (Registered NER Structural) 5276880  
 QLD : RPEQ No. 24223; TAS : 185770492; VIC : EC67493; N.T. : 303557ES;  
 Practising Professional Structural & Civil Engineers

Signature:

J. Ronaldson

Date: 26/06/21

Right Leanto Left End

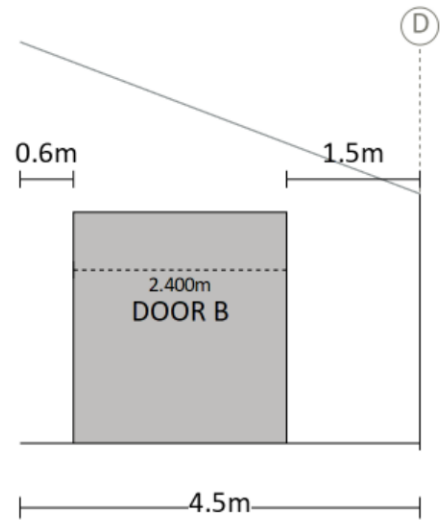

Measurements are from the outside of side girts to the inside of component opening size.

Purchaser Name: Robert Stutsel

Site Address: 426 The Driftway Londonderry NSW 2753 Australia

Drawing # WSS212462 - 10

Print Date: 26/06/21

**Component Position**  
**NOT FOR CONSTRUCTION**  
 Not to Scale  
 Page 2 of 2  
 © Copyright Steelx IP Pty Ltd

Seller: Wide Span Sheds Pty Ltd  
 Wide Span Sheds Pty Ltd  
 Phone: 07 5657 8888  
 Fax: 07 5657 8899  
 Email: admin@sheds.com.au

Apex Engineering Group PTY LTD  
 ACN 632 588 562  
 ME Aust. (Registered NER Structural) 5276880  
 QLD : RPEQ No. 24223; TAS : 185770492; VIC : EC67493; N.T. : 303557ES;  
 Practising Professional Structural & Civil Engineers

Signature

J. Ronaldson

Date: 26/06/21

# ROOF (TOP VIEW)

Notes:  
Brackets are not shown. Refer to Specification Details  
for more information. Opening members not labeled.

LEFT SIDE  
C10010 (PL3)

C10012 (PL4)

C10012 (PL5)

C10012 (PL1)

C10012 (PL2)



RIGHT SIDE

Revision	Date	Initial	Purchaser Name: Robert Stutsel	Purlin and Girt Plan NOT FOR CONSTRUCTION NOT TO SCALE Page 1 of 5 ©Copyright Steelx IP Pty Ltd	Seller: Wide Span Sheds Pty Ltd Name: Wide Span Sheds Pty Ltd Phone: 07 5657 8888 Fax: 07 5657 8899 Email: admin@sheds.com.au	Apex Engineering Group PTY LTD ACN 632 588 562 MIE Aust. (Registered NER Structural) 5276680 QLD : RPEQ No. 24223; TAS : 185770492; VIC : EC67493; N.T : 303557ES; Practising Professional Structural & Civil Engineers  Signature: J. Ronaldson Date: 26/06/21
			Site Address: 426 The Driftway Londonderry NSW 2753 Australia			
			Drawing # WSS212462 - 11			
			Print Date: 26/06/2021			

Notes:  
 Brackets are not shown. Refer to Specification Details  
 for more information. Opening members not labeled.

LEFT END ELEVATION

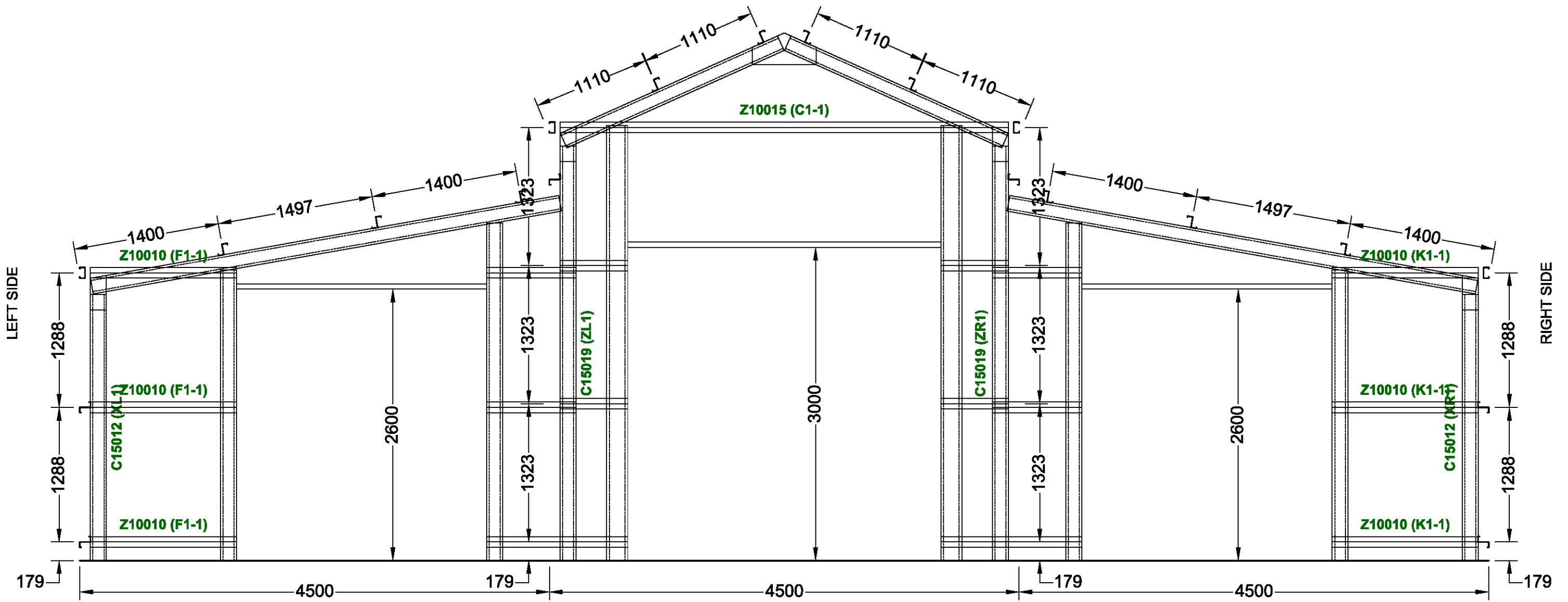

Revision	Date	Initial	Purchaser Name: Robert Stutsel	
			Site Address: 426 The Driftway Londonderry NSW 2753 Australia	
			Drawing # WSS212462 - 11	Print Date: 26/06/2021

Purlin and Girt Plan  
 NOT FOR CONSTRUCTION  
 NOT TO SCALE  
 Page 2 of 5  
 ©Copyright Steelx IP Pty Ltd

Seller: Wide Span Sheds Pty Ltd  
 Name: Wide Span Sheds Pty Ltd  
 Phone: 07 5657 8888  
 Fax: 07 5657 8899  
 Email: admin@sheds.com.au

Apex Engineering Group PTY LTD  
 ACN 632 588 562  
 MIE Aust. (Registered NER Structural) 5276680  
 QLD : RPEQ No. 24223; TAS : 185770492; VIC : EC67493; N.T : 303557ES;  
 Practising Professional Structural & Civil Engineers

Signature: J. Ronaldson  
 Date: 26/06/21

Notes:  
 Brackets are not shown. Refer to Specification Details  
 for more information. Opening members not labeled.

RIGHT END ELEVATION

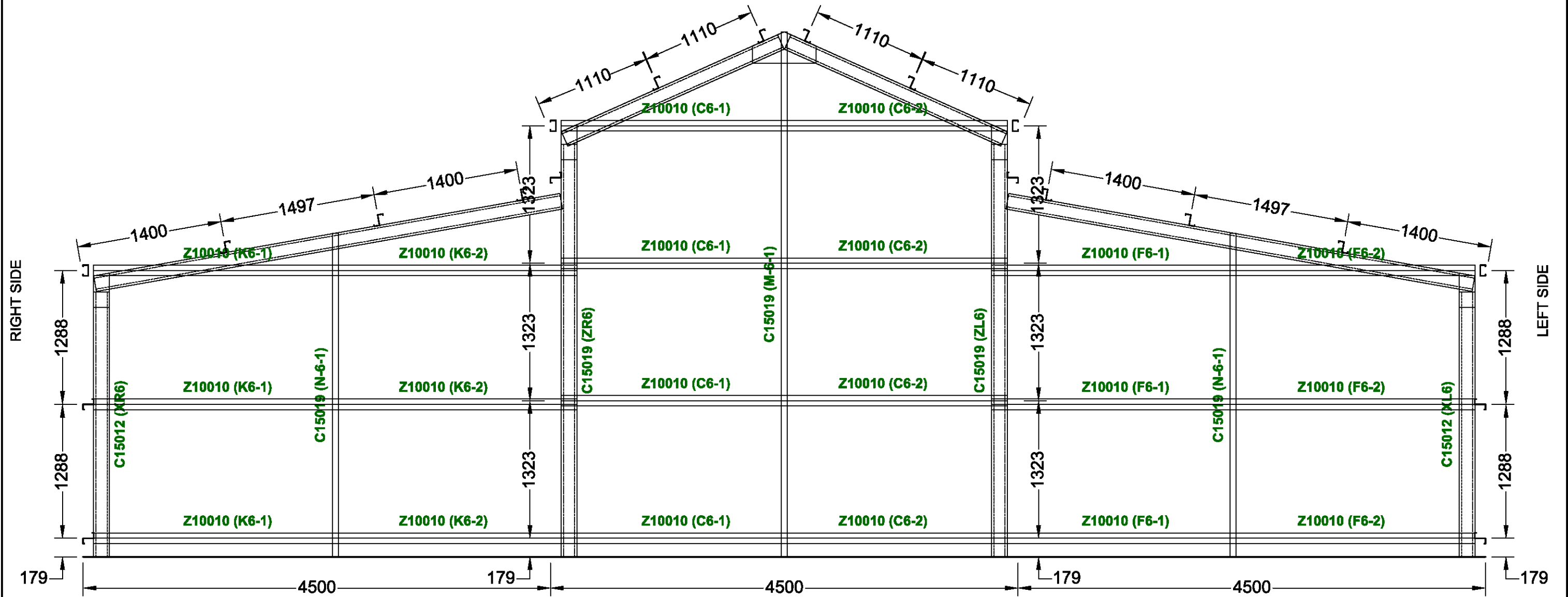

Revision	Date	Initial	Purchaser Name: Robert Stutsel	
			Site Address: 426 The Driftway Londonderry NSW 2753 Australia	
			Drawing # WSS212462 - 11	Print Date: 26/06/2021

Purlin and Girt Plan  
 NOT FOR CONSTRUCTION  
 NOT TO SCALE  
 Page 3 of 5  
 ©Copyright Steelx IP Pty Ltd

Seller: Wide Span Sheds Pty Ltd  
 Name: Wide Span Sheds Pty Ltd  
 Phone: 07 5657 8888  
 Fax: 07 5657 8899  
 Email: admin@sheds.com.au

Apex Engineering Group PTY LTD  
 ACN 632 588 562  
 MIE Aust. (Registered NER Structural) 5276680  
 QLD : RPEQ No. 24223; TAS : 185770492; VIC : EC67493; N.T : 303557ES;  
 Practising Professional Structural & Civil Engineers

Signature: \_\_\_\_\_  
 lonaldson  
 e: 26/06/21

**LEFT ELEVATION**

Notes:  
Brackets are not shown. Refer to Specification Details for more information. Opening members not labeled.

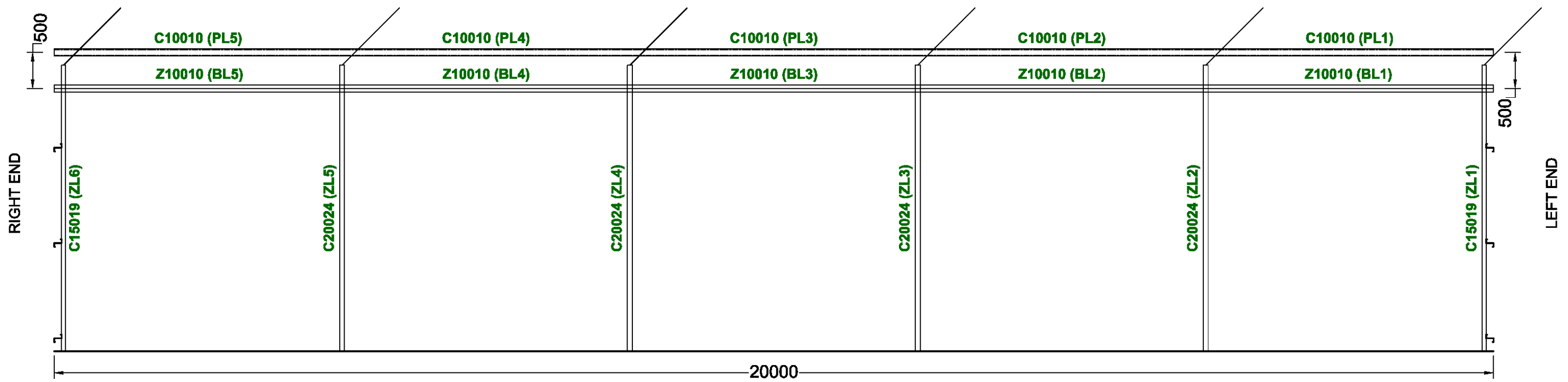

**RIGHT ELEVATION**

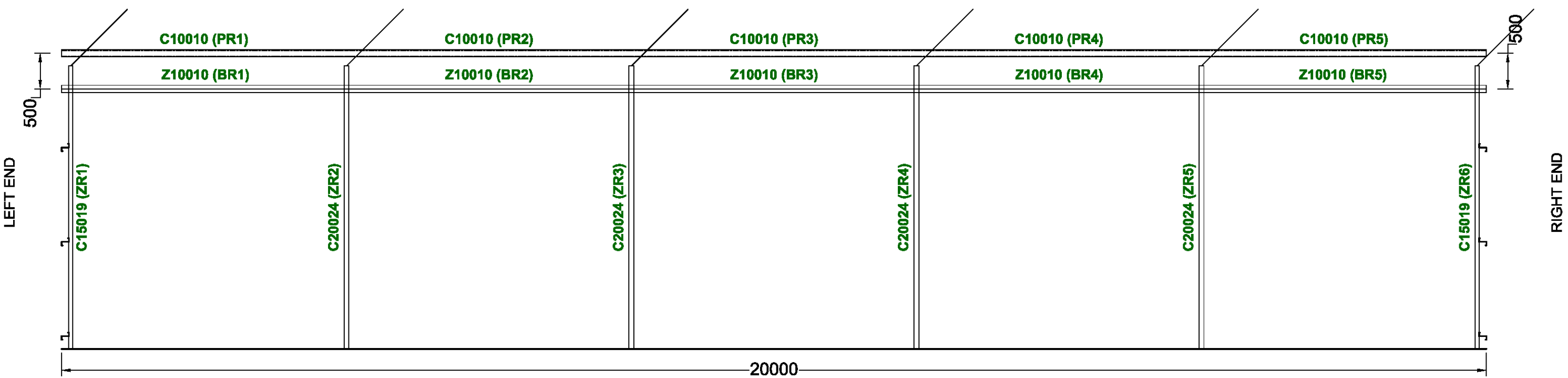

Revision	Date	Initial	Purchaser Name: Robert Stutsel	
			Site Address: 426 The Driftway Londonderry NSW 2753 Australia	
			Drawing # WSS212462 - 11	Print Date: 26/06/2021

**Purlin and Girt Plan**  
 NOT FOR CONSTRUCTION  
 NOT TO SCALE  
 Page 4 of 5  
 ©Copyright Steelx IP Pty Ltd

Seller: Wide Span Sheds Pty Ltd  
 Name: Wide Span Sheds Pty Ltd  
 Phone: 07 5657 8888  
 Fax: 07 5657 8899  
 Email: admin@sheds.com.au

Apex Engineering Group PTY LTD  
 ACN 632 588 562  
 MIE Aust. (Registered NER Structural) 5276680  
 QLD : RPEQ No. 24223; TAS : 185770492; VIC : EC67493; N.T : 303557ES;  
 Practising Professional Structural & Civil Engineers  
 Signature: J. Ronaldson  
 Date: 26/06/21

Notes:  
 Brackets are not shown. Refer to Specification Details  
 for more information. Opening members not labeled.

### LEFT LEANTO ELEVATION

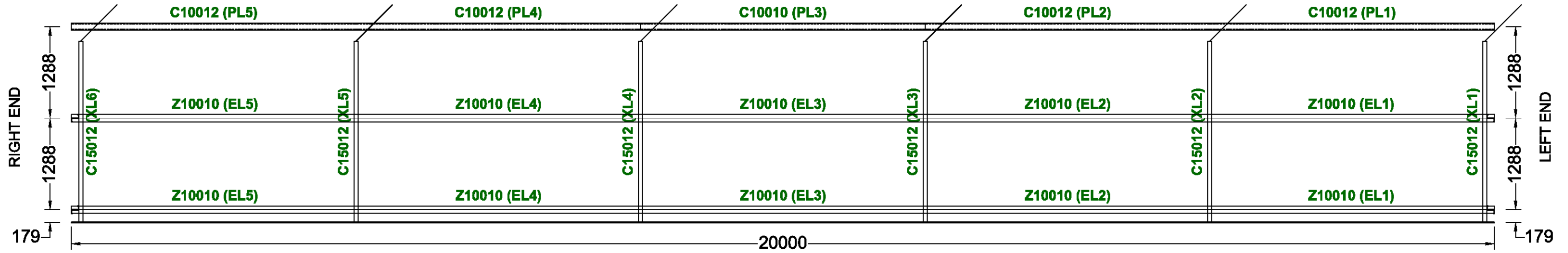

### RIGHT LEANTO ELEVATION

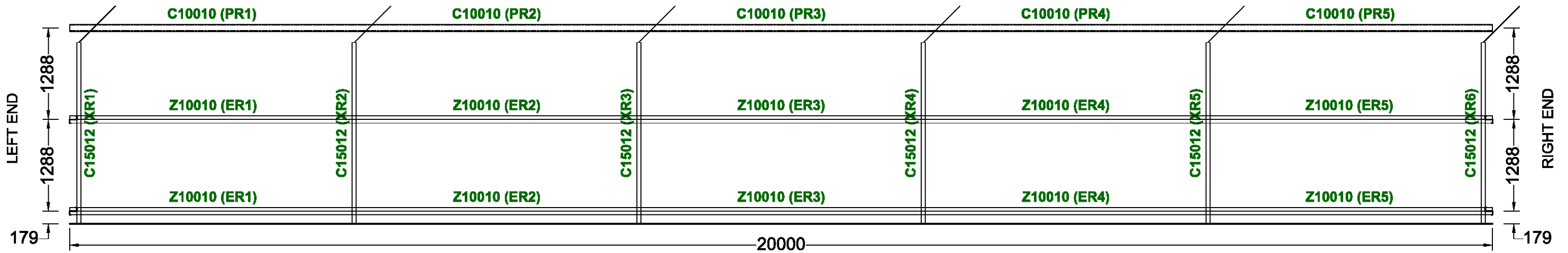

Revision	Date	Initial		
			Purchaser Name: Robert Stutzel	
			Site Address: 426 The Driftway Londonderry NSW 2753 Australia	
			Drawing # WSS212462 - 11	Print Date: 26/06/2021

**Purlin and Girt Plan**  
 NOT FOR CONSTRUCTION  
 NOT TO SCALE  
 Page 5 of 5  
 ©Copyright Steelx IP Pty Ltd

Seller: Wide Span Sheds Pty Ltd  
 Name: Wide Span Sheds Pty Ltd  
 Phone: 07 5657 8888  
 Fax: 07 5657 8899  
 Email: admin@sheds.com.au

Apex Engineering Group PTY LTD  
 ACN 632 588 562  
 MIE Aust. (Registered NER Structural) 5276680  
 QLD : RPEQ No. 24223; TAS : 185770492; VIC : EC67493; N.T : 303557ES;  
 Practising Professional Structural & Civil Engineers

Signature: J. Ronaldson  
 Date: 26/06/21