

PROPOSED LANDSCAPE DESIGN @ 1 EDNA STREET, KINGSWOOD FOR MR ELIE ELIAS DEVELOPMENT APPROVAL

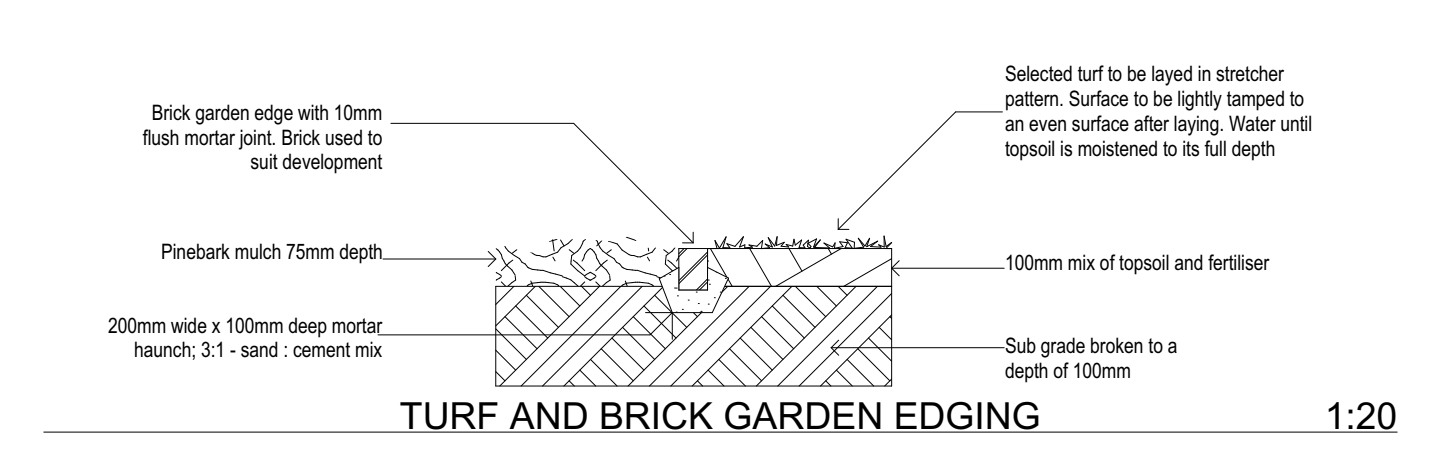
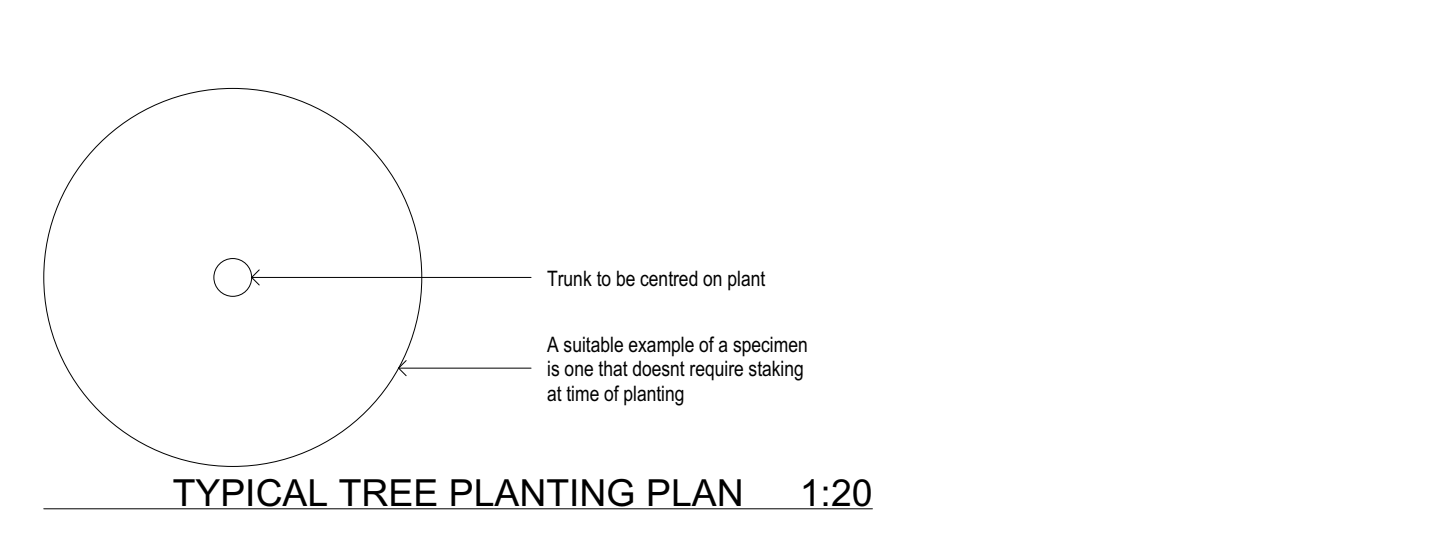
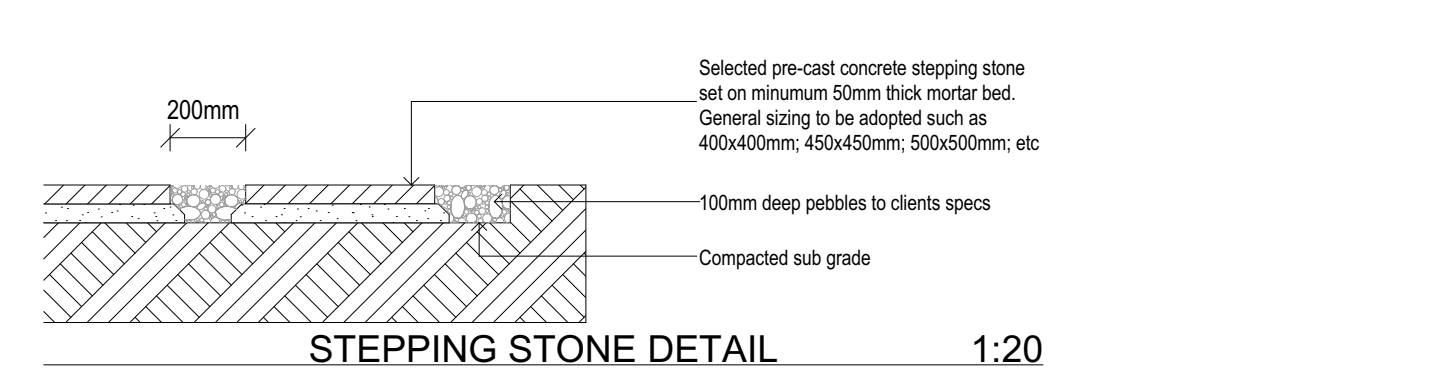
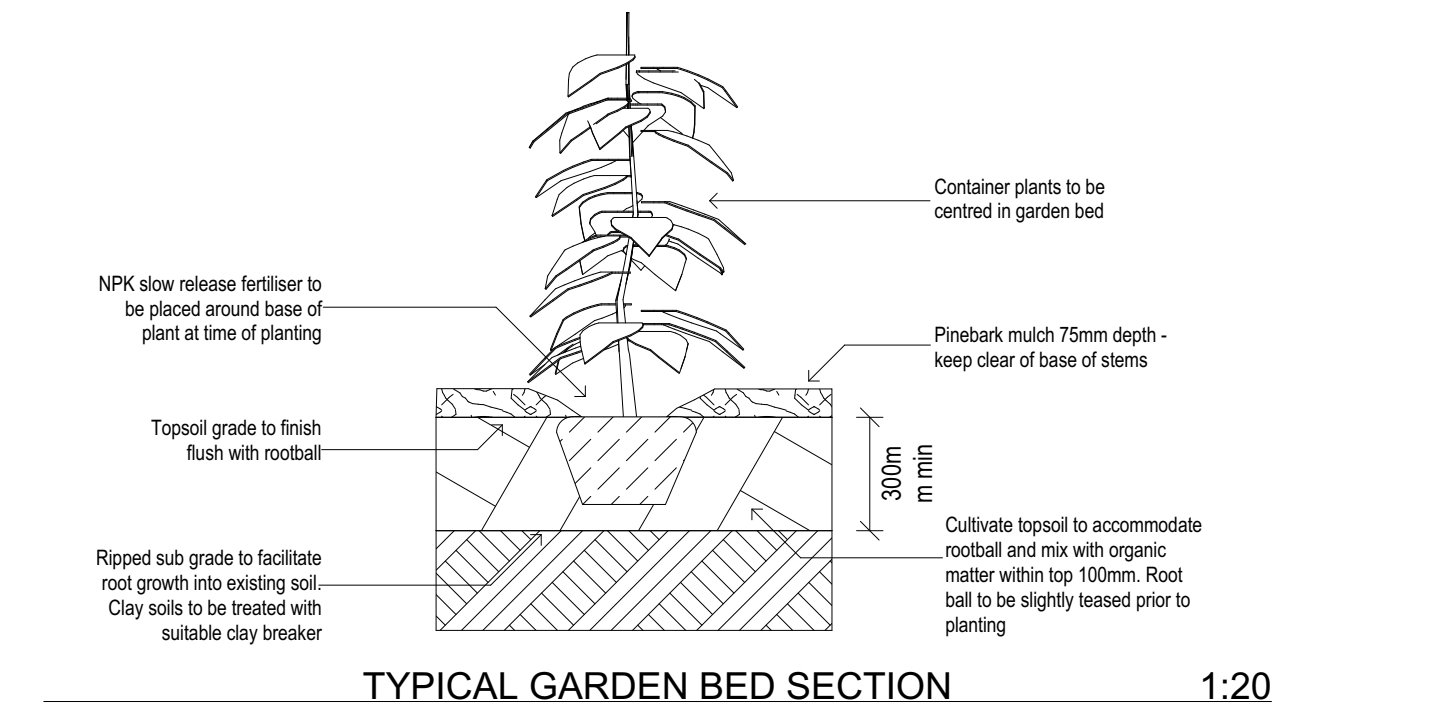
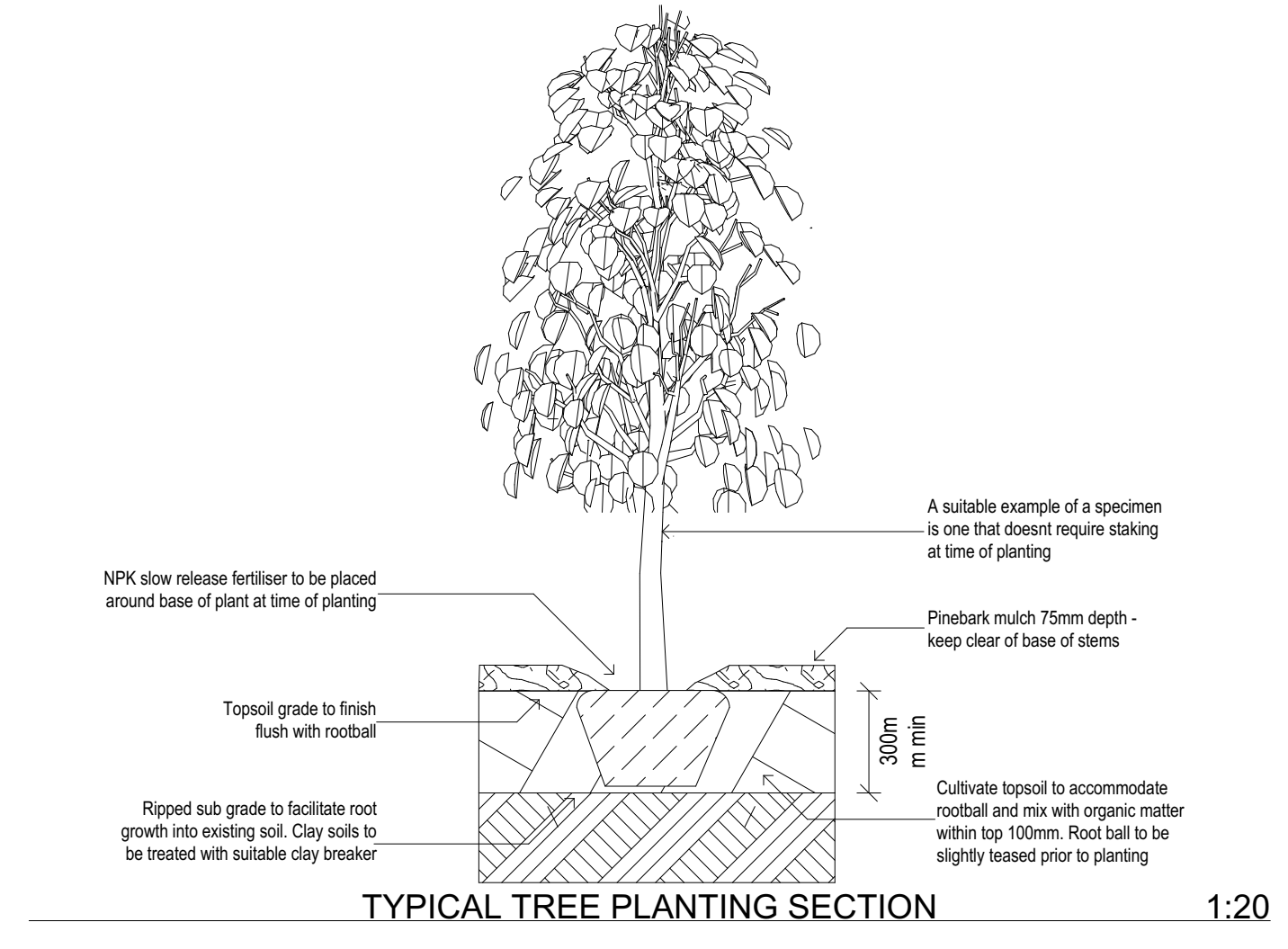
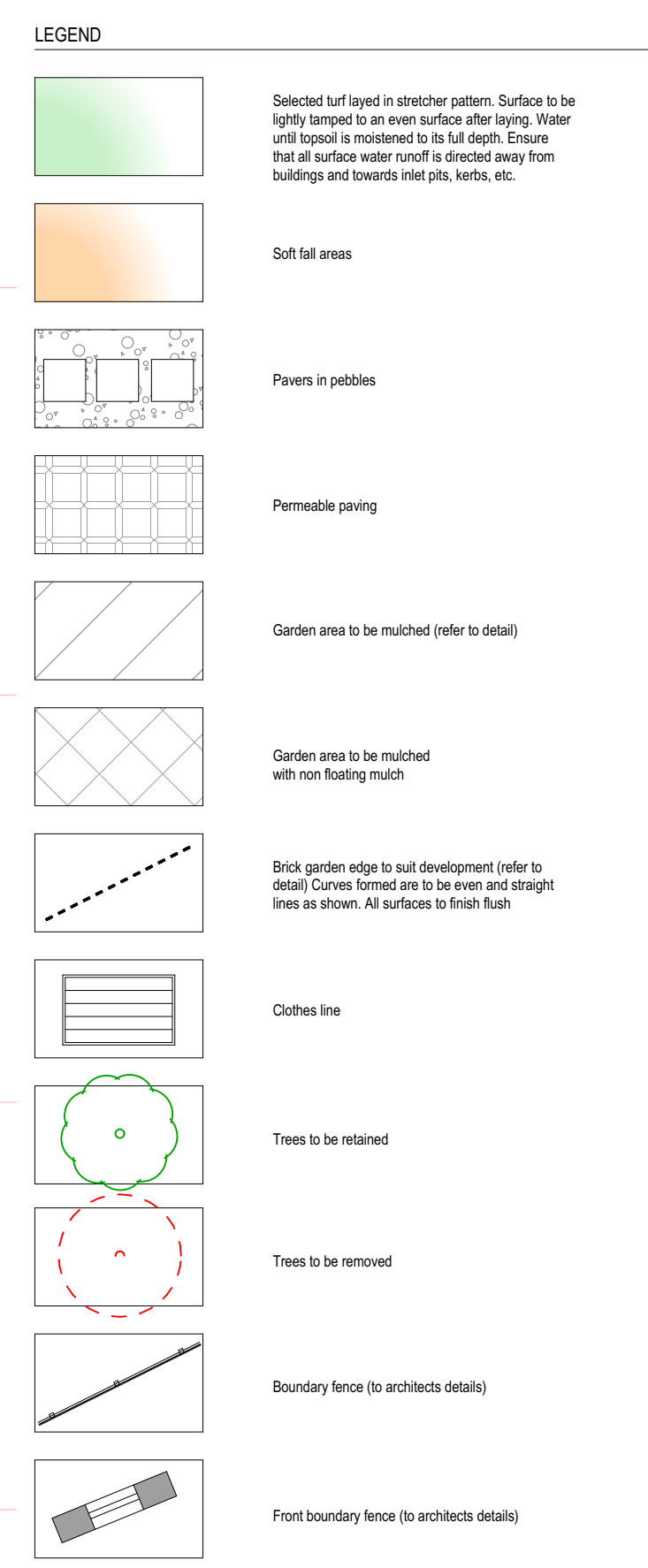
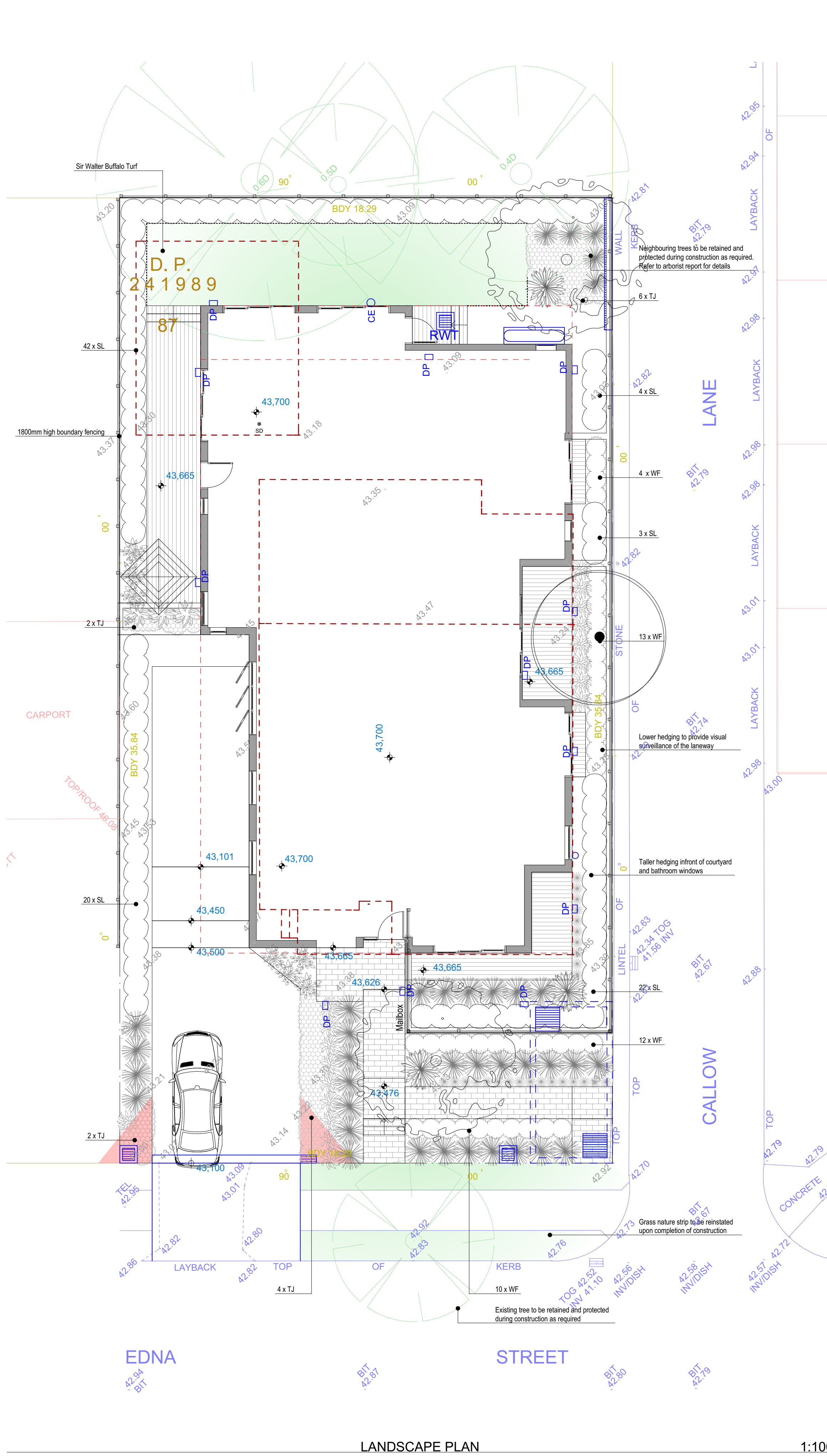
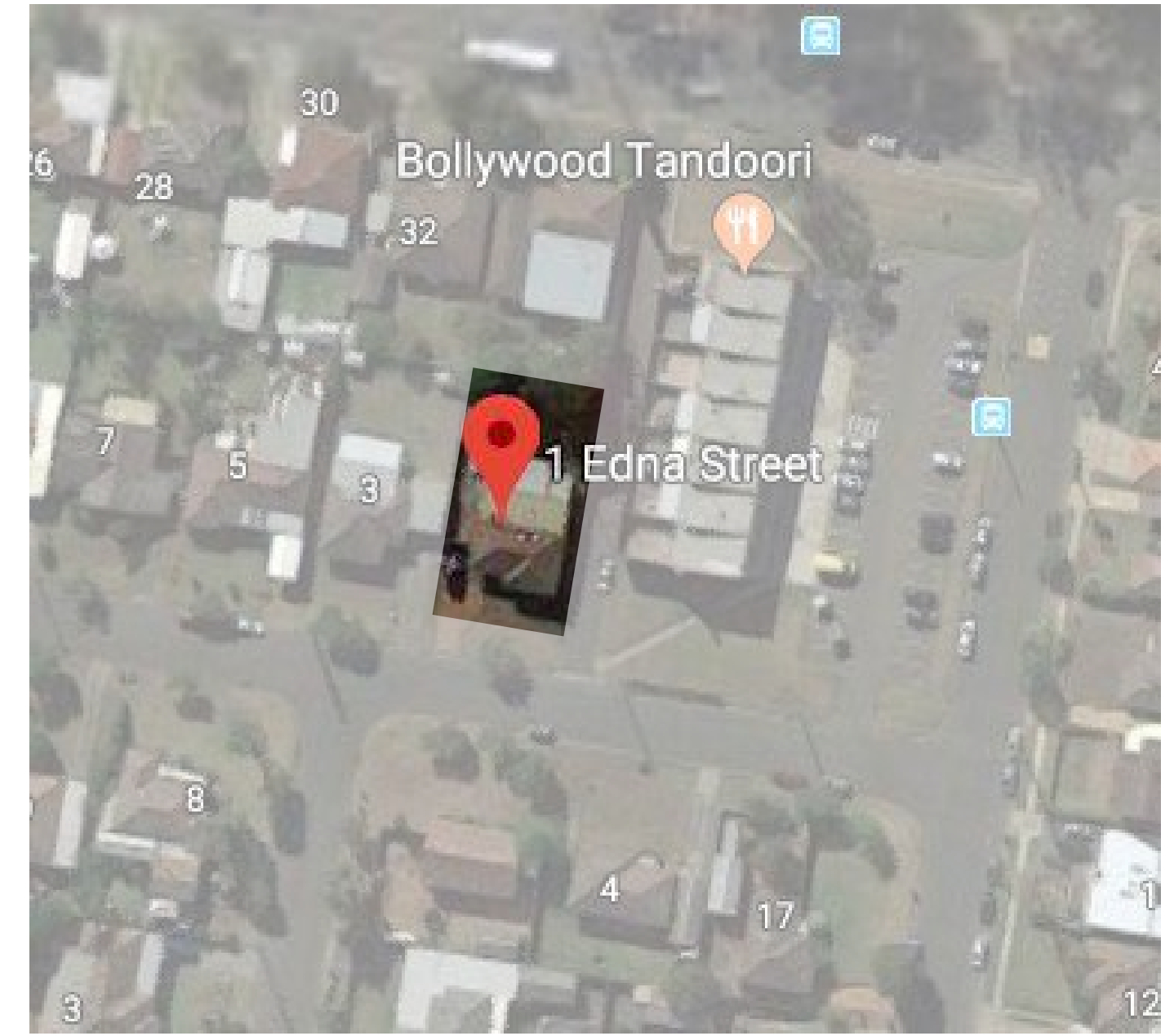

PLANTING SCHEDULE Note: Plant symbols on plan refers directly to table below. Plants to be mass planted have number allocated accordingly *denotes native species

Symbol	Code	Botanical Name	Common Name	Mature Height	Pot size	Quantity
	TJ	Trachelospermum jasminoides	Star Jasmine	300mm	140mm	14
	LM	Liriope muscari cvs	Lily Turf	400mm	50mm	26
	LLT	Lomandra longifolia 'Tanika'	Tanika Lomandra	700mm	140mm	18
	WF	Westringia fruticosa *	Coastal Rosemary	1,000mm	200mm	39
	PX	Phlloendron 'Xanadu'	Xanadu	1,000mm	140mm	4
	PAR	Pennisetum advena 'Rubrum'	Purple Fountain Grass	1,200mm	140mm	32
	LH	Lomandra hysterix *	Katie's Belles Lomandra	1,500mm	150mm	3
	DE	Doryanthes excelsa *	Gymea Lily	1,500mm	25L	3
	SL	Syzygium leuhmannii *	Lily Pilly 'Royal Flame'	2,000mm	200mm	91
	ER	Elaeocarpus reticulatus *	Blueberry Ash	10,000mm	45L	1
	TL	Tristania laurina *	Water Gum	15,000mm	75L	1

- NOTES**
- Contractors must verify all dimensions on site before commencing work which must be approved before manufacturing
 - Do not scale off drawing. If in doubt all dimensions are to be verified by designer
 - This drawing is to be read in conjunction with the approved architectural, hydraulic and survey plans
 - All trees to be retained shall be protected as per arborist report and/or council requirements. All pruning shall be in accordance with A.S. 4373
 - All landscape works shall comply with all council DA & CC conditions and all relevant Australian Standards. Any deviation from the approved design is not authorised under the development consent. Any alteration to design and plant material must be approved by the accredited certifier
 - Irrigation system - If required, shall be designed & installed to comply with AS 2698.1-1994, AS 2698.2-1995, AS 2698.3-1990, water board and other relevant authority regulations
 - All landscape works are to be maintained for a period of 12 months after final completion. All plants that fall are to be replaced with the same species. Mulch is to be maintained at specified depth. All plants and turf shall be watered on a regular basis to maintain moisture levels required for optimum growth. All garden areas are to be maintained free from weeds
 - Minimum BASIX requirement in relation to native landscaped area to be met
 - Planted areas within on site detentions or any planted areas on a flood risk sites or sites that contain overland flow are to be mulched with non floating mulch to avoid floating material

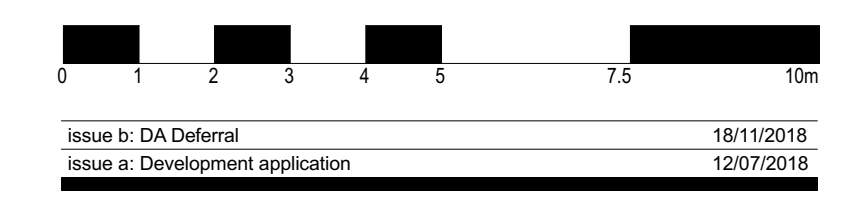

PO BOX 5081
Old Toongabbie NSW 2146
mob: 0413 933 613
info@andrewmurphydesign.com.au

ANDREW MURPHY DESIGN ABN 658019745153

Project: PROPOSED LANDSCAPE DESIGN @ 1 EDNA STREET, KINGSWOOD
Client: MR ELIE ELIAS
drawn: A.M. | date: NOV18 | ref: 2018-053 | Council PCC

B01