

Periodic Maintenance Procedures – Stormwater Treatment Device

PROJECT: **06962 - 88 Reid St Werrington**

Prepared on: 01/03/2016

The procedures as listed below are set out as a guide only and do not take precedence over the manufactures' maintenance warranty procedures and Authority requirements

ENVIROPOD PIT INSERTS

Item	Period	Responsibility	Maintenance Procedure
Inspection	Monthly and after Major Storms	Owner	Follow procedure set out in the EnviroPod Operations Manual
Major Maintenance	4 months or as required	Maintenance Contractor	Follow procedure set out in the EnviroPod Operations Manual
Emergency Maintenance	As required	Maintenance Contractor	Follow procedure set out in the EnviroPod Operations Manual

STORMFILTER

Item	Period	Responsibility	Maintenance Procedure
Inspection – Minor Maintenance	12 monthly and after major storms	Maintenance Contractor	Follow procedure set out in StormFilter Operations Manual
Inspection – Major Maintenance	12 monthly and after major storms	Maintenance Contractor	Follow procedure set out in StormFilter Operations Manual
Major Maintenance Sediment Removal	12 months or as required	Maintenance Contractor	Follow procedure set out in StormFilter Operations Manual
Major Maintenance Cartridge Replacement	12 months or as required	Maintenance Contractor	Follow procedure set out in StormFilter Operations Manual

Harout Tcherkezian

Stormwater 360

NSW Office

PO Box 792, Botany, NSW 1455

Tel: 1300 354 722

Fax: 1300 971 566

QLD Office

PO Box 4471 Forest Lake QLD 4078

Tel: 1300 354 722

Fax: 1300 971 566

Email: enquiries@stormwater360.com.au

IES Stormwater P/L trading as Stormwater 360

ABN: 79 101 258 182

www.stormwater360.com.au

STORMFILTER DESIGN TABLE					
<ul style="list-style-type: none"> STORMFILTER TREATMENT CAPACITY VARIES BY NUMBER OF FILTER CARTRIDGES INSTALLED AND BY REGION SPECIFIC INTERNAL FLOW CONTROLS. CONVEYANCE CAPACITY IS RATED AT 80L/S. THE STANDARD CONFIGURATION IS SHOWN. ACTUAL CONFIGURATION OF THE SPECIFIED STRUCTURE(S) PER CIVIL ENGINEER WILL BE SHOWN ON SUBMITTAL DRAWING(S). ALL PARTS PROVIDED AND INTERNAL ASSEMBLY BY STORMWATER360 AUSTRALIA UNLESS OTHERWISE NOTED. 					
CARTRIDGE HEIGHT	690		460		310
SYSTEM HYDRAULIC DROP (H - REQ'D. MIN.)	930		700		550
TREATMENT BY MEDIA SURFACE AREA L/S/m2	1.4	0.7	1.4	0.7	1.4
CARTRIDGE FLOW RATE (L/s)	1.42	0.71	0.95	0.47	0.63
					0.32

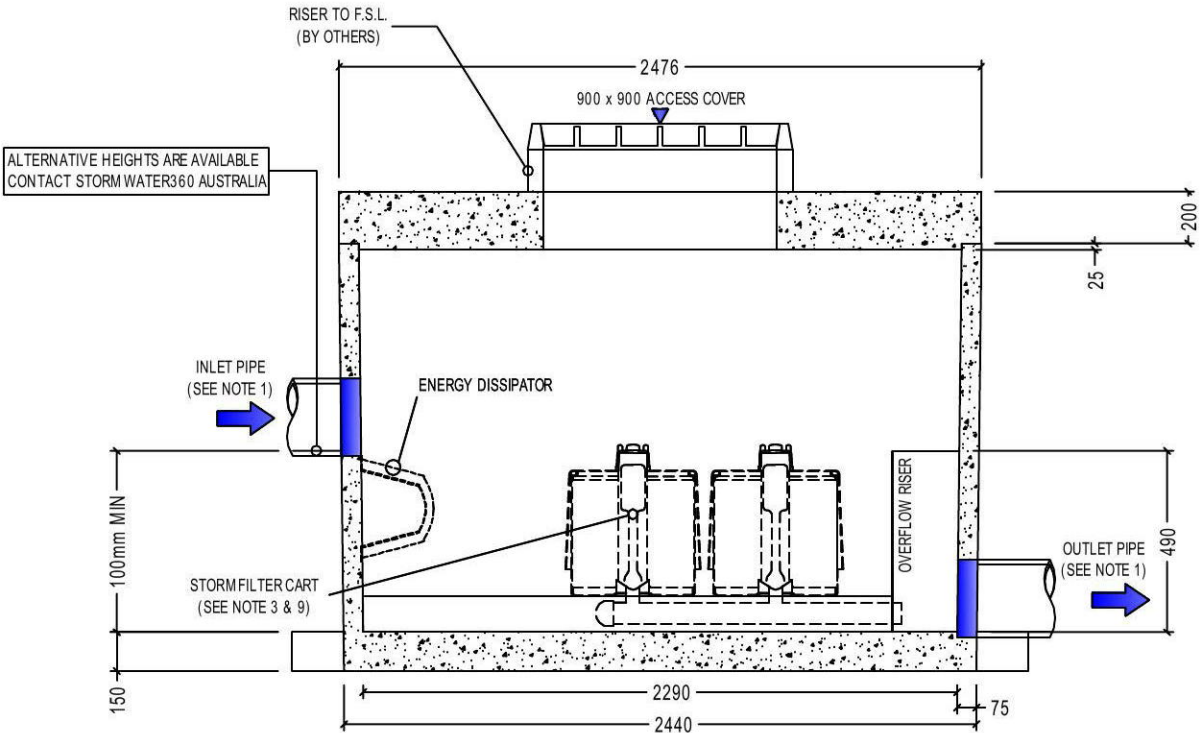

MANHOLE STORMFILTER SECTION

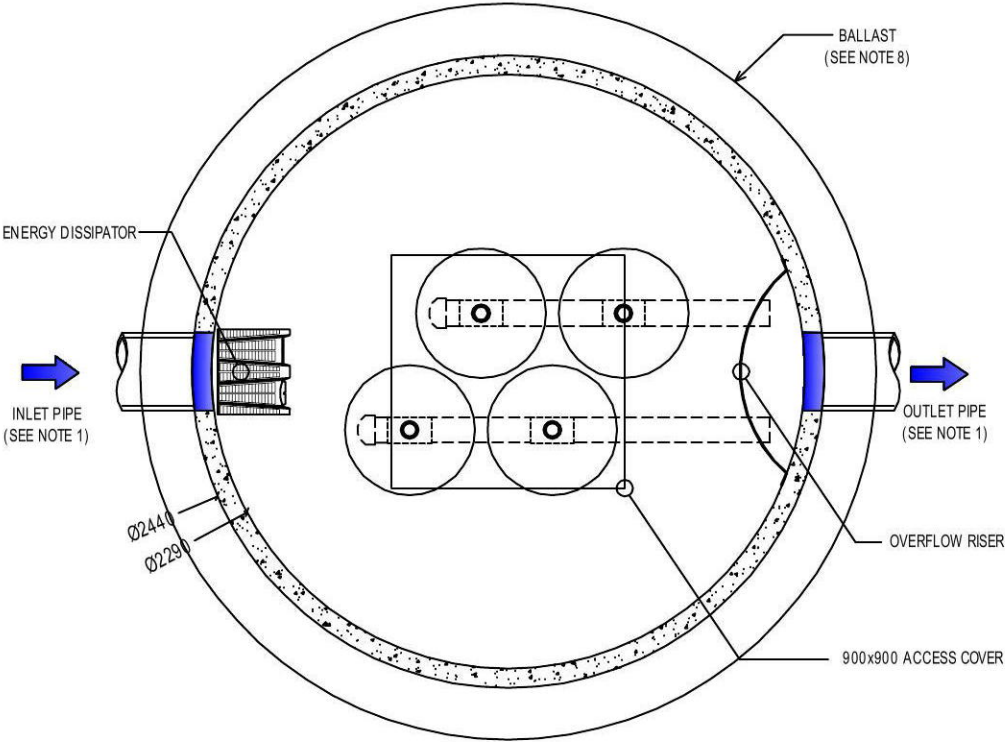

MANHOLE STORMFILTER PLAN

GENERAL NOTES	
1.	INLET AND OUTLET PIPING SHALL BE SPECIFIED BY SITE CIVIL ENGINEER (SEE PLANS) AND PROVIDED BY CONTRACTOR. STORMFILTER IS PROVIDED WITH OPENINGS AT INLET AND OUTLET LOCATIONS.
2.	IF THE PEAK FLOW RATE, AS DETERMINED BY THE SITE CIVIL ENGINEER, EXCEEDS THE PEAK HYDRAULIC CAPACITY OF THE PRODUCT, AN UPSTREAM BYPASS STRUCTURE IS REQUIRED. PLEASE CONTACT STORMWATER360 AUSTRALIA FOR OPTIONS.
3.	THE FILTER CARTRIDGE(S) ARE SIPHON-ACTUATED AND SELF-CLEANING. THE ACTUAL NUMBER SHALL BE SPECIFIED BY THE SITE CIVIL ENGINEER ON SITE PLANS OR IN DATA TABLE BELOW. PRECAST STRUCTURE TO BE CONSTRUCTED BY STORMWATER360 AUSTRALIA IN ACCORDANCE WITH AS3600.
4.	SEE STORMFILTER DESIGN TABLE FOR REQUIRED HYDRAULIC DROP. FOR SHALLOW, LOW DROP OR SPECIAL DESIGN CONSTRAINTS, CONTACT STORMWATER360 AUSTRALIA FOR DESIGN OPTIONS.
5.	ALL WATER QUALITY PRODUCTS REQUIRE PERIODIC MAINTENANCE AS OUTLINED IN THE O&M GUIDELINES. PROVIDE MINIMUM CLEARANCE FOR MAINTENANCE ACCESS.
6.	STRUCTURE AND ACCESS COVERS DESIGNED TO MEET AUSTRROADS T44 LOAD RATING WITH 0.0m TO 2.0m FILL MAXIMUM (CLASS D).
7.	THE STRUCTURE THICKNESSES SHOWN ARE FOR REPRESENTATIONAL PURPOSES AND VARY REGIONALLY.
8.	ANY BACKFILL DEPTH, SUB-BASE, AND OR ANTI-FLOTATION PROVISIONS ARE SITE-SPECIFIC DESIGN CONSIDERATIONS AND SHALL BE SPECIFIED BY SITE CIVIL ENGINEER.
9.	CARTRIDGE HEIGHT IS 690mm (SHOWN). CARTRIDGE HEIGHT AND ASSOCIATED DESIGN PARAMETERS PER STORMFILTER DESIGN TABLE.
10.	STORMFILTER BY STORMWATER360 AUSTRALIA: PHONE: 1300 354 722 OR www.stormwater360.com.au

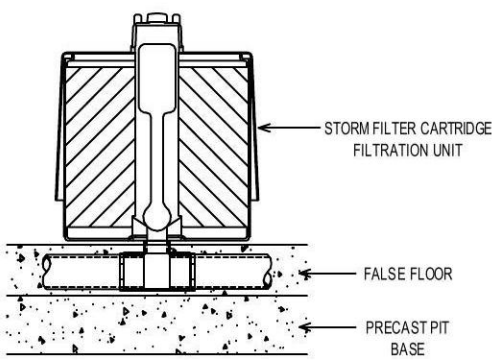

STORMFILTER CARTRIDGE DETAIL

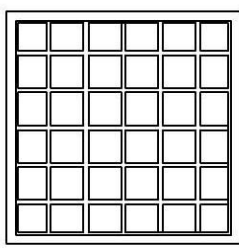

900 x 900 ACCESS COVER

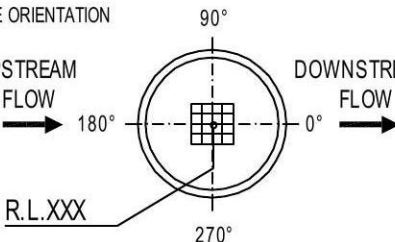
SITE SPECIFIC DATA REQUIREMENTS			
STRUCTURE ID		XXX	
WATER QUALITY FLOW RATE (L/S)		XXX	
PEAK FLOW RATE (L/S)		XXX	
RETURN PERIOD OF PEAK FLOW (yrs)		XXX	
# OF CARTRIDGES REQUIRED		4	
CARTRIDGE HEIGHT (310, 460 or 690mm)		310	
MEDIA TYPE (PERLITE, PERLITE/ZEOLITE OR ZPG)		PSORB	
PRECAST VAULT WEIGHT		XXX kg	
PRECAST LID WEIGHT		XXX kg	
PIPE DATA:			
I.L.	MATERIAL	DIAMETE	
INLET PIPE # 1	XXX	XXX	XXX
INLET PIPE # 2	N/A	N/A	N/A
OUTLET PIPE	XXX	XXX	XXX
PIPE ORIENTATION			
<div><div>UPSTREAM FLOW</div><div>180°</div><div>90°</div><div>0°</div><div>DOWNSTREAM FLOW</div><div>270°</div><div>R.L.XXX</div></div>			
LADDER		YES/NO	
ANTI-FLOTATION BALLAST	N/A	N/A	
	N/A	N/A	
NOTES/SPECIAL REQUIREMENTS:			



STORMWATER360 AUSTRALIA
4 CARTRIDGE STORMFILTER SYSTEM
Ø 2290 CONCRETE MANHOLE
GENERAL ARRANGEMENT

DRAWIN
1
A

DATE: 05.05.14 FILE NAME: 4C310SFMH_1A DRN: W.J. CHK: M.W