

1. SITE PLAN 1:200

date	revision	issue
30/10	for client review	-

**This drawing shall not be copied or used without authorization and is protected by copyright.**

all work shall comply with the provisions of the building code of australia, any applicable government act, australian standards, and any bylaws or requirements of the local authority.  
use figured dimensions only, do not scale, if in doubt ask.

report any discrepancies immediately for clarification and rectification. verify dimensions on site prior to any ordering or shop fabrication.  
this drawing shall not be copied or used without authorisation and is protected by copyright.

sheet index	
Layout ID	Layout Name
A.01.1	SITE PLAN
A.01.2	FLOOR PLAN
A.01.3	FLOOR PLAN
A.01.4	REFLECTED CEILING PLAN
A.01.5	ELEVATION & SECTION



**AusJu**  
**DESIGN & BUILD**  
 PO BOX 256 MAROUBRA NSW 2035  
 T: +61 450 971 010  
 W: www.ausju.com.au

**bdoc** **ABSA**  
Building Designers Association of Australia Architects Building Sustainability Association

datum	A.H.D.
survey	
scale	
drawn	C.CAI
approved	
date	30/10/21

project  
 U3 222 Queen Street St  
 Marys NSW 2760

Proposed Tenancy  
 Refurbishment

client <b>Michael Kelly</b>
drawing title <b>SITE PLAN</b>
drawing no. A.01.1
page no. 1/5
issue -

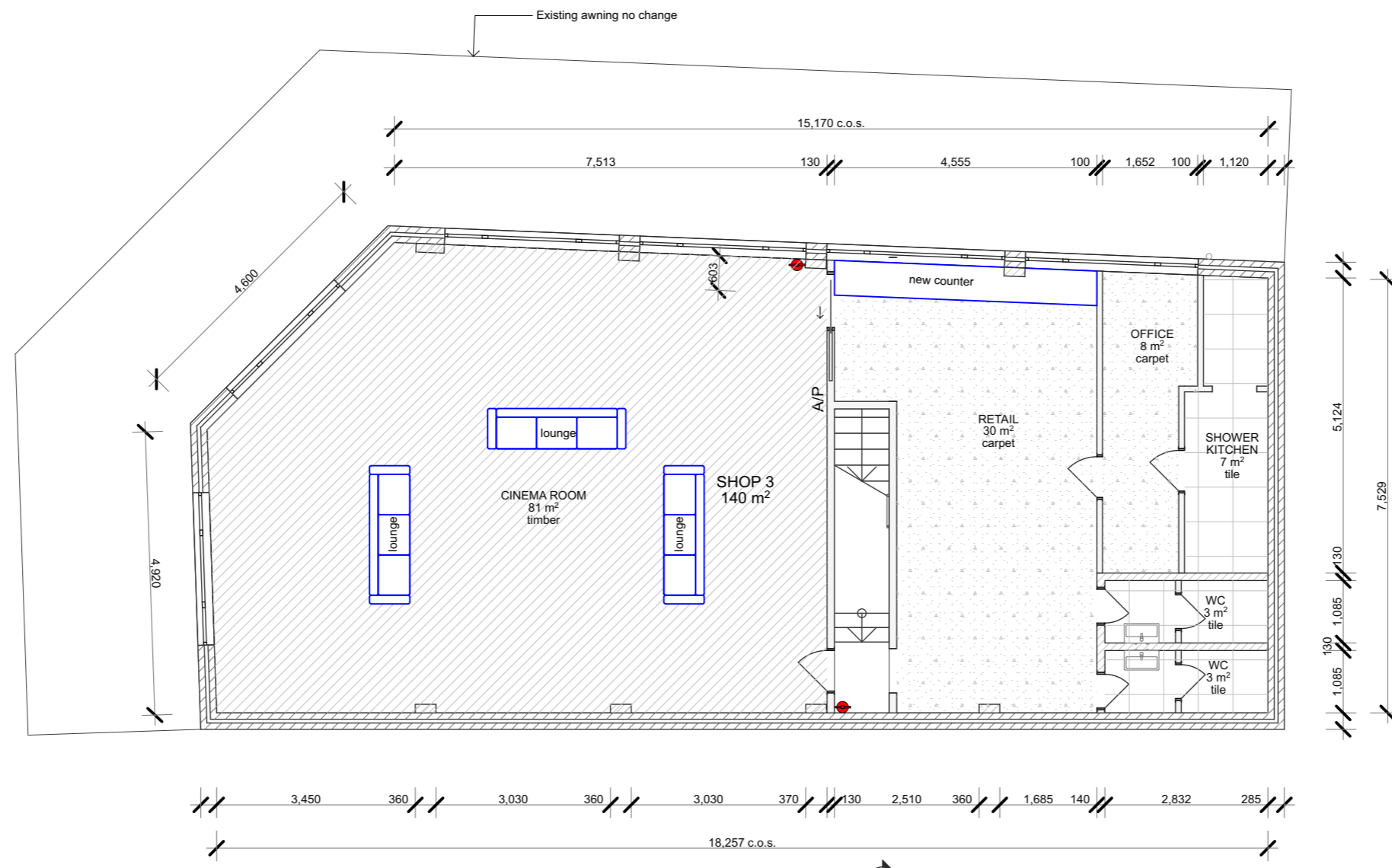

2. FIRST FLOOR PLAN 1:100

**Floor Plan Key**

- Existing Wall to Remain
- Existing Wall to be Removed
- New Joinery

date	revision	issue
30/10	for client review	-

**This drawing shall not be copied or used without authorization and is protected by copyright.**

all work shall comply with the provisions of the building code of australia, any applicable government act, australian standards, and any bylaws or requirements of the local authority.  
use figured dimensions only, do not scale, if in doubt ask.

report any discrepancies immediately for clarification and rectification. verify dimensions on site prior to any ordering or shop fabrication.  
this drawing shall not be copied or used without authorisation and is protected by copyright.

sheet index

Layout ID	Layout Name
A.01.1	SITE PLAN
A.01.2	FLOOR PLAN
A.01.3	FLOOR PLAN
A.01.4	REFLECTED CEILING PLAN
A.01.5	ELEVATION & SECTION



**AusJu**  
DESIGN & BUILD  
PO BOX 256 MAROUBRA NSW 2035  
T: +61 450 971 010  
W: www.ausju.com.au

datum	A.H.D.
survey	
scale	
drawn	C. CAI
approved	
date	30/10/21

project  
U3 222 Queen Street St  
Marys NSW 2760

Proposed Tenancy  
Refurbishment

client <b>Michael Kelly</b>		
drawing title FLOOR PLAN		
drawing no. A.01.2	page no. 2/5	issue -

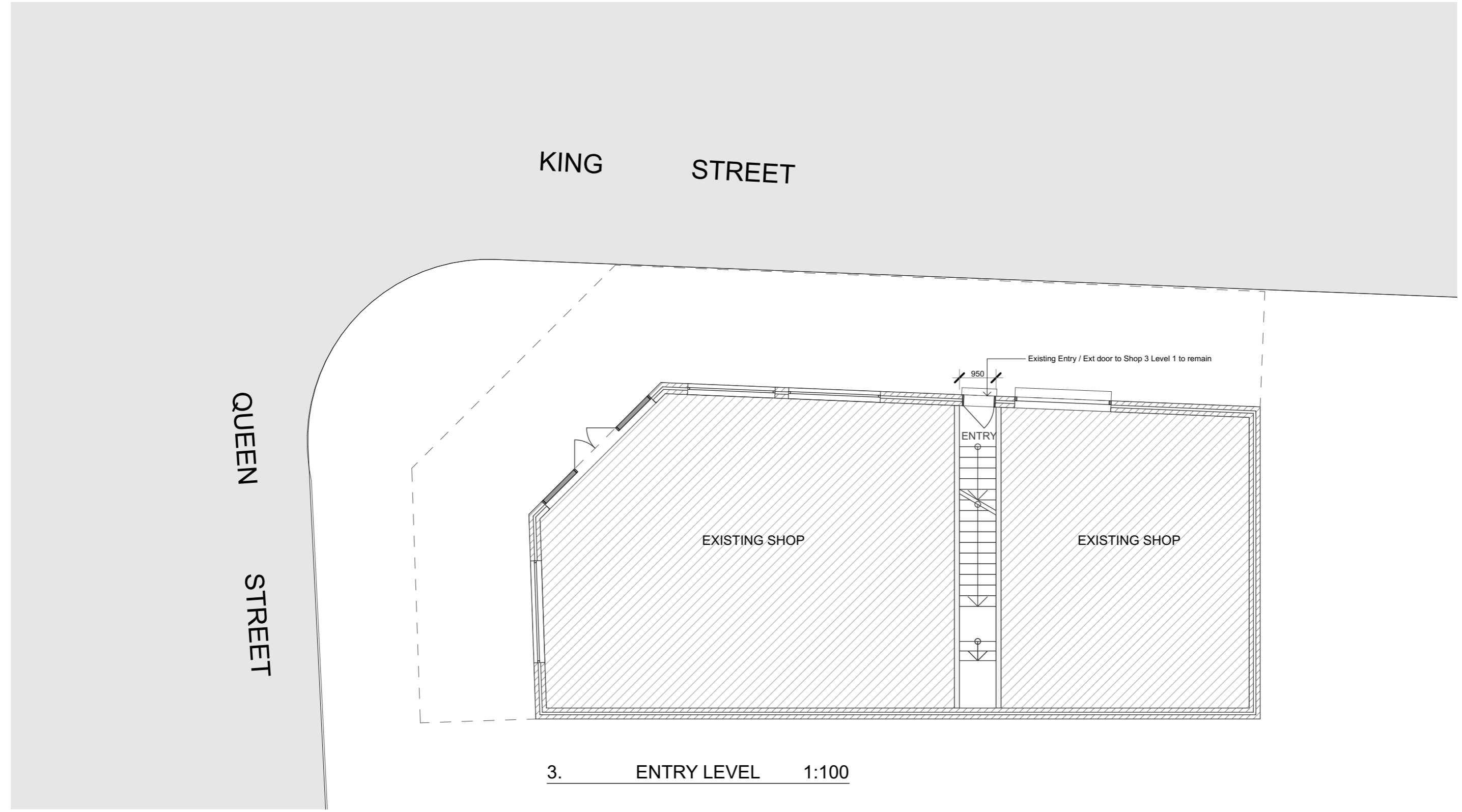

date	revision	issue
30/10	for client review	-

**This drawing shall not be copied or used without authorization and is protected by copyright.**

all work shall comply with the provisions of the building code of australia, any applicable government act, australian standards, and any bylaws or requirements of the local authority.  
use figured dimensions only, do not scale, if in doubt ask.

report any discrepancies immediately for clarification and rectification. verify dimensions on site prior to any ordering or shop fabrication.  
this drawing shall not be copied or used without authorisation and is protected by copyright.

sheet index	
Layout ID	Layout Name
A.01.1	SITE PLAN
A.01.2	FLOOR PLAN
A.01.3	FLOOR PLAN
A.01.4	REFLECTED CEILING PLAN
A.01.5	ELEVATION & SECTION



**AusJu**  
**DESIGN & BUILD**  
 PO BOX 256 MAROUBRA NSW 2035  
 T: +61 450 971 010  
 W: www.ausju.com.au

**bdo** **ABS**  
 BUILDING DESIGNERS ASSOCIATION OF AUSTRALIA  
 AUSTRALIAN BUILDING SUSTAINABILITY ASSOCIATION

datum	A.H.D.
survey	
scale	
drawn	C. CAI
approved	
date	30/10/21

project  
 U3 222 Queen Street St  
 Marys NSW 2760

Proposed Tenancy  
 Refurbishment

client <b>Michael Kelly</b>
drawing title FLOOR PLAN
drawing no. A.01.3
page no. 3/5
issue -

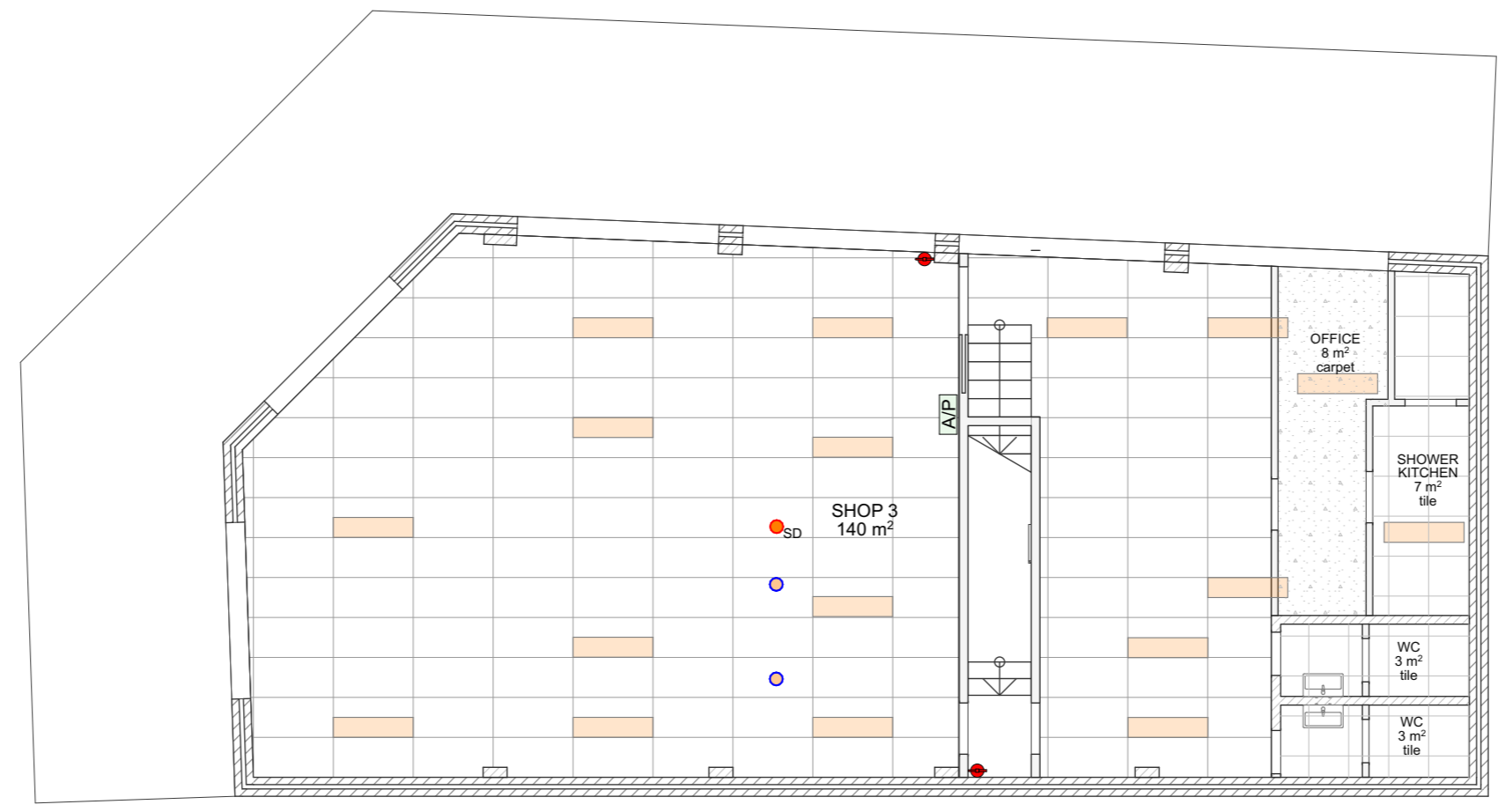

3. REFLECTED CEILING PLAN 1:100



**Services Legend**

- X ILLUMINATED EXIT SIGN (Existing)
- FLUORESCENT EXISTING SURFACE LIGHT FITTING
- SURFACE LIGHT
- SMOKE DETECTOR HARDWIRED
- A/P EXISTING ACCESS PANEL
- Portable fire extinguisher

date	revision	issue
30/10	for client review	-

**This drawing shall not be copied or used without authorization and is protected by copyright.**

all work shall comply with the provisions of the building code of australia, any applicable government act, australian standards, and any bylaws or requirements of the local authority.  
use figured dimensions only, do not scale, if in doubt ask.

report any discrepancies immediately for clarification and rectification. verify dimensions on site prior to any ordering or shop fabrication.  
this drawing shall not be copied or used without authorisation and is protected by copyright.

sheet index	
Layout ID	Layout Name
A.01.1	SITE PLAN
A.01.2	FLOOR PLAN
A.01.3	FLOOR PLAN
A.01.4	REFLECTED CEILING PLAN
A.01.5	ELEVATION & SECTION



**AusJu**  
**DESIGN & BUILD**  
 PO BOX 256 MAROUBRA NSW 2035  
 T: +61 450 971 010  
 W: www.ausju.com.au

bdoo ABSA

datum	A.H.D.
survey	
scale	
drawn	C. CAI
approved	
date	30/10/21

project  
 U3 222 Queen Street St  
 Marys NSW 2760

Proposed Tenancy  
 Refurbishment

client <b>Michael Kelly</b>
drawing title <b>REFLECTED CEILING PLAN</b>
drawing no. <b>A.01.4</b> page no. <b>4/5</b> issue <b>-</b>

NO. 222  
TWO STORY BRICK COMMERCIAL  
BUILDING METAL ROOF

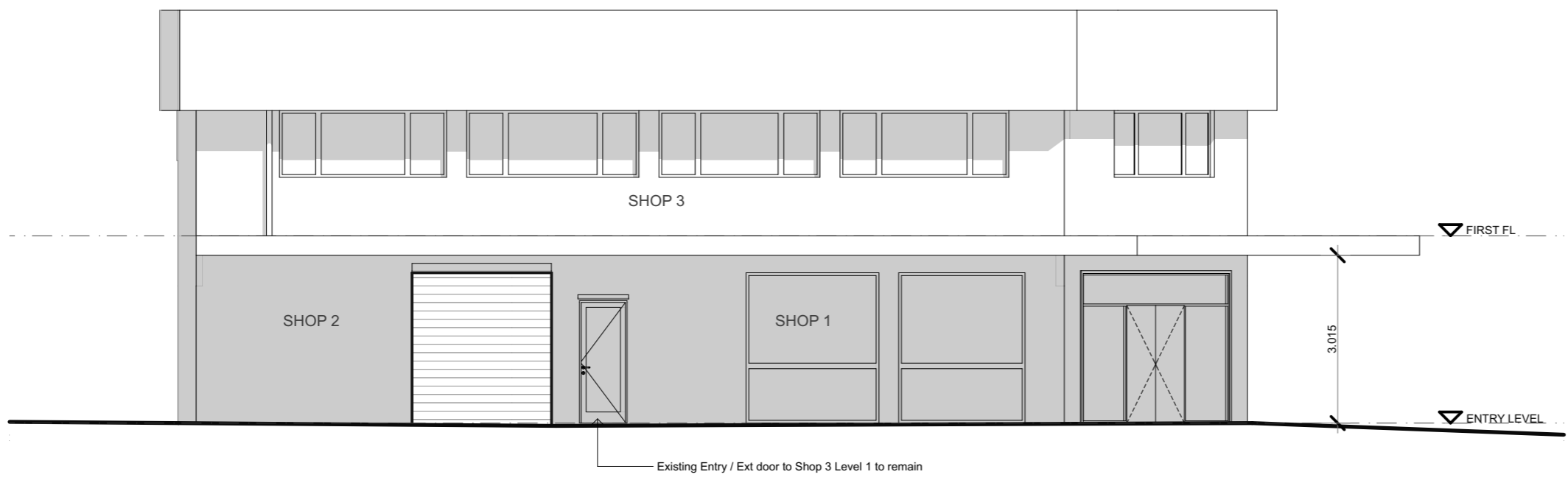

UP SHOP FRONT ELEVATION 1:100

NO. 222  
TWO STORY BRICK  
COMMERCIAL BUILDING  
METAL ROOF

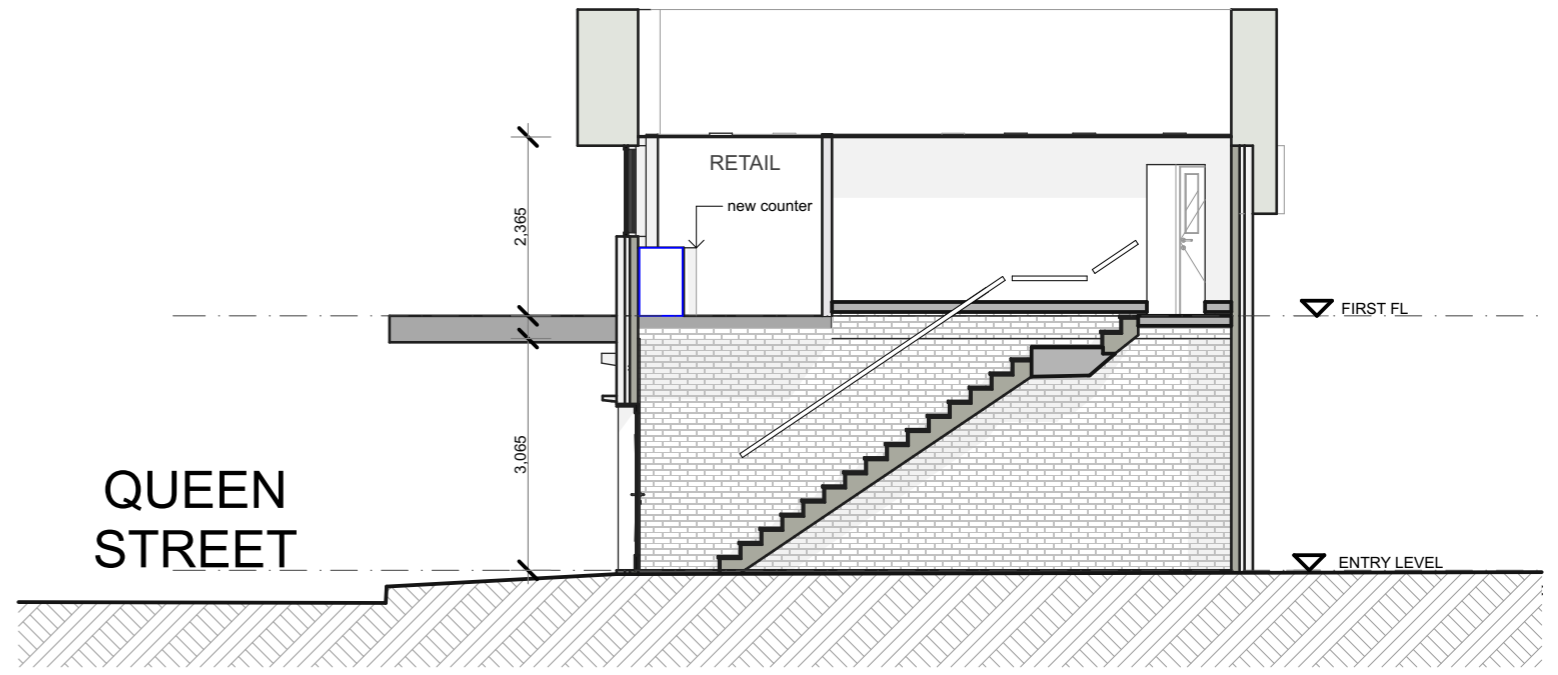

S-01 Building Section 1:100

date	revision	issue
30/10	for client review	-

**This drawing shall not be copied or used without authorization and is protected by copyright.**

all work shall comply with the provisions of the building code of australia, any applicable government act, australian standards, and any bylaws or requirements of the local authority.  
use figured dimensions only, do not scale, if in doubt ask.

report any discrepancies immediately for clarification and rectification. verify dimensions on site prior to any ordering or shop fabrication.  
this drawing shall not be copied or used without authorisation and is protected by copyright.

sheet index	
Layout ID	Layout Name
A.01.1	SITE PLAN
A.01.2	FLOOR PLAN
A.01.3	FLOOR PLAN
A.01.4	REFLECTED CEILING PLAN
A.01.5	ELEVATION & SECTION



**AusJu**  
DESIGN & BUILD  
PO BOX 256 MAROUBRA NSW 2035  
T: +61 450 971 010  
W: www.ausju.com.au

**bdo** **ABSA**  
AUSTRALIAN BUSINESS ASSOCIATION  
AUSTRALIAN BUILDING SUSTAINABILITY ASSOCIATION

datum	A.H.D.
survey	
scale	
drawn	C. CAI
approved	
date	30/10/21

project  
U3 222 Queen Street St  
Marys NSW 2760

Proposed Tenancy  
Refurbishment

client <b>Michael Kelly</b>		
drawing title ELEVATION & SECTION		
drawing no. A.01.5	page no. 5/5	issue -