

SEATING LEGEND		
◻	SLIM'N'COMFY 1 SEAT AUDITTO UNIT	10 TOTAL = 10 seats
◻◻◻	SLIM'N'COMFY 3 SEAT AUDITTO UNIT	38 TOTAL = 114 seats
◻◻◻◻	SLIM'N'COMFY 4 SEAT AUDITTO UNIT	103 TOTAL = 412 seats
		TOTAL = 536 seats

<p><b>Location</b>          SEATING AUDITORIUM          536 SEATING CAPACITY          PRELIMINARY SUBJECT TO          SEATING COMPLIANCE</p>	<p><b>SEATING SYSTEMS</b>          BY          LORITZ CIRCUS PTY          (STAMBUL PTY LTD)          Lot 4/Unit 24 Burnside Road          Yatala Qld. 4207          Phone: 07 3807 9700          Fax: 07 3807 9600          Email: office@webershowmakers.com.au</p>	<p><b>SEATING LAYOUT PLAN</b>          DRAWN BY OSMAN DESIGNPAC (M. DAVIS)          SHEET 1          SCALE 1:100          DATE 27/02/2006          C:\DWG\WEBER BROS\6471-24DIA-NZ-G.DWG          JOB NUMBER          6471</p>
--	--	--

© Copyright  
 Reproduction in part or whole is  
 forbidden without written permission.

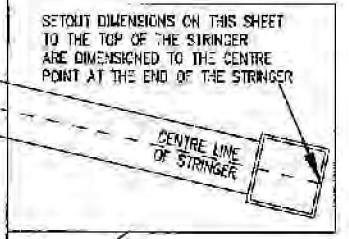
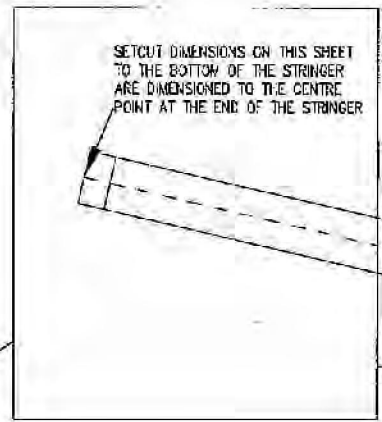
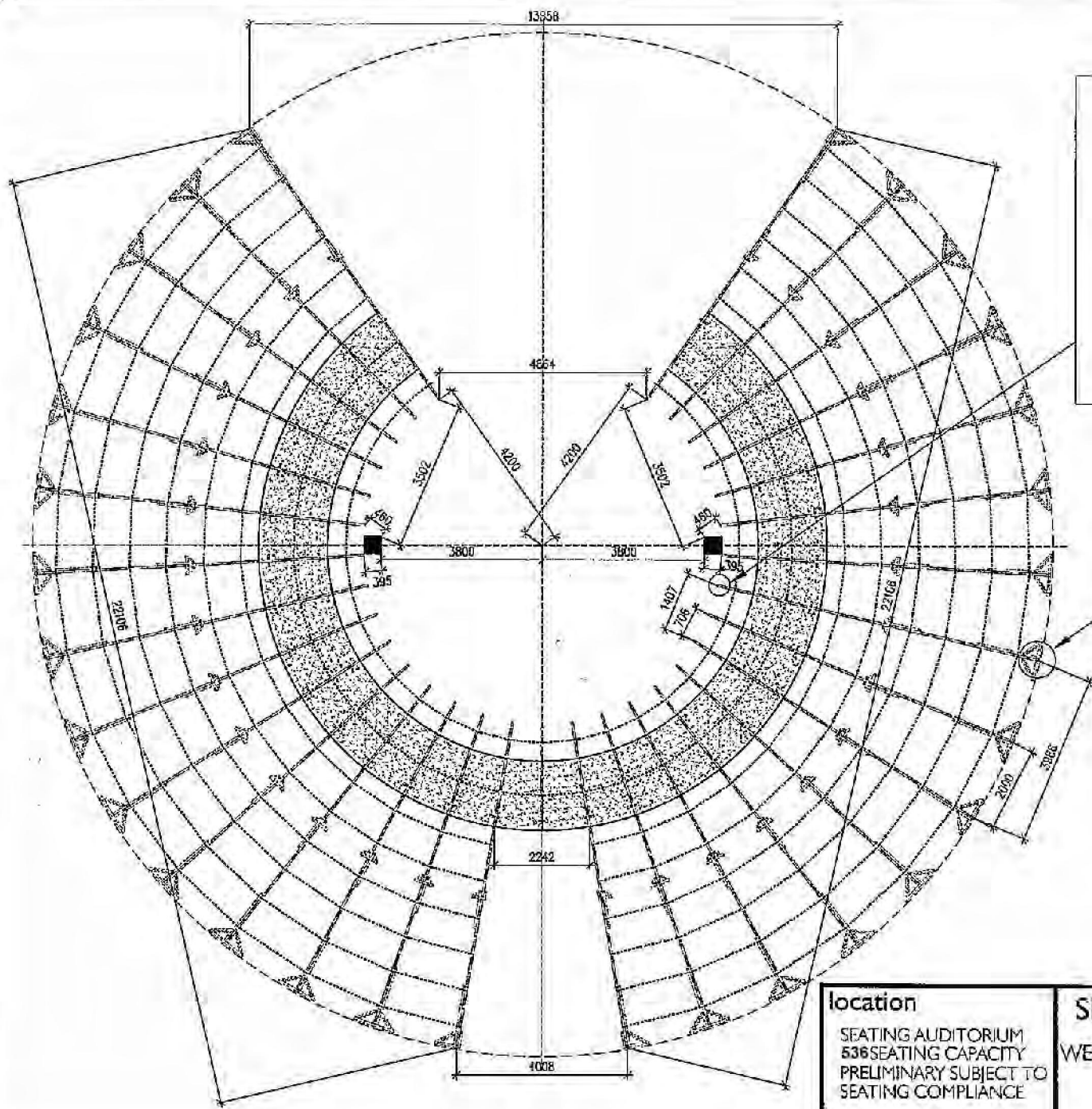

**location**  
 SEATING AUDITORIUM  
 536 SEATING CAPACITY  
 PRELIMINARY SUBJECT TO  
 SEATING COMPLIANCE

**SEATING SYSTEMS**  
 BY  
**WEBER BROS SHOW MAKERS**  
 (STAMBUL PTY LTD)  
 Lot 47 Unit 24 Burnside Road  
 Yatala Qld. 4207  
 Phone: 07 3807 9700  
 Fax: 07 3807 9600  
 Email: office@weberbroshowmakers.com.au

**STRINGER SETOUT PLAN**  
 DRAWN BY OSMAN DESIGNPAC (M. DAVIS)  
 SHEET 2  
 SCALE 1:100  
 DATE 27/02/2006  
 C:\DWG\WEBER BROS\6471-24DIA-N-Z-G.DWG  
**JOB NUMBER**  
 6471

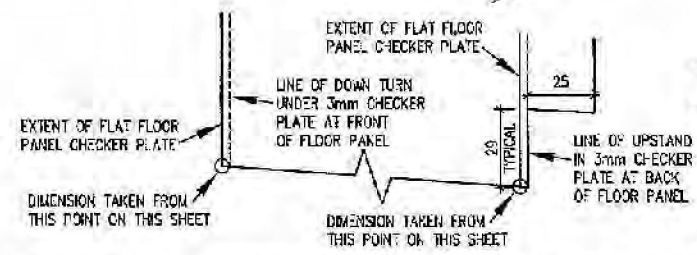
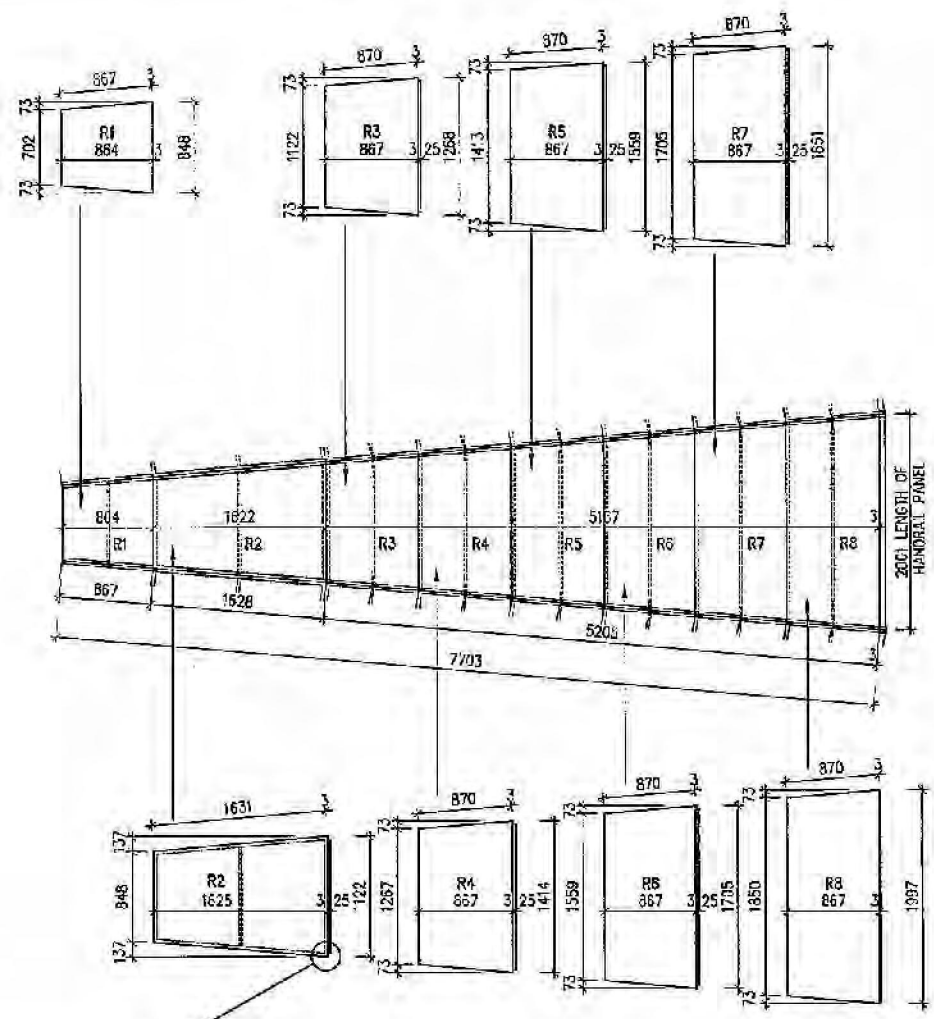

**TYPICAL WEDGE FLOOR PANEL LAYOUT**  
 SCALE 1:50

**FLOOR PANEL DIMENSION SET OUT DETAIL**  
 SCALE 1:2

<p><b>location</b>                  SEATING AUDITORIUM                  536 SEATING CAPACITY                  PRELIMINARY SUBJECT TO                  SEATING COMPLIANCE</p>	<p><b>SEATING SYSTEMS</b>                  BY                  WEBER BROS SHOW MAKERS                  (STAMBUL PTY LTD)                  Lot 4/Unit 24 Burnside Road                  Yatala Qld, 4207                  Phons : 07 3807 9700                  Fax : 07 3807 9633                  Email : office@webershowmakers.com.au</p>	<p><b>FLOOR PANEL LAYOUT</b>                  DRAWN BY GEMAN DESIGNPAC (M. DAVIS)                  SHEET 3                  SCALE 1:50, 1:2                  DATE 27/02/2006                  C:\DWG\WEBER BROS\6471-2ADIA-NZ-G.DWG                  JOB NUMBER                  6471</p>
--	--	---



© Copyright

Reproduction in part or whole is  
forbidden without written permission.

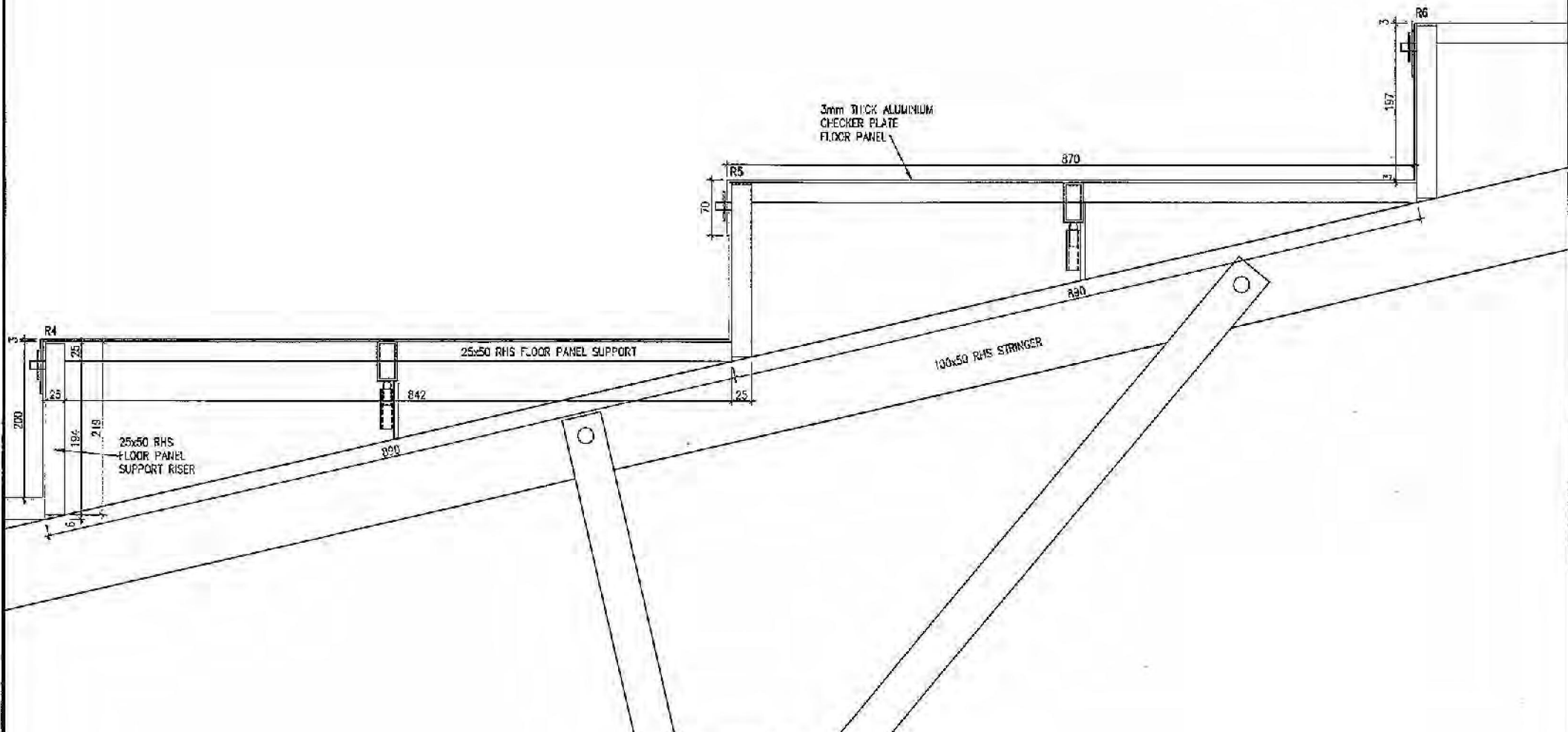

**STRINGER DETAIL**  
SCALE 1:5

<p><b>location</b></p> <p>SEATING AUDITORIUM 536 SEATING CAPACITY PRELIMINARY SUBJECT TO SEATING COMPLIANCE</p>	<p><b>SEATING SYSTEMS</b> BY <b>WEBER BROS SHOW MAKERS</b> (STAMBUL PTY LTD) Lot 4/Unit 24 Burnside Road Yatala Qld. 4207 Phone: 07 3807 9700 Fax: 07 3807 9600 Email: office@webershowmakers.com.au</p>	<p><b>STRINGER DETAIL</b></p> <p>DRAWN BY OSMAN DESIGN/RAC (M. DAVIS) SHEET 5 SCALE 1:5 DATE 27/02/2016 CNDWG/WEBER BROS/6471-24D/A/NZ/G.DWG</p> <p><b>JOB NUMBER</b> 6471</p>
---	--	--

© Copyright  
 Reproduction in part or whole is  
 forbidden without written permission.

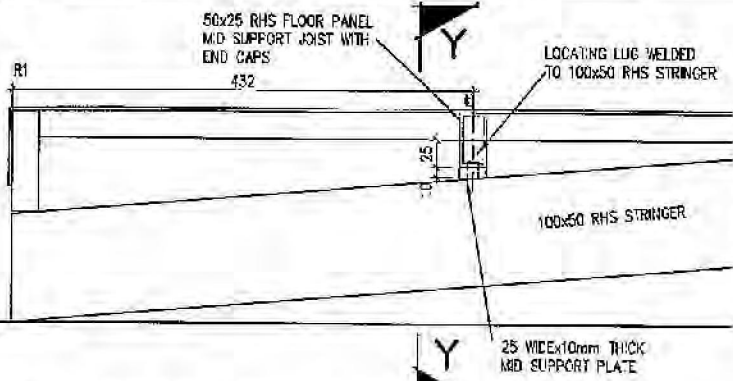

MID SUPPORT JOIST  
 TO STRINGER DETAIL (R1)  
 SCALE 1:5

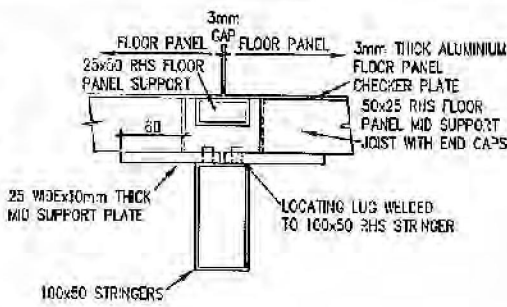

SECTION Y-Y  
 SCALE 1:5

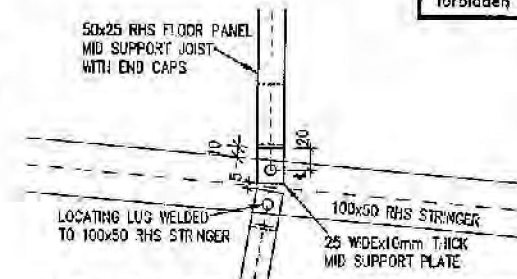

MID SUPPORT JOIST DETAIL (R1)  
 SCALE 1:5

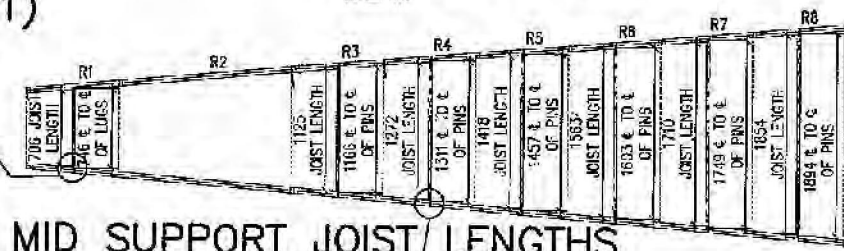

MID SUPPORT JOIST LENGTHS  
 TO TYPICAL WEDGE  
 SCALE 1:50

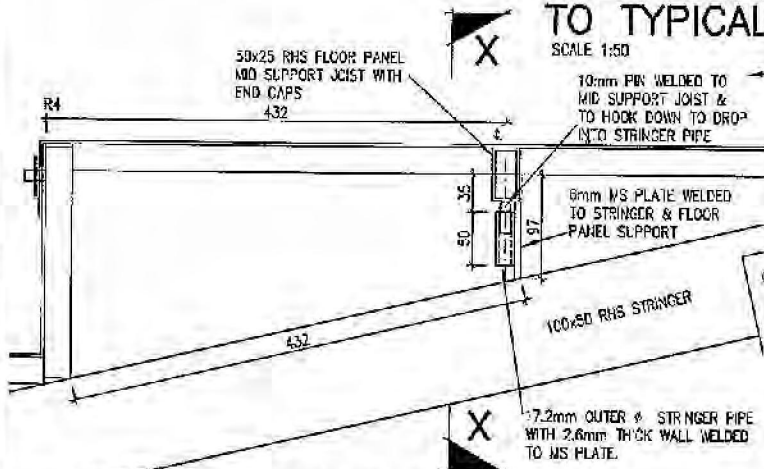

MID SUPPORT JOIST  
 TO STRINGER DETAIL (TYPICAL)  
 SCALE 1:5

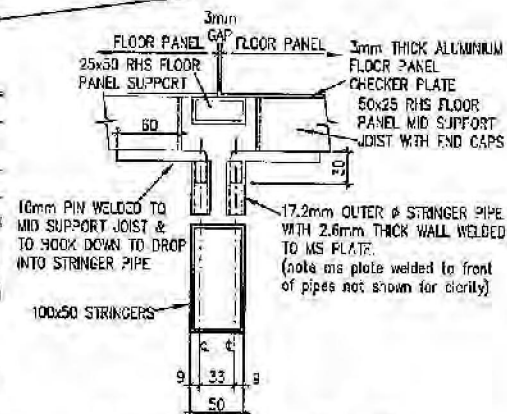

SECTION X-X  
 SCALE 1:5

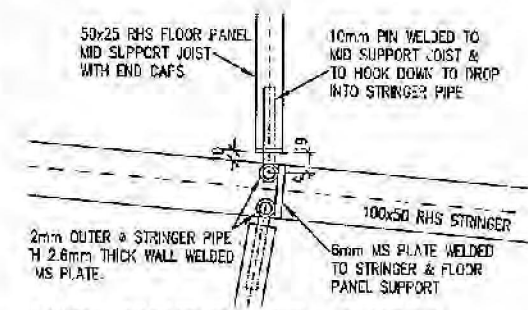

MID SUPPORT JOIST  
 DETAIL (TYPICAL)  
 SCALE 1:5

<p>location          SEATING AUDITORIUM          536 SEATING CAPACITY          PRELIMINARY SUBJECT TO          SEATING COMPLIANCE</p>	<p>SEATING SYSTEMS          BY          WEBER BROS SHOW MAKERS          (STAMBUL PTY LTD)          Lot 4A/Unit 24 Burridge Road          Yatai Qld. 4207          Phone: 07 3807 9700          Fax: 07 3307 9600          Email: office@webershshowmakers.com.au</p>	<p>MID SUPPORT JOIST DETAILS          DRAWN BY OSMAN DESIGN/PAC (M. DAVIS)          SHEET 6          SCALE 1:50, 1:5          DATE 27/02/2006          CAD/DWG/WEBER BROS/6471-24/DIA-NZ-G.DWG          JOB NUMBER          6471</p>
---	--	--

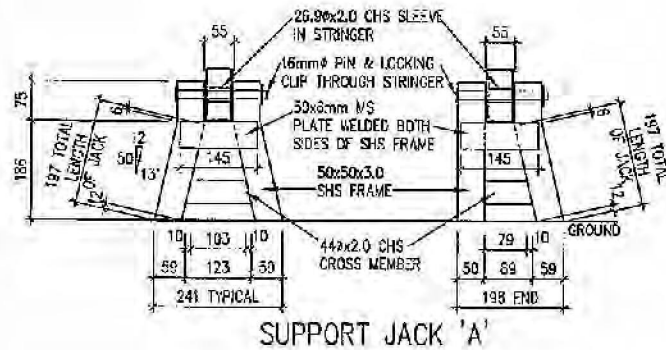
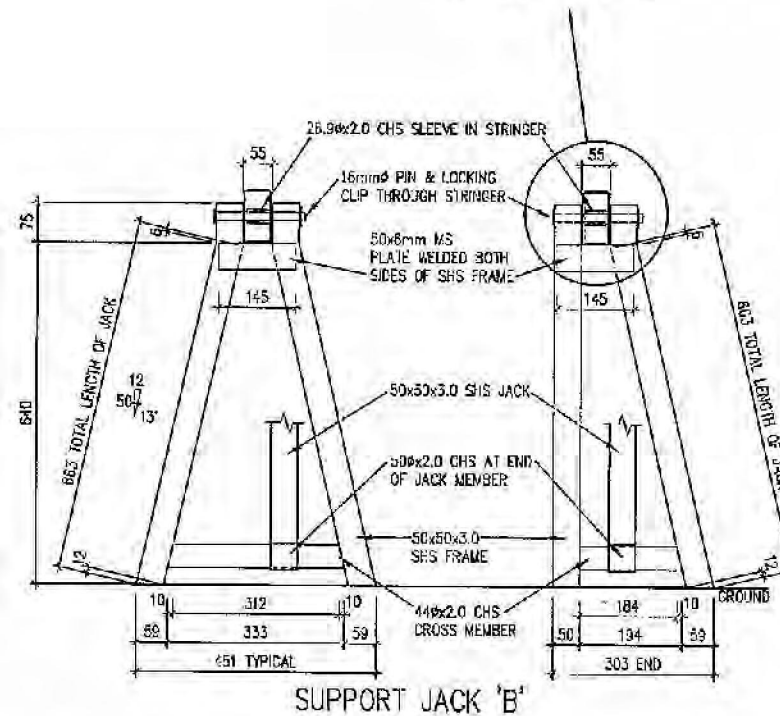
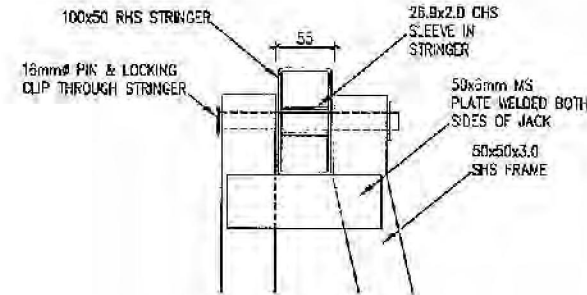

**location**

SEATING AUDITORIUM  
536 SEATING CAPACITY  
PRELIMINARY SUBJECT TO  
SEATING COMPLIANCE

**SEATING SYSTEMS**

BY  
WEBER BROS SHOW MAKERS  
(STAMBUL PTY LTD)

Lot 4 Unit 24 Burnside Road  
Yazba Qld. 4237

Phone : 07 3807 9700

Fax : 07 3807 9600

Email : office@webershowmakers.com.au

**SUPPORT JACKS**

DRAWN BY OSMAN DESIGNPAC (M. DAVIS)

SHEET 7

SCALE 1:10

DATE 27/02/2006

CADWG:WEBER BROS:6471-24DIA-NZ-G.DWG

JOB NUMBER

6471

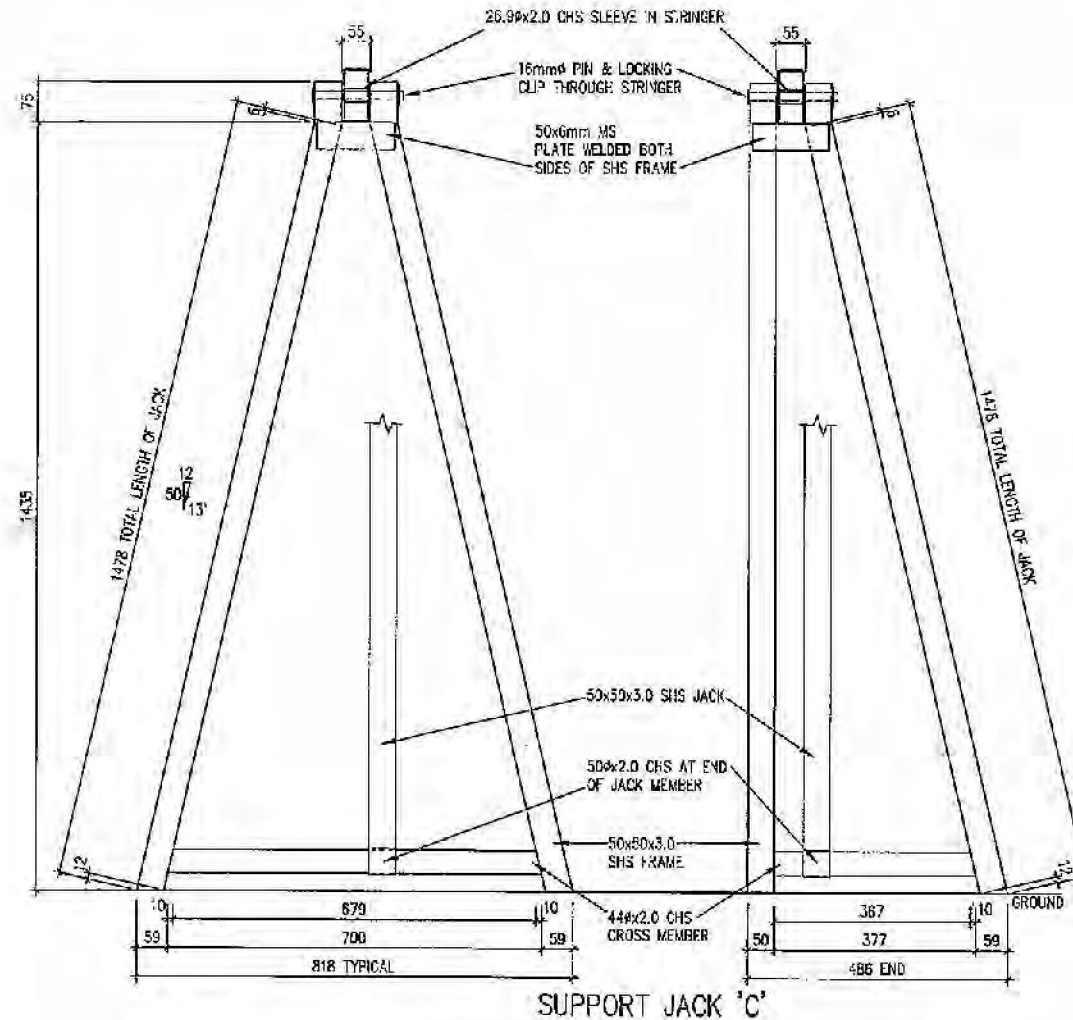

<p><b>location</b></p> <p>SEATING AUDITORIUM 536 SEATING CAPACITY PRELIMINARY SUBJECT TO SEATING COMPLIANCE</p>	<p><b>SEATING SYSTEMS</b> BY <b>WEBER BROS SHOW MAKERS</b> (STAMBUL PTY LTD) Lot 4/Unit 24 Burnside Road Tata's CML 4207 Phone : 07 3807 9700 Fax : 07 3307 9600 email : ulf@webershowmakers.com.au</p>	<p><b>SUPPORT JACKS</b></p> <p>DRAWN BY OSMAN DESIGNPAC (M. DAVIS) SHEET 8 SCALE 1:10 DATE 27/02/2004 C:\DWG\WEBER BROS\6471-24DIA-NZ-G.DWG</p> <p><b>JOB NUMBER</b> 6471</p>
---	---	---



© Copyright  
 Reproduction in part or whole is  
 forbidden without written permission.

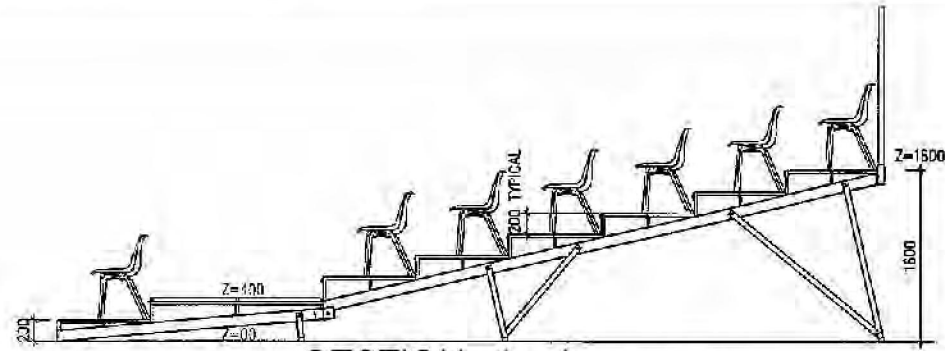

**SECTION 1-1** DOWN SIDE OF SEATING PANEL  
 SCALE 1:30

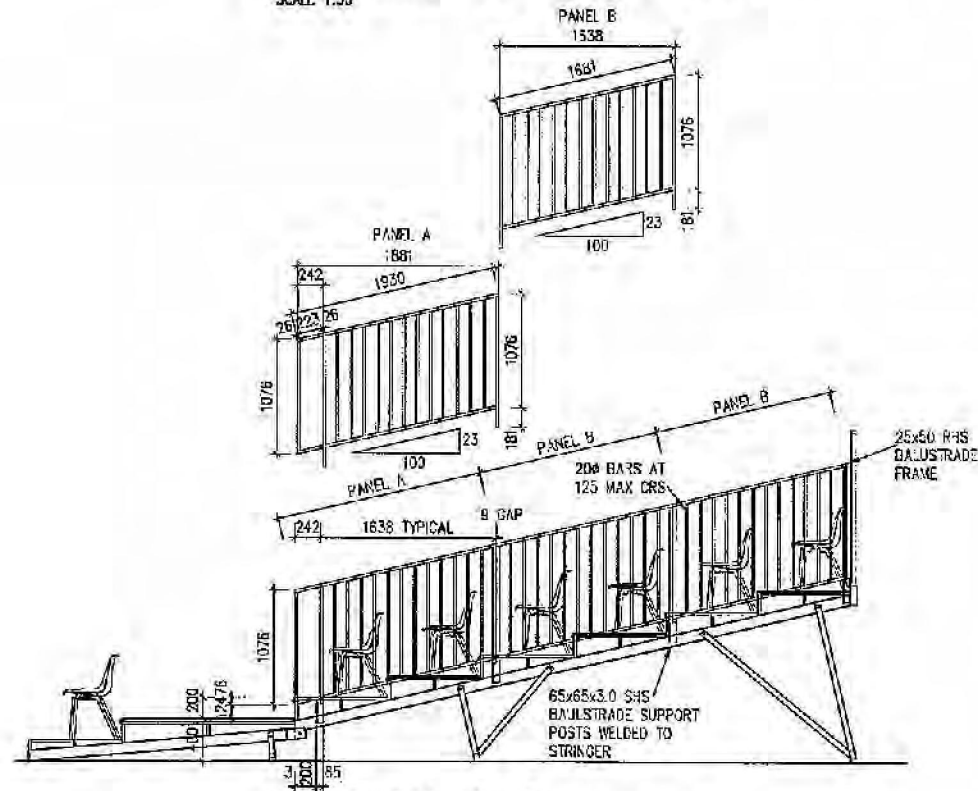

**SECTION 2-2** DOWN SIDE OF SEATING PANEL  
 SCALE 1:50

11027

location	SEATING SYSTEMS	SECTIONS
SEATING AUDITORIUM 536 SEATING CAPACITY PRELIMINARY SUBJECT TO SEATING COMPLIANCE	BY WEBER BROS SHOW MAKERS (STAMBUL PTY LTD) Lot 4, Unit 24 Burnside Road Yerrola, Qld. 4207 Phone: 07 3307 9790 Fax: 07 3807 9600 Email: office@webershowmakers.com.au	DRAWN BY OSMAN DESIGN PAC (M. DAVIS) SHEET 9 SCALE 1:50 DATE 27/02/2006 CADWG\WEBER_BROS\6471-24\A-NZ-G.DWG JOB NUMBER 6471

**Baytex Performance Tent**

**Loritz Circus**

**Note:**  
All dimensions in mm.  
All dimensions have tolerances of  
± 0.5mm unless otherwise stated.  
Break all sharp edges.

**Copyright:**  
This drawing and all the information  
it contains is the property of  
**Baytex Manufacturing Co Ltd.**

<b>Approved</b>		Initial	Date
	Checked		
	Issued		

Original Copy Red

Pantone Colors  
186c  
293c

- G APL 23.01.13 Altered Shroud Colour to White
- F 08.01.13 Pole Spacing Changed
- E 07.01.13 King Pole Spacing to 10m
- D 20.12.12 Revision of Graphics Detail
- A 19.12.12 Mdoified frm 011 to remove grap

No.	By	Date	Amendment
-----	----	------	-----------



**Baytex Manufacturing Company Ltd**  
52 Newton Street  
P.O. Box 4370  
Mt Maunganui  
New Zealand

Phone: 64 7 579 0190  
Fax: 64 7 579 0194  
email: sales@baytex.co.nz

A3 Drg 3rd Angle Proj

Scale **1:250** Drawing Type **Final Design**

Job Title

**Baytex Performance Tent  
Loritz Circus**

Drawing Title

**32m 4 Pole Circus Tent  
Perspective**

Sheet No.

Part No.

Drawing No. **15.242.111** Revision No. **G**

Date **19.12.12**

Drawn By **A.P.Lingman**

**Thu, 7 Mar 2013  
2:05:53 PM  
15.242.110-114h Ø32m Loritz Fin**

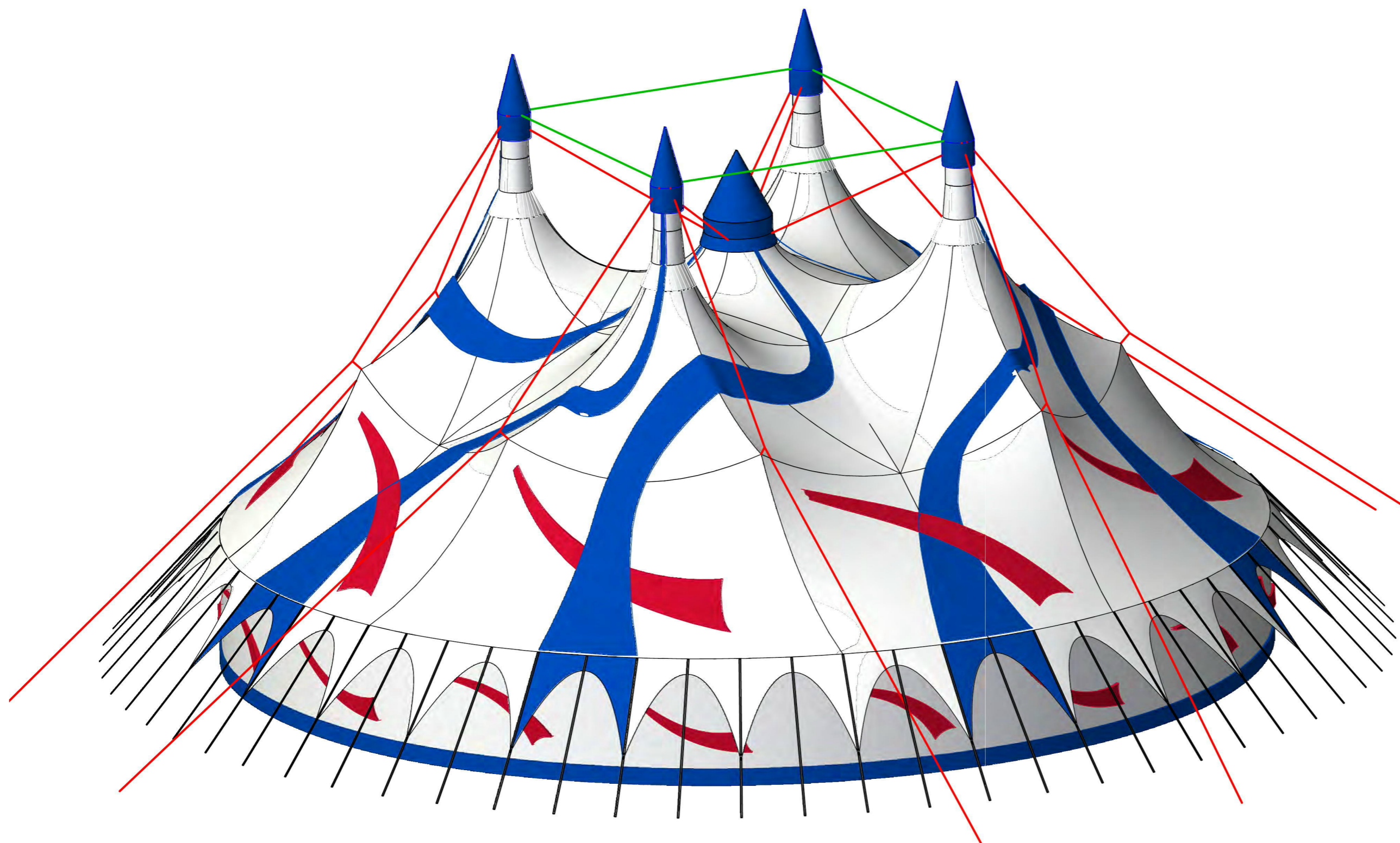

**Baytex Circus Tents**  
**Loritz Ø32m 4 pole**

**Note:**  
 All dimensions in mm.  
 All dimensions have tolerances of  $\pm 0.5\text{mm}$  unless otherwise stated.  
 Break all sharp edges.

**Copyright:**  
 This drawing and all the information it contains is the property of  
**Baytex Manufacturing Co Ltd.**

**Approved**

	Initial	Date
Checked		
Issued		

Original Copy Red

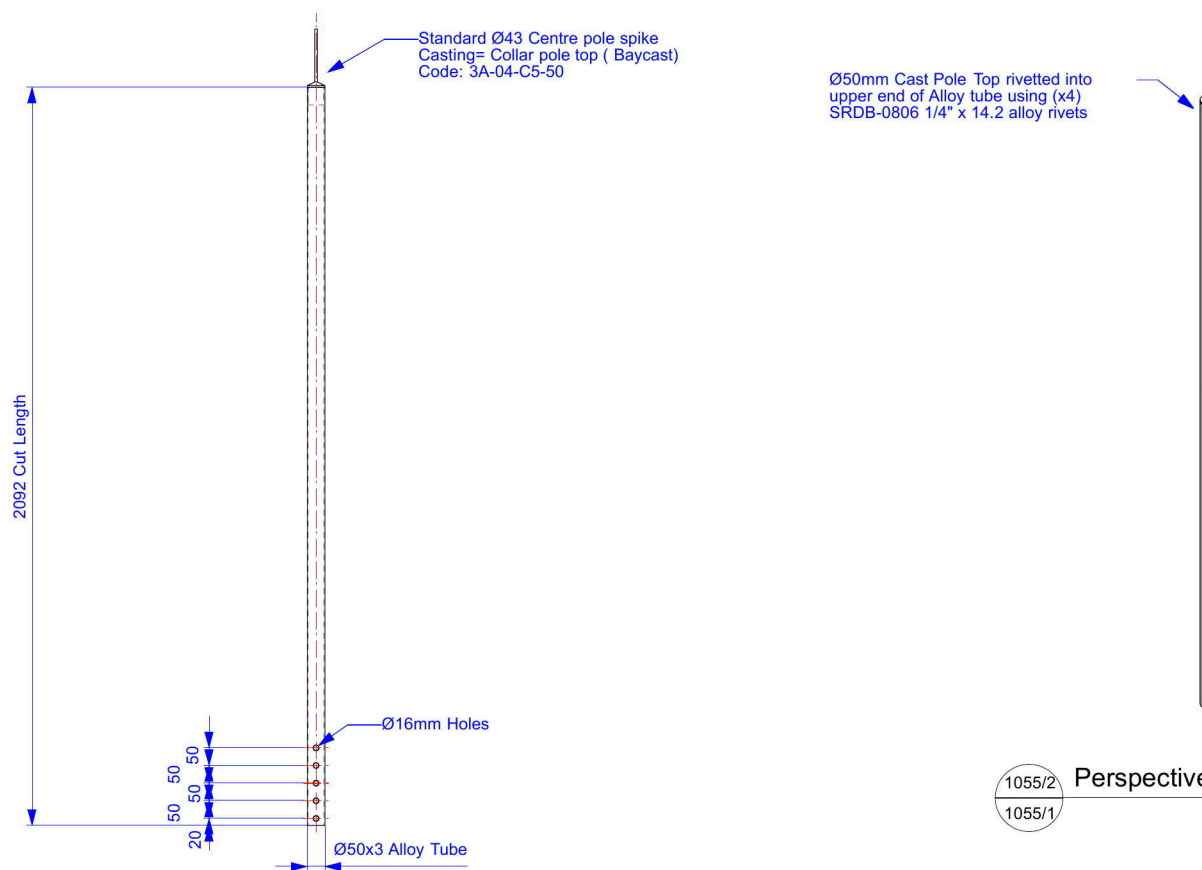

1055/1 **Ø2m Cupola Centre Pole**  
 Quantity: (x1) off  
 Material: Ø50mm Alloy Tube  
 Scale: 1:15

1055/2 Perspective  
 1055/1

No.	Date	Amendment



**Baytex Manufacturing Company Ltd**  
 52 Newton Street  
 P.O. Box 4370  
 Mt Maunganui  
 New Zealand

**Phone: 64 7 579 0190**  
**Fax: 64 7 579 0194**  
**email: sales@baytex.co.nz**

A3 Drg 3rd Angle Proj

Scale  
**1:25**

Job Title  
**Baytex Circus Tents**  
**Loritz Ø32m 4 pole**

Drawing Title  
**Ø2m Cupola**  
**Centre Pole**

Sheet Name

Part N°

Drawing N°  
**15.242.1055**

Date  
**24.01.13**

Drawn By  
**A.P.Lingman**

**Thu, 7 Mar 2013**  
**12:19:11 PM**  
**15.242.1050-1055 Ø2m Cupola**

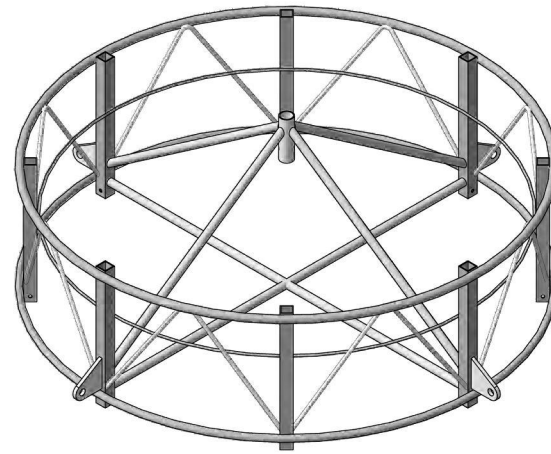
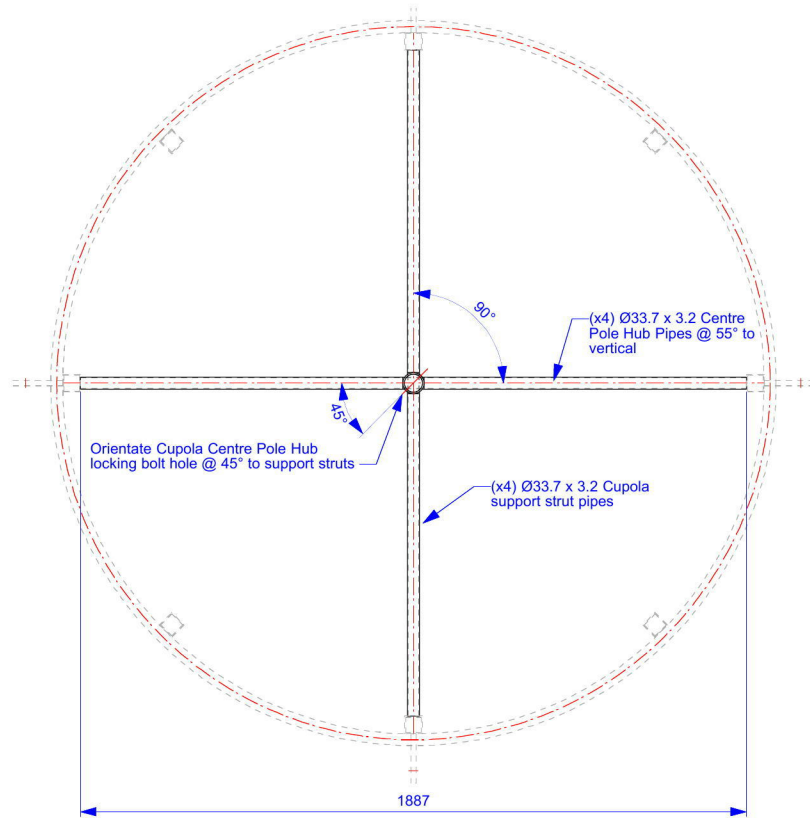

1054/3 Assembly Perspective  
Scale 1:20

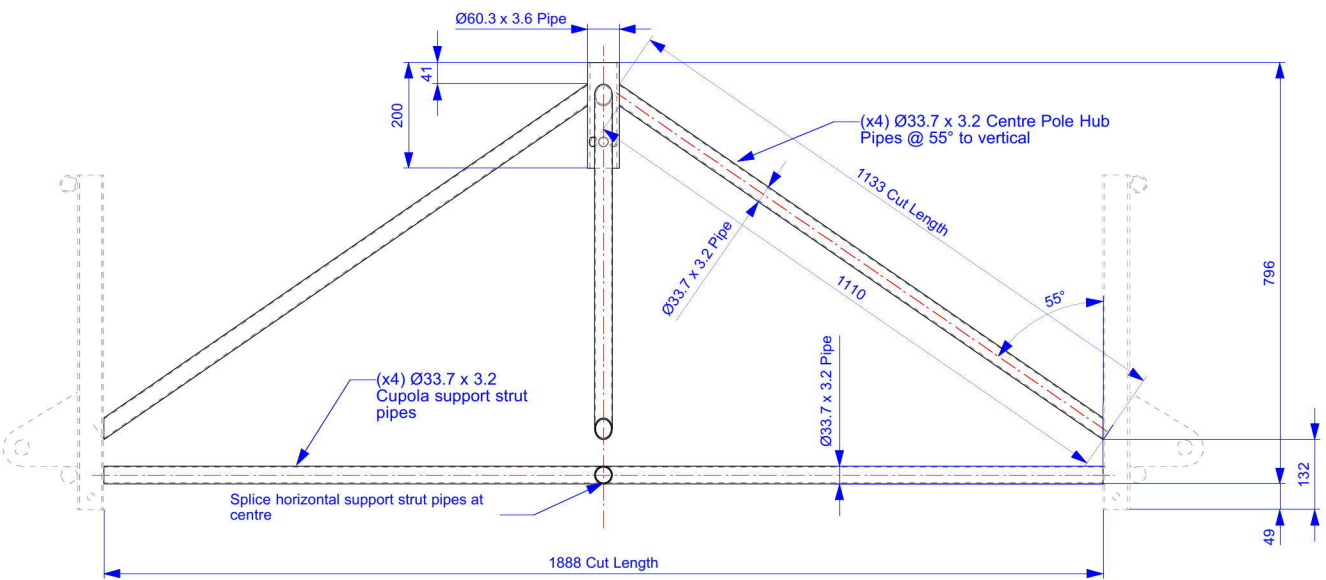

1054/1 Cupola Hub  
1051/1 Quantity: (x1) off  
Material: 350 MPA Steel Pipe or as specified  
Finish: Black Paint  
Scale 1:10

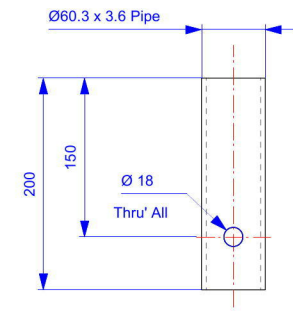

1054/4 Cupola Hub Tube  
1054/1 Quantity: (x1) off  
Material: Mild Steel  
Finish: As specified  
Scale 1:5

**Baytex Circus Tents**  
**Loritz Ø32m 4 pole**

**Note:**  
All dimensions in mm.  
All dimensions have tolerances of  $\pm 0.5\text{mm}$  unless otherwise stated.  
Break all sharp edges.

**Copyright:**  
This drawing and all the information it contains is the property of **Baytex Manufacturing Co Ltd.**

Approved

	Initial	Date
Checked		
Issued		

Original Copy Red

**Material Notes - Steel:**  
1. All mild steel flat bars & round bars to AS 3679-300 (grade 300)  
2. All mild steel plate to AS3678-250 Y = 250 mpa (min)  
3. All pipe sections as specified

**Weld Notes:**  
1. All welds to AS/NZS 1554 GP  
2. General fillet weld - 4mm  
3. Bevel weld - 4mm single bevel full penetration ground flush  
4. Stitch welds - 4mm fillet 50(100)  
5. All others as specified

No.	Date	Amendment



**Baytex Manufacturing Company Ltd**  
52 Newton Street  
P.O. Box 4370  
Mt Maunganui  
New Zealand

Phone: 64 7 579 0190  
Fax: 64 7 579 0194  
email: sales@baytex.co.nz

A3 Drg 3rd Angle Proj

Scale 1:25

Job Title  
**Baytex Circus Tents**  
**Loritz Ø32m 4 pole**

Drawing Title  
**Cupola Hub Tube & Arm Assembly for Centre Pole**

Sheet Name

Part N°

Drawing N° 15.242.1054

Date 24.01.13

Drawn By **A.P.Lingman**

Thu, 7 Mar 2013  
12:18:32 PM  
15.242.1050-1055 Ø2m Cupola

**Baytex Circus Tents**  
**Loritz Ø32m 4 pole**

**Note:**  
 All dimensions in mm.  
 All dimensions have tolerances of  $\pm 0.5\text{mm}$  unless otherwise stated.  
 Break all sharp edges.

**Copyright:**  
 This drawing and all the information it contains is the property of  
**Baytex Manufacturing Co Ltd.**

Approved

	Initial	Date
Checked		
Issued		

Original Copy Red

**Material Notes - Steel:**  
 1. All mild steel flat bars & round bars to AS 3679-300 (grade 300)  
 2. All mild steel plate to AS3678-250 Y = 250 mpa (min)  
 3. All pipe sections as specified

**Weld Notes:**  
 1. All welds to AS/NZS 1554 GP  
 2. General fillet weld - 4mm  
 3. Bevel weld - 4mm single bevel full penetration ground flush  
 4. Stitch welds - 4mm fillet 50(100)  
 5. All others as specified

No.	Date	Amendment



**Baytex**  
 TENTMAKERS  
**Baytex Manufacturing Company Ltd**  
 52 Newton Street  
 P.O. Box 4370  
 Mt Maunganui  
 New Zealand

**Phone: 64 7 579 0190**  
**Fax: 64 7 579 0194**  
**email: sales@baytex.co.nz**

A3 Drg 3rd Angle Proj

Scale  
**1:25**

Job Title  
**Baytex Circus Tents**  
**Loritz Ø32m 4 pole**

Drawing Title  
**Ø2m Cupola**  
**Retractable Leg**

Sheet Name

Part N°

Drawing N°  
**15.242.1052** Revision No

Date  
**24.01.13**

Drawn By  
**A.P.Lingman**

**Thu, 7 Mar 2013**  
**12:18:00 PM**  
**15.242.1050-1055 Ø2m Cupola**

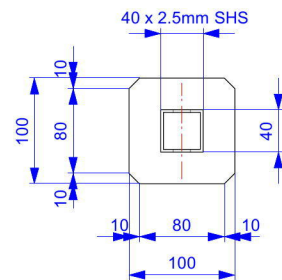

1052/2 Plan View  
 1052/1 Scale 1:5

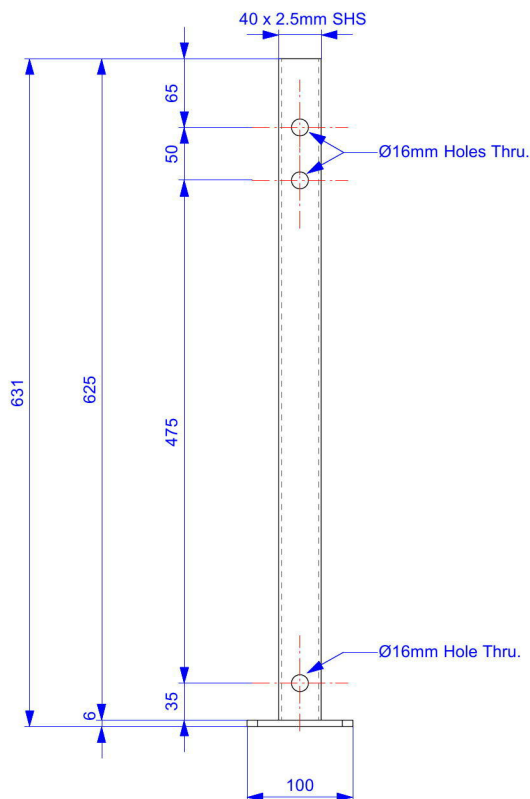

1052/1 Cupola Retractable Leg  
 - Quantity: (x4) off  
 Material: Mild Steel  
 Finish: Black Paint  
 Scale 1:5

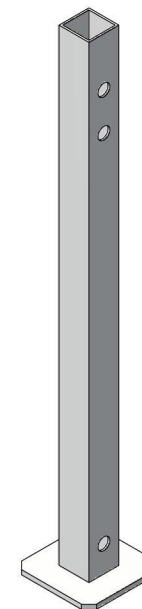

1052/3 Perspective  
 1052/1 Scale 1:5

**Note:**  
All dimensions in mm.  
All dimensions have tolerances of  $\pm 0.5\text{mm}$  unless otherwise stated.  
Break all sharp edges.

**Copyright:**  
This drawing and all the information it contains is the property of  
**Baytex Manufacturing Co Ltd.**

Approved	Initial	Date
	Checked	
	Issued	

Original Copy Red

**Material Notes - Steel:**  
1. All mild steel flat bars & round bars to AS 3679-300 (grade 300)  
2. All mild steel plate to AS3678-250 Y = 250 mpa (min)  
3. All pipe sections as specified

**Weld Notes:**  
1. All welds to AS/NZS 1554 GP  
2. General fillet weld - 4mm  
3. Bevel weld - 4mm single bevel full penetration ground flush  
4. Stitch welds - 4mm fillet 50(100)  
5. All others as specified

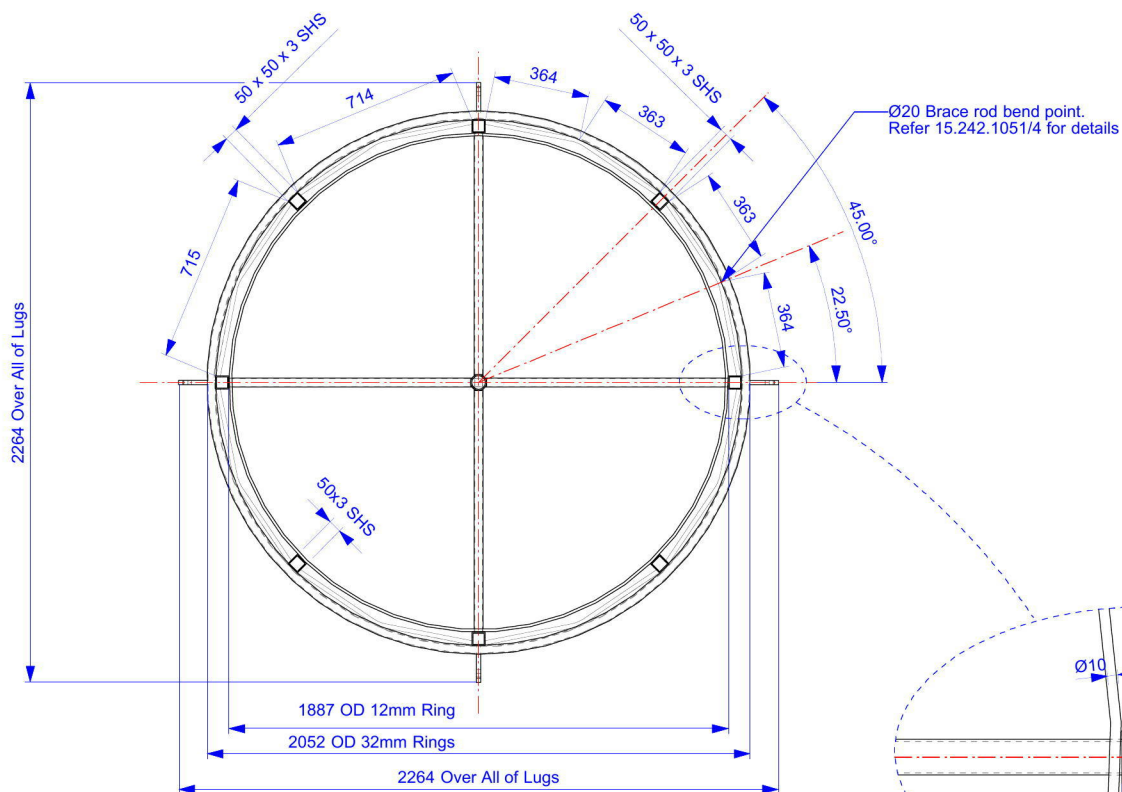

1051/2 Plan View

1051/1

Scale 1:20

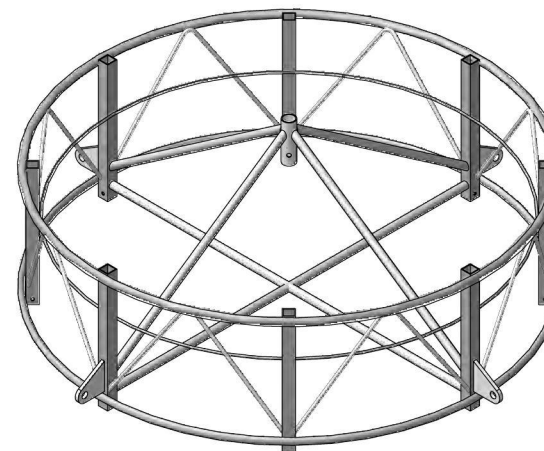

1051/5 Perspective

1051/1

Scale 1:20

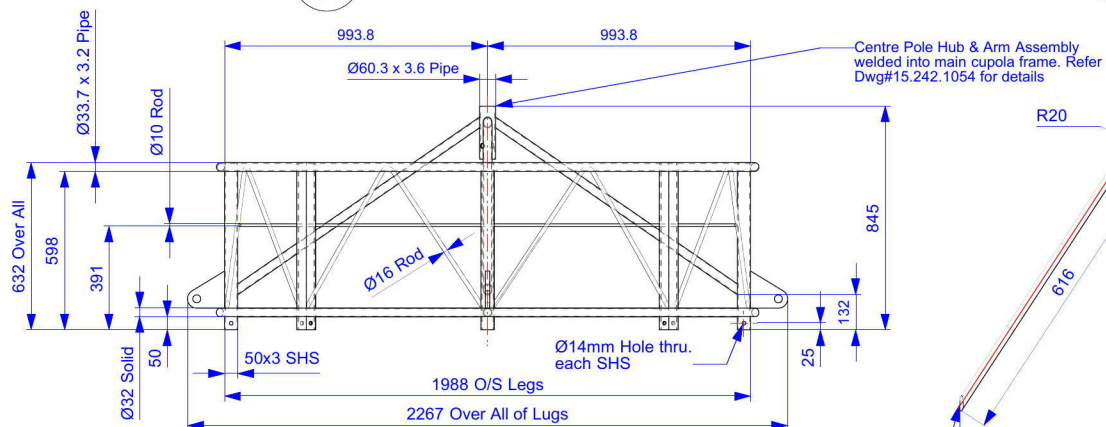
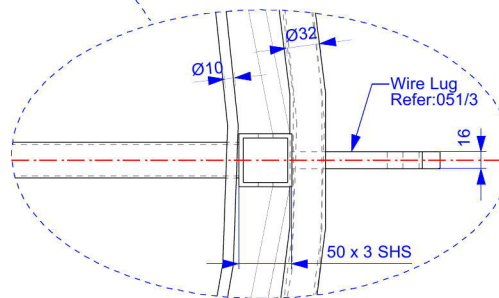

1051/1 Ø2m Cupola Ring Frame

Quantity: x1  
Material: Mild Steel  
Finish: Black Paint

Scale 1:20

Chamber ends to blend into 50 x 50 SHS. Approx cut length 1290mm

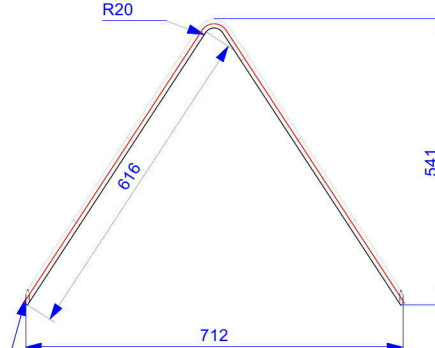

1051/4 Brace Rod

1051/2 Material: Ø16 Mild Steel Rod  
Qty: (x8) off required

Scale 1:10

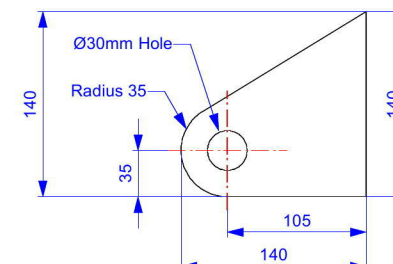

1051/3 Wire Lug

Quantity: (x4) off Required  
Material: 16mm Mild Steel Plate

A3 Drg 3rd Angle Proj

Scale 1:25

Job Title

Baytex Circus Tents  
Loritz Ø32m 4 pole

Drawing Title

Cupola  
Ring Frame

Sheet Name

Part N°

Drawing N°  
15.242.1051

Date  
24.01.13

Drawn By  
A.P.Lingman

Revision No  
Scale: Fri, 8 Mar 2013  
11:59:36 AM  
15.242.1050-1055 Ø2m Cupola

**Baytex Circus Tents**  
**Loritz Ø32m 4 pole**

**Note:**  
 All dimensions in mm.  
 All dimensions have tolerances of  
 ± 0.5mm unless otherwise stated.  
 Break all sharp edges.

**Copyright:**  
 This drawing and all the information  
 it contains is the property of  
**Baytex Manufacturing Co Ltd.**

Approved

	Initial	Date
Checked		
Issued		

Original Copy Red

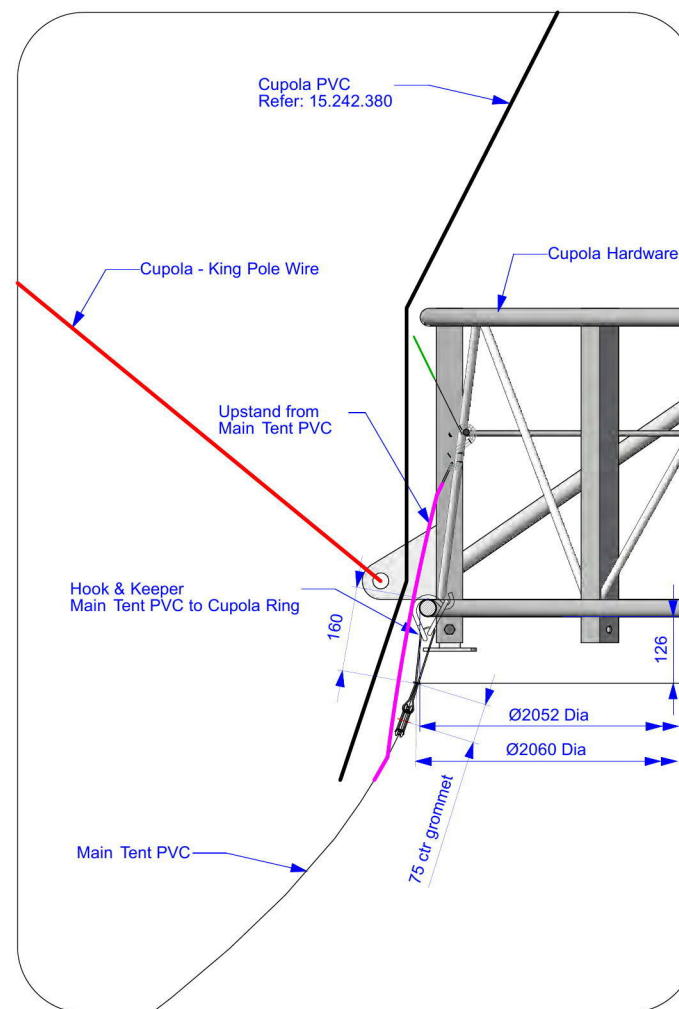
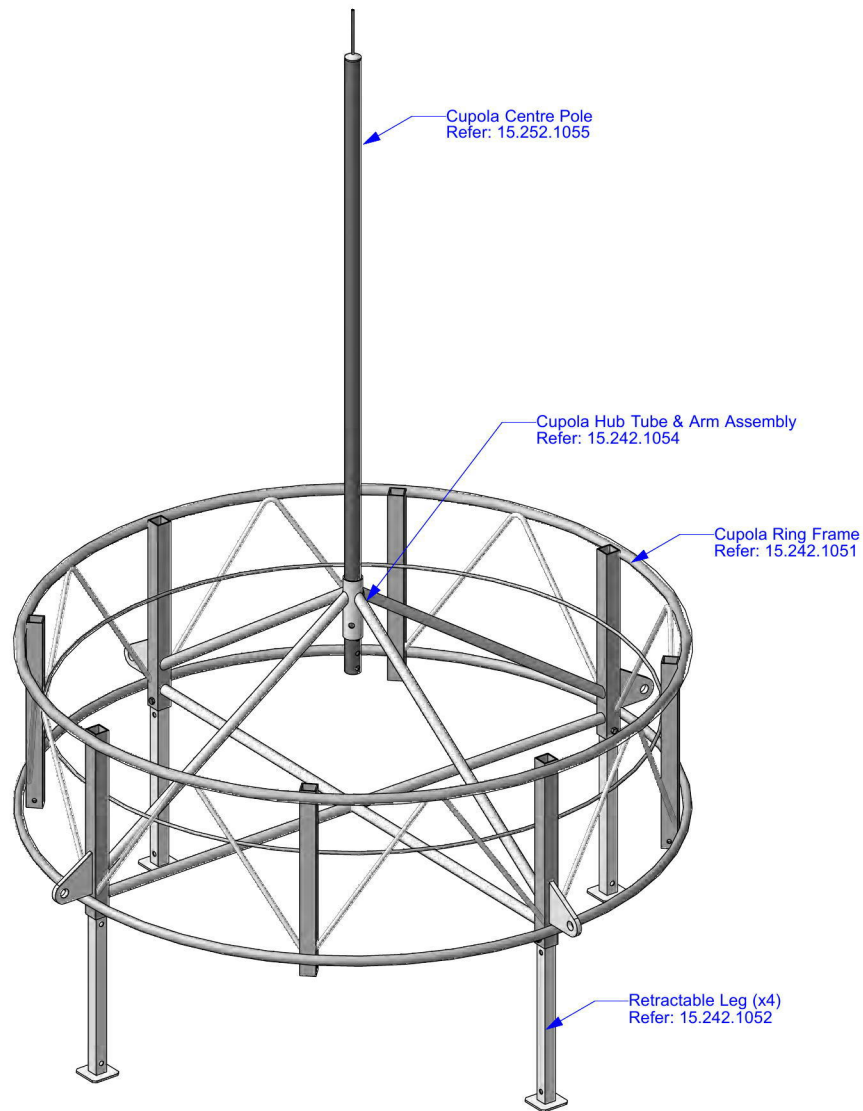
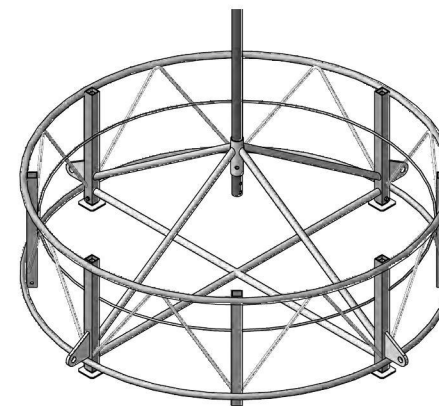

No.	Date	Amendment



**Baytex Manufacturing Company Ltd**  
 52 Newton Street  
 P.O. Box 4370  
 Mt Maunganui  
 New Zealand

Phone: 64 7 579 0190  
 Fax: 64 7 579 0194  
 email: sales@baytex.co.nz

A3 Drg 3rd Angle Proj

Scale  
**1:25**

Job Title  
**Baytex Circus Tents**  
**Loritz Ø32m 4 pole**

Drawing Title  
**Ø2m Cupola**  
**Hardware Assembly**

Sheet Name

Part N°

Drawing N°  
**15.242.1050**

Date  
**24.01.13**

Drawn By  
**A.P.Lingman**

Fri, 8 Mar 2013  
 12:54:23 PM  
 15.242.1050-1055 Ø2m Cupola

1050 Cupola Hardware Assembly  
 Scale 1:15

<b>Approved</b>	Initial	Date
	Checked APL	04.03.13
	Issued MSR	04.03.13

Original Copy Red

**Baytex Performance Tent  
Loritz Circus**

**Note:**  
All dimensions in mm.  
All dimensions have tolerances of  $\pm 0.5\text{mm}$  unless otherwise stated.  
Break all sharp edges.

**Copyright:**  
This drawing and all the information it contains is the property of **Baytex Manufacturing Co Ltd.**

Finished Length = 591 + 16  
= 607  
( Load Face to Load face )

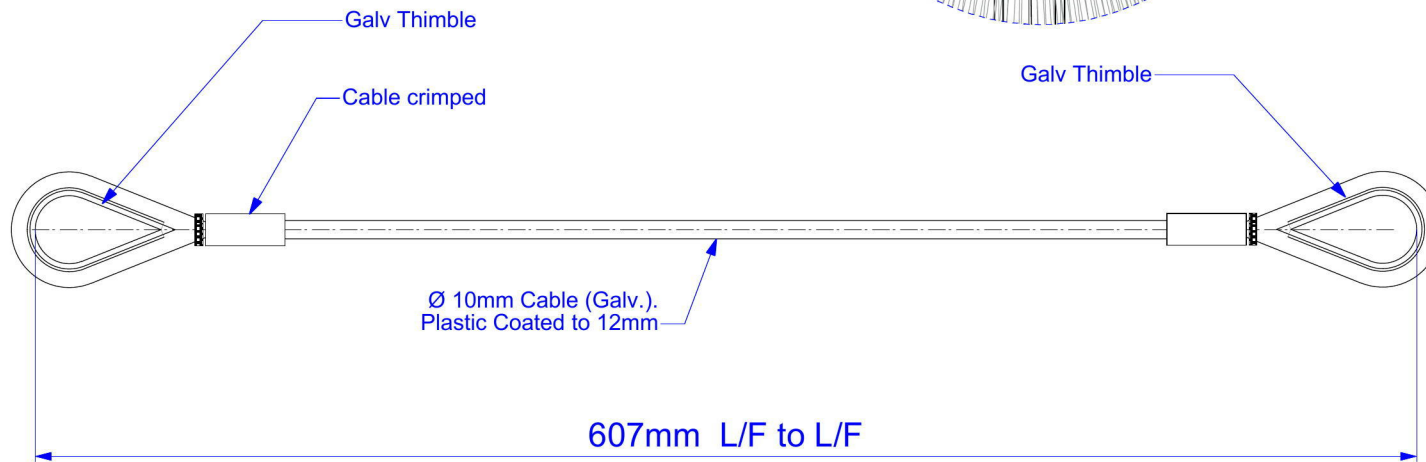
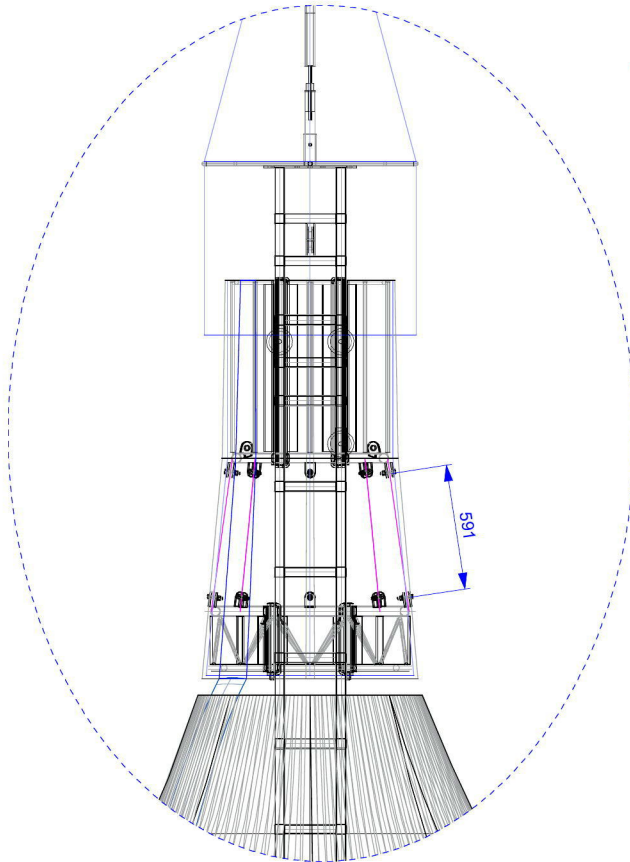

No.	Date	Amendment
-----	------	-----------



**Baytex Manufacturing Company Ltd**  
52 Newton Street  
P.O. Box 4370  
Mt Maunganui  
New Zealand

Phone: 64 7 579 0190  
Fax: 64 7 579 0194  
email: sales@baytex.co.nz

A3 Drg 3rd Angle Proj

Scale  
**1:100**

Job Title  
**Baytex Performance Tent  
Loritz Circus**  
Drawing Title  
**32m $\text{\O}$  4 Pole Circus Tent  
Bail Ring Wires**

Sheet Name  
Part N<sup>o</sup>

Drawing N <sup>o</sup> <b>15.242.1034</b>	Revision No
Date <b>18.02.13</b>	
Drawn By <b>A.P.Lingman</b>	

**Thu, 7 Mar 2013  
2:02:11 PM  
15.242.1030-1037 Bail Rings.vwx**

024 **Bail Wires**  
 $\text{\O} 10\text{mm}$  Cable (Galv.) Plastic Coated  
Quantity : ( x32 )

Scale 1:2



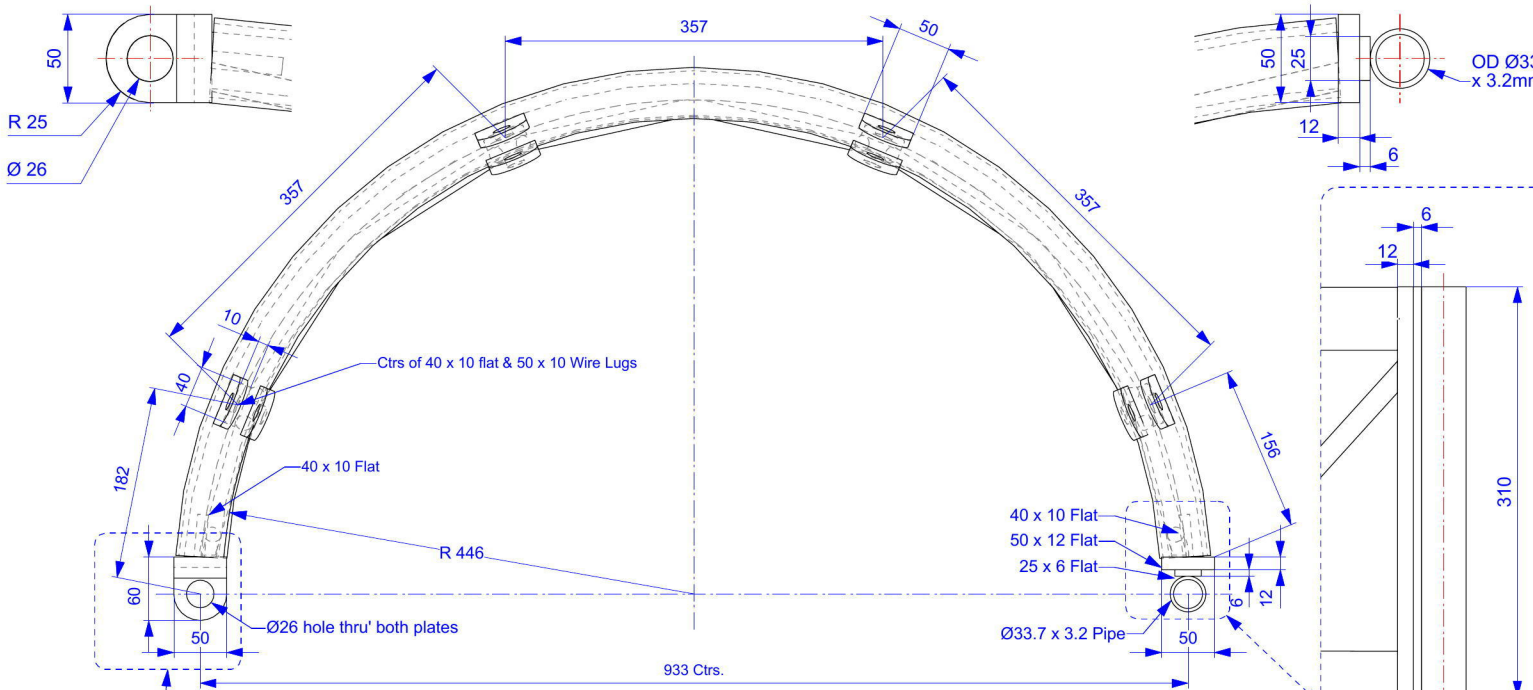

1033/1 Plan View  
Scale 1:5

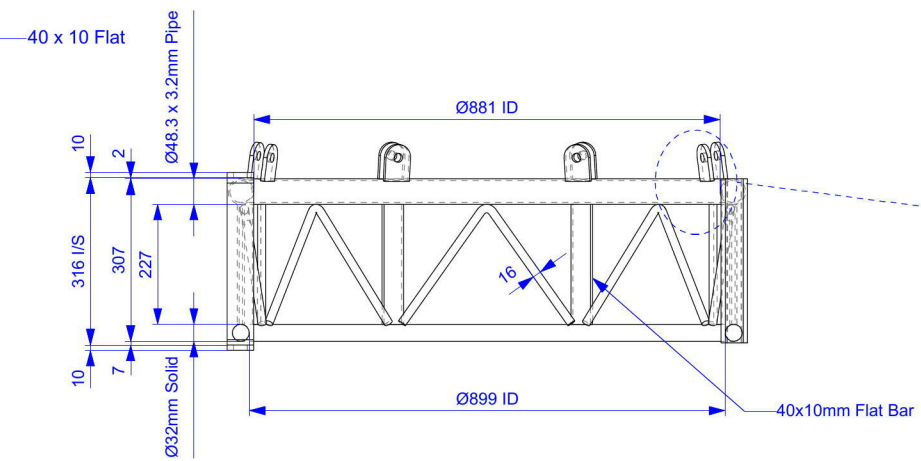
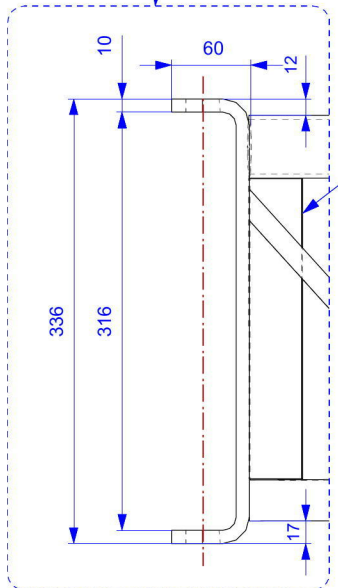

1033/2 Main Bail Ring  
Scale 1:10  
Ø32mm rod, Ø60.3x4.5 tube, 8mm & 10mm Flat  
Finish : Black Paint  
Quantity : (x4) Full sets (x8) Halfs as shown

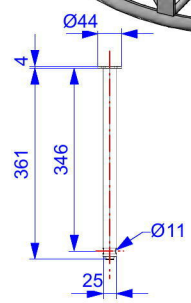
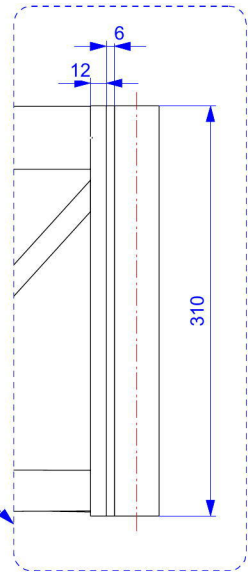
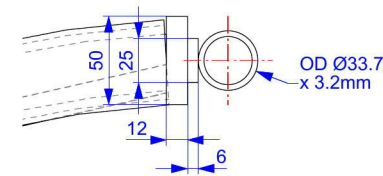

1033/3 Pin Detail  
Scale 1:10  
Material: Grade 4140 round  
Qty: 2 Required per Bail Ring

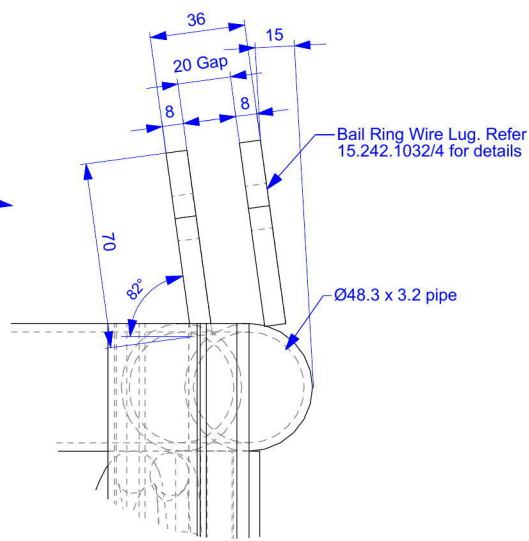

Approved

Checked	Initial	Date
Issued	MSR	04.03.13

Original Copy Red

**Baytex Performance Tent  
Loritz Circus**

**Note:**  
All dimensions in mm.  
All dimensions have tolerances of ± 0.5mm unless otherwise stated.  
Break all sharp edges.

**Copyright:**  
This drawing and all the information it contains is the property of **Baytex Manufacturing Co Ltd.**

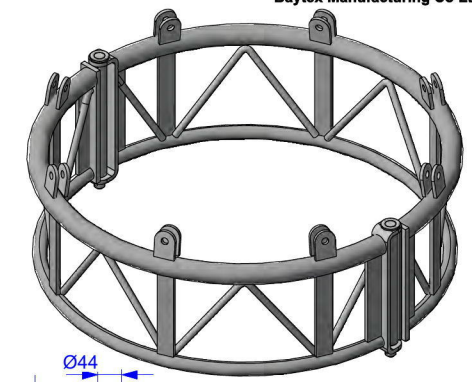

No.	Date	Amendment



**Baytex Manufacturing Company Ltd**  
52 Newton Street  
P.O. Box 4370  
Mt Maunganui  
New Zealand

Phone: 64 7 579 0190  
Fax: 64 7 579 0194  
email: sales@baytex.co.nz

A3 Drg 3rd Angle Proj

Scale: 1:100  
Job Title:

**Baytex Performance Tent  
Loritz Circus**

Drawing Title:  
**Ø32m 4 Pole Circus Tent  
Main Bail Ring**

Sheet Name:  
Part N°:

Drawing N°: 15.233.1033  
Revision No:

Date: 26.02.13  
Drawn By: A.P.Lingman

Fri, 8 Mar 2013  
11:44:15 AM  
15.242.1030-1037 Ø1m Witches Hat & B



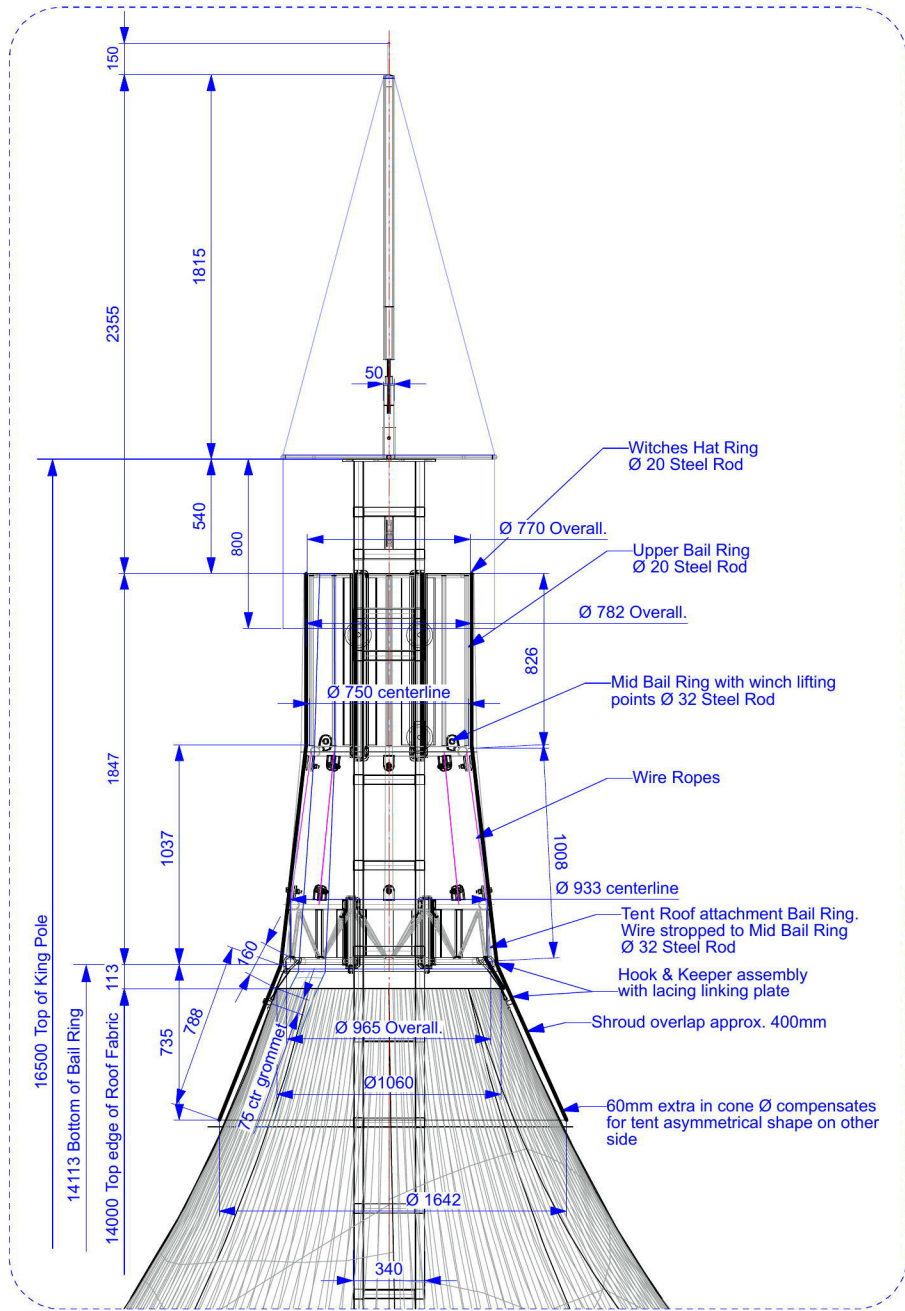

1030/1 Shroud, Witches Hat, Bail Ring Detail  
113/1 Design Dimensions

Approved

	Initial	Date
Checked	APL	04.03.13
Issued	MSR	04.03.13

Original Copy Red

**Baytex Performance Tent  
Loritz Circus**

**Note:**  
All dimensions in mm.  
All dimensions have tolerances of  $\pm 0.5\text{mm}$  unless otherwise stated.  
Break all sharp edges.

**Copyright:**  
This drawing and all the information it contains is the property of **Baytex Manufacturing Co Ltd.**

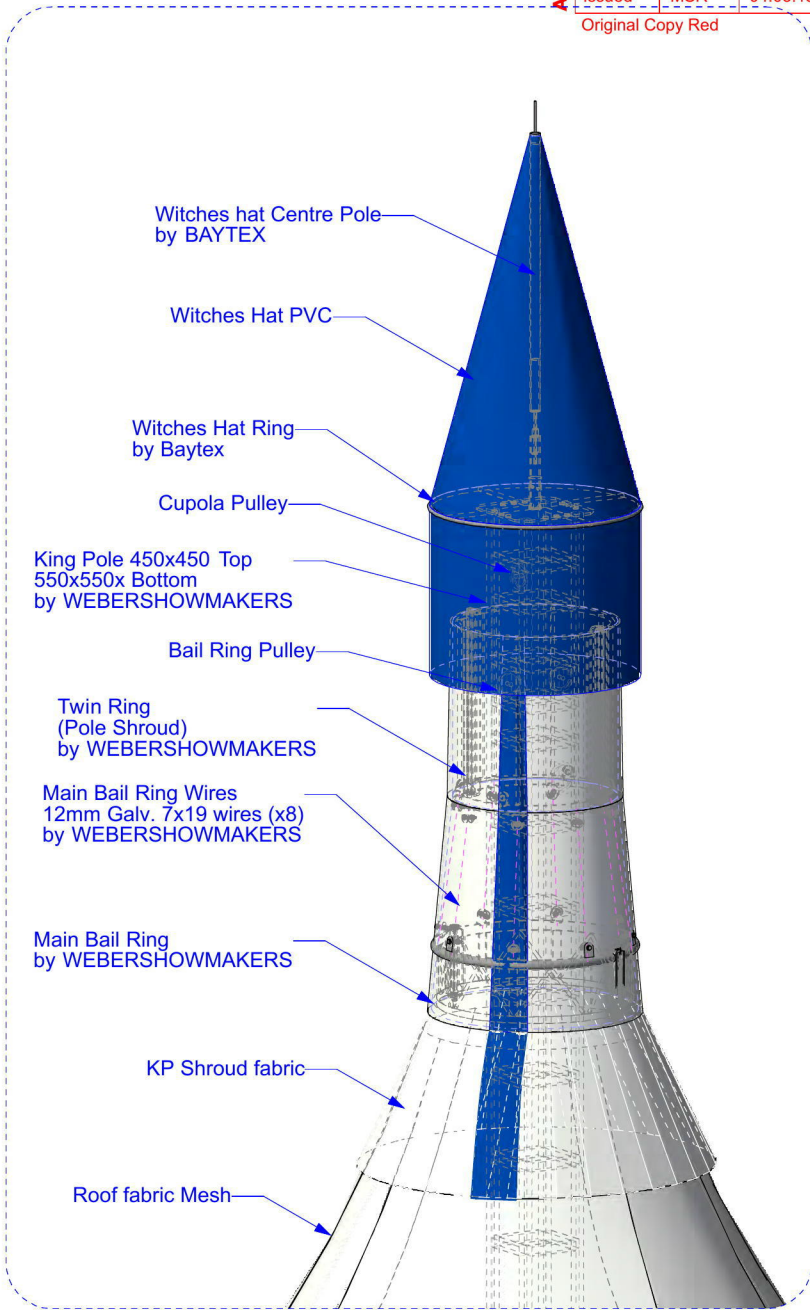

1030/2 Component Supply Details  
1030/1 Perspective View

No.	Date	Amendment
-----	------	-----------



**Baytex Manufacturing Company Ltd**  
52 Newton Street  
P.O. Box 4370  
Mt Maunganui  
New Zealand

**Phone: 64 7 579 0190**  
**Fax: 64 7 579 0194**  
**email: sales@baytex.co.nz**

A3 Drg	3rd Angle Proj	
Scale	<b>1:100</b>	
Job Title	<b>Baytex Performance Tent Loritz Circus</b>	
Drawing Title	<b>Ø32m 4 Pole Circus Tent Bail Ring Layout Geometry</b>	
Sheet Name		
Part N°		
Drawing N°	<b>15.242.1030</b>	Revision No
Date	<b>25.01.13</b>	
Drawn By	<b>A.P.Lingman</b>	

**Thu, 7 Mar 2013**  
**12:19:55 PM**  
**15.242.1030-1037 Bail Rings.vwx**

**Note:**  
All dimensions in mm.  
All dimensions have tolerances of ± 0.5mm unless otherwise stated.  
Break all sharp edges.

**Copyright:**  
This drawing and all the information it contains is the property of  
**Baytex Manufacturing Co Ltd.**

Approved

	Initial	Date
Checked		
Issued		

Original Copy Red

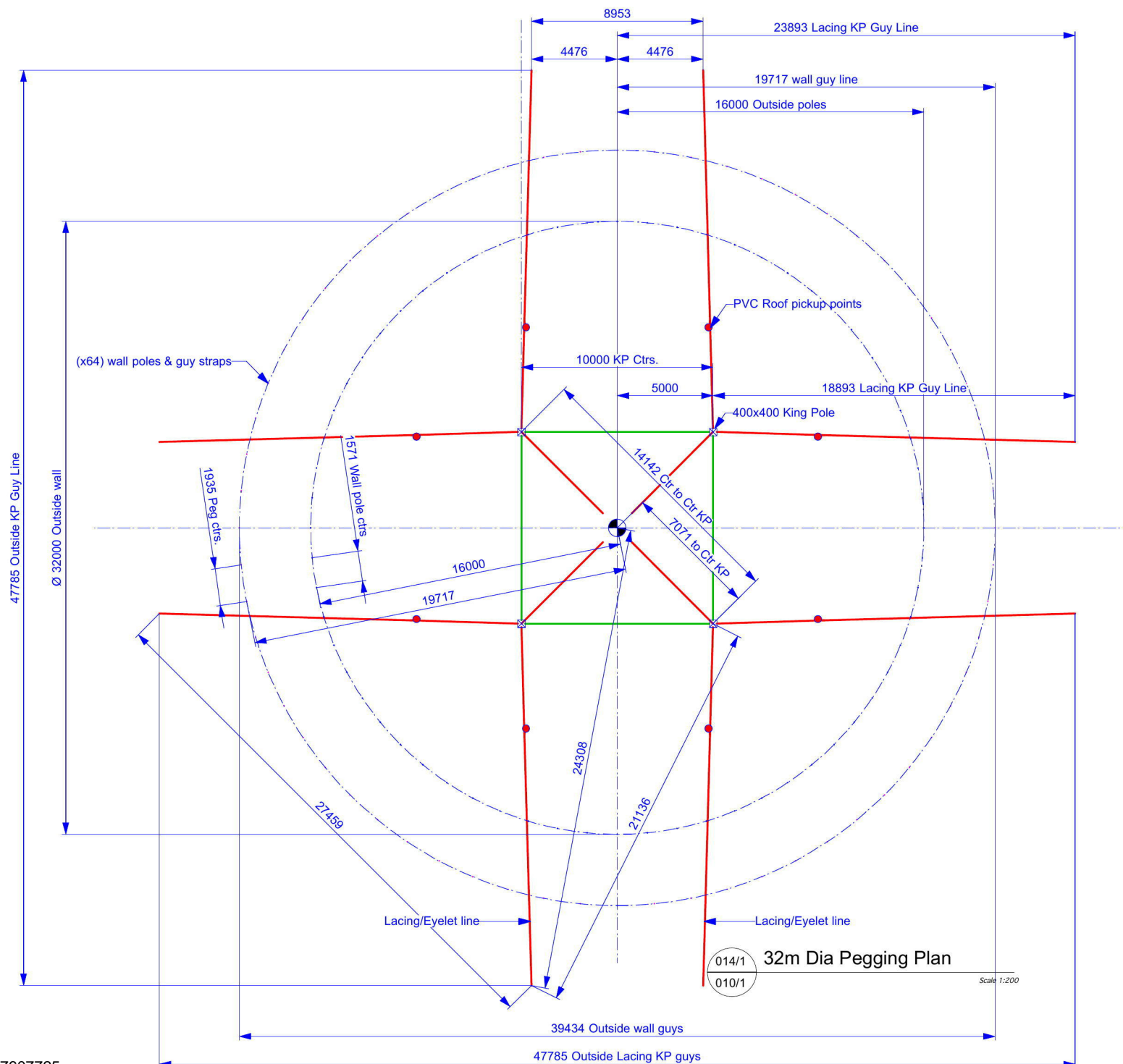

No.	By	Date	Amendment



**Baytex**  
TENTMAKERS

**Baytex Manufacturing Company Ltd**  
52 Newton Street  
P.O. Box 4370  
Mt Maunganui  
New Zealand

Phone: 64 7 579 0190  
Fax: 64 7 579 0194  
email: sales@baytex.co.nz

A3 Drg 3rd Angle Proj

Scale **1:250** Drawing Type **Final Design**

Job Title

**Baytex Performance Tent Loritz Circus**

Drawing Title  
**32m 4 Pole Circus Tent Pegging Plan Details**

Sheet No.

Part No.

Drawing No. **15.242.114** Revision No.

Date **22.01.13**

Drawn By **A.P.Lingman**

Thu, 7 Mar 2013  
2:07:12 PM  
15.242.110-114h Ø32m Loritz Fin

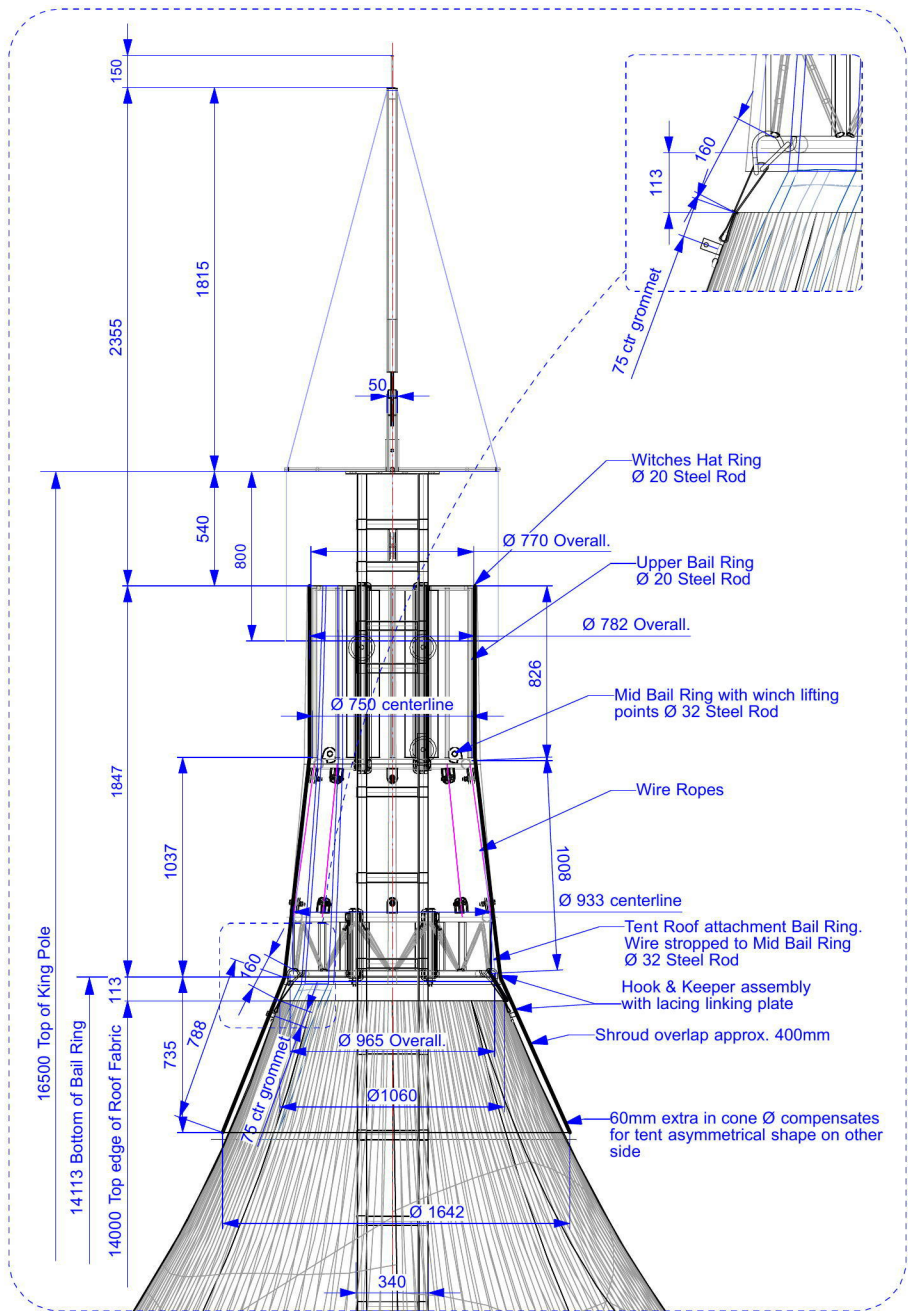

113/1 Shroud, Witches Hat, Bail Ring Detail  
110/1 Design Dimensions Scale 1:20

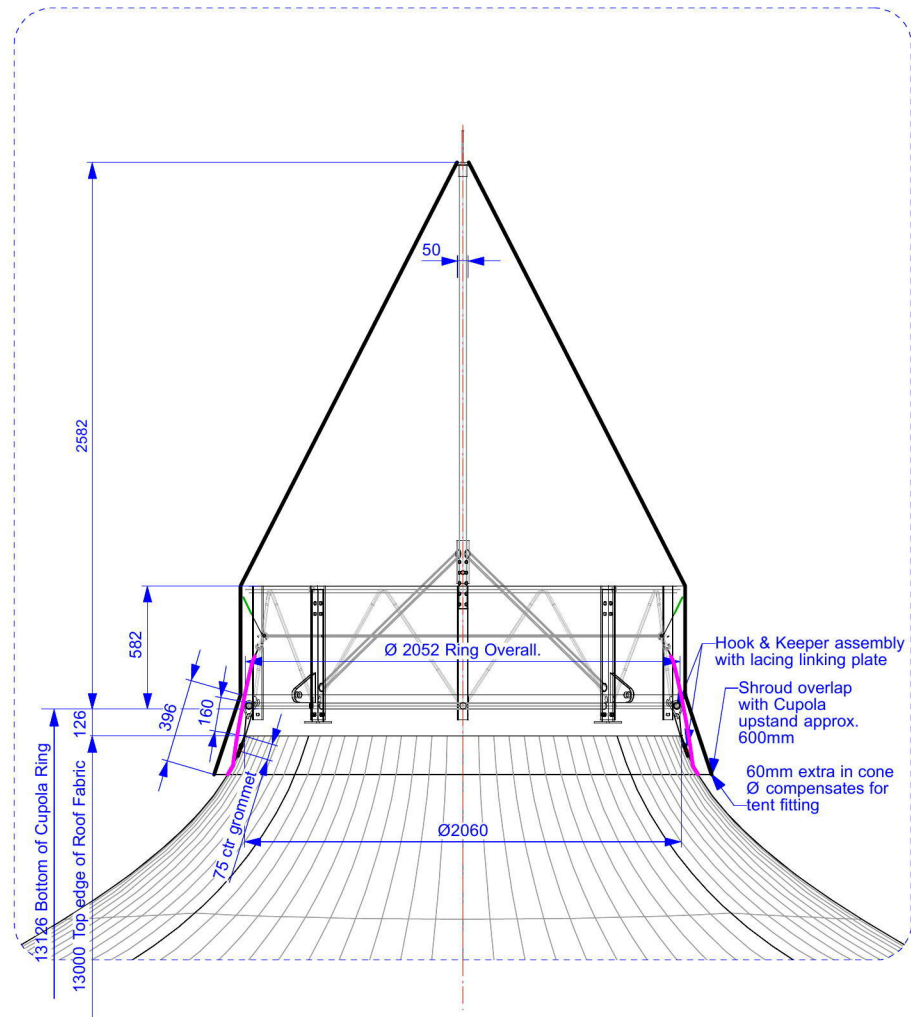

113/2 Cupola PVC, Cupola Frame Detail  
110/1 Design Dimensions Scale 1:20

**Baytex Performance Tent**

**Loritz Circus**

**Note:**  
All dimensions in mm.  
All dimensions have tolerances of  $\pm 0.5\text{mm}$  unless otherwise stated.  
Break all sharp edges.

**Copyright:**  
This drawing and all the information it contains is the property of **Baytex Manufacturing Co Ltd.**

**Approved**

	Initial	Date
Checked		
Issued		

Original Copy Red

No.	By	Date	Amendment



**Baytex Manufacturing Company Ltd**  
52 Newton Street  
P.O. Box 4370  
Mt Maunganui  
New Zealand

**Phone:** 64 7 579 0190  
**Fax:** 64 7 579 0194  
**email:** sales@baytex.co.nz

A3 Drg	3rd Angle Proj	
Scale	Drawing Type	
<b>1:250</b>	<b>Final Design</b>	

Job Title  
**Baytex Performance Tent Loritz Circus**  
Drawing Title  
**32m 4 Pole Circus Tent Bail Ring & Cupola Details**

Sheet No.

Part No.

Drawing No. **15.242.113** Revision No.

Date **22.01.13**

Drawn By **A.P.Lingman**

**Thu, 7 Mar 2013 2:06:41 PM 15.242.110-114h Ø32m Loritz Fins**

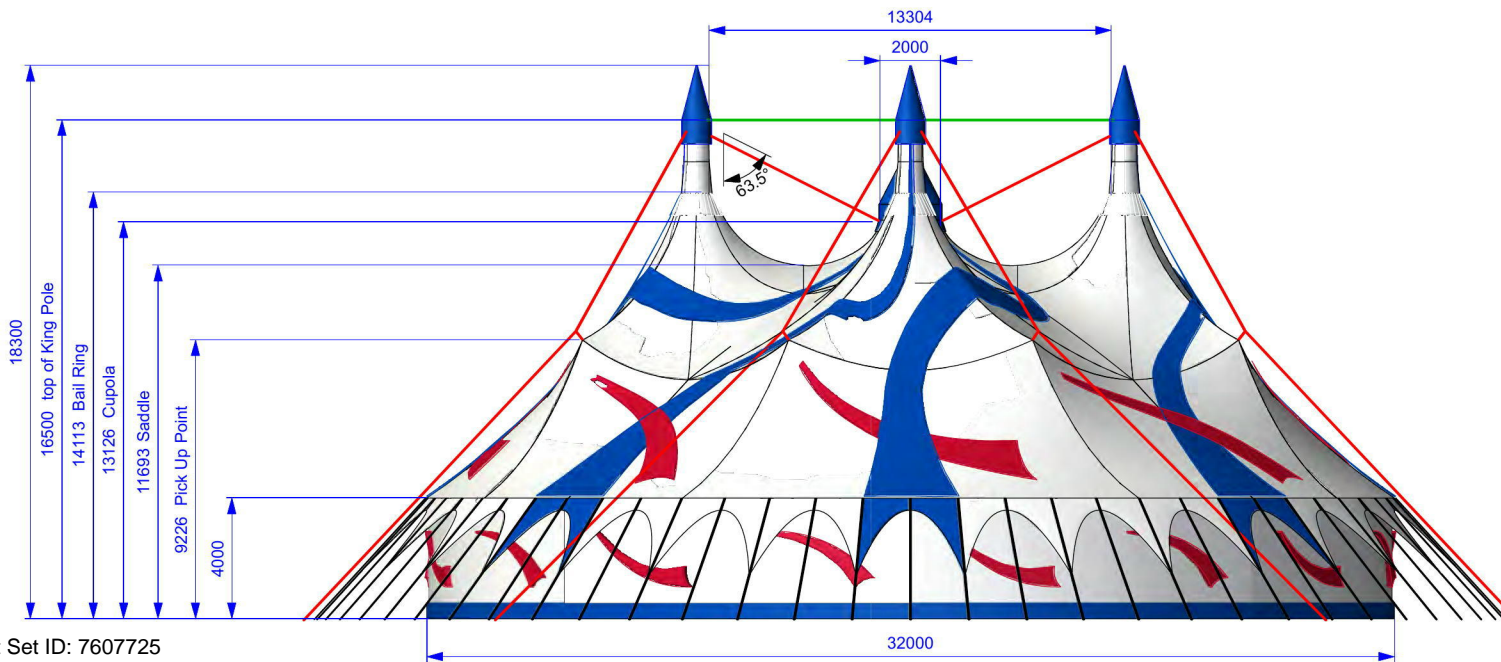
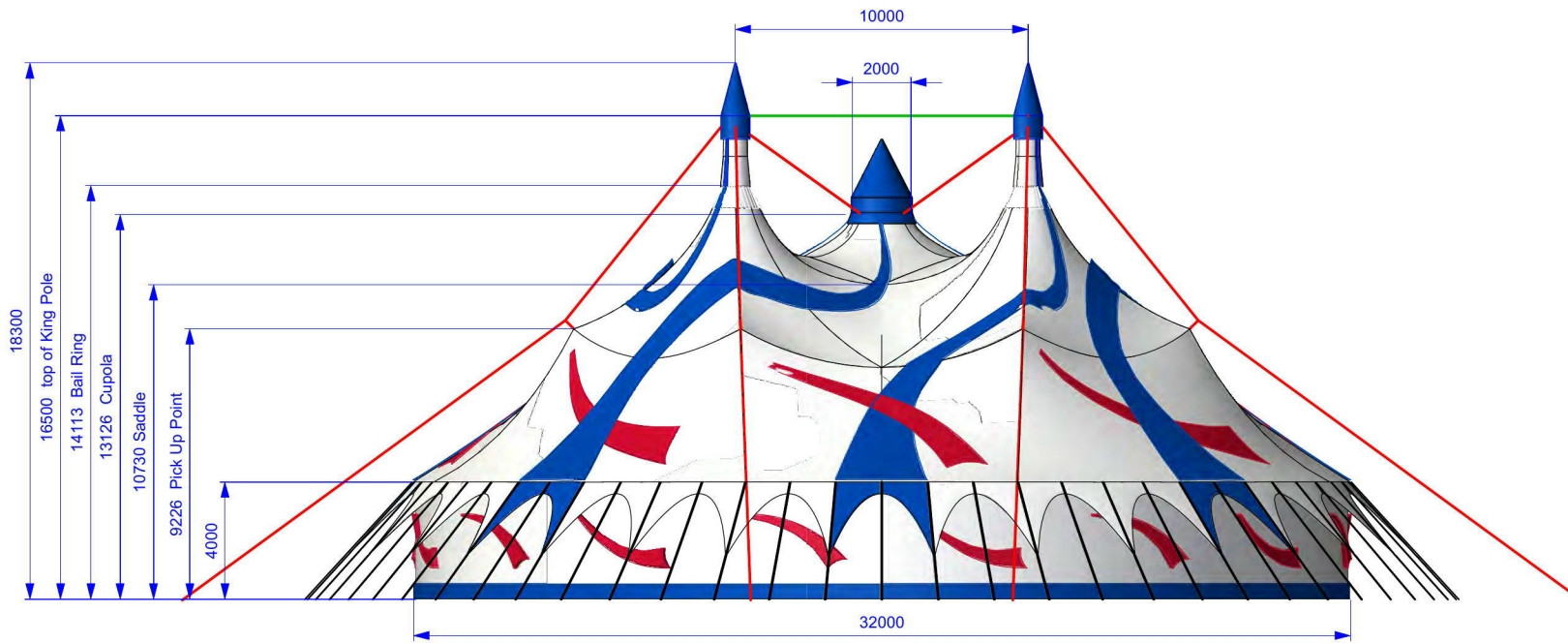

**Baytex Performance Tent**

**Loritz Circus**

**Note:**  
All dimensions in mm.  
All dimensions have tolerances of  $\pm 0.5\text{mm}$  unless otherwise stated.  
Break all sharp edges.

**Copyright:**  
This drawing and all the information it contains is the property of **Baytex Manufacturing Co Ltd.**

Approved

	Initial	Date
Checked		
Issued		

Original Copy Red

G APL 23.01.13 Altered Shroud Colour to White /

F 08.01.13 Pole Spacing Changed

E 07.01.13 King Pole Spacing to 10m

No.	By	Date	Amendment



**Baytex**  
TENT MAKERS

**Baytex Manufacturing Company Ltd**  
52 Newton Street  
P.O. Box 4370  
Mt Maunganui  
New Zealand

Phone: 64 7 579 0190  
Fax: 64 7 579 0194  
email: sales@baytex.co.nz

A3 Drg 3rd Angle Proj

Scale <b>1:250</b>	Drawing Type <b>Final Design</b>
-----------------------	-------------------------------------

Job Title

**Baytex Performance Tent**  
**Loritz Circus**

Drawing Title  
**32m 4 Pole Circus Tent**  
**Views for wire angle**

Sheet No.

Part No.

Drawing No. <b>15.242.112</b>	Revision No. <b>G</b>
----------------------------------	--------------------------

Date  
**08.06.12**

Drawn By  
**A.P.Lingman**

**Thu, 7 Mar 2013**  
**2:06:18 PM**  
**15.242.110-114h Ø32m Loritz Fins**