

All work to be carried out in accordance with BCA, AS & Council conditions. Copyright: The concepts & information contained in these drawings are the copyright of I Draft Group Pty Ltd. Use or duplication in part or in full without written permission of I Draft Group Pty Ltd constitutes an infringement of copyright. Do not scale off architectural drawings. These notes must be read in conjunction with colours selection for additional details on appliances, FC items & shower sizes shown on plan are inside hob dimensions shower screens to be fitted on inside of hob bulheads may be required to accommodate drainage lines & steel beams position to be determined on site. Use figured dimensions ONLY, do not scale. Finished ground levels shown on plans are subject to site conditions, all calculated dimensions are subject to site measure during construction & no allowance has been made for shrinkage or milling position of electrical meter to be determined on site in accordance to the turret position front garden tap on meter. Energy Smart Design: AAA rated water conservation devices include rainwater tanks shower heads, water tap flow regulators, dual flush toilets & cisterns & compliant hot water systems with minimum green house score of 3.5 stars are to be used in this development. All occupants are encouraged to use AAA rated dish washing machines with front loading where possible.

NOTES

NO.	ISSUE	DATE	DRAWING DESCRIPTION

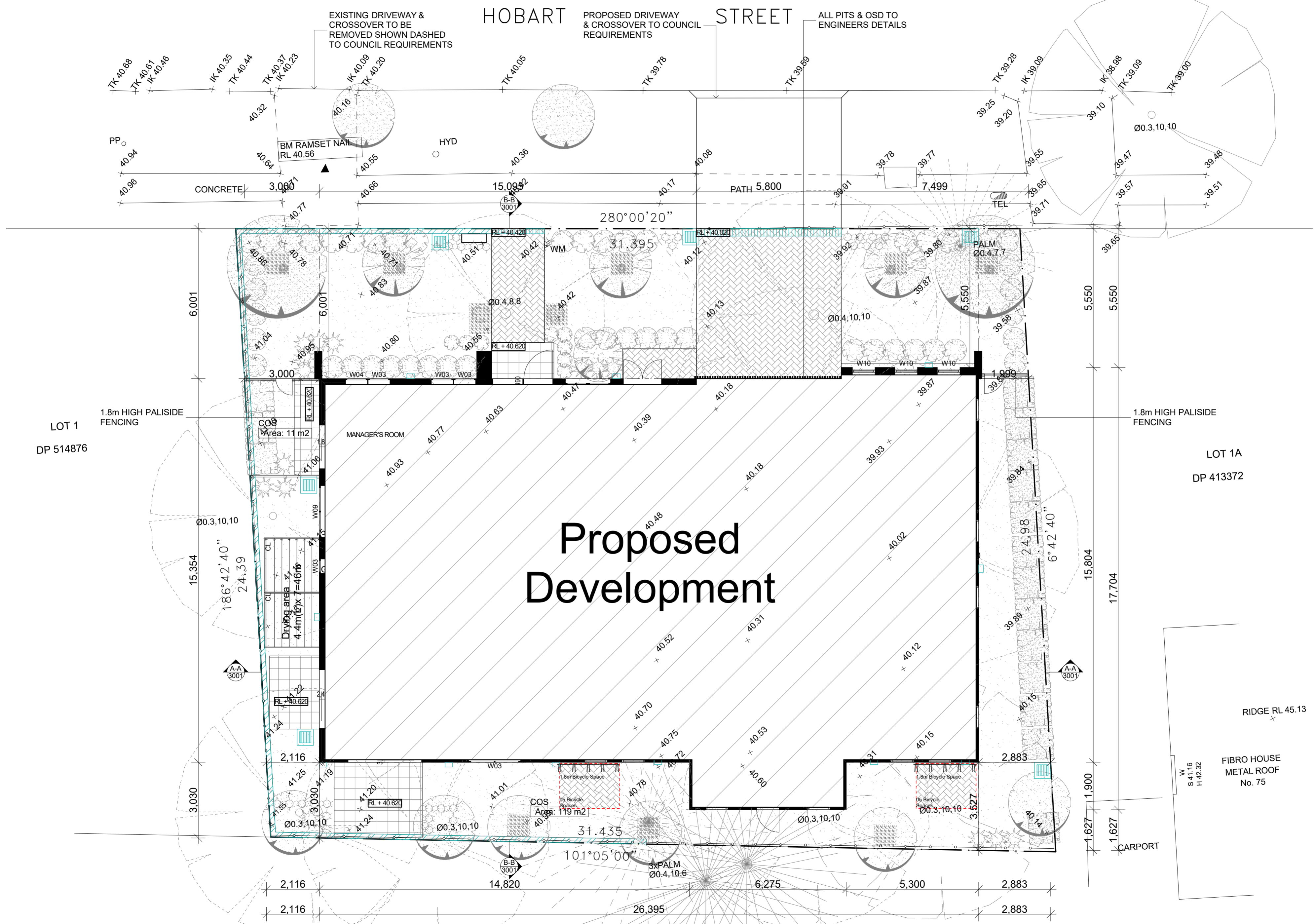

Proposed Development

76 HOBART STREET ST. MARYS



Architect
 Address: Wilson NSW Architects Registration Board 0347
 City: Cheshire NSW Architects Registration Board 0493
 P.O. Box 8681, Seagraves NSW
 project:
 Demolition & construction of a Two (2) storey Boarding House Comprising of 17 Rooms

Client:
 GPS Constructions Pty Ltd
 Council:
 Penrith City Council
 Drawing title:
SITE PLAN

Designed & drawn:
 M. Trinh & P. Revollar
 Issue/Stage:
DA - ISSUE A
 paper/size:
 A2/1:100
 date:
 12/05/2021
 Job #:
 28811
 dwg #:
 2

