

Fernhill Estate Eastern Precinct Subdivision Development Application

DRAWING LIST			
Drawing No.	Layout Name	Issue	Date
EP 01	Site Analysis	A	29 - 07 - 14
EP 02	Landscape Plan	A	29 - 07 - 14
EP 03	Entry Road Landscape Plan	A	30 - 07 - 14
EP 04	Entry Road Landscape Elevations	A	30 - 07 - 14
EP 05	Typical Landscape Sections	A	29 - 07 - 14
EP 06	Public Space Plan	A	29 - 07 - 14





LANDSCAPE SCHEDULE

- Trees:**
- Silky Oak (*Grevillea Robusta*)
18-35m height, 15m spread
- Street Trees:**
- Brush Box (*Lophostemon Confertus*)
10-40m height, 12m spread
- Shrubs:**
- Glossy Abelia (*Abelia Grandiflora*)
1m height, 1m spread
 - Tea Tree (*Lophostemon Spinescens*)
1m height, 1m spread
 - Native Rosemary (*Westringia Fruticosa*)
1.5m height, 1.5m spread
 - Sickle Wattle (*Acacia Falcata*)
2m height, 1m spread
 - Grevillea Juniperina (*Juniper Grevillea*)
1.5m height, 1m spread
- Ground:**
- Grass
 - Fire Trail
- Existing Trees:**
- Existing Trees Retained
 - Existing Trees to be Removed

- Grey Box - Forest Red Gum grassy woodland trees and scrub extended into site.
- Detention basins shaped to appear naturally occurring. Refer to Mott MacDonald's civil drawings sheet 0257.
- Clumps of Silky Oak to be planted to form pockets of open space, frame views to the landscape beyond and screen houses.
- Existing driveway to be repurposed as a fire trail.
- Use of shrubs to screen houses and focus views beyond the site towards Fernhill House.
- Rural post and rail rough cut timber fence reinforces rural character of the site whilst screening houses.
- Retention of as many trees as possible to maintain the existing rural character of the site.
- Gate provides pedestrian access from Mulgoa Village.

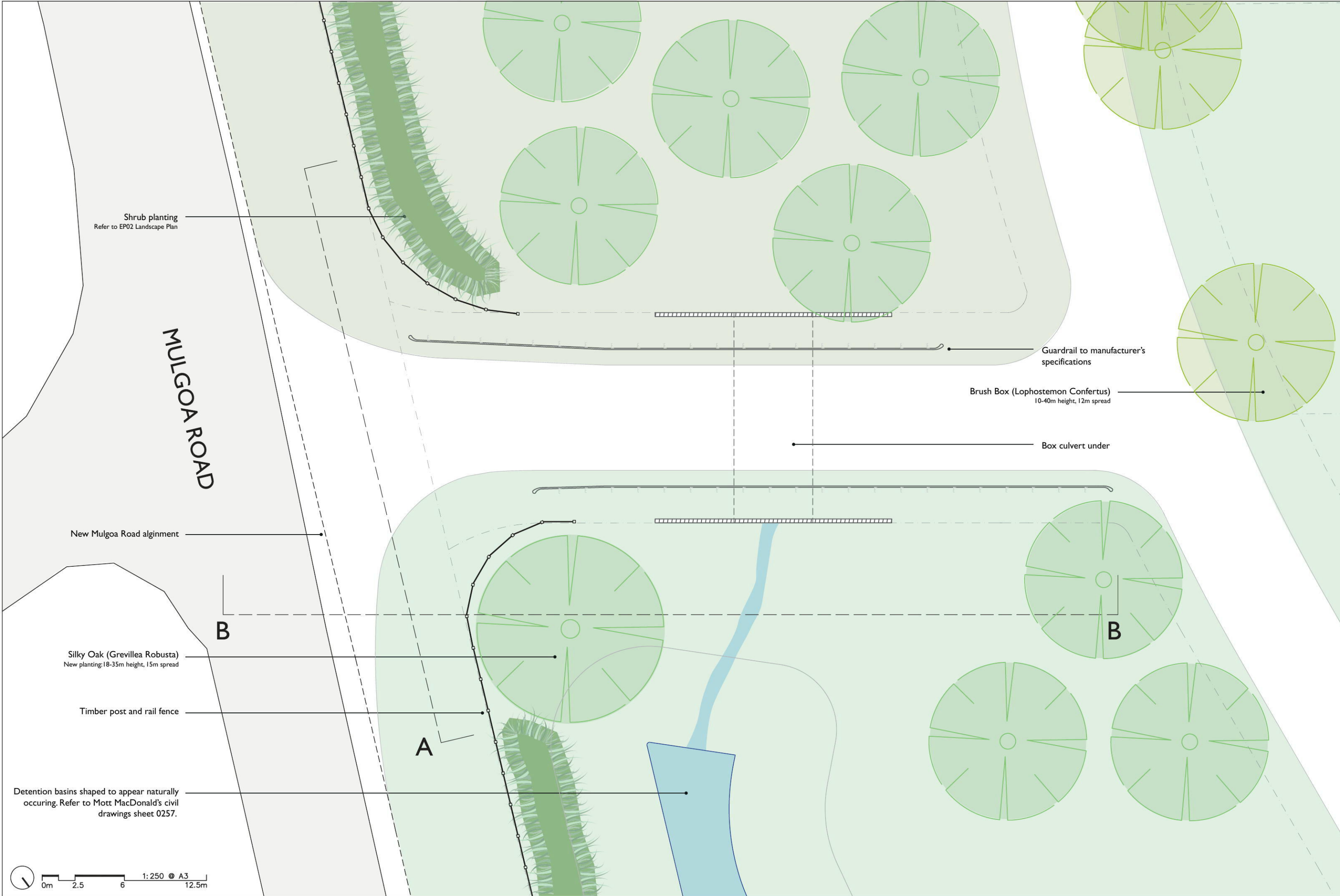

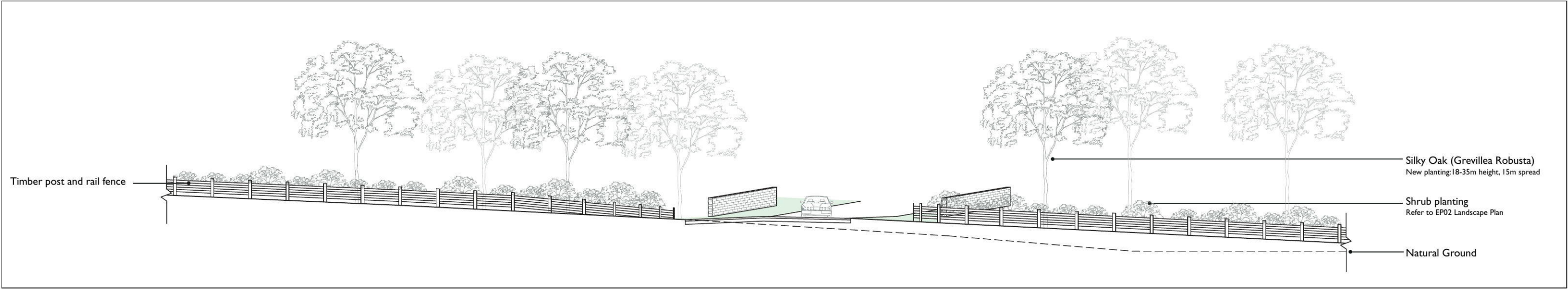

ELEVATION A-A

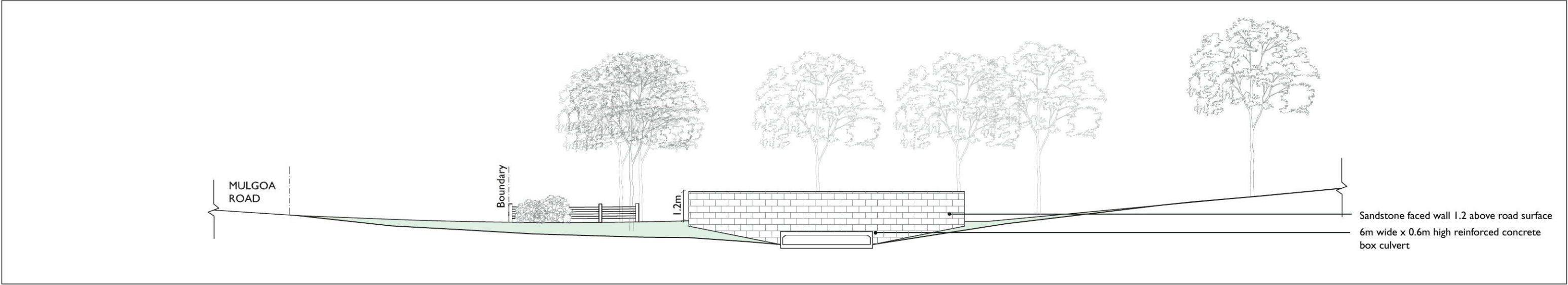

ELEVATION B-B

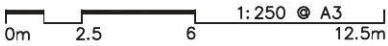

1: 250 © A3

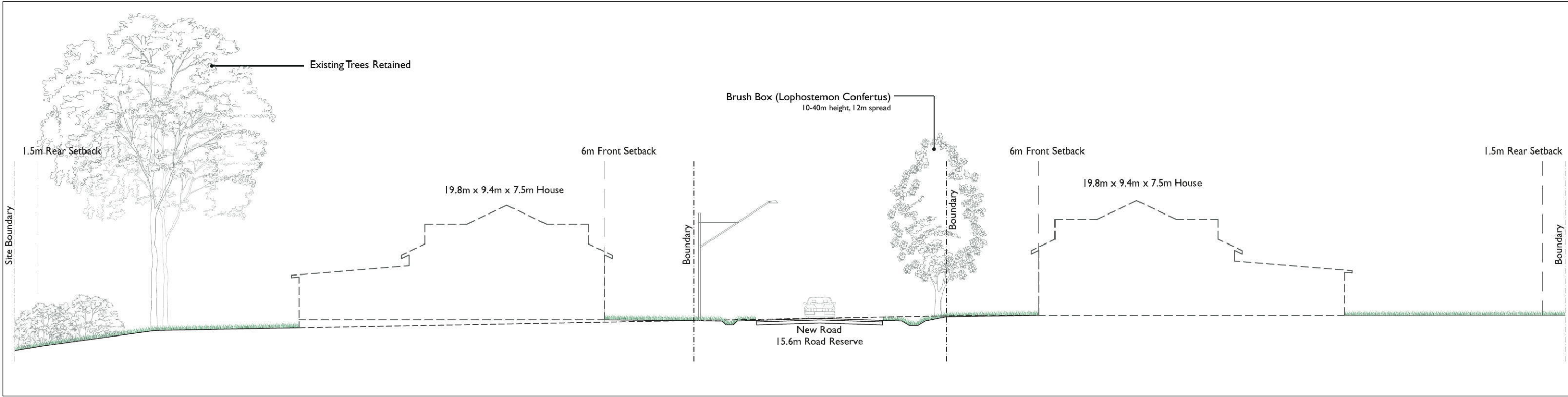

SECTION A-A

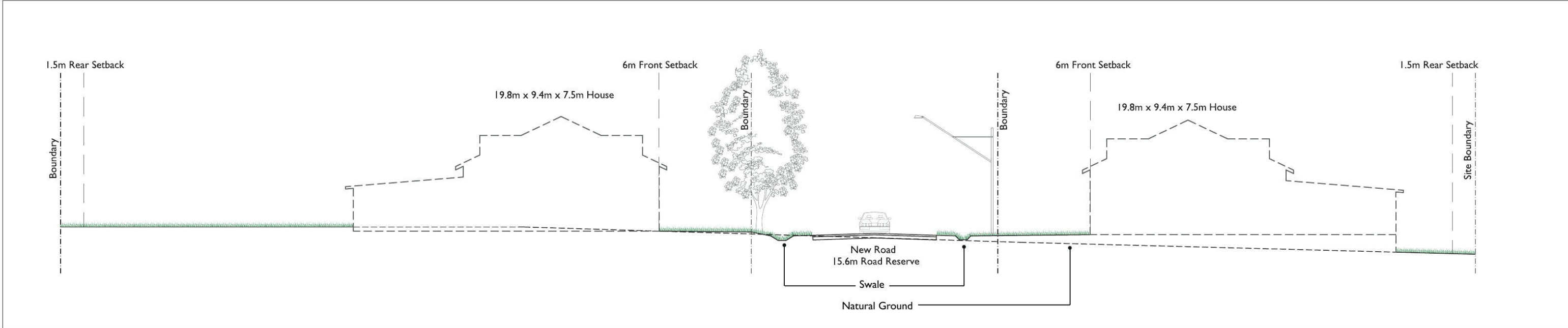

SECTION B-B

