

LEGEND / FINISHES SCHEDULE

EXISTING RL
EXISTING TREE TO BE REMOVED
EXISTING TREE TO BE RETAINED AND SHALL BE PROTECTED DURING CONSTRUCTION. TREE PRUNING SHALL BE IN ACCORDANCE WITH AS 4373

PROPOSED TREES, SHRUBS & GROUND COVER (REFER NO. TO PLANT SCHEDULE)

BOUNDARY FENCE

MULCHED GARDEN BED REFER TO DETAIL 1

BIO RETENTION WALL / OSD WALL TO ENGINEER DETAIL REFER TO DETAIL 2 FOR PLANTING

PERMEABLE PEBBLE AREA SELECTED 50-100 DEPTH RIVER PEBBLES WITH WEED MAT UNDER

STORM WATER PIT REFER TO ENGINEER PLANS FOR DETAILS

ITEM	MATERIAL
SOIL	NOTE: ALL SOIL TYPE AS PER AUST. NATIVE LANDSCAPE SUPPLY OR EQUIVALENT AND SHALL BE IN ACCORDANCE WITH AS 4419 AND 4454 FOR SOIL CONDITIONERS AND COMPOSTS
LAWN AREA	1st QUALITY TOP SOIL
NATIVE GARDEN BED	NATIVE GARDEN MIX
EXOTIC GARDEN BED	ORGANIC GARDEN MIX
MULCH	SELECTED HARD WOOD CHIP SHALL BE IN ACCORDANCE WITH AS 4454 DECORATIVE GRAVEL TO OSD AREA REFER TO DETAIL 1 & 2
PLANT MATERIAL	AS PER PLANT SCHEDULE REFER TO DETAIL 2
RETAINING WALL & PLANTER BOX	SELECTED MASONRY RETAINING WALL AND DRAINAGE TO ENG. DETAIL
FENCE	1800 HIGH LAPPED & CAPPED TIMBER FENCE OR 1800 HIGH COLOURBOND

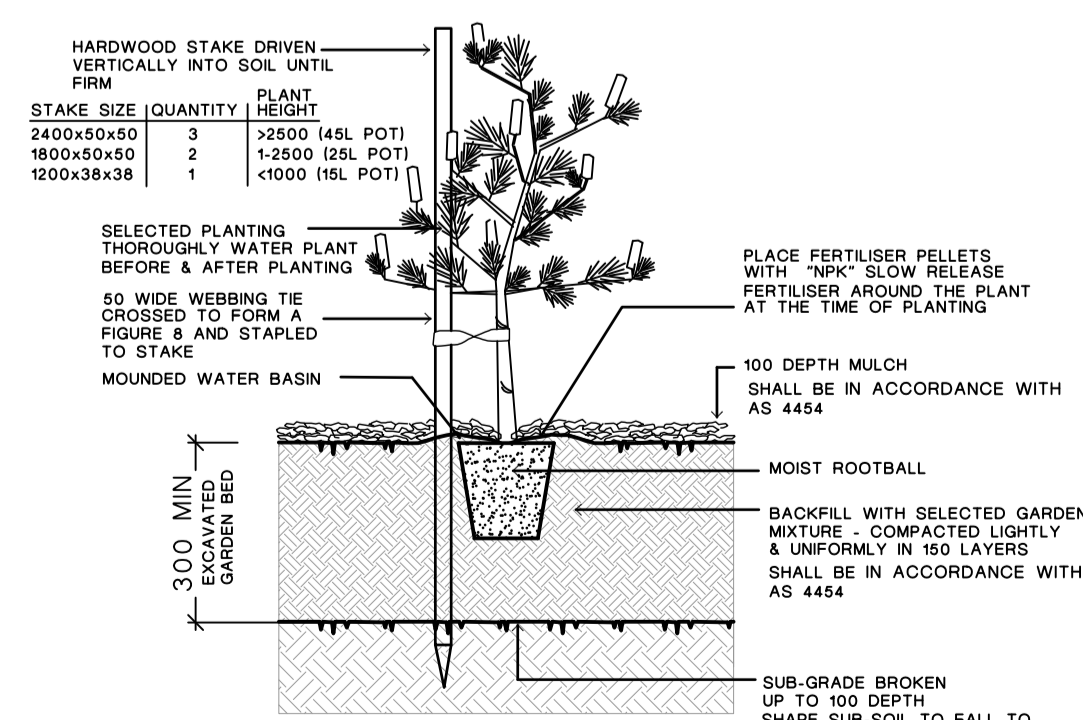
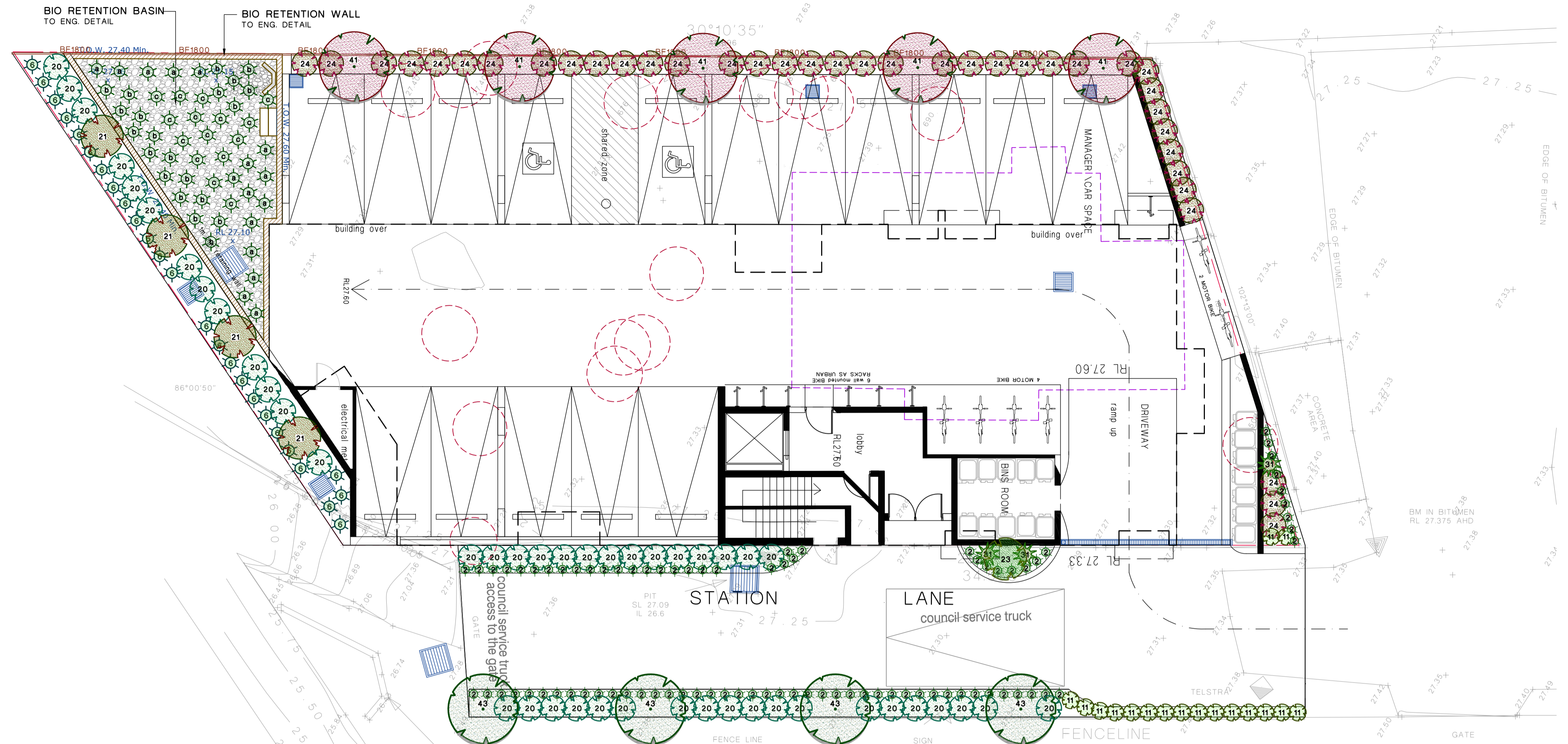

1. TREE & SHRUB PLANTING IN GARDEN BED
NOTE:
DO NOT PLANT IN UNSUITABLE WEATHER CONDITIONS SUCH AS EXTREME HEAT, COLD, WIND OR RAIN. CLAY SOIL IS TO BE TREATED WITH CLAY BREAKER AND ORGANIC COMPOST.
ALL SOIL TYPE AS PER AUST. NATIVE LANDSCAPE SUPPLY OR EQUIVALENT AND SHALL BE IN ACCORDANCE WITH AS 4419

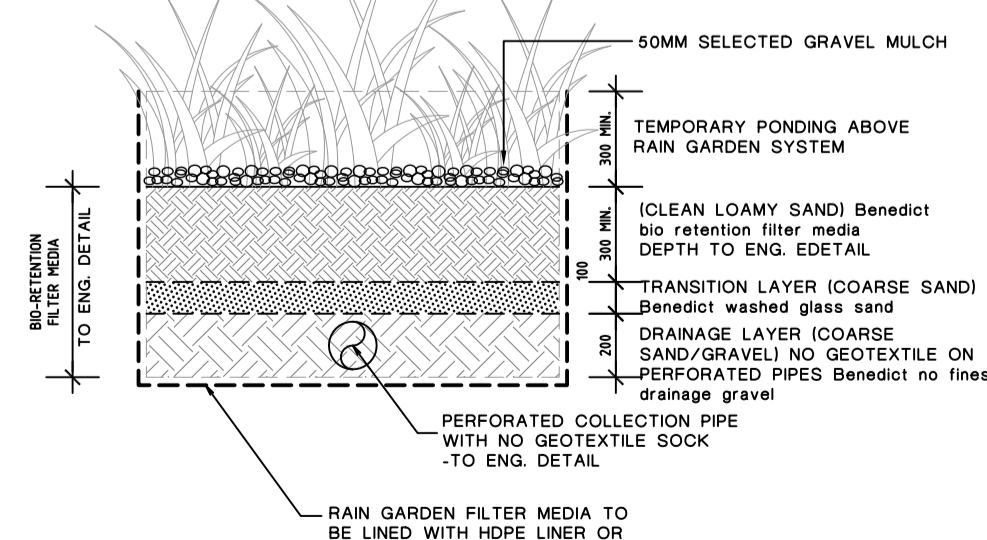

2. RAIN GARDEN TYPICAL SECTION
not to scale
BIO-RETENTION FILTER MEDIA
<http://www.benedict.com.au/products/gardening-growing-media/specialty-blend/bio-retention-specialty-blend/>

PROPOSED PLANT SCHEDULE
IN ACCORDANCE WITH AS 2303: 2015

No.	BOTANICAL NAME	COMMON NAME	APPROX MATURED HEIGHT	POT SIZE	QUANTITY
GROUND COVER / BOARDER					
2	Lomandra 'TANIKA'	Dwarf Lomandra	0.75	150mm	84
6	Juncus usitatus	Common Rush	0.6	150mm	26
LOW SHRUBS					
11	Westringia Ozbreed Aussie Box	Aussie Box Westringia	0.5	200mm	17
20	Westringia fruticosa	Westringia	1.5	200mm	46
TALL SHRUBS					
21	Callistemon citrinus	crimson bottlebrush	4	200mm	4
23	Backhousia myrtifolia	Grey Myrtle	3	200mm	1
24	Callistemon 'Slim'	Slim Bottlebrush	3	200mm	38
FEATURE SHRUBS					
31	Cordylina stricta	Slender palm lily	3	200mm	3
TREES					
41	Callistemon viminalis	Weeping bottlebrush	7	25 L	5
43	Elaeocarpus reticulatus 'Prima Donna'	Blueberry Ash	8	45 L	4
RAIN GARDEN					
a	Carex appressa	Tall sedge	2	150mm	16
b	Isolepis nodosa	Knobby club bush	0.5	150mm	21
c	Themeda australis 'Mingo'	Kangaroo grass	0.4	150mm	15

NOTE:
HEIGHT AND SPAN ARE INDICATIVE ONLY. SUBJECT TO ON SITE ENVIRONMENTAL FACTORS. USE ONLY AS A GUIDE.

REV	DESCRIPTION	REVISION DATE
A	NEW DA ISSUE	27.7.20

- NOTE:
- All landscape works shall be carried out by members of the LANDSCAPE CONTRACTORS ASSOCIATION OF AUSTRALIA.
 - Contractors must verify all dimensions at the site before commencing any work or making any shop drawings which must be approved before manufacturing.
 - Do not scale drawing, if in doubt - ASK
 - This drawing is to be read in conjunction with Architectural, Hydraulic and survey plans
 - All existing trees to remain shall be protected as per arborist report & council requirements
 - All pruning shall be in accordance with the AS 4373
 - Thoroughly eradicate weeds from all garden areas.
 - No variation to the works to be carried out without prior approval from owner.
 - All materials to be the best of their respective kinds and shall comply with approved sample type submitted or specified.
 - Substitution of plant species or varieties will not be permitted.
 - Unless otherwise specified or directed, all instructions are to be issued by the consulting landscape designer.
 - All storm water outlets & surface run off shall be to Hydraulic Engineers detail.
 - Provide sub-soil drainage to garden beds & lawn areas where required - To be confirmed on site.
 - Refer to survey plan for position of all existing services.
 - Refer to Architectural elevations & Sections for existing and proposed ground lines.
 - All landscape works shall comply with all councils DA & CC conditions and all relevant "AUSTRALIAN STANDARDS" and AUS SPEC NO.1 Specification C273-Landscaping
 - Irrigation system - If required, shall be designed & installed to comply with AS 2698, AS 2698.1-1994, AS 2698.2-1995, AS 2698.3-1990, water board and other relevant authority regulations.

MAINTENANCE
All landscape works are to be maintained for a period of 12 months (or as required by council DA Consent) by landscape contractor after final completion AND shall be maintained at all times in a suitable manner. Replace all plants which have failed with the same species. Mulch is to be maintained at specified depth. All plants and turf shall be watered on a regular basis to maintain moisture levels required for optimum growth. All garden areas are to be maintained free from weeds.



PROPOSED HOME UNITS
1 Station Lane
Penrith

ARCHITECT:
Antoine Saouma
Architect

vision dynamics
landscape design
8 Blaxland Road
Killara NSW 2071
m.0412 282 888
Ph:021 9499 8888 Fax:021 9499 8899
em - visiondynamics @ westnet.com.au

DRAWING TITLE
LANDSCAPE CONCEPT
PLAN

DRAWN	FF	SCALE	1:100@A1 OR 1:200@A3	REV.	
DRAWING NUMBER	18122-1 DA 1				
MEMBER	Australian Institute of Landscape Designers & Managers Ltd				
					NORTH