

NOTES

- * THE TITLE BOUNDARIES OF THE PROPERTY HAVE NOT BEEN SURVEYED.
- * DIMENSIONS AND AREAS WHERE SHOWN HAVE BEEN TAKEN FROM DP 219187 & DP 111896 (AND DP 1103316).
- * CONTOUR INTERVAL = 0.25 METRES
- * CONTOURS ARE AN INDICATION OF LANDFORM ONLY AND MUST NOT BE TAKEN IN PREFERENCE TO SPOT LEVELS SHOWN.
- * SERVICES SHOWN HEREON HAVE BEEN LOCATED WHERE POSSIBLE BY FIELD SURVEY AND ARE INDICATIVE ONLY FROM SURFACE INDICATORS FOUND ON SITE.
- * RIDGE & GUTTER HEIGHTS SHOWN ARE ACCURATE TO +/- 50mm ONLY.
- * PRIOR TO ANY DEMOLITION, EXCAVATION OR CONSTRUCTION ON THE SITE, DIAL BEFORE YOU DIG SHOULD BE CONTACTED FOR POSSIBLE LOCATION OF FURTHER UNDERGROUND SERVICES NOT SURVEYED.
- * THIS DETAIL SURVEY IS NOT A "SURVEY" AS DEFINED BY THE SURVEYING AND SPATIAL INFORMATION ACT, 2002. IF ANY CONSTRUCTION IS PLANNED IT WOULD BE MANDATORY TO CARRY OUT FURTHER SURVEY WORK TO DETERMINE THE BOUNDARY DIMENSIONS.
- * LOT 1 DP 111896 EXTENTS OF CONCRETE IN THE REAR YARD AREA IS APPROXIMATE ONLY DUE TO THE EXTENT OF MATERIALS STORED ON SITE AND THE EXCESS UNDERGROWTH.
- * THESE NOTES ARE AN INTEGRAL PART OF THE PLAN.

Remember to...



DECLARATION

NO RESPONSIBILITY WILL BE ACCEPTED BY T GRABARA & ASSOCIATES IF ANY PART OF WHOLE OF THIS PLAN HAS BEEN ALTERED, VARIED, MODIFIED, DELETED, ADDED OR INTERPOLATED IN ANY WAY.

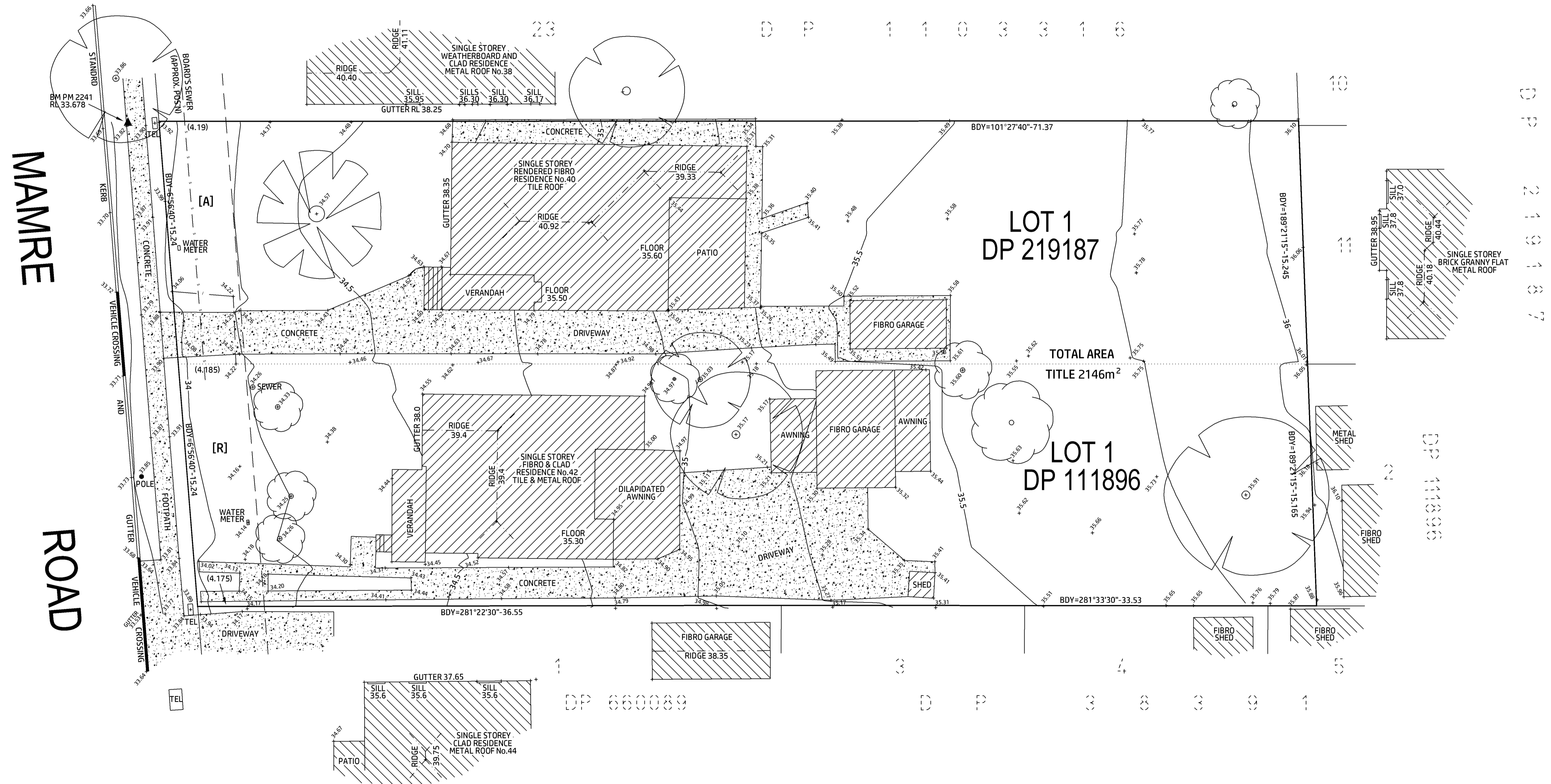
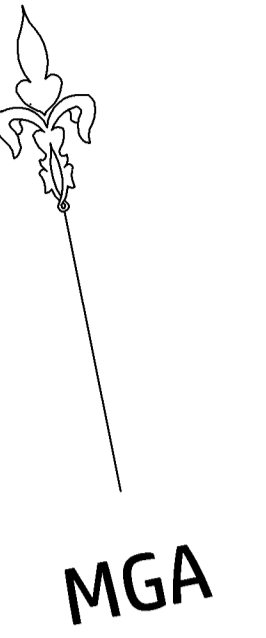

- [A] - RESTRICTION ON USER VARIABLE WIDTH (S27 E(6) MAINS ROAD ACT 1924) GAZETTED 13-08-1965 FOLIO 2587 (DP 225282)
- [R] - PROPOSED ROAD WIDENING BEING LOT 14 DP 225282

T GRABARA & ASSOCIATES
 A DIVISION OF TRAZTAR PTY LTD ACN 002 207 356
SURVEYORS & DEVELOPMENT CONSULTANTS
 OFFICE: No.4/188-190 QUEEN STREET, ST MARYS NSW 2760
 POSTAL: PO BOX 50 ST MARYS NSW 1790
 Phone: (02) 9833-2733 Email: tga@grabara.com.au

REFERENCE: 4201	LOCALITY: ST MARYS
DATE: August 6th, 2020	LGA: PENRITH
SCALE: 1:150	SHEET 1 OF 1 SHEETS
DATUM: AHD (ORIGIN OF LEVELS PM 2241 RL 33.678m)	REVISION 4201-LEV
PLAN OF LEVELS AND CONTOURS OF LOT 1 DP 219187 AND LOT 1 DP 111896 BEING No.40-42 MAMRE ROAD, ST MARYS FOR Mr JASON GRIMA.	