

LEGEND	
	EXISTING TREE
	EXTENT OF EXISTING DRIVEWAY TO BE REMOVED
	PROPOSED FULL DEPTH AC PAVEMENT
	EXISTING TOPOGRAPHICAL FEATURE
	EXISTING BOUNDARY
	PROPOSED LINEMARKING
	EXISTING BB LINE
	EXISTING E1 LINE
	EDGE LINE (E1)
	CONTINUITY LINE (C1)
	BB LINE (BB)
	EXISTING EDGE OF BITUMEN (EB)

PLAN
SCALE 1:200

Title: X:\696001\18_A114_X\696001_01_Ext\696001_01_Ext.dwg, X:\696001_01_Ext\696001_01_Ext.dwg, X:\696001_01_Ext\696001_01_Ext.dwg, X:\696001_01_Ext\696001_01_Ext.dwg
 Plot Date: 05/02/2022 09:17:53.32 Login Name: jack Call File: X:\696001_01_Ext\696001_01_Ext.dwg

DO NOT SCALE FROM DRAWINGS, CHECK & VERIFY ALL DIMENSIONS & LEVELS BEFORE COMMENCEMENT OF ANY WORK.

THIS DRAWING IS NOT TO BE COPIED IN PART OR WHOLE WITHOUT WRITTEN PERMISSION FROM WARREN SMITH AND PARTNERS.

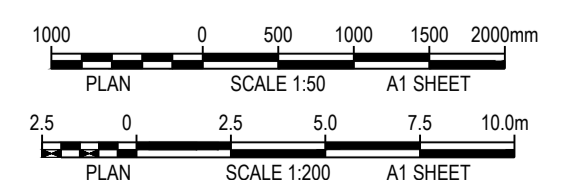
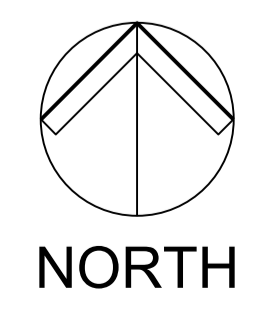

REVISION	AMENDMENT	DATE	REVISION	AMENDMENT	DATE
1	ISSUE FOR INFORMATION	05/06/20			
2	ISSUE FOR INFORMATION	11/06/20			
3	ISSUE FOR INFORMATION	18/03/21			
4	ISSUE FOR INFORMATION	05/07/21			

CLIENT
CMCT

PROJECT
WALLACIA MEMORIAL PARK

PREPARED BY

WARREN SMITH CONSULTING ENGINEERS PTY LTD
SINCE 1981.

NSW
9/233 Castlereagh St,
Sydney 2000 NSW Australia
PH +61 (2) 9299 1312

VIC
20/485 La Trobe St,
Melbourne 3000 VIC
Australia
PH +61 (3) 8648 9942

www.warrensmith.com.au
wsp@warrensmith.com.au
ACN 002 197 088 ABN 36 300 430 126

Hydraulic Fire Civil Utilities Infrastructure

EXTERNAL WORKS PLAN SHEET 3				
SCALE AS SHOWN	DRAWN J.W.	DESIGNED J.W.	CHECKED -	APPROVED -
JOB No. 5936001	DRAWING No. C7.03	ISSUE 4		
DATE JUNE 2020	STATUS DEVELOPMENT APPLICATION			

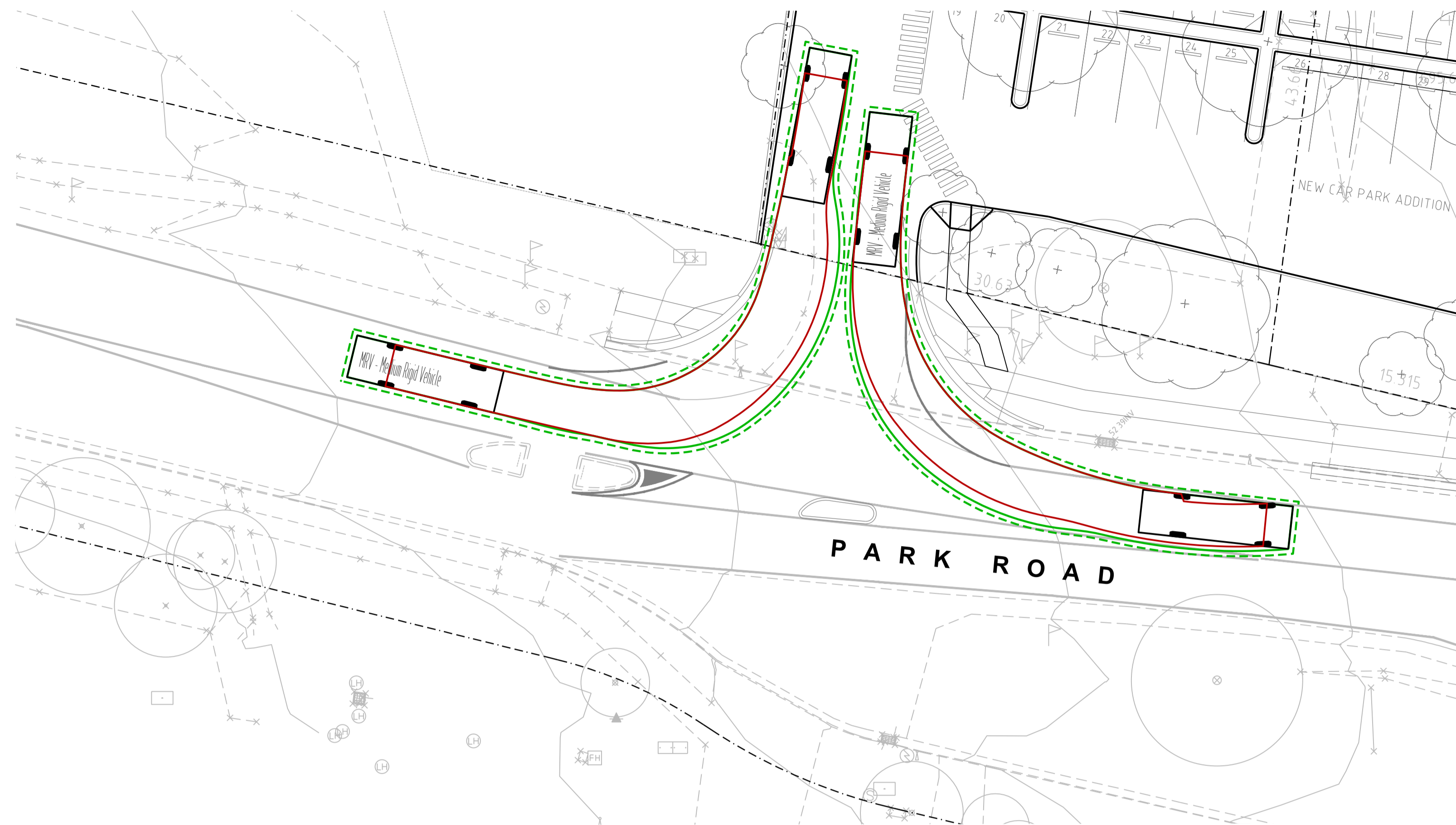

SWEPT PATH - MRV 8.8m LEFT ENTRY EXIT

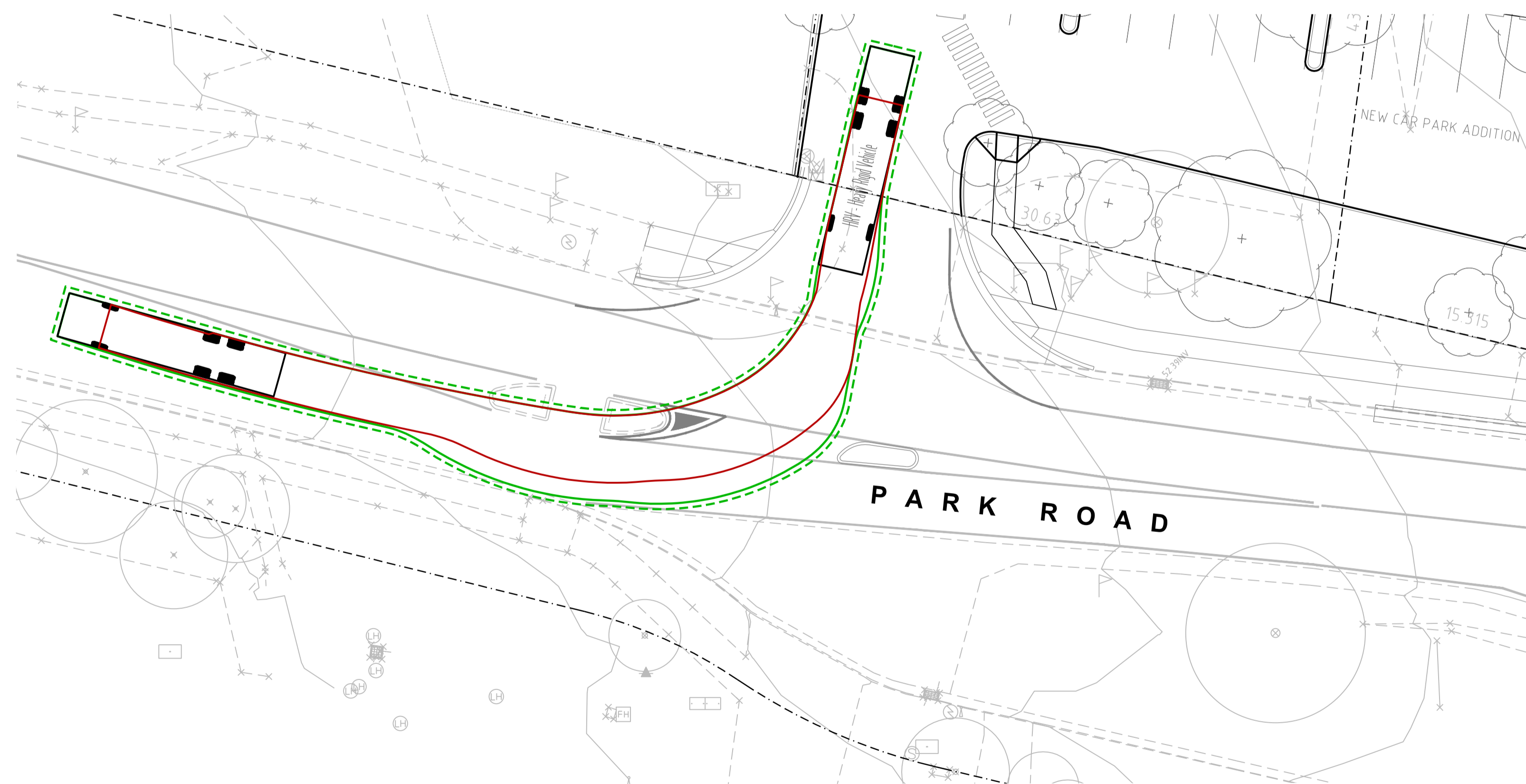

SWEPT PATH - MRV 8.8m RIGHT EXIT

PRELIMINARY - NOT FOR CONSTRUCTION

Path: X:\6536001\18_A114_X\6536001_DE_Plan_SweepPath.dwg
 User: J.W.
 Plot Date: 10/03/2022 10:55:46
 Plot File: X:\6536001\18_A114_X\6536001_DE_Plan_SweepPath.dwg

DO NOT SCALE FROM DRAWINGS, CHECK & VERIFY ALL DIMENSIONS & LEVELS BEFORE COMMENCEMENT OF ANY WORK.
THIS DRAWING IS NOT TO BE COPIED IN PART OR WHOLE WITHOUT WRITTEN PERMISSION FROM WARREN SMITH AND PARTNERS.

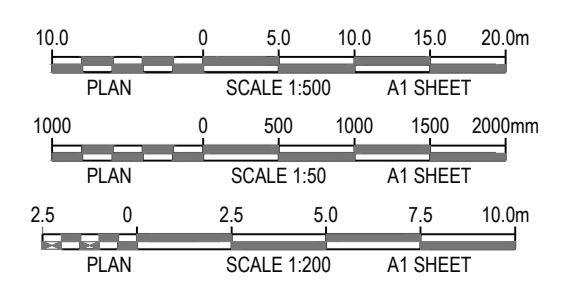

REVISION	AMENDMENT	DATE	REVISION	AMENDMENT	DATE
1	ISSUE FOR INFORMATION	06/11/20			
2	ISSUE FOR INFORMATION	09/11/20			
3	ISSUE FOR INFORMATION	10/03/21			
4	ISSUE FOR INFORMATION	20/03/21			
5	ISSUE FOR INFORMATION	10/03/22			

CLIENT	CMCT
PROJECT	NEPEAN GARDENS

PREPARED BY

WARREN SMITH CONSULTING ENGINEERS PTY LTD
SINCE 1981.

NSW 9/233 Castlereagh St, Sydney 2000 NSW Australia	VIC 20/485 La Trobe St, Melbourne 3000 VIC Australia
PH +61 (0) 2 9299 1312	PH +61 (0) 3 8648 9942
www.warrensmith.com.au	
ACN 002 197 088 ABN 36 300 430 126	

■ Hydraulic
 ■ Fire
 ■ Civil
 ■ Utilities Infrastructure

TITLE				
SWEPT PATHS - SHEET 1				
SCALE	DRAWN	DESIGNED	CHECKED	APPROVED
AS SHOWN	J.W.	J.W.	-	-
JOB No.	DRAWING No.		ISSUE	
5936001	C9.01		5	
DATE	STATUS			
JUNE 2020	DEVELOPMENT APPLICATION			

