

AUSTROADS DESIGN PRIME MESH SEMI-TRAILER (19 m)
 TURNING SPEED 0 - 5 km/h

M.M.

SCALE OF METRES

- Notes:
1. Locate flow of horns at least 0.6 m clear of wheel paths.
 2. Ensure that this area is kept free of road furniture.
 3. Paved area of the swept path remains within the paved area.

EXCAVATED DRIVEWAY & HARDSTAND AREA TO BE FILLED WITH A MINIMUM OF 200mm CRUSHED SANDSTONE OR EQUIVALENT.

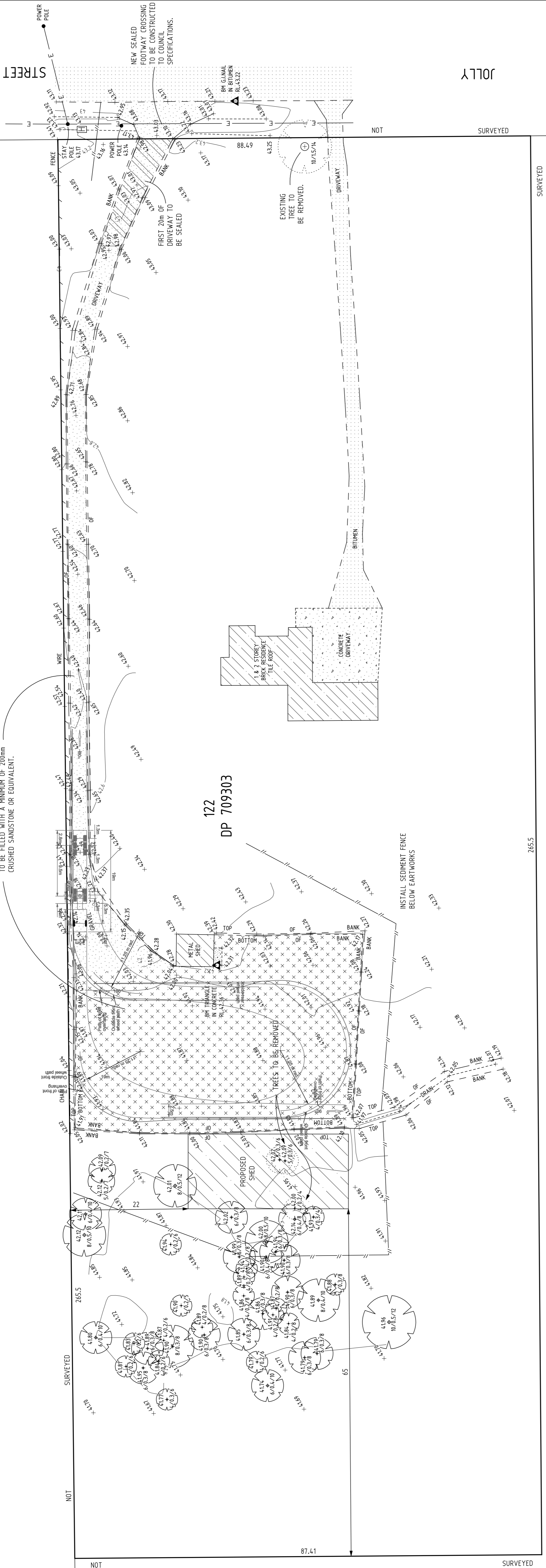

122 DP 709303
 No.49 VACANT

CAUTION
 * The position of features shown & accurate boundary dimensions are subject to a specific boundary survey.
 * This survey plan is for planning and design purposes only and is not to be used for construction. If any construction is to be undertaken prior to any demolition, excavation or construction, service authorities must be contacted for the possible location of further services and the precise location of all services.
 * Only visible services of water and electricity have been located.
 * No searches have been made with any service authority for the location of any other services.
 * Prior to any demolition, excavation or construction, service authorities must be contacted for the possible location of further services and the precise location of all services.

122 DP 709303

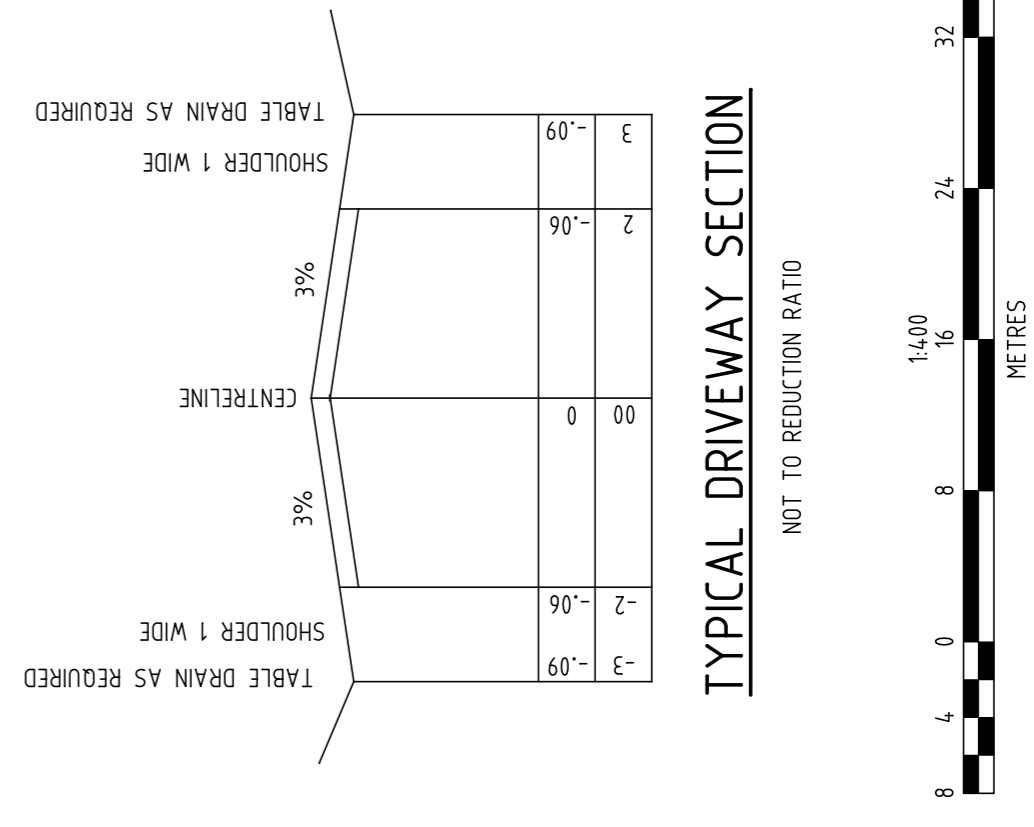

TYPICAL DRIVEWAY SECTION
 NOT TO A REDUCTION RATIO

SILT FENCE DETAIL
 NOT TO A REDUCTION RATIO

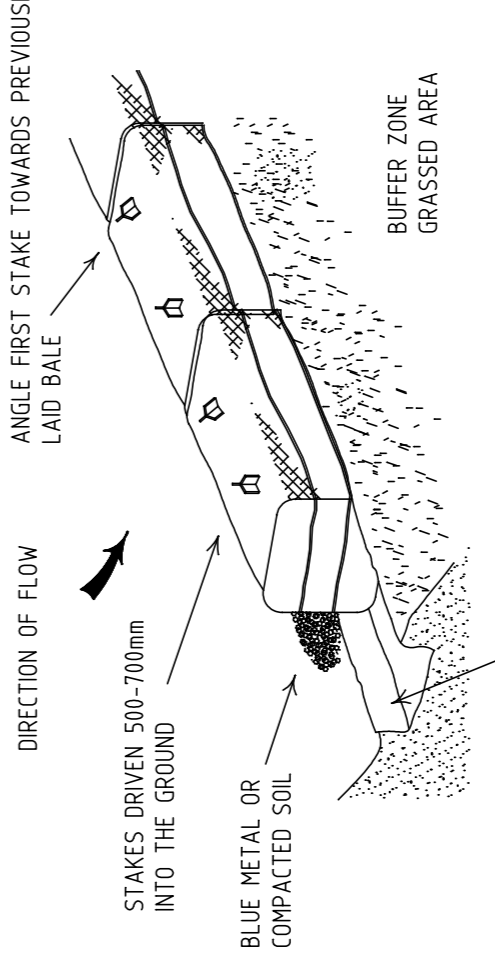
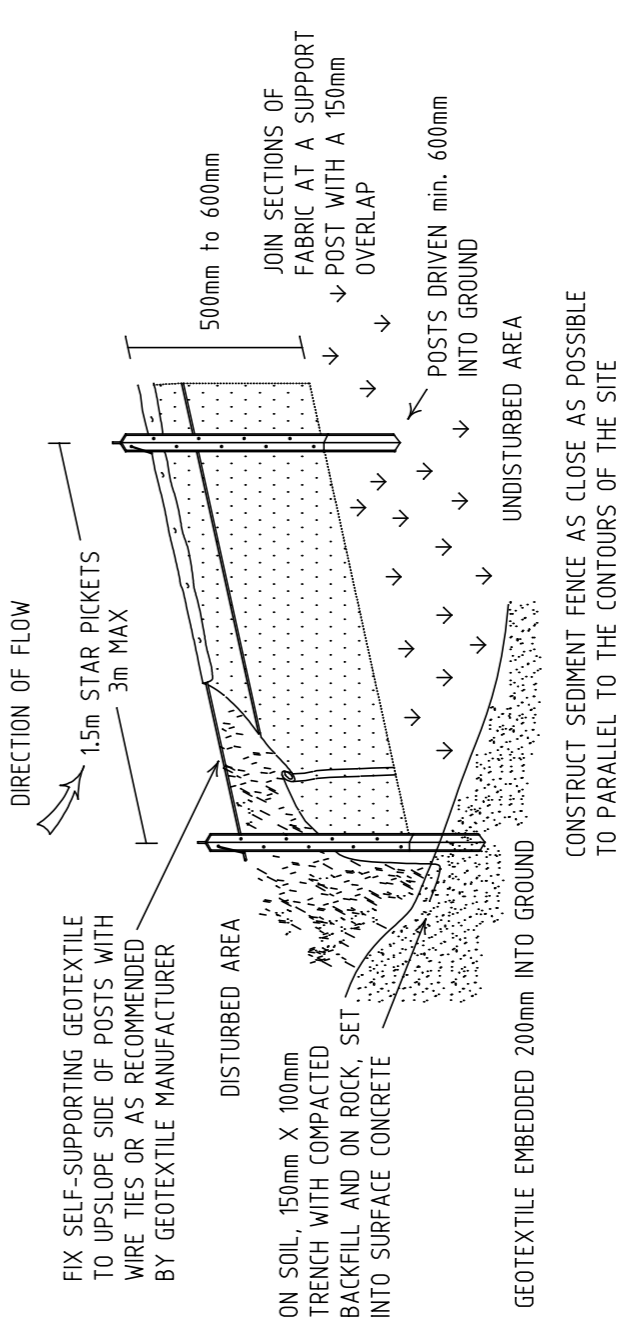

STRAW BALE SEDIMENT BARRIER
 NOT TO A REDUCTION RATIO

LEGEND

- E — DENOTES OVERHEAD ELECTRICITY LINE
- DENOTES HYDRANT
- DENOTES AREA TO BE FILLED
- 3/0.2/8 DENOTES APPROX. SPREAD/TRUNK DIAMETER/HEIGHT
- / — / — DENOTES SILT FENCE TO BE INSTALLED



F	0	10	20	30	40	50	100	110	120	130	140	150
E	REDUCTION RATIO AT A1 1:400											
D	CONTOUR INTERVAL 0.2m											
C	ORIGIN OF LEVELS GNS (GFS)											
B	DATUM APPROXIMATE A.H.D (+/-0.1m)											
A	SEMI-TRAILER TURNING PATH ADDED IN COLOUR											
Date	REVISION											

DESIGN BY	G.DOUGLAS
SURVEY BY	G.DOUGLAS
CALCS BY	G.DOUGLAS
DRAWN BY	G.DOUGLAS
CHECKED BY	A.EDWARDS

CLIENT NAME	TY & DEANNE GOSLING C/O URBAN CITY CONSULTING
LOCALITY	CASTLEREAGH
PLAN No.	93180.E1
C-FILE:	93180E1-ADWG
DATE	1 MARCH 2013
(DATE OF SURVEY)	27-2-13
FILE No.	93180
COUNCIL REF	
LGA	PENRITH

McKINLAY MORGAN & ASSOCIATES Pty Ltd.
 CONSULTING SURVEYORS - PROJECT MANAGERS
 Phone: 4577 6011
 Fax: 4577 4910
 Email: mail@mckinlaymorgan.com.au
 www.mckinlaymorgan.com.au