

CIVIL ENGINEERING WORKS



Sheet List Table	
Sheet Number	Sheet Title
CI-000-01	COVER SHEET
CI-060-01	GENERAL ARRANGEMENT PLAN - SHEET 1
CI-060-02	GENERAL ARRANGEMENT PLAN - SHEET 2
CI-066-01	CIVIL DETAILS
CI-070-01	SEDIMENT & EROSION CONTROL PLAN
CI-076-01	SEDIMENT AND EROSION CONTROL DETAILS

RINGMER PACIFIC MANAGEMENT PTY LTD. ST CLAIR SHOPPING CENTRE, ST CLAIR NSW 2759

CLIENT

PROJECT



36073

PROJECT No

CI-000-01

DRAWING No

A

REV

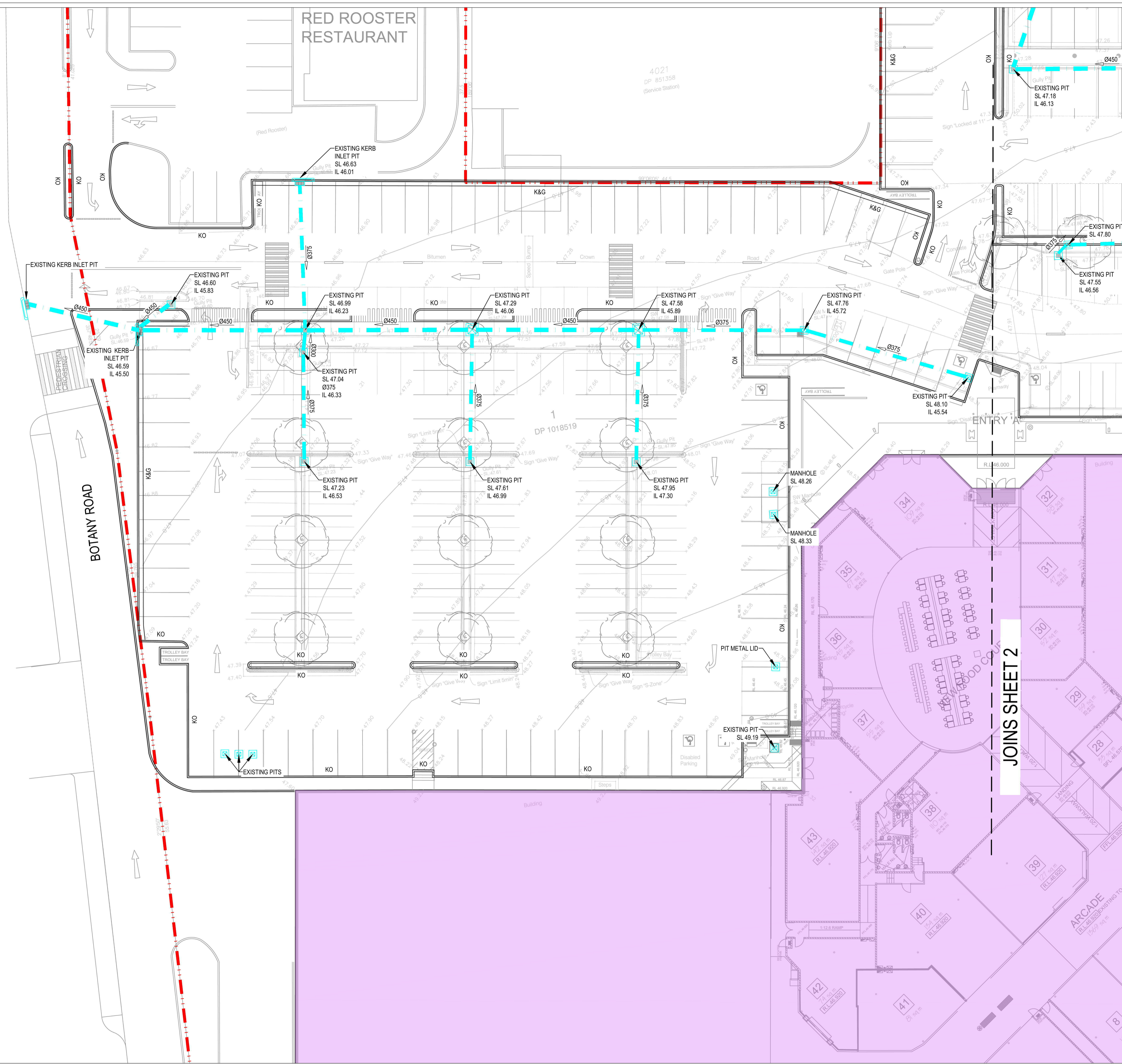

LEGEND	
	SITE BOUNDARY
	EXISTING BUILDING
	EXISTING STORMWATER PIPE
	EXISTING JUNCTION PIT
	EXISTING GRATED PIT
	EXISTING KERB INLET PIT
	PROPOSED KERB INLET PIT
	PROPOSED KERB ONLY
	PROPOSED KERB AND GUTTER

- NOTE:
1. ALL PIT LEVELS, PIT LOCATIONS, AND PIPE ALIGNMENTS TO BE ARE CONFIRMED BY SURVEYOR AT C.C. STAGE.
 2. ALL EXISTING PITS ARE TO BE ADJUSTED TO SUIT PROPOSED DESIGN.
 3. ASPHALT PAVEMENT TO BE ADJUSTED TO SUIT PROPOSED KERB ALIGNMENT. REFER TO CI-066-01 FOR DETAILS.

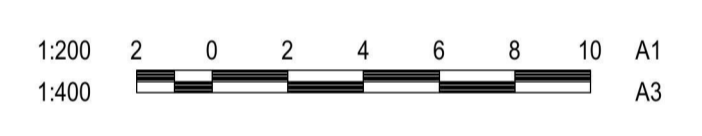
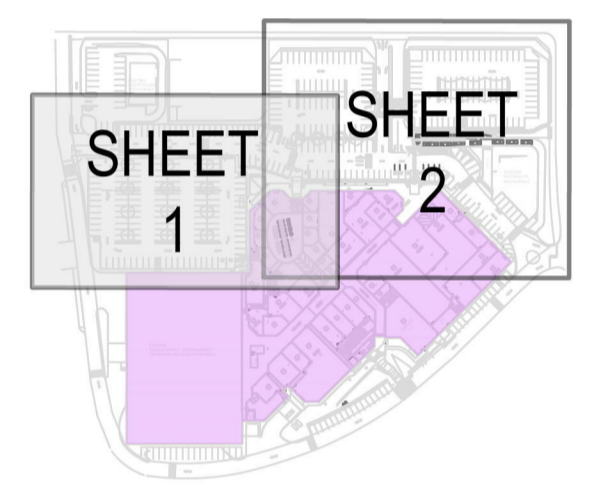

REV	DESCRIPTION	DRAWN	APPD	DATE
A	ISSUED FOR DA APPROVAL	JDL	TIF	19.12.17

RINGMER PACIFIC MANAGEMENT PTY LTD.

ARCHITECT/CLIENT	
DRAWN:	JCL
DESIGNED:	JDL
VERIFIED:	- J.L.
APPROVED FOR TENDER:	- J.L.
APPROVED FOR CONSTRUCTION:	- J.L.

**ST CLAIR SHOPPING CENTRE
ST CLAIR NSW 2759**

PROJECT
GENERAL ARRANGEMENT PLAN - SHEET 1

TITLE
FOR APPROVAL
NOT FOR CONSTRUCTION

AS SHOWN	36073	CI-060-01	A
SCALE @ A1	PROJECT No	DRAWING No	REV

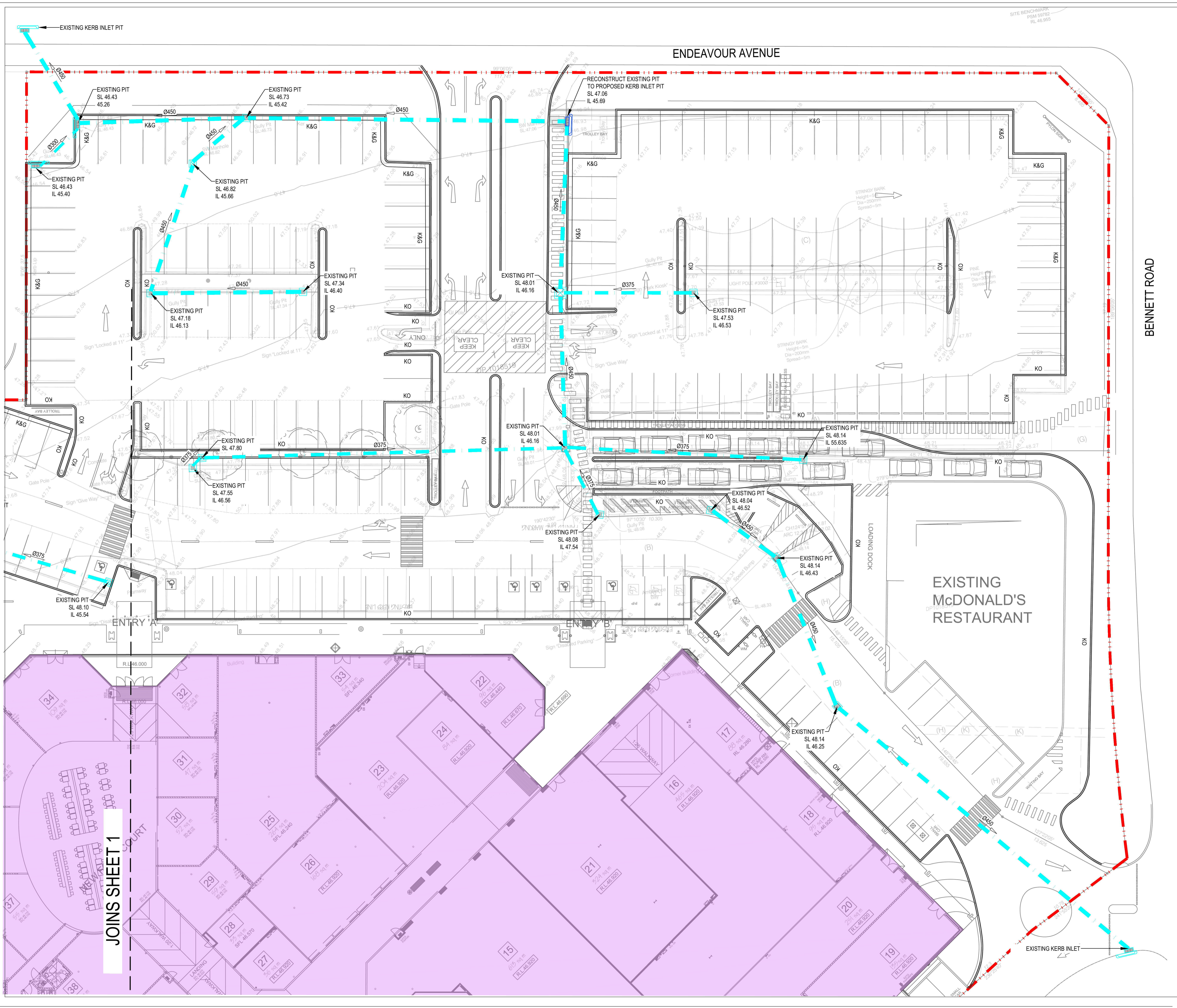

LEGEND

- SITE BOUNDARY
- EXISTING BUILDING
- EXISTING STORMWATER PIPE
- EXISTING JUNCTION PIT
- EXISTING GRATED PIT
- EXISTING KERB INLET PIT
- PROPOSED KERB INLET PIT
- PROPOSED KERB ONLY
- PROPOSED KERB AND GUTTER

NOTE:
 1. ALL PIT LEVELS, PIT LOCATIONS, AND PIPE ALIGNMENTS TO BE ARE CONFIRMED BY SURVEYOR AT C.C. STAGE.
 2. ALL EXISTING PITS ARE TO BE ADJUSTED TO SUIT PROPOSED DESIGN
 3. ASPHALT PAVEMENT TO BE ADJUSTED TO SUIT PROPOSED KERB ALIGNMENT. REFER TO CI-066-01 FOR DETAILS.

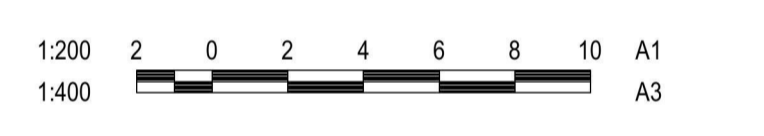
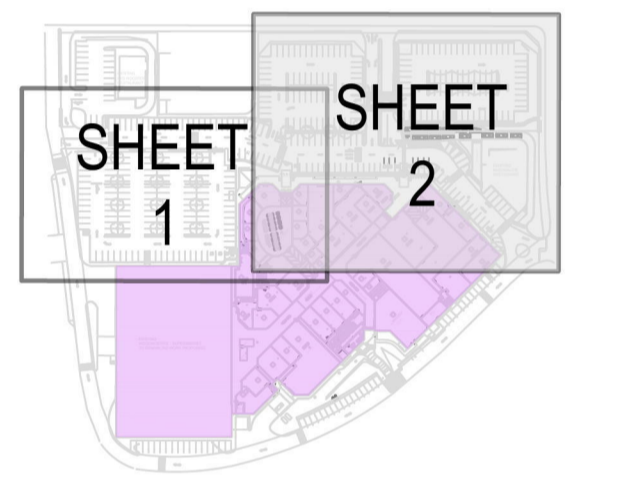

REV	DESCRIPTION	DRAWN	APPD	DATE
A	ISSUED FOR DA APPROVAL	JDL	TIF	19.12.17

RINGMER PACIFIC MANAGEMENT PTY LTD.

WOOD & GRIEVE ENGINEERS

ARCHITECT/CLIENT

DRAWN:	JCL
DESIGNED:	JDL
VERIFIED:	- J.L.
APPROVED FOR TENDER:	- J.L.
APPROVED FOR CONSTRUCTION:	- J.L.

ST CLAIR SHOPPING CENTRE ST CLAIR NSW 2759

PROJECT
GENERAL ARRANGEMENT PLAN - SHEET 2

TITLE
FOR APPROVAL
 NOT FOR CONSTRUCTION

AS SHOWN	36073	CI-060-02	A
SCALE @ A1	PROJECT No	DRAWING No	REV

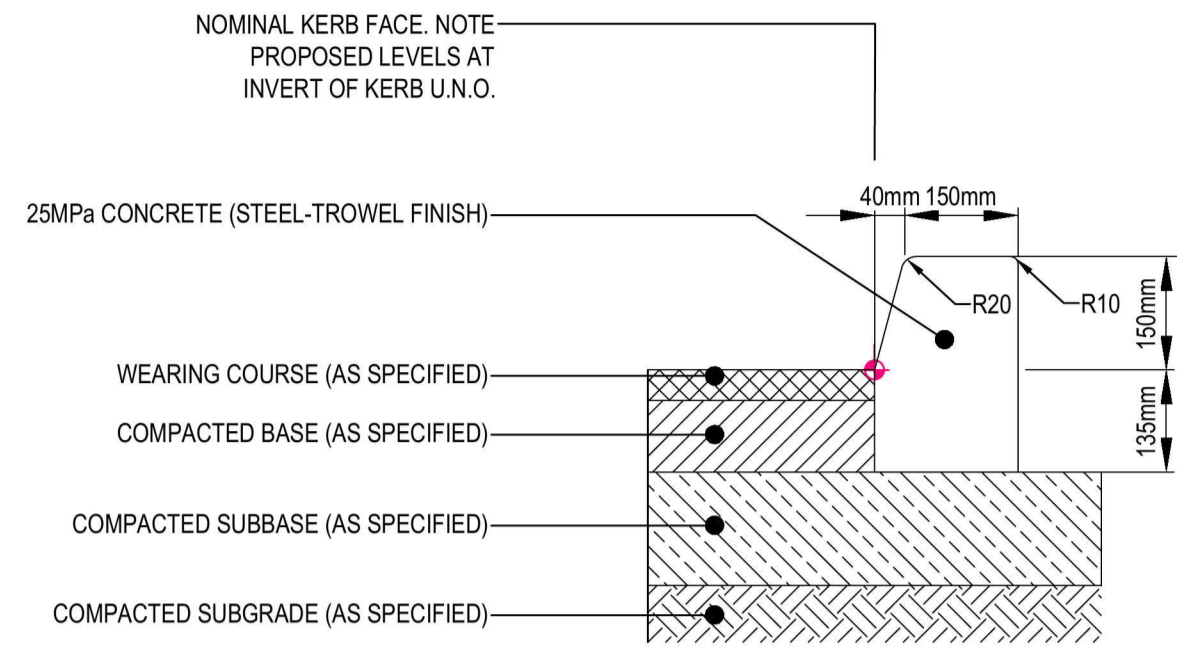

KERB ONLY 'KO' DETAIL
(SCALE 1:10)

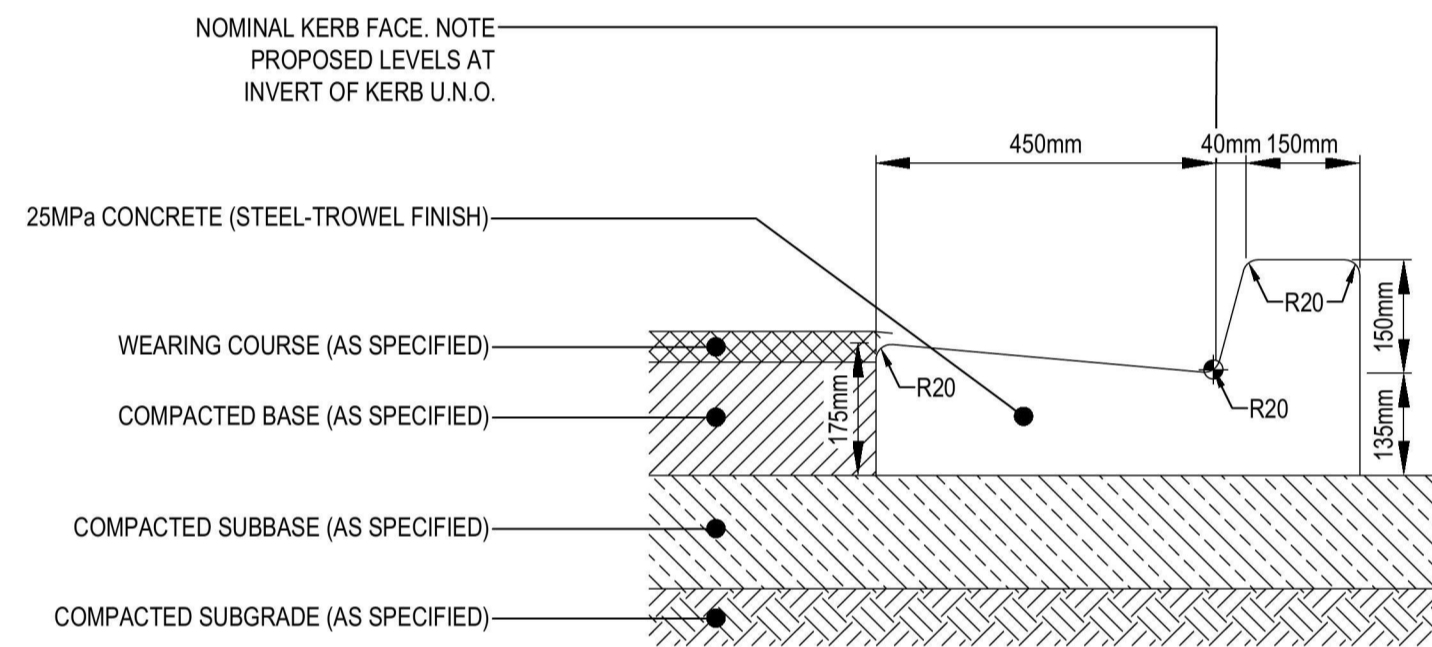

KERB AND GUTTER DETAIL
(SCALE 1:10)

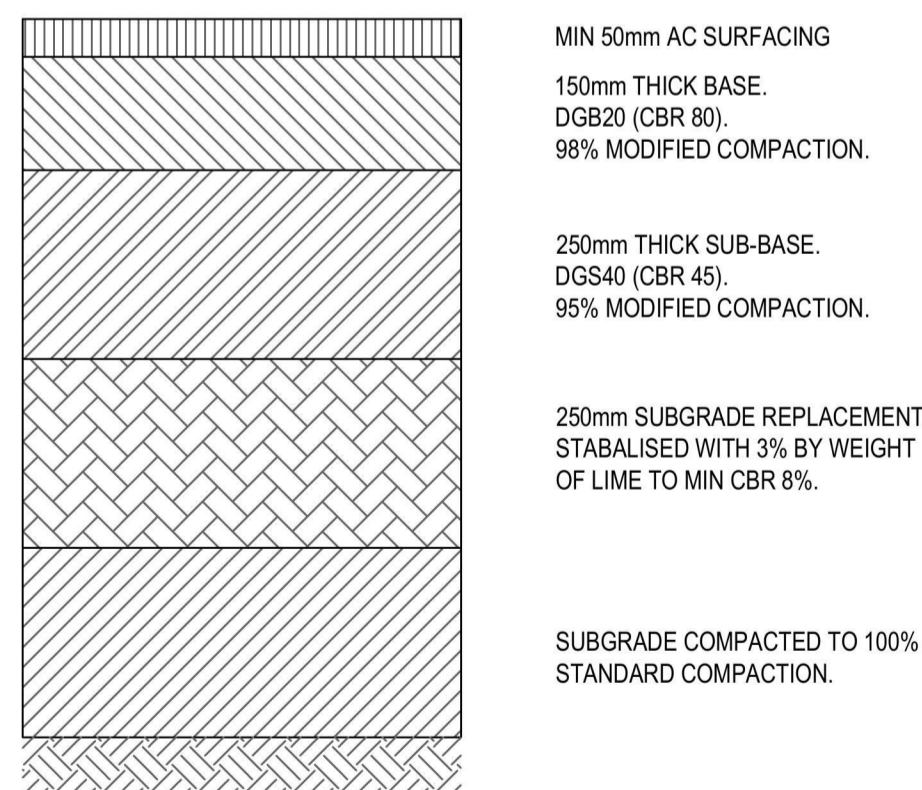

ROAD (ASPHALT) PAVEMENT DETAIL
(SCALE 1:10)

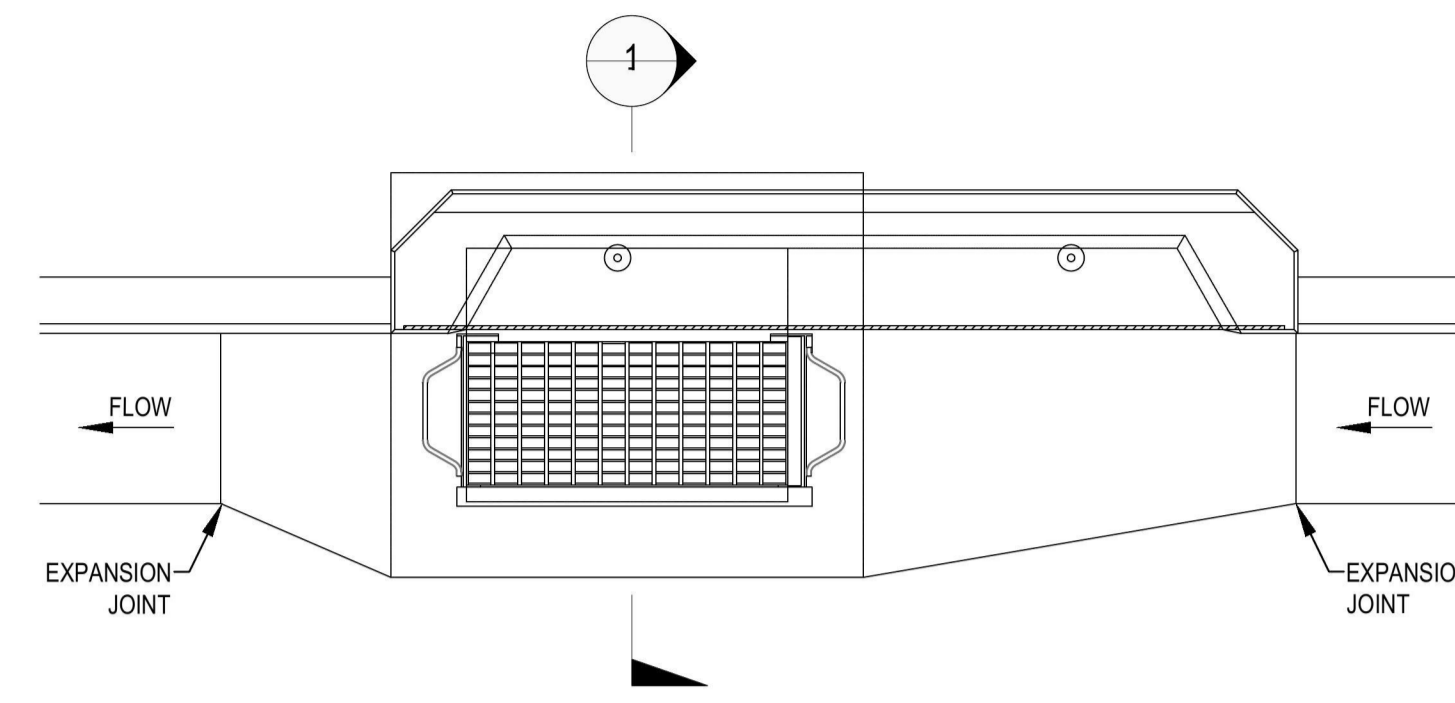

PLAN

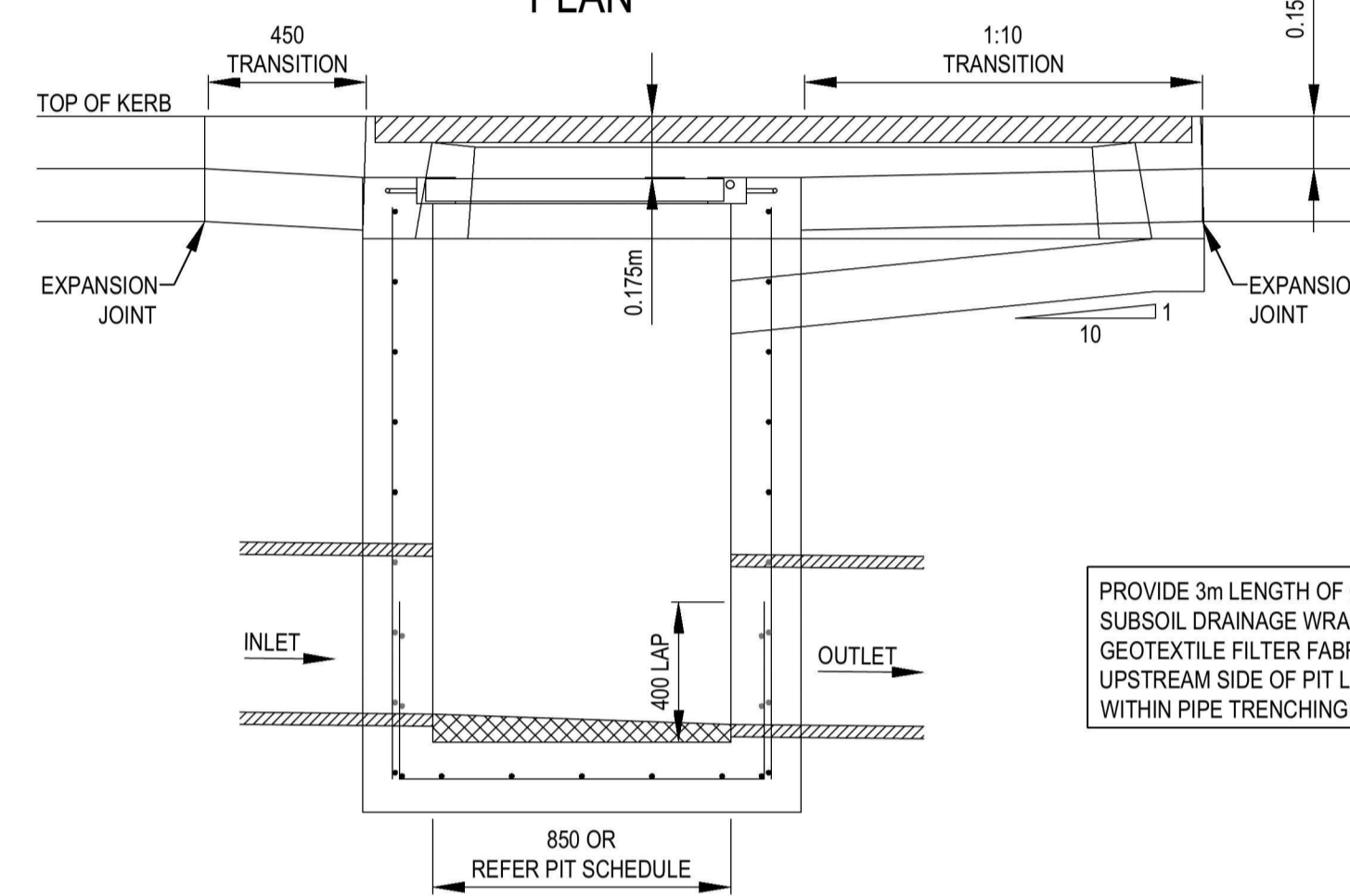

SECTION 2
SCALE 1:20

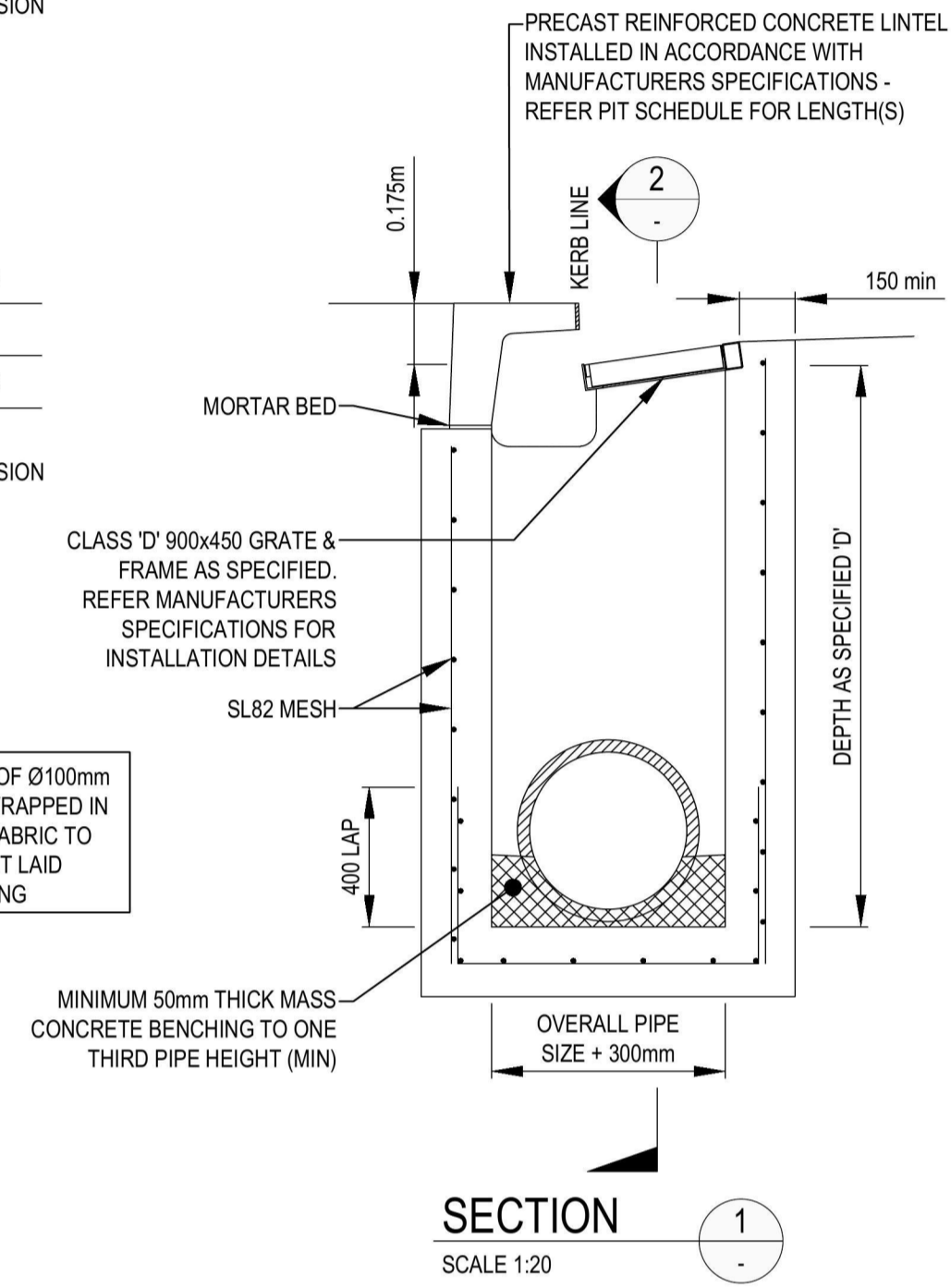

SECTION 1
SCALE 1:20

KERB INLET PIT
SCALE 1:20

REV	DESCRIPTION	DRAWN	APPD	DATE
A	ISSUED FOR DA APPROVAL	JDL	TIF	19.12.17

RINGMER PACIFIC MANAGEMENT PTY LTD.

ARCHITECT/CLIENT

DRAWN:	JCL
DESIGNED:	JDL
VERIFIED:	- J.J.
APPROVED FOR TENDER:	- J.J.
APPROVED FOR CONSTRUCTION:	- J.J.



ST CLAIR SHOPPING CENTRE
ST CLAIR NSW 2759

PROJECT
CIVIL DETAILS

TITLE
FOR APPROVAL
NOT FOR CONSTRUCTION

AS SHOWN	36073	CI-066-01	A
SCALE @ A1	PROJECT No	DRAWING No	REV

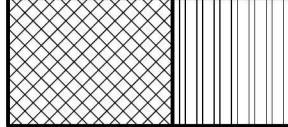
LEGEND

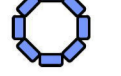
-  PROPOSED SITE BOUNDARY
-  VEHICLE SHAKEDOWN DEVICE
-  PROPOSED SILT FENCE
-  SANDBAG PIT PROTECTION

NOTE:
REFER DRAWING CI-076-01 FOR EROSION AND SEDIMENT CONTROL DETAILS

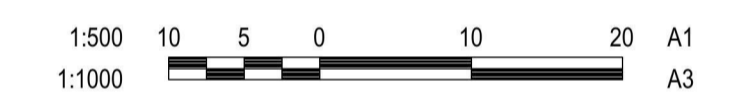
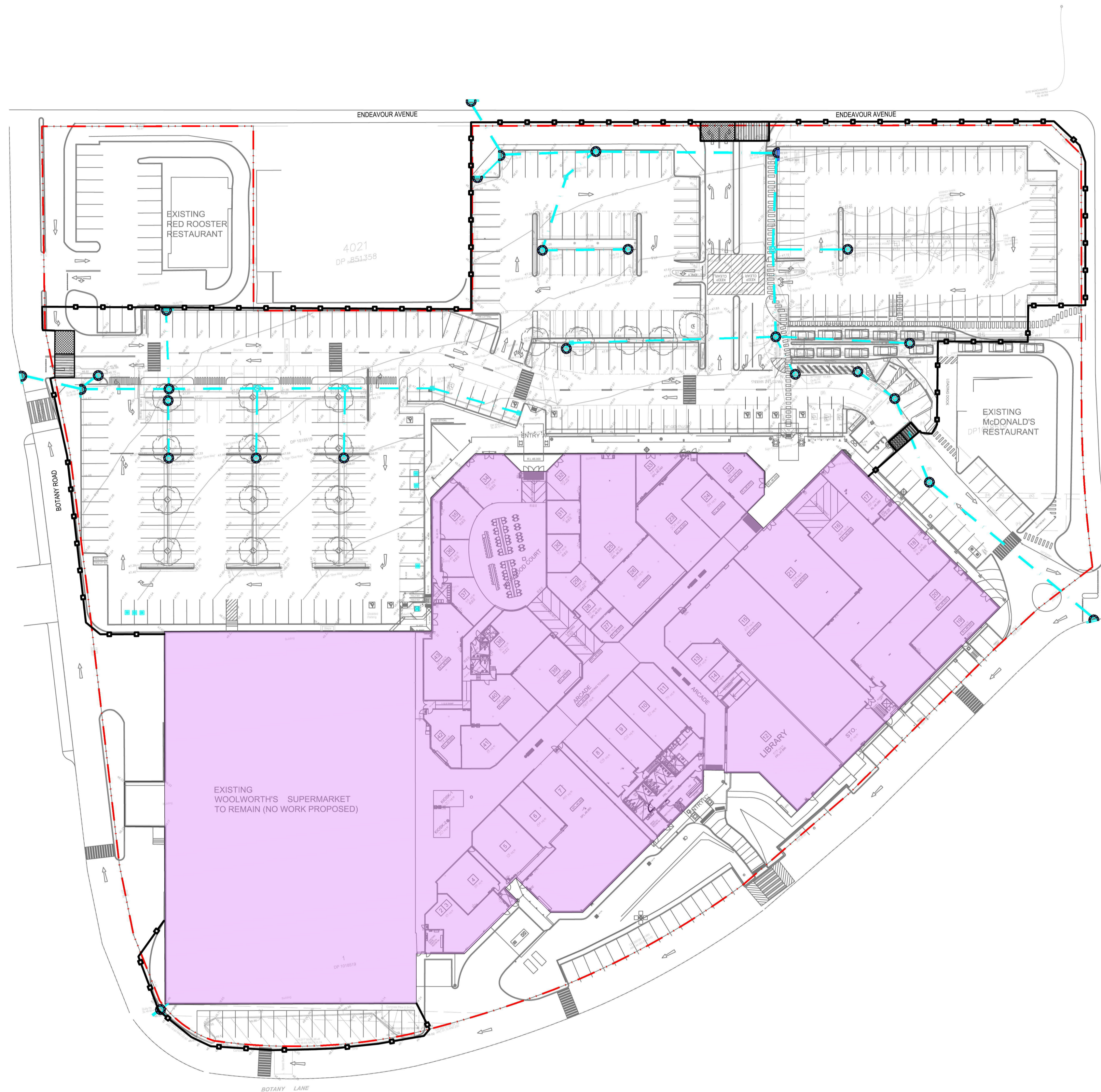

REV	DESCRIPTION	DRAWN	APPD	DATE
A	ISSUED FOR DA APPROVAL	JDL	TIF	19.12.17

RINGMER PACIFIC MANAGEMENT PTY LTD.

ARCHITECT/CLIENT	
DRAWN:	JCL
DESIGNED:	JDL
VERIFIED:	J.J.
APPROVED FOR TENDER:	J.J.
APPROVED FOR CONSTRUCTION:	J.J.

**ST CLAIR SHOPPING CENTRE
ST CLAIR NSW 2759**

PROJECT
SEDIMENT & EROSION CONTROL PLAN

TITLE
**FOR APPROVAL
NOT FOR CONSTRUCTION**

AS SHOWN	36073	CI-070-01	A
SCALE @ A1	PROJECT No	DRAWING No	REV

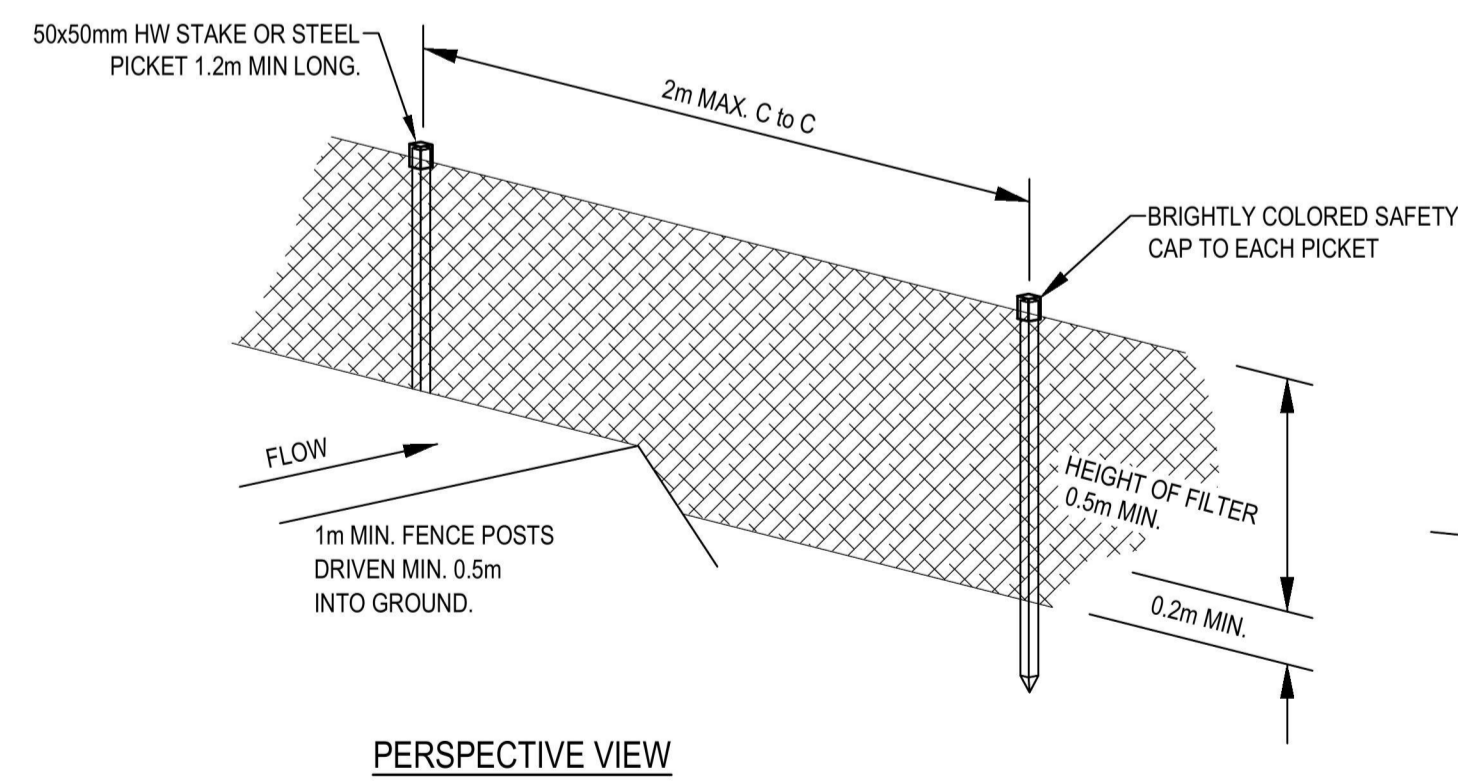
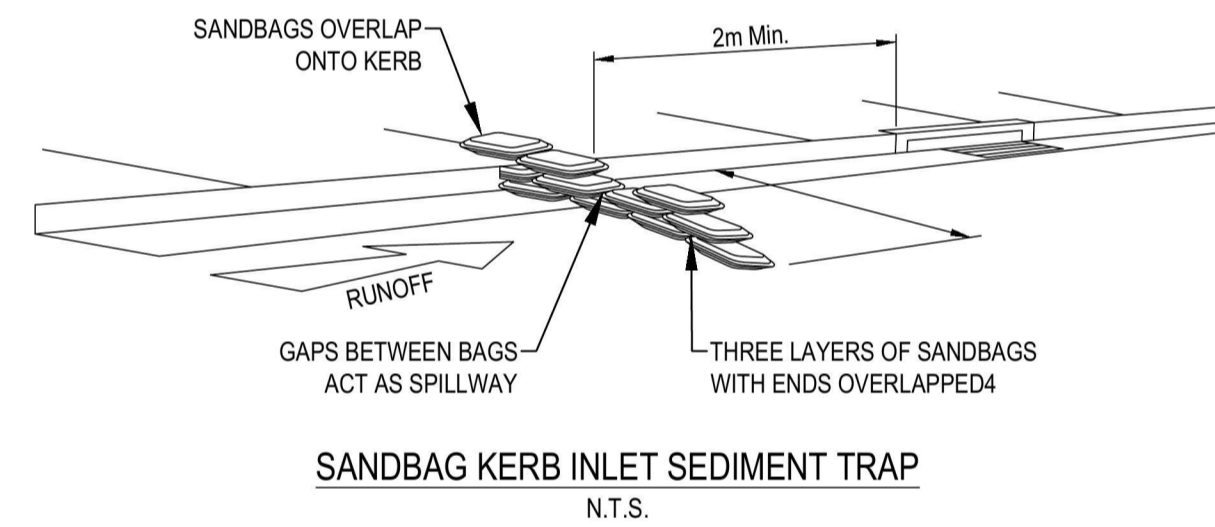
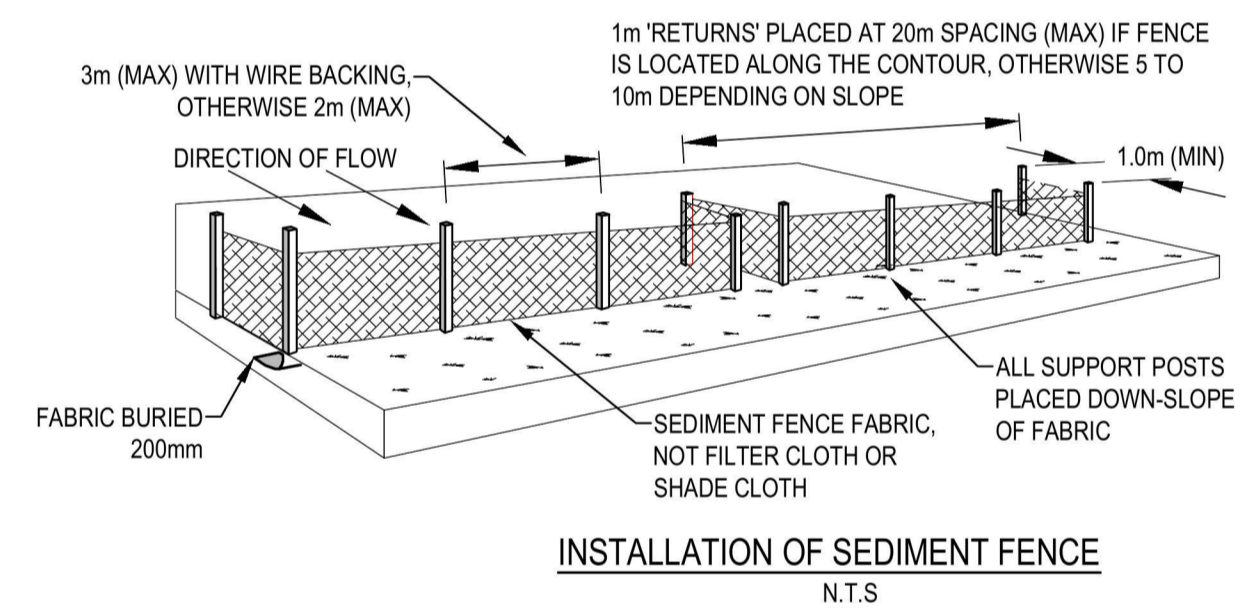
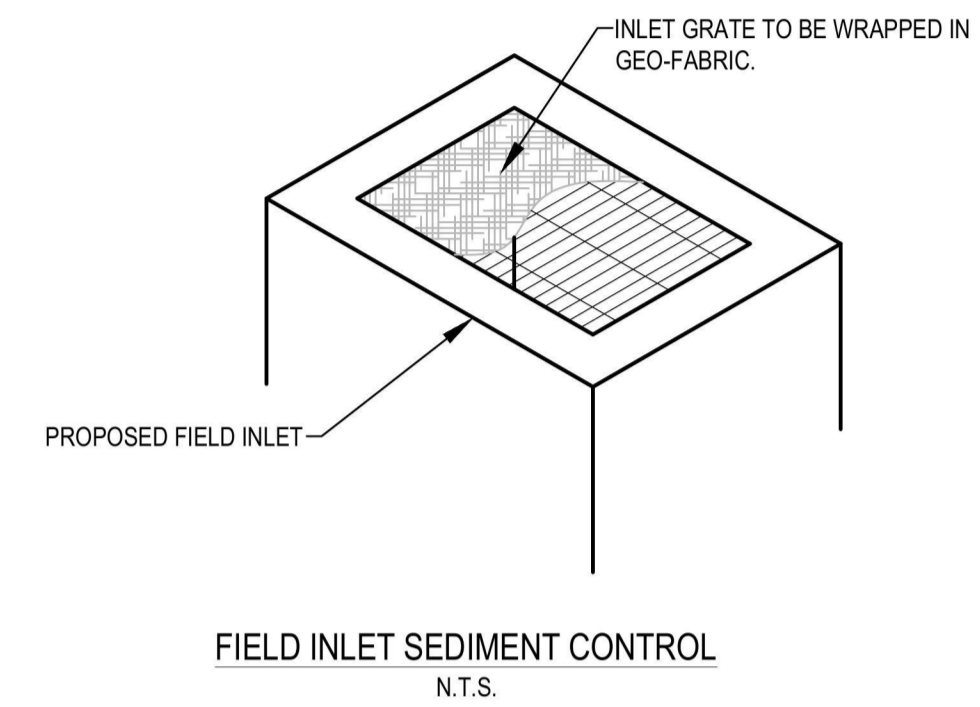
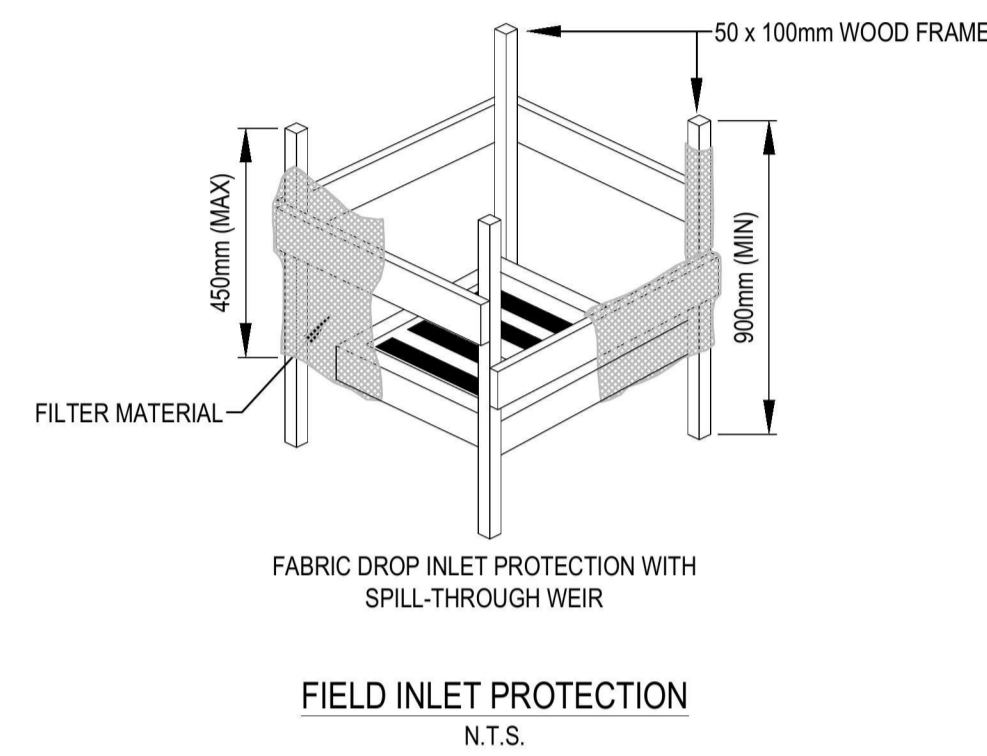
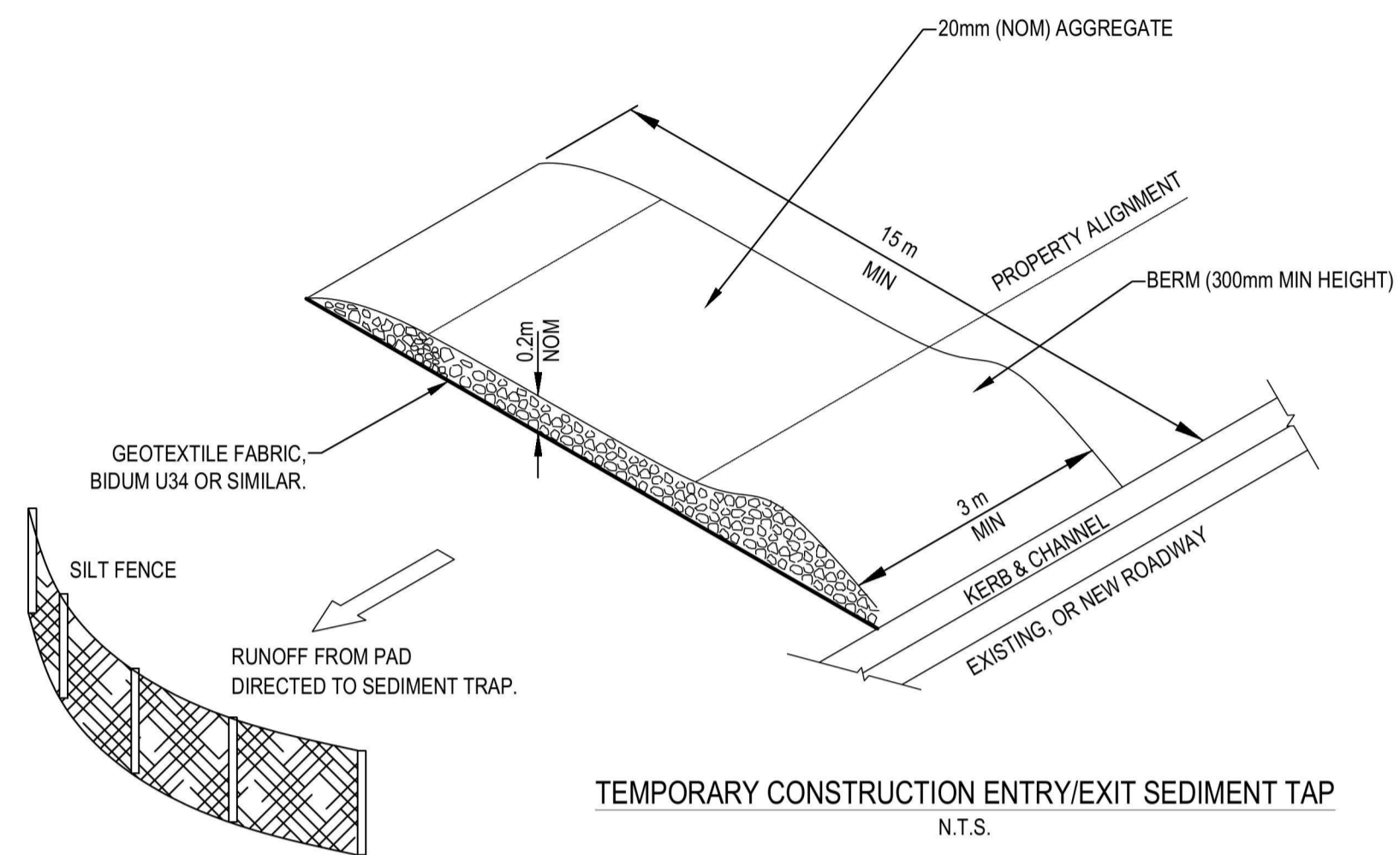

SEDIMENT FENCE DETAIL
N.T.S.

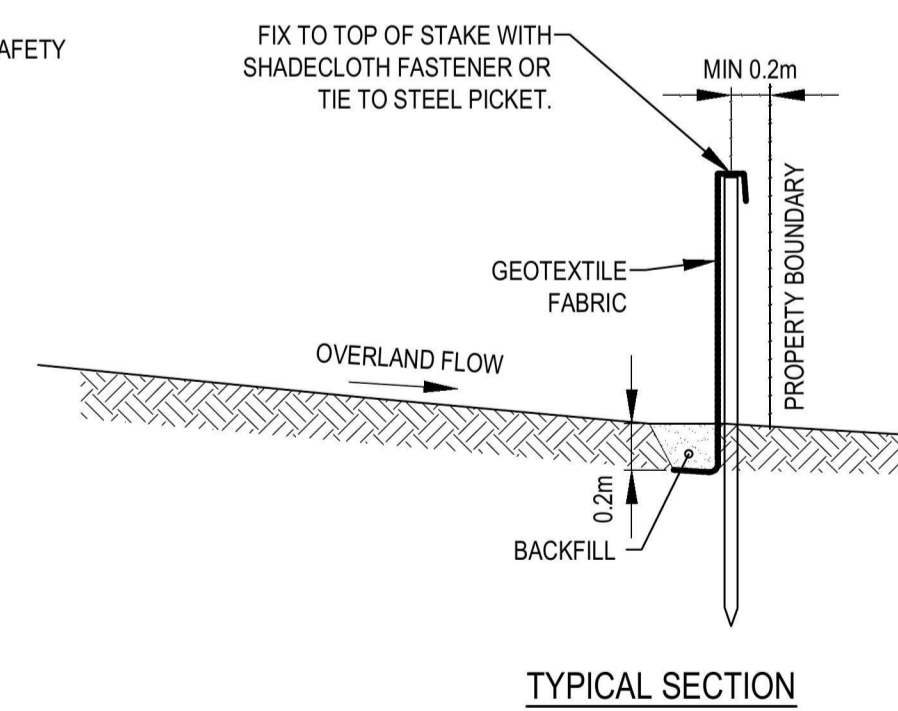

TYPICAL SECTION

REV	DESCRIPTION	DRAWN	APPD	DATE
A	ISSUED FOR DA APPROVAL	JDL	TIF	19.12.17

**RINGMER PACIFIC MANAGEMENT
PTY LTD.**

ARCHITECT/CLIENT	
DRAWN:	JCL
DESIGNED:	JDL
VERIFIED:	J.J.L.
APPROVED FOR TENDER:	J.J.L.
APPROVED FOR CONSTRUCTION:	J.J.L.

**ST CLAIR SHOPPING CENTRE
ST CLAIR NSW 2759**

PROJECT
SEDIMENT AND EROSION CONTROL DETAILS

TITLE
FOR APPROVAL
NOT FOR CONSTRUCTION

AS SHOWN	36073	CI-076-01	A
SCALE @ A1	PROJECT No	DRAWING No	REV