

(A) EASEMENT FOR OVERHEAD POWERLINE & ACCESS VARIABLE WIDTH (AK366230)
 (B) EASEMENT FOR ACCESS 7 WIDE & VARIABLE (AK366231)

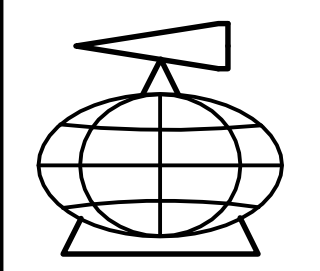

- NOTES:**
1. NO BOUNDARY SURVEY HAS BEEN MADE.
 2. BOUNDARY DIMENSIONS COMPILED FROM INFORMATION SHOWN ON PLANS ON PUBLIC RECORD AT THE N.S.W. LAND REGISTRY SERVICES.
 3. REFER TO YSCO PLAN 6719/2 FOR THE DETAIL INFORMATION.

DATE	REVISIONS	BY



YSCO GEOMATICS
LAND RESOURCE CONSULTANTS
 SUITE 4, 114 HAMPDEN ROAD, ARTARMON, 2064
 PH: 1021 94198222 FAX: (02) 94194762
 Email: enquiries@yscogeomatics.com.au
 Website: www.yscogeomatics.com.au
 YODALE STRUDWICK & COMPANY PTY LTD A.C.N. 002 819 865

GEOMATIC ENGINEERING
 LAND & ENGINEERING SURVEYING
 PROJECT MANAGEMENT
 SOIL AND WATER MANAGEMENT
 ENVIRONMENTAL PLANNING & DESIGN

PLAN SHOWING BOUNDARIES OF NEPEAN CREATIVE & PERFORMING ARTS HIGH SCHOOL, 115-119 GREAT WESTERN HIGHWAY, EMU PLAINS, BEING LOT 12 IN DP 1056135 IN PENRITH L.G.A.				
DRAWN: 15th JANUARY 2020	CHECKED: P.Y.	SCALE: 1:1000 © A1	DATUM: -	REFERENCE: 6719/1

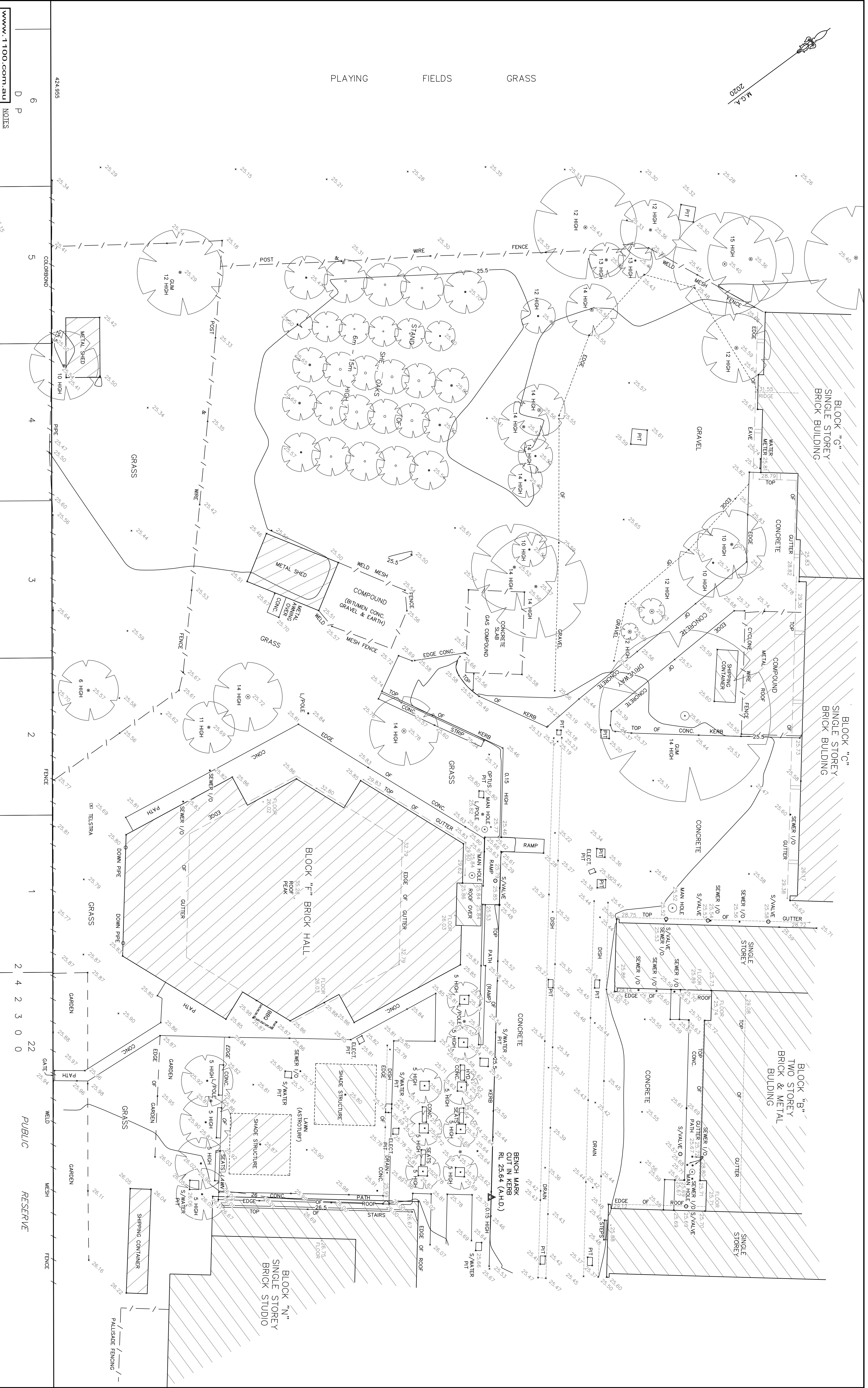
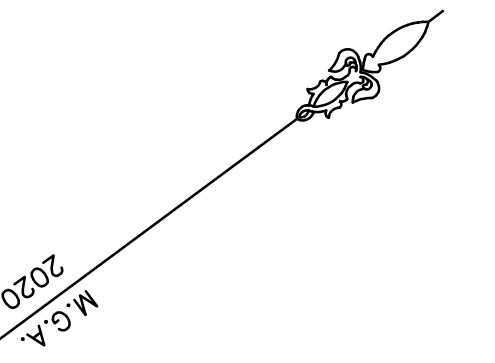

PLAYING FIELDS GRASS

BLOCK "C"
SINGLE STOREY
BRICK BUILDING

BLOCK "C"
SINGLE STOREY
BRICK BUILDING

BLOCK "B"
TWO STOREY
BRICK & METAL
BUILDING

BLOCK "E"
BRICK HALL

BLOCK "N"
SINGLE STOREY
BRICK STUDIO

6	D	P	5	4	3	2	1	2	4	2	3	0	0	22	PUBLIC RESERVE
---	---	---	---	---	---	---	---	---	---	---	---	---	---	----	----------------



www.1100.com.au
DIAL 1100 BEFORE YOU DIG
DIAL BEFORE YOU DIG
SHOULD BE CONTACTED PRIOR TO ANY EXCAVATION ON SITE

- NOTES
1. SPOT LEVELS SHOWN THUS: 25.15
 2. CONTOURS SHOWN THUS: 36.5
 3. CONTOUR INTERVAL 0.5 METRE
 4. SIGNIFICANT TREES SHOWN THUS:
 5. BOUNDARY INFORMATION HAS BEEN COMPILED FROM INFORMATION SHOWN ON PLANS ON PUBLIC RECORD AT THE N.S.W. LAND REGISTRY SERVICES.
 6. BOUNDARIES PLOTTED ARE ACCURATE FOR D.A. PURPOSES. BOUNDARIES SHOULD BE MARKED ON THE GROUND PRIOR TO ANY FURTHER DEVELOPMENT OF THE LAND.
 7. TREES IN STAND OF SHE-OAKS ARE INDICATIVE ONLY. ONLY TREES AT THE ENDS OF EACH ROW HAVE BEEN LOCATED ACCURATELY.
- THE SPREAD OF EACH TREE IS INDICATIVE ONLY AND CANNOT BE SHOWN ACCURATELY WITHOUT VERY DETAILED FURTHER SURVEY. THE SHAPE AND SIZE OF SPREAD OF THE TREE MAY VARY DUE TO LACK OF UNIFORMITY OF THE BRANCHES, TRUNK AND OTHER REASONS.

DATE	REVISIONS	BY

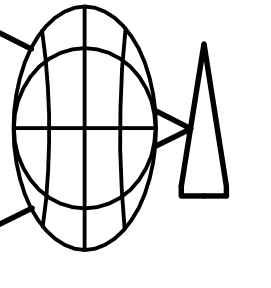

YSCO GEOMATICS
LAND RESOURCE CONSULTANTS
GEO-MATIC ENGINEERING
LAND & ENGINEERING SURVEYING
PROJECT MANAGEMENT
SOIL AND WATER MANAGEMENT
ENVIRONMENTAL PLANNING & DESIGN

SUITE 4, 7th HAMPDEN ROAD, APT. 4000, 2064
PH: (02) 94392222 FAX: (02) 94394782
Website: www.ysco.com.au
VOLUME SURVEYING & CONVEYANCE PT. 120. K.M. 002 819 866

PLAN SHOWING DETAIL & LEVELS OVER LAND AT NEPEAN CREATIVE & PERFORMING ARTS HIGH SCHOOL, 115-119 GREAT WESTERN HIGHWAY, EMU PLAINS, BEING LOT 12 IN DP 1056135 IN PENRITH L.G.A.	DRAWN: 13TH JANUARY 2020	CHECKED: P.Y.	SCALE: 1:200 @ A1	DATUM: A.H.D.	REFERENCE: 6719/2
---	--------------------------------	------------------	-------------------------	------------------	----------------------