

46-66 O'Connell Street Subdivision, CADDENS, NSW

LANDSCAPE DOCUMENTATION FOR DEVELOPMENT APPLICATION

Drawing Register

Dwg No.	Drawing Name
LDA-00	Cover Sheet
LDA-01	Streetscape Masterplan & Tree Schedule
LDA-02	Streetscape Sections & Tree Imagery
LDA-03	Park Concept Plan
LDA-04	Park Concept Section & Design Imagery
LDA-05	Park Plant Schedule and Imagery
LDA-06	Bioretention Basin Section & Plant schedule
LDA-07	Specifications & Typical Landscape Details



IMAGE TAKEN FROM NEARMAP 2020



Site Plan

Drawing Title:
Cover Sheet
DWG No:

LDA-00

GEOSCAPES
LANDSCAPE ARCHITECTS
Suite 215, 284 Victoria Ave, Chatswood NSW 2067 Ph. (02) 9411 1485
www.geoscapes.com.au
ABN 84 620 205 781 ACN 620 205 781

Architect:
PBD | ARCHITECTS

Client:
VANTAGER

Scale: 1:1000 @ A1
1:2000 @ A3
Date: 05.08.20
Job Number: 191113
Project: 46-66 O'Connell St Subdivision
CADDENS, NSW

Revision		FOR DEVELOPMENT APPLICATION			
Rev	Date	Description	Drawn	Checked	
A	31.07.20	DRAFT FOR REVIEW	SB	BG	
B	05.08.20	FOR DA	SB	BG	



LEGEND

STAGE 1 BOUNDARY

PROPOSED TURF VERGE

STAGE 2 BOUNDARY

PROPOSED FOOTPATH IN VERGE

STAGE 3 BOUNDARY

PROPOSED RESIDENTIAL LOT SUBDIVISION

STAGE 4 BOUNDARY

PROPOSED B2 ZONE FOR FUTURE COMMERCIAL USE

T01

PROPOSED STREET TREES. REFER TO TREE SCHEDULE.

PROPOSED BIORETENTION BASIN. REFER TO CIVIL DRAWINGS.

PROPOSED ROAD. REFER TO CIVIL DRAWINGS.

Street Trees Schedule					
Tree Code	Botanical Name	Common Name	Mature Height	Spacing*	Pot Size
T01	<i>Eucalyptus crebra</i>	Narrow-leaved Ironbark	25m	As Shown	75L
T02	<i>Corymbia maculata</i>	Spotted Gum	25-45m	As Shown	75L
T03	<i>Angophora subvelutina</i>	Broad leaved Apple	12m	As Shown	110ML
T04	<i>Acacia implexa</i>	Hickory Wattle	5-8m	As Shown	110ML
T05	<i>Eucalyptus moluccana</i>	Grey Box	25m	As Shown	100L
T06	<i>Eucalyptus fibrosa</i>	Red Ironbark	35-40m	As Shown	45L
T07	<i>Eucalyptus amplifolia</i>	Cabbage Gum	30-35m	As Shown	75L
T08	<i>Eucalyptus tereticornis</i>	Forest Red Gum	30m	As Shown	75L
* Final tree positioning to be determined at CC stage					

Drawing Title:

Streetscape Masterplan and Tree Schedule

DWG No:

LDA-01

GEOSCAPES
LANDSCAPE ARCHITECTS

Suite 215, 284 Victoria Ave, Chatswood NSW 2067 Ph. (02) 9411 1485
www.geoscapes.com.au
ABN 84 620 205 781 ACN 620 205 781

Architect:

PBD | ARCHITECTS

Client:

VANTAGER

Scale: 1:750 @ A1
1:1500 @ A3

Date: 05.08.20

Job Number: 191113

North:

Project: 46-66 O'Connell St Subdivision
CADDENS, NSW

Revision		FOR DEVELOPMENT APPLICATION			
Rev	Date	Description	Drawn	Checked	
A	31.07.20	DRAFT FOR REVIEW	SB	BG	
B	05.08.20	FOR DA	SB	BG	

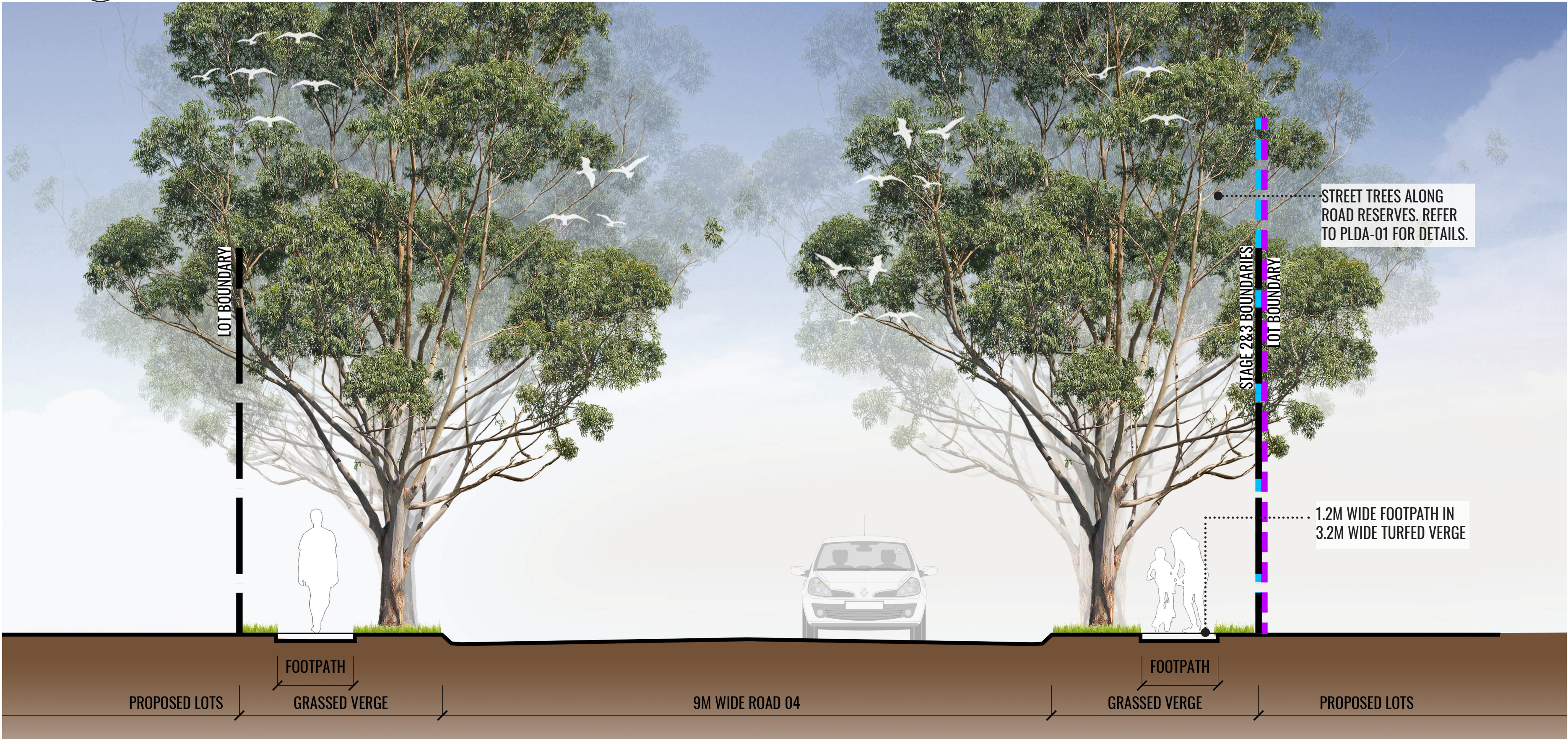
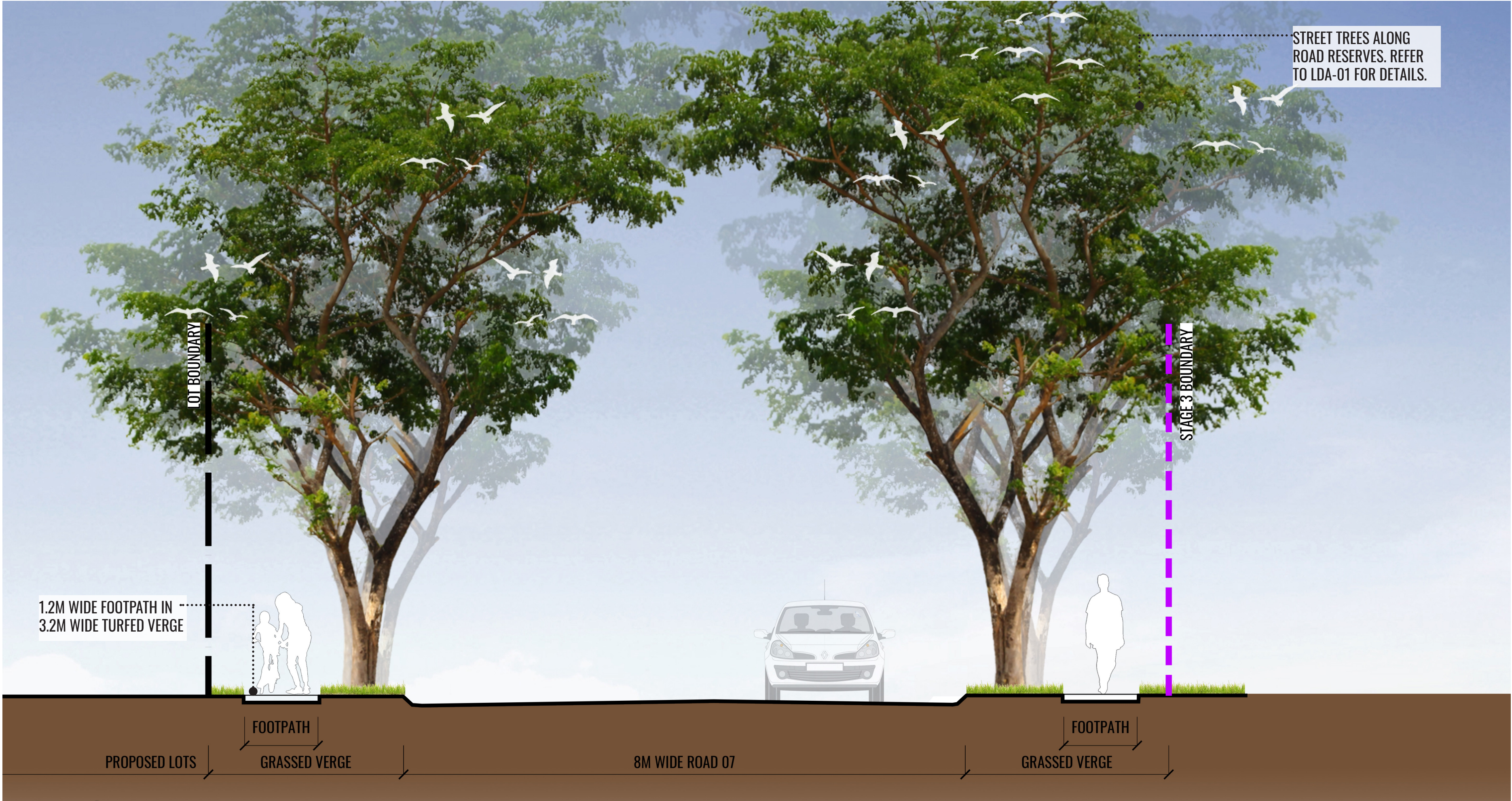

STREET TREE IMAGERY



T01: Eucalyptus crebra



T02: Corymbia maculata



T03: Angophora subvelutina

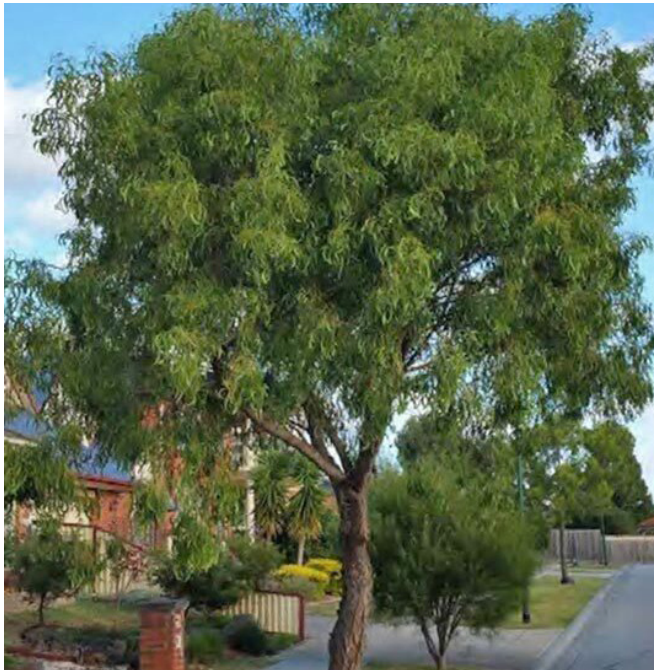

T04: Acacia implexa



T05: Eucalyptus moluccana



T06: Eucalyptus fibrosa



T07: Eucalyptus amplifolia



T08: Eucalyptus paniculata



T09: Eucalyptus tereticornis



Drawing Title:
Streetscape Sections & Tree Imagery
DWG No:

LDA-02

GEOSCAPES
LANDSCAPE ARCHITECTS
Suite 215, 284 Victoria Ave, Chatswood NSW 2067 Ph. (02) 9411 1485
www.geoscapes.com.au
ABN 84 620 205 781 ACN 620 205 781

Architect:
PBD | ARCHITECTS

Client:
VANTAGER

Scale:	Date:	Job Number:	North:	Revision					FOR DEVELOPMENT APPLICATION	
1:50 @ A1	05.08.20	191113		Rev	Date	Description	Drawn	Checked		
1:100 @ A3				A	31.07.20	DRAFT FOR REVIEW			SB	BG
				B	05.08.20	FOR DA			SB	BG
Project:	46-66 O'Connell St Subdivision									
	CADDENS, NSW									

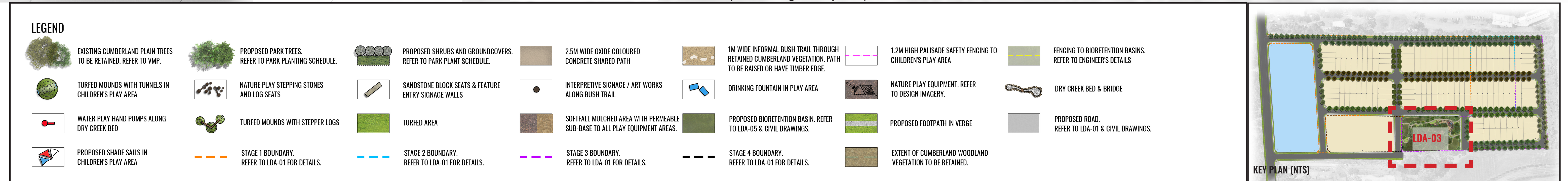
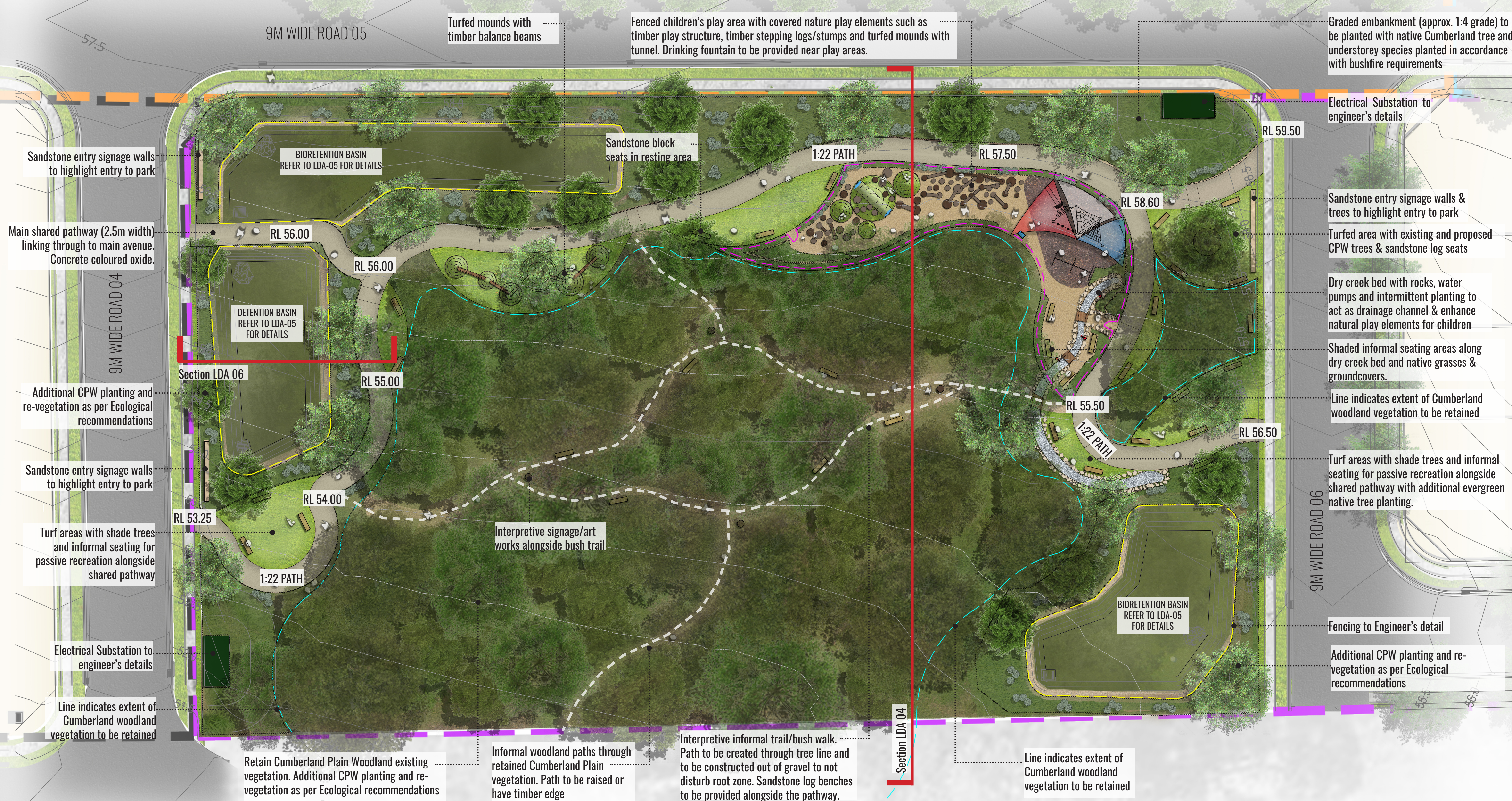

Drawing Title:
Park Concept Plan

DWG No:
LDA-03

GEOSCAPHES
LANDSCAPE ARCHITECTS
Suite 215, 284 Victoria Ave, Chatswood NSW 2067 Ph. (02) 9411 1485
www.geoscapes.com.au
ABN 84 620 205 781 ACN 620 205 781

Architect:
PBD | ARCHITECTS

Client:
VANTAGER

Scale:
1:200 @ A1
1:400 @ A3

Date:
05.08.20

Job Number:
191113

North:
North arrow pointing up

Project:
46-66 O'Connell St Subdivision
CADDENS, NSW

Revision		FOR DEVELOPMENT APPLICATION		
Rev	Date	Description	Drawn	Checked
A	31.07.20	DRAFT FOR REVIEW	SB	BG
B	05.08.20	FOR DA	SB	BG

Document Set ID: 9283958
Version: 1, Version Date: 04/09/2020



SECTION THROUGH PARK
SCALE 1:100@ A1

DESIGN IMAGERY

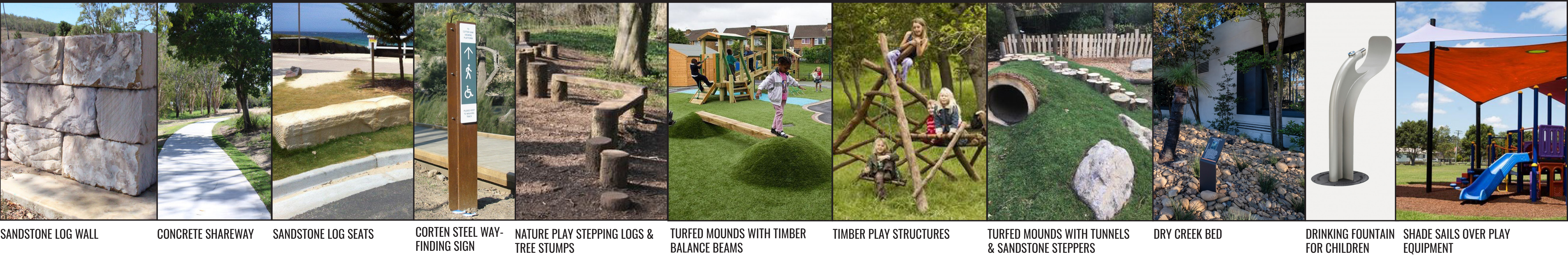

Drawing Title:
Park Concept Section & Design Imagery
DWG No:
LDA-04

GEOSCAPES
LANDSCAPE ARCHITECTS
Suite 215, 284 Victoria Ave, Chatswood NSW 2067 Ph. (02) 9411 1485
www.geoscapes.com.au
ABN 84 620 205 781 ACN 620 205 781

Architect:
PBD | ARCHITECTS

Client:
VANTAGER

Scale:
1:100 @ A1
1:200 @ A3
Date:
05.08.20
Job Number:
191113
North:
Project:
46-66 O'Connell St Subdivision
CADDENS, NSW

Revision		FOR DEVELOPMENT APPLICATION			
Rev	Date	Description	Drawn	Checked	
A	31.07.20	DRAFT FOR REVIEW	SB	BG	
B	05.08.20	FOR DA	SB	BG	

INDICATIVE PLANTING SCHEDULES

Indicative Park Planting Schedule				
Botanical Name	Common Name	Mature Height	Spacing	Pot Size
Trees				
<i>Acacia implexa</i>	Lightwood	8m	*	75L
<i>Angophora bakeri</i>	Narrow Leaf Apple	10m	*	75L
<i>Backhousia myrtifolia</i>	Grey Myrtle	7m	*	75L
<i>Corymbia maculata</i>	Spotted Gum	30m	*	75L
<i>Exocarpus cuppressiformis</i>	Cherry Ballarat	8m	*	75L
<i>Eucalyptus punctata</i>	Grey Gum	25m	*	75L
<i>Melaleuca decora</i>	White Feather Honeymyrtle	6m	*	75L
<i>Syncarpia glomulifera</i>	Turpentine Tree	30m	*	75L
Shrubs				
<i>Acacia cognata</i> 'Limelight'	Blackthorn	0.5m	*	200mm
<i>Bursaria spinosa</i>	Blackthorn	3m	*	200mm
<i>Callistemon</i> 'Better John'	Dwarf Bottlebrush	0.6-1.2m	*	200mm
<i>Correa alba</i>	Native Fuschia	1m	*	200mm
<i>Doryanthes excelsa</i>	Gymea lily	2m	*	200mm
<i>Goodenia ovata</i>	Hop Goodenia	1-2.5m	*	200mm
<i>Grevillea juniperina</i>	Juniper-leafed Grevillea	0.25-2m	*	200mm
<i>Indigofera australis</i>	Australian Indigo	2m	*	200mm
<i>Ozothamnus diosmifolius</i>	Rice Flower	2m	*	200mm
<i>Callistemon</i> 'Reeve's Pink'	Pink Bottlebrush	3m	*	200mm
<i>Westringia fruticosa</i>	Coastal Rosemary	1.2m	*	200mm
Grasses + Groundcover				
<i>Arthropodium milleflorum</i>	Pale Vanilla Lilly	1.3m	5/m2	Tubestock
<i>Brachyscome multifida</i>	Native Daisy	0.3m	3/m2	140mm
<i>Dianella revoluta</i>	Native Flax Lily	0.6m	5/m2	Tubestock
<i>Dianella longifolia</i>	Flax Lily	0.5m	5/m2	Tubestock
<i>Goodenia hederacea</i>	Violet Leaved Goodenia	0.3m	3/m2	140mm
<i>Grevillea</i> 'Cherry Cluster'	Grevillea	0.5m	4/m2	140mm
<i>Hibbertia diffusa</i>	Wild Guinea Flower	0.3m	*	200mm
<i>Hardenbergia violacea</i>	Purple Coral-pea	0.3m	4/m2	140mm
<i>Lomandra longifolia</i>	Spiny Mat-Rush	0.6m	5/m2	Tubestock
<i>Myoporum parvifolium</i>	Creeping boobialla	0.3m	3/m2	140mm
<i>Poa labillardieri</i>	Tussock Grass	0.6m	5/m2	Tubestock
<i>Pennisetum alopecuroides</i> 'Nafray'	Nafray Fountain Grass	0.6m	5/m2	Tubestock
<i>Scaevola aemula</i>	Fan flower	0.4m	3/m2	140mm
<i>Themeda australis</i>	Kangaroo Grass	0.5m	4/m2	Tubestock
* Final plant positioning to be determined at CC stage				

PLANT IMAGERY



Acacia implexa



Backhousia myrtifolia



Melaleuca decora



Exocarpus cuppressiformis



Acacia cognata ‘ Limelight’



Ozothamnus diosmifolius



Grevillea juniperina



Westringia fruticosa



Doryanthes excelsa



Poa labillardieri



Dianella revoluta



Arthropodium milleflorum



Hardenbergia violacea



Myoporum parvifolium



Brachyscome multifida



Lomandra longifolia

Drawing Title:
Park Plant Schedule & Imagery
DWG No:
LDA-05

GEOSCAPHES

LANDSCAPE ARCHITECTS

Suite 215, 284 Victoria Ave, Chatswood NSW 2067 Ph. (02) 9411 1485
www.geoscapes.com.au
ABN 84 620 205 781 ACN 620 205 781

Architect:

PBD

ARCHITECTS

Client:

VANTAGER

Scale:	Date:	Job Number:	North:	Revision				
				FOR DEVELOPMENT APPLICATION				
Rev	Date	Description	Drawn	Checked				
A	31.07.20	DRAFT FOR REVIEW	SB	BG				
B	05.08.20	FOR DA	SB	BG				
Project:		46-66 O'Connell St Subdivision			CADDENS, NSW			

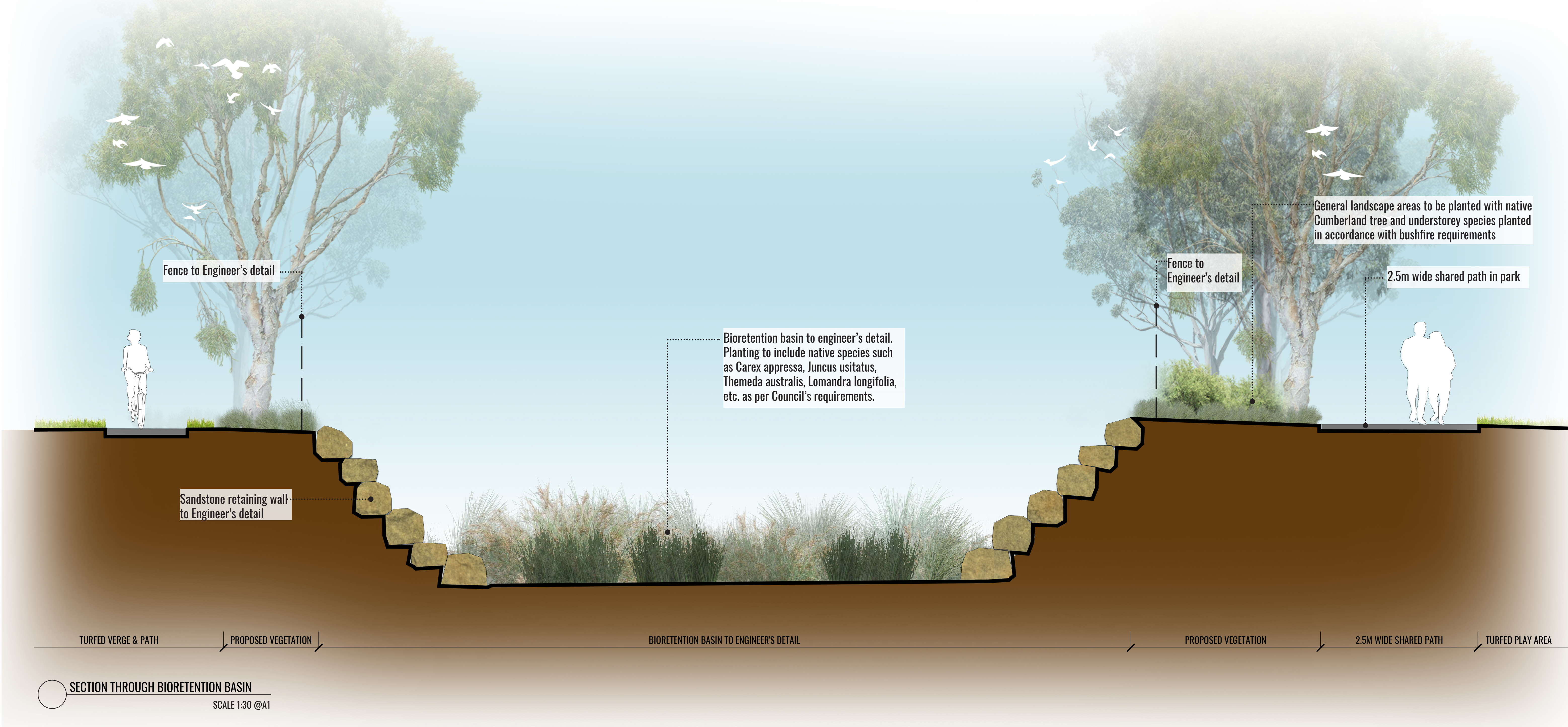

INDICATIVE BASIN PLANTING SCHEDULE

Bioretention Basin Schedule				
Botanical Name	Common Name	Mature Height	Spacing	Pot Size
Grasses & Sedges				
Carex appressa	Tussock Sedge	1.2m	8/m2	Tubestock
Dianella caerulea	Blue-Flax Lily	1m	8/m2	Tubestock
Ficinia nodosa	Knobby Club Rush	0.8m	8/m2	Tubestock
Imperta cylindrica	Blady Grass	0.7m	8/m2	Tubestock
Juncus usitatus	Soft Rush	1m	8/m2	Tubestock
Lomandra longifolia	Spiny Headed Mat-rush	1.2m	8/m2	Tubestock
Poa siebreiana	Grey Tussock Grass	0.6m	8/m2	Tubestock
Themeda australis	Kangaroo Grass	1.5m	8/m2	Tubestock

* Final plant positioning to be determined at CC stage

BASIN PLANTING IMAGERY



Carex appressa



Dianella caerulea



Ficinia nodosa



Imperta cylindrica



Juncus usitatus



Lomandra longifolia



Poa siebreiana

Drawing Title:
Bioretention Basin Section & Schedule
DWG No:

LDA-06

GEOSCAPHES
LANDSCAPE ARCHITECTS
Suite 215, 284 Victoria Ave, Chatswood NSW 2067 Ph. (02) 9411 1485
www.geoscapes.com.au
ABN 84 620 205 781 ACN 620 205 781

Architect:
PBD | ARCHITECTS

Client:
VANTAGER

Scale:	Date:	Job Number:	North:	Revision				
				Rev	Date	Description	Drawn	Checked
Project:	46-66 O'Connell St Subdivision CADDENS, NSW	191113		A	31.07.20	DRAFT FOR REVIEW	SB	BG
				B	05.08.20	FOR DA	SB	BG

TYPICAL SPECIFICATIONS

Maintenance shall mean the care and maintenance of the landscape works by accepted horticultural practice as rectifying any defects that become apparent in the landscape works under normal use. The landscape contractor shall attend the site on a **weekly basis** to maintain the landscape works commencing from practical completion.

Rubbish Removal

The Landscape Contractor shall undertake rubbish removal from the site on a **weekly basis** to ensure the site remains in tidy condition.

Weed Eradication

Weed growth that may occur in grassed, planted or mulched areas is to be removed using environmentally acceptable methods i.e. non-residual glyphosate herbicide (e.g. ‘Roundup’, applied in accordance with the manufacturer’s direction.

Tree Replacement

Trees shall show signs of healthy vigorous growth and be free from disease and not exhibit signs of stress prior to handover to the client. Any trees or plant that die or fail to thrive, or are damaged or stolen will be replaced. Replacement material shall have the initial maintenance period extended in accordance with the landscape contract conditions. Trees and plant materials shall be equal to the minimum requirements of species specified and approved material delivered to site. Should the condition decline from the approved sample the Superintendent reserves the right to reject the tree / plants. Frequency: as required.

Stakes

Adjust and/or replace stakes and ties where required. Remove staking and guying when instructed by the Superintendent

Pruning

Selective pruning may be required during the establishment period to promote a balanced canopy structure. These activities shall be carried out to the best horticultural and industry practice. All pruned material is to be removed from site.

Mulched Surfaces

All planter beds and garden areas shall have a minimum depth of 75mm organic mulch. All mulch is to be free of deleterious matter such as soil, weeds, sticks and should conform to AS 4454. Mulched surfaces are to be kept clean and tidy and free of any deleterious material and foreign matter. Reinstate depths to a uniform level of 75mm with mulch as specified, mulch to be free of any wood material impregnated with CCA or similar toxic treatment. Top up mulch levels prior to handover to client & estate management.

Watering

Implement an appropriate hand watering regime in areas not irrigated in association with current watering programme to maintain plant health and vigour. The program shall reflect seasonal conditions and plant species. Frequency: Weekly or as required.

Soil In Natural Ground

Non-Australian native garden beds to have soil installed consisting of 50% existing site topsoil and 50% new topsoil equal or equivalent to ‘Organic Garden Mix’ as supplied by Australian Native Landscapes. Australian native garden beds to have soil installed consisting of 50% existing site topsoil and 50% new topsoil equal or equivalent to ‘Native Low ‘P’ Mix’ as supplied by Australian Native Landscapes. Soil to conform to AS4419 refer to typical detail.

Pest and Disease Control

The Landscape Contractor shall spray for pests and disease infestations when the pest and fungal attack has been positively identified and when their populations have increased to a point that will become detrimental to plant growth. Apply all pesticides to manufacturer’s directions. Frequency: weekly inspection

Fertilising

Generally check for signs of nutrient deficiencies (yellowing of leaves, failure to thrive), and adapt fertiliser regime to suit. Fertiliser should be applied at the beginning and the end of the (summer) growing season.

Standards

All grown or purchased plant stock must conform to all the conditions and requirements given in NATSPEC Guide: Specifying Trees. Soils to be in accordance with AS4419, mulching composts and conditioners to be in accordance with AS4454. Soils should conform to best practice specifications as listed in the Landscape Soils Handbook (Simon Leake & Elke Haege 2017).

PLANT SCHEDULE AND TYPICAL DETAILS

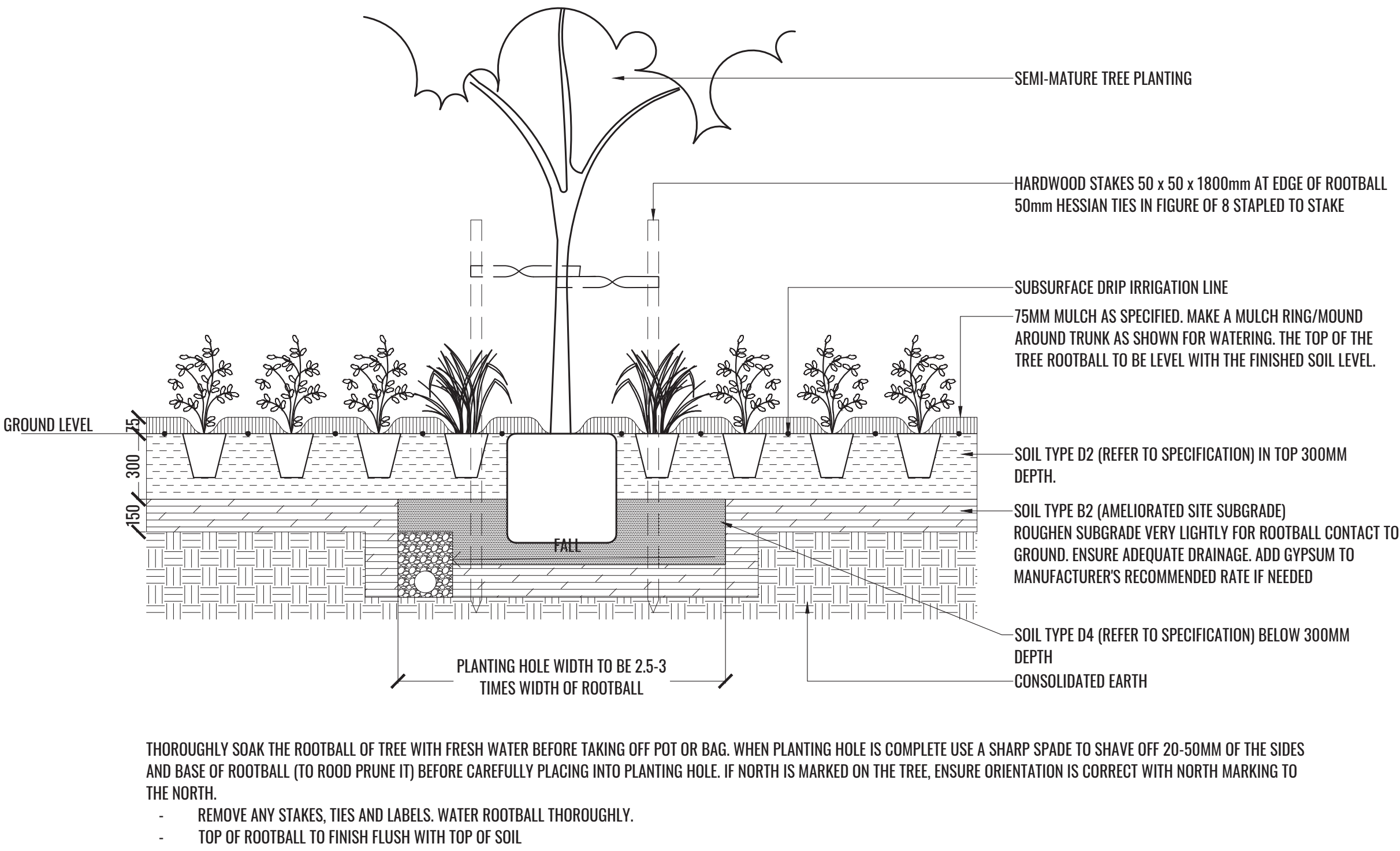

1 TYPICAL MASS PLANTING DETAIL

SCALE 1:20

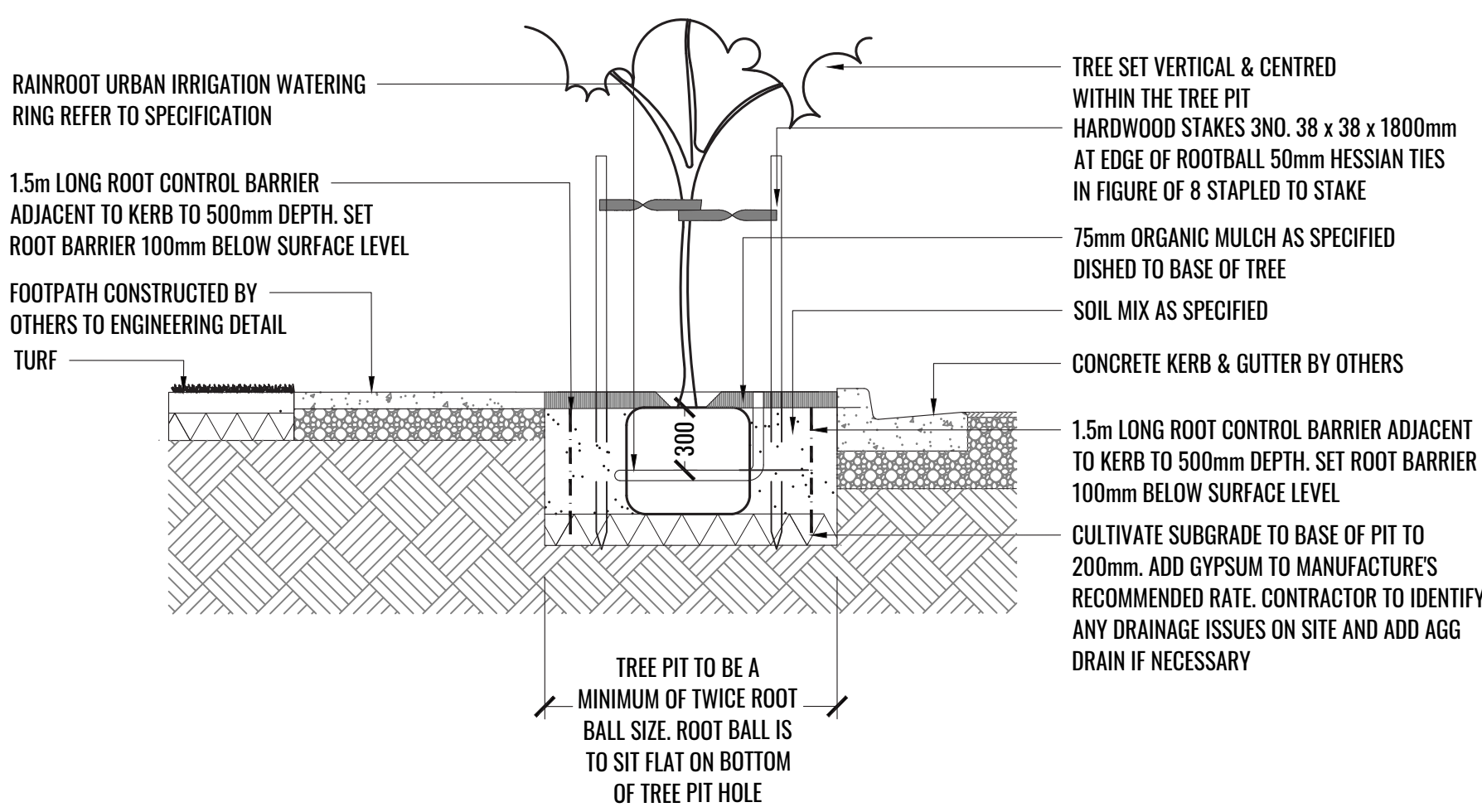
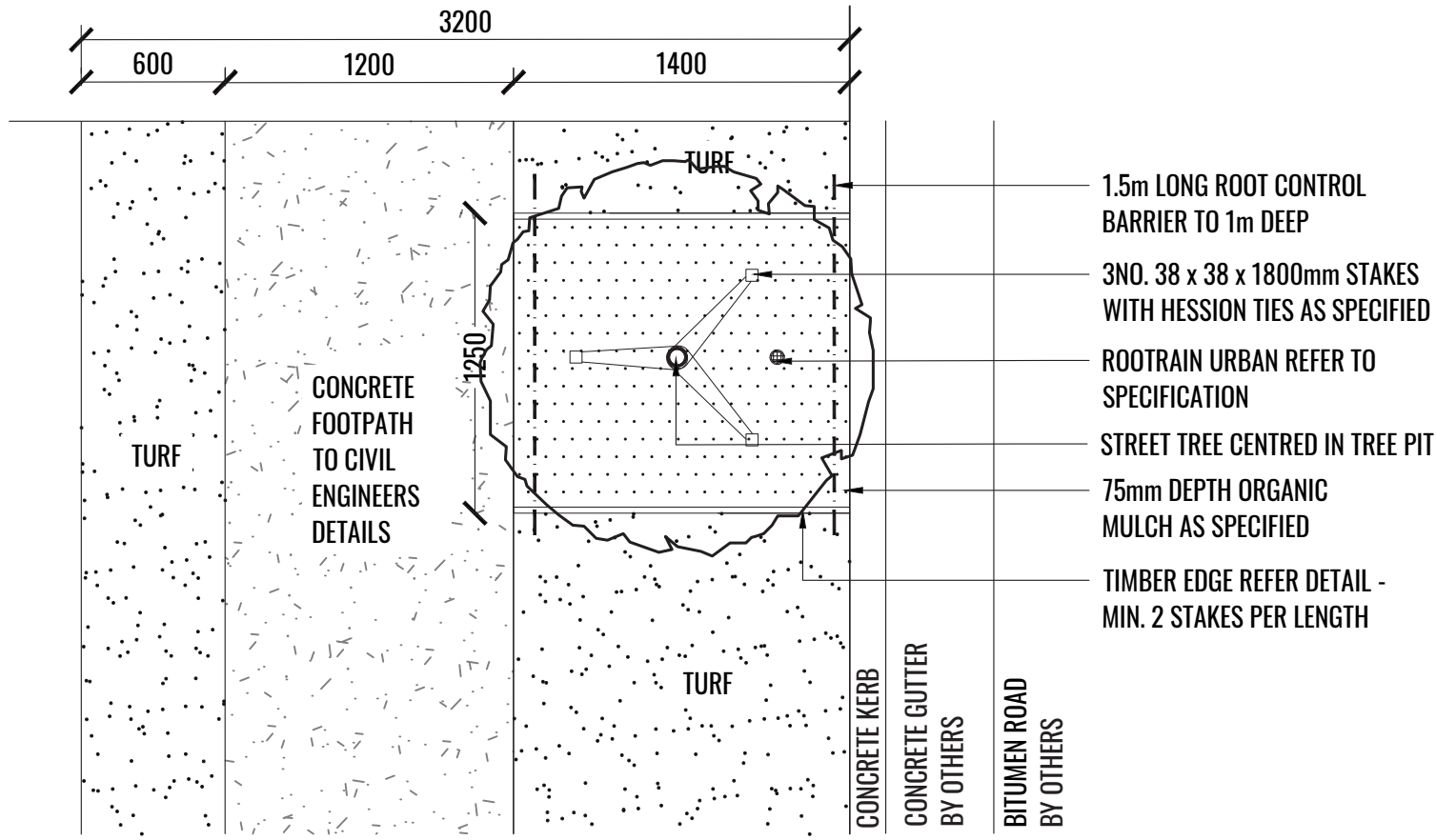

3 TUBESTOCK PLANTING ON 1 IN 3 SLOPE OR FLATTER

SCALE 1:20

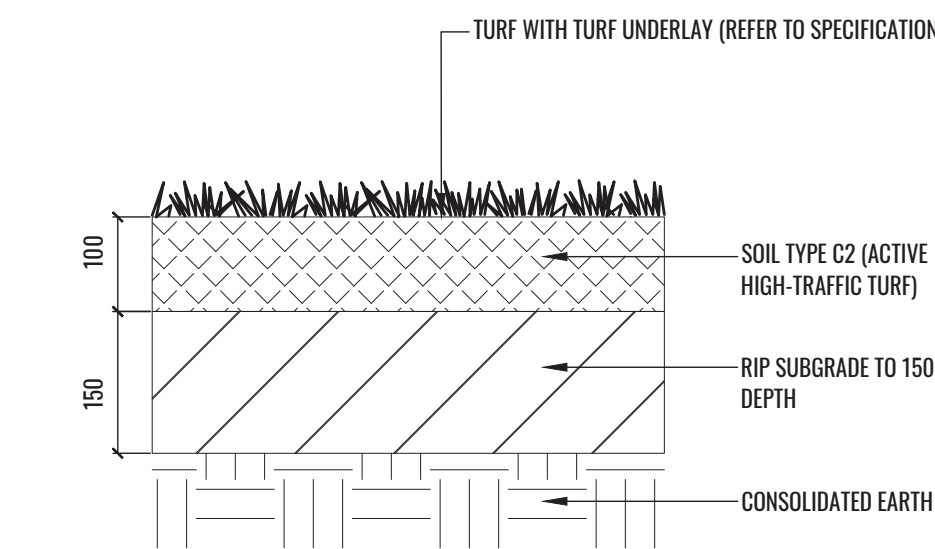

4 TYPICAL TURF DETAIL

SCALE 1:5

Drawing Title:
Specifications & Typical Landscape Details
DWG No:
LDA-07

GEOSCAPHES

LANDSCAPE ARCHITECTS

Suite 215, 284 Victoria Ave, Chatswood NSW 2067 Ph. (02) 9411 1485
www.geoscapes.com.au
ABN 84 620 205 781 ACN 620 205 781

Architect:
PBD | ARCHITECTS

Client:
VANTAGER

Scale:	Date:	Job Number:	North:	Revision						FOR DEVELOPMENT APPLICATION	
AS SHOWN @ A1	05.08.20	191113		Rev	Date	Description		Drawn		Checked	
				A	31.07.20	DRAFT FOR REVIEW		SB		BG	
				B	05.08.20	FOR DA		SB		BG	
Project:	46-66 O'Connell St Subdivision CADDENS, NSW										