

- ⊗ SEWER MANHOLE
- LIGHT POLE
- ⊓ WATER METER

MGA

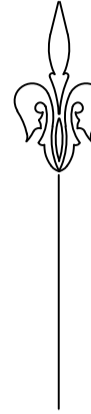

- LIP DENOTES LEVEL AT LIP OF KERB
- BK DENOTES LEVEL AT BACK OF KERB
- LIN DENOTES LEVEL AT TOP OF LINTEL
- VC DENOTES VEHICULAR CROSSING



LOCATION FROM DBYD SEARCH ONLY
 DENOTES LINE OF APPROX. SEWER LINE

DENOTES LINE OF APPROX. STORM WATER LINE

(A) - EASEMENT TO DRAIN WATER 2 WIDE

(D) - EASEMENT FOR ELECTRICITY PURPOSES 2.75 WIDE

(E) - EASEMENT FOR UNDERGROUND MAINS 1 WIDE

MGA 2020
 CO-ORDINATE ORIGIN E 296 151.478
 SSM 89170 (SCIMS) N 6 257 481.513

MGA ORIENTATION
 SSM 89170 TO SSM 89172
 188°54'19" - 351.393

NOTES:

1. THIS DETAIL SURVEY IS NOT A 'SURVEY' AS DEFINED BY THE SURVEYING & SPATIAL INFORMATION ACT, 2002.
2. DATUM OF LEVELS : AUSTRALIAN HEIGHT DATUM
3. ALL AREAS AND DIMENSIONS HAVE BEEN COMPILED FROM PLANS MADE AVAILABLE BY THE OFFICE OF LAND & PROPERTY INFORMATION (NSW) AND ARE SUBJECT TO FINAL SURVEY.
4. NO SEARCH MADE OF LOCATION AND NATURE OF TELEPHONE, ELECTRICITY, SEWER, WATER, GAS AND DRAINAGE RECORDS AT THE RELEVANT AUTHORITY. PRIOR TO ANY CONSTRUCTION THE RELEVANT AUTHORITY SHOULD BE CONTACTED FOR LOCATION OF SERVICES.
5. THE POSITION OF IMPROVEMENTS IN RELATION TO BOUNDARIES IS DIAGRAMMATIC ONLY.
6. VISIBLE, ACCESSIBLE SERVICES LOCATED ONLY
7. SIGNIFICANT TREES LOCATED ONLY.
8. NEIGHBOURING HOUSES, RIDGE AND ROOF POSITIONS ARE APPROXIMATE ONLY.
9. THIS TITLE BLOCK AND NOTES IS AN INTEGRAL PART OF THIS DRAWING WHICH IS NOT TO BE REMOVED.
10. CONTOURS ARE INDICATIVE ONLY. SPOT LEVELS SHOULD BE USED FOR CALCULATIONS OF QUANTITIES WITH CAUTION.

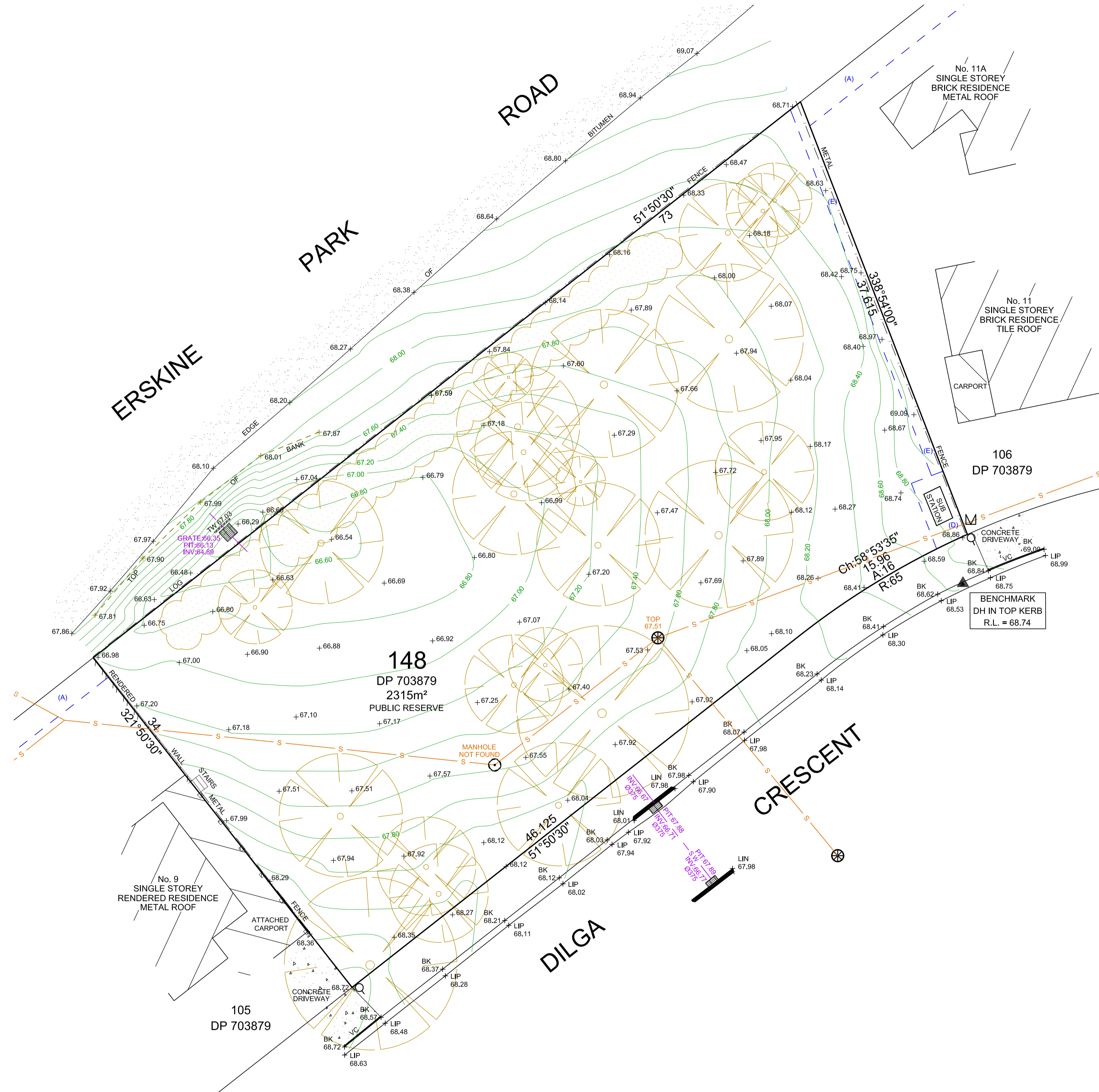
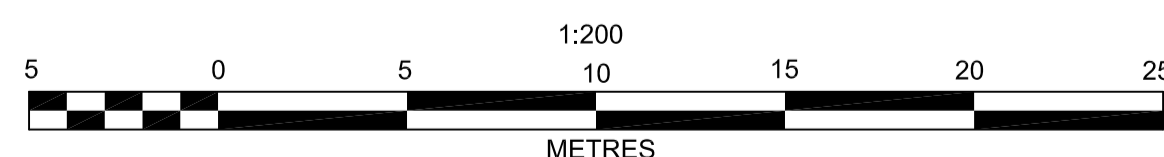

© THIS PLAN AND THE INFORMATION CONTAINED HEREIN REMAINS THE PROPERTY OF RICHARD HOGAN & CO, PTY LTD. IT MUST NOT BE COPIED IN WHOLE OR PART, AND IS NOT TO BE USED FOR ANY PURPOSE OTHER THAN FOR THAT WHICH IT HAS BEEN PREPARED, WITHOUT THE WRITTEN CONSENT OF RICHARD HOGAN & CO PTY LTD. THIS PLAN HAS BEEN PREPARED FOR THE SOLE USE OF THE INSTRUCTING PARTY.

RHCO RICHARD HOGAN & CO.
 SURVEYING & DEVELOPMENT CONSULTANTS

ABN 59 082 453 165
 P.O. BOX 4365, Penrith Plaza, NSW 2750.
 Phone: (02) 4732 8599
 Web: www.rhco.com.au Email: admin@hoganco.com.au

SURVEYOR: SW
 DRAWN: SW
 REDUCTION RATIO: 1:200 @ A1
 CONTOUR INTERVAL: 0.2m
 SHEET 1 OF 1

ORIGIN OF LEVELS:
 SSM 89172
 RL=68.665 (SCIMS)
 DATUM: AUSTRALIAN HEIGHT DATUM
 DATE: 29.07.20
 VERSION No.: A

PLAN OF DETAIL AND LEVELS OVER LOT 148 IN DP 703879 AT DILGA CRESCENT, ERSKINE PARK	
CLIENT:	PENRITH CITY COUNCIL
L.G.A.:	PENRITH
JOB REF:	20406