

Tenant Identification Pylon Signage

CASTLEREAGH ROAD

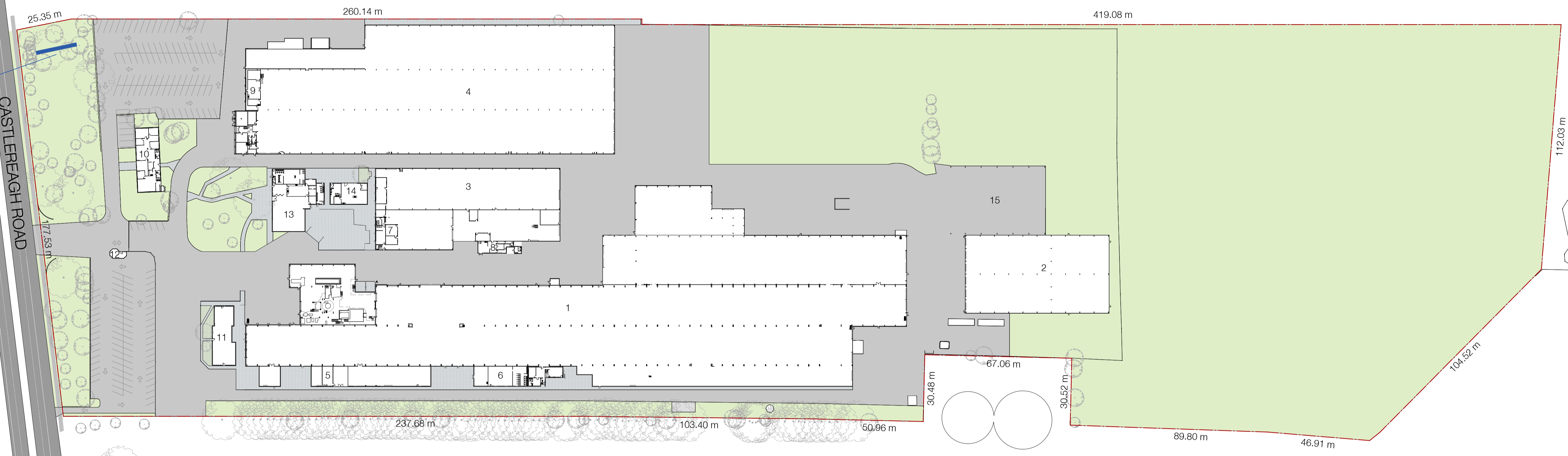

- OPEN SPACE
- ROAD
- DRIVEWAY / VEHICLE ACCESS
- SHARED/ FOOTPATH
- INDICATIVE SOLAR PANEL LOCATIONS

FOR APPROVAL

In accepting and utilising this document the recipient agrees that SJB Architecture (NSW) Pty. Ltd. ACN 081 094 724 T/A SJB Architects, retain all common law, statutory law and other rights including copyright and intellectual property rights. The recipient agrees not to use this document for any purpose other than its intended use, to waive all claims against SJB Architects resulting from unauthorised changes, or to reuse the document on other projects without prior written consent from SJB Architects. Under no circumstances shall transfer of this document be deemed a sale. SJB Architects makes no warranties of fitness for any purpose. The Builder/Contractor shall verify job dimensions prior to any work commencing. Use figured dimensions only. Do not scale drawings.

Nominated Architects: Adam Haddow-7188 | John Pradel-7004

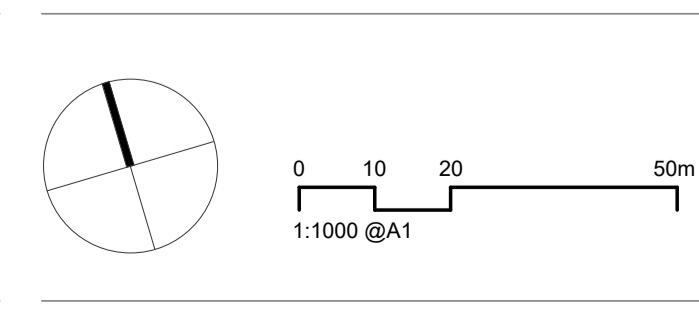

Rev	Date	Revision	By	Chk.
1	08.12.2020	For Information	TM	ML
2	17.12.2020	For Information	TM	ML
3	25.01.2021	For Information	TM	ML
4	08.02.2021	For Information	TM	ML
5	11.02.2021	For Information	TM	ML
6	18.02.2021	Development Application	TM	ML
7	24.02.2021	Updated DA Drawings	TM	ML
8	01.03.2021	Updated DA Drawings	TM	ML
9	08.03.2021	Updated DA Drawings	TM	ML
10	24.03.2021	Updated DA Drawings	TM	ML

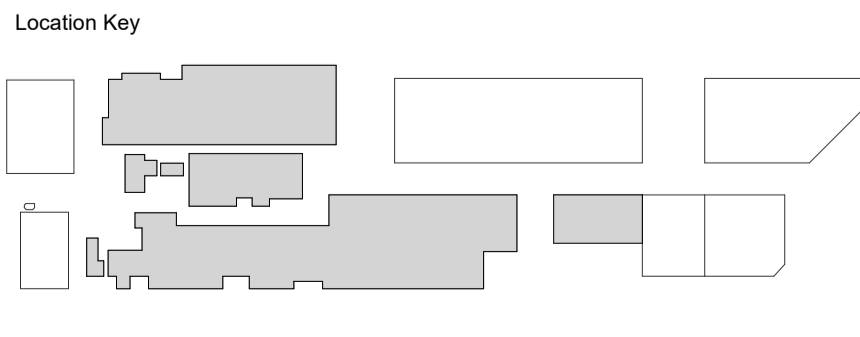

Project
Manufacturer
 2115 Castlereagh Rd,
 Penrith
 Drawing Name
SITE PLAN

Date	Scale	Sheet Size
24.03.2021	1 : 1000	@ A1
Drawn	Chk.	Job No.
TM	ML	6348
Drawing No.	Revision	
DA-0102	/ 10	

SJB Architects
 L2, 490 Crown St
 Surry Hills NSW
 2010 Australia
 T 61 2 9380 9911
 www.sjb.com.au





Digital signage content FOR APPROVAL



Project
 Manufactor 2115 Castlereagh Rd,
 Penrith
 Drawing Name
 EXISTING SITE PLAN
 HOARDING

Date
 14.09.2021
 Drawn
 TM
 Drawing No.
 DA-0102

Scale
 NOT TO SCALE
 Chk.
 ML

Sheet Size
 @ A1
 Job No.
 6348
 Revision
 / 10



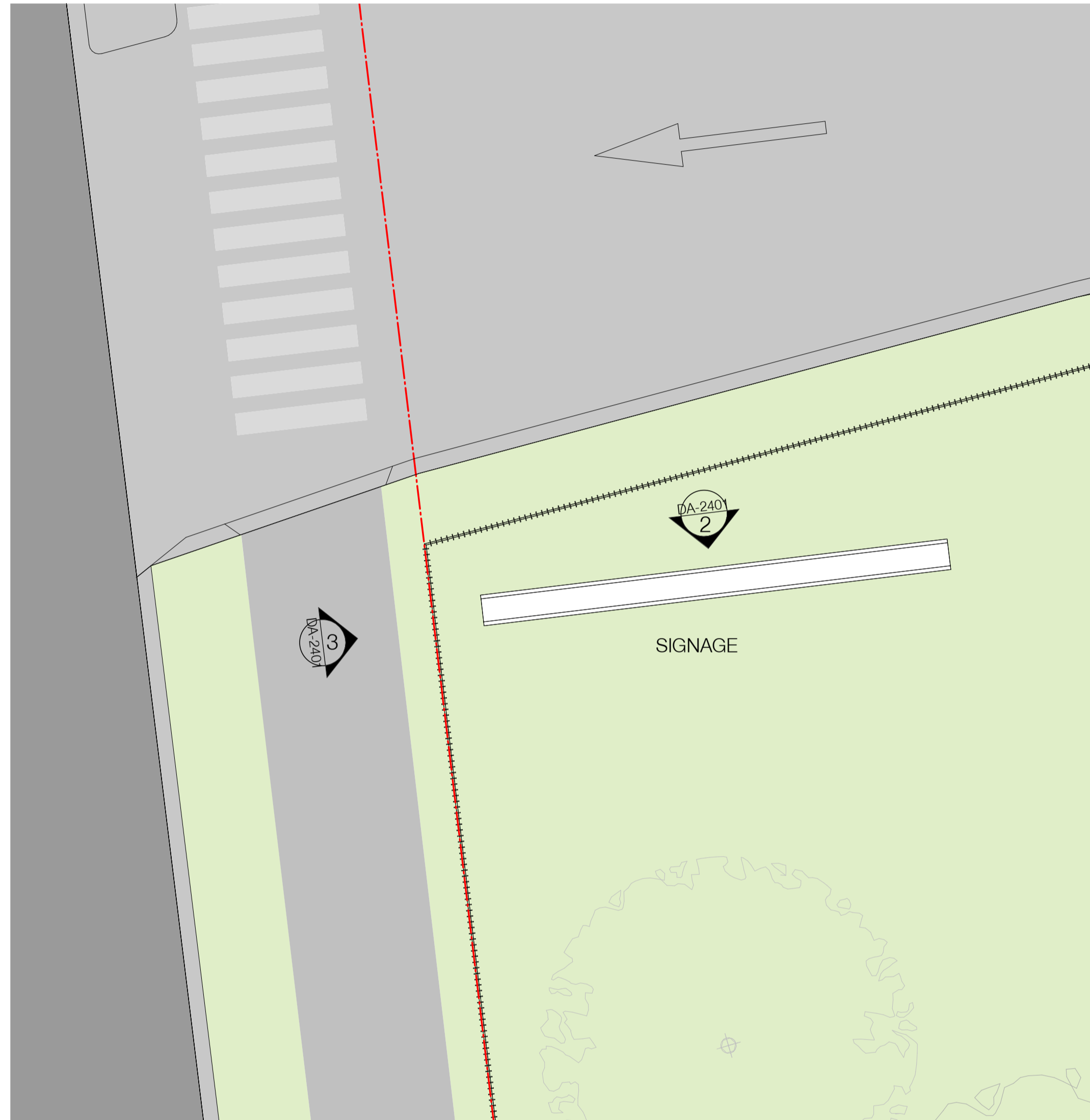

SIGNAGE PLAN

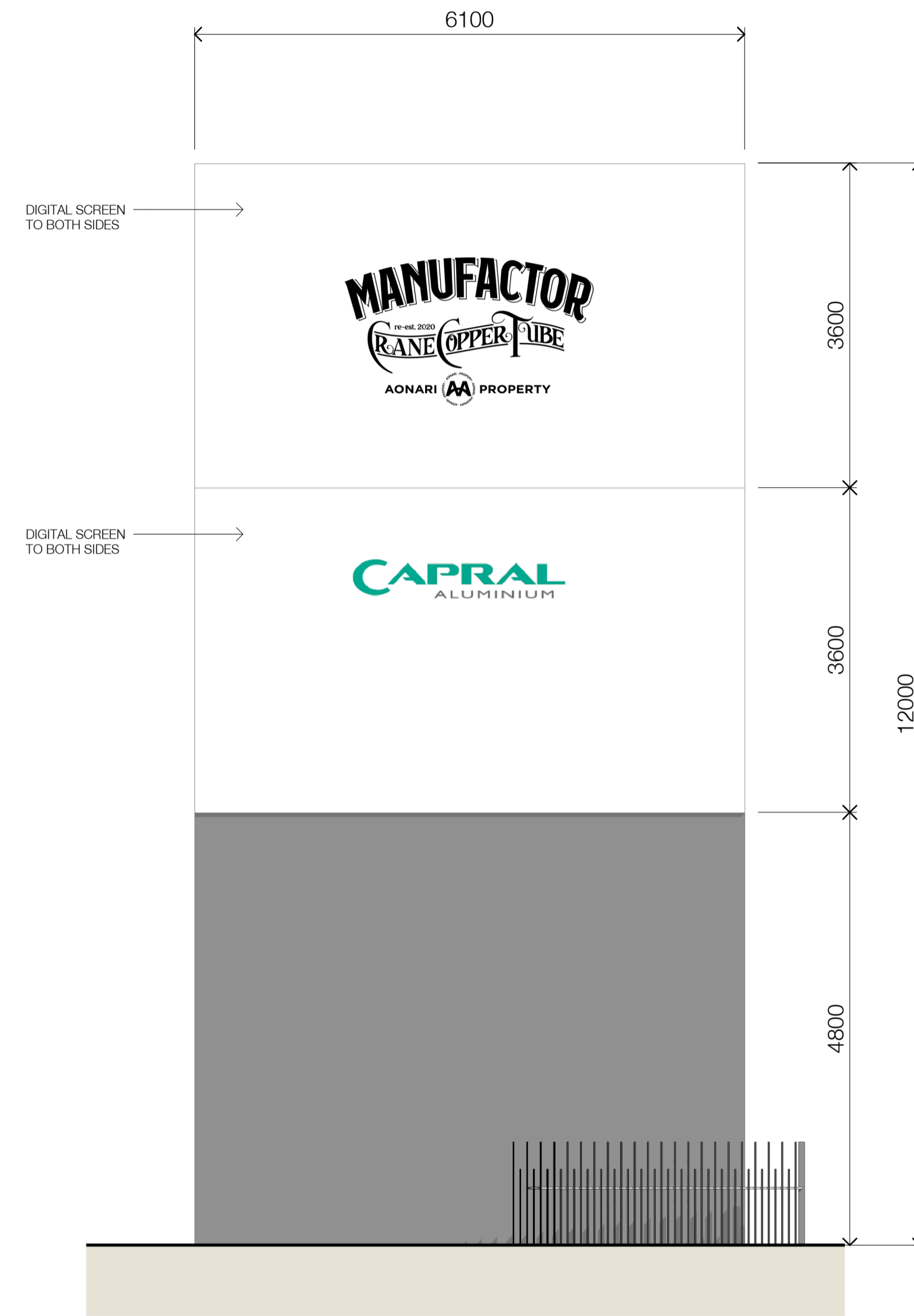

SIGNAGE - NORTH ELEVATION

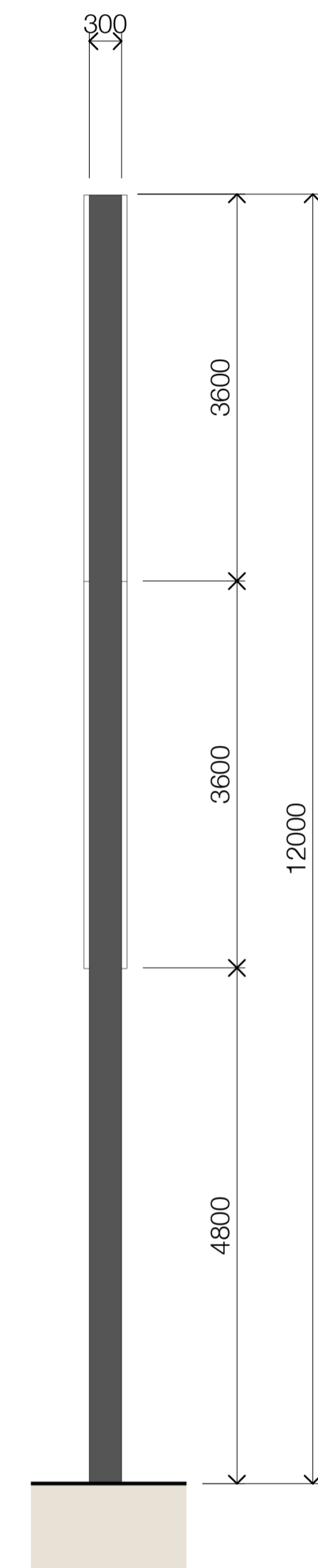

SIGNAGE - WEST ELEVATION

In accepting and utilising this document the recipient agrees that SJB Architects (NSW) Pty. Ltd. ACN 081 094 724 T/A SJB Architects, retain all common law, statutory law and other rights including copyright and intellectual property rights. The recipient agrees not to use this document for any purpose other than its intended use, to waive all claims against SJB Architects resulting from unauthorised changes, or to reuse the document on other projects without prior written consent from SJB Architects. Under no circumstances shall transfer of this document be deemed a sale. SJB Architects makes no warranties of fitness for any purpose. The Builder/Contractor shall verify job dimensions prior to any work commencing. Use figured dimensions only. Do not scale drawings.
Nominated Architects: Adam Haddow-7188 | John Pradel-7004

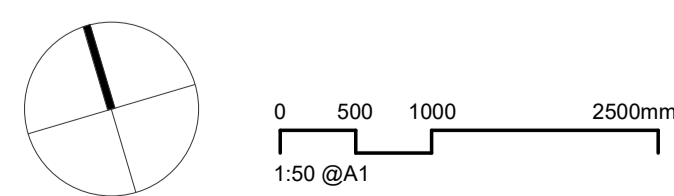

Rev	Date	Revision	By	Chk.
1	18.02.2021	For Information	TM	ML
2	18.02.2021	Development Application	TM	ML
3	24.02.2021	Updated DA Drawings	TM	ML
4	01.03.2021	Updated DA Drawings	TM	ML
5	24.03.2021	Updated DA Drawings	TM	ML

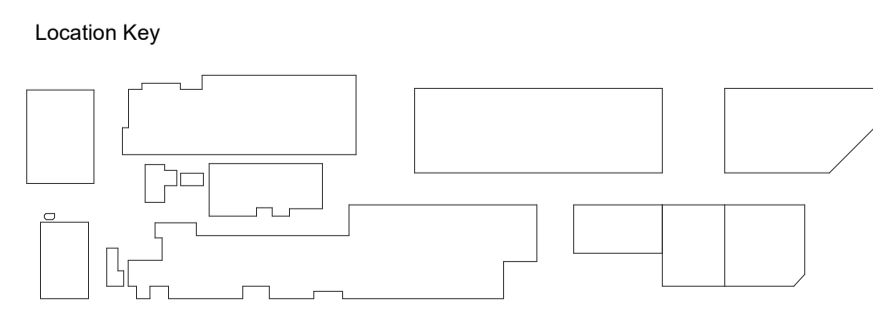

Project
Manufacturer
 2115 Castlereagh Rd,
 Penrith
 Drawing Name
SIGNAGE DETAILS

Date	Scale	Sheet Size
24.03.2021	1 : 50	@ A1
Drawn	Chk.	Job No.
TM	ML	6348
Drawing No.	Revision	
DA-2401	/ 5	

FOR APPROVAL

SJB Architects
 L2, 490 Crown St
 Surry Hills NSW
 2010 Australia
 T 61 2 9380 9911
 www.sjb.com.au



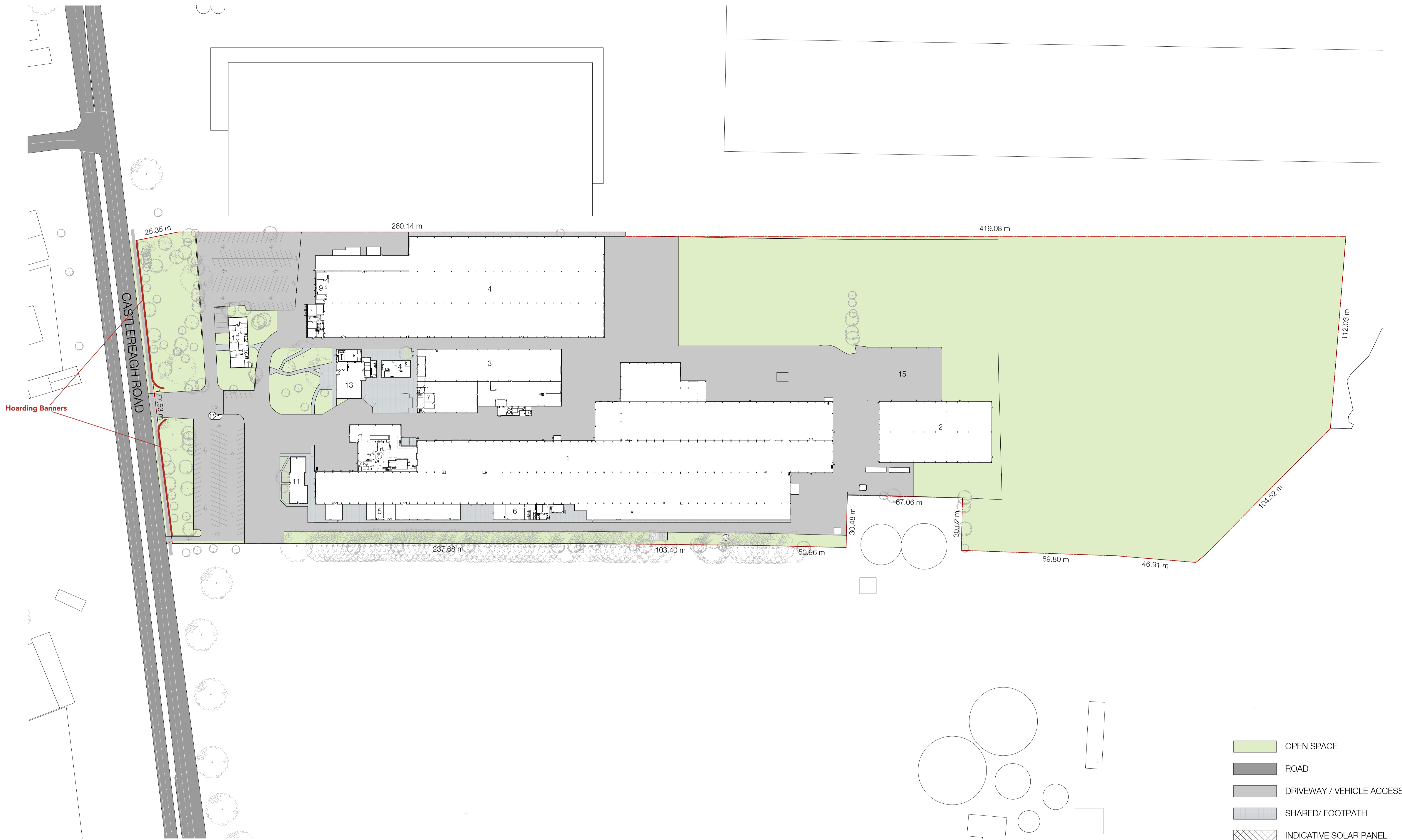

In accepting and utilising this document the recipient agrees that SJB Architects (NSW) Pty. Ltd. ACN 081 094 724 T/A SJB Architects, retain all common law, statutory law and other rights including copyright and intellectual property rights. The recipient agrees not to use this document for any purpose other than its intended use, to waive all claims against SJB Architects resulting from unauthorised changes, or to reuse the document on other projects without prior written consent from SJB Architects. Under no circumstances shall transfer of this document be deemed a sale. SJB Architects makes no warranties of fitness for any purpose. The Builder/Contractor shall verify job dimensions prior to any work commencing. Use figured dimensions only. Do not scale drawings.

Nominated Architects: Adam Haddow-7188 | John Pradel-7004

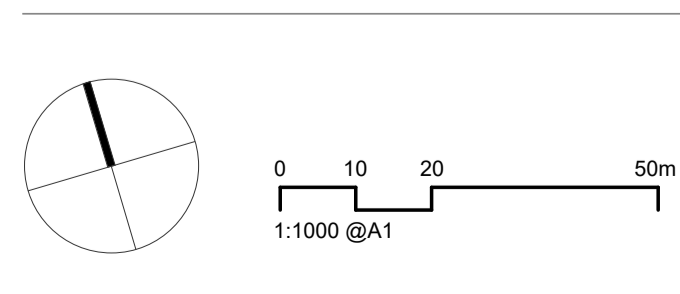

Rev	Date	Revision	By	Chk.
1	08.12.2020	For Information	TM	ML
2	17.12.2020	For Information	TM	ML
3	25.01.2021	For Information	TM	ML
4	08.02.2021	For Information	TM	ML
5	11.02.2021	For Information	TM	ML
6	18.02.2021	Development Application	TM	ML
7	24.02.2021	Updated DA Drawings	TM	ML
8	01.03.2021	Updated DA Drawings	TM	ML
9	08.03.2021	Updated DA Drawings	TM	ML
10	24.03.2021	Updated DA Drawings	TM	ML

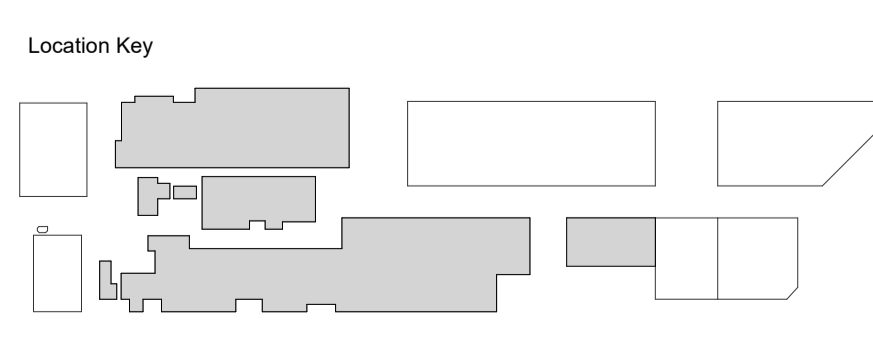

Project
Manufacturer
 2115 Castlereagh Rd,
 Penrith
 Drawing Name
EXISTING SITE PLAN

Date	Scale	Sheet Size
24.03.2021	1 : 1000	@ A1
Drawn	Chk.	Job No.
TM	ML	6348
Drawing No.	Revision	
DA-0102	/ 10	

FOR APPROVAL

SJB Architects
 L2, 490 Crown St
 Surry Hills NSW
 2010 Australia
 T 61 2 9380 9911
 www.sjb.com.au



Hoarding content mockup

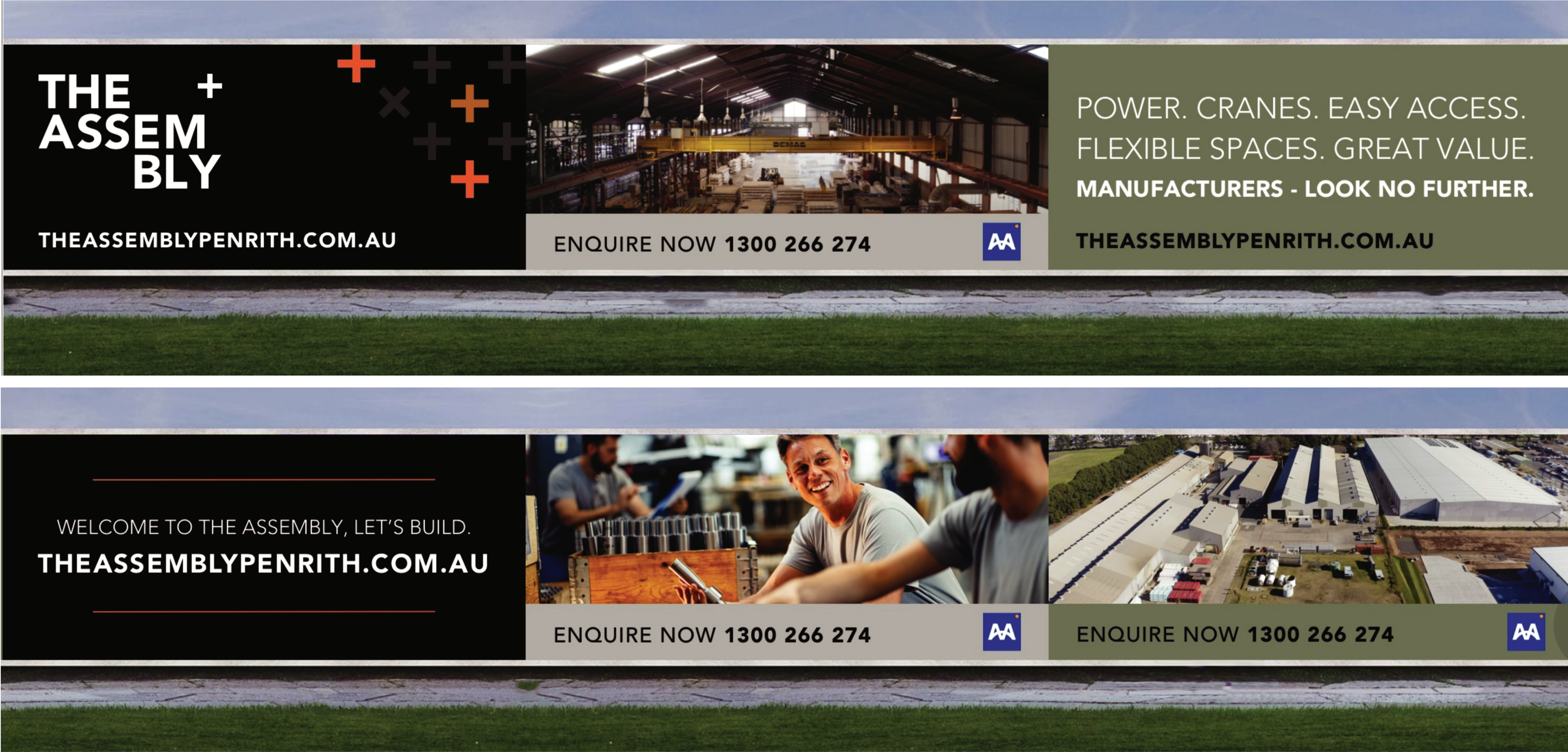

Hoarding Dimension: 135LM x 2M

FOR APPROVAL



Project	Date	Scale	Sheet Size
Manufacturer 2115 Castlereagh Rd, Penrith	14.09.2021	NOT TO SCALE	@ A1
Drawing Name	Drawn	Chk.	Job No.
EXISTING SITE PLAN HOARDING & SIGNAGE	TM	ML	6348
	Drawing No.		Revision
	DA-0102		/ 10

