



CADDENS HILL SPORTS & RECREATION PRECINCT

Landscape DA Report

Prepared for
Legacy Property

Project Reference: 2516076A
May 2017



Australia
China
South East Asia

Follow us on



placedesigngroup.com

Report title	CADDENS HILL SPORTS & REC PRECINCT
Document number	2516076A
Prepared for	Legacy Property
Authors	Steven Holmes, Jared Phillips
Revision number	C
Revision issue date	May 2017
Approved	
Reason for revision	DA Issue

Disclaimer: This report has been prepared in accordance with the scope of services described in the contract or agreement between Place Design Group Pty Ltd ACN 082 370063 and the Client. The report relies upon data, surveys, measurements and results taken at or under the particular times and conditions specified herein. Any findings, conclusions or recommendations only apply to the aforementioned circumstances and no greater reliance should be assumed or drawn by the Client. Furthermore, the report has been prepared solely for use by the Client and Place Design Group accepts no responsibility for its use by other parties.

CONTENTS

SPORTS PRECINCT MASTER PLAN	3
CIRCULATION DIAGRAM	4
SPORTS PRECINCT PLANT SCHEDULE	5
SPORTS PRECINCT PLANTING DIAGRAM	6
SPORTS PRECINCT GRADING PLAN	7
SPORTS PRECINCT - SECTION 1	8
SPORTS PRECINCT - SECTION 2 & 3	9
SPORTS PRECINCT - SECTION 4	10 - 11
SPORTS PRECINCT PLAY DETAIL	12
SPORTS PRECINCT FURNITURE	13-14
PRECEDENT IMAGES	15
MATERIALS FURNITURE & PLAY EQUIPMENT	16

SPORTS PRECINCT MASTER PLAN



LEGEND

- 01 Entrance to oval and circuit path
- 02 Timber boardwalk bridges across the drainage swale
- 03 Proposed terraced lawn ampitheatre
- 04 Vegetated sections of swale
- 05 Low height white picket fence to the perimeter of the oval
- 06 Proposed oval suitable for rugby/ soccer and cricket
- 07 Circuit path to basketball, playground and cricket net areas
- 08 Planting batter down to circuit path with sporadic tree plantings
- 09 Proposed location of change rooms
- 10 Proposed half court basket ball court
- 11 Proposed Rain Water Tank
- 12 Proposed Playground with softfall rubber surface
- 13 Proposed light pole locations
- 14 Proposed surface car parking (56 spaces)
- 15 Proposed basin maintenance access path
- 16 Iconic Norfolk Island Pines
- 17 Proposed cricket nets
- 18 Proposed bicycle parking (20 spaces)



CIRCULATION DIAGRAM

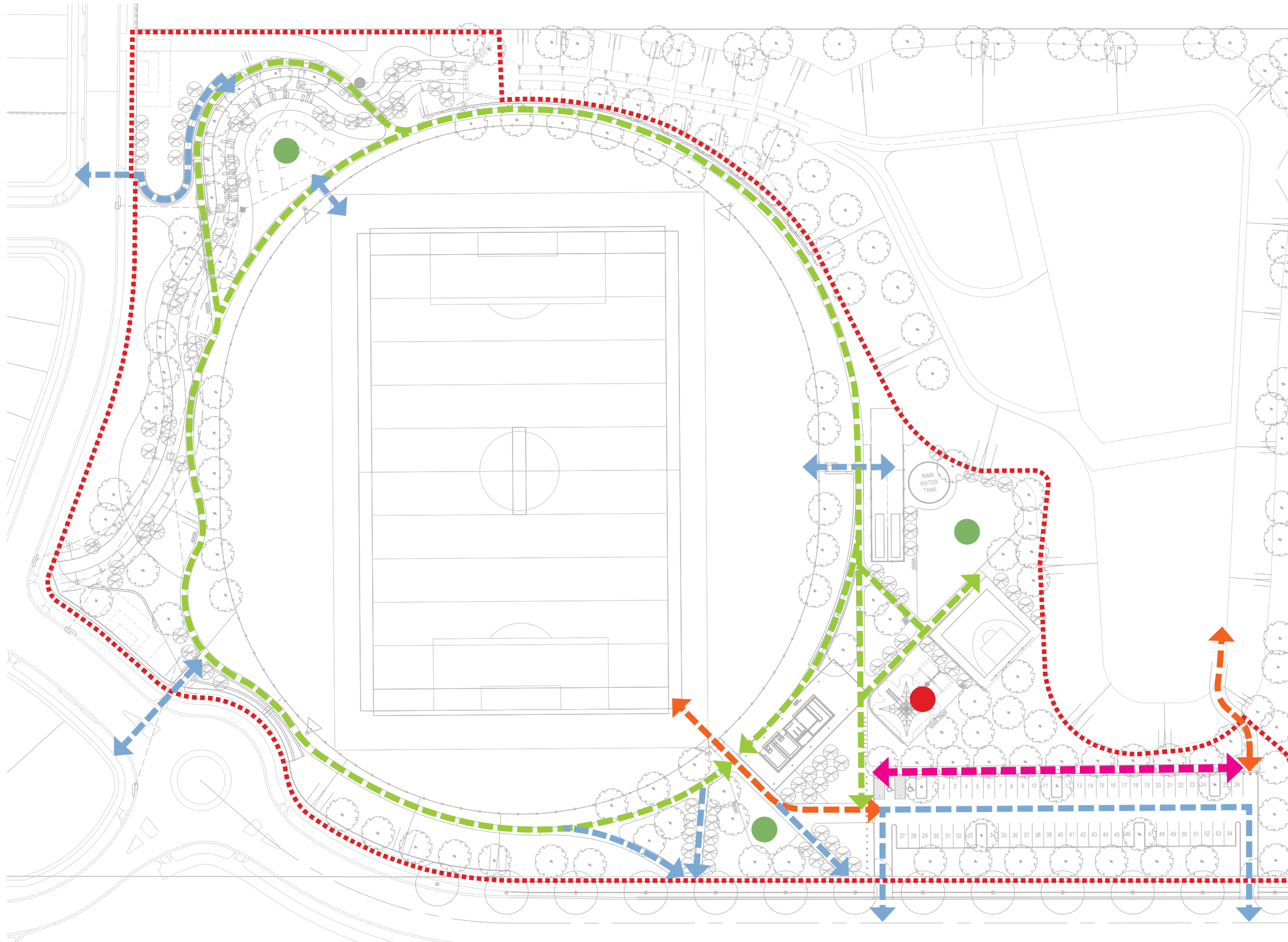

LEGEND

- - - - - Scope of Work
- - - - - 1.8m wide path
- - - - - 1.5m wide path
- - - - - Entrances
- - - - - Maintenance Access
- Playground
- Picnic / Recreation Areas



SCALE 1:1000@A3
0 10m 50m

CADDENS HILL PLANT SCHEDULE				
SPORTS PRECINCT				
Botanical Name	Common Name	Mature Height	Pot Size	Spacing /m2
TREES TO SPORTS PRECINCT				
<i>Araucaria heterophylla</i>	Norfolk Island Pine	20m	200L	As Shown
<i>Backhousia citriodora</i>	Lemon Myrtle	8m	200L	As Shown
<i>Cupaniopsis anacardioides</i>	Tuckeroo	8m	200L	As Shown
<i>Elaeocarpus eumundi</i>	Eumundi Quandong	10m	200L	As Shown
<i>Fraxinus pennsylvanica 'Cimmzam'</i>	Ash	13m	400L	As Shown
<i>Lagerstroemia indica x L. fauriei 'Natchez'</i>	Crepe Mytle	8m	100L	As Shown
<i>Tristaniopsis laurina 'Luscious'</i>	Watergum	8m	200L	As Shown
<i>Waterhousia floribunda 'Green Avenue'</i>	Weeping Lilly Pilly	10m	200L	As Shown
SHRUBS TO SPORTS PRECINCT				
<i>Callistemon 'Captain Cook'</i>	Captain Cook Bottlebrush	1.5m	200mm	1
<i>Callistemon 'Slim'</i>	Slim Bottlebrush	3m	200mm	1
<i>Grevillea 'Honey Gem'</i>	Grevillea Honey Gem	5m	200mm	1
<i>Leptospermum scoparium</i>	New Zealand Teatree	2m	200mm	1
<i>Melaleuca 'Claret Tops'</i>	Honey Myrtle	1m	200mm	3
<i>Nandina 'Obsession'</i>	Sacred Bamboo	0.6m	200mm	3
<i>Westringia 'Aussie Box'</i>	Coastal Rosemary	0.9m	200mm	3
<i>Westringia 'Mundi'</i>	Coastal Rosemary	0.5m	200mm	3
GRASSES TO SPORTS PRECINCT				
<i>Baloskion tetraphyllum 'Feather Top'</i>	Feather Rush	0.5m	75mm	4
<i>Carex appressa</i>	Sedge	1.3m	75mm	4
<i>Lomandra 'Katie Belles'</i>	Lomandra Katie Belles	1.5m	75mm	3
<i>Lomandra 'Tropic Belle'</i>	Lomandra Tropic Belle	0.8m	75mm	2
<i>Pennisetum 'Nafray'</i>	Swamp Foxtail Grass	0.6m	75mm	3
<i>Poa eskdale</i>	Poa	0.6m	75mm	5
GRASSES AND SHRUBS TO SWALE				
BANKS				
<i>Baloskion tetraphyllum 'Feather Top'</i>	Feather Rush	0.5m	75mm	4
<i>Juncus usitatus</i>	Common Rush	0.9m	75mm	5
<i>Lomandra 'Katie Belles'</i>	Lomandra Katie Belles	1.5m	75mm	3
<i>Lomandra 'Tropic Belle'</i>	Lomandra Tropic Belle	0.8m	75mm	2
<i>Pennisetum 'Nafray'</i>	Swamp Foxtail Grass	0.6m	75mm	3
<i>Poa eskdale</i>	Poa	0.6m	75mm	5
<i>Themeda australis</i>	Kangaroo Grass	0.5m	75mm	4
GROWING MEDIUM				
<i>Carex appressa</i>	Sedge	1.3m	75mm	4
<i>Ficinia nodosa</i>	Knobby Club Rush	0.8m	75mm	3
<i>Juncus usitatus</i>	Mat Rush	1.0m	75mm	6
<i>Lepironia articulata</i>	Grey rush	0.9m	75mm	5
<i>Lomandra 'Katie Belles'</i>	Lomandra Katie Belles	1.5m	75mm	3
<i>Lomandra 'Shara'</i>	Lomandra Shara	0.5m	75mm	4
TREES TO PERIMETER OF BASIN AREA				
<i>Acacia decurrens</i>	Black Wattle	8m	45L	As Shown
<i>Callistemon 'Kings Park Special'</i>	Bottlebrush	5m	45L	As Shown
<i>Casuarina glauca</i>	Swamp Oak	10m	45L	As Shown
<i>Elaeocarpus grandis</i>	Blue Quandong	10m	45L	As Shown
<i>Eucalyptus moluccana</i>	Grey Gum	20m	45L	As Shown
<i>Eucalyptus sideroxylon 'Rosea'</i>	Pink Ironbark	20m	45L	As Shown
<i>Eucalyptus tereticornis</i>	Forest Red Gum	20m	45L	As Shown
<i>Melaleuca decora</i>	White Feather Honeymyrtle	6m	100L	As Shown
<i>Syzygium australe</i>	Brush Cherry	8m	45L	As Shown
TURF TO SPORTS PRECINCT				
Kikuyu Grass	Pennisetum clandestinum			

SPORTS PRECINCT PLANT SCHEDULE



Araucaria heterophylla



Cupaniopsis anacardioides



Tristaniopsis laurina 'Luscious'



Melaleuca decora



Eucalyptus tereticornis



Fraxinus pennsylvanica 'Cimmzam'



Eucalyptus sideroxylon 'Rosea'



Lagerstroemia indica x L. fauriei 'Natchez'



Acacia decurrens



Eucalyptus moluccana



Dodonaea viscosa ssp cuneata



Lomandra longifolia



Poa labillardieri

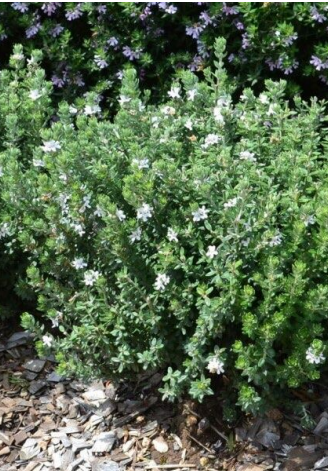

Westringia 'Aussie Box'



Melaleuca 'Claret Tops'

SPORTS PRECINCT PLANTING DIAGRAM

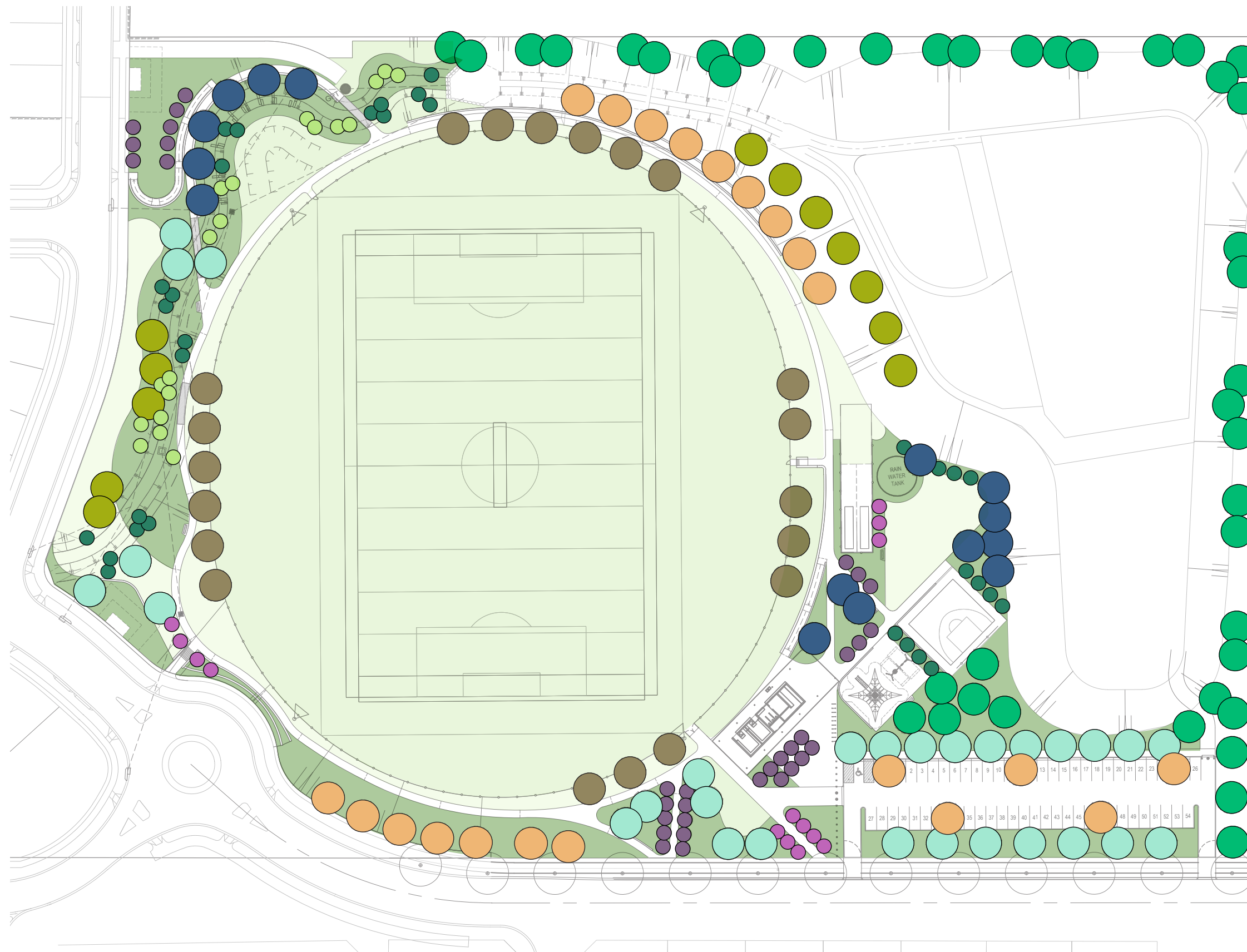

LEGEND

-  **Capital Pear**
(*Pyrus Calleryana* 'Chanticleer')
-  **Purple Leaved Plum**
(*Prunus blireana*)
-  **Watergum**
(*Tristaniopsis Laurina* 'Luscious')
-  **Norfolk Island Pine**
(*Araucaria heterophylla*)
-  **Crepe Myrtle**
(*Lagerstroemia indica* x *L. fauriei* 'Biloxi')
-  **Claret Ash**
(*Fraxinus pennsylvanica* 'Cimmzam')
-  **Tuckeroo**
(*Cupaniopsis anacardioides*)
-  **Lemon Myrtle**
(*Backhousia citriodora*)
-  **Eumundi Quandong**
(*Elaeocarpus eumundi*)
-  **Weeping Lilly Pilly**
Waterhousia floribunda 'Green Avenue'
-  **Trees to Revegetation Area**
Black Wattle (*Acacia decurrens*)
Grey Gum (*Eucalyptus moluccana*)
Pink Ironbark (*Eucalyptus sideroxylon* 'Rosea')
Forest Red Gum (*Eucalyptus tereticornis*)
White Feather Honeymyrtle (*Melaleuca decora*)
Black Wattle (*Acacia decurrens*)
Grey Gum (*Eucalyptus moluccana*)
Pink Ironbark (*Eucalyptus sideroxylon* 'Rosea')
Forest Red Gum (*Eucalyptus tereticornis*)
White Feather Honeymyrtle (*Melaleuca decora*)

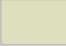
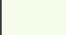
-  **Shrubs and Grasses to Sports Precinct**
-  **Shrubs/ Herbs and Grasses to Sports Precinct**
-  **Kikuyu Turf to Sports Precinct**



SPORTS PRECINCT GRADING PLAN

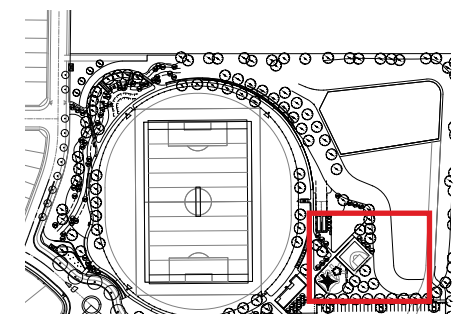
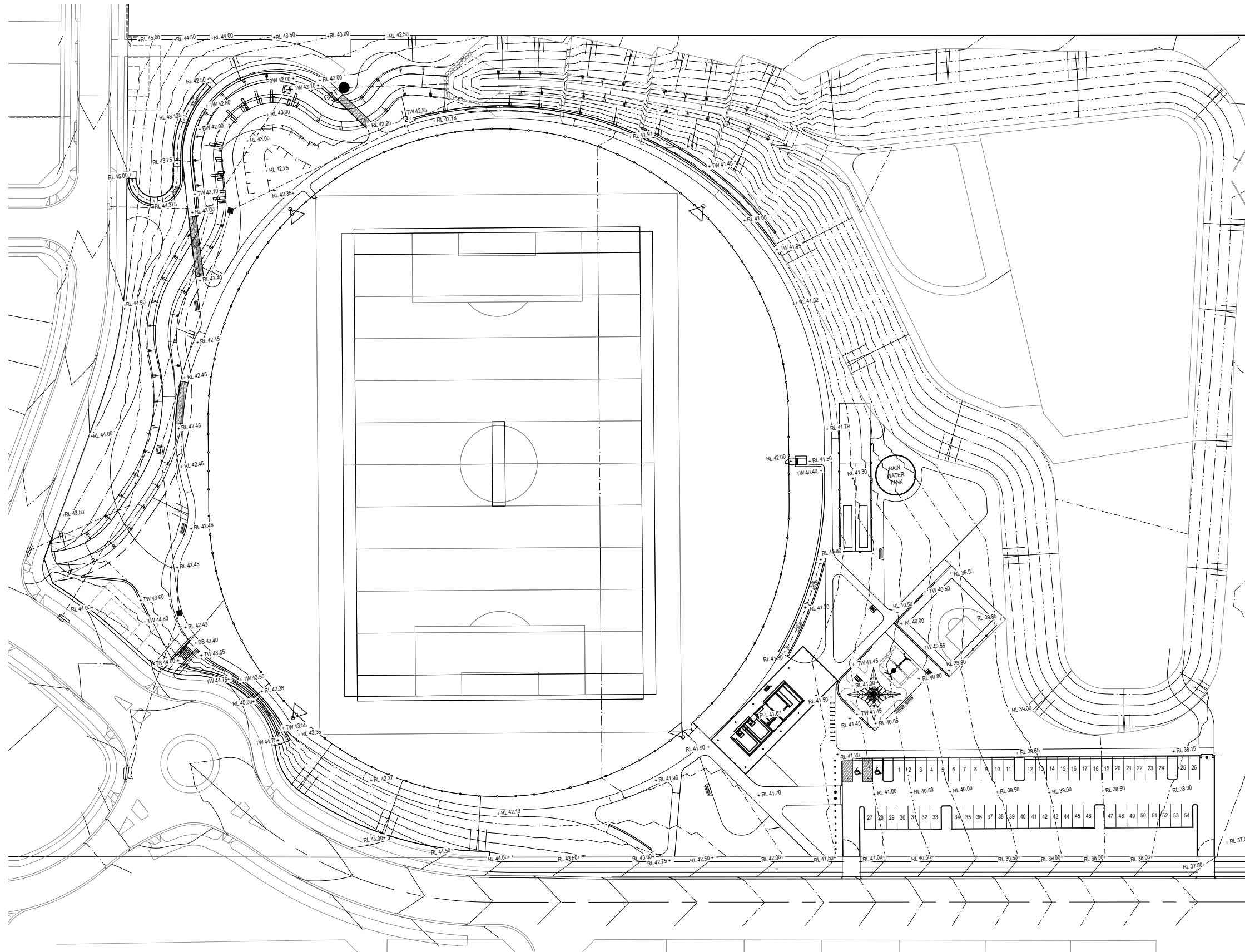

SPORTS PRECINCT - SECTION 1



SECTION 1 - PEDESTRIAN WALKWAY BRIDGES, TERRACED LAWN AND OVAL

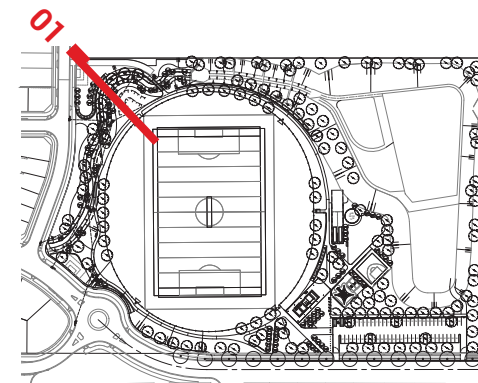

SPORTS PRECINCT - SECTIONS 2 & 3

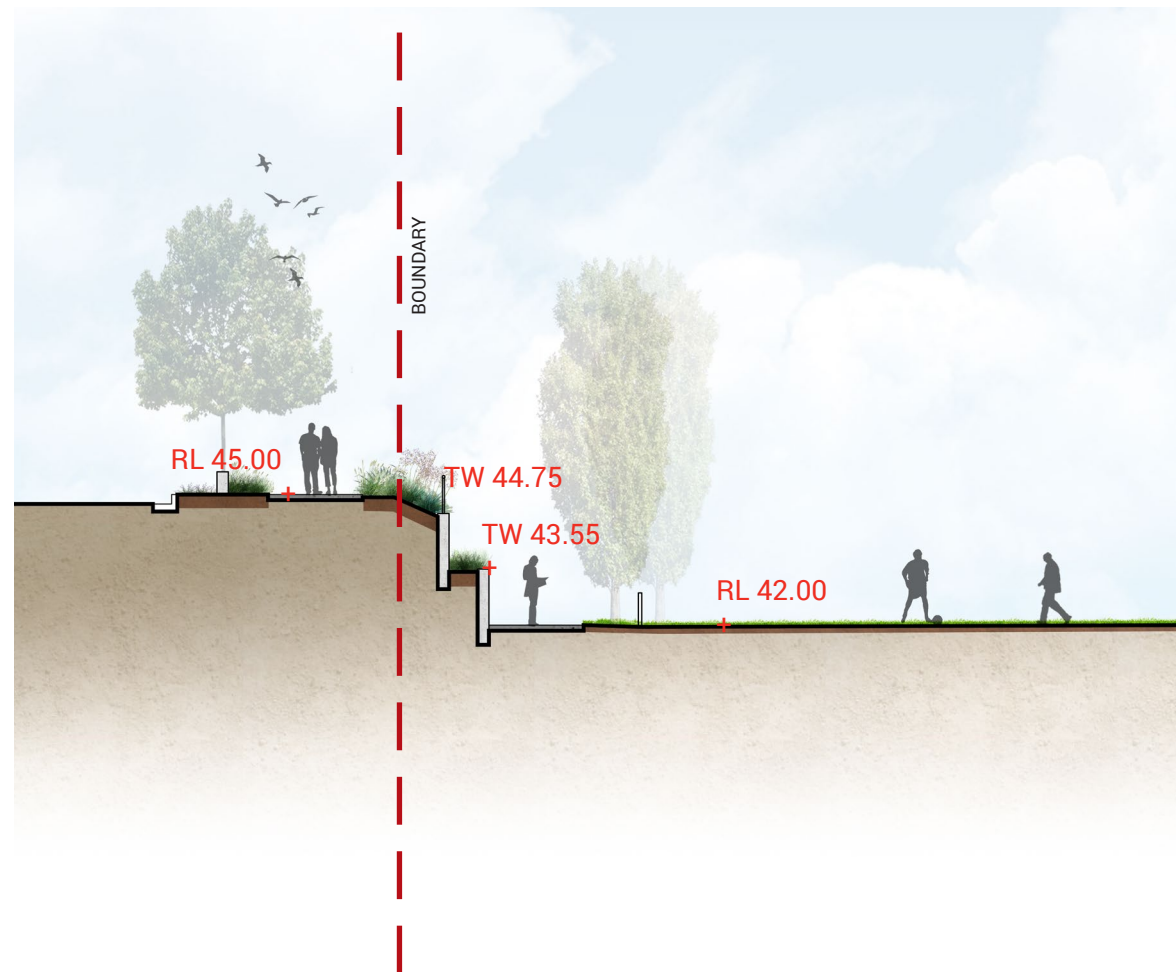

SECTION 2 - UPPER AND LOWER PATHWAYS



SECTION 3 - UPPER PATHWAY, PLANTING BATTER AND TERRACED SEATING WALLS

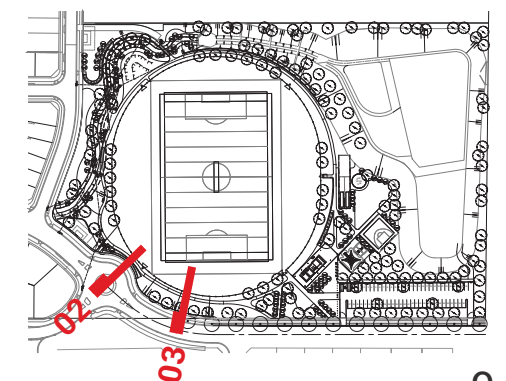

SPORTS PRECINCT - SECTION 4

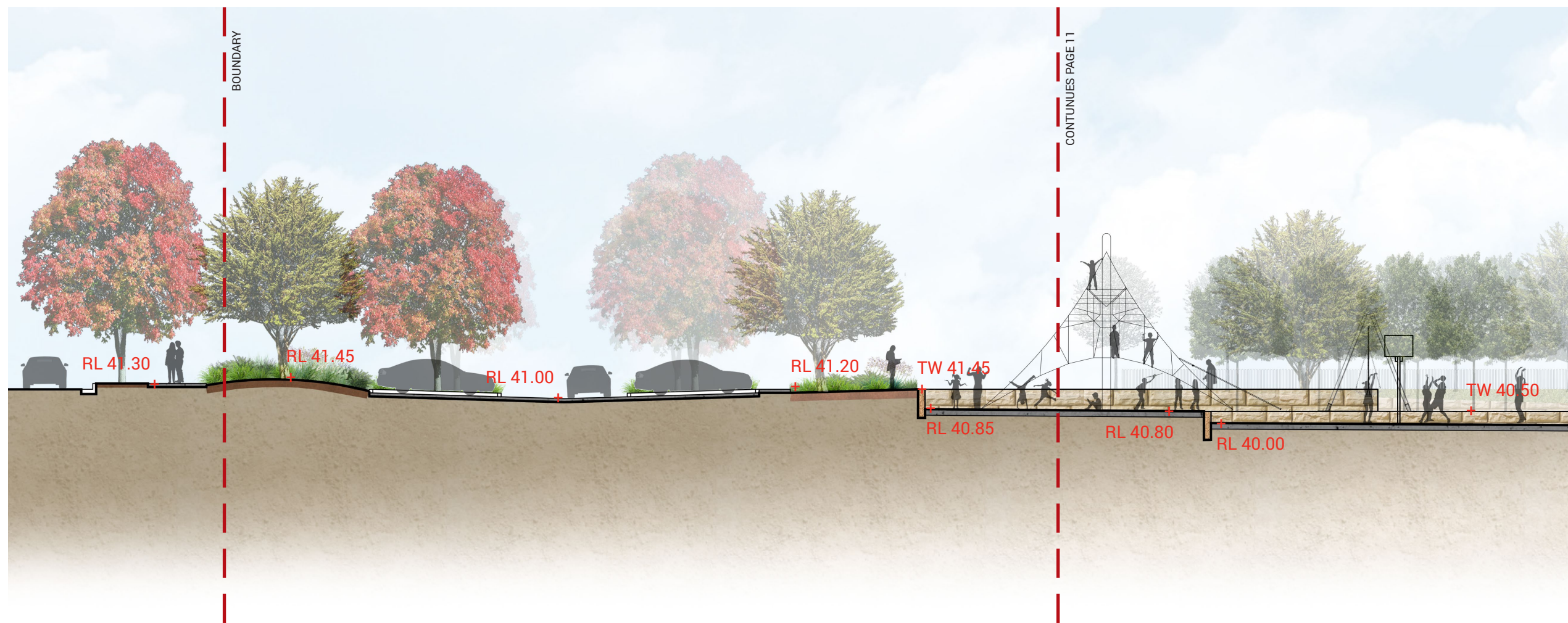

SECTION 4 - CAR PARK AND PLAYGROUND

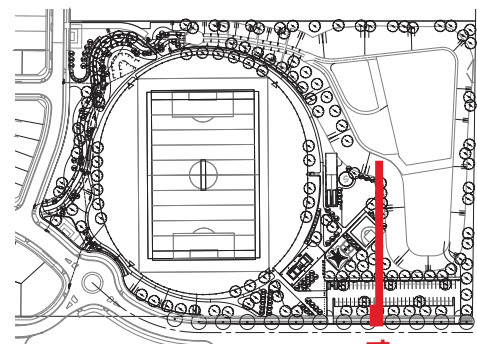

SPORTS PRECINCT - SECTION 4



SECTION 4 CONTINUED - PLAYGROUND, BASKET BALL COURT AND CRICKET NETS

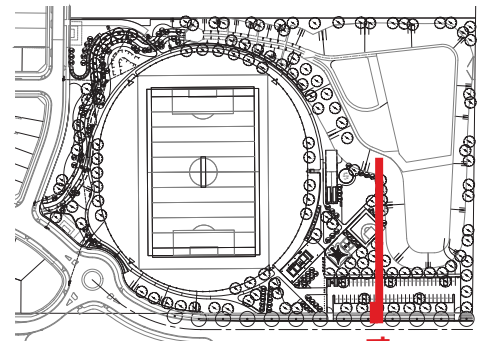

SPORTS PRECINCT - PLAY DETAIL

The playground area is located in close proximity to the car park and amenities building, providing ease of access to toilet and change room facilities. Shade will be provided via three (3) large trees and several smaller species. A single rubbish bin and two (2) bench seats will also be provided allowing parents and guardians to sit and supervise their children. Low height walls and generous planting buffers will aid in enclosing the playground and providing a safer environment.

The selected playground equipment will provide opportunities for swinging, climbing, balancing, swaying and rocking. This combination of equipment will provide a stimulating and engaging play space for the children who use it.



LAPPSET 220068M - Erbium, Birds Nest Swing and Single Swings
Swing frame with birds nest swing and (2) swings for one with 210 cm long chain.(swinging)

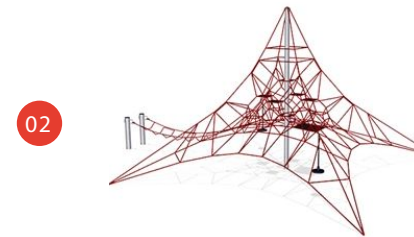

COROCORD COR10110 - Mini Spacenet 3030 with Extensions
Made from durable materials this mini spacenet encourages active play (climbing and balancing) and a vantage point at the top looking over the playground and basketball courts.

classic plaza bench

Sep 2014

CMP4

General Description

Classic, contoured bench supported by strong marine-grade stainless steel frames.

Dimensions (mm)

625W x 470H x 1750L

Specifications

Tick one box per category to specify your project.

Seat Type:
CMP4

Battens (mm):
40W x 20D x 1750L
☐ Eco-accredited Hardwood Oiled*
☐ Aluminium Anodised
*Street Furniture uses sustainably sourced timber from certified managed forests.

Mounting:
☐ Surface
☐ Subsurface

Powder Coat Finish:
Please refer to Colour Chart

Tailored options are available for all Street Furniture products. Additional fees and lead times may apply.

Related Products

Classic Plaza, Promenade and Galleria products

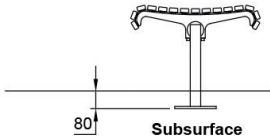
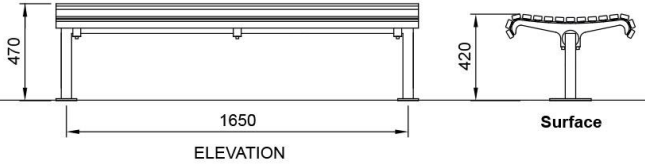

classic plaza seat

Sep 2014

CMP1

General Description

Classic, contoured seat supported by strong marine-grade stainless steel frames.

Dimensions (mm)

705W x 800H x 1750L

Specifications

Tick one box per category to specify your project.

Seat Type:
CMP1

Battens (mm):
40W x 20D x 1750L
☐ Eco-accredited Hardwood Oiled*
☐ Aluminium Anodised
*Street Furniture uses sustainably sourced timber from certified managed forests.

Mounting:
☐ Surface
☐ Subsurface

Arms:
☐ None
☐ Angle Powder Coated (Pair)

Powder Coat Finish:
Please refer to Colour Chart

Tailored options are available for all Street Furniture products. Additional fees and lead times may apply.

Related Products

Classic Plaza, Promenade and Galleria products

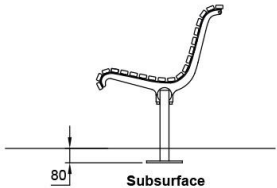
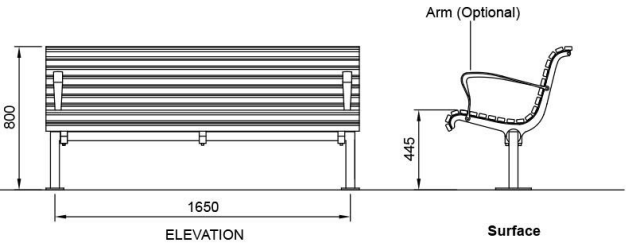
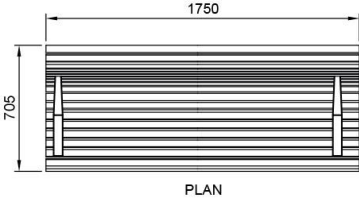

escola bin enclosure 240L

Class: Litter Solutions, Family: Escola

Sep 2016

MCODE:
WBE-E240OVERALL DIMENSIONS:
W695 x H1380 x D760 (mm)CAPACITY:
Fits 240L wheeled binROOF:
☐ Flat
☐ Angled
☐ Tray ReturnPACKAGING:
☐ Fully Assembled
☐ Flat Packed*Flat packed requires assembly by a qualified tradesperson on site. Incorrect assembly or assembly by unqualified person/s will void warranty. An assembly guide is included in delivery and available on the website.*SIGNAGE:
Qty 2, 150x210mm UV-protected
☐ None
☐ 'Garbage' Charcoal
☐ 'Garbage' Red
☐ 'Recycling' Green
☐ 'Recycling' Yellow
☐ Tailored - provide EPS artworkBODY:
Stainless 304 No.4 Finish (brushed)MOUNTING:
☐ Surface Fixed
☐ Freestanding (HDPE base in black - fee applies)SECURITY KEY:
☐ Qty 2 Triangular 7mm (standard)
☐ Tailored - specify quantityRECYCLING INSERT:
☐ None
☐ Qty 2 Recycling Insert in Brilliant Yellow
☐ Recycling Insert [select from colour chart](#)OPTIONAL EXTRA (FEE APPLIES):
☐ Anti-graffiti Clear Powder Coat
☐ Stainless Ash Box
☐ 'Dog Tidy' Bag Dispenser*Some options incur additional fees and lead time.*

Need more information?

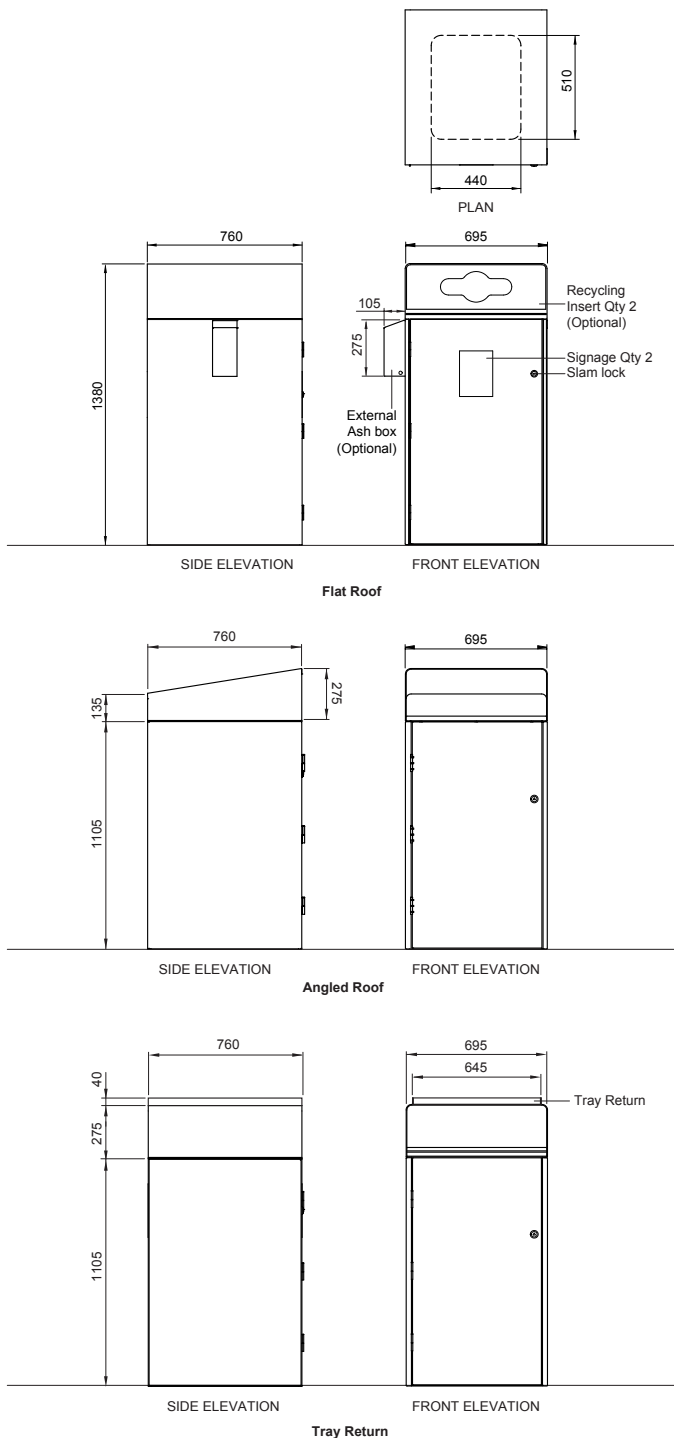
Find online: Brochure, colour chart, parts and care guide, image gallery and CAD downloads. Go to streetfurniture.com/au/product/escola-bin-enclosure-240L1300 027 799 streetfurniture.com

© Street Furniture Australia Pty Limited 2016. All rights reserved.
This technical sheet is copyright and owned by Street Furniture Australia Pty Limited ACN 070 910 100. You may download and use this technical sheet in unaltered form only for tendering our products to current or potential new clients. All rights are reserved. Any use of our technical sheet for purposes other than for the abovementioned purpose, is strictly prohibited without the prior written permission of Street Furniture Australia Pty Limited, Level 1, 52-58 William Street, East Sydney NSW 2011. Street Furniture Australia Pty Limited reserves the right to make modifications to product specifications without prior notice.

TOWN&PARK

BIKERACK

Construction:

- Heavy Duty Materials
- 316 Stainless Steel Fasteners
- High Quality Finishes
- Australian Made

Specification Text:

Supply Town and Park **SPTP.BR.BHS.SM.304.900** Bike Rack Hoop with a high quality finish. All fasteners to be 316 grade stainless steel. S/S surface mount 950mm high

Product/Install Details:

All measurements in millimetres

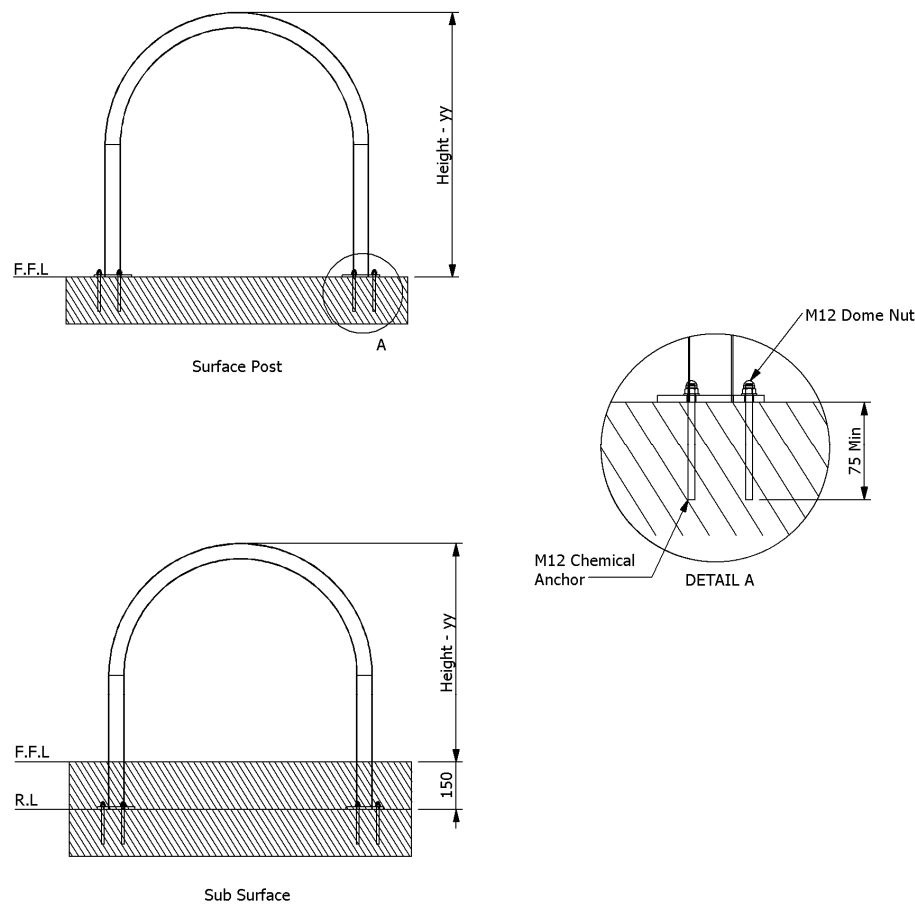
1300 782 101 | www.townandpark.com.au | info@townandpark.com.au
Revision Date: 6/11/2014

Due to continuous product research and development, the information contained herein is subject to change without notice



PRECEDENT IMAGES

FURNITURE & STRUCTURES



PAVEMENT



PARK PRECINCT



FURNITURE, PLAY AND EXERCISE EQUIPMENT

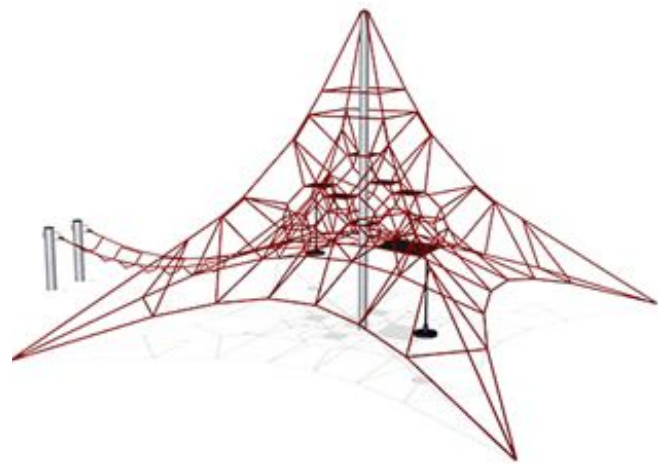

CLIMBING ROPES



BIRDS NEST SWING AND SINGLE SWINGS

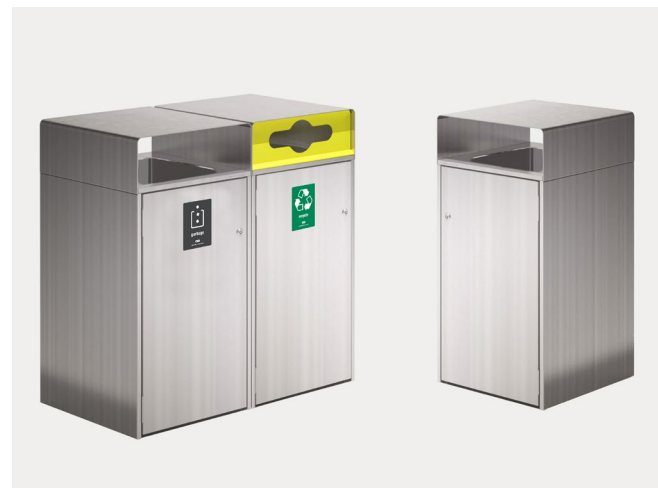

RUBBISH BINS

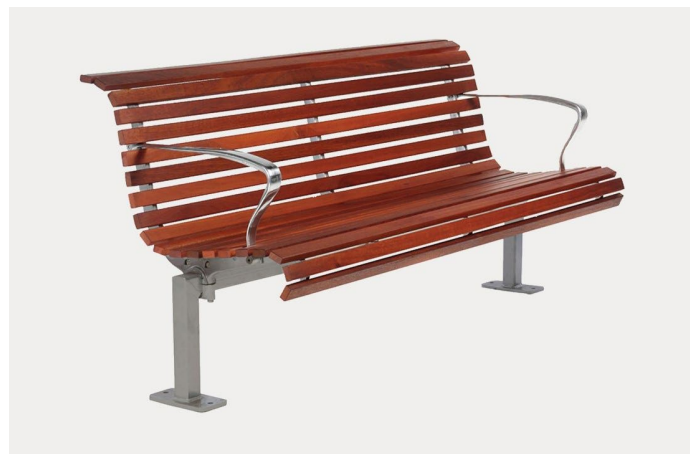

BENCH SEATS (Back and Arm Rests)



BENCH SEATS

place
design
group.

Australia
China
South East Asia

Follow us on



placedesigngroup.com