

WORK COMPLETED / FIELD BOOK

CONSTRUCTED BY _____
 SIGNATURE _____ DATE _____

INSPECTED BY _____
 SIGNATURE _____ DATE _____

UNDERGROUND ASSETS

INSTALLED BY _____
 RECORDED BY _____
 CONTACT No _____
 SIGNATURE _____ DATE _____

HV TRENCH LENGTH 465 M
 LV TRENCH LENGTH 645 M
 TOTAL TRENCH LENGTH 1110 M

- LEGEND**
- EXISTING POLE SUBSTATION
 - PROPOSED PADMOUNT SUBSTATION
 - EXISTING PADMOUNT SUBSTATION
 - PROPOSED LV PILLAR LOCATION
 - EXISTING LV PILLAR LOCATION
 - PROPOSED S.L. COLUMN LOCATION
 - EXISTING S.L. COLUMN LOCATION
 - HV CABLE TRENCH
 - LV CABLE TRENCH
 - EXISTING UNDERGROUND CABLE
 - INSTALL 40mm PVC SERVICE CONDUIT
 - EXISTING OVERHEAD MAINS
 - PROPOSED DUCT LOCATIONS
 - EXISTING DUCT LOCATIONS
 - EXISTING POLE
 - DUCT CONFIGURATION - REFER MCI 0006 SECTION 4

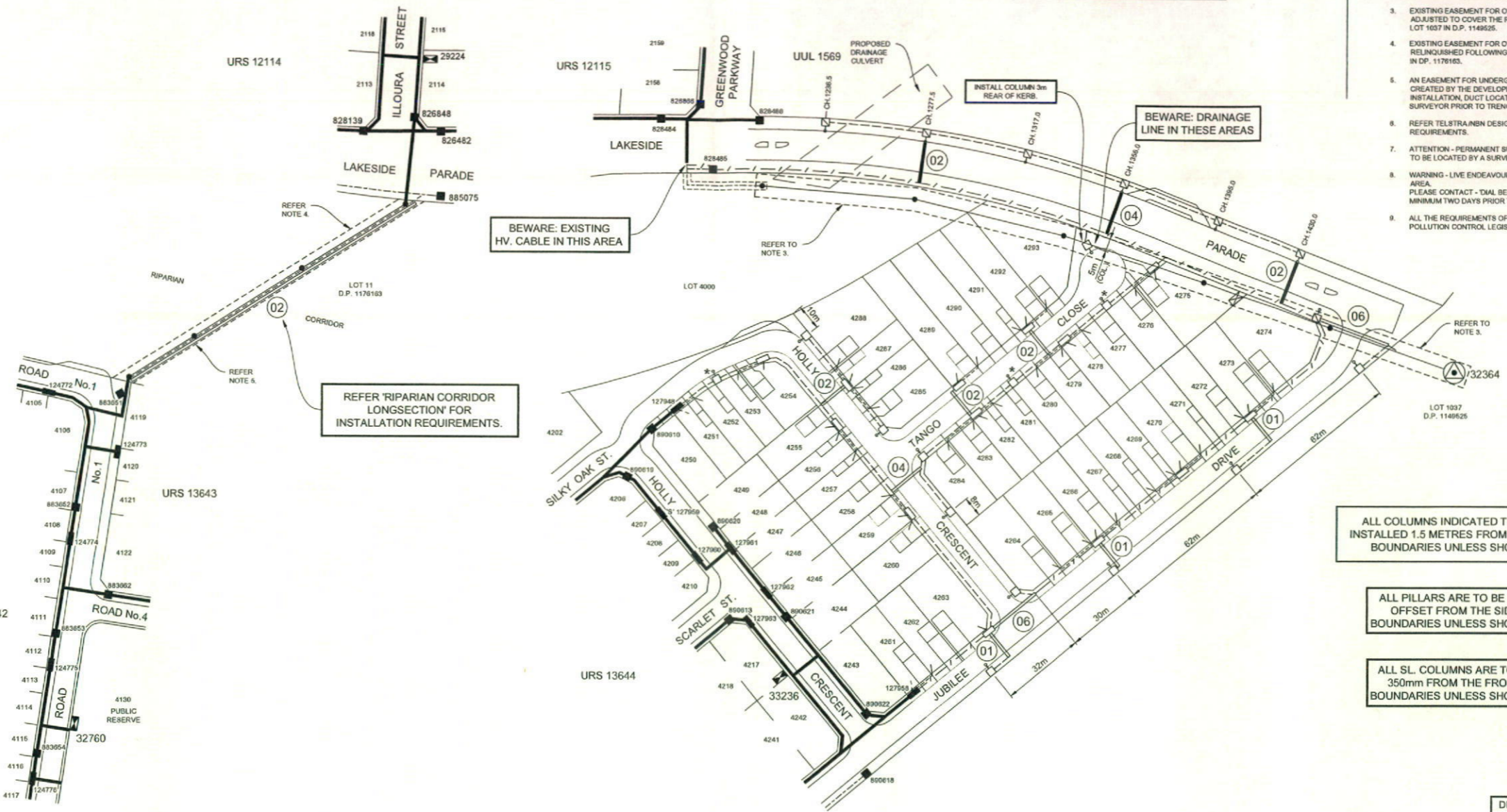

ALL WORKS TO BE CONSTRUCTED ARE TO BE COMPLETED IN ACCORDANCE WITH ENDEAVOUR ENERGY'S GENERIC ENVIRONMENTAL PLAN - EMS 9001.

WARNING
 LIVE ENDEAVOUR ENERGY CABLES AND OTHER SERVICES EXIST IN THIS AREA.
 PLEASE CONTACT - DIAL BEFORE YOU DIG ON TEL-1100 FOR SEARCH INFORMATION A MINIMUM TWO DAYS PRIOR TO EXCAVATION

- NOTES**
- THIS DRAWING IS TO BE READ IN CONJUNCTION WITH ENDEAVOUR ENERGY'S MCI 0028, MCI 0006 AND THE GENERAL TERMS AND CONDITIONS FOR NEW URBAN SUBDIVISIONS.
 - AN EASEMENT FOR SUBSTATION SITE (B) 8.5M x VARIABLE x 2.75M (THIS IS MINIMUM SIZE ONLY) IS REQUIRED TO BE CREATED BY THE DEVELOPER OVER LOT 4275. IN ADDITION TO THE EASEMENT A RESTRICTION ON THE USE OF LAND (A) IS REQUIRED IN RELATION TO THE FIRE RATING OF BUILDINGS MEASURED 3M FROM THE PLINTH. ALSO A RESTRICTION ON THE USE OF LAND (D) IS REQUIRED IN RELATION TO SWIMMING POOLS MEASURED 5M FROM THE EASEMENT.
 - EXISTING EASEMENT FOR OVERHEAD MAINS 9 METRES WIDE IS TO BE ADJUSTED TO COVER THE REMAINING OVERHEAD MAINS & POLES WITHIN LOT 1037 IN D.P. 1146625.
 - EXISTING EASEMENT FOR OVERHEAD MAINS 9 METRES WIDE IS TO BE RELINQUISHED FOLLOWING OH MAINS & POLE REMOVALS WITHIN LOT 11 IN DP. 1178163.
 - AN EASEMENT FOR UNDERGROUND CABLES 1m WIDE IS REQUIRED TO BE CREATED BY THE DEVELOPER OVER LOT 11 IN DP. 1178163. FOLLOWING DUCT INSTALLATION, DUCT LOCATIONS ARE TO BE CONFIRMED BY A REGISTERED SURVEYOR PRIOR TO TRENCH BACKFILL.
 - REFER TELSTRAMAN DESIGN LAYOUT FOR DUCTING AND EXCAVATION REQUIREMENTS.
 - ATTENTION - PERMANENT SURVEY MARKS MAY EXIST IN THIS AREA. THESE ARE TO BE LOCATED BY A SURVEYOR PRIOR TO THE COMMENCEMENT OF WORK.
 - WARNING - LIVE ENDEAVOUR ENERGY CABLES AND OTHER SERVICES IN THIS AREA. PLEASE CONTACT - DIAL BEFORE YOU DIG ON TEL-1100 FOR SEARCHES A MINIMUM TWO DAYS PRIOR TO EXCAVATION.
 - ALL THE REQUIREMENTS OF THE ENVIRONMENTAL PROTECTION AUTHORITY POLLUTION CONTROL LEGISLATION IS TO BE STRICTLY ADHERED TO.

BEWARE: EXISTING HV. CABLE IN THIS AREA

BEWARE: DRAINAGE LINE IN THESE AREAS

REFER 'RIPARIAN CORRIDOR LONGSECTION' FOR INSTALLATION REQUIREMENTS.

ALL COLUMNS INDICATED THUS ARE TO BE INSTALLED 1.5 METRES FROM THE SIDE PROPERTY BOUNDARIES UNLESS SHOWN OTHERWISE.

ALL PILLARS ARE TO BE INSTALLED 1.5m OFFSET FROM THE SIDE PROPERTY BOUNDARIES UNLESS SHOWN OTHERWISE.

ALL S.L. COLUMNS ARE TO BE INSTALLED 350mm FROM THE FRONT PROPERTY BOUNDARIES UNLESS SHOWN OTHERWISE.

DUCT DECLARATION

OF _____

CONTACT NUMBER _____
 HEREBY CERTIFY THAT THE CUTS SHOWN ON THIS DRAWING HAVE BEEN INSTALLED IN ACCORDANCE WITH THIS DRAWING AND ENDEAVOUR ENERGY'S MCI 0006 SECTION 4. THE DUCT DEPTHS AT EACH END HAVE BEEN CORRECTLY MARKED ON THIS DRAWING IN THE RED. THE INSTALLATION OF THE DUCTS WAS _____

COMMENCED ON _____
 & COMPLETED ON _____

SIGNATURE _____

LAND SURVEYOR REGISTERED UNDER SURVEYING ACT 2002 OR MEMBER OF THE INSTITUTE OF ENGINEERS OF AUSTRALIA.

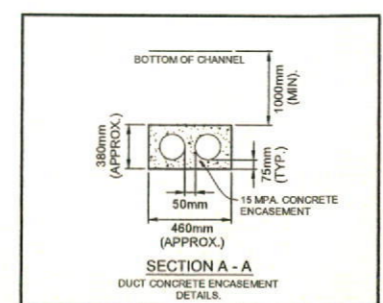
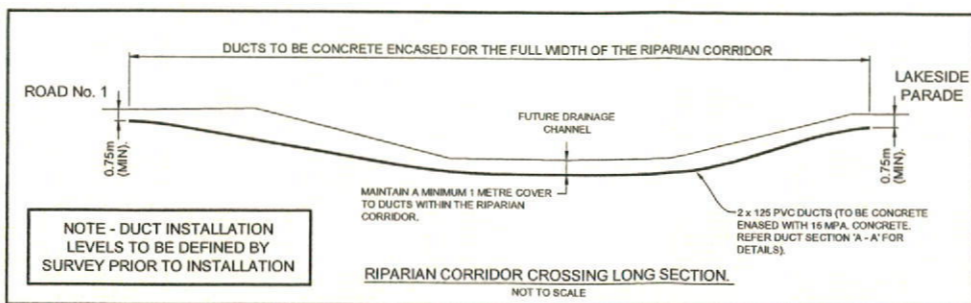
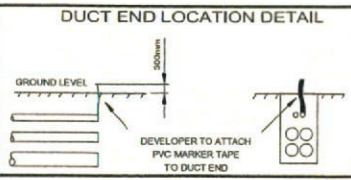
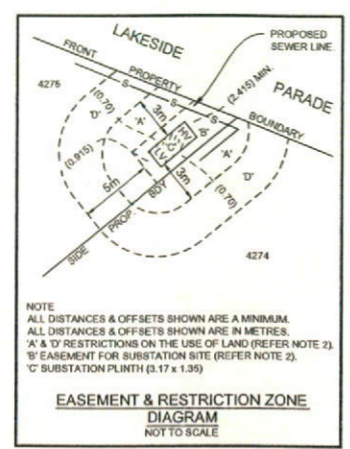

CERTIFIED BY ENDEAVOUR ENERGY

AMENDMENT A
 DATE APPROVED: 15/01/2014
 EXAMINER'S SIGNATURE: _____
 PRINT NAME: Eugene Lorenzo

THIS CERTIFICATION IS ISSUED SUBJECT TO ENDEAVOUR ENERGY'S STANDARD CERT. TERMS.

DESIGN COMPLIANCE AND INDEMNITY

This design complies with the Endeavour Energy's relevant standards as current at this time and as listed on the Endeavour Energy Accredited Service Provider's internet site. These standards include, but are not limited to:

- GT&C : General Terms and Conditions
- EMS : Environmental Management Standard
- MCI : Mains Construction Instruction
- MDI : Mains Design Instruction
- PDI : Protection Design Instruction
- SDI : Substation Design Instruction
- SAD 0001 : Design Drawing Standard
- MMI : Mains Maintenance Instruction
- SMI : Substation Maintenance Instruction
- LDI 0001 : Public Lighting Electrical Design Element

Additionally, where relevant, the design complies with CB-1 'Guidelines for Design and Maintenance of Overhead Distribution and Transmission Lines' published by ENA and other relevant Australian Standards.

ESTATE POWER DESIGN (Company name)
 indemnifies Endeavour Energy for any loss or damage resulting from non-compliance of the design with the above standards.

Signature: _____
 Name: BRIAN JUDE
 Service Provider Number: 1033 Date: 15_01_2014



EPD REFERENCE No. 23/365/ED4E

Endeavour Energy

A1 390308 A

SHEET No. 1 OF 1 SHEETS

ESTATE POWER DESIGN PTY LIMITED
 ABN 69 002 331 142
 ELECTRICAL RETICULATION CONSULTANTS
 142 SUNNYHOLT ROAD, BLACKTOWN 2148
 TEL: (02) 9621-3433 FAX: (02) 9671-7256
 EMAIL: brian@estatepower.com.au

AMENDMENTS	ORIGINAL ISSUE	REFERENCE DRAWINGS	WORK ORDERS	CAP / SAMP No.	URB 13645	ORIGINAL SCALE	DO NOT SCALE
		390310 ELECTRICAL RETICULATION	GENERAL OVERHEAD UNDERGROUND SUBSTATIONS	AM PROJ. No. _____ HV SWITCHING _____ URD/PENGUIN REF _____ GIS MAP No. _____ HV OP DIAGRAM _____ LOCAL GOV AREA _____	MAP 144 REF J14 7360_12 CRANE BROOK PENRITH	1:1000	DRAWN: E.C. DATE: 14.01.14 CHD: B.J. DESIGN: B.J.

STAGE 4E
 LOT 4252 - HOLLY CRESCENT
 URS13645
 JORDAN SPRINGS
 DUCT, EASEMENT & TRENCHING REQUIREMENTS

WORK COMPLETED / FIELD BOOK

CONSTRUCTED BY: _____
 WORKS COMPLETED: _____
 SIGNATURE: _____ DATE: _____

INSPECTED BY: _____

UNDERGROUND ASSETS

INSTALLED BY: _____
 RECORDED BY: _____
 CONTACT No: _____
 SIGNATURE: _____ DATE: _____

WARNING

LIVE ENDEAVOUR ENERGY CABLES AND OTHER SERVICES EXIST IN THIS AREA. PLEASE CONTACT - DIAL BEFORE YOU DIG ON TEL-1100 FOR SEARCH INFORMATION A MINIMUM TWO DAYS PRIOR TO EXCAVATION

ALL PILLARS ARE TO BE INSTALLED 1.5m OFFSET FROM THE SIDE PROPERTY BOUNDARIES UNLESS SHOWN OTHERWISE.

ALL COLUMNS INDICATED THUS ARE TO BE INSTALLED 1.5 METRES FROM THE SIDE PROPERTY BOUNDARIES UNLESS SHOWN OTHERWISE.

ALL SL COLUMNS ARE TO BE INSTALLED 350mm FROM THE FRONT PROPERTY BOUNDARIES UNLESS SHOWN OTHERWISE.

- NOTES**
- THIS DRAWING IS TO BE READ IN CONJUNCTION WITH ENDEAVOUR ENERGY'S MCI 0005, MDI 0028, THE RELEVANT SDI AND THE GENERAL TERMS AND CONDITIONS FOR NEW URBAN SUBDIVISIONS SPJ 4004 & THE DUCT, EASEMENT AND TRENCH REQUIREMENTS DRAWING.
 - ENDEAVOUR ENERGY CONTACT PHONE No. 131081.
 - DESIGN CERTIFICATION SHALL LAPSE WHERE -
 (i) NOTICE OF INTENT HAS NOT BEEN RECEIVED WITHIN SIX (6) MONTHS OF THIS CERTIFICATION, OR
 (ii) CONSTRUCTION HAS BEEN INTERRUPTED FOR MORE THAN SIX (6) MONTHS. WHERE DESIGN CERTIFICATION HAS LAPSED, THE DESIGN MUST BE RESUBMITTED FOR CERTIFICATION BY THE ACCREDITED DESIGNER.
 - ATTENTION - PERMANENT SURVEY MARKS MAY EXIST IN THIS AREA. THESE ARE TO BE LOCATED BY A SURVEYOR PRIOR TO THE COMMENCEMENT OF WORK.
 - ATTENTION - ALL SERVICES SEARCHES MUST BE CHECKED BEFORE CONSTRUCTION.
 - WARNING - LIVE ENDEAVOUR ENERGY CABLES AND OTHER SERVICES IN THIS AREA. PLEASE CONTACT - DIAL BEFORE YOU DIG ON TEL-1100 FOR SEARCHES A MINIMUM TWO DAYS PRIOR TO EXCAVATION.
 - ATTENTION - SERVICE PROVIDER TO NOTIFY ENDEAVOUR ENERGY'S ASSET DATA CUSTOMER DEPT. DAILY WHEN CABLE WORKS IS IN PROGRESS. TELEPHONE 131 081.
 - OPERATIONAL LIMITS - UNLESS APPROVED OTHERWISE, INTERRUPTIONS TO ANY CUSTOMER'S SUPPLY MUST BE AVOIDED. THE FOLLOWING ALTERNATIVES SHOULD BE CONSIDERED:
 - MOBILE GENERATORS OR SUBSTATIONS.
 - LIVE NETWORK.
 - DESIGN ALTERNATIVES.
 - LOW VOLTAGE PARALLELS.
 - WORK PRACTICES / STANDARDS.
 THE COST IS TO BE FUNDED BY THE CUSTOMER / DEVELOPER.
 - REIMBURSEMENTS WILL BE CREDITED TO THE DEVELOPER ONLY FOR LENGTHS AND QUANTITIES SHOWN IN THE SCOPE OF WORKS. ANY DISCREPANCIES SHOULD BE RESOLVED PRIOR TO THE CONTRACT AGREEMENT.
 - HAVE ALL THE EXISTING ASSETS BEEN FIELD CHECKED AND ARE ACCURATE AT THE TIME OF DESIGN: YES / NO
 - ALL NEW LANTERNS TO BE CONTROLLED BY NEW PHOTO ELECTRIC CELLS & STREETLIGHT CONTROL POINT (REFER CIRCUITS). STREETLIGHT COLUMNS ARE TO BE POWDER COATED IN ACCORDANCE WITH COUNCIL'S WRITTEN REQUIREMENTS.
 - IDENTIFICATION OF CABLES VIEWED FROM FOOTPATH SIDE:
 LEFT SIDE: ONE DOT
 RIGHT SIDE OF CABLE: TWO DOTS
 THIRD CABLE: THREE DOTS
 IRRESPECTIVE OF DIRECTION

ALL WORKS TO BE CONSTRUCTED ARE TO BE COMPLETED IN ACCORDANCE WITH ENDEAVOUR ENERGY'S GENERIC ENVIRONMENTAL PLAN - EMS 0001.

- LEGEND**
- EXISTING POLE SUBSTATION
 - PROPOSED PADMOUNT SUBSTATION
 - EXISTING PADMOUNT SUBSTATION
 - PROPOSED LV PILLAR
 - EXISTING LV PILLAR
 - PROPOSED S.L. COLUMN (REFER TO SCHEDULE)
 - EXISTING S.L. COLUMN
 - HV CABLE TRENCH
 - LV CABLE TRENCH
 - INSTALL 40mm PVC SERVICE CONDUIT
 - EXISTING SERVICE CONDUIT
 - EXISTING UNDERGROUND CABLE
 - EXISTING OVERHEAD MAINS
 - REMOVE EX OVERHEAD MAINS
 - EXISTING DUCT LOCATIONS
 - PILLAR EARTHING LOCATIONS
 - EXISTING POLE
 - NEW POLE
 - REMOVE POLE

- PLAN SYMBOLS**
- SPARE DUCT
 - DUCT WITH CABLE
 - DUCT WITH NEW CABLE

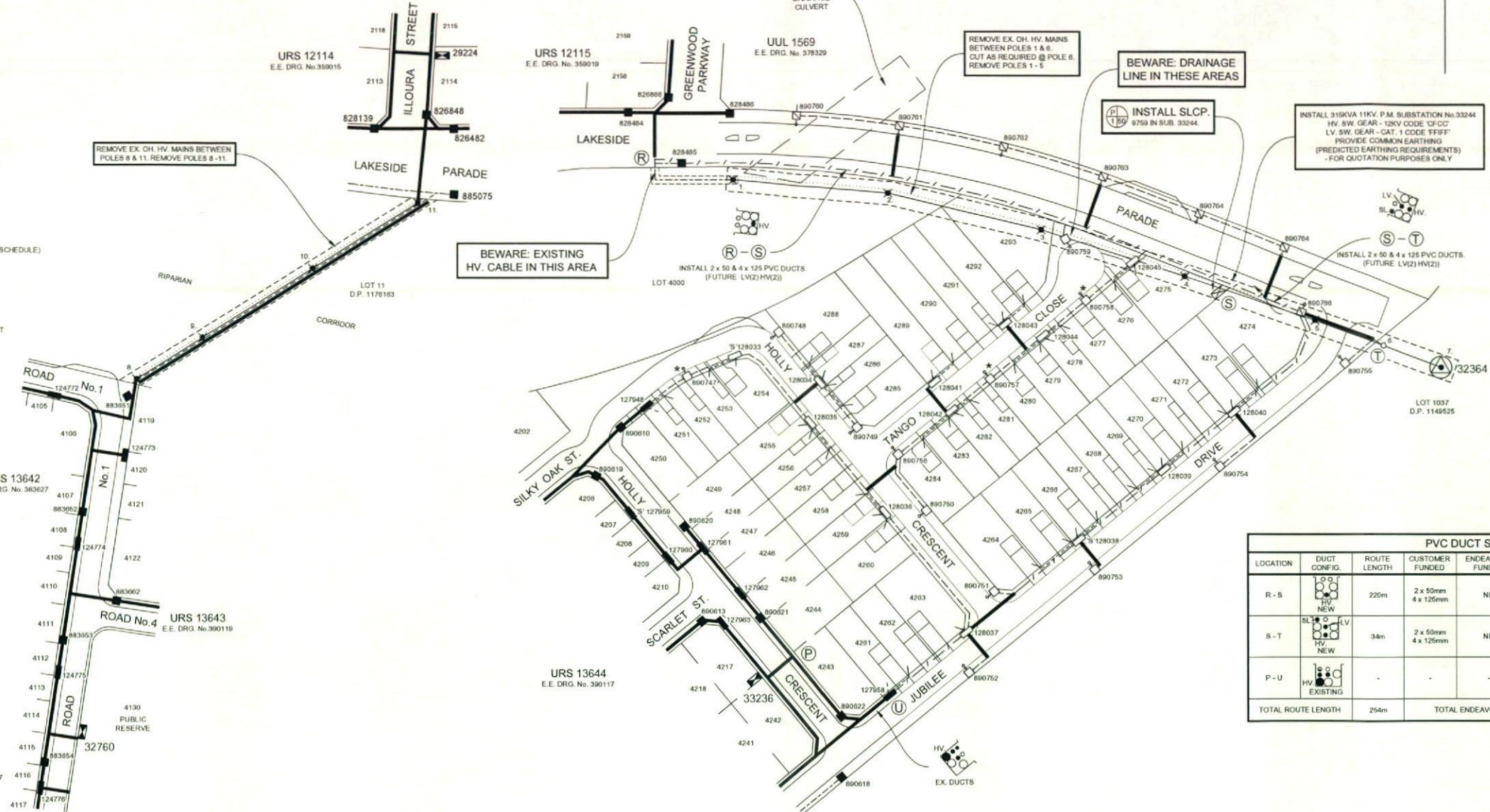

PVC DUCT SCHEDULE

LOCATION	DUCT CONFIG.	ROUTE LENGTH	CUSTOMER FUNDED	ENDEAVOUR FUNDED	RATE PER METRE	ENDEAVOUR REIMBURSED	EXISTING DUCT USAGE CHARGE
R - S		220m	2 x 50mm 4 x 125mm	NIL	N/A	N/A	N/A
S - T		34m	2 x 50mm 4 x 125mm	NIL	N/A	N/A	N/A
P - U							NIL DEV FUNDED UNDER URS 13644 DRG. 390117
TOTAL ROUTE LENGTH		254m	TOTAL ENDEAVOUR REIMBURSED		NIL	NIL	

THE CERTIFICATION OF THIS PRODUCT IS SUPPORTED BY THE FOLLOWING KEY DOCUMENTS -

DOCUMENT NAME	NOTATION DATE
ENVIRONMENTAL IMPACT ASSESSMENT (EMS0001) - FAT0058	19.12.13
AGREEMENT FOR ENTRY, GRANT AND CREATION OF EASEMENT - FPJ5013	-
EQUIPMENT TO BE RETURNED TO ENDEAVOUR ENERGY - FPJ4252 (SWITCH GEAR TRANSFORMERS & BARE COPPER CONDUCTOR)	-
EQUIPMENT TO BE RETURNED TO ENDEAVOUR ENERGY - FPJ4253 (TREATED TIMBER POLES AND CONCRETE POLES)	19.12.13
TELECOMMUNICATION ASSET AGREEMENT - FPJ4194	-
PROJECT DEFINITION	-

SPARE DUCT REQUIREMENTS

A CONTINUOUS SPARE 125MM PVC DUCT IS TO BE INSTALLED FOR EACH VOLTAGE IN ALL TRENCHES WHERE 50 SQMM, HV. & LV. CABLES ARE INSTALLED. (IE. - MAXIMUM 1HV. & 1 LV.)

A CONTINUOUS SPARE 50MM PVC DUCT IS TO BE INSTALLED IN THE TRENCHES WHERE DUCTED SL CABLES IS TO BE INSTALLED. IN AREAS WHERE ADDITIONAL DUCTS ARE REQUIRED THE SPARE DUCT IS INCLUDED IN THE SECTION SHOWN.

FUNDING ARRANGEMENTS FOR SCOPE OF WORKS

ASP LEVEL 1 ELECTRICAL WORKS		CUSTOMER
ENDEAVOUR ENERGY SUPPLIED MATERIALS	CUSTOMER FUNDED NON-CONTESTABLE WORKS	CUSTOMER FUNDED
1 x 315 KVA 11 KV TRANSFORMER	SWITCHING, INSPECTION AND COMMISSIONING COSTS	INCLUDES BUT NOT LIMITED TO: - PEGGING OF EASEMENTS, PROPERTY BOUNDARIES AND INFRASTRUCTURE LOCATIONS - REGISTRATION OF EASEMENTS. - PROVIDING ACCESS. - OWN SERVICE & SERVICE CONNECTION. - CONFIRM FINISHED GROUND LEVELS.
ENDEAVOUR ENERGY FUNDED & CONSTRUCTED	CUSTOMER FUNDED - CONTESTABLE	- REGISTRATION OF EASEMENTS. - PROVIDING ACCESS. - OWN SERVICE & SERVICE CONNECTION. - CONFIRM FINISHED GROUND LEVELS.
WORKS REQUIRED PRIOR TO COMPLETION OF CUSTOMER CONTESTABLE PROJECT.	ALL OTHER WORKS & MATERIALS INCLUDING BUT NOT LIMITED TO: - INSTALLATION & ESTABLISHMENT OF THE PM SUBSTATION. - TRENCHING. - DUCT INSTALLATIONS. - CABLE LAYING AND/OR INSTALLATIONS. - JOINTING. - OVERHEAD INSTALLATION/REMOVALS.	- EXISTING DUCT USAGE CHARGE NIL. (REFER PVC DUCT SCHEDULE)
NIL	NIL	COORDINATION SUPPLY REQUIRED DATE (TO BE CONFIRMED WITH PROJECT MANAGER) DAY 28 MONTH 02 YEAR 2014
ENDEAVOUR ENERGY FUNDED & ASP L1 CONSTRUCTED - REIMBURSED	NIL (REFER PVC DUCT SCHEDULE)	ASSETS TO BE RETURNED TO THE NEAREST ENDEAVOUR ENERGY DEPOT BY LEVEL 1 ASP. 8 x 12.5W WOOD POLES 3 x 12.5W WOOD POLES

EX. POLE SUB. 32364	REMARKS	EX. E.E. POLE NUMBER	NEW E.E. POLE NUMBER	SPAN LENGTH (m)	LINE DEV. DEGREES (°)	HV	LV	DM (mm)	DEPTH (m)	TYPE	FOOTING REF. DATE	REMARKS	NUMBER
DRESS FOR UOQH HV TERMINATION.		862300	HJ/GCH/A25	600	1.85	12.5	0			X	7		7
		877750								X	6		6
		877749								X	4		4
		877748								X	3		3
		877747								X	2		2
		877746								X	1		1

DESIGN COMPLIANCE AND INDEMNITY

This design complies with the Endeavour Energy's relevant standards as current at the time and as listed on the Endeavour Energy Accredited Service Provider's internet site. These standards include, but are not limited to:

- GT&C : General Terms and Conditions
- EMS : Environmental Management Standard
- MCI : Mains Construction Instruction
- MDI : Mains Design Instruction
- POI : Protection Design Instruction
- SDI : Substation Design Instruction
- SAD 0001 : Design Drawing Standard
- MMI : Mains Maintenance Instruction
- SME : Substation Maintenance Instruction
- LDI 0001 : Public Lighting Electrical Design Element

Additionally, where relevant, the design complies with (Cb) - 1 "Guideline for Design and Maintenance of Overhead Distribution and Transmission Lines" published by ENA and other relevant Australian Standards.

ESTATE POWER DESIGN
 I indemnify Endeavour Energy for any loss or damage resulting from non-compliance of the design with the above standards.

Signed:
 Name: BRIAN JUDE
 Service Provider Number: 1033 Date: 14/01/2014

THIS DRAWING SUPPLIES 43 LOTS

CAP No.	FILE No.	LOT No.	No OF LOTS	DEVELOPER	DEVELOPER'S REP.	TEL No.
URS 13645	201208470/001	4251 - 4293	43	MARYLAND DEV CO.	A. ALI	8016 6520

AUTHORISATION OF ESTIMATED VALUE OF ENDEAVOUR ENERGY FUNDED ASSETS

SIGNED:
 PRINT NAME: Eugene Lorenzo
 SERVICE NUMBER: 37497
 FUNDING AMOUNT \$ 18,370.00
 DATE: 14/01/2014

CERTIFIED BY ENDEAVOUR ENERGY

AMENDMENT: A
 DATE APPROVED: 15/01/2014
 EXAMINER'S SIGNATURE:
 PRINT NAME: Eugene Lorenzo
 THIS CERTIFICATION IS ISSUED SUBJECT TO ENDEAVOUR ENERGY'S STANDARD CENT. TERMS.

APPROVAL TO CONNECT TO PUBLIC LIGHTING

Date Approved: 6/01/2014
 Reviewers Name: Dragana Hole
 Reviewers Signature:
 This approval is issued subject to Endeavour Energy's General Terms & Conditions for connection of Public Lighting and is specifically for drawing number 23/365/ER4E.

EPD REFERENCE No.
23/365/ER4E

A1 390310 A

SHEET No. 1 OF 2 SHEETS

ESTATE POWER DESIGN PTY LIMITED
 ABN 69 002 331 142
 ELECTRICAL RETICULATION CONSULTANTS
 142 SUNNYHOLT ROAD, BLACKTOWN 2148
 TEL: (02) 9621-3433 FAX: (02) 9671-7256
 EMAIL: brian@estatepower.com.au

REFERENCE DRAWINGS	WORK ORDERS	CAP / SAMP No.	URS 13645	ORIGINAL SCALE	DO NOT SCALE
390308 DUCT, EASEMENTS & TRENCHING REQ'S	GENERAL	AM PROJ No.		1:1000	DIMENSIONS IN METRES
	OVERHEAD	HV SWITCHING		DATE	14.01.14.
	UNDERGROUND	UBOP/ENQUIRY REF	MAP 144 REF. J14	CHD	B.J.
	SUBSTATIONS	GIS MAP No	7390.12	DESIGN	B.J.
		HV OP DIAGRAM	CRANESBROOK		
		LOCAL GOV AREA	PENRITH		

STAGE 4E
 LOT 4252 - HOLLY CRESCENT
 URS 13645
 JORDAN SPRINGS
 ELECTRICAL RETICULATION

COLUMN AND LUMINAIRE SCHEDULE															
ITEM I.D.	LUMINAIRE	RATE CODE	RAQS/C/LT	FOUNDATION	POLE	RATE CODE	OUTREACH	RATE CODE	UPCAST	POLE QTY	LANTERN QTY	LTO CAT	CHARGE TO		
1	42W CFL SUBURBAN ECO	JS87100L	853	TYPE 2	5.5m STANDARD	E 5.5 MAC	895	3.0 MACARTHUR	IE 3.0 SOR/MAC/25	891	5'	13	13	P4	PENRITH COUNCIL
2	150W MH SLI ROADSTER	PR42G35	800	TYPE 2	8.5m IMPACT ABSORBING	IE / IA 8.5	895	4.5 MACARTHUR	IE 4.5 SOR/MAC/32	891	5'	7	7	V6	PENRITH COUNCIL

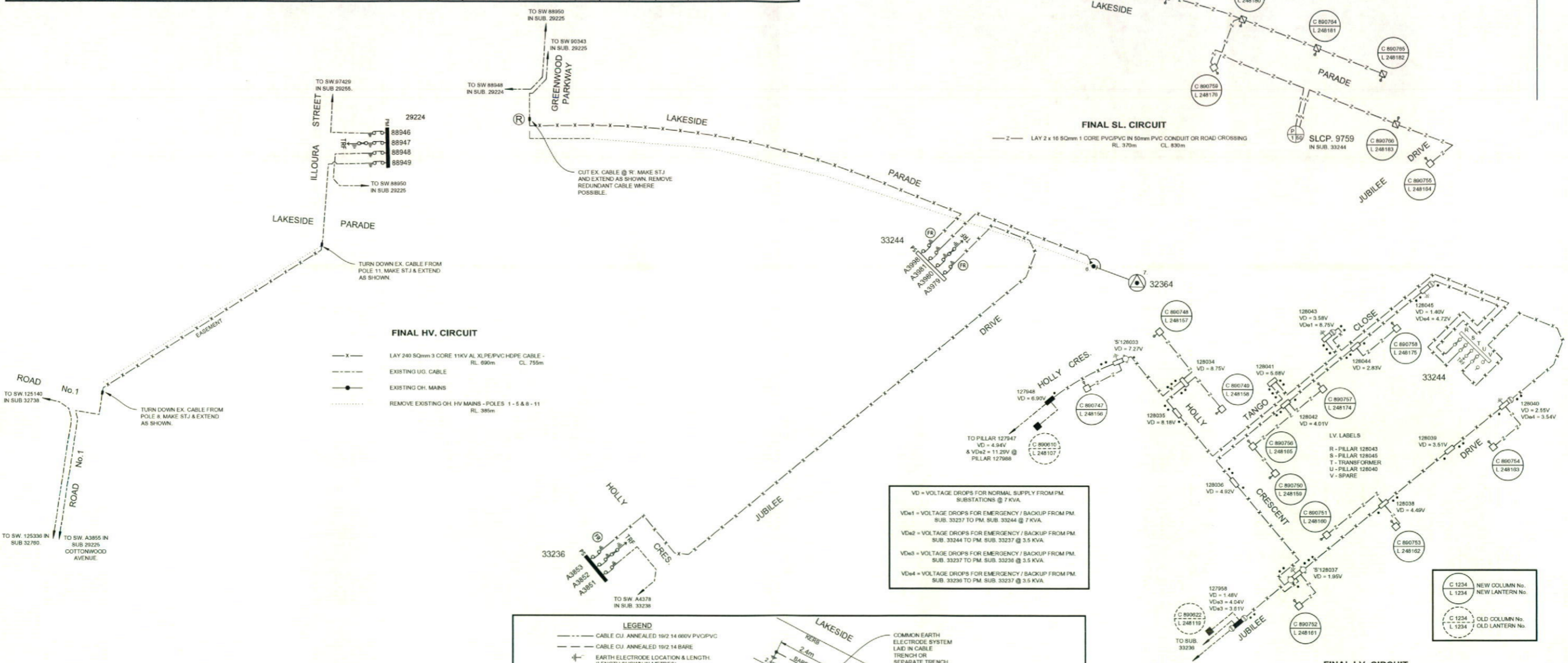

EARTHING DATA TO BE CAPTURED TO GIS	
SUBSTATION NO.	33244
INSTALLATION TYPE	UNDERGROUND
EARTHING SYSTEM TYPE	COMMON
SOIL RESISTIVITY AVERAGE IN OHMS	10 OHM METRES
HV SEPARATE EARTHING GRID RESISTANCE (SEPARATE EARTHING ONLY)	N/A
SIZE/NO. OF HV ELECTRODES (SEPARATE EARTHING ONLY)	N/A
LV SEPARATE EARTHING GRID RESISTANCE (SEPARATE EARTHING ONLY)	N/A
SIZE/NO. OF LV ELECTRODES (SEPARATE EARTHING ONLY)	N/A
COMBINED EARTH RESISTANCE IN OHMS (FOR COMMON EARTHING)	2.39 OHMS
SIZE/NO. OF COMBINED ELECTRODES (COMMON EARTHING)	2 x 2.4m
SIZE/NO. OF THE SUPPLEMENTARY ELECTRODE	1 x 4.8m
BONDING CONDUCTOR SIZE IN MM2 (INSULATED/BARE)	70 SQMM CU
CONNECTION TYPE (CAD OR CRIMP)	CRIMP
AMBIENT TEMPERATURE/WEATHER CONDITION	24°C
DATE OF SOIL TEST	31.10.13
INSULATED DEPTH FROM GROUND LEVEL (IN METRES)	0M
LENGTH OF MEN CONNECTION CABLE (IN METRES)	N/A
TOTAL LENGTH OF EARTH ELECTRODE SYSTEM CABLE (INCL. INSULATED & BARE IN METRES)	11m (APPROX)
MEASURED EARTH RESISTANCE IN OHMS (TO BE MEASURED BY L1 ASP ON COMMISSIONING)	-

ESTATE POWER DESIGN PTY LIMITED
 ABN 69 002 331 142
 ELECTRICAL RETICULATION CONSULTANTS
 142 SUNNYHOLT ROAD, BLACKTOWN 2148
 TEL: (02) 9621-3433 FAX (02) 9671-7256
 EMAIL: brian@estatepower.com.au

REFERENCE DRAWINGS	WORK ORDERS	CAP / SAMP No.	URS 13645	ORIGINAL SCALE	1:1000	DO NOT SCALE DIMENSIONS IN METRES
390308 DUCT, EASEMENTS & TRENCHING REQ'S	GENERAL	AM PROJ No.		DATE	14.01.14	DESIGN B.J.
	OVERHEAD	HV SWITCHING		CHD	B.J.	DESIGN B.J.
	UNDERGROUND	UBD/PENQUIN REF	MAP 144 REF J14			
	SUBSTATIONS	GB MAP No.	7390_12			
		HV OP DIAGRAM	CRANE BROOK			
		LOCAL GOV AREA	PENRITH			

WORK COMPLETED / FIELD BOOK

CONSTRUCTED BY: _____
 WORKS COMPLETED: _____
 SIGNATURE: _____ DATE: _____

INSPECTED BY: _____

UNDERGROUND ASSETS

INSTALLED BY: _____
 RECORDED BY: _____
 CONTACT No: _____
 SIGNATURE: _____ DATE: _____

CERTIFIED BY ENDEAVOUR ENERGY

AMENDMENT: A
 DATE APPROVED: 15/01/2014
 EXAMINER'S SIGNATURE: _____
 PRINT NAME: Eugene Lorenzo
 THIS CERTIFICATION IS ISSUED SUBJECT TO ENDEAVOUR ENERGY'S STANDARD CERT. TERMS.

EPD REFERENCE No: 23/365/ER4E

STAGE 4E
 LOT 4252 - HOLLY CRESCENT
 URS 13645
 JORDAN SPRINGS
 ELECTRICAL RETICULATION

Endeavour Energy

A1 390310 A

SHEET No. 2 OF 2 SHEETS