

Key:

Emergency Access Route	
Private Car Route	
Pedestrian Walking Route	
Event Shuttle Bus Route	
Charter/Self Organised Buses	
Taxi Route	

INGRESS

DEFQON.1 Music Festival
 Saturday 17 September 2016
SIRC Parking, Pedestrian and Vehicle Flows
Attachment 12_v14May16

SYDNEY INTERNATIONAL REGATTA CENTRE



MAP 1

- Vehicle Access Gates**
- Gate A: VIP, Artist & Shuttle Bus entry
 - Gate B: NO ENTRY – All vehicles to exit Gate B
 - Gate C: Private Vehicle Parking Entry, Taxis, Private Charters; Minibuses
 - Gate E: Emergency Vehicle Access & Private Vehicle Exit Only

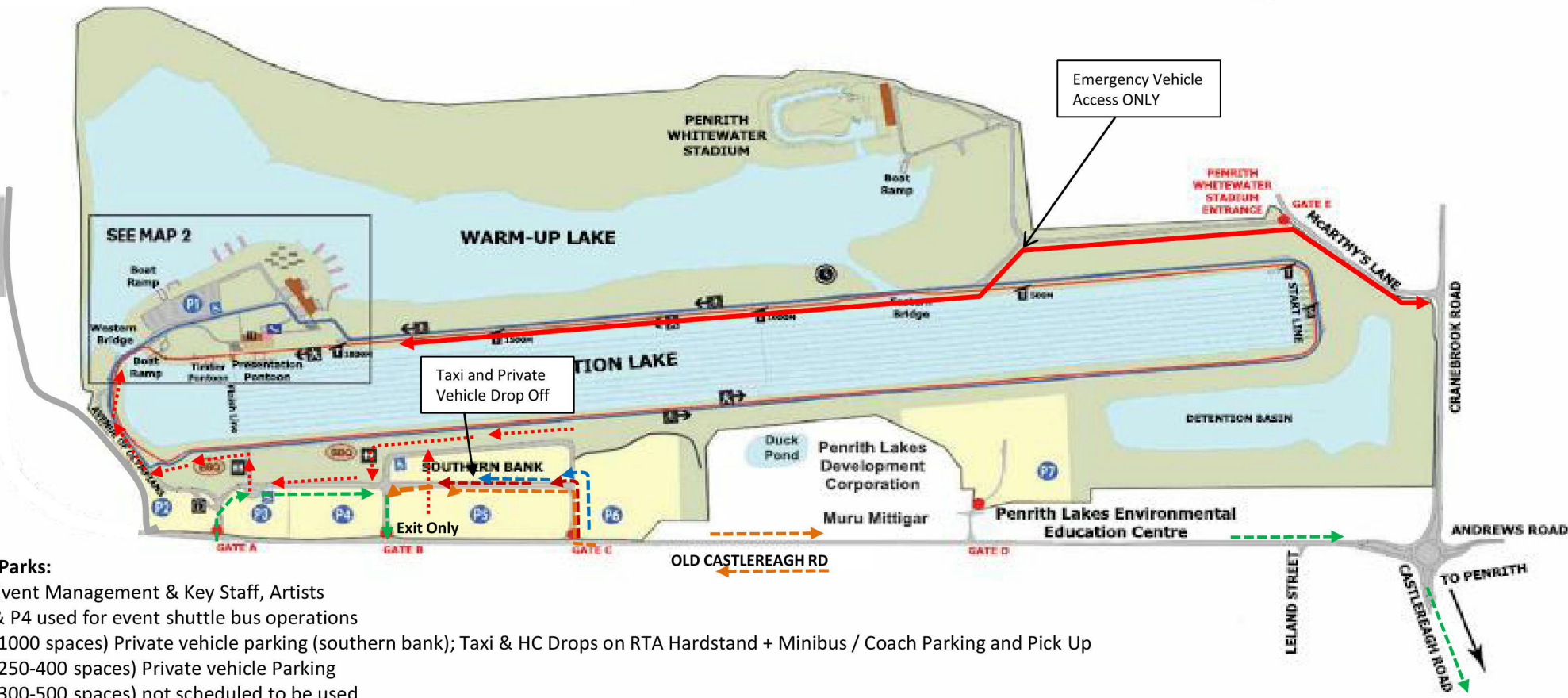

- Car Parks:**
- P2 Event Management & Key Staff, Artists
 - P3 & P4 used for event shuttle bus operations
 - P5 (1000 spaces) Private vehicle parking (southern bank); Taxi & HC Drops on RTA Hardstand + Minibus / Coach Parking and Pick Up
 - P6 (250-400 spaces) Private vehicle Parking
 - P7 (300-500 spaces) not scheduled to be used
- Document Set ID: 7193556
 Version: 1, Version Date: 07/06/2016, Sydney International Regatta Centre
 Jay Rubie RMS Card No.:0030520664 ESPA v14May16 Attachment 12

Key:

Emergency Access Route	
Private Car Route	
Pedestrian Walking Route	
Event Shuttle Bus Route	
Charter/Self Organised Buses	

EGRESS

DEFQON.1 Music Festival
 Saturday 17 September 2016
SIRC Parking, Pedestrian and Vehicle Flows
Attachment 12_v14May16

SYDNEY INTERNATIONAL REGATTA CENTRE



MAP 1

Vehicle Access Gates

- Gate A: VIP, Artist & Shuttle Bus entry
- Gate B: NO ENTRY – All vehicles to exit Gate B
- Gate C: Private Vehicle Parking Entry, Taxis, Private Charters; Minibuses
- Gate E: Emergency Vehicle Access & Private Vehicle Exit Only

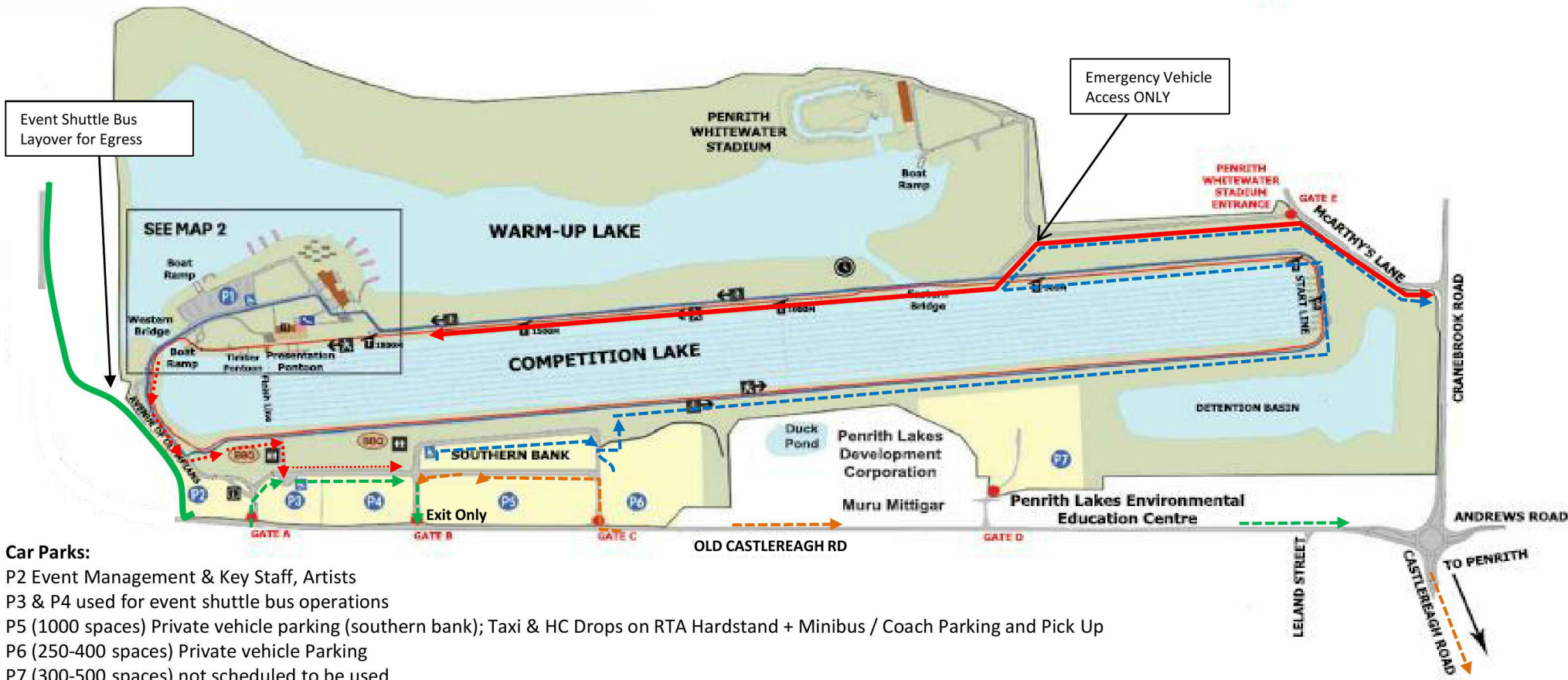

- Car Parks:**
- P2 Event Management & Key Staff, Artists
 - P3 & P4 used for event shuttle bus operations
 - P5 (1000 spaces) Private vehicle parking (southern bank); Taxi & HC Drops on RTA Hardstand + Minibus / Coach Parking and Pick Up
 - P6 (250-400 spaces) Private vehicle Parking
 - P7 (300-500 spaces) not scheduled to be used