

LOT 12
DP 1176987

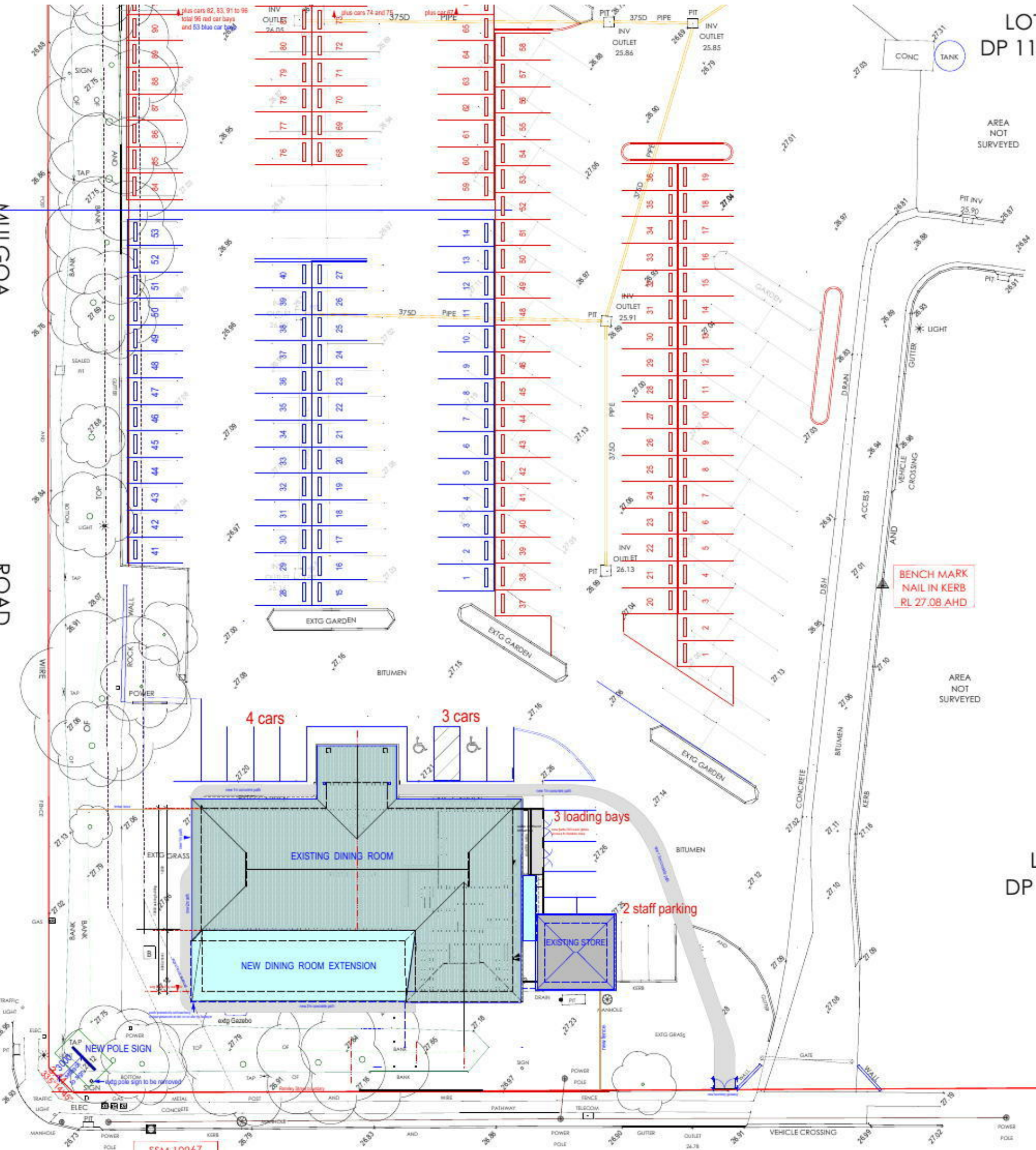

A - EASEMENT FOR PADMOUNT SUBSTATION 2.75 WIDE (DP 1035367)
 B - EASEMENT FOR SEWERAGE PURPOSES 3.5 WIDE & VARIABLE (VIDE 2929810) (DP 649076)
 C - EASEMENT FOR STORMWATER CHANNEL VARIABLE WIDTH (GOV.GAZETTE DATED 9/1/45 FOLIO 4)

LOT 12
DP 1176987



25.5.16 amended as issue SD2A to delete external Bar and covered way from Ransley Street. New gate moved to adjacent to car entrance.

ADAPTATION OF EXISTING FUNCTION CENTRE AS A NEW HOG'S BREATH CAFE AT CLUB PACEWAY CNR. MULGOA ROAD AND RANSLEY STREET, PENRITH



PROPOSED EXTENSIONS - SITE PLAN		Job No. 1753
McKay architects		drawing SD2A
ROBIN MCKAY OAM, A.S.T.C. (Arch) NSW, F.R.A.I.A. ARCHITECT Nominated Practising Architect within McKay architects NSW Architects Registration Board Registration No. 2238		ISSUE
71 RIVER ROAD, EMU PLAINS NSW 2750 PHONE: 4735 4222 MOB: 0418 272 075 robin@mckayarchitects.com	SCALE: 1:100 at A1, 1:200 at A3 DATE: 26 MAY 2016	DRAWN: RMCK TEAM