

COORDINATE SCHEDULE						
MARK	MGA COORDINATES		CLASS	PU	METHOD	STATE
	EASTING	NORTHING				
PM 41952	292 952.566	6 263 451.635	LB	0.02	SCIMS	FOUND
PM 56645	292 990.994	6 263 783.019	B	N/A	SCIMS	FOUND
SS 78866	293 239.093	6 263 579.567	LB	0.02	SCIMS	FOUND
SS 78886	292 792.498	6 263 355.546	LB	0.02	SCIMS	FOUND
MGA COORDINATES ADOPTED FROM SCIMS AS AT: 20th SEPTEMBER 2021						
MGA ZONE: 56 MGA DATUM: MGA2020 COMBINED SCALE FACTOR= 1.000121						

SCHEDULE OF SHORT LINES		
No	BEARING	DISTANCE
1	133°41'05"	40.235
2	223°41'05"	99.88
3	178°30'30"	71.34
4	159°28'20"	69.745
5	233°54'10"	41.765
6	339°28'20"	87.7
7	358°30'30"	85.62
8	301°13'10"	87.015
9	263°52'40"	66.33
10	301°13'10"	42.275
11	63°13'25"	27.88
12	92°47'40"	10.505

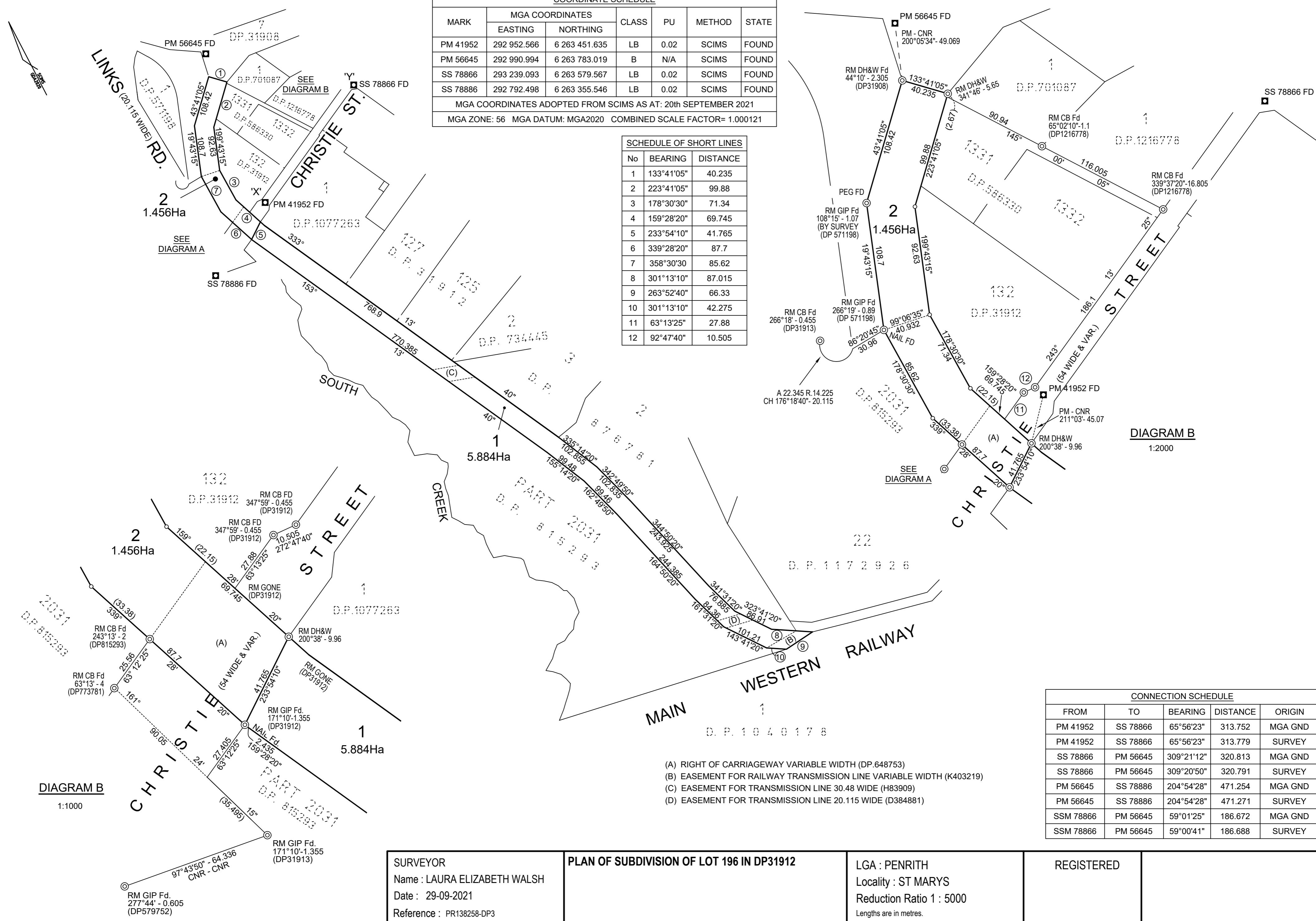

DIAGRAM B
1:1000

DIAGRAM B
1:2000

CONNECTION SCHEDULE				
FROM	TO	BEARING	DISTANCE	ORIGIN
PM 41952	SS 78866	65°56'23"	313.752	MGA GND
PM 41952	SS 78866	65°56'23"	313.779	SURVEY
SS 78866	PM 56645	309°21'12"	320.813	MGA GND
SS 78866	PM 56645	309°20'50"	320.791	SURVEY
PM 56645	SS 78886	204°54'28"	471.254	MGA GND
PM 56645	SS 78886	204°54'28"	471.271	SURVEY
SSM 78866	PM 56645	59°01'25"	186.672	MGA GND
SSM 78866	PM 56645	59°00'41"	186.688	SURVEY

- (A) RIGHT OF CARRIAGEWAY VARIABLE WIDTH (DP.648753)
- (B) EASEMENT FOR RAILWAY TRANSMISSION LINE VARIABLE WIDTH (K403219)
- (C) EASEMENT FOR TRANSMISSION LINE 30.48 WIDE (H83909)
- (D) EASEMENT FOR TRANSMISSION LINE 20.115 WIDE (D384881)

SURVEYOR Name : LAURA ELIZABETH WALSH Date : 29-09-2021 Reference : PR138258-DP3	PLAN OF SUBDIVISION OF LOT 196 IN DP31912	LGA : PENRITH Locality : ST MARYS Reduction Ratio 1 : 5000 Lengths are in metres.	REGISTERED
---	---	--	------------