

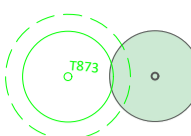

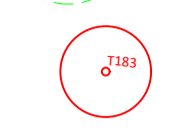



KEY PLAN







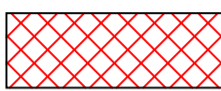
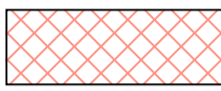



LEGEND

-  EXISTING TREES TO BE RETAINED
-  EXISTING TREES TO BE REMOVED

REVEGETATION AREAS:  
(REFER TRAVERS DOCUMENTATION FOR FULL EXTENT OF REVEGETATION ACROSS SITE)

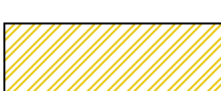
-  RIVER FLAT EUCALYPT FULL REVEGETATION
-  CUMBERLAND PLAIN WOODLAND FULL REVEGETATION
-  CUMBERLAND PLAIN WOODLAND (NO MID STOREY)

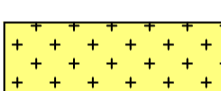
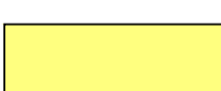
GOLF COURSE AREAS:

-  PROPOSED BUNKER
-  PROPOSED GREEN
-  PROPOSED TEE
-  PROPOSED FAIRWAY
-  PROPOSED SHORT ROUGH
-  CREEK/WETLAND EXISTING REVEGETATION WITH TRAVERS
-  LANDSCAPE PLANTING - REFER LP.02 & LP.03
-  BUSHLAND BUFFER PLANTING - REFER LP.01
-  BUFFER PLANTING WITHIN APZ - REFER LP.01
-  RIPARIAN REVEGETATION (HIGH) IN CONSULTATION WITH TRAVERS
-  MOWN LONG ROUGH (WITH TREES)
-  MOWN LONG ROUGH INCLUDING EXISTING TREES

NOTE: REFER TRAVERS 'FLORA & FAUNA SURVEY REPORT AND RESULTS' FOR DETAILS ON ALL REVEGETATION AND REGENERATION WORKS ON SITE

Issue:	Rev:	Description:	Date:
DA		FOR APPROVAL	05.12.19

Project title:  
WALLACIA COUNTRY CLUB

Drawing title:  
LANDSCAPE SITE PLAN 2 of 2

N A R E L L E S O N T E R  
**BOTANICA**  
LANDSCAPE AND HORTICULTURAL SPECIALISTS  
PO Box 911 Avonlea NSW 2107  
Tel: (02) 9918 4018 Mobile: 0419 501 144

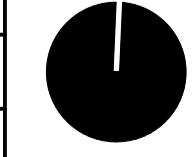
Job no: 191112		
Drawn by: EH		
Checked by: NS		
Scale: 1:1000 @ A1		Drw no: LPS.02
CAD file name:		Sheet no: 2/5
Plot date:		

**BUSHLAND BUFFER PLANTING**

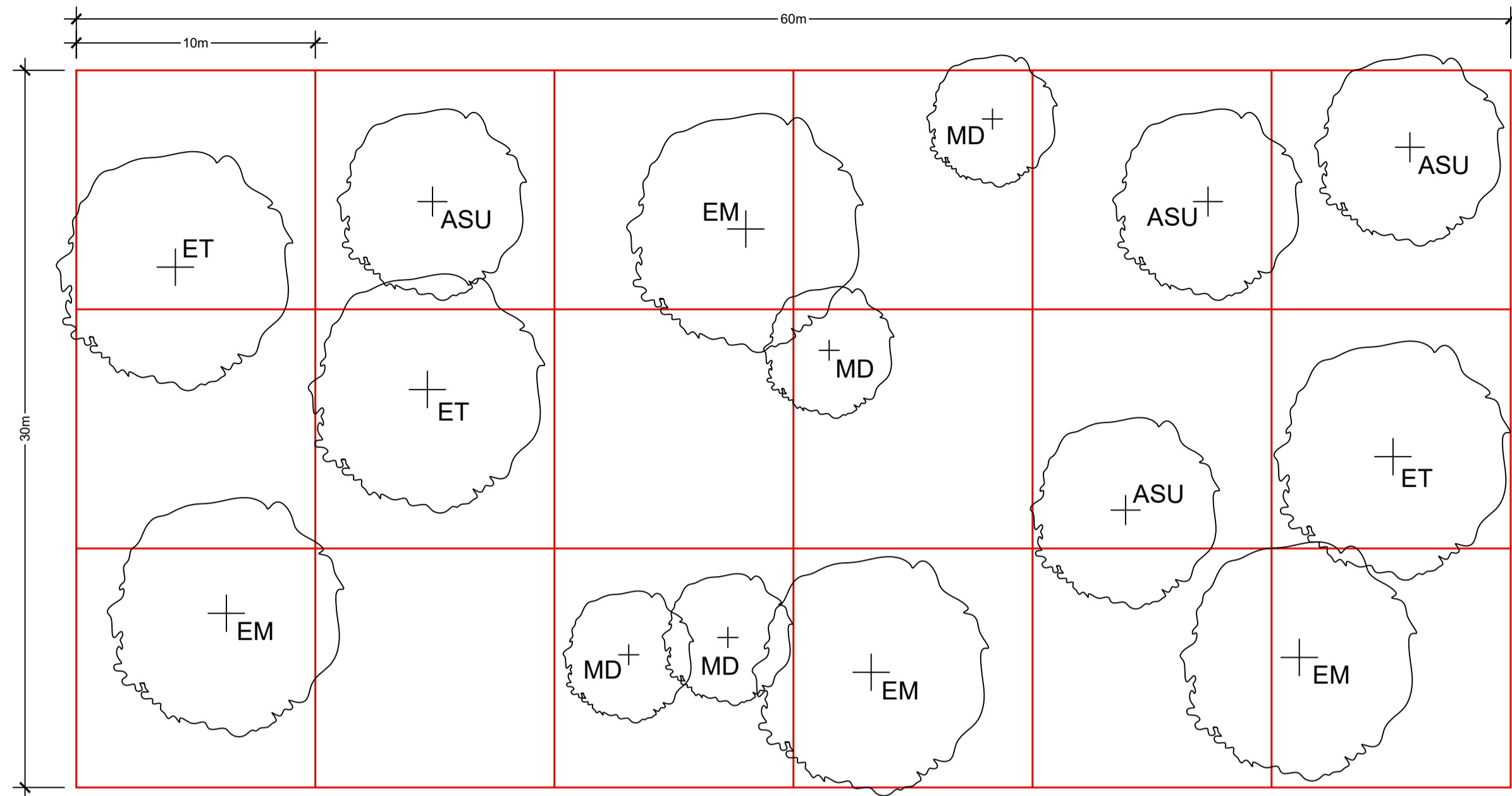

**01 INDICATIVE TREE PLANTING FORMAT**  
1:200

**PLANTING SCHEDULE**

Key	Botanical Name	Common Name	Mat Ht	Pot Size
<b>Large Cumberland Plain Woodland Trees</b>				
EM	<i>Eucalyptus moluccana</i>	Grey Box	20-25m	5 litre
ET	<i>Corymbia tereticomis</i>	Forest Red Gum	15-22m	5 litre
<b>Small Trees</b>				
ASU	<i>Angophora subvelutina</i>	Broad-Leaved Apple	15-20m	5 Litre
MD	<i>Maleleuca decora</i>	White Feather Honey	3-7m	5 litre
OR	<i>Acacia decurrens</i>	Black Wattle	4-6m	5 litre

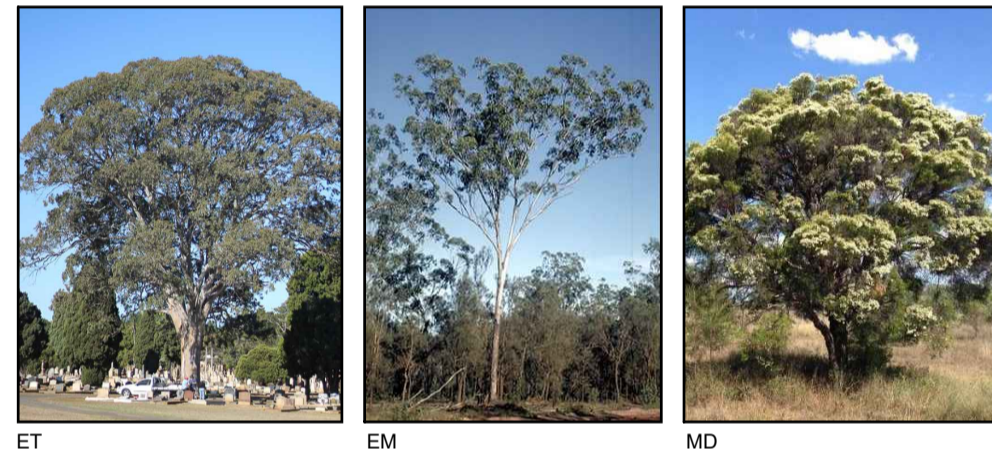

**BUFFER PLANTING WITHIN APZ**

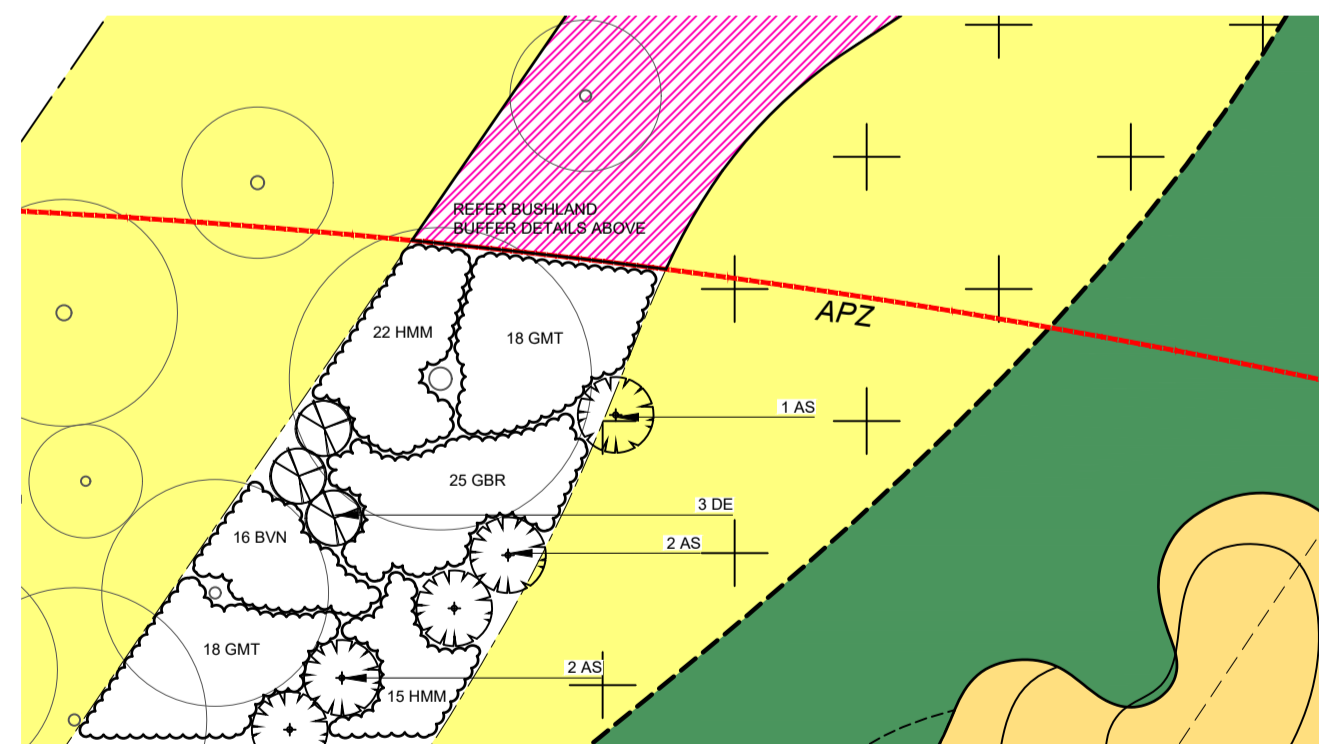

**03 INDICATIVE BUFFER PLANTING WITHIN APZ**  
1:200

**PLANTING SCHEDULE**

Key	Botanical Name	Common Name	Mat Ht	Pot Size
<b>Small and Medium Shrubs</b>				
AS	<i>Acmena 'Sublime'</i>	Sublime Lilly Pilly	2-3m	5 litre
DE	<i>Bursaria spinosa</i>	Blackthorn	2-3m	5 litre
BVN	<i>Dodonaea viscosa</i>	Hop Bush	2m	5 litre
GMT	<i>Doryanthes aequalis</i>	Cymes Lily	1.2m	5 litre
HMM	<i>Indigofera australis</i>	Native Indigo	1.5m	5 litre
WFM	<i>Phlotocha 'Flower Girl'</i>	Wax Flower	1.5m	5 litre
<b>Groundcovers</b>				
BVN	<i>Babingtonia virgata nana</i>	Dwarf Honey Myrtle	0.3m	150mm
GBR	<i>Crevillea 'Blossa Rambler'</i>	Bronze Rambler	0.2m	150mm
GMT	<i>Grevillea 'Mt Tamboritha'</i>	Mount Tamboritha	0.2m	150mm
HMM	<i>Hardenbergia 'Mini Meema'</i>	Mini Meema	0.4m	150mm
WFM	<i>Westringia 'Fulvous Mundi'</i>	Mundi	0.3m	5 litre

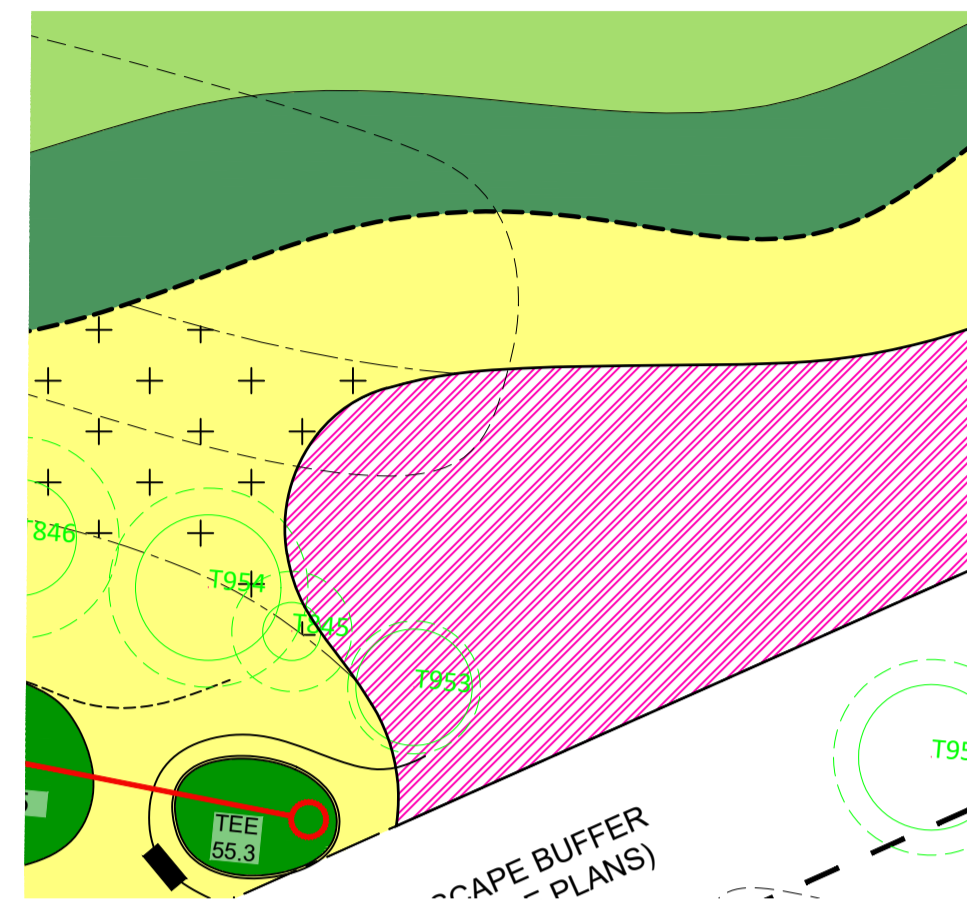

**UNDERSTOREY PLANTING (FOR TREE PLANTING PLEASE REFER TO INDICATIVE TREE PLANTING FORMAT)**

**UNDERSTOREY PLANTING SCHEDULE**

All plants to be tube stock

Key	Botanical Name	Common Name	Mature Height	Density
<b>Groundcovers and Grasses</b>				
AR	<i>Aristida ramosa</i>	Purple Wiregrass	1.2m	-
AV	<i>Aristida vagans</i>	Threeween Speargrass	0.8m	-
BA	<i>Branonella australis</i>	Blue Trumpet	0.2m	-
DL	<i>Dianella longifolia</i>	Blue Flax Lily	0.6m	-
DM	<i>Dichelachne micrantha</i>	Plume Grass	1.2m	-
DV	<i>Diemodium varians</i>	Slender Tick	0.5m	-
EO	<i>Echinopogon ovatus</i>	Forest Hedgehog Grass	1.2m	-
HV	<i>Hardenbergia violacea</i>	Native Sarsparilla	0.3m	-
GS	<i>Glycyne Spp.</i>	Twining Glycyne	0.3m	-
LM	<i>Lomandra multiflorus</i>	Many Flowered Mat Rush	0.8m	-
MS	<i>Microlophus stipoides</i>	Weeping Grass	0.4m	-
TA	<i>Themeda australis</i>	Kangaroo Grass	0.5m	-
WG	<i>Wahlenbergia gracilis</i>	Sprawling Bluebell	0.8m	-

**02 UNDERSTOREY PLANTING**  
NTS

**MOWN LONG ROUGH**

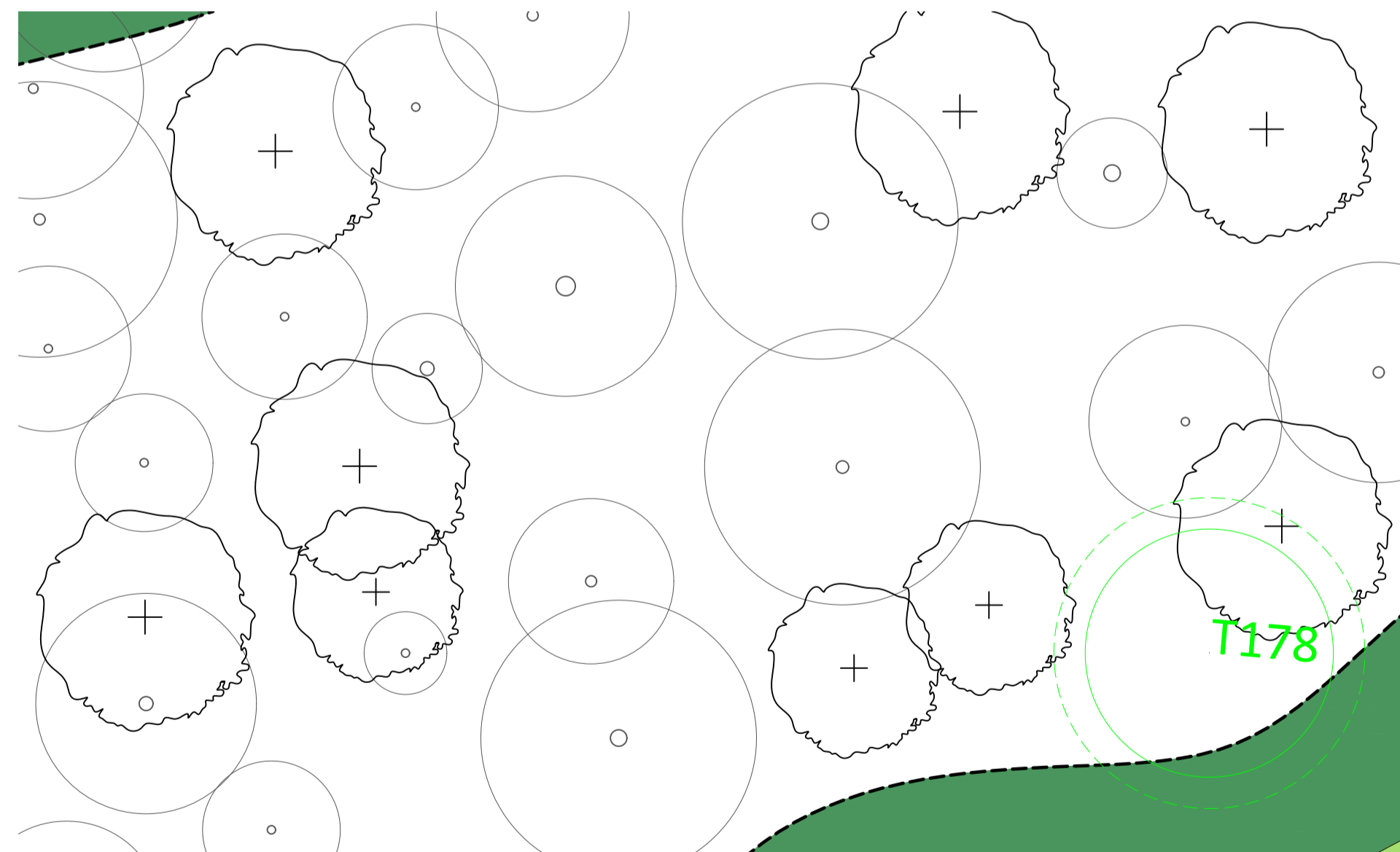

**04 INDICATIVE INFILL PLANTING - MOWN LONG ROUGH**  
1:200

**PLANTING SCHEDULE**

Key	Botanical Name	Common Name	Mat Ht
<b>Cumberland Plain Woodland</b>			
	<i>Angophora floribunda</i>	Rough-Barked Apple	25m
	<i>Angophora subvelutina</i>	Broad Leaved Apple	12-20m
	<i>Corymbia maculata</i>	Spotted Gum	15-22m
	<i>Eucalyptus amplifolia</i>	Cabbage Gum	15-20m
	<i>Eucalyptus eugenioides</i>	Thin-Leaved Stringybark	25m
	<i>Eucalyptus florosa</i>	Red Ironbark	30m
	<i>Eucalyptus globoides</i>	White Stringybark	20m
	<i>Eucalyptus moluccana</i>	Grey Box	20-25m
	<i>Eucalyptus punctata</i>	Grey Ironbark	25-30m
	<i>Eucalyptus punctata</i>	Grey Gum	25-35m
	<i>Eucalyptus tereticomis</i>	Forest Red Gum	25m
	<i>Syncairpa glaucoflora</i>	Turpentine	15-20m

**LEGEND**

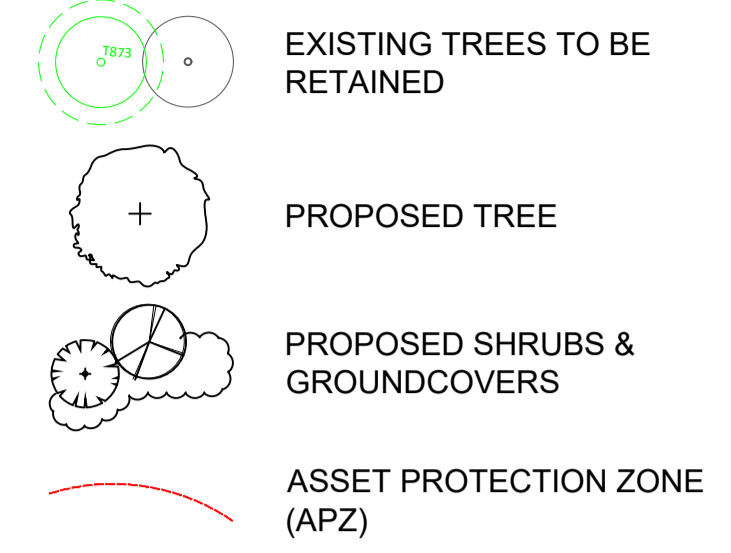

**GOLF COURSE AREAS:**

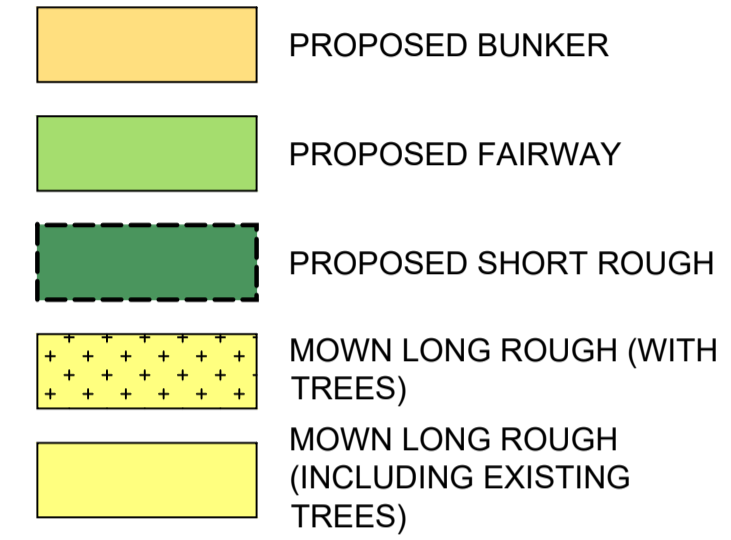

NOTE: REFER TRAVERS 'FLORA & FAUNA SURVEY REPORT AND RESULTS' FOR DETAILS ON ALL REVEGETATION AND REGENERATION WORKS ON SITE

Issue	Rev	Description	Date
DA		FOR APPROVAL	05.12.19

**Project title:**  
WALLACIA COUNTRY CLUB

**Drawing title:**  
LANDSCAPE PLANTING STYLES

N A R E L L E S O N T E R  
**BOTANICA**  
LANDSCAPE AND HORTICULTURAL SPECIALISTS

PO Box 911 Avonlea NSW 2107  
Tel: (02) 9918 4019 Mobile: 0419 501 144

<b>Job no:</b> 191112	
<b>Drawn by:</b> EH	
<b>Checked by:</b> NS	
<b>Scale:</b> AS SHOWN @ A1	<b>Drw no:</b> LP.01
<b>CAD file name:</b>	
<b>Plot date:</b>	<b>Sheet no:</b> 3/5

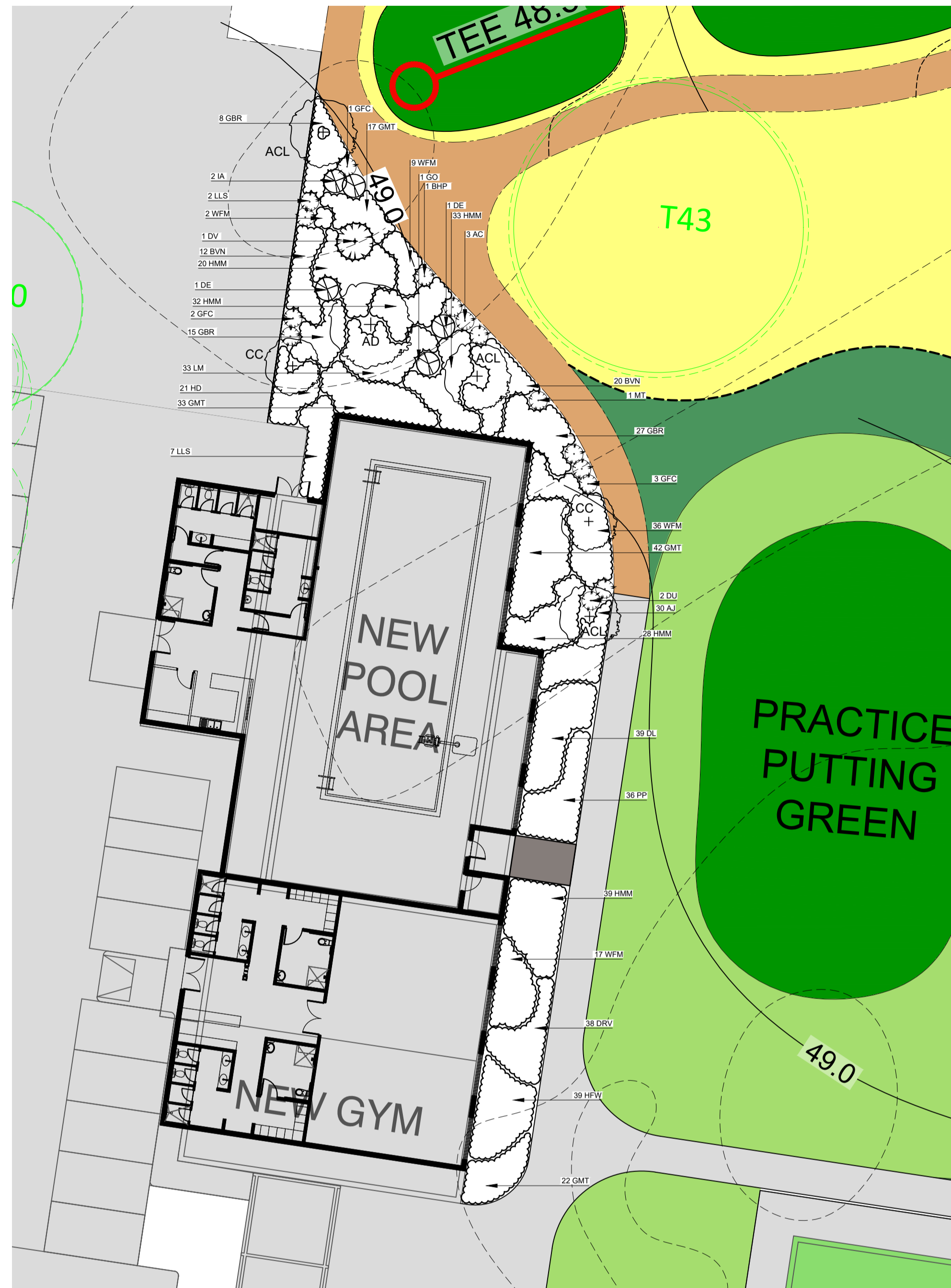

**01** DETAIL PLANTING WITHIN APZ AROUND POOL & GYM  
1:200



**02** DETAIL PLANTING WITHIN APZ - AROUND BOWLING GREEN  
1:200

**MASTER PLANTING SCHEDULE**

Key	Botanical Name	Common Name	Mat Ht	Pot Size	No's
<b>Small Trees and Large Shrubs</b>					
ACL	<i>Acacia cognata</i> 'Lime Magik'	Bower Wattle	5m	25 litre	6
AD'	<i>Acacia decurrens</i>	Black Wattle	10-15m	25 litre	1
BUS'	<i>Bursaria spinosa</i>	Blackbourn	2-3m	25 litre	3
CC	<i>Callistemon citrinus</i>	Crimson Bottlebrush	3m	25 litre	2
CIS	<i>Callistemon salignus</i>	Willow Bottlebrush	3-4m	25 litre	3
MD	<i>Melaleuca decora</i>	White Feather Honey	3-7m	25 litre	3

Key	Botanical Name	Common Name	Mat Ht	Pot Size	No's
<b>Small and Medium Shrubs</b>					
ACC	<i>Acacia cognata</i>	Little Cog	0.9m	5 litre	9
BHP	<i>Banksia spinulosa</i> 'Honey Pots'	Honey Pots	1m	5 litre	8
CAW	<i>Callistemon Anzac White</i>	Anzac White	1m	5 litre	3
DU*	<i>Dodonaea viscosa</i>	Hop Bush	2m	5 litre	6
DU*	<i>Daviesia ulicifolia</i>	Gorse Bitter Pea	1m	5 litre	4
DE	<i>Doryanthes excelsa</i>	Gymea Lily	1.2m	5 litre	11
GFC	<i>Grevillea 'Fire Cracker'</i>	Fire Cracker	1m	5 litre	16
GO*	<i>Goodenia ovata</i>	Goodenia	1.5m	5 litre	9
HGN	<i>Hymenoporum 'Gold Nugget'</i>	Gold Nugget Frangipani	0.7m	5 litre	7
IA*	<i>Indigofera australis</i>	Native Indigo	1.5m	5 litre	2
KA	<i>Kunzea ambigua</i>	Tick Bush	2-3m	5 litre	3
LLS	<i>Leptospermum 'Little Lemon Scents'</i>	Little Lemon Scents	1m	5 litre	13
LP	<i>Leptospermum polygalifolium</i>	Yellow Tea Tree	2-3m	5 litre	2
MT	<i>Melaleuca thymifolia</i>	Thyme Honey Myrtle	1m	5 litre	6
WF	<i>Westringia fruticosa</i>	Coastal Rosemary	1.5m	5 litre	5

Key	Botanical Name	Common Name	Mat Ht	Pot Size	No's
<b>Grasses</b>					
DL*	<i>Dianella longifolia</i>	Smooth Flax Lily	0.8m	150mm	93
DRV*	<i>Dianella revoluta</i>	Paroo Lily	0.6m	150mm	337
LLF*	<i>Lomandra filiformis</i>	Wattle Mat-Rush	0.4m	150mm	50
LM*	<i>Lomandra multiflora</i>	Many Flowered Mat-Rush	0.7m	150mm	179
LLT	<i>Lomandra 'Tanika'</i>	Tanika Mat-Rush	0.6m	150mm	102
<b>Groundcovers, Climbers</b>					
AJ*	<i>Ajuga australis</i>	Australian Bugle	0.2m	150mm	86
GBR	<i>Grevillea 'Bronze Rambler'</i>	Bronze Rambler	0.2m	150mm	203
GMT	<i>Grevillea 'Mt Tamboritha'</i>	Mount Tamboritha	0.2m	150mm	290
HFV	<i>Hardenbergia 'Flat White'</i>	Flat White Twining-Pea	0.2m	150mm	78
HMM	<i>Hardenbergia 'Mini Meema'</i>	Mini Meema	0.4m	150mm	389
HD'	<i>Hibbertia diffusa</i>	Guinea Flower	0.3m	150mm	171
PP	<i>Pandorea pandorana</i>	Wonga-Wonga Vine	0.3m	150mm	133
WFM	<i>Westringia fruticosa 'Mundi'</i>	Mundi	0.3m	5 litre	160

\*Cumberland Plain Woodland Species

**LEGEND**

- EXISTING TREES TO BE RETAINED
- PROPOSED TREE
- PROPOSED SHRUBS & GROUNDCOVERS

**GOLF COURSE AREAS:**

- PROPOSED BUNKER
- PROPOSED GREEN
- PROPOSED TEE
- PROPOSED FAIRWAY
- PROPOSED SHORT ROUGH
- LANDSCAPE PLANTING
- MOWN LONG ROUGH INCLUDING EXISTING TREES

NOTE: REFER TRAVERS 'FLORA & FAUNA SURVEY REPORT AND RESULTS' FOR DETAILS ON ALL REVEGETATION AND REGENERATION WORKS ON SITE

Issue	Rev	Description	Date
DA		FOR APPROVAL	05.12.19

Project title:  
WALLACIA COUNTRY CLUB

Drawing title:  
DETAIL PLANTING PLANS

N A R E L L E S O N T E R  
**BOTANICA**  
LANDSCAPE AND HORTICULTURAL SPECIALISTS

Job no: 191112	
Drawn by: EH	
Checked by: NS	Drw no: LP.02
Scale: AS SHOWN @ A1	
CAD file name:	Sheet no: 4/5
Plot date:	

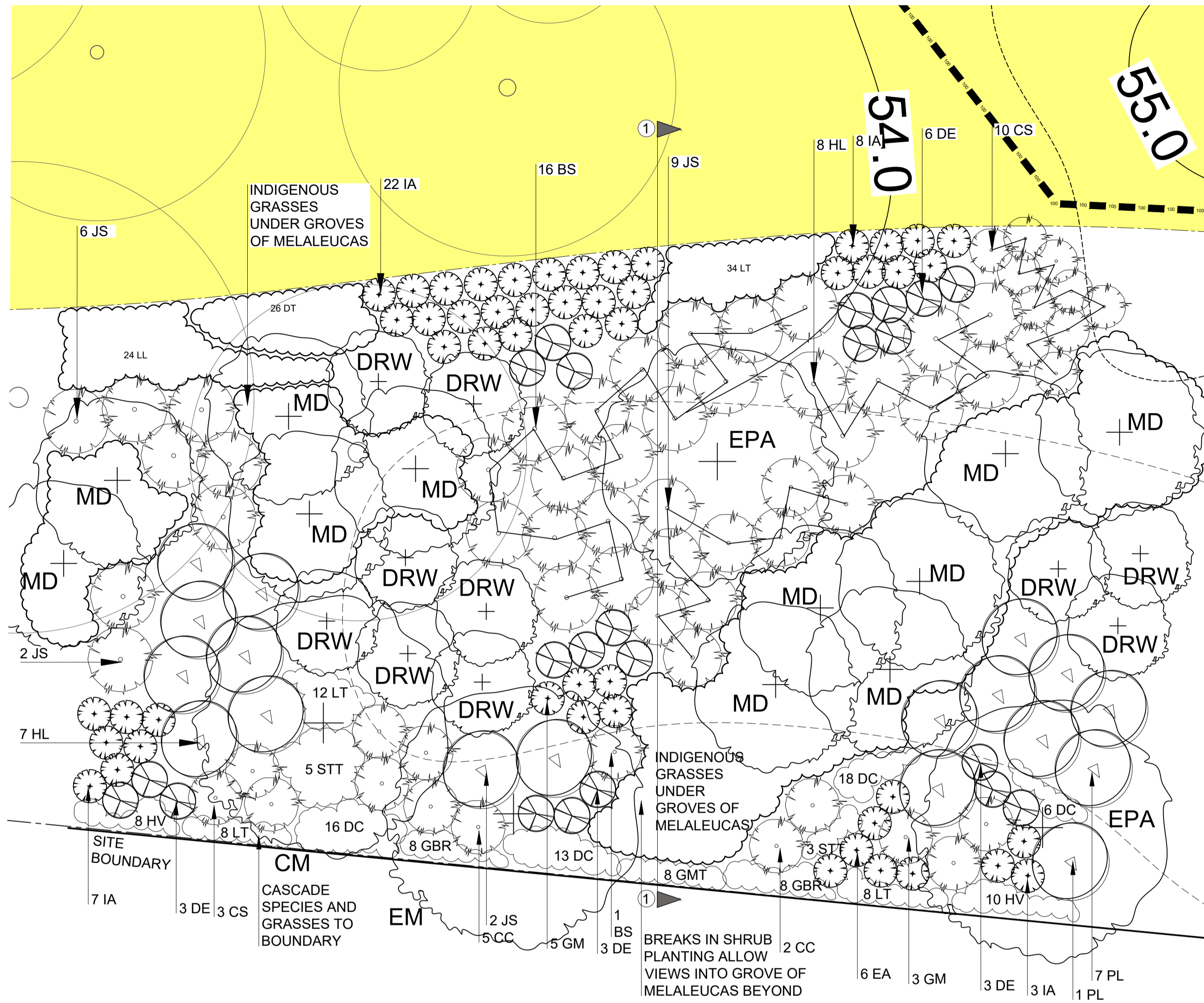

01 INDICATIVE PLANTING - PARK ROAD BOUNDARY  
1:100

02 SECTION 1-1  
1:100

PLANTING SCHEDULE

Key Botanical Name	Common Name	Mat Ht	Pot Size	Key Botanical Name	Common Name	Mat Ht	Pot Size	Key Botanical Name	Common Name	Mat Ht	Pot Size
<b>Large Trees</b>				<b>Small and Medium Shrubs</b>				<b>Grasses</b>			
CM* <i>Corymbia maculata</i>	Spotted Gum	15-22m	25 litre	ACC <i>Acacia cognata</i>	Little Cog	0.9m	5 litre	AR* <i>Arzilda ramosa</i>	Three-Awn Speargrass	0.5m	150mm
EM* <i>Eucalyptus moluccana</i>	Grey Gum	20-25m	25 litre	BHP <i>Banksia spinulosa 'Honey Pot'</i>	Honey Pots	1m	5 litre	CSP* <i>Carex spp.</i>	Tall Sedge	1m	150mm
EPA* <i>Eucalyptus punctata</i>	Grey Gum	25-35m	25 litre	CAW <i>Callistemon 'Anzac White'</i>	Anzac White	1m	5 litre	CG* <i>Cyperus gracilis</i>	Slender Flat Sedge	1.2m	150mm
				DV* <i>Dodonaea viscosa</i>	Hop Bush	2m	5 litre	CT* <i>Chloris fruticosa</i>	Windmill Grass	0.5m	150mm
				DU* <i>Daviesia ulicifolia</i>	Gorse Sitter Pea	1m	5 litre	DL* <i>Dianella longifolia</i>	Smooth Flax Lily	0.8m	150mm
				DS* <i>Dillwynia sieberi</i>	Parrot Pea	1.5m	5 litre	DRV* <i>Dianella revoluta</i>	Parrot Lily	0.6m	150mm
				DE <i>Doryanthes excelsa</i>	Gymea Lily	1.2m	5 litre	EC* <i>Echinopogon caespitosus</i>	Tufted Hedgehog Grass	0.6m	150mm
				EA <i>Eriostemon australis</i>	Pink Wax Flower	1.2m	5 litre	F* <i>Festuca</i>	Common Rush	1m	150mm
				GFC <i>Grevillea 'Fire Cracker'</i>	Fire Cracker	1m	5 litre	LLF* <i>Lomandra filiformis</i>	Wattle Mat-Rush	0.4m	150mm
				GU* <i>Grevillea juniperina</i>	Prickly Spider Flower	2m	5 litre	LLT* <i>Lomandra multiflora</i>	Many Flowered Mat-Rush	0.7m	150mm
				GM* <i>Grevillea mucronata</i>	Green Spider Flower	1.2m	5 litre	LT* <i>Lonicera 'Tango'</i>	Tenika Mat-Rush	0.6m	150mm
				GO* <i>Goodenia ovata</i>	Goodenia	1.5m	5 litre	MS* <i>Microsaena stipoides</i>	Weeping Grass	0.4m	150mm
				GS* <i>Grevillea sericea</i>	Pink Spider Flower	1.2m	5 litre	PCL* <i>Phalaenoxylon</i>	Common Tussock Grass	0.6m	150mm
				HGN <i>Hymenopogon 'Gold Nugget'</i>	Gold Nugget Frangipani	0.7m	5 litre	SG* <i>Stypania glauca</i>	Nodding Blue Lily	1m	150mm
				IA* <i>Indigofera australis</i>	Native Indigo	1.5m	5 litre	TA* <i>Themeda australis</i>	Kangaroo grass	1m	150mm
				KA <i>Kunzea ambigua</i>	Tick Bush	2-3m	5 litre				
				LLS <i>Leptospermum 'Little Lemon Scents'</i>	Little Lemon Scents	1m	5 litre				
				LP <i>Leptospermum polygallifolium</i>	Yellow Tea Tree	2-3m	5 litre				
				MT <i>Melaleuca thymifolia</i>	Thyme Honey Myrtle	1m	5 litre				
				OD <i>Ozothamnus diosmifolium</i>	Sago Flower	2m	5 litre				
				PPG <i>Philothea 'Flower Girl'</i>	Wax Flower	1.5m	5 litre				
				PV* <i>Pultenaea villosa</i>	Willowow	0.5-2m	5 litre				
				WF <i>Westringia fruticosa</i>	Coast Rosemary	1.5m	5 litre				

\*Cumberland Plain Woodland Species

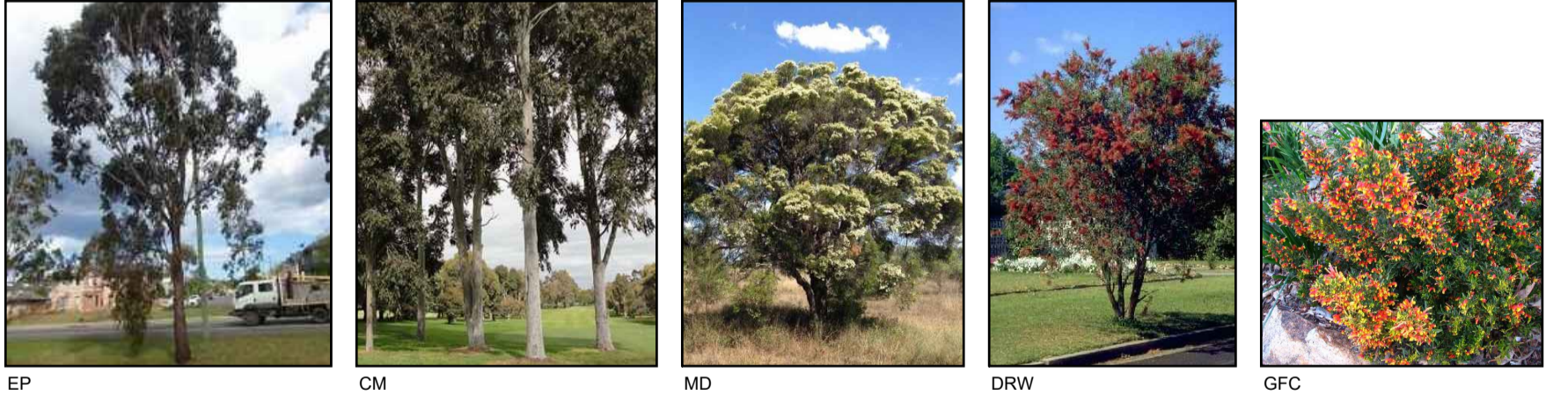

**LEGEND**

- EXISTING TREES TO BE RETAINED
- PROPOSED TREE
- PROPOSED SHRUBS & GROUNDCOVERS

**GOLF COURSE AREAS:**

- MOWN LONG ROUGH (INCLUDING EXISTING TREES)

NOTE: REFER TRAVERS 'FLORA & FAUNA SURVEY REPORT AND RESULTS' FOR DETAILS ON ALL REVEGETATION AND REGENERATION WORKS ON SITE

Issue:	Rev:	Description:	Date:
DA		FOR APPROVAL	05.12.19

Project title:  
**WALLACIA COUNTRY CLUB**

Drawing title:  
**INDICATIVE PLANTING PLAN - PARK ROAD BOUNDARY**

**N A R E L L E S O N T E R**  
**BOTANICA**  
LANDSCAPE AND HORTICULTURAL SPECIALISTS

PO Box 911 Aviation NSW 2107  
Tel: (02) 9918 4018 Mobile: 0419 501 144

Job no: 191112		
Drawn by: EH		
Checked by: NS		
Scale: AS SHOWN @ A1		Drw no: LP.03
CAD file name:		Sheet no: 5/5