

LEGEND	
KEY	DESCRIPTION
	PROPOSED SUBMERSIBLE IRRIGATION PUMP IN TANK
	IRRIGATION CONTROLLER
	IRRIGATION PUMP & SUMP PUMP CONTROL PANEL
	IRRIGATION RAIN SENSOR
	10kL DIVERSION PIT AND SUMP PUMP
	WATER METER ASSEMBLY - POTABLE WATER SUPPLY
	IRRIGATION SOLENOID CONTROL VALVE ASSEMBLY
	POTABLE WATER SUPPLY
	IRRIGATION MAINLINE PIPE
	STORMPRO DRAINAGE PIPE MAIN LINE
	CARRIER DRAINS AND 50mm SLOTTED AG PIPE (NO SOCK) IN THE TRENCH
	PE100 PN10 PE100 POLY PIPE FOR SUMP PUMP DISCHARGE AND ROOF STORM WATER
	RAINBIRD 8005 #16 SPRINKLERS, FULL CIRCLE 360°
	RAINBIRD 8005 #16 SPRINKLERS, HALF CIRCLE 180°
	RAINBIRD 8005 #12 SPRINKLERS, FULL CIRCLE 360°

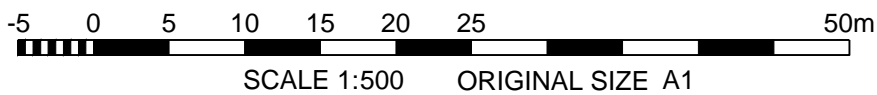
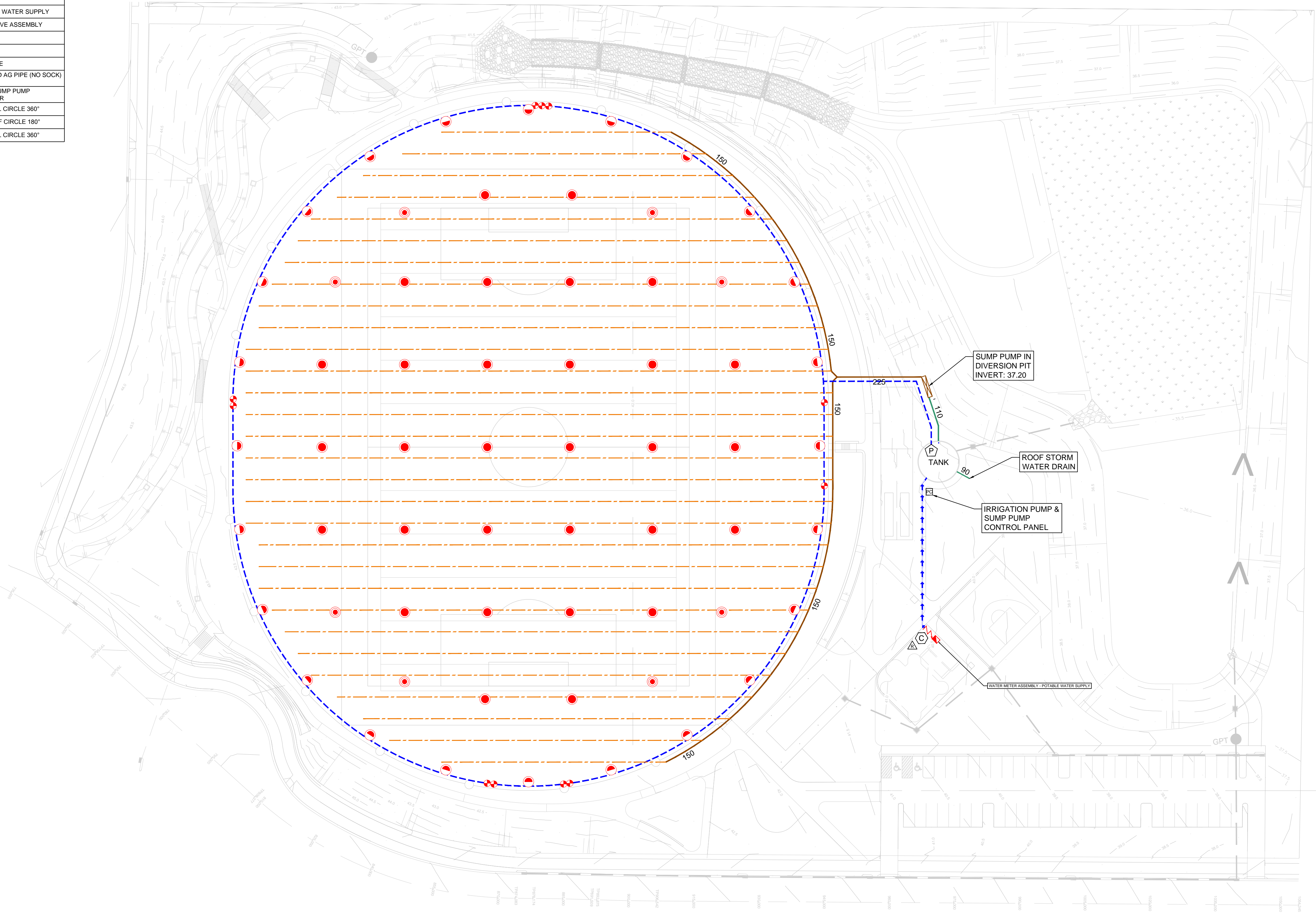

REV	ISSUED	D.DWN	APRVD	REVISION DESCRIPTION
2	15/11/2017	HR	JN	100% DETAILED DESIGN, ISSUE FOR CONSTRUCTION CERTIFICATE
1	10/11/2017	HR	JN	CONCEPT DESIGN FOR CLIENT REVIEW

REV	ISSUED	D.DWN	APRVD	REVISION DESCRIPTION

HYDROPLAN

<http://hydroplan.com.au>

PERTH ADELAIDE MELBOURNE SYDNEY BRISBANE BEIJING

COPYRIGHT
This document is and shall remain the property of HYDRO-PLAN PTY. LTD. The document may only be used for the purpose for which it was commissioned and in accordance with the terms of engagement for the commission.

The arrangement and general details as shown on this drawing are essentially diagrammatic and must be applied to the circumstances as found on site.

DRAWN:	HR
DESIGN:	HR
CHECKED:	JN
APPROVED:	JN
DRAFT REF:	3-PDG-d2

CLIENT:	CADDENS HILL
PROJECT:	IRRIGATION, DRAINAGE AND STORM WATER OVERALL PLAN
DRAWING No.	14304-001
SHEET	1 OF 4
REVISION	2

LEGEND	
KEY	DESCRIPTION
	PROPOSED SUBMERSIBLE IRRIGATION PUMP IN TANK
	IRRIGATION CONTROLLER
	IRRIGATION PUMP & SUMP PUMP CONTROL PANEL
	IRRIGATION RAIN SENSOR
	WATER METER + DOUBLE CHECK VALVE ASSEMBLY - POTABLE WATER SUPPLY
	RAINBIRD 200-PEB SOLENOID CONTROL VALVE ASSEMBLY
	DN50 PN12.5 PE100 POTABLE WATER SUPPLY
	PN10 PE100 IRRIGATION MAINLINE PIPE
	PN8 PE100 IRRIGATION LATERAL PIPE
	RAINBIRD 8005 #16 SPRINKLERS, FULL CIRCLE 360°
	RAINBIRD 8005 #16 SPRINKLERS, HALF CIRCLE 180°
	RAINBIRD 8005 #12 SPRINKLERS, FULL CIRCLE 360°
	POWER CABLE
	CONTROL OR SIGNAL CABLE IN POLY PIPE CONDUIT

SPRINKLER TABLE						
KEY	MAKE	MODEL	NOZZLE, #	DESIGN, (kPa)	Max. Radius, (m)	FLOW, (LPM)
	RainBird	8005	#12	550	18.5	53.65
	RainBird	8005	#16	550	20.4	70.28

FLOW TABLE						
Valve No	Valve Size	Flow, LPM	No of SPKS	PRESSURE (kPa)	PRECIP RATE (mm/hr)	RUN TIME** (min)
V1	200-FEB 2"	422	6	550	10.13	59
V2	200-FEB 2"	422	6	550	20.26	27
V3	200-FEB 2"	422	6	550	10.13	59
V4*	200-FEB 2"	215	4	550	9.41	64
V5	200-FEB 2"	422	6	550	20.26	27
V6	200-FEB 2"	422	6	550	10.13	59
V7	200-FEB 2"	422	6	550	10.13	59
V8	200-FEB 2"	422	6	550	20.26	27
V9	200-FEB 2"	422	6	550	20.26	27
V10	200-FEB 2"	422	6	550	10.13	59
V11*	200-FEB 2"	215	4	550	9.41	64

* VALVE 4 AND 11 ARE RUNNING SIMULTANEOUSLY
** RUN TIME CALCULATED TO APPLY 10mm. ACTUAL SCHEDULE TO BE CALCULATED BASED ON PLANT WATER REQUIREMENTS AND SHOULD BE ADJUSTED FOR SEASONAL VARIATION.

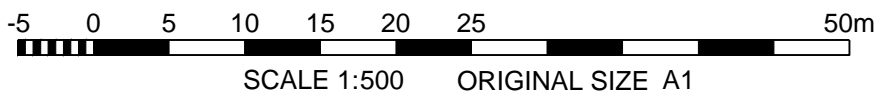
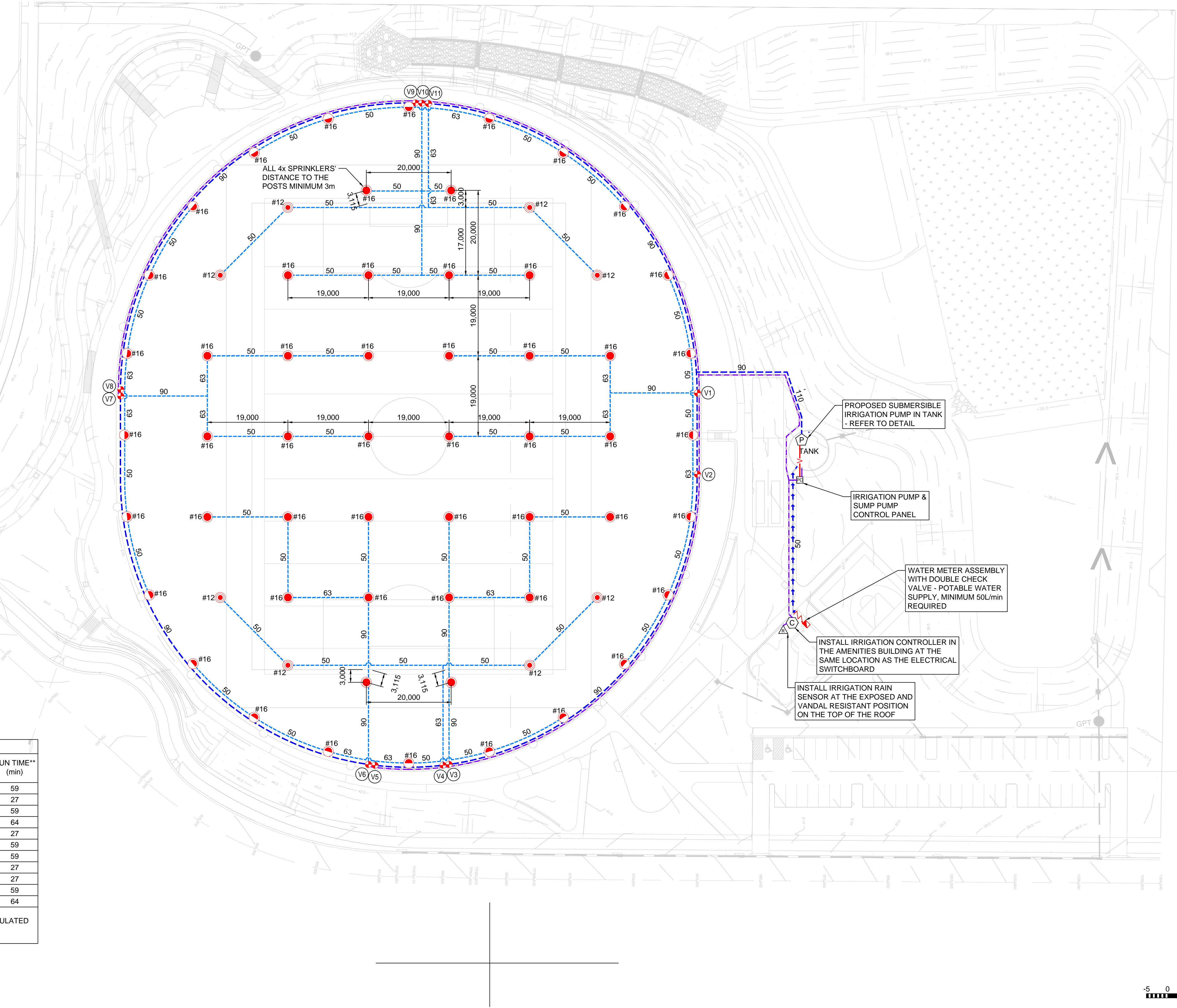

REV	ISSUED	D.DWN	APRVD	REVISION DESCRIPTION	REV	ISSUED	D.DWN	APRVD	REVISION DESCRIPTION
1	15/11/2017	HR	JN	100% DETAILED DESIGN, ISSUE FOR CONSTRUCTION CERTIFICATE	-				

HYDROPLAN

http://hydroplan.com.au

PERTH ADELAIDE MELBOURNE SYDNEY BRISBANE BEIJING

COPYRIGHT
This document is and shall remain the property of HYDRO-PLAN PTY. LTD. The document may only be used for the purpose for which it was commissioned and in accordance with the terms of engagement for the commission.

The arrangement and general details as shown on this drawing are essentially diagrammatic and must be applied to the circumstances as found on site.

DRAWN:	HR	CLIENT:	CADDENS HILL		
DESIGN:	HR	PROJECT:	IRRIGATION, DRAINAGE AND STORM WATER IRRIGATION PLAN		
CHECKED:	JN	APPROVED:	JN	DRAWING No.	14304-002
DRAFT REF:	3-PDG-d2	SHEET	2	OF	4
		REVISION			1

LEGEND	
KEY	DESCRIPTION
	IRRIGATION PUMP & SUMP PUMP CONTROL PANEL
	10kL DIVERSION PIT AND SUMP PUMP
	STORMPRO DRAINAGE PIPE MAIN LINE
	CARRIER DRAINS AND 50mm SLOTTED AG PIPE (NO SOCK) IN THE TRENCH
	POWER CABLE
	CONTROL OR SIGNAL CABLE IN POLY PIPE CONDUIT
	PE100 PN10 PE100 POLY PIPE: FOR SUMP PUMP DISCHARGE AND ROOF STORM WATER

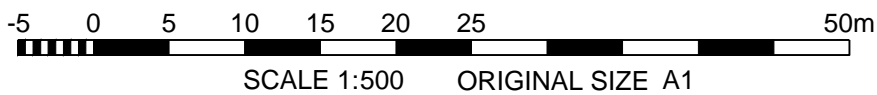
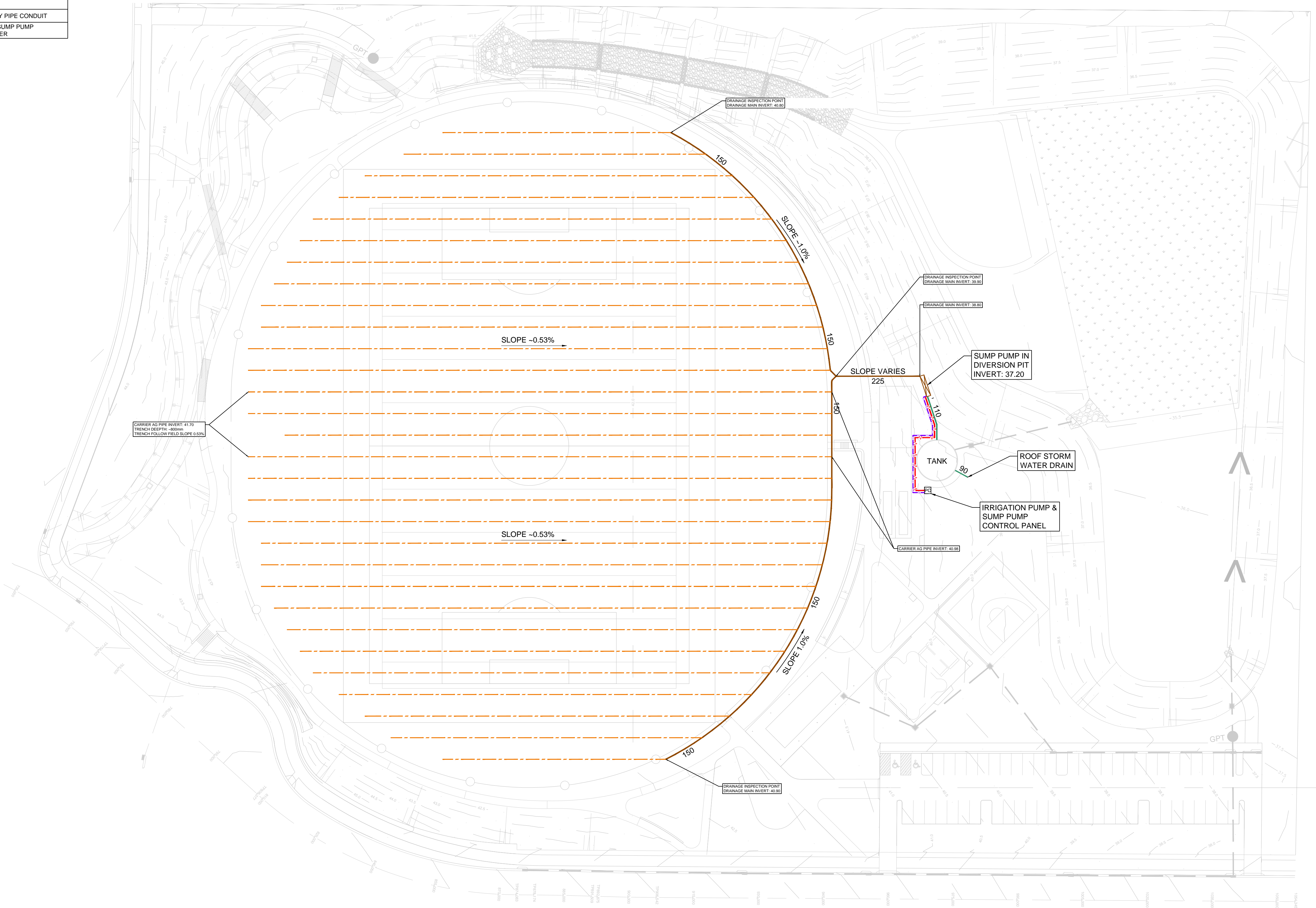

REV	ISSUED	D.DWN	APRVD	REVISION DESCRIPTION	REV	ISSUED	D.DWN	APRVD	REVISION DESCRIPTION
1	15/11/2017	HR	JN	100% DETAILED DESIGN, ISSUE FOR CONSTRUCTION CERTIFICATE	-				-



<http://hydroplan.com.au>

PERTH ADELAIDE MELBOURNE SYDNEY BRISBANE BEIJING

COPYRIGHT
This document is and shall remain the property of HYDRO-PLAN PTY. LTD. The document may only be used for the purpose for which it was commissioned and in accordance with the terms of engagement for the commission.

The arrangement and general details as shown on this drawing are essentially diagrammatic and must be applied to the circumstances as found on site.

DRAWN:	HR	CLIENT:	CADDENS HILL		
DESIGN:	HR	PROJECT:	IRRIGATION, DRAINAGE AND STORM WATER DRAINAGE AND STORM WATER PLAN		
CHECKED:	JN	APPROVED:	JN	DRAFT REF:	3-PDG-d2
DRAWING No.	14304-003	SHEET	3	OF	4
REVISION	1				



NOTE

1. REFER TO DRAINAGE LAYOUT FOR SLOPES
2. CONFIRM GROWING MEDIA IS FREE DRAINING WITH ACCEPTABLE HYDRAULIC CONDUCTIVITY AND TO LANDSCAPE ARCHITECT'S SPECIFICATION. SUBMIT SAMPLE WITH SOIL ANALYSIS FOR APPROVAL PRIOR BY CONSULTANT TO CONSTRUCTION.



NOT TO SCALE

1. UNDERGROUND IRRIGATION WATER TANK.
2. LOCK-UP ACCESS HATCH (2X).
3. SUBMERSIBLE PUMP ASSEMBLY, PUMP DUTY 420L/min @ 700kPa, DETAIL TO IRRIGATION SPECIFICATION.
4. DN80 GALVANISED STEEL (OR 316 SS) PIPE AND FITTINGS
5. PVC SHROUD AND SWIRL PLATE.
6. CHECK VALVE.
7. DN90 PN10 PE100 IRRIGATION MAINLINE PIPE AND FITTINGS.
8. 150mm OVERFLOW WITH 300mm AIR GAP TO AS3500.
9. BERMAD 700 SERIES VALVE CONTROL VALVE IN VALVE BOX.
10. 400L WATER TANK. IF THE WATER TANK, INSTALL DOUBLE CHECK VALVE AFTER WATER METER.
11. LOW LEVEL PUMP STOP TRANSDUCER
12. DN110 SUMP PUMP DISCHARGE PIPE
13. DN90 ROOF STORM WATER INLET



NOTE: SUMP & PUMP DETAIL TO DRAINAGE
TECHNICAL SPECIFICATION



- NOTE:
1. INSTALL DETECTION TAPE WITH TRACE WIRE IN MAINLINE TRENCH
 2. APPLY 50mm BEDDING SAND TO BOTTOM OF TRENCH, INSTALL PIPE AND COVER WITH 150mm SAND ABOVE PIPE.
 3. FINAL LAYER TO BE FLUSH WITH SURROUNDING GROUND.



1	15/11/2017	HR	JN	100% DETAILED DESIGN, ISSUE FOR CONSTRUCTION CERTIFICATE	-				-
REV	ISSUED	D.DWN	APRVD	REVISION DESCRIPTION	REV	ISSUED	D.DWN	APRVD	REVISION DESCRIPTION



PERTH ADELAIDE MELBOURNE SYDNEY BRISBANE BEIJING

COPYRIGHT

This document is and shall remain the property of HYDRO-PLAN PTY. LTD. The document may only be used for the purpose for which it was commissioned and in accordance with the terms of engagement for the commission.

The arrangement and general details as shown on this drawing are essentially diagrammatic and must be applied to the circumstances as found on site.

DRAWN:	HR	CLIENT: CADDENS HILL					
DESIGN:	HR						
CHECKED:	JN	PROJECT: IRRIGATION, DRAINAGE AND STORM WATER INSTALLATION DETAILS					
APPROVED:	JN						
DRAFT REF:	3-PDG-d2	DRAWING No.	14304-004	SHEET	4 OF 4	REVISION	1