

PLAN – FIRST FLOOR SLAB

Overlap fabric one whole uncut wire panel plus 25mm minimum at splices.

Note:
Provide 1 row of temporary props below midspan of Bondek sheeting.

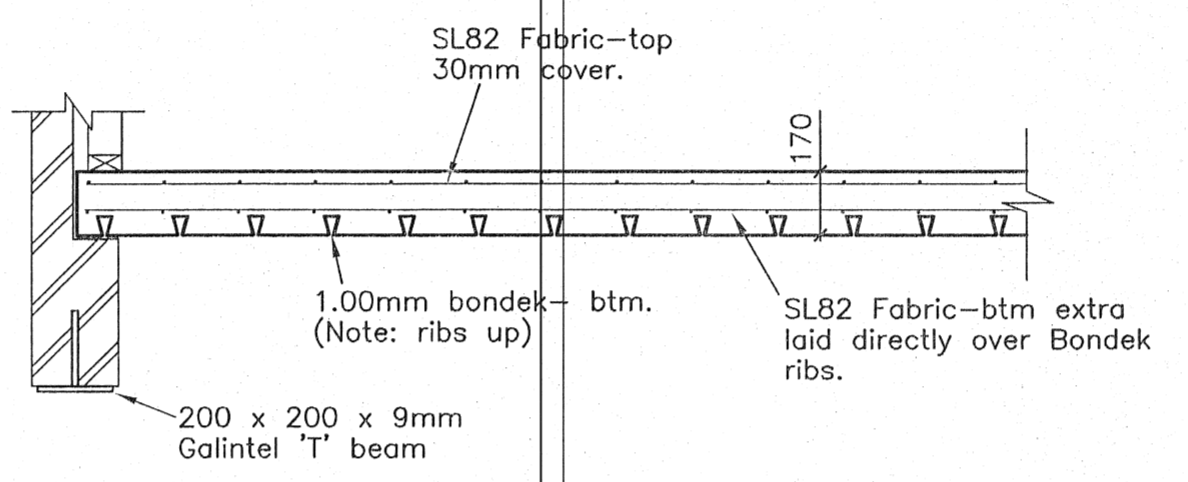

SECTION A-A

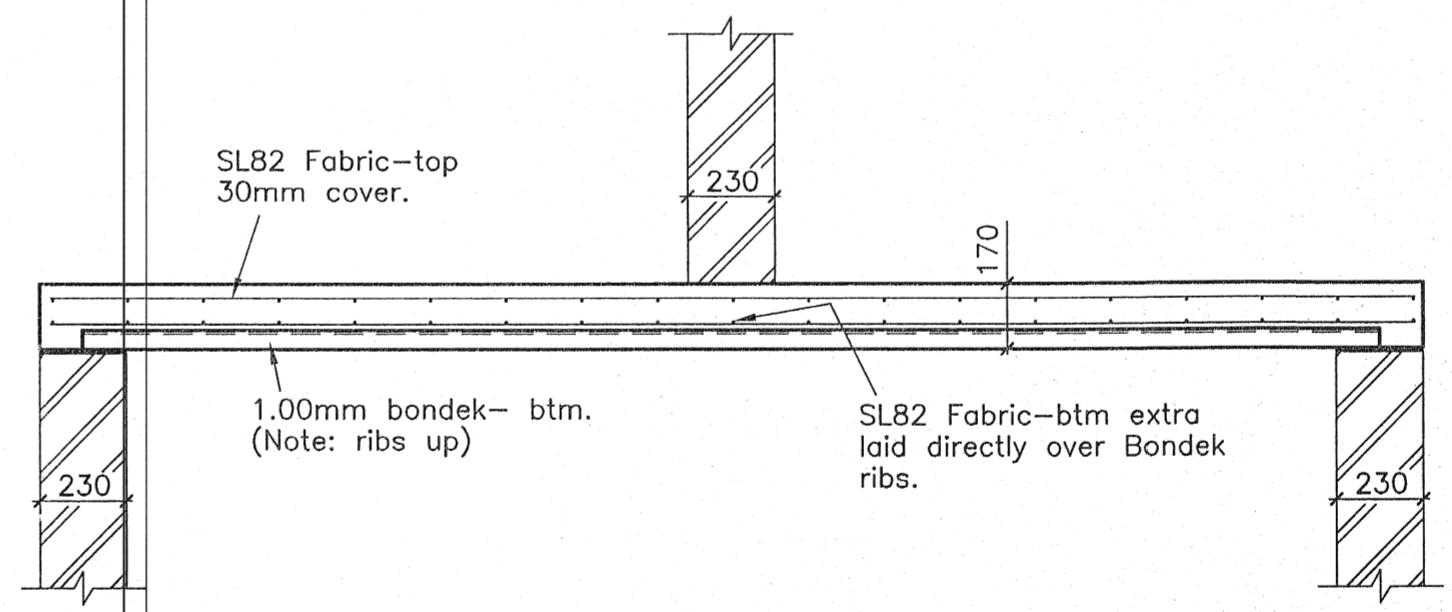

SECTION B-B

NOTES:

- This drawing is to be read in conjunction with the Architectural drawing and specifications.
- All concrete and workmanship to be in accordance with AS3600

SLAB	
Characteristic Strength	25MPa
Slump	80mm
Maximum Aggregate Size	20mm
- Concrete in slabs to be mechanically vibrated during placing.
- Cure concrete in slabs by keeping constantly damp for at least 5 days after placing.
- Reinforcement to be supported on bar chairs spaced at every 5th wire in both directions.
- Steel trowel brick bearing surfaces smooth and cover with "ALCOR" or equivalent before placing membrane.
- Termite protection to be in accordance with AS3660.1-1995 and Council's requirements.
- Construction requirements and site maintenance outlined in AS2870-1996 are to be followed. Performance expectations set out in AS2870-1996 Appendix B are acceptable. Refer also to CSIRO Information Sheet 10-91 "Guide to house owners on foundation maintenance and footing performance" – a copy of which is available from our office.

Issue	Date	App'd	DESCRIPTION
REVISIONS			

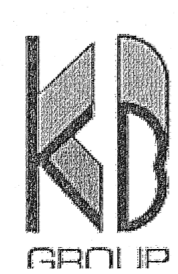

KNEEBONE, BERETTA & HALL PTY LTD
 CONSULTING STRUCTURAL & CIVIL ENGINEERS
 4 MACQUARIE AVENUE, PENRITH NSW 2750
 PHONE: (02) 4731 3833 FACSIMILE: (02) 4721 5442
 WEBSITE: www.kneeboneandberetta.com
 E-MAIL ADDRESS: kneebone@pnc.com.au

A.C.N 002 419 767
 A.B.N 36 822 442 203
 Directors:
 Trevor B. HALL, B.Sc (Eng), F.I.E. Aust., C.P. Eng.
 Peter R. ANDRESEN, B.E. M.I.E. Aust., C.P. Eng.



SCALE	1:100, 1:20
DATE	29-6-15
DRAWN	P.Martin.
DESIGNED	P.Andresen.
APPROVED	<i>M. Andresen</i>

CLIENT: MR & MRS. L. LORENS
PROPOSED DUAL OCCUPANCY AT 12 ANTHONY CRESCENT, KINGSWOOD. FOR: MR & MRS. L. LORENS
FIRST FLOOR SLAB

DRAWING NUMBER 100206-3
ISSUE

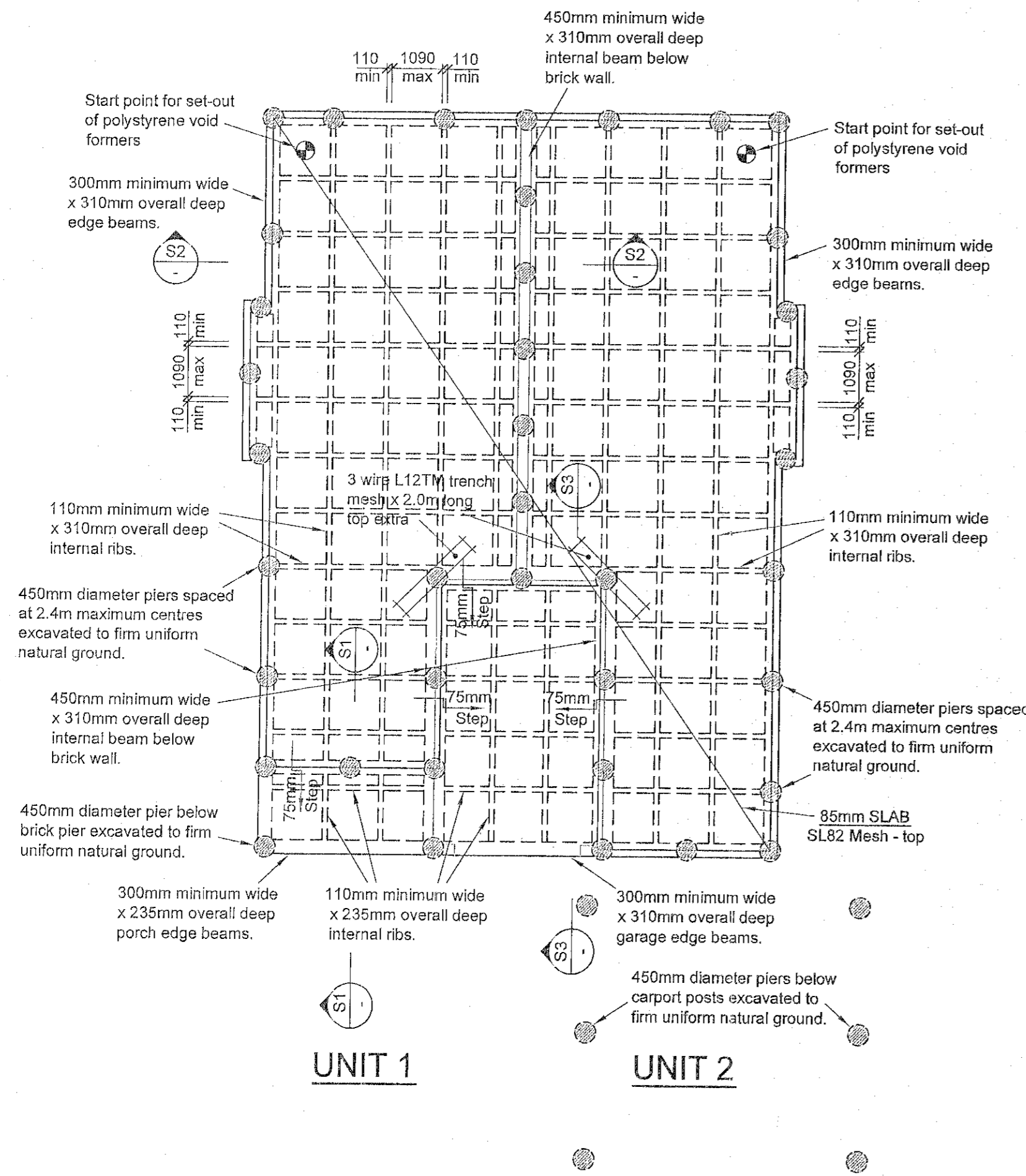

PLAN - FOUNDATION WAFFLE SLAB
Overlap fabric one whole uncut wire panel plus 25mm minimum at splices.

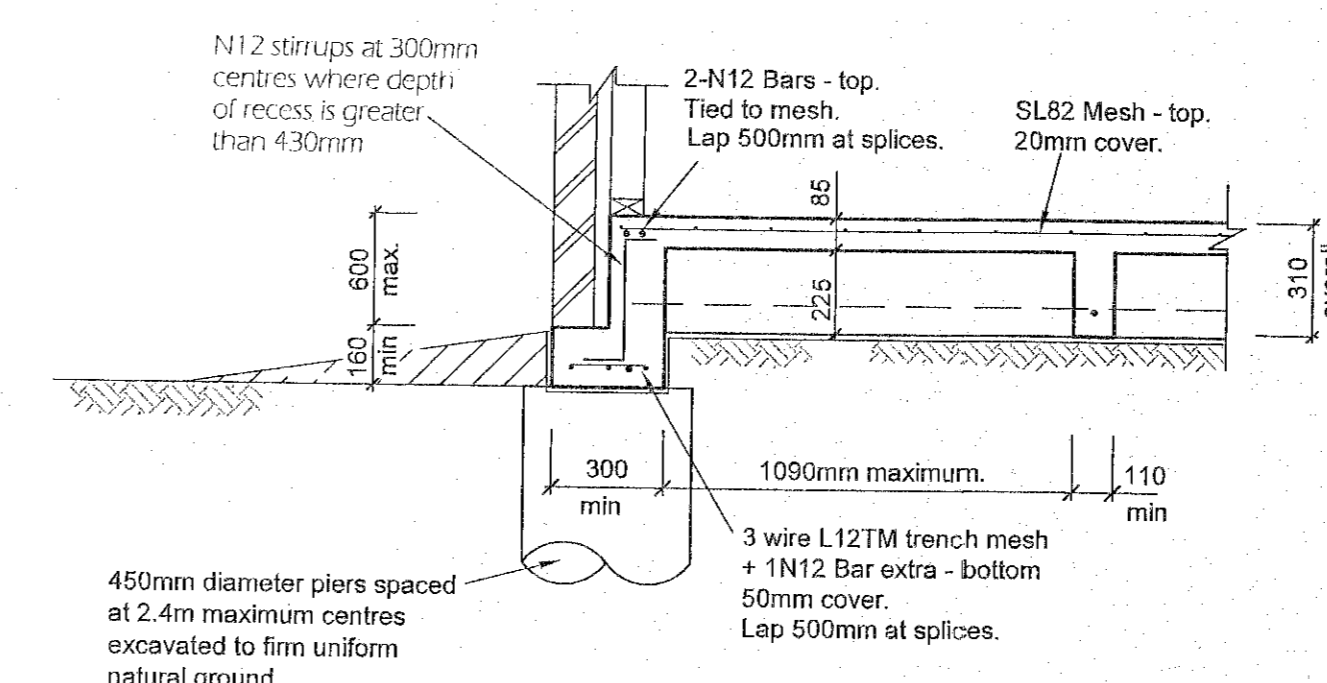

DETAIL - DEEPEDED EDGE RECESS

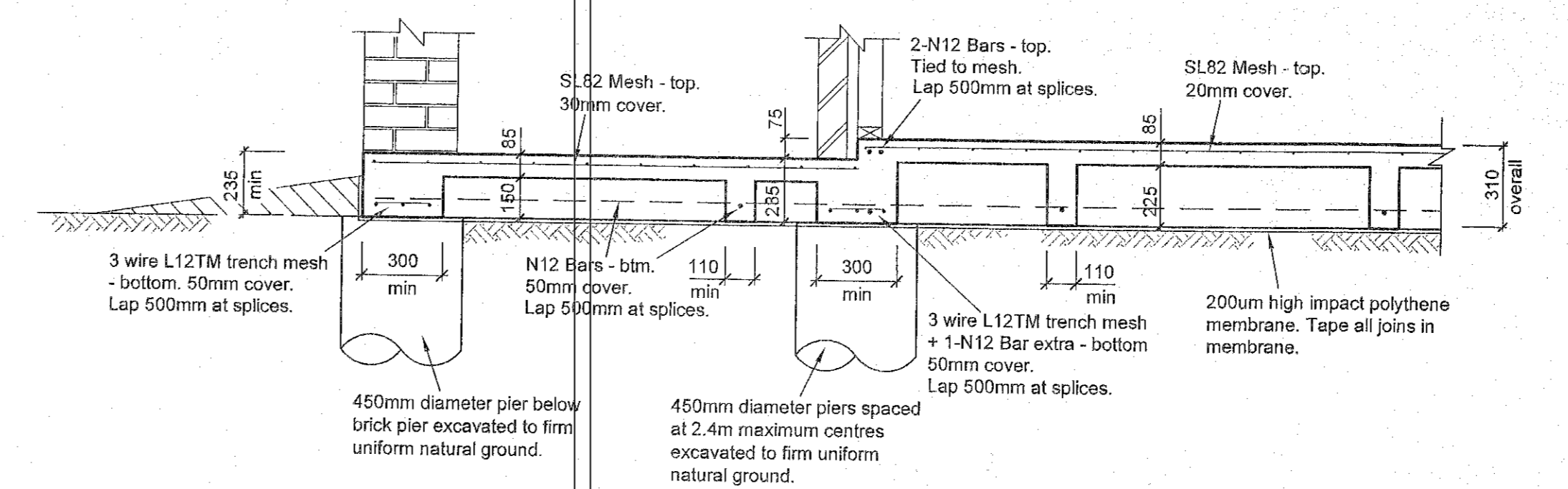

SECTION S1

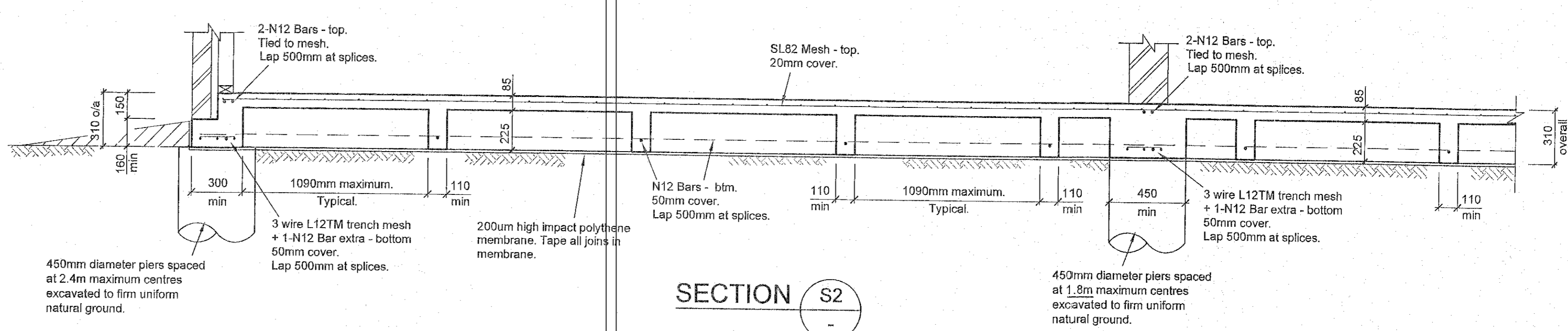

SECTION S2

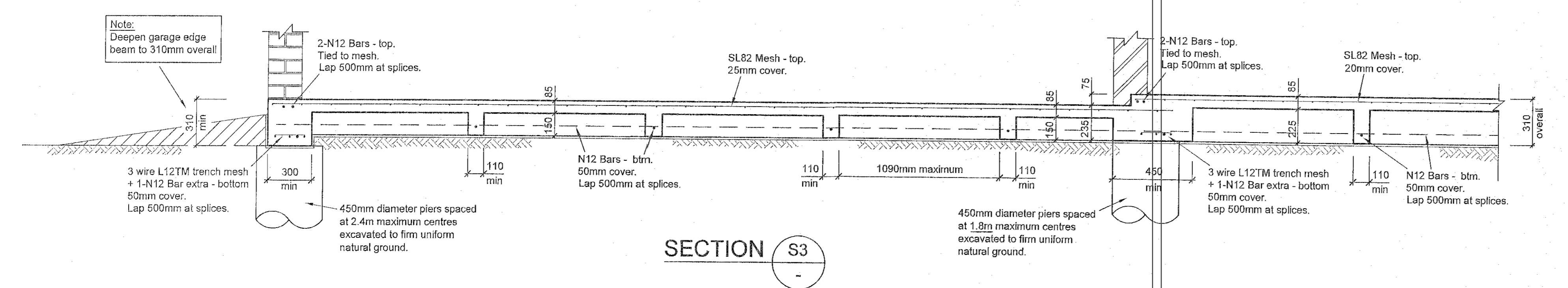

SECTION S3

- NOTES:**
- This drawing is to be read in conjunction with the Architectural drawing and specification.
 - Workmanship and materials to comply with AS3600 and associated Australian Standards.
 - Characteristic concrete compressive strength in accordance with AS3600 to be 20MPa.
 - Concrete slump to be 80mm.
 - Concrete in slab to be mechanically vibrated during placing.
 - Cure concrete by keeping constantly damp for at least 5 days after placing.
 - Reinforcement to be supported on bar chairs spaced at every 5th wire in both directions.
 - During site excavation provide sufficient drainage around building area to ensure that all rain water run-off is diverted away from area and is not allowed to pond on completion of the slab. Fill around the edge to at least 120mm minimum above the underside of the edge beam and fall away from slab at a slope of 50mm in 1000mm.
 - Filling to be thoroughly compacted in shallow layers (150mm thick) by multiple passes of earth moving equipment.
 - Termite protection to be in accordance with AS3660.1-1996 and Council's requirements.
 - Construction requirements and site maintenance outlined in AS2870-1996 are to be followed. Performance expectations set out in AS2870-1996 Appendix B are acceptable. Refer also to CSIRO Information sheet 10-91 "Guide to house owners on foundation maintenance and footing performance" - a copy of which is available from our office.

ALL SLAB EDGE BEAMS ARE TO BE SUPPORTED BY 450mm DIAMETER PIERS SPACED AT 2.4m MAXIMUM CENTRES TO FIRM UNIFORM NATURAL GROUND WITH AN ALLOWABLE SAFE BEARING CAPACITY OF AT LEAST 300kPa. PIER SIZE MAY BE REDUCED TO 400mm WHERE PIERED TO ROCK.

The slab shown on this drawing has been designed for a class "M" site in accordance with the requirements of AS2870 & AS3600 and if constructed in accordance with the details shown will be structurally adequate for the proposed two storey brick veneer dual occupancy on this site.

KNEEBONE, BERETTA & HALL PTY LTD CONSULTING STRUCTURAL & CIVIL ENGINEERS 4 MACQUARIE AVENUE, PENRITH NSW 2750 PHONE: (02) 4731 3883 FACSIMILE: (02) 4721 5442 WEBSITE: www.kneeboneandberetta.com E-MAIL ADDRESS: kneebone@pnc.com.au			Member of 	CLIENT: MR & MRS. L. LORENS PROPOSED DUAL OCCUPANCY AT 12 ANTHONY CRESCENT, KINGSWOOD. FOR: MR & MRS. L. LORENS FOUNDATION SLAB DETAILS	DRAWING NUMBER 100206-2 ISSUE
SCALE 1:100, 1:20 DATE 25-6-15 DRAWN P.Martin DESIGNED P.Andresen APPROVED <i>[Signature]</i>	Issue Date App'd DESCRIPTION REVISIONS			A.C.N 002 419 767 A.B.N 36 822 442 203 Trevor B. HALL, B.Sc (Eng), F.I.E. Aust., C.P. Eng. Peter R. ANDRESEN, B.E. M.I.E. Aust., C.P. Eng.	

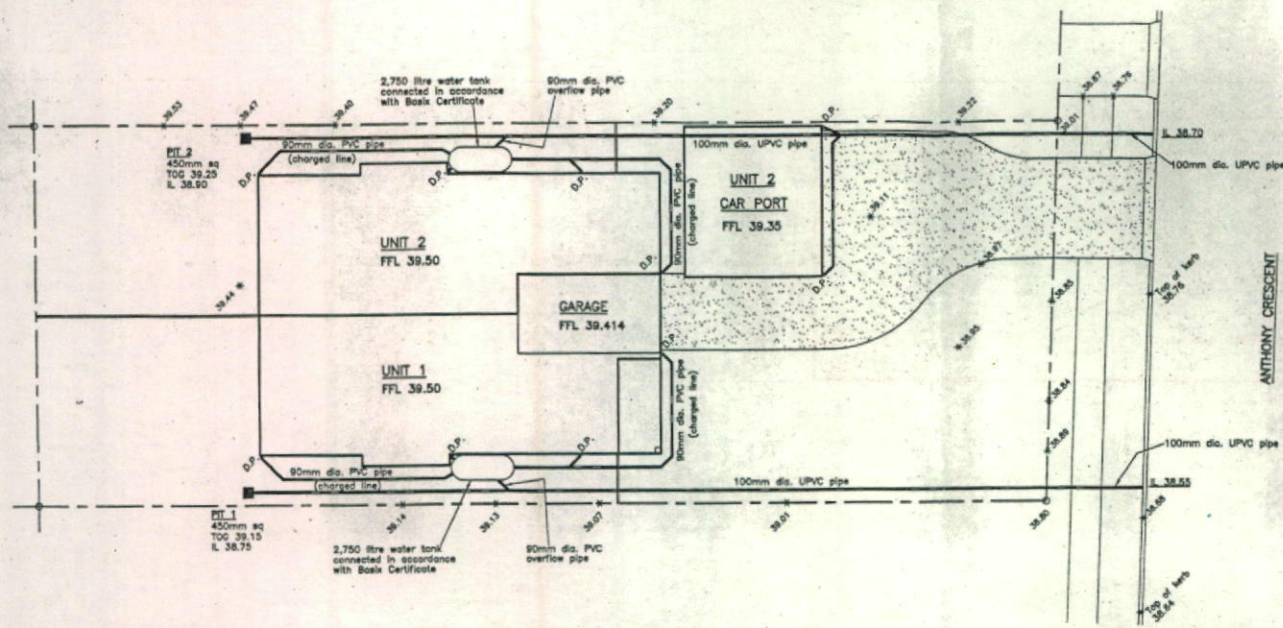

PLAN - STORMWATER DRAINAGE

STORMWATER DRAINAGE NOTES:

- This drawing to be read in conjunction with the Architectural drawings, specifications and the remainder of the engineers drawings. Refer any discrepancies to the Architect before proceeding with construction.
- ALL LEVELS SHOWN ON DRAWING ARE TO BE CHECKED ON SITE BEFORE EXCAVATION OF INSTALLATION OF PIPEWORK TO ENSURE CORRECT COVER AND FALL.
- All levels as detailed on Architectural drawing and are to be confirmed on site before the commencement of any work.
- All pipes and discharge have been calculated on the following design parameters:
 20 Year Recurrence Interval
 6 minute storm duration.
 Rainfall intensity 156mm/hour
- Number and location of downpipes to be confirmed by builder.
- Pits 1 & 2 to be 450mm square with metal grates.
- Do not cover or conceal from view under ground or enclosed work until it has been inspected and approved by council.
- Concrete in pits and elsewhere in the drainage system to have a characteristic compressive strength in accordance with AS3600 of 20MPa.
- Trenches for drain pipes shall be of sufficient width to allow for backfilling firmly around pipes.
- Pipes shall be laid true to grade and alignment on a firm, well rammed and compacted foundation.
- Any pipe which is not true alignment or grade or which shows any settlement after laying or which is damaged during laying or the operation of rolling the formation shall be taken up and replaced.
- Pits shall be formed to the depths indicated on the drawings or as necessary to give the required grades and falls to the drainage system. All soft, yielding and unsuitable material shall be removed from under the pits and the bed thoroughly compacted and finished to a firm surface of uniform bearing value.
- ALL CONNECTIONS IN STORMWATER PIPES AND DOWNPIPES IN CHARGED STORMWATER LINES TO WATER STORAGE TANKS MUST BE FULLY SEALED TO CONTAIN 2.0m WATER HEAD. PROVIDE SCREW FIXED ACCESS POINTS IN ALL CHARGED PIPES TO ALLOW LINES TO BE FLUSHED CLEAN.

NOTE:
 Location of Sydney Water's sewer main, sewer connection lines, water pipes, stormwater drains, underground electricity lines and other services must be obtained prior to commencement of any work on site.
DIAL BEFORE YOU DIG 1100

PENRITH CITY COUNCIL This plan / document relates to:
 Development Consent
131316
 Subject to the conditions outlined in the consent
 COUNCIL DOES NOT ATTEST TO THE ACCURACY OF DETAILS IN PLANS

RECEIVED
 D/MGT
 13 JUL 2015
 PENRITH CITY COUNCIL

Issue	Date	App'd	DESCRIPTION

KNEEBONE, BERETTA & HALL PTY LTD
 CONSULTING STRUCTURAL & CIVIL ENGINEERS
 4 MACDOUGALL AVENUE, PENRITH NSW 2150
 PHONE: (02) 4711 3833 FACSIMILE: (02) 4721 6442
 WEBSITE: www.kneeboneberetta.com.au
 EMAIL ADDRESS: kneebone@pbm.com.au

Member of
CONSULT AUSTRALIA
 GROUP

CLIENT
MR & MRS. L. LORENS
 PROPOSED DUAL OCCUPANCY AT
 12 ANTHONY CRESCENT, KINGSWOOD.
 FOR: MR & MRS. L. LORENS
 STORMWATER DRAINAGE DETAILS

DRAWING NUMBER	100206-1
ISSUE	

LANDSCAPE CONCEPT PLAN

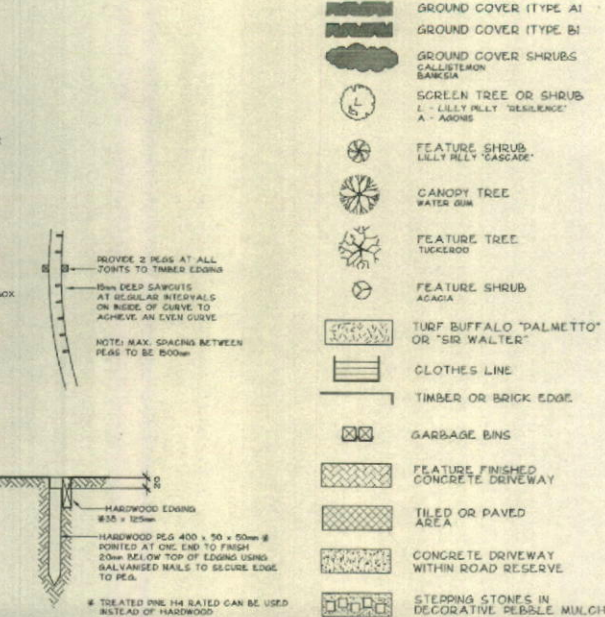
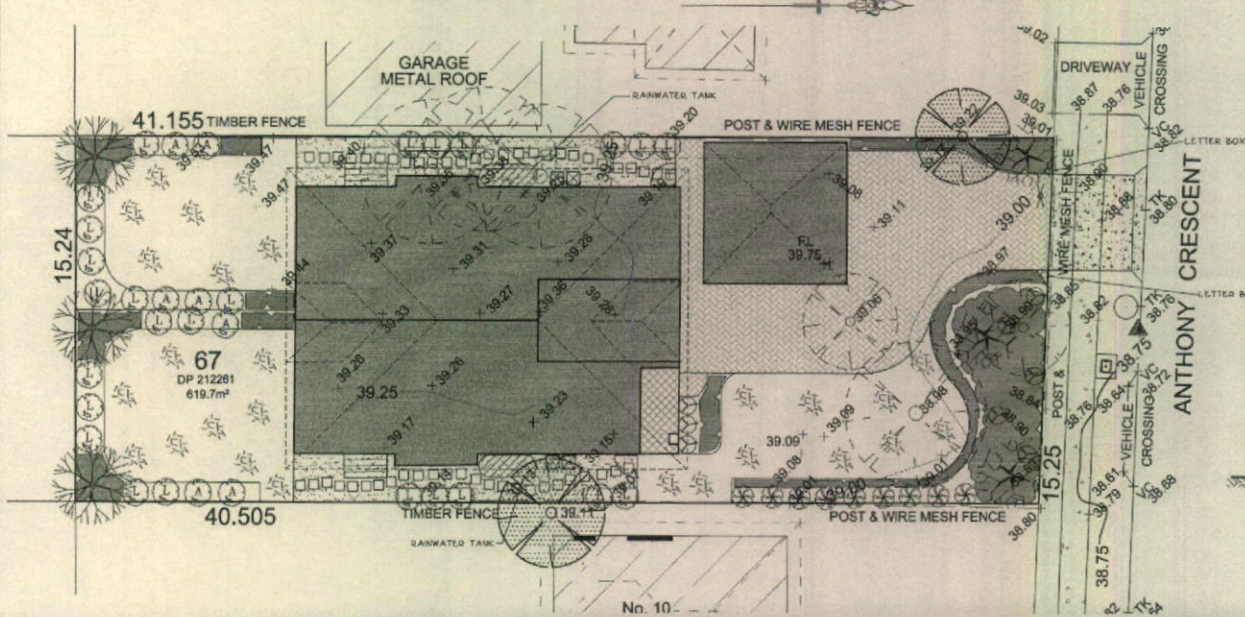

INDICATIVE SPECIES LIST

BOTANICAL NAME	COMMON NAME	MATURE HEIGHT	POT SIZE	APPROX NUMBERS
GROUND COVER (TYPE A) <i>Dymalis easmaniana</i> "Tas Aard"	Flax Grass	40cm	150mm	50
GROUND COVER (TYPE B) <i>Lomandra longifolia</i> "Lanka"	Lomandra Lanka	60cm	150mm	36
GROUND COVER SHRUB <i>Banksia spinulosa</i> "Bankia"	Dwarf Banksia	1m	200mm	10
<i>Callistemon viminalis</i> "Little John"	Dwarf Bottlebrush	0.5-1m	200mm	10
FEATURE SHRUB <i>Syzygium "Resilience"</i>	Weeping Lilly Pilly	2-3m	200mm	3
<i>Acacia Cognata</i> "Z. ameliae"	Bower Wattle	0.5m-1m	200mm	8
SCREEN TREES & SHRUBS <i>Syzygium "Resilience"</i>	Lilly Pilly	3-4m	200mm	24
<i>Agave attenuata</i> "Hans"	Dwarf Willow Myrtle	1-1.5m	200mm	7
FEATURE TREE <i>Casuarina antarctica</i>	Tuckerbo	6-8m	45 litre	3
CANOPY TREE <i>Tristania laurina</i> "Zussouvs"	Water Gum	8-10m	45 litre	3

NOTES

- HARDWOOD STAKES TO BE 36 x 50 x 1000
- AN APPROVED SLOW RELEASE PELLET TYPE FERTILISER HAVING AN NPK RATIO OF 16:3:2:1 EQUIVALENT TO OSMOGOTE 12 - 14 MONTH SLOW RELEASE FERTILISER APPLIED AT THE RATE SPECIFIED BY THE MANUFACTURER SHALL BE USED
- RECYCLED TURF AREA SHOWN TO BE FERTILISED WITH A NPK RATIO OF 3:2:4:2 SIMILAR TO NUT LAMN FOOD AT THE RATE SPECIFIED BY THE MANUFACTURER
- ALL GARDEN AREAS TO BE FILLED WITH APPROVED TOP SOIL AT MINIMUM 100mm DEPTH
- ALL TURFED AREAS TO HAVE A MIN. OF 50mm OF APPROVED TOP SOIL PLACED ABOVE TO TURFING
- TOPSOIL SHOULD CONFORM TO AS 4487 "SOILS FOR LANDSCAPING AND GARDEN" AND TO BE SUITABLE FOR NATIVE PLANT GROWTH WITH LOW PHOSPHOROUS CONTENT, CONTAINING ORGANIC MATTER AND FREE FROM STONES OR OTHER MATERIAL EXCEEDING 25mm IN ANY DIMENSION.
- IT IS THE CONTRACTOR'S RESPONSIBILITY TO CHECK AND ADJUST SOIL pH AS REQUIRED
- IN ALL GARDEN AREAS EXISTING SOIL TO BE REMOVED TO 100mm AND CULTIVATED TO 100mm
- IN ALL TURFED AREAS EXISTING SOIL TO BE REMOVED TO 100mm
- WATERING REGIME: THE FIRST MONTH AFTER PLANTING IS CRITICAL TIME FOR WATERING THE PLANTS. DURING HEAVY WATERS EVERY 3 DAYS. 30mm OF WATER PER WEEK AS A MINIMUM SHOULD BE ADOPTED AS A GENERAL GUIDE
- MULCH PLANTING BEDS TO A MINIMUM OF 50 - 100mm AS SPECIFIED MULCH TO BE COURSE GRADE HARDWOOD MULCH, CONFORMING TO AS 4454 "COMPOSITE SOIL COMPONENTS AND MULCHES"
- DECORATIVE PEBBLE MULCH COULD BE USED IN AREAS BORDERING DRIVEWAYS & AREAS SUBJECT TO TRAFFIC DETENTION
- IF DECORATIVE MULCH IS USED NEXT TO GARDEN BEDS IN AREAS AND SIDES OF UNITS, A CONTRASTING PEBBLE MULCH OR HARDWOOD MULCH TO BE USED WITHIN THE BEDS
- EXCESS TOPSOIL GENERATED BY THE DEVELOPMENT CAN BE USED TO MOUND UP PLANTING BEDS IN SPECIFIED AREAS

PLANTING NOTES
GROUND COVER TYPE "A" TO BE PLANTED AT 3 - 4 PER SQM
GROUND COVER TYPE "B" TO BE PLANTED AT 2 - 3 PER SQM
GROUND COVER SHRUBS TO BE PLANTED AT 1 PER SQM

PENRITH CITY COUNCIL This plan / document relates to:
Development Consent
131316
Subject to the conditions outlined in the consent
COUNCIL DOES NOT ATTEST TO THE ACCURACY OF DETAILS IN PLANS

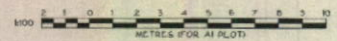
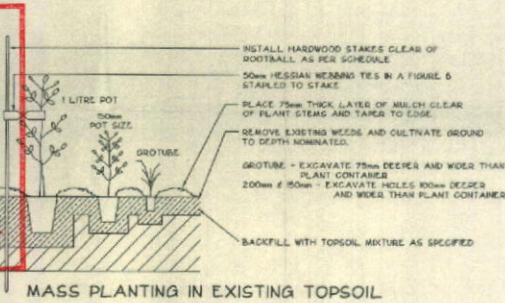

Bio Engineered Solutions Pty. Ltd. Landscape design and Environmental Management			DESIGNED: JLN DRAWN: JLN CHECKED:	SCALES: 1:100 CLIENT: MR F MAS LORENZ	PROPOSED DUAL OCCUPANCY DEVELOPMENT LOT 67 DP 212281 12 ANTHONY CRESCENT, KINGSWOOD LANDSCAPE CONCEPT PLAN	PLAN No: 1506LAN2 A FILE No: 1506LAN2 SHEET 2 OF 2 SHEETS
No.	AMENDMENT	DATE	3 TERNPICT RD WARRIOOL, 274	DATE: 11/06/2019 PH: (02) 4233 4844	APPROVED: _____ DATE: _____	

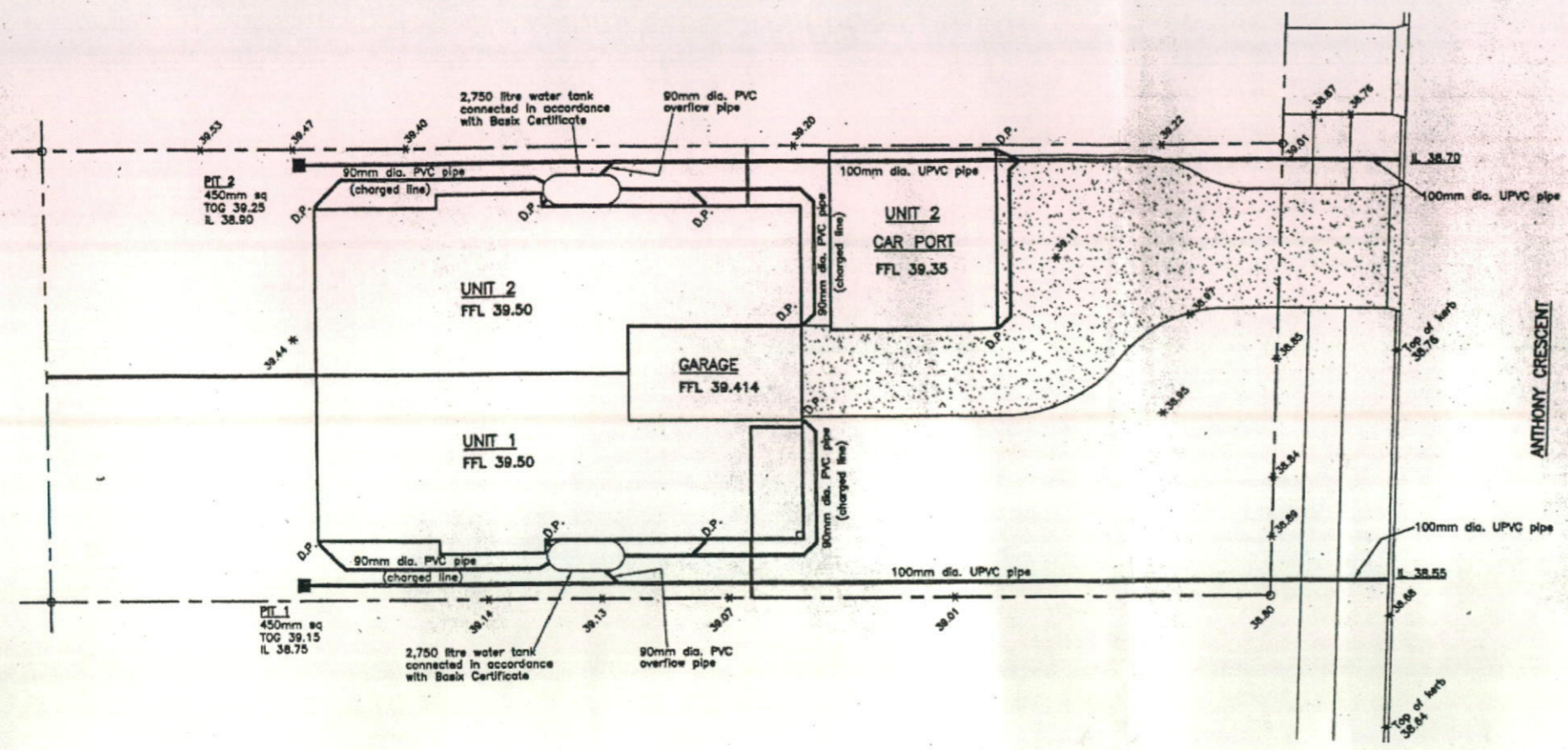

PLAN - STORMWATER DRAINAGE

- STORMWATER DRAINAGE NOTES:**
- This drawing to be read in conjunction with the Architectural drawings, specifications and the remainder of the engineers drawings. Refer any discrepancies to the Architect before proceeding with construction.
 - ALL LEVELS SHOWN ON DRAWING ARE TO BE CHECKED ON SITE BEFORE EXCAVATION OF INSTALLATION OF PIPEWORK TO ENSURE CORRECT COVER AND FALL.
 - All levels as detailed on Architectural drawing and are to be confirmed on site before the commencement of any work.
 - All pipes and discharges have been calculated on the following design parameters:
 20 Year Recurrence Interval
 6 minute storm duration.
 Rainfall intensity 156mm/hour
 - Number and location of downpipes to be confirmed by builder.
 - Pits 1 & 2 to be 450mm square with metal grates.
 - Do not cover or conceal from view under ground or enclosed work until it has been inspected and approved by council.
 - Concrete in pits and elsewhere in the drainage system to have a characteristic compressive strength in accordance with AS3600 of 20MPa.
 - Trenches for drain pipes shall be of sufficient width to allow for backfilling firmly around pipes.
 - Pipes shall be laid true to grade and alignment on firm, well rammed and compacted foundation.
 - Any pipe which is not true alignment or grade or which shows any settlement after laying or which is damaged during laying or the operation of rolling the formation shall be taken up and replaced.
 - Pits shall be formed at the depths indicated on the drawings or as necessary to give the required grades and falls to the drainage system. All soft, yielding and unsuitable material shall be removed from under the pits and the bed thoroughly compacted and finished to a firm surface of uniform bearing value.
 - ALL CONNECTIONS IN STORMWATER PIPES AND DOWNPIPES IN CHARGED STORMWATER LINES TO WATER STORAGE TANKS MUST BE FULLY SEALED TO CONTAIN 2.0m WATER HEAD. PROVIDE SCREW FIXED ACCESS POINTS IN ALL CHARGED PIPES TO ALLOW LINES TO BE FLUSHED CLEAN.

NOTE:
 Location of Sydney Water's sewer main, sewer connection lines, water pipes, stormwater drains, underground electricity lines and other services must be obtained prior to commencement of any work on site.
DIAL BEFORE YOU DIG 1100

PENRITH CITY COUNCIL This plan / document relates to:
 Development Consent
131316
 Subject to the conditions outlined in the consent
 COUNCIL DOES NOT ATTEST TO THE ACCURACY OF DETAILS IN PLANS

Issue	Date	App'd	DESCRIPTION
REVISIONS			

KNEEBONE, BERETTA & HALL PTY LTD
 CONSULTING STRUCTURAL & CIVIL ENGINEERS
 4 MACQUARIE AVENUE, PENRITH NSW 2750
 PHONE: (02) 4731 3833 FACSIMILE: (02) 4721 6442
 WEBSITE: www.kneeboneandberetta.com
 E-MAIL ADDRESS: kneebone@pnc.com.au

Member of:
CONSULT AUSTRALIA
 SCALE: 1:100
 DATE: 6-9-13
 DRAWN: P.Martin
 DESIGNED: P.Andersen
 APPROVED: *[Signature]*

CLIENT:
MR & MRS. L. LORENS
PROPOSED DUAL OCCUPANCY AT
12 ANTHONY CRESCENT, KINGSWOOD.
FOR: MR & MRS. L. LORENS
STORMWATER DRAINAGE DETAILS

DRAWING NUMBER	100206-1
ISSUE	

LANDSCAPE CONCEPT PLAN

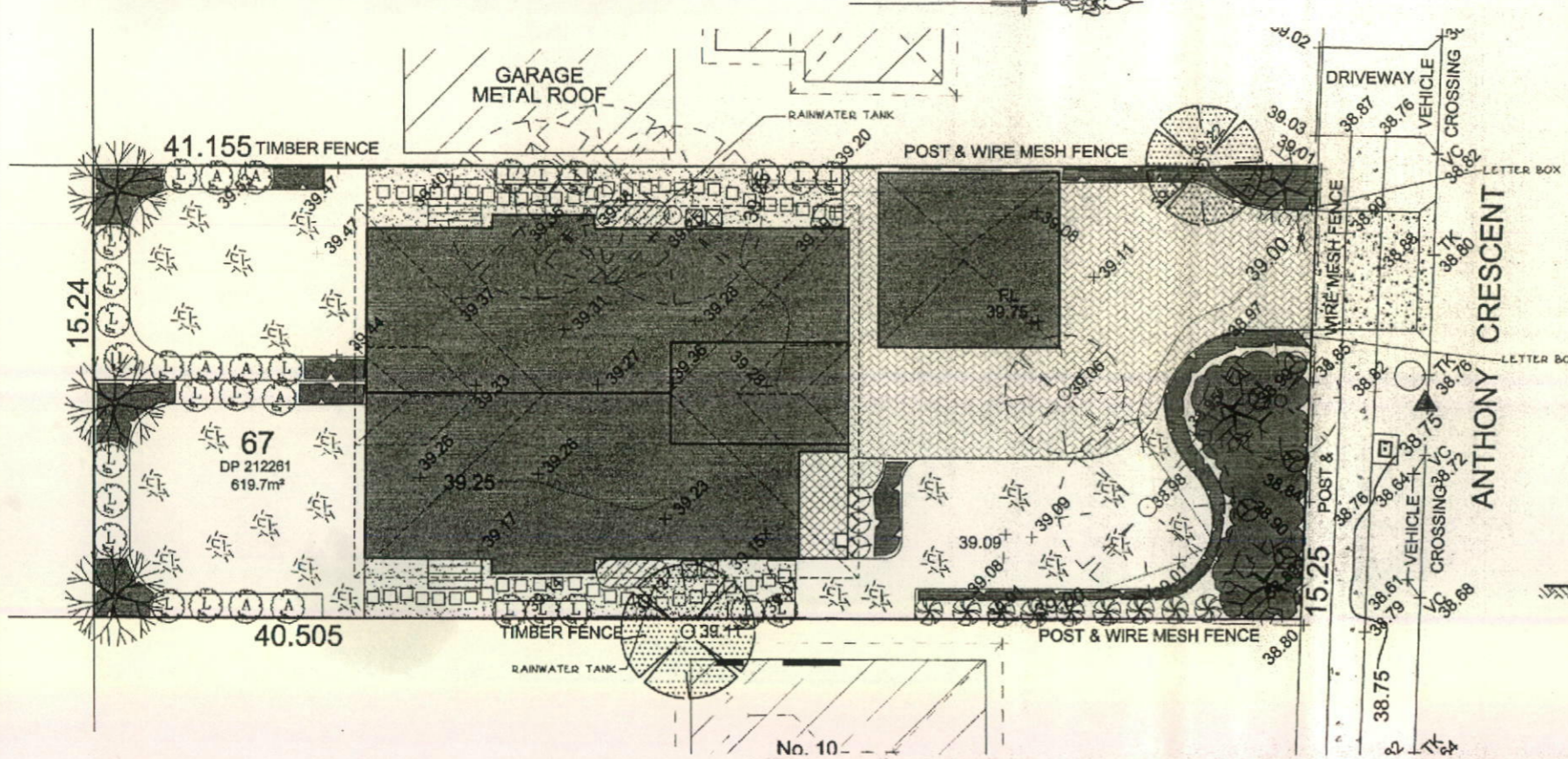

LEGEND

- GROUND COVER (TYPE A)
- GROUND COVER (TYPE B)
- GROUND COVER SHRUBS
CALLISTEMON
BANKSIA
- SCREEN TREE OR SHRUB
L - LILLY PILLY "RESILIENCE"
A - AGONIS
- FEATURE SHRUB
LILLY PILLY "CASCADE"
- CANOPY TREE
WATER GUM
- FEATURE TREE
TUCKEROO
- FEATURE SHRUB
ACACIA
- TURF BUFFALO "PALMETTO"
OR "SIR WALTER"
- CLOTHES LINE
- TIMBER OR BRICK EDGE
- GARBAGE BINS
- FEATURE FINISHED
CONCRETE DRIVEWAY
- TILED OR PAVED
AREA
- CONCRETE DRIVEWAY
WITHIN ROAD RESERVE
- STEPPING STONES IN
DECORATIVE PEBBLE MULCH
- EXISTING TREES
TO REMAIN AND BE PROTECTED
- EXISTING TREES
TO BE REMOVED

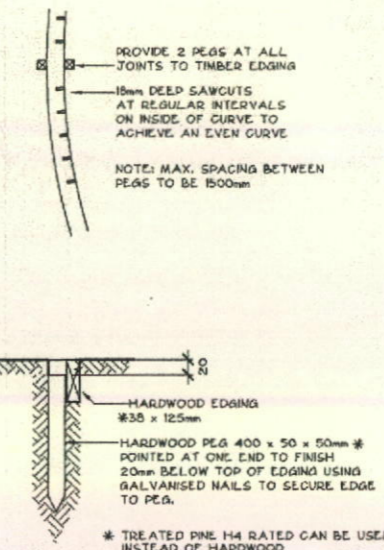

PLAN
TIMBER EDGING DETAIL
SCALE 1:10

INDICATIVE SPECIES LIST

BOTANICAL NAME	COMMON NAME	MATURE HEIGHT	POT SIZE	APPROX NUMBERS	NOTES
GROUND COVER (TYPE A) <i>Dianella tasmanica</i> "Tas Red"	Flax Grass	40cm	150mm	50	<p>NOTES</p> <ol style="list-style-type: none"> HARDWOOD STAKES TO BE 36 x 36 x 1800 AN APPROVED SLOW RELEASE PELLET TYPE FERTILISER HAVING AN NPK RATIO OF 18:2:13 EQUIVALENT TO DEMOGOTE 12 - 14 MONTH SLOW RELEASE FERTILISER APPLIED AT THE RATE SPECIFIED BY THE MANUFACTURER SHALL BE USED PROPOSED TURF AREA SHOWN TO BE FERTILISED WITH A NPK RATIO OF 3:2:4:3 SIMILAR TO No 17 LAWN FOOD AT THE RATE SPECIFIED BY THE MANUFACTURER ALL GARDEN AREAS TO BE FILLED WITH APPROVED TOP SOIL AT MINIMUM 150mm DEPTH ALL TURFED AREAS TO HAVE A MIN. OF 50mm OF APPROVED TOP SOIL PLACED PRIOR TO TURFING TOPSOIL SHOULD CONFORM TO AS 4415 "SOILS FOR LANDSCAPING AND GARDEN" AND TO BE SUITABLE FOR NATIVE PLANT GROWTH WITH LOW PHOSPHORUS CONTENT, CONTAINING ORGANIC MATTER AND FREE FROM STONES OR OTHER MATERIAL EXCEEDING 25mm IN ANY DIMENSION. IT IS THE CONTRACTORS RESPONSIBILITY TO CHECK AND ADJUST SOIL PH AS REQUIRED IN ALL GARDEN AREAS, EXISTING SOIL TO BE CULTIVATED TO 100mm IN ALL TURFED AREAS, EXISTING SOIL TO BE CULTIVATED TO 75mm WATERING REGIME. THE FIRST MONTH AFTER PLANTING THE CRITICAL TIME FOR WATERING. THE PLANTS REQUIRE HEAVY WATERING EVERY 3 DAYS. 50mm OF WATER PER WEEK AS A MINIMUM SHOULD BE ADOPTED AS A GENERAL GUIDE MULCH PLANTING BEDS TO A MINIMUM OF 50mm AS REQUIRED. MULCH TO BE COURSE GRADE HARDWOOD MULCH CONFORMING TO AS 4454 "COMPOSTS, SOIL CONDITIONERS AND MULCHES" DECORATIVE PEBBLE MULCH COULD BE USED IN AREAS BORDERING DRIVEWAYS & AREAS SUBJECT TO ON-SITE DETENTION IF DECORATIVE MULCH IS USED NEXT TO GARDEN BEDS IN REAR AND SIDES OF UNITS, A CONTRASTING PEBBLE MULCH OR HARDWOOD MULCH TO BE USED WITHIN THE BEDS EXCESS TOPSOIL, GENERATED BY THE DEVELOPMENT CAN BE USED TO MOUND UP PLANTING BEDS IN SPECIFIED AREAS
GROUND COVER (TYPE B) <i>Lomandra longifolia</i> "Tanika"	Lomandra Tanika	60cm	150mm	36	
GROUND COVER SHRUB <i>Banksia spinulosa</i> "Birthday Candles"	Dwarf Banksia	1m	200mm	10	
<i>Callistemon viminalis</i> "Little John"	Dwarf Bottlebrush	0.5-1m	200mm	10	
FEATURE SHRUB <i>Syzygium "Cascade"</i>	Weeping Lilly Pilly	2-3m	200mm	3	
<i>Acacia Cognata</i> "Lumlight"	Bower Wattle	0.5m-1m	200mm	8	
SCREEN TREES & SHRUBS <i>Syzygium Rosinella</i>	Lilly Pilly	3-4m	200mm	24	
<i>Agonis flexuosa "Nano"</i>	Dwarf Willow Myrtle	1-1.5m	200mm	7	
FEATURE TREE <i>Cupressopsis anacardioides</i>	Tuckeroo	6-8m	45-litre	3	
CANOPY TREE <i>Tristania laurina "Luscious"</i>	Water Gum	8-10m	45 litre	3	

PLANTING NOTES
GROUND COVER TYPE "A" TO BE PLANTED AT 3 - 4 PER SQM
GROUND COVER TYPE "B" TO BE PLANTED AT 2 - 3 PER SQM
GROUND COVER SHRUBS TO BE PLANTED AT 1 PER SQM

PENRITH CITY COUNCIL This plan / document relates to:
Development Consent
131316
Subject to the conditions outlined in the consent
COUNCIL DOES NOT ATTEST TO THE ACCURACY OF DETAILS IN PLANS

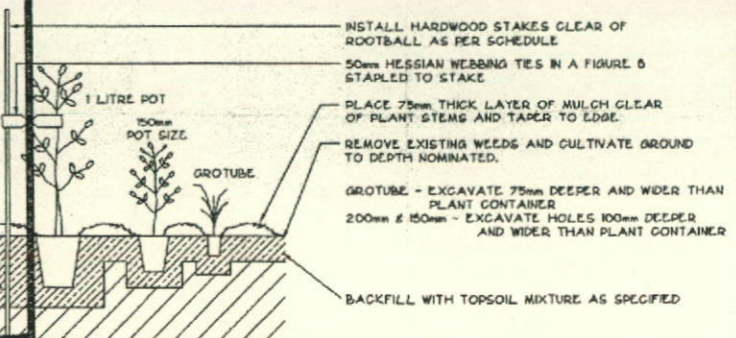
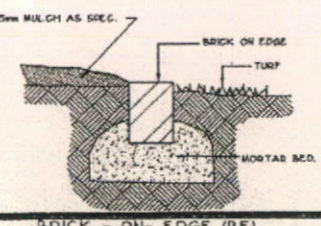

MASS PLANTING IN EXISTING TOPSOIL
N.T.S.

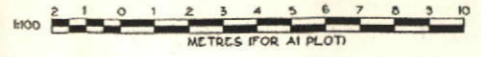

Bio Engineered Solutions Pty. Ltd. Landscape design and Environmental Management 3 TERRYMONT RD WARRIMOO, 2774 EMAIL: info@bes.com.au			DESIGNED: J.N. DRAWN: K.N. CHECKED: _____ APPROVED: _____ DATE: _____	SCALES: 1:100 CLIENT: MR & MRS LORENS	PROPOSED DUAL OCCUPANCY DEVELOPMENT LOT 67 DP 212261 12 ANTHONY CRESCENT, KINGSWOOD LANDSCAPE CONCEPT PLAN	PLAN No. 1506LAN2 A FILE No. 1506LAN2 SHEET 2 OF 2 SHEETS
--	--	--	--	--	---	--

MM
(DP 212261)



www.dialbeforeyoudig.com.au

**DIAL 1100
BEFORE YOU DIG**

TM

DIAL BEFORE YOU DIG
SHOULD BE CONTACTED
PRIOR TO ANY EXCAVATION ON SITE

269°41'00"

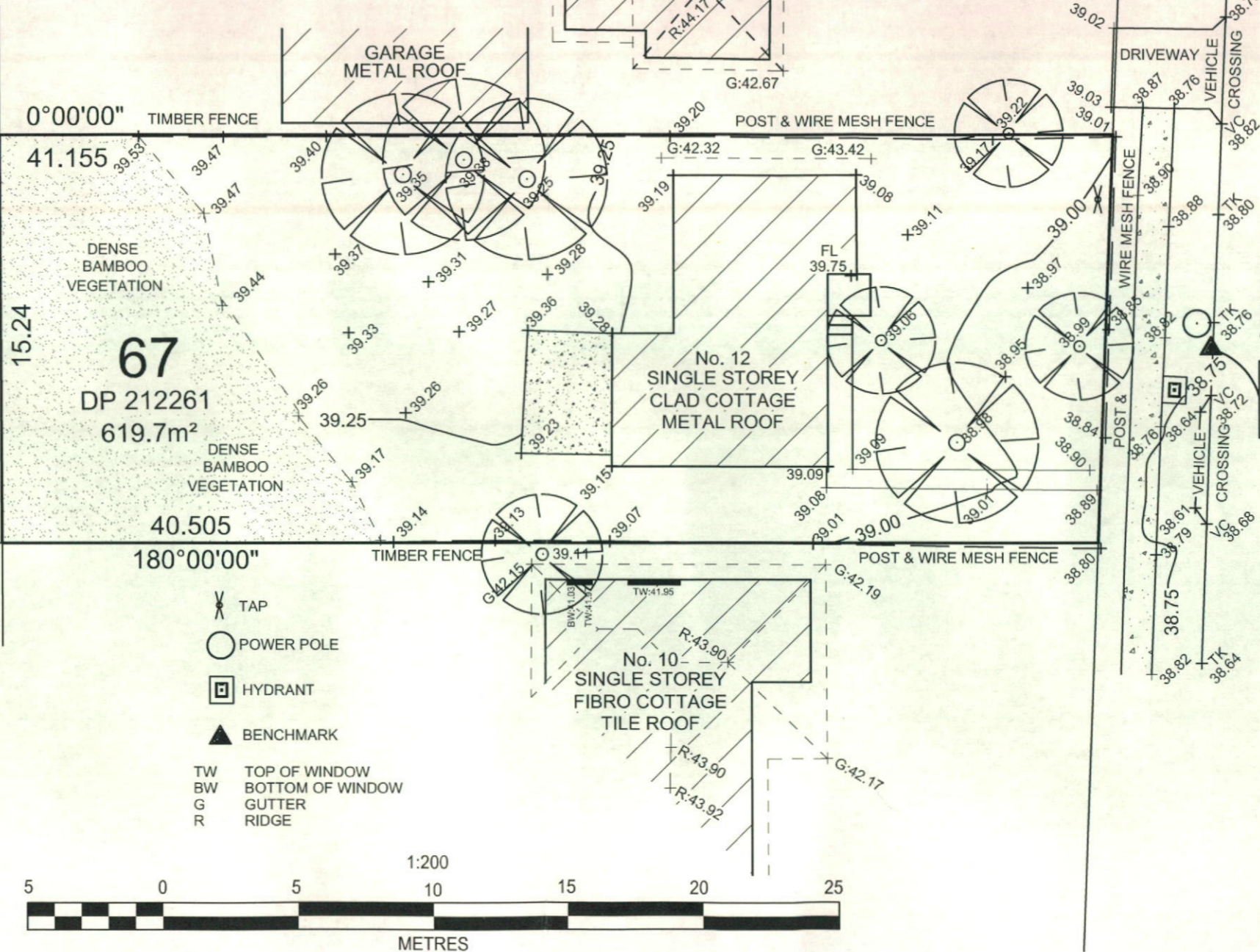

CRESCENT

ANTHONY

NOTES :

1. THIS DETAIL SURVEY IS NOT A 'SURVEY' AS DEFINED BY THE SURVEYING & SPATIAL INFORMATION ACT, 2002.
2. DATUM OF LEVELS : AUSTRALIAN HEIGHT DATUM
3. ALL AREAS AND DIMENSIONS HAVE BEEN COMPILED FROM PLANS MADE AVAILABLE BY THE OFFICE OF LAND & PROPERTY INFORMATION (NSW) AND ARE SUBJECT TO FINAL SURVEY.
4. NO SEARCH MADE OF LOCATION AND NATURE OF TELEPHONE, ELECTRICITY, SEWER, WATER, GAS AND DRAINAGE RECORDS AT THE RELEVANT AUTHORITY. PRIOR TO ANY CONSTRUCTION THE RELEVANT AUTHORITY SHOULD BE CONTACTED FOR LOCATION OF SERVICES.
5. THE POSITION OF IMPROVEMENTS IN RELATION TO BOUNDARIES IS DIAGRAMMATIC ONLY.
6. VISIBLE, ACCESSIBLE SERVICES LOCATED ONLY
7. SIGNIFICANT TREES LOCATED ONLY.
8. NEIGHBOURING HOUSES, RIDGE AND ROOF POSITIONS ARE APPROXIMATE ONLY.
9. THIS TITLE BLOCK AND NOTES IS AN INTEGRAL PART OF THIS DRAWING WHICH IS NOT TO BE REMOVED.
10. CONTOURS ARE INDICATIVE ONLY. SPOT LEVELS SHOULD BE USED FOR CALCULATIONS OF QUANTITIES WITH CAUTION.

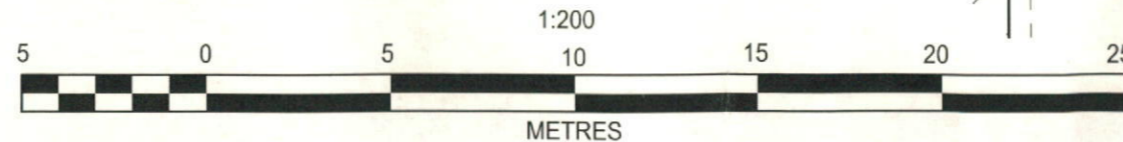

RICHARD HOGAN & CO. PTY LTD
SURVEYING & DEVELOPMENT CONSULTANTS

A.B.N. 59 082 453 165
P.O. BOX 4365, PENRITH PLAZA, NSW 2750.
PHONE: (02) 4732 6599 FAX: (02) 4732 6699 MOB.: 0416 - 021 222
EMAIL: admin@hoganco.com.au

SURVEYOR: RR
DRAWN: TZ
REDUCTION RATIO: 1:200
CONTOUR INTERVAL: 0.25m
SHEET 1 OF 1

ORIGIN OF LEVELS: PM 41908
R.L. = 43.871
(GNSS)
DATUM: AUSTRALIAN HEIGHT DATUM
DATE: 21/05/13
VERSION No.: A

PLAN OF DETAIL AND LEVELS OVER
LOT 67 IN DP 212261, BEING
No. 12 ANTHONY CRESCENT, KINGSWOOD

CLIENT: LORENS
L.G.A.: PENRITH
JOB REF: 13146