

1 ELEVATION 1:100

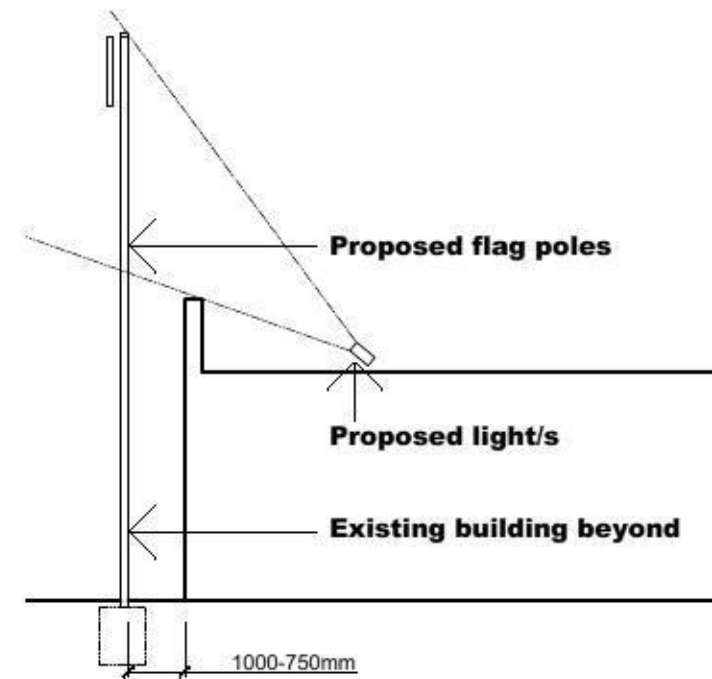

2 SECTION 1:100

A	21.08.2013	FOR COMMENT	RMC
REV.	DATE	DESCRIPTION	BY
PHASE DESIGN DEVELOPMENT			
CLIENT PENRITH CITY COUNCIL COMMUNITY & CULTURAL DEVELOPMENT			
ARCHITECT PENRITH CITY COUNCIL Major Projects Department 601 High Street PENRITH NSW 2150 Australia Postal Address: p (02) 4732 7777 GPO Box 69 s (02) 4732 7668 Penrith NSW 2151 Australia e: penrithc@penrithcity.nsw.gov.au			
PROJECT Penrith Valley Cultural Centre St Marys Corner, Flag poles Crn Great Western Highway, Mamre Road			
TITLE Elevation & Section			
SCALE	AS SHOWN	DRAWN	RMC PROJECT CODE
DATE	23.07.13		
SHEET NO. DA-MP-A-2013-13-03 rev(A)			

Location of proposed flag poles

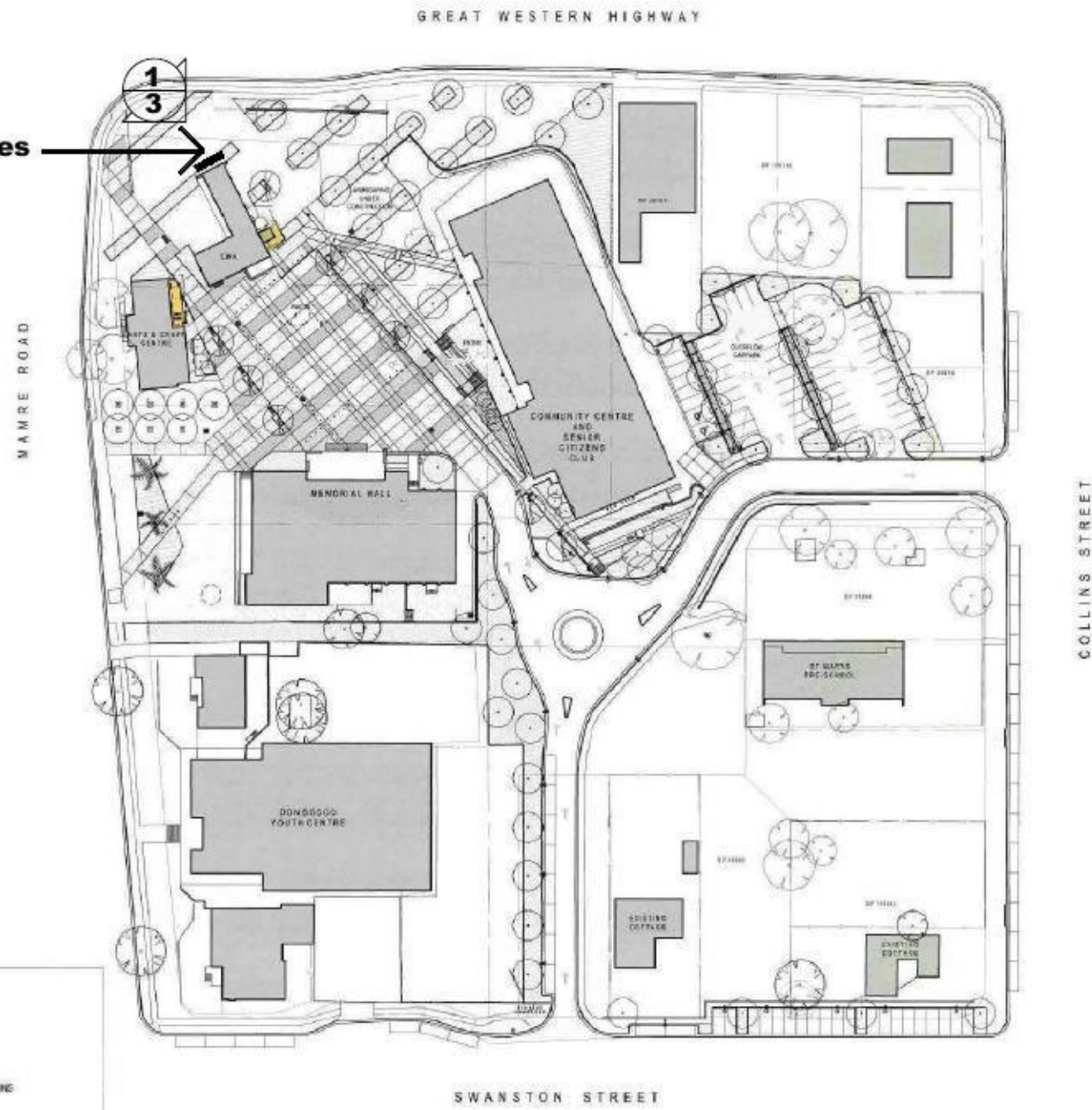

1 PROPOSED SITE PLAN
SCALE 1:500

2 PLAN - SITE
NTS

ST MARYS
PIAZZA



1 PLAN - LOCALITY
NTS

REV.	DATE	DESCRIPTION	BY
PHASE			
DESIGN DEVELOPMENT			
CLIENT			
PENRITH CITY COUNCIL COMMUNITY & CULTURAL DEVELOPMENT			
ARCHITECT			
PENRITH CITY COUNCIL Major Projects Department 601 High Street PENRITH NSW 2750 Australia Postal Address: GPO Box 60 Penrith NSW 2751 Australia p (02) 4732 7777 f (02) 4732 7664 w penrith@penrithcity.nsw.gov.au			

PROJECT
**Penrith Valley Cultural Centre
St Marys Corner, Flag poles
Crm Great Western Highway, Mamre Road**

TITLE		
Locality & Site Plan		
SCALE	DRAWN	PROJECT CODE
AS SHOWN	RMC	
DATE		
23.07.13		
SHEET NO.		
DA-MP-A-2013-13-02 rev(A)		