

▲ DATUM - TOP OF NGL 9.6. TOP OF POOL TO BE 400mm ABOVE THE DATUM AT 10.0 (ASSUMED)

PROPOSED FIBREGLASS POOL
THE PROPOSED POOL TO COMPLY WITH THE SWIMMING POOL ACT AND REGULATIONS.

FILTER & PUMP INSIDE BEHIND WATER FEATURE

1200 HIGH CHILD PROOF SAFETY FENCE AND SELF CLOSING, SELF LOCKING GATE TO AS1926.1-2012 AND LOCAL COUNCIL REQUIREMENTS (BY OTHERS)

POOL HEATING UNIT

ALFRESCO

PROPOSED DWELLING
AREA = 217m²
No.2289

GREENHOUSE

EXISTING DWELLING

PROPOSED DRIVEWAY

LANDSCAPE CALCULATION
(FOR CDC WHERE APPLICABLE)

SITE AREA = 20,367m²
DWELLING = 217m²
OTHER AREAS = 1,714m²
PROPOSED POOL/COPING = 45m²
TOTAL B.U.A. = 1,976m²
LANDSCAPED = 18,391m²
AS SITE AREA IS 20,367m² - 45% (9,165m²) OF LOT TO BE LANDSCAPED.
50% OF LANDSCAPED AREA BEHIND BUILDING LINE.
WIDTH OF LOT MEASURED AT BUILDING LINE IS GREATER THAN 18m. 50% OF AREA FORWARD OF BUILDING LINE LANDSCAPED.

LANDSCAPE CALCULATION
(FOR DA APPLICATION WHERE APPLICABLE)

SITE AREA = 20,367m²
DWELLING = 217m²
OTHER AREAS = 1,714m²
PROPOSED POOL/COPING = 45m²
TOTAL B.U.A. = 1,976m²
LANDSCAPED = 18,391m² = 90%



PART SITE PLAN
SCALE 1:200@A3

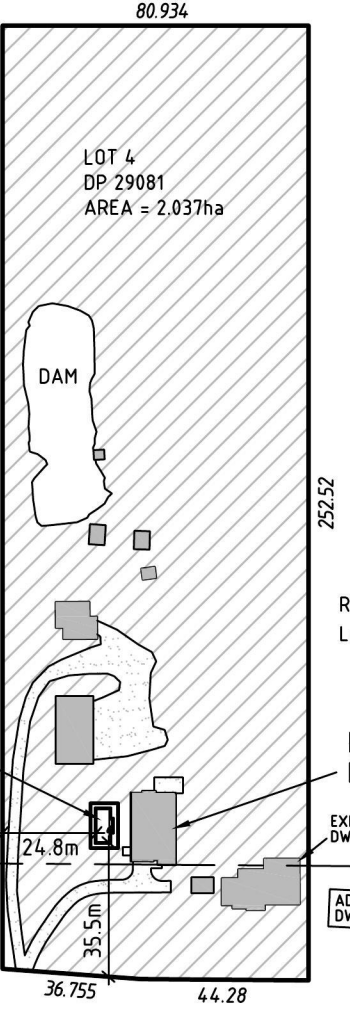

AREA FORWARD OF BUILDING LINE = 2,407m². REQUIRED LANDSCAPED = 50% = 1,204m². AREA LANDSCAPED FRONT OF BUILDING LINE = 1,857m²

REQUIRED L/SCAPE AT REAR = 4,583m²(50%)
LANDSCAPE AREA AT REAR = 15,552m² or
16,534m² INCLUDING DAM

THE NORTHERN ROAD
SITE PLAN
SCALE 1:2000@A3

LEGEND:

- DENOTES SOFT LANDSCAPE
- DENOTES HARDSTAND (CONCRETE, GRAVEL, PAVERS ETC.)
- DENOTES BUILDING STRUCTURES

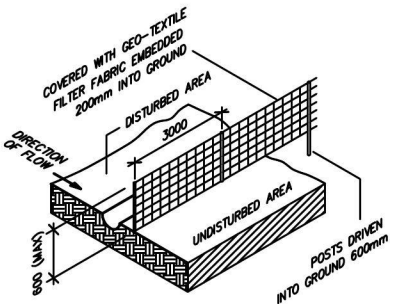

SEDIMENT FENCE DETAIL
NOT TO SCALE

ALL FENCES TO COMPLY WITH TO AS1926.1-2012 AND THE SWIMMING POOL ACT AND LOCAL COUNCIL REQUIREMENTS

DESIGNATED AREA FOR WASTE & MATERIAL STOCKPILE. EXCESS WASTE TO BE REMOVED FROM SITE

SITE LEVELS
TOP OF POOL COPING LEVEL +/- FROM EXISTING GROUND LEVEL.

A:	+500
B:	-500
C:	-400
D:	+400



LEISURE POOLS WESTERN
SYDNEY & ILLAWARRA
2/133 RUSSELL STREET
EMU PLAINS 2750
4721 0176

Pool: **ELEGANCE 9m**
Volume: **38,950 LTRS**
THE PROPOSED POOL TO COMPLY WITH THE SWIMMING POOL ACT AND REGULATIONS.

CUSTOMER / ADDRESS
JEANNETTE & LEANNE SMITH
2289 THE NORTHERN ROAD
MULGOA

ISSUE	DATE	REVISION
A	31-10-2016	INITIAL ISSUE

SHEET
1 of 2

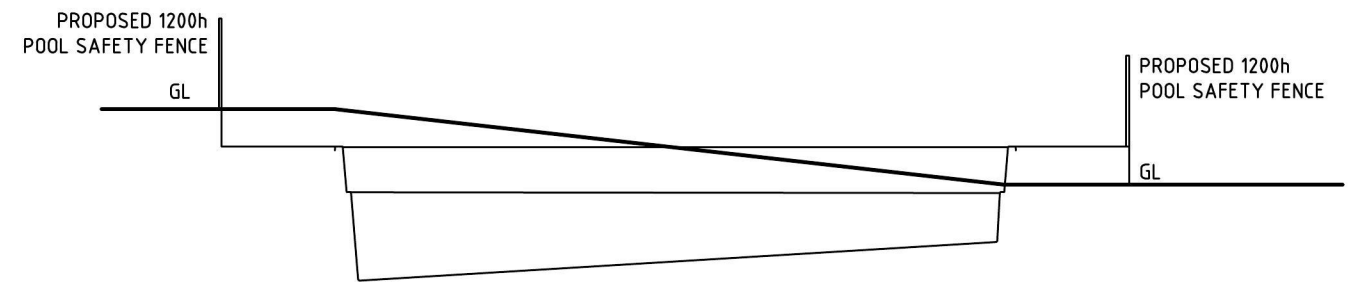

SOUTH-ELEVATION
SCALE 1:100@A3

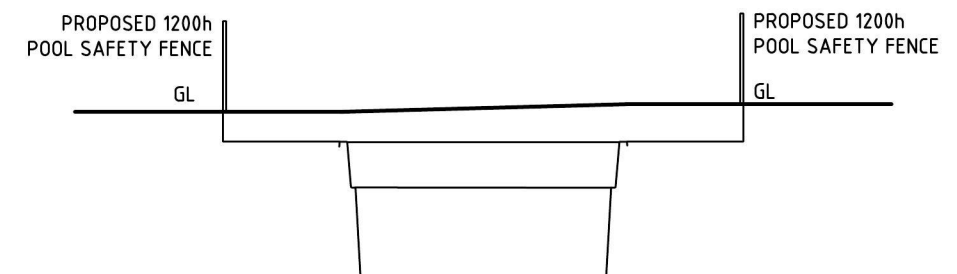

WEST-ELEVATION
SCALE 1: 100@A3

Document Set ID: 7438790
Version: 2, Version Date: 13/12/2016