

SUBJECT SITE

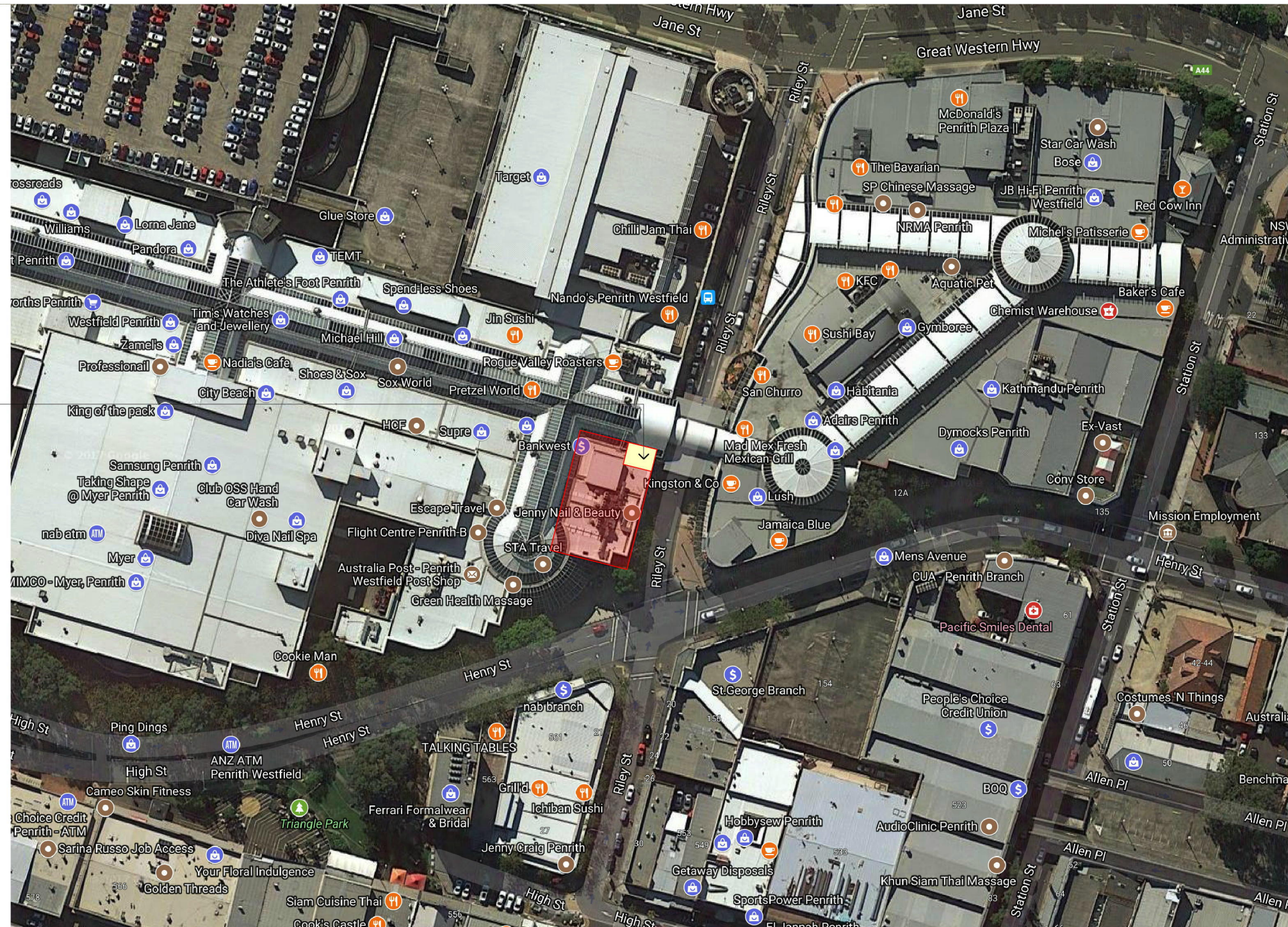

01

LOCATION MAP  
NOT TO SCALE

GENERAL NOTES

1. DO NOT SCALE DRAWINGS. FIGURED DIMENSIONS ARE TO BE FOLLOWED.
2. COPYRIGHT OF THESE DRAWINGS AND RELATED DOCUMENTS ARE RESERVED BY VIE STUDIO.
3. ALL DIMENSIONS ARE TO BE CONFIRMED ON SITE PRIOR TO CONSTRUCTION. IN THE EVENT OF ANY DISCREPANCIES ON THESE DRAWINGS, THE CONTRACTOR SHALL CONTACT THE DESIGNER BEFORE PROCEEDING WITH ANY WORK.
4. IT IS THE CONTRACTOR'S RESPONSIBILITY TO OBTAIN APPROVALS FROM APPROPRIATE AUTHORITIES INCLUDING LOCAL COUNCIL AND WATER BOARD PRIOR TO CONSTRUCTION.
5. MEASUREMENTS FOR THE FABRICATION OF SECONDARY COMPONENTS ARE TO BE TAKEN ON SITE TO SUIT.
6. CONTRACTOR TO Liaise WITH THIRD PARTY SUPPLIERS TO CONFIRM EXACT REQUIREMENTS, INCLUDING ELECTRICAL, DATA, COMM, HYDRAULICS AND ANY OTHER RELATED REQUIREMENTS.
7. CONTRACTOR TO ENSURE STRUCTURAL INTEGRITY, STABILITY AND FEASIBILITY OF ALL UNITS/COMPONENTS PRIOR TO FABRICATION. ALL STRUCTURAL COMPONENTS SHALL BE READ IN ACCORDANCE TO DETAILS AND SPECIFICATIONS PREPARED BY A STRUCTURAL ENGINEER.
8. ALL ARCHITECTURAL DOCUMENTATION ARE TO BE READ IN CONJUNCTION WITH OTHER CONSULTANTS' DRAWINGS/SPECIFICATION AND ALL OTHER RELATED DOCUMENTS.
9. ALL WORKS TO BE IN ACCORDANCE WITH THE BUILDING CODE OF AUSTRALIA, AUSTRALIAN STANDARDS, STATUTORY REGULATIONS AND LOCAL AUTHORITY REQUIREMENTS.

REV: NOTES:

- | REV: | NOTES:                   | DATE:      |
|------|--------------------------|------------|
| A    | FLOOR PLAN               | 2017.01.13 |
| B    | SHOPFRONT DA APPLICATION | 2017.02.06 |
| C    | PRELIMINARY DRAWINGS     | 2017.02.23 |
| D    | REVISED DRAWINGS         | 2017.03.16 |
| E    | REVISED DRAWINGS         | 2017.04.04 |
| F    | REVISED DRAWINGS         | 2017.04.11 |
| G    | CDC REVISED DRAWINGS     | 2017.05.11 |
| H    | REVISION                 | 2017.08.03 |
| I    | OUTDOOR SEATING PLAN     | 2017.09.13 |

DATE:

- | DATE:      |
|------------|
| 2017.01.13 |
| 2017.02.06 |
| 2017.02.23 |
| 2017.03.16 |
| 2017.04.04 |
| 2017.04.11 |
| 2017.05.11 |
| 2017.08.03 |
| 2017.09.13 |

PROJECT  
**GELATO MESSINA PENRITH**  
SHOP 060A WESTFIELD PENRITH PENRITH NSW 2750

PROJECT NO.  
17208-S

DRAWING TITLE:  
LOCATION MAP





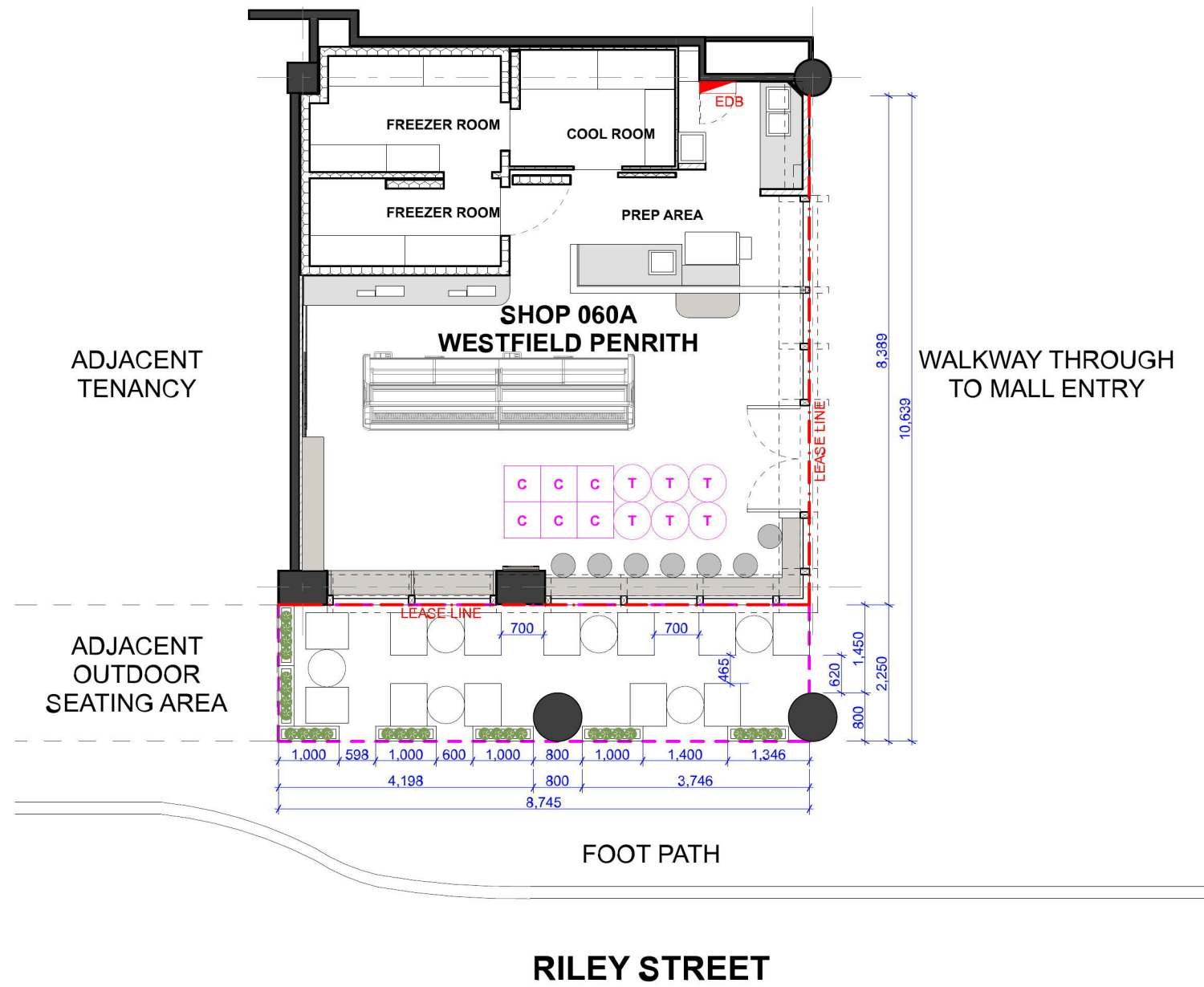

PAPER SIZE: A3 SCALE: 1:100

DRAWN BY: BL CHECKED BY: SL

DRAWING No: A-401 REVISION: 1

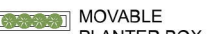

OUTDOOR FURNITURE SCHEDULE	
	OUTDOOR SEATING
	OUTDOOR TABLE
	MOVABLE PLANTER BOX

LEGEND		STORAGE SCHEDULE	
	CIRCULAR TABLE 620MM D		OUTDOOR CHAIR
	MOVABLE PLANTER BOX		INDOOR CHAIR
CIRCLE TABLE QTY: 6		OUTDOOR CHAIR QTY: 12	
		TOTAL AREA 19.5 M <sup>2</sup>	
			VERTICALLY STACKED EXTERNAL CHAIRS
			BACK-TO-BACK TABLES

01

## OUTDOOR SEATING PLAN

1:100



5/77-83 PARRAMATTA ROAD ANNANDALE NSW 2038  
T: 02 35505289 E: DESIGN@VIESTUDIO.COM.AU

Document ID: 7961067

Version: 1, Version Date: 06/12/2017

### GENERAL NOTES

- DO NOT SCALE DRAWINGS. FIGURED DIMENSIONS ARE TO BE FOLLOWED.
- COPYRIGHT OF THESE DRAWINGS AND RELATED DOCUMENTS ARE RESERVED BY VIE STUDIO.
- ALL DIMENSIONS ARE TO BE CONFIRMED ON SITE PRIOR TO CONSTRUCTION. IN THE EVENT OF ANY DISCREPANCIES ON THESE DRAWINGS, THE CONTRACTOR SHALL CONTACT THE DESIGNER BEFORE PROCEEDING WITH ANY WORK.
- IT IS THE CONTRACTOR'S RESPONSIBILITY TO OBTAIN APPROVALS FROM APPROPRIATE AUTHORITIES INCLUDING LOCAL COUNCIL AND WATER BOARD PRIOR TO CONSTRUCTION.
- MEASUREMENTS FOR THE FABRICATION OF SECONDARY COMPONENTS ARE TO BE TAKEN ON SITE TO SUIT.
- CONTRACTOR TO LAISE WITH THIRD PARTY SUPPLIERS TO CONFIRM EXACT REQUIREMENTS, INCLUDING ELECTRICAL, DATA, COMMS, HYDRAULICS AND ANY OTHER RELATED REQUIREMENTS.
- CONTRACTOR TO ENSURE STRUCTURAL INTEGRITY, STABILITY AND FEASIBILITY OF ALL UNITS/COMPONENTS PRIOR TO FABRICATION. ALL STRUCTURAL COMPONENTS SHALL BE READ IN ACCORDANCE TO DETAILS AND SPECIFICATIONS PREPARED BY A STRUCTURAL ENGINEER.
- ALL ARCHITECTURAL DOCUMENTATION ARE TO BE READ IN CONJUNCTION WITH OTHER CONSULTANTS' DRAWINGS/SPECIFICATION AND ALL OTHER RELATED DOCUMENTS.
- ALL WORKS TO BE IN ACCORDANCE WITH THE BUILDING CODE OF AUSTRALIA, AUSTRALIAN STANDARDS, STATUTORY REGULATIONS AND LOCAL AUTHORITY REQUIREMENTS.

### REV: NOTES:

- | REV: | NOTES:                   | DATE:      |
|------|--------------------------|------------|
| A    | FLOOR PLAN               | 2017.01.13 |
| B    | SHOPFRONT DA APPLICATION | 2017.02.06 |
| C    | PRELIMINARY DRAWINGS     | 2017.02.23 |
| D    | REVISED DRAWINGS         | 2017.03.16 |
| E    | REVISED DRAWINGS         | 2017.04.04 |
| F    | REVISED DRAWINGS         | 2017.04.11 |
| G    | CDC REVISED DRAWINGS     | 2017.05.11 |
| H    | REVISION                 | 2017.08.03 |
| I    | OUTDOOR SEATING PLAN     | 2017.09.13 |

### DATE:

- 2017.01.13  
2017.02.06  
2017.02.23  
2017.03.16  
2017.04.04  
2017.04.11  
2017.05.11  
2017.08.03  
2017.09.13

### PROJECT

GELATO MESSINA PENRITH  
SHOP 060A WESTFIELD PENRITH PENRITH NSW 2750

PROJECT NO.  
17208-S

### DRAWING TITLE:

OUTDOOR SEATING PLAN

PAPER SIZE: A3

SCALE: 1:100

DRAWN BY: BL

CHECKED BY: SL

DRAWING No:

REVISION:

A-402

1