

SUNBURST DRIVE

AVENUE

MIDNIGHT

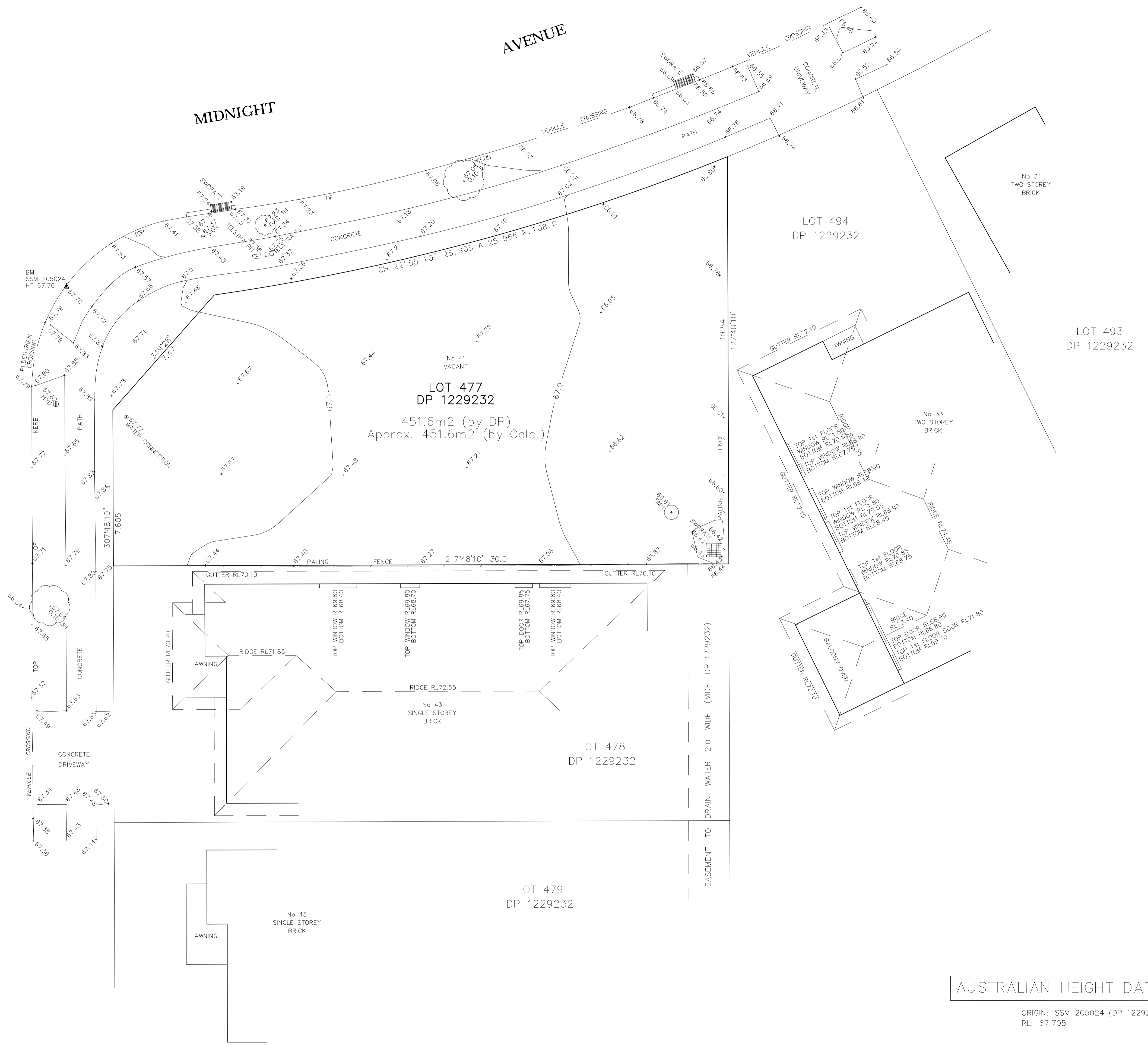

- IMPORTANT NOTES:**
1. This detail survey is not a "survey" as defined by the Surveying and Spatial Information Act 2002. If any structure is to be erected upon the land then the boundary corners MUST be marked.
 2. All bearings and distances are subject to final survey.
 3. If any building or structure is to be located relative to an existing feature shown on this plan, such feature should be located accurately by survey.
 4. Underground services have not been surveyed. Only visible services are shown and are in approximate positions only. A "Dial Before You Dig" search MUST be made before any excavation and construction work can commence.
 5. Ridge and gutter heights on subject and adjoining properties are approximate only.
 6. All tree canopies are to scale.
 7. Contours show indicative relief patterns only and are not to be used for level interpolation.
 8. These general notes should be stored with the supplied CAD drawing.



AUSTRALIAN HEIGHT DATUM

ORIGIN: SSM 205024 (DP 1229232)
RL: 67.705

DATE	REVISION	BY

© COPYRIGHT New South Surveys Pty Ltd, 2021. This plan is and shall remain the property of New South Surveys Pty Ltd. This plan is not to be used or reproduced by any process without prior written permission. Unauthorised use of this plan in any way is prohibited.



NOTE: ALL DIMENSIONS ARE IN METRES UNLESS SPECIFIED OTHERWISE

DRAWN:	PCJ
SURVEYED:	SF
CHECKED:	DH
	M.I.S. NSW

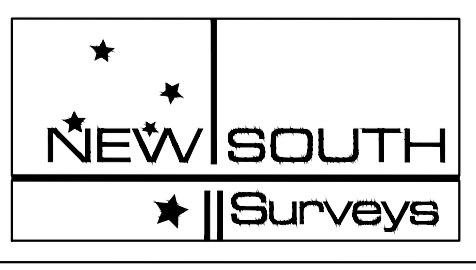

NEW SOUTH SURVEYS Pty Ltd
Land & Engineering Surveyors
P.O. BOX 617 Granville NSW 2142
Mobile: 0405 416 914 Fax: (02)9885 0630
Email: info@newsouthsurveys.com.au

CLIENT:	ZEDCORP DEVELOPMENTS
PROJECT:	41 SUNBURST DRIVE CADDENS TOPOGRAPHICAL SURVEY

SCALE:	1 : 100 @ A1
DATE:	01/06/2021
DRAWING No:	121282-2