

STORMWATER DRAINAGE PIT SCHEDULE

| PIT # | Pit Type | Internal Dimensions | Inlet Pipe/s | Outlet Pipe/s | Approx. Level Top of Cover | Cover Type | Step Iron |
|-----------------|---------------------|---------------------|--|----------------|----------------------------|------------------|-----------|
| P1 ^s | Grated Pit | 600 x 600 | NA | 41.35 | 41.95 | Webforge MSG 66D | N |
| P2 ^s | Grated Pit | 900 x 900 | NA | 41.50 | 42.10 | Webforge MSG 99D | N |
| P3 ^s | Grated Pit | 900 x 900 | From Pit P1 = 41.15 From Pit P2 = 41.20 | 41.10 | 42.15 | Webforge MSG 99D | N |
| Ex.P4 | Existing Grated Pit | TBC -900 x 900 | From Pit P3 = 40.70 Ex Pipe -IL = 40.68 | Ex. Pipe 40.66 | 42.02 | N/A Ex. Cover | N/A |
| P5 ^s | Grated Pit | 600 x 600 | NA | 41.20 | 41.93 | Webforge MSG 66D | N |
| P6 ^s | Grated Pit | 900 x 900 | From Pit P5 = 40.90 | 41.17 | 41.85 | Webforge MSG 99D | N |
| Ex.P7 | Existing Grated Pit | TBC -900 x 900 | From Pit P6 = 40.50 Ex Pipe -IL = 41.10 | Ex. Pipe 40.00 | 41.61 | N/A Ex. Cover | N/A |

* Outlet pipes of the pit/strip drain are to have a wall mounted Mascot Engineering Trash Screen Item No: MMMP5 (or other similar approved Trash Screen) installed.

WARNING:
The existing services shown on this plan have been derived either from field survey or plotted from records of the relevant authorities and no guarantee is given as to their accuracy. It is the responsibility of the contractor to verify on site the location of all services prior to the commencement of works.

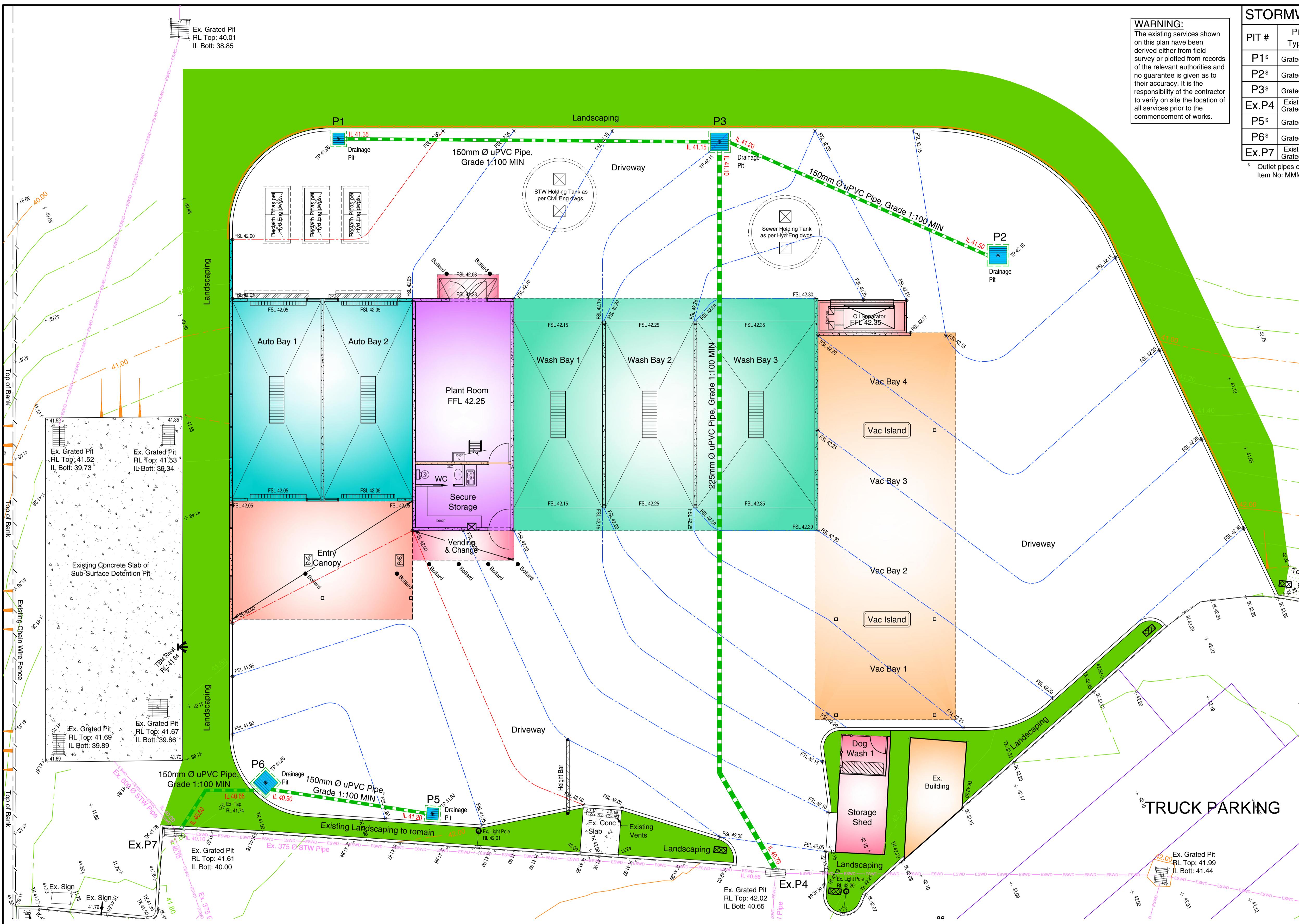

LEGEND

- New Stormwater Drainage Pipe
- Existing Stormwater Drainage Pipe
- Down Pipe
- Down Pipe Spreader (onto ground level)
- Rain Water Tank Overflow Pipe
- ▶ One Way Valve
- x Existing surface levels
- * FSL 42.05 Finished surface levels
- Grated Drainage Pit

- CIVIL NOTES:**
- Contractor / builder are to acquaint themselves with location of all services prior to commencement of work - no responsibility will be taken for any damage to services whether shown or not.
 - All work (including Pits & Crossovers) is to comply with the Tamworth Regional Council specifications & Standard Stormwater Drawings.
 - All Stormwater pipes with their size not noted on plan to be 150mm Ø uPVC quality with MIN grade of 1:100 and are to be fully sealed. All pipes under driveway areas are to be 150mm Ø uPVC quality. I.O. (inspection opening) fittings are to be installed at all pipe junctions and changes of direction except at pits. New stormwater pipes installed under hard stand (ie: Concrete) driveway & paved areas are to have a MIN cover of 450mm from finished surface level to top of the stormwater pipe UNO. Pipes installed in garden areas (not exposed to vehicle access) to have a MIN cover of 300mm from finished surface level to top of the stormwater pipe UNO by manufacturer of alternative pipe type. Pipes installed under non-hard stand (ie: Gravel/Crushed Rock) driveway areas exposed to vehicle access are to have a MIN cover of 600mm from finished surface level to top of the stormwater pipe.
 - All drainage works & installation of same shall comply with AS 3500.2 Part 3 Stormwater Drainage. Stormwater pipes shall be located in sufficient proximity to other services as per AS 3500.3 Cl 6.2.6.
 - Agricultural drains shall be 90/100mm diameter 'Draincoil' laid in continuous lengths to a minimum grade of 1 in 400 -alternatively- they are to be specified by the Structural Engineer.
 - All excess spoil to be disposed of off site as directed.
 - All concrete to be f'c 32 MPa MIN.
 - The contractor shall arrange all inspections and obtain certificates of approval plus any additional instructions from the relevant authorities prior to backfilling/enclosing new services.
 - Backfilling of trenches is to be in accordance with the relevant Council Standard Specifications, Manufacturers specifications and/or in accordance with the Soil report.
 - Forty-eight hours notice shall be given to the relevant Council before starting works outside property boundary.
 - Pavement make up to be as noted on the Civil Engineering drawings.
 - Connect to legal point of discharge to the satisfaction of the Tamworth Regional Council's Engineer.
 - All pit wall & base thicknesses shall be 150mm MIN.
 - All pit grates shall be as noted on the Pit Schedule. They shall be installed & maintained in accordance with the Manufacturer's recommendations.
 - All drains are to be laid in accordance with manufacturers specifications.
 - Concrete encasement around pipes, where noted on the drawings, shall be of square cross section with 100mm MIN cover to pipe.
 - Any footpaths, driveways or existing features disturbed, broken or affected by the works are to be reinstated to the complete satisfaction of Tamworth Regional Council's Supervisor/Engineer.
 - Dial 1100 Before You Dig for existing underground services which may be affected by the proposed services.
 - All excess spoil to be disposed of off site as directed.

PROPOSED CAR WASH SITE STORMWATER LAYOUT PLAN

SCALE 1 : 100

| ISSUE | DESCRIPTION | DATE |
|-----------|---------------------------------|------------|
| A | Issued For DA Planning Approval | 29-11-2020 |
| REVISIONS | | |

ISSUED FOR PLANNING APPROVAL
NOT TO BE USED FOR CONSTRUCTION PURPOSES

DIAL BEFORE YOU DIG
www.1100.com.au

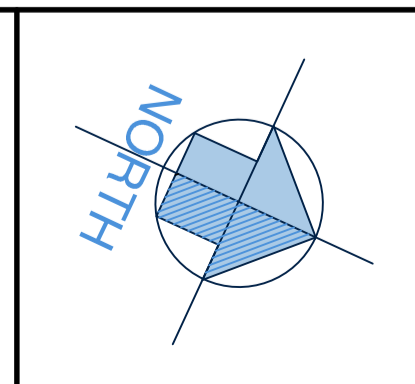

PROPOSED CAR WASH ADDITION

AT: LOT 3, 1-21 CRANBROOK ROAD,
CRANBROOK, NSW, 2749.
FOR: CARWASH WORLD PTY LTD

Drawn: T. MICHAELS Designed: T. MICHAELS

TMC Building Design Group
P.O. Box 3494, Mornington, VIC, 3931. Phone No. 0416 114 573
E: mail - tracay@tmcdesign.com.au

Scale: 1:100 (A1) Date: NOV 2020 Issue: A

Sheet No: C1 of 1 Job No: 20-026 DA