

\* THIS DETAIL SURVEY IS NOT A 'LAND SURVEY' AS DEFINED BY THE SURVEYING ACT, 2002.  
 \* DISTANCES SHOWN HAVE BEEN TAKEN FROM A REGISTERED PLAN OF SUBDIVISION KNOWN AS DP16937  
 \* THE AREA SHOWN HAS BEEN CALCULATED FROM THE REGISTERED LAND DIMENSIONS.  
 \* BOUNDARY ANGLES AND DIMENSIONS ARE SUBJECT TO SURVEY INVESTIGATION.  
 \* VISIBLE AND ACCESSIBLE SERVICES HAVE ONLY BEEN LOCATED. THE LOCATION OF ANY UNDERGROUND SERVICES WAS NOT INVESTIGATED. INVESTIGATIONS WITH DIAL BEFORE YOU DIG (PH:1100) AND SERVICE PROVIDORS MUST BE UNDERTAKEN PRIOR TO ANY DESIGN, EXCAVATION AND/OR CONSTRUCTION WORKS.

**TITLE NOTES :**  
 1 RESERVATIONS AND CONDITIONS IN THE CROWN GRANT(S)  
 2 AP40027 MORTGAGE TO AMP BANK LIMITED  
 THE ABOVE NOTIFICATIONS HAVE NOT BEEN INVESTIGATED.

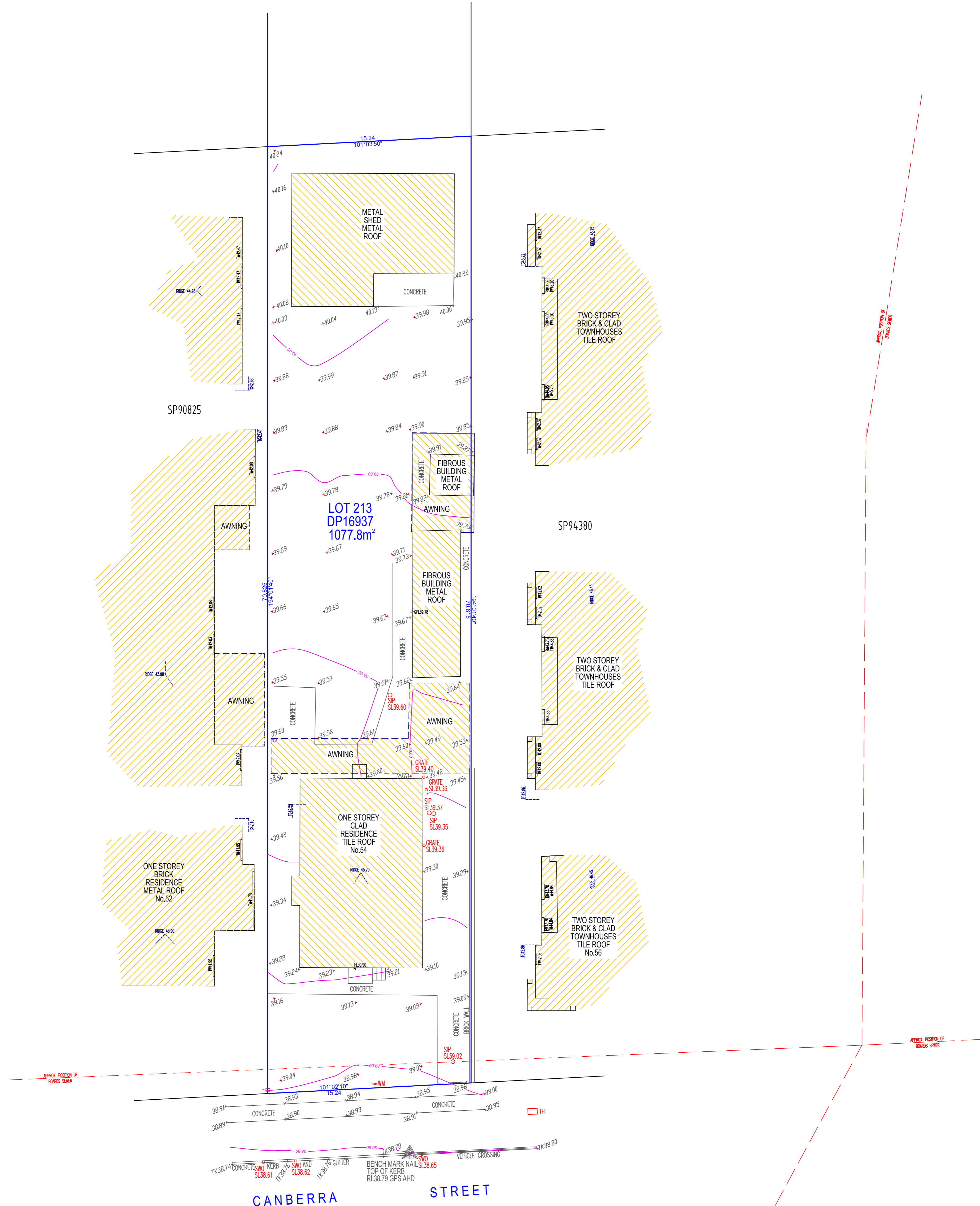
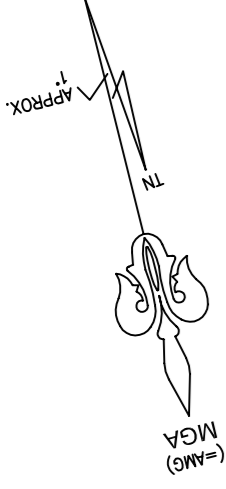

REVISION	DATE	DETAILS
A	1/10/2021	1ST ISSUE

© UNITED SURVEYORS 2021  
 REPRODUCTION WITHOUT WRITTEN APPROVAL IS STRICTLY PROHIBITED

DATUM: AUSTRALIAN HEIGHT DATUM  
 ORIGIN: GLOBAL POSITIONING SYSTEM  
 DWG REF: 10722-1  
 REDUCTION RATIO: 1:150  
 SHEET SIZE: A1  
 DATE OF SURVEY: 29 SEPTEMBER 2021  
 SURVEYOR: RB/JF  
 SHEET 1 OF 1

**LEGEND**  
 WM - WATER METER  
 TEL - TELSTRA PIT  
 SIP - SEWER INSPECTION POINT  
 SWO - STORMWATER OUTLET

\* AUSTRALIAN HEIGHT DATUM HAS BEEN DETERMINED USING GLOBAL POSITIONING SYSTEMS (GPS). THE ACCURACY OF THE LEVEL IS DEPENDANT ON THE NUMBER AND POSITION OF SATELLITES AT THE TIME OF SURVEY.



**PLAN OF: DETAIL AND LEVELS**  
**AT: 54 CANBERRA STREET**  
**OXLEY PARK**  
**BEING: LOT 213 IN DP16937**  
**CLIENT: MAZEN ABU-DUHOU**