

LEGEND

- mulch
- artificial turf - 40mm pile summer prestige
- stoneset - cudjee yellow 10mm
- timber decking - hardwood - spotted gum
- tree stumps min 350mmØ - heights between 200-550mm for balancing and 300mm for seating
- stepping stones - concrete or sandstone flagging

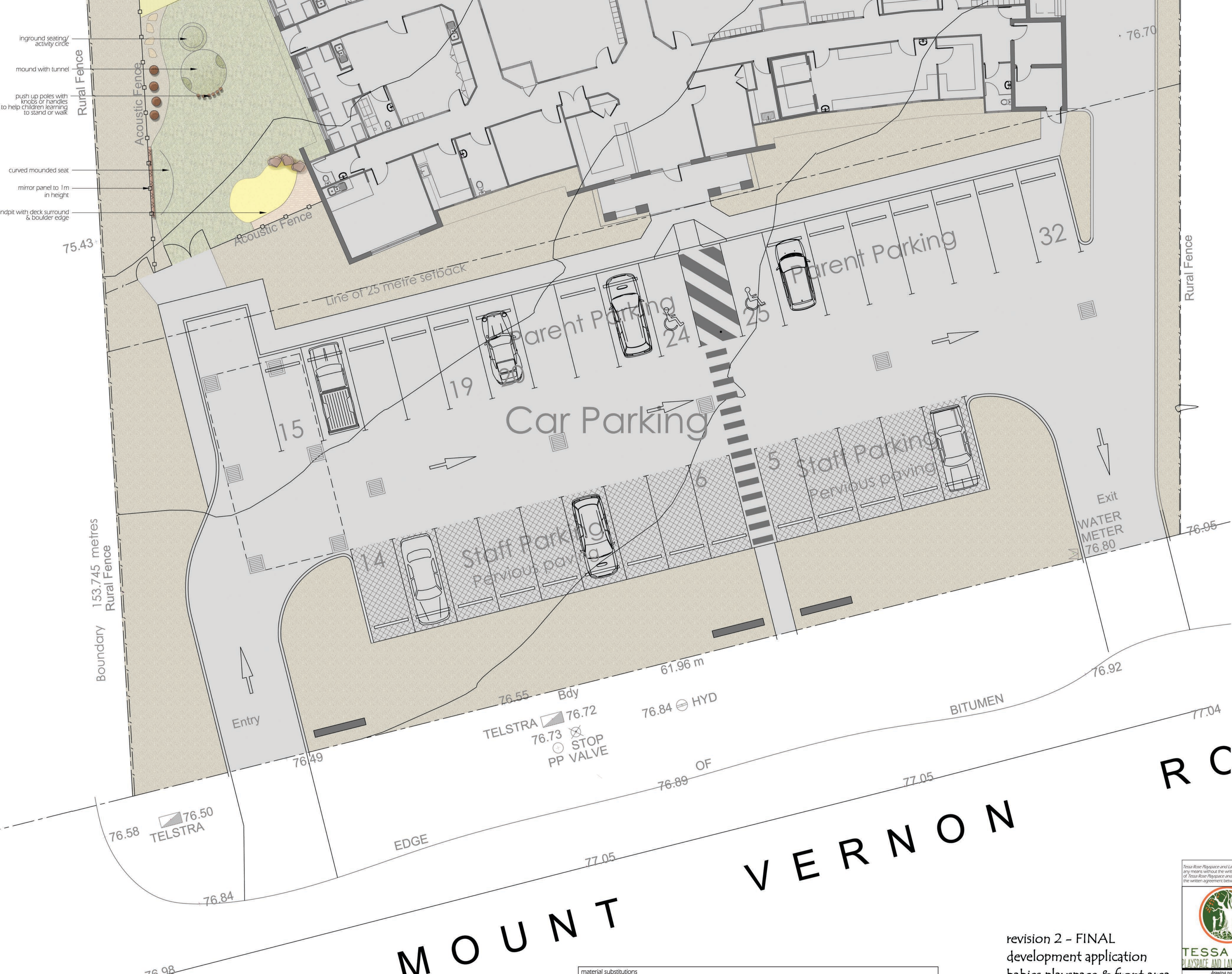

NOTES

soil and mulch
Use an Australian Standard planter mix with low phosphorus for where natives have been specified & other good quality soil mix in other areas with a min of 5% OM.

mulch
Use mulch with material size greater than 15mm only - recommend Forest Blend - ANL in all planters

planting
Plants shall be vigorous, well established, hardened off, of good form consistent with the species or variety, free from disease & insect pests, with large healthy root systems & no evidence of having been restricted or damaged. All plants to be planted in locations specified on this plan. Planting holes to be twice the pot size & all soil to loosely fill the planting hole. Plants must be watered before planting begins, immediately after planting and on a continual basis thereafter until established. Construct a watering basin around the base of each individual planted tree

All plants selected and specified are appropriate, non-toxic and non-hazardous and comply with the *Education and Care Services National Regulations 2011* and *Kidsafe* as being suitable for use in child care centres

timber
Use hardwood timber only preferably *Spotted Gum* for all visible timber sections & treated Durability class 1, H4 for in ground use & H3 otherwise. Use of sustainable hardwood timbers are preferred. Open timber features such as knot holes, loose or unsound knots, gum pockets, loose gum veins, shakes & termite galleries not to be used on the outer face of the timber. All timber contactable by hand shall be dressed or sanded smooth free of splinters & shavings. All bolted connections shall use washers under bolt heads & nuts & all external bolts, nuts, washers & decking screws shall be stainless steel. All exposed timber to be sealed with *Sikkens Cetol HLS* in Mahogany

Tessa Rose PlaySpace and Landscape Design reserves all rights. This drawing is copyright and shall not be reproduced or copied in any form or by any means without the written permission of Tessa Rose PlaySpace and Landscape Design. Any license, expressed or implied to use this document for any purpose is restricted to the terms of the written agreement between Tessa Rose PlaySpace and Landscape Design and the instructing party.

24 Baxter Road MASCOT NSW 2020
04 16 565297
tess@tessaroselandscapes.com.au
www.tessaroselandscapes.com.au

PROJECT:
Proposed Child Care Centre
110-112 Mount Vernon Rd
MOUNT VERNON NSW 2178

date: 15 October 2019 drawing no. 5/5
scale: 1:100/A1 drawn by: kj checked tm

TESSA ROSE
PLAYSPACE AND LANDSCAPE DESIGN

VERNON RC

This plan is certified as meeting all relevant local government DCP's & legislation and the *Education and Care Services National Regulations 2011*

revision 2 - FINAL
development application
babies playspace & front area
playspace/landscape design plan - surfaces

material substitutions
Materials which are not available or cannot be reasonably provided for the works may be substituted in consultation with the client

1.033ha

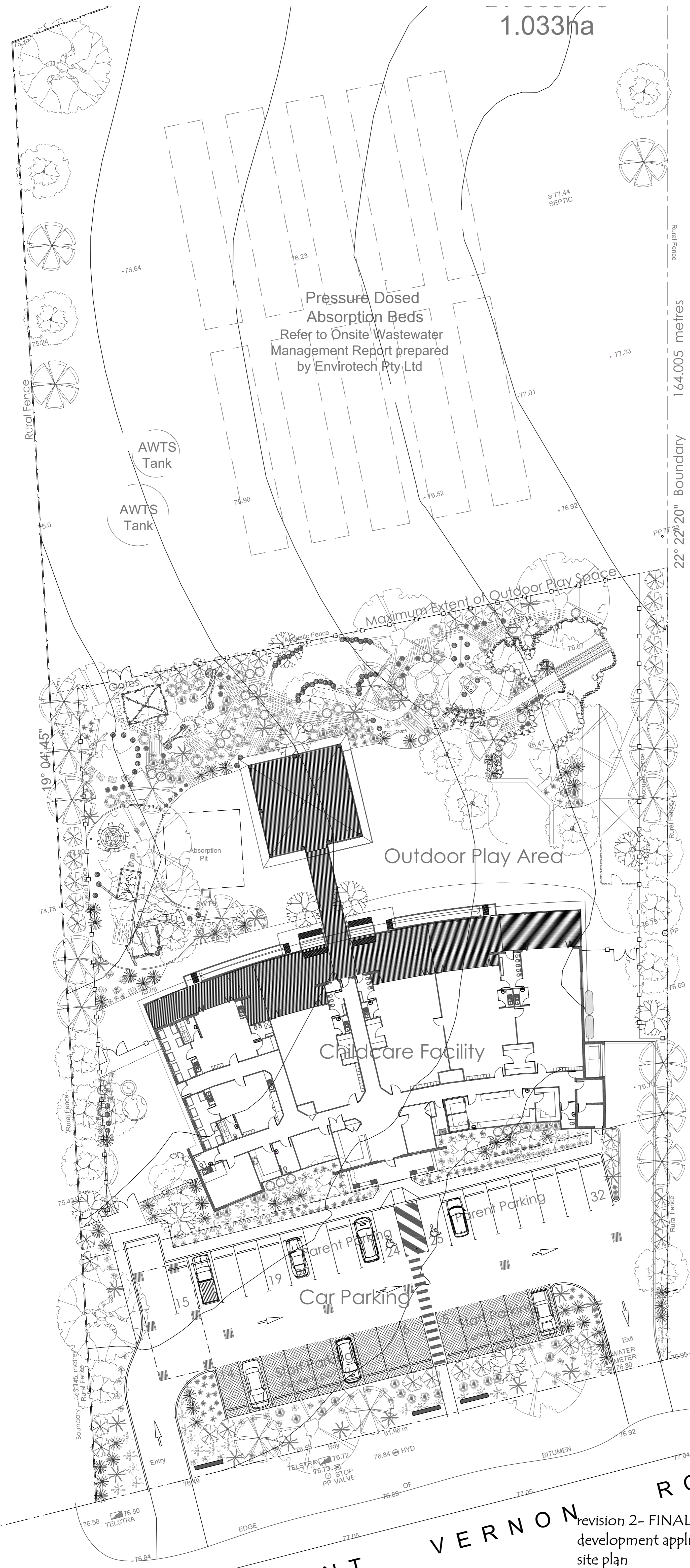

LEGEND - Site Plan

| | |
|--|--|
| | empire zoisya species or similar |
| | stoneseer - cudgee yellow 10mm |
| | decomposed granite - gold |
| | sandstone flagging paving |
| | timber decking - hardwood - spotted gum |
| | mulch |
| | pebbles over 50mmØ |
| | tree stumps min 350mmØ - heights between 200-550mm for balancing and 300mm for seating |
| | stepping stones - concrete or sandstone flagging |
| | railway sleepers as pathway |
| | artificial turf - 40mm pile summer prestige |

Tessa Rose Playspace and Landscape Design reserves all rights. This drawing is copyright and shall not be reproduced or copied in any form or by any means without the written permission of Tessa Rose Playspace and Landscape Design. Any license, expressed or implied to use this document for any purpose is restricted to the terms of the written agreement between Tessa Rose Playspace and Landscape Design and the instructing party.

24 Baxter Road MASCOF NSW 2020
0416 565297
tessa@tessaroselandscapes.com.au
www.tessaroselandscapes.com.au

PROJECT:
Proposed Child Care Centre
110-112 Mount Vernon Rd
MOUNT VERNON NSW 2178

date: 15 October 2019 **drawing no.:** A/5
scale: 1:200/A1 **drawn by:** kj **checked:** tm

drawing notes:
1. Contractor should check site conditions and measurements prior to works
2. No substitutions for plants and materials may occur without prior approval

This plan is certified as meeting all relevant local government DCP's & legislation and the Education and Care Services National Regulations 2011

VERNON ROAD

revision 2- FINAL
development application
site plan

- Australian Standards**
- AS 1684 Residential Timber Framed Construction Part 1
 - AS 1720.1 - 1997 (Amdt 4) 2002 Timber Structures - Design
 - AS 4419 - 2002 Soils for Landscaping and Garden Use
 - AS 3600 - 2009 (Amdt 1 - 2012) Concrete Structures
 - AS 1012 Methods of Testing Concrete
 - AS 3610 - 1996 Formwork for Concrete
 - AS/NZ4455 - Part 1 - 2008 and Part 2 - 2010 Masonry Units, Pavers, Flags and Segmental Retaining Walls - Masonry Units
 - AS/NZS 4486.1: 2014 Playgrounds and playground equipment
 - AS/NZS 4422: 2014 Playground surfacing - Specifications, requirements and test methods
 - AS 1428.1 - 2009 (Amdt 1 - 2010) Design for Access and Mobility - General requirements for Access - New Building Works
 - AS 1428.3 - 1992 Requirements for children and adolescents with physical disabilities

- LEGEND**
- empire zoisya species or similar
 - stonerac - cudgee yellow 10mm
 - decomposed granite - gold
 - sandstone flagging paving
 - timber decking - hardwood - spotted gum
 - mulch
 - pebbles over 50mmØ
 - tree stumps min 350mmØ - heights between 200-550mm for balancing and 300mm for seating
 - stepping stones - concrete or sandstone flagging
 - railway sleepers as pathway

PLANTS TOTAL FOR FULL SITE

| TREES | | | | | | | |
|----------------------|---------------------------------|------------------------------------|--------|----------|----------|----------------------------|----|
| symbol | botanical name | common name | height | width | pot size | no. | |
| | <i>eucalyptus punctata</i> | narrow leaved iron bark | 15m | 10m | 75L | 7 | |
| | <i>eleocharis reticulatus</i> | blueberry ash | 12m | 5m | 100L | 22 total (3) in outer area | |
| | <i>callistemon viminalis</i> | dawson's river creeper bottlebrush | 5-6m | 3m | 200mm | 44 | |
| | <i>casuarina cunninghamiana</i> | river she-oak | 20m | 10m | 100L | 5 total (1) in outer area | |
| | <i>tristaniaopsis laurina</i> | luscious | n/a | 7-10m | 46m | 24 total (3) in outer area | |
| | <i>melaleuca decora</i> | white feather honeyeucalypt | 6m | 4m | 45L | 10 | |
| SHRUBS | | | | | | | |
| | <i>indigofera australis</i> | australia indigo | 1-2m | 1-2m | 200mm | 26 | |
| | <i>westringia hybrid</i> | blue gem coastal rosemary | 1-1.5m | 0.8-1.3m | 200mm | 46 | |
| | <i>melaleuca thymifolia</i> | pink lace | n/a | 1-1.2m | 1m | 29 | |
| | <i>hardenbergia violacea</i> | meera | n/a | 0.5m | 1-2m | 53 | |
| GRASSES/GROUNDCOVERS | | | | | | | |
| | <i>grevillea hybrid</i> | teaz | n/a | 0.2m | 1-2m | 38 | |
| | <i>angozanthus</i> | gold velvet kangaroo paw | 0.6m | 0.6m | 150mm | 39 | |
| | <i>dianella caerulea</i> | breeze | n/a | 0.7m | 0.7m | 39 | |
| | <i>paai poliorrhiza</i> | 'kingsdale' | n/a | 0.5m | 0.5m | 25 | |
| | <i>lomandra longifolia</i> | 'easy as' | n/a | 0.6m | 0.6m | 86 | |
| | <i>themeda australis</i> | meera | n/a | 0.4m | 0.6m | 43 | |
| CLIMBERS | | | | | | | |
| | <i>pandorea pandorana</i> | 'ruby belle' | n/a | climber | climber | 200mm | 10 |
| FEATURE | | | | | | | |
| | <i>doryanthes excelsa</i> | gymea lily | 2m | 2m | 140mm | 22 | |



NOTES

soil and mulch
Use an Australian Standard planter mix with low phosphorus for where natives have been specified & other good quality soil mix in other areas with a min of 5% OM.

planting
Use mulch with material size greater than 15mm only - recommend Forest Blend - ANL in all planters
Plants shall be vigorous, well established, hardened off, of good form consistent with the species or variety, free from disease & insect pests, with large healthy root systems & no evidence of having been restricted or damaged. All plants to be planted in locations specified on this plan. Planting holes to be twice the pot size & all soil to loosely fill the planting hole. Plants must be watered before planting begins, immediately after planting and on a continual basis thereafter until established. Construct a watering basin around the base of each individual planted tree
All plants selected and specified are appropriate, non-toxic and non-hazardous and comply with the Education and Care Services National Regulations 2011 and Kidsafe as being suitable for use in child care centres

material substitutions
Materials which are not available or cannot be reasonably provided for the works may be substituted in consultation with the client

timber
Use hardwood timber only preferably Spotted Gum for all visible timber sections & treated Durability class 1, H4 for in ground use & H3 otherwise. Use of sustainable hardwood timbers are preferred. Open timber features such as knot holes, loose or unsound knots, gum pockets, loose gum veins, shakes & termite galleries not to be used on the outer face of the timber. All timber contactable by hand shall be dressed or sanded smooth free of splinters & shavings. All bolted connections shall use washers under bolt heads & nuts & all external bolts, nuts, washers & decking screws shall be stainless steel. All exposed timber to be sealed with Sikkers Cetol HLS in Mahogany

revision 2 - FINAL
development application
rear playspace
playspace/landscape design plan - plants

Tessa Rose Playspace and Landscape Design reserves all rights. This drawing is copyright and shall not be reproduced or copied in any form or by any means without the written permission of Tessa Rose Playspace and Landscape Design. Any license, expressed or implied to use this document for any purpose is restricted to the terms of the written agreement between Tessa Rose Playspace and Landscape Design and the instructing party.

24 Baxter Road MASCOT NSW 2020
0416 565297
tess@tessaroselandscapes.com.au
www.tessaroselandscapes.com.au

PROJECT:
Proposed Child Care Centre
110-112 Mount Vernon Rd
MOUNT VERNON NSW 2178

date: 15 October 2019
scale: 1:100/A1
drawing no.: 2/5
drawn by: kj checked tm

TESSA ROSE
PLAYSPACE AND LANDSCAPE DESIGN

1. Contractor should check site conditions and measurements prior to works
2. No substitutions for plants and materials may occur without prior approval

This plan is certified as meeting all relevant local government DCP's & legislation and the Education and Care Services National Regulations 2011

- Australian Standards**
 All materials & workmanship shall be in accordance with the relevant standards of the *Standards Association of Aus.*
- AS1684 Residential Timber Framed Construction Part 1
 - AS1720.1 - 1997 (Amdt 4) 2002 Timber Structures - Design
 - AS4419 - 2002 Soils for Landscaping and Garden Use
 - AS3600 - 2009 (Amdt 1 - 2012) Concrete Structures
 - AS1012 Methods of Testing Concrete
 - AS3610 - 1996 Formwork for Concrete
 - AS/NZ4455 - Part 1 - 2008 and Part 2 - 2010 Masonry Units, Pavers, Flags and Segmental Retaining Walls - Masonry Units
 - AS/NZS 4486.1: 2014 Playgrounds and playground equipment
 - AS/NZS 4422: 2014 Playground surfacing - Specifications, requirements and test methods
 - AS1428.1 - 2009 (Amdt 1 - 2010) Design for Access and Mobility - General requirements for Access - New Building Works
 - AS1428.3 - 1992 Requirements for children and adolescents with physical disabilities

- LEGEND**
- empire zoisya species or similar
 - stoneset - cudgee yellow 10mm
 - decomposed granite - gold
 - sandstone flagging paving
 - timber decking - hardwood - spotted gum
 - mulch
 - pebbles over 50mmØ
 - tree stumps min 350mmØ - heights between 200-550mm for balancing and 300mm for seating
 - stepping stones - concrete or sandstone flagging
 - railway sleepers as pathway

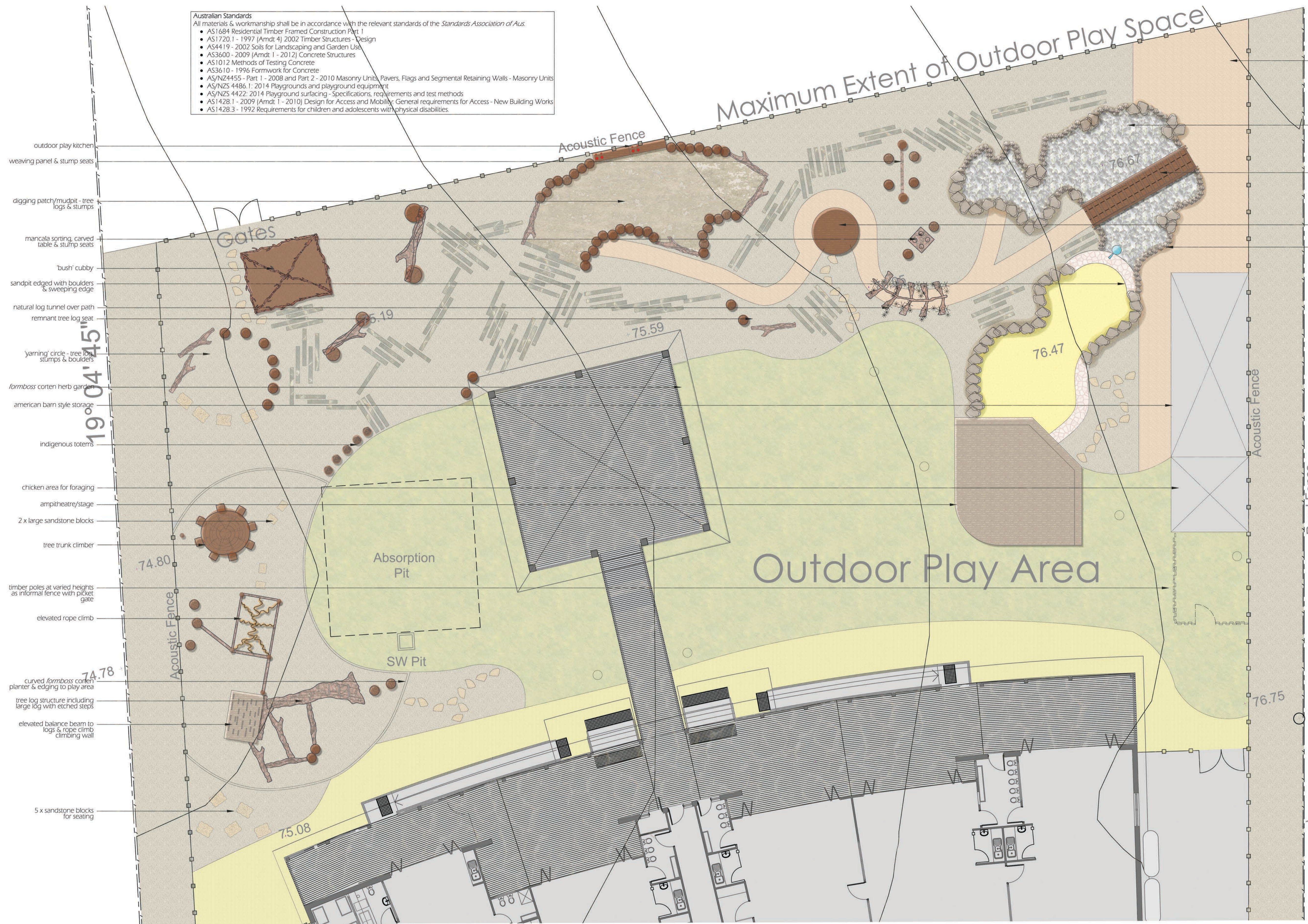

19° 04' 45" S
 151° 04' 45" E

Rural Fence
 76.75
 76.1

NOTES

soil and mulch
 Use an Australian Standard planter mix with low phosphorus for where natives have been specified & other good quality soil mix in other areas with a min of 5% OM.

planting
 Use mulch with material size greater than 15mm only - recommend Forest Blend - ANL in all planters
 Plants shall be vigorous, well established, hardened off, of good form consistent with the species or variety, free from disease & insect pests, with large healthy root systems & no evidence of having been restricted or damaged. All plants to be planted in locations specified on this plan. Planting holes to be twice the pot size & all soil to loosely fill the planting hole. Plants must be watered before planting begins, immediately after planting and on a continual basis thereafter until established. Construct a watering basin around the base of each individual planted tree
 All plants selected and specified are appropriate, non-toxic and non-hazardous and comply with the *Education and Care Services National Regulations 2011* and *Kidsafe* as being suitable for use in child care centres

material substitutions
 Materials which are not available or cannot be reasonably provided for the works may be substituted in consultation with the client

timber
 Use hardwood timber only preferably *Spotted Gum* for all visible timber sections & treated Durability class 1, H4 for in ground use & H3 otherwise. Use of sustainable hardwood timbers are preferred. Open timber features such as knot holes, loose or unsound knots, gum pockets, loose gum veins, shakes & termite galleries not to be used on the outer face of the timber. All timber contactable by hand shall be dressed or sanded smooth free of splinters & shavings. All bolted connections shall use washers under bolt heads & nuts & all external bolts, nuts, washers & decking screws shall be stainless steel. All exposed timber to be sealed with *Sikkens Cetol HLS* in Mahogany

revision 2 - FINAL
 development application
 rear playspace
 playspace/landscape design plan - surfaces

Tessa Rose Playspace and Landscape Design reserves all rights. This drawing is copyright and shall not be reproduced or copied in any form or by any means without the written permission of Tessa Rose Playspace and Landscape Design. Any license, expressed or implied to use this document for any purpose is restricted to the terms of the written agreement between Tessa Rose Playspace and Landscape Design and the instructing party.

24 Baxter Road MASCOT NSW 2020
 0416 565297
 tess@tessarose.com.au
 www.tessarose.com.au

PROJECT:
 Proposed Child Care Centre
 110-112 Mount Vernon Rd
 MOUNT VERNON NSW 2178

date: 15 October 2019
 scale: 1:100/A1
 drawing no.:3/5
 drawn by: kj checked tm

TESSA ROSE
 PLAYSACE AND LANDSCAPE DESIGN

NOTES
 1. Contractor should check site conditions and measurements prior to works
 2. No substitutions for plants and materials may occur without prior approval

This plan is certified as meeting all relevant local government DCP's & legislation and the *Education and Care Services National Regulations 2011*

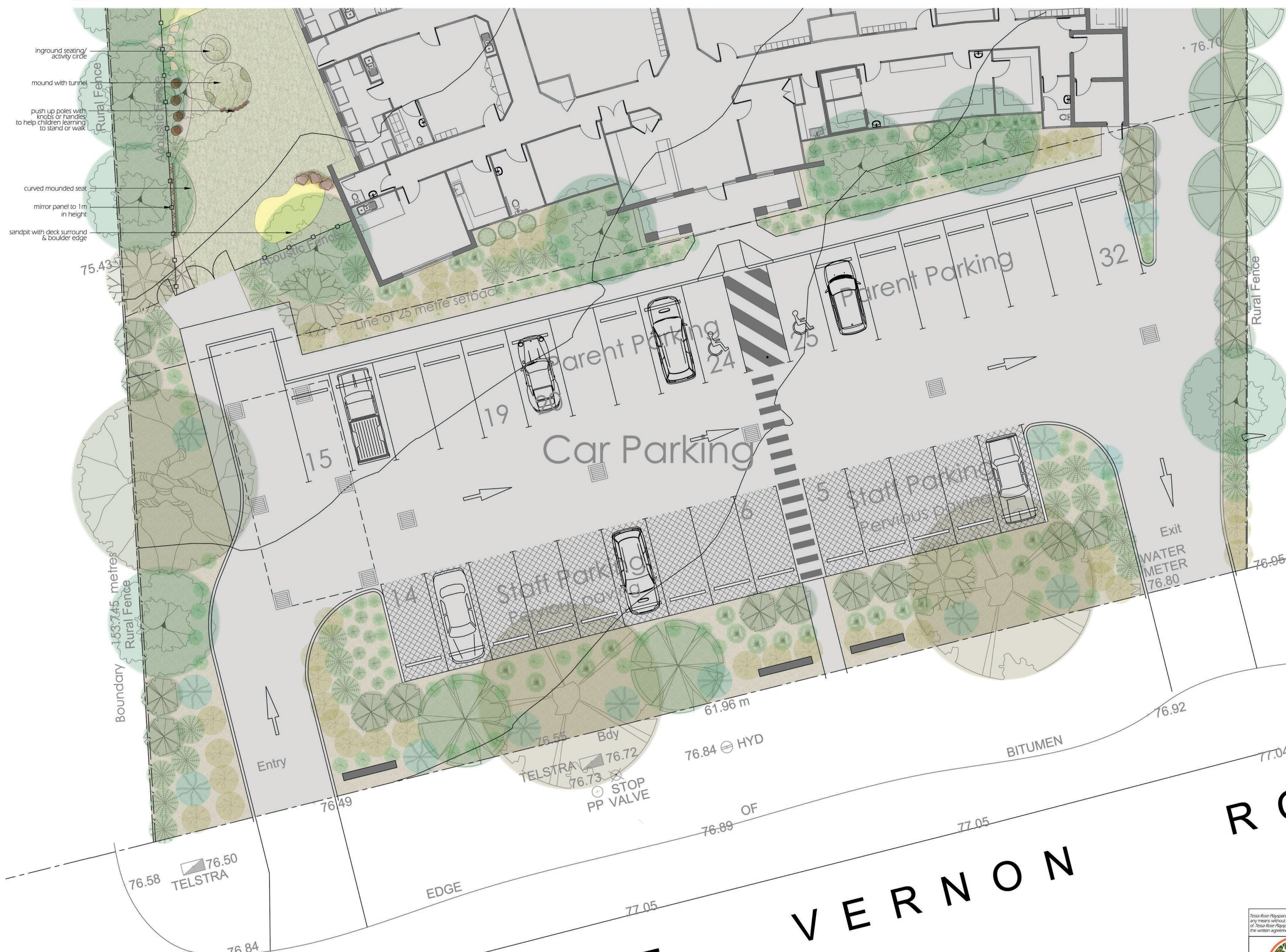

LEGEND

- mulch
- artificial turf - 40mm pile summer prestige
- stoneset - cudjee yellow 10mm
- timber decking - hardwood - spotted gum
- tree stumps min 350mmØ - heights between 200-550mm for balancing and 300mm for seating
- stepping stones - concrete or sandstone
- flagging

PLANTS TOTAL FOR FULL SITE

| TREES | | | | | | | |
|----------------------|---------------------------------|---------------------------|--------|----------|----------|----------------------------|----------------------------|
| symbol | botanical name | common name | height | width | pot size | no | |
| | <i>eucalyptus punctata</i> | narrow leaved iron bark | 15m | 10m | 75L | 7 | |
| | <i>eleocharis reticulata</i> | blueberry ash | 12m | 5m | 100L | 22 total (3) in outer area | |
| | <i>callistemon viminalis</i> | dawson's river creeper | 5-6m | 3m | 200mm | 44 | |
| | <i>casuarina cunninghamiana</i> | river she-oak | 20m | 10m | 100L | 5 total (1) in outer area | |
| | <i>tristanopsis laurina</i> | 'luscious' | n/a | 7-10m | 4-6m | 75L | 24 total (3) in outer area |
| | <i>melaleuca decora</i> | white feather honeysuckle | 6m | 4m | 45L | 10 | |
| SHRUBS | | | | | | | |
| | <i>indigofera australis</i> | australia indigo | 1-2m | 1-2m | 200mm | 26 | |
| | <i>westringia hybrid</i> | blue gem coastal rosemary | 1-1.5m | 0.8-1.3m | 200mm | 46 | |
| | <i>melaleuca thymifolia</i> | 'pink lace' | n/a | 1-1.2m | 1m | 200mm | 29 |
| | <i>hardenbergia violacea</i> | 'meema' | n/a | 0.5m | 1-2m | 150mm | 53 |
| GRASSES/GROUNDCOVERS | | | | | | | |
| | <i>grevillea hybrid</i> | 'katez' | n/a | 0.2m | 1-2m | 150mm | 38 |
| | <i>angozanthus</i> | 'gold velvet' | 0.6m | 0.6m | 150mm | 39 | |
| | <i>dianella caerulea</i> | 'breeze' | n/a | 0.7m | 0.7m | 150mm | 39 |
| | <i>poa polytrichoides</i> | 'kingsdale' | n/a | 0.5m | 0.5m | 150mm | 25 |
| | <i>tomandra longifolia</i> | 'easy as' | n/a | 0.6m | 0.6m | 150mm | 86 |
| | <i>thermesia australis</i> | 'mango' | n/a | 0.4m | 0.6m | 200mm | 43 |
| CLIMBERS | | | | | | | |
| | <i>pandorea pandorana</i> | 'ruby belle' | n/a | climber | climber | 200mm | 10 |
| FEATURE | | | | | | | |
| | <i>doyanthes exelsa</i> | gynea lily | 2m | 2m | 140mm | 22 | |

NOTES
 soil and mulch
 Use an Australian Standard planter mix with low phosphorus for where natives have been specified & other good quality soil mix in other areas with a min of 5% OM.
 mulch
 Use mulch with material size greater than 15mm only - recommend Forest Blend - ANL in all planters
 planting
 Plants shall be vigorous, well established, hardened off, of good form consistent with the species or variety, free from disease & insect pests, with large healthy root systems & no evidence of having been restricted or damaged. All plants to be planted in locations specified on this plan. Planting holes to be twice the pot size & all soil to loosely fill the planting hole. Plants must be watered before planting begins, immediately after planting and on a continual basis thereafter until established. Construct a watering basin around the base of each individual planted tree
 All plants selected and specified are appropriate, non-toxic and non-hazardous and comply with the Education and Care Services National Regulations 2011 and Kidsafe as being suitable for use in child care centres

timber
 Use hardwood timber only preferably *Spotted Gum* for all visible timber sections & treated Durability class 1, H4 for in ground use & H3 otherwise. Use of sustainable hardwood timbers are preferred. Open timber features such as knot holes, loose or unsound knots, gum pockets, loose gum veins, shakes & termite galleries not to be used on the outer face of the timber. All timber contactable by hand shall be dressed or sanded smooth free of splinters & shavings. All bolted connections shall use washers under bolt heads & nuts & all exposed timber to be sealed with Sikkers Cetol HLS in Mahogany

material substitutions
 Materials which are not available or cannot be reasonably provided for the works may be substituted in consultation with the client

revision 2 - FINAL
 development application
 babies playspace & front area
 playspace/landscape design plan - plants

TESSA ROSE
 PLAYSPACE AND LANDSCAPE DESIGN

24 Baxter Road MASCOT NSW 2020
 04 16 565297
 tess@tessaroslandscapes.com.au
 www.tessaroslandscapes.com.au

PROJECT:
 Proposed Child Care Centre
 110-112 Mount Vernon Rd
 MOUNT VERNON NSW 2178

date: 15 October 2019 drawing no: 4/5
 scale: 1:100/A1 drawn by: kj checked tm

NOTES
 1. Contractor should check site conditions and measurements prior to works
 2. No substitutions for plants and materials may occur without prior approval

This plan is certified as meeting all relevant local government DCP's & legislation and the Education and Care Services National Regulations 2011



Left to right: : Sandstone edged sandpit with building platforms, Dry creek bed, Mirror panel, Rainwell - Stainless steel pump, Outdoor kitchen, Bush type Cubbyhouse, Reading nook, Carved [Mancala](#) /sorting table, First nation timber totem poles,



Left to right: Log rounds for climbing, balancing & seating, Boulders for seating, Balance beam – Elevated, Varied height timber panel screening, Digging patch /mud pit sides can be tree stumps or boulders or a combination thereof, Weaving Panel, Timber log tunnel, Ampitheatre/stage,



Left to right: Push/pull-up poles, Dipped artificial grass playspace for babies, Remnant logs for seating and balancing, Yarning circle, Tree log with carved steps, American barn type storage shed, Tree trunk climber,



Left to right: The mansion –Chicken coop, Formboss Corten planter -rectangle shape, Elevated rope climb, Tree log balance activity, Climbing wall, Mound with tunnell 0-2's, Rattle bridge,

* Please note these images are to be considered in conjunction with your plan and are used to give an idea of colours, textures & constructs that will be present in the completed playspace.



Left to right: Artificial turf, Stoneset - Yellow, Sandstone flagging stepper pathway, Sandstone steppers, Timber sleeper steppers, Turf – Empire Zoysia, Deco granite – Deco gold,



Left to right: *Eucalyptus punctata*, *Elaeocarpus reticulatus* 'Blueberry Ash', *Callistemon viminalis* 'Dawsons river creeper', *Casuarina cunninghamiana*, *Tristaniopsis Laurina* 'Luscious', *Melaleuca decora*,



Left to right: *Indigofera australis*, *Westringia fruticosa* 'Blue Gem', *Melaleuca thymifolia* 'Pink lace', *Hardenbergia violacea* 'Meema'

Left to right: *Dianella caerulea* 'Breeze', *Themeda australis*,



Left to right: 'Mingo', *Poa piformis* 'Kingsdale', *Lomandra* 'Easy As', *Anigozanthos* 'Gold Velvet', *Grevillia Hybrid* 'Flataz',

Left to right: *Pandorea* 'Ruby Belle',

Left to right: *Doryanthes excelsa*

* Please note these images are to be considered in conjunction with your plan and are used to give an idea of colours, textures & constructs that will be present in the completed playspace.