

LEGEND

STAGE 1	[Grey Box]
STAGE 2	[Light Blue Box] 24 LOTS
STAGE 3	[Light Purple Box] 24 LOTS
STAGE 4	[Purple Box] 16 LOTS
STAGE 5	[Yellow Box] 22 LOTS
STAGE 6	[Orange Box] 24 LOTS
STAGE 7	[Light Green Box] 14 LOTS
STAGE 8	[Purple Box] 24 LOTS
STAGE 9	[Yellow Box] 24 LOTS
STAGE 10	[Pink Box] 10 LOTS
STAGE 11	[Light Green Box] 36 LOTS
STAGE 12	[Pink Box] 18 LOTS
STAGE 13	[Blue Box] 15 LOTS
STAGE 14	[Dark Green Box]



(A) EASEMENT TO DRAIN WATER 1.5m WIDE
 (B) EASEMENT FOR MAINTENANCE 0.9m WIDE

DRAWING CHECK PRINT

DATE RAISED	11/05/21	BY		DATE	
DRAFTING CHECK					
BACK-DRAFTING CHECK					
NEXT ACTION	_____				

REVISION	DESCRIPTION	BY	DATE
G	STAGING & EASEMENTS ADDED	MT	06/05/21
F	STAGING	MT	29/04/21
E	STAGING	MT	17/03/21

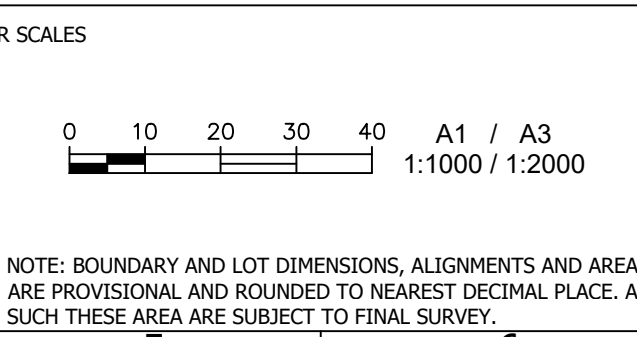

SURVEY	HEIGHT DATUM	LGA	AUTHORITY REFERENCE
-	AHD	-	-
DESIGN	CHECKING	DA No.	DATE
DRAWN	CHECKING	CC No.	DATE

PROJECT MANAGERS • SURVEYORS • PLANNERS • ENGINEERS

GROUP DEVELOPMENT SERVICES PTY LTD
 ARN: 86 064 110 809
 PO Box 498, Penrith Hills NSW 1715
 Phone: +61 2 9980 1000
 Email: info@gdsland.com.au
 Fax: +61 2 9484 0355
 www.gdsland.com.au

gds

THIS DRAWING IS SUBJECT TO COPYRIGHT AND MUST NOT BE REPRODUCED BY WHOLE OR PART WITHOUT PRIOR WRITTEN CONSENT OF GROUP DEVELOPMENT SERVICES PTY LTD. THIS PLAN MUST NOT BE USED FOR CONSTRUCTION UNLESS SIGNED AS APPROVED BY PRINCIPAL CERTIFYING AUTHORITY.

SITE DESCRIPTION
 PLAN OF SUBDIVISION OF LOT ...

THIS PLAN IS PRELIMINARY ONLY AND IS SUBJECT TO AMENDMENTS AND CHANGES DUE TO FURTHER INVESTIGATION, LATENT FINDS, UNKNOWN SITE CONDITIONS, SURVEYING AND LOCAL COUNCIL STATE AND FEDERAL GOVERNMENT AUTHORITIES RECOMMENDATIONS AND APPROVALS. REPORTS AND INFORMATION REQUIRED TO FINALISE THIS PLAN WILL INCLUDE BUT WILL NOT BE LIMITED TO ARCHAEOLOGY, HERITAGE, CONTAMINATION, ECOLOGY, ZONING, DWELLING DENSITIES, CONSCIOUS OBJECTION, GEOTECHNICAL, ADJOINING LANDOWNERS, REFERRAL AUTHORITIES, FLOODING AND WATERWAYS, SEWERAGE, WATER SUPPLY, ELECTRICITY, TELECOMMUNICATION.

PROJECT	Subdivision of Lot 3 DP 1103503 and Lot 6 DP 593628			DRAWING NUMBER	
46-66 O'Connell rd Caddens					
PROJECT REFERENCE	DATE OF ISSUE	REVISION No.	SHEET SIZE		
P00361	31/07/2020	G	A1		

PRELIMINARY ISSUE
 NOT FOR CONSTRUCTION