

Mixed Used Development

1 Renshaw Street Cranebrook, NSW 2749

Landscape Development Application

Drawing Schedule

| Drawing Number | Drawing Title | Scale |
|----------------|----------------------|----------|
| 000 | Landscape Coversheet | N/A |
| 101 | Landscape Plan | 1:100 |
| 102 | Landscape Plan | 1:100 |
| 103 | Landscape Plan | 1:100 |
| 104 | Landscape Plan | 1:100 |
| 105 | Landscape Plan | 1:100 |
| 106 | Landscape Plan | 1:100 |
| 501 | Landscape Details | As Shown |

PLANT SCHEDULE

| | Botanic Name | Common Name | Mature Size | Pot Size | Density | Qty |
|-------------------------|---|------------------------|-------------|----------|----------|------|
| GROUND FLOOR | | | | | | |
| TREES | | | | | | |
| MI | <i>Melaleuca linarifolia</i> | Narrow lead paperbark | 8 x 4 | 100L | As Shown | 3 |
| LN | <i>Lagerstroemia indica x fauriei</i> 'Natchez' | White Crepe Myrtle | 5 x 4 | 100L | As Shown | 6 |
| LT | <i>Lagerstroemia indica x fauriei</i> 'Tuscarora' | Pink Crepe Myrtle | 5 x 4 | 100L | As Shown | 3 |
| Bs | <i>Banksia serrata</i> | Old Man Banksia | 5 x 4 | 100L | As Shown | 3 |
| TI | <i>Tristaniopsis laurina</i> | Water Gum | 8 x 5 | 100L | As Shown | 5 |
| Bm | <i>Backhousia myrtifolia</i> | Grey Myrtle | 3 x 4 | 100L | As Shown | 10 |
| SHRUBS & ACCENTS | | | | | | |
| WGB | <i>Westringia</i> 'Grey Box' | Westringia | 0.5 x 0.5 | 300mm | As Shown | 175 |
| CLJ | <i>Callistemon citrinus</i> 'Little John' | Little John | 0.9 x 0.9 | 300mm | As Shown | 570 |
| Vo | <i>Viburnum odoratissimum</i> | Sweet Viburnum | 3 x 2 | 300mm | As Shown | 149 |
| MCT | <i>Melaleuca linarifolia</i> 'Claret Tops' | Honey Myrtle | 1.5 x 1.5 | 300mm | As Shown | 103 |
| Gj | <i>Grevillea juniperina</i> | Juniper-leaf grevillea | 1 x 1.5 | 300mm | As Shown | 39 |
| PBB | <i>Phormium</i> 'Bronze Baby' | New Zealand Flax | 1 x 1 | 300mm | As Shown | 144 |
| Aa | <i>Agave attenuata</i> | Foxtail | 1 x 1.5 | 300mm | As Shown | 191 |
| GRASSES & GROUND COVERS | | | | | | |
| LIT | <i>Lomandra longifolia</i> 'Tanika' | Tanika Mat Rush | 0.6 x 0.65 | 200mm | 5/m2 | 665 |
| PIE | <i>Poa labillardieri</i> 'Eskdale' | Poa labillardieri | 1 x 1 | 200mm | 5/m2 | 1469 |
| Cg | <i>Carpobrotus glaucescens</i> | Pigface | 0.3 x 1 | 150mm | 5/m2 | 811 |
| TJ | <i>Trachelospermum jasminoides</i> | Star Jasmine | 0.2 x 1 | 150mm | 5/m2 | 1231 |
| RP | <i>Rosmarinus officinalis</i> 'Prostratus' | Prostrate Rosemary | 0.3 x 0.5 | 150mm | 5/m2 | 419 |
| Ju | <i>Juncus usitatus</i> | Tussock Rush | 1.2 x 0.5 | 150mm | 5/m2 | 698 |

CHILDCARE CENTRE (OUTDOOR PLAY AREA)

| Symbol | Botanical Name | Common Name | Mature Height (m.) | Mature Spread (m.) | Pot Size | Quantity |
|--|-----------------------------------|------------------------|--------------------|--------------------|----------|----------|
| Trees | | | | | | |
| TI | <i>Tristaniopsis laurina</i> | Watergum | 8 | 5 | 100L | 3 |
| CSS | <i>Citrus Sinensis</i> 'Valencia' | Orange Valencia | 2 | 1 | 75L | 4 |
| LE | <i>Citru limon</i> 'Eureka Dwarf' | Lemon | 2 | 1 | 75L | 2 |
| Shrub & Accent | | | | | | |
| AsM | <i>Acmena smithii</i> 'Minor' | Acmena dwarf | 2 | 2 | 200mm | 67 |
| CLJ | <i>Callistemon</i> 'Little John' | Bottlebrush | 0.4 | 0.4 | 200mm | 104 |
| Ro | <i>Rosmarinus officianus</i> | rosmarinus officinalis | 1.5 | 1.5 | 200mm | 58 |
| Grasses & Groundcover | | | | | | |
| LT | <i>Lomandra</i> 'Tanika' | Lomandra | 0.5 | 0.5 | 150mm | 70 |
| Grasses & Groundcover (Outdoor play areas) | | | | | | |
| Dcs | <i>Daucus carota sativus</i> | Carrot | 1.2 | 0.3 | 200mm | 69 |
| Ob | <i>Ocimum basilicum</i> | Basil | 0.5 | 0.3 | 150mm | 30 |
| Ov | <i>Origanum Vulgare</i> | Oregano | 0.3 | 0.3 | 150mm | 84 |
| SO | <i>Salvia officinalis</i> | Common Sage | 0.75 | 0.5 | 150mm | 9 |
| Sb | <i>Stachys byzantina</i> | Wooly Lamb's Ears | 0.3 | 0.3 | 150mm | 25 |
| Tv | <i>Thymus vulgaris</i> | Thyme | 0.3 | 0.2 | 150mm | 60 |

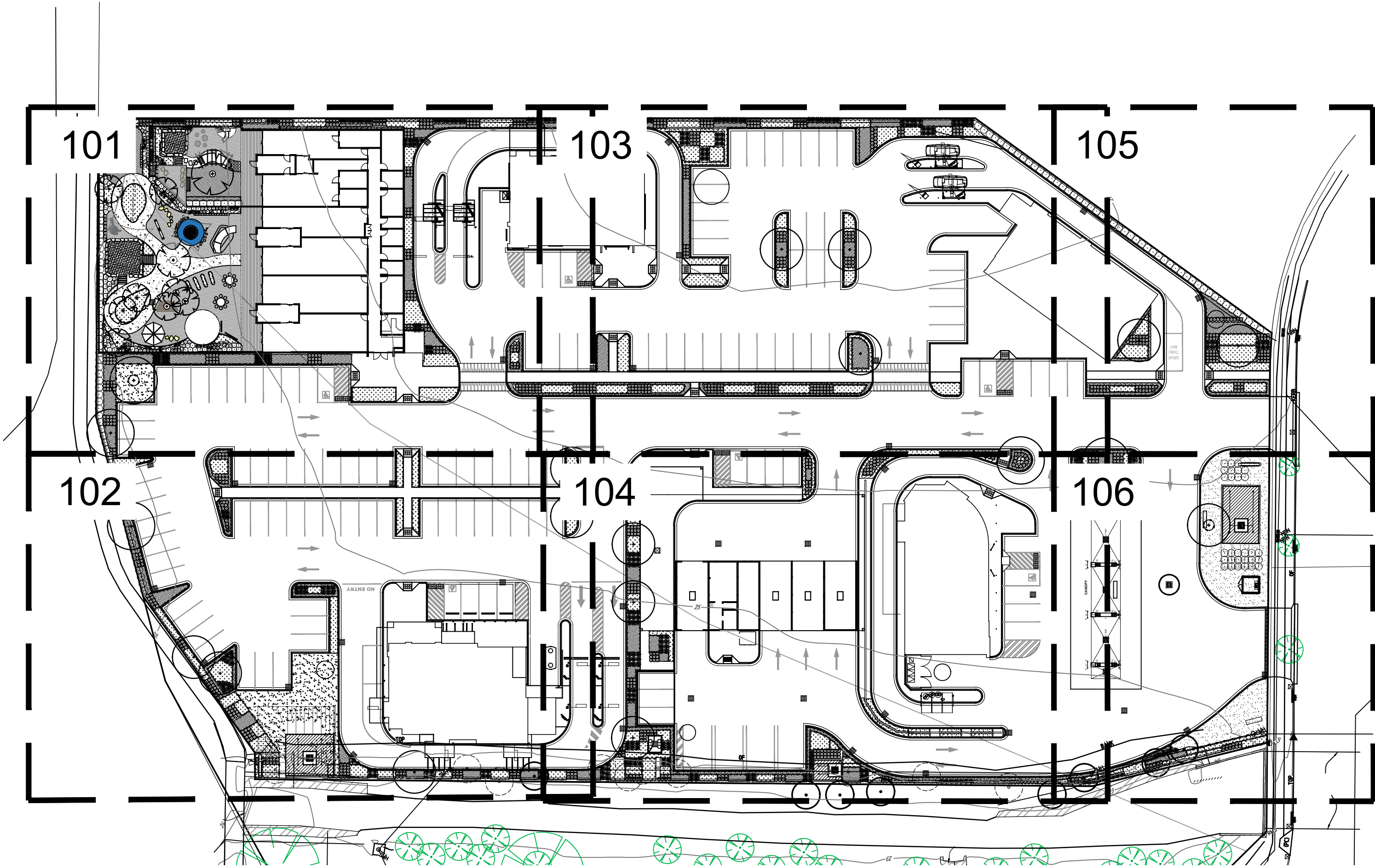

Site Plan | Scale 1:500

NOTE:

Total Site area : 14,863m2

Total Landscape area : 2239m2 15%

Total Landscape area with minimum 2m width : 1210 m2 8%

Playground area: 644 m2 (included in total site area)

Landscape area in Playground: 136 m2

NOT FOR CONSTRUCTION

© 2021 Site Image (NSW) Pty Ltd ABN 44 801 262 380 as agent for Site Image NSW Partnership. All rights reserved. This drawing is copyright and shall not be reproduced or copied in any form or by any means (graphic, electronic or mechanical including photocopy) without the written permission of Site Image (NSW) Pty Ltd Any license, expressed or implied, to use this document for any purpose what so ever is restricted to the terms of the written agreement between Site Image (NSW) Pty Ltd and the instructing party.

The contractor shall check and verify all work on site (including work by others) before commencing the landscape installation. Any discrepancies are to be reported to the Project Manager or Landscape Architect prior to commencing work. Do not scale this drawing. Any required dimensions not shown shall be referred to the Landscape Architect for confirmation.

| Issue | Revision Description | Drawn | Check | Date |
|-------|-------------------------|-------|-------|------------|
| C | Update site plan | LW | NM | 09.11.2021 |
| B | Development Application | LW | NM | 08.11.2021 |
| A | Development Application | KP | NM | 12.10.2021 |

Legend

Key Plan

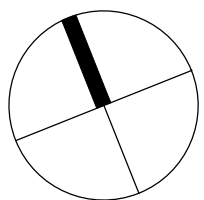

SITE IMAGE



Landscape Architects
Level 1, 3-5 Baptist Street
Redfern NSW 2016
Australia
Tel: (61 2) 8332 5600
Fax: (61 2) 9698 2877
www.siteimage.com.au

Client
Issac Property

Project
Mix Used Development
1 Renshaw Street, Cranebrook
NSW 2749

Drawing Name
Landscape Coversheet

DEVELOPMENT APPLICATION

Scale
Job Number
Drawing Number
Issue
SS21-4784
000 C

- 1 1.2m High timber fort with slide, access steps and bubble panels. Provide storage underneath
- 2 Low timber stepping blocks at different heights
- 3 Long timber bench seat
- 4 Sandpit with sandstone boulders to edge (babies yard)
- 5 Sensory path with varied surfaces and colours. Timber pergola over
- 6 interactive wall (blackboards and musical elements)
- 7 Soft fall mounds
- 8 Low height slide
- 9 Flexible use outdoor learning area
- 10 Low Sandstone boulders - sawn for easy stepping
- 11 Shade tree
- 10 Mound/ tunnel
- 12 Splash pad with bubbling rock mountain and in ground water spouts
- 13 Balancing logs and steppers
- 14 Hand water pump (playworks)
- 15 Toddler sandpit with sandstone boulders and Timber sleepers to edge
- 16 Concrete circuit path for trikes
- 17 Garden bed with organic edge to playground boundary. Tall Screening hedge to western fence
- 18 Rustic Teepee with hardwood log reading circle
- 19 Raised timber seating deck to citrus grove
- 20 Citrus tree grove
- 21 Herb Gardens
- 22 Flexible use passive area/ learning area
- 23 Blackboards
- 24 Shade sail over
- 25 Timber Batten fence/ screen to boundary

- SURFACES
- A Concrete
- B Brick paving
- C Artificial turf
- D Soft fall

NOT FOR CONSTRUCTION

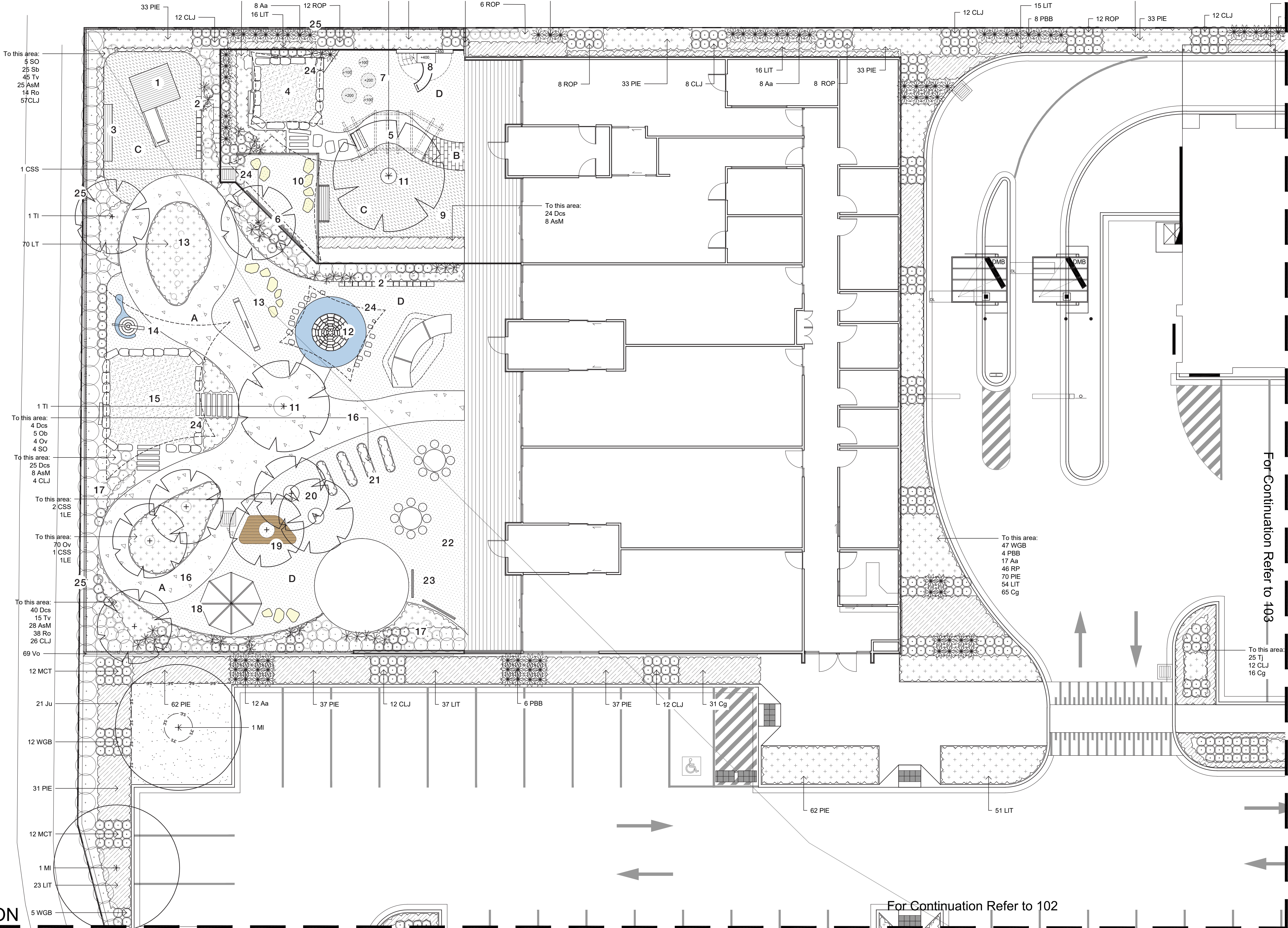

© 2021 Site Image (NSW) Pty Ltd ABN 44 801 262 380 as agent for Site Image NSW Partnership. All rights reserved. This drawing is copyright and shall not be reproduced or copied in any form or by any means (graphic, electronic or mechanical including photocopy) without the written permission of Site Image (NSW) Pty Ltd Any license, expressed or implied, to use this document for any purpose what so ever is restricted to the terms of the written agreement between Site Image (NSW) Pty Ltd and the instructing party.

The contractor shall check and verify all work on site (including work by others) before commencing the landscape installation. Any discrepancies are to be reported to the Project Manager or Landscape Architect prior to commencing work. Do not scale this drawing. Any required dimensions not shown shall be referred to the Landscape Architect for confirmation.

| | |
|-------|-------------------------|
| B | Development Application |
| A | Development Application |
| Issue | Revision Description |

| | | |
|-------|-------|------------|
| LW | NM | 08.11.2021 |
| KP | NM | 12.10.2021 |
| Drawn | Check | Date |

Legend

Boundary

Proposed Tree
(Refer Schedule and Detail)

Grasses and
Groundcovers
(Refer Schedule and Detail)

Shrubs and Accents
(Refer Schedule and Detail)

Steel Edge
(Refer Detail)

Turf
(Refer Detail)

Key Plan

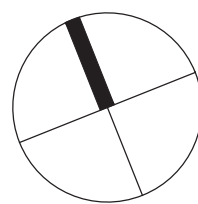

SITE IMAGE



Landscape Architects
Level 1, 3-5 Baptist Street
Redfern NSW 2016
Australia

Tel: (61 2) 8332 5600
Fax: (61 2) 9698 2877
www.siteimage.com.au

Client

Issac Property

Project

Mix Used Development
1 Renshaw Street, Cranebrook
NSW 2749

Drawing Name

Landscape Plan

DEVELOPMENT APPLICATION

Scale 1:100 @ A1

Job Number

SS21-4784

0 1 2 3 4 5m
Drawing Number Issue

101 B

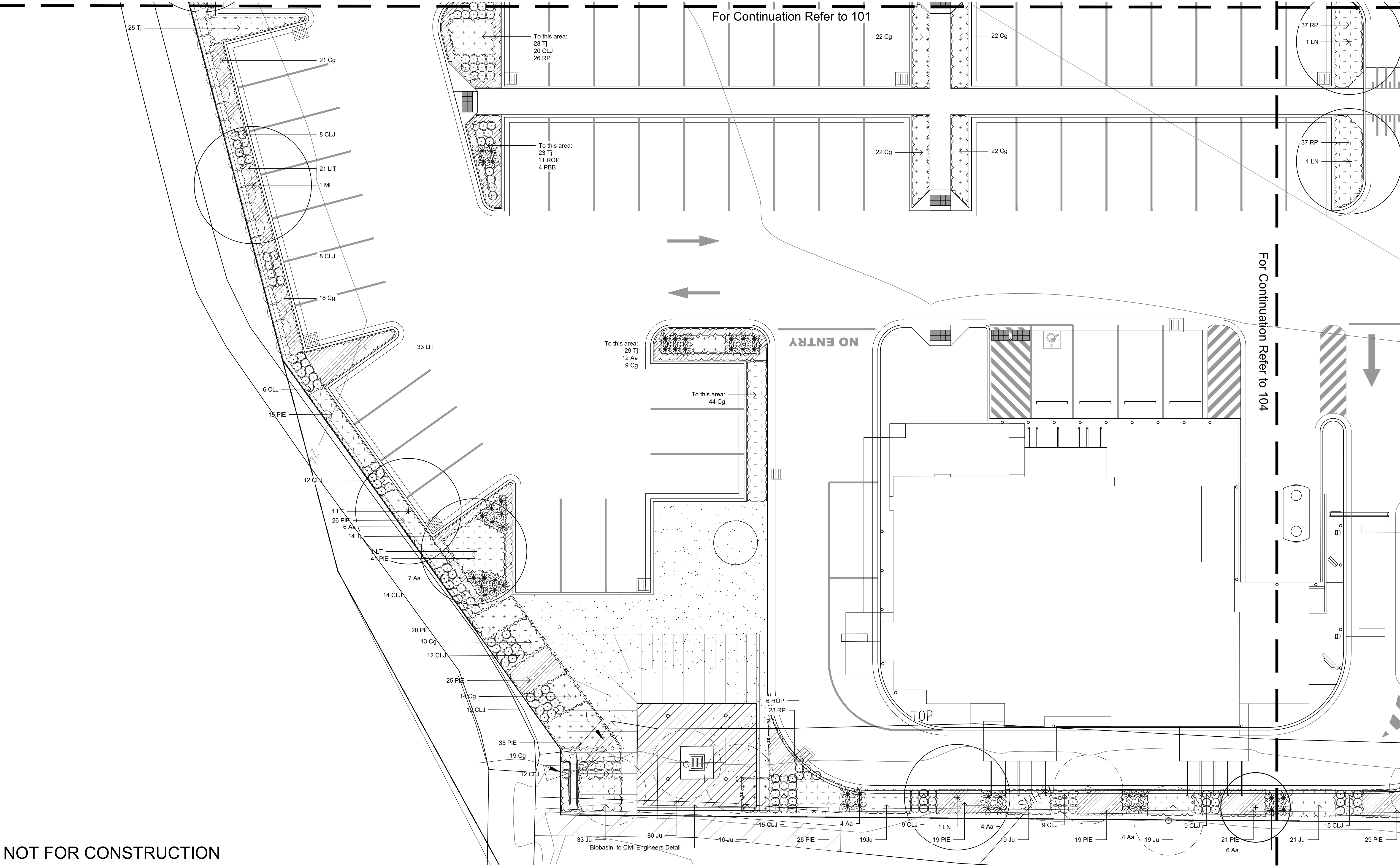

NOT FOR CONSTRUCTION

© 2021 Site Image (NSW) Pty Ltd ABN 44 801 262 380 as agent for Site Image NSW Partnership. All rights reserved. This drawing is copyright and shall not be reproduced or copied in any form or by any means (graphic, electronic or mechanical including photocopy) without the written permission of Site Image (NSW) Pty Ltd. Any license, expressed or implied, to use this document for any purpose what so ever is restricted to the terms of the written agreement between Site Image (NSW) Pty Ltd and the instructing party.

The contractor shall check and verify all work on site (including work by others) before commencing the landscape installation. Any discrepancies are to be reported to the Project Manager or Landscape Architect prior to commencing work. Do not scale this drawing. Any required dimensions not shown shall be referred to the Landscape Architect for confirmation.

| | | | | |
|-------|-------------------------|-------|-------|------------|
| C | Update site plan | LW | NM | 09.11.2021 |
| B | Development Application | LW | NM | 08.11.2021 |
| A | Development Application | KP | NM | 12.10.2021 |
| Issue | Revision Description | Drawn | Check | Date |

| | | | | | |
|--|---|--|---|--|--|
| | Boundary | | Shrubs and Accents Refer Schedule and Detail | | Retained Tree Refer Schedule and Detail |
| | Proposed Tree (Refer Schedule and Detail) | | Steel Edge (Refer Detail) | | Existing Tree Removed |
| | Grasses and Groundcovers (Refer Schedule and Detail) | | Turf (Refer Detail) | | |

Key Plan

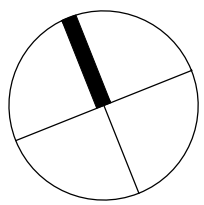

Client
Issac Property

Project
Mix Used Development
1 Renshaw Street, Cranebrook
NSW 2749

Drawing Name
Landscape Plan

DEVELOPMENT APPLICATION

Scale 1:100 @ A1
Job Number
SS21-4784

0 1 2 3 4 5m
Drawing Number
102 C

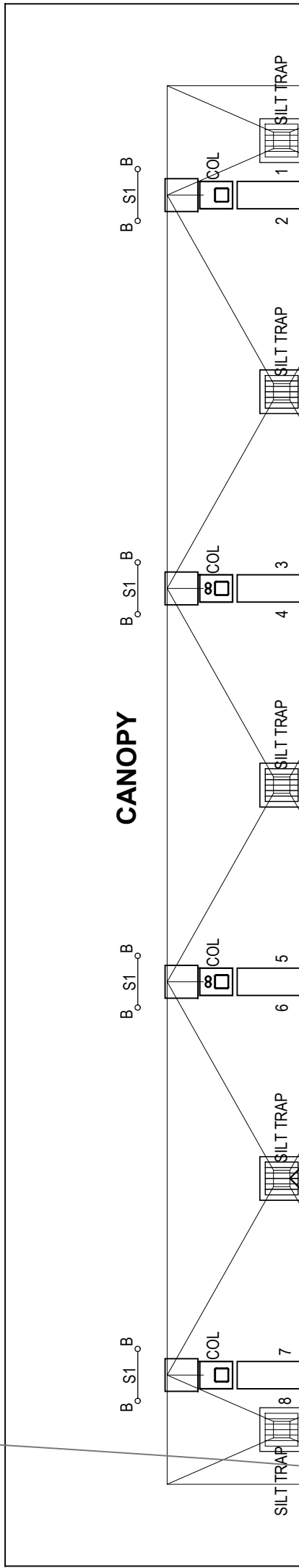
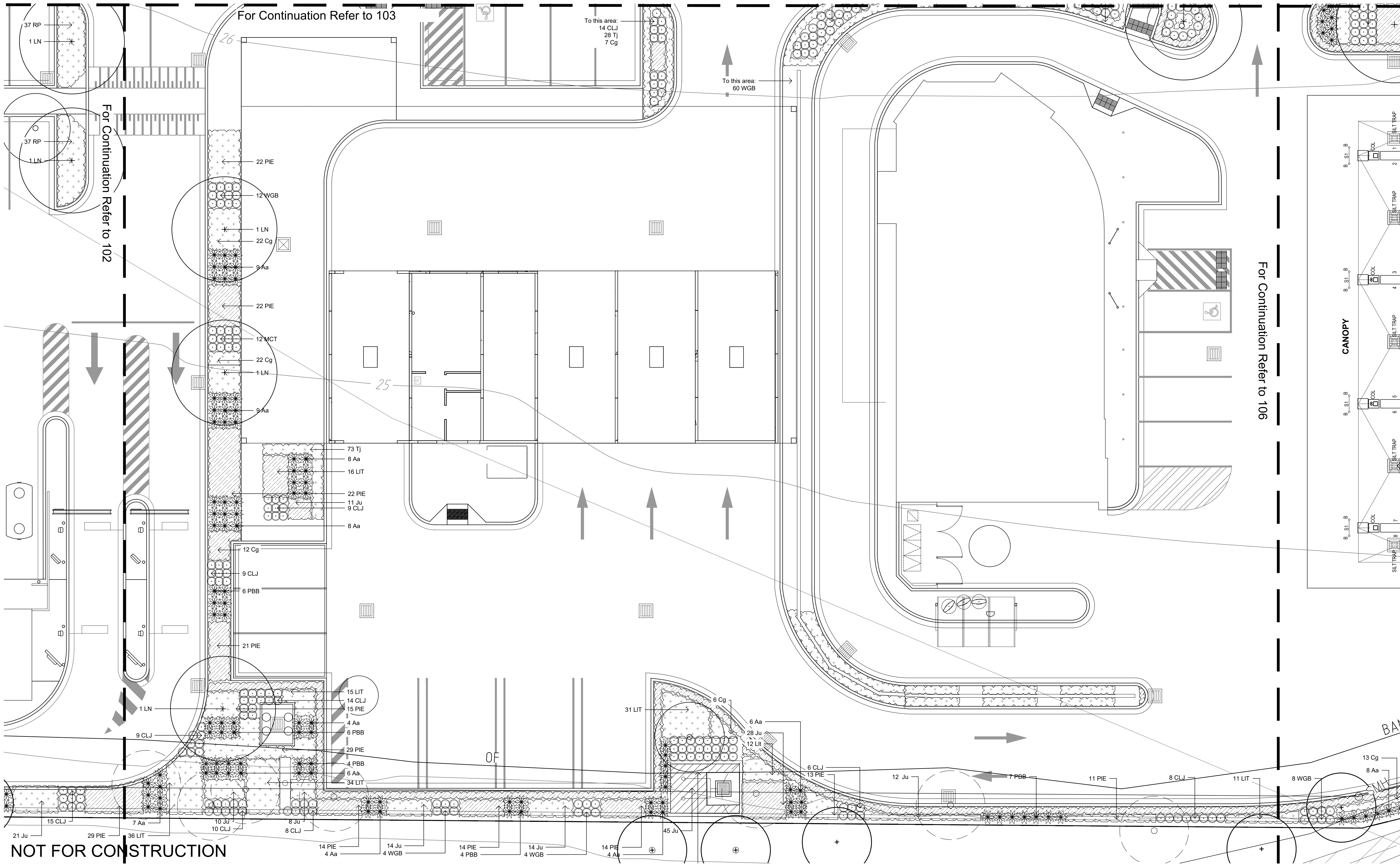

© 2021 Site Image (NSW) Pty Ltd ABN 44 801 262 380 as agent for Site Image NSW Partnership. All rights reserved. This drawing is copyright and shall not be reproduced or copied in any form or by any means (graphic, electronic or mechanical including photocopy) without the written permission of Site Image (NSW) Pty Ltd. Any license, expressed or implied, to use this document for any purpose what so ever is restricted to the terms of the written agreement between Site Image (NSW) Pty Ltd and the instructing party.

The contractor shall check and verify all work on site (including work by others) before commencing the landscape installation. Any discrepancies are to be reported to the Project Manager or Landscape Architect prior to commencing work. Do not scale this drawing. Any required dimensions not shown shall be referred to the Landscape Architect for confirmation.

| Issue | Revision Description | Drawn | Check | Date |
|-------|-------------------------|-------|-------|------------|
| C | Update site plan | LW | NM | 09.11.2021 |
| B | Development Application | LW | NM | 08.11.2021 |
| A | Development Application | KP | NM | 12.10.2021 |

Legend

| | |
|--|--|
| | Boundary |
| | Proposed Tree (Refer Schedule and Detail) |
| | Grasses and Groundcovers (Refer Schedule and Detail) |

| | |
|--|---|
| | Shrubs and Accents (Refer Schedule and Detail) |
| | Steel Edge (Refer Detail) |
| | Turf (Refer Detail) |

| | |
|--|--|
| | Retained Tree (Refer Schedule and Detail) |
| | Existing Tree Removed |

Key Plan

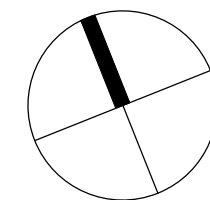

SITE IMAGE
Landscape Architects
Level 1, 3-5 Baptist Street
Redfern NSW 2016
Australia
Tel: (61 2) 8332 5600
Fax: (61 2) 9698 2877
www.siteimage.com.au

Client
Issac Property

Project
Mix Used Development
1 Renshaw Street, Cranebrook
NSW 2749

Drawing Name
Landscape Plan

DEVELOPMENT APPLICATION

Scale 1:100 @ A1
Job Number
SS21-4784

0 1 2 3 4 5m
Drawing Number
104 C

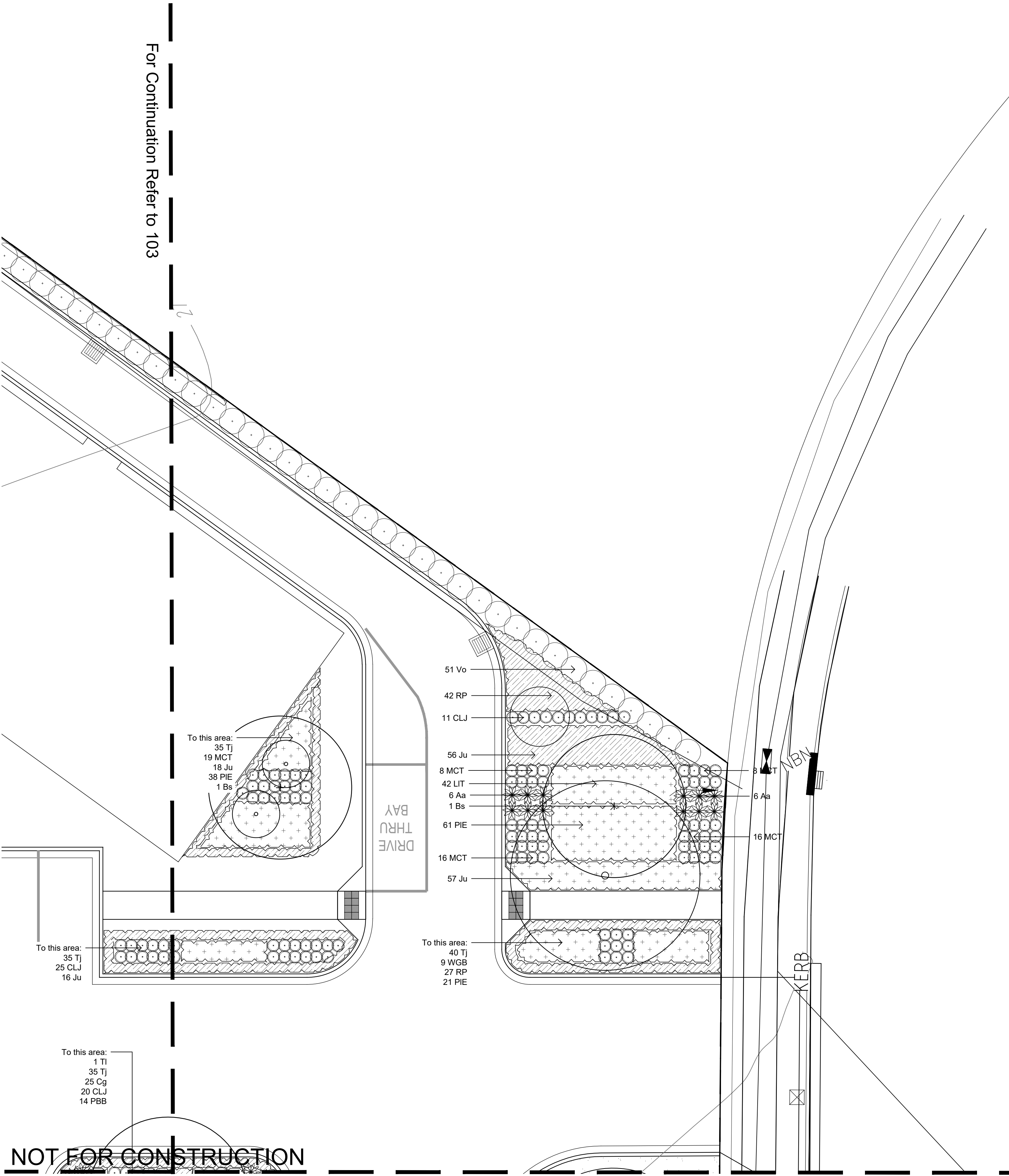

NOT FOR CONSTRUCTION

© 2021 Site Image (NSW) Pty Ltd ABN 44 801 262 380 as agent for Site Image NSW Partnership. All rights reserved. This drawing is copyright and shall not be reproduced or copied in any form or by any means (graphic, electronic or mechanical including photocopy) without the written permission of Site Image (NSW) Pty Ltd Any license, expressed or implied, to use this document for any purpose what so ever is restricted to the terms of the written agreement between Site Image (NSW) Pty Ltd and the instructing party.

The contractor shall check and verify all work on site (including work by others) before commencing the landscape installation. Any discrepancies are to be reported to the Project Manager or Landscape Architect prior to commencing work. Do not scale this drawing. Any required dimensions not shown shall be referred to the Landscape Architect for confirmation.

| | |
|-------|-------------------------|
| C | Update site plan |
| B | Development Application |
| A | Development Application |
| Issue | Revision Description |

| | | |
|-------|-------|------------|
| LW | NM | 09.11.2021 |
| LW | NM | 08.11.2021 |
| KP | NM | 12.10.2021 |
| Drawn | Check | Date |

Legend

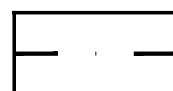

Boundary

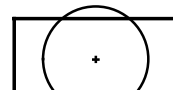

Proposed Tree
(Refer Schedule and Detail)



Grasses and
Groundcovers
(Refer Schedule and Detail)

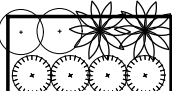

Shrubs and Accents
(Refer Schedule and Detail)

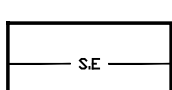

Steel Edge
(Refer Detail)

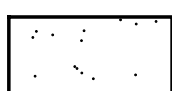

Turf
(Refer Detail)

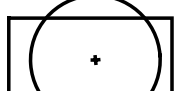

Retained Tree
(Refer Schedule and Detail)



Existing Tree Removed

Key Plan

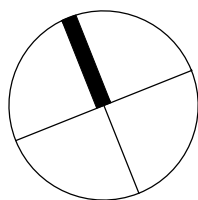

SITE IMAGE



Landscape Architects
Level 1, 3-5 Baptist Street
Redfern NSW 2016
Australia
Tel: (61 2) 8332 5600
Fax: (61 2) 9698 2877
www.siteimage.com.au

Client

Issac Property

Project

Mix Used Development
1 Renshaw Street, Cranebrook
NSW 2749

Drawing Name

Landscape Plan

DEVELOPMENT APPLICATION

Scale 1:100 @ A1

Job Number

SS21-4784

0 1 2 3 4 5m
Drawing Number Issue

105 C

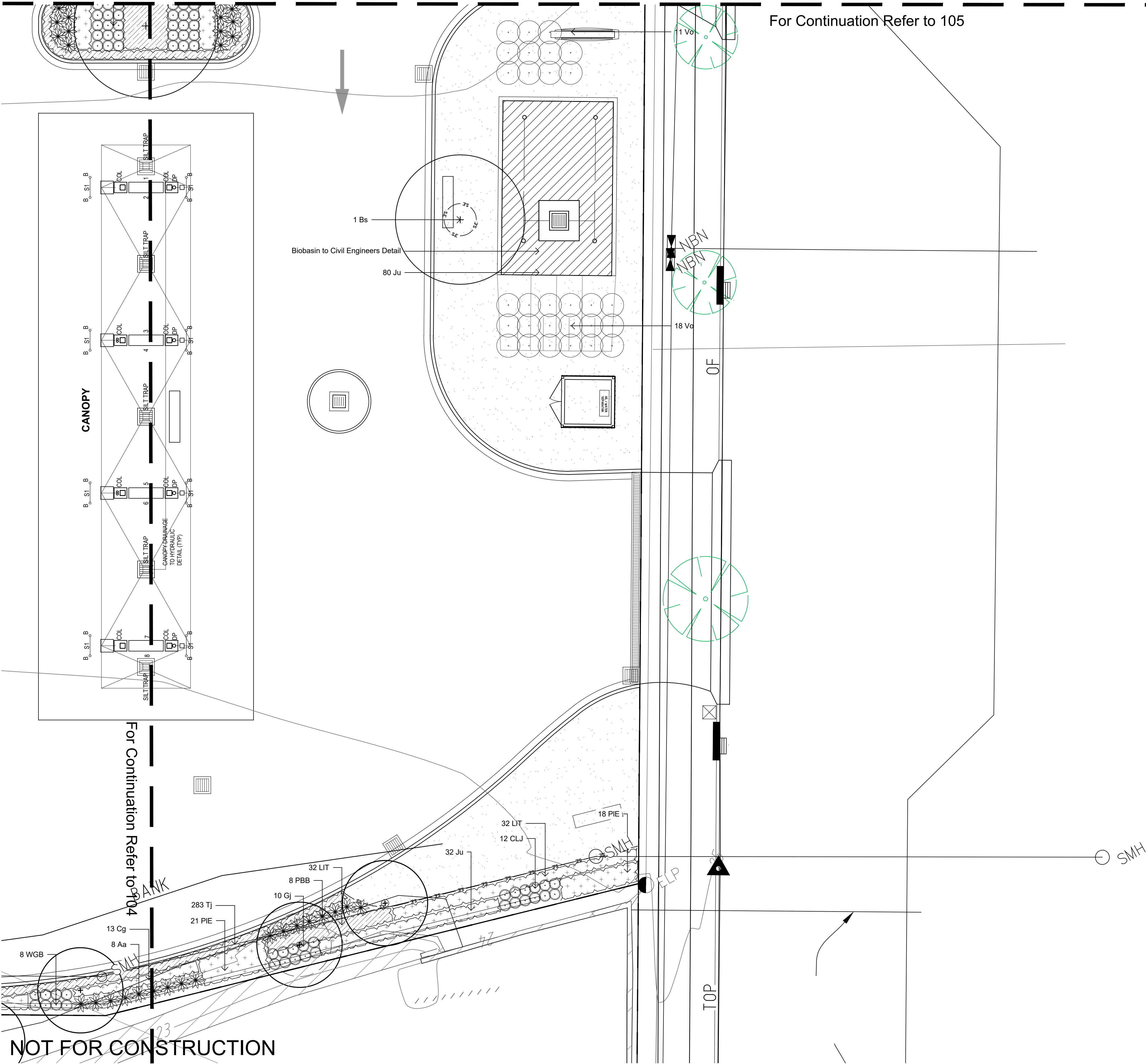

© 2021 Site Image (NSW) Pty Ltd ABN 44 801 262 380 as agent for Site Image NSW Partnership. All rights reserved. This drawing is copyright and shall not be reproduced or copied in any form or by any means (graphic, electronic or mechanical including photocopy) without the written permission of Site Image (NSW) Pty Ltd Any license, expressed or implied, to use this document for any purpose what so ever is restricted to the terms of the written agreement between Site Image (NSW) Pty Ltd and the instructing party.

The contractor shall check and verify all work on site (including work by others) before commencing the landscape installation. Any discrepancies are to be reported to the Project Manager or Landscape Architect prior to commencing work. Do not scale this drawing. Any required dimensions not shown shall be referred to the Landscape Architect for confirmation.

| | | | | |
|-------|-------------------------|-------|-------|------------|
| C | Update site plan | LW | NM | 09.11.2021 |
| B | Development Application | LW | NM | 08.11.2021 |
| A | Development Application | KP | NM | 12.10.2021 |
| Issue | Revision Description | Drawn | Check | Date |

| | | | | | |
|--|---|--|---|--|--|
| | Boundary | | Shrubs and Accents (Refer Schedule and Detail) | | Retained Tree (Refer Schedule and Detail) |
| | Proposed Tree (Refer Schedule and Detail) | | Steel Edge (Refer Detail) | | Existing Tree Removed |
| | Grasses and Groundcovers (Refer Schedule and Detail) | | Turf (Refer Detail) | | |

SITE IMAGE
Landscape Architects
Level 1, 3-5 Baptist Street
Redfern NSW 2016
Australia
Tel: (61 2) 8332 5600
Fax: (61 2) 9698 2877
www.siteimage.com.au

Client
Issac Property
Project
Mix Used Development
1 Renshaw Street, Cranebrook
NSW 2749

Drawing Name
Landscape Plan

DEVELOPMENT APPLICATION
Scale 1:100 @ A1
Job Number
SS21-4784
Drawing Number
106
Issue
C

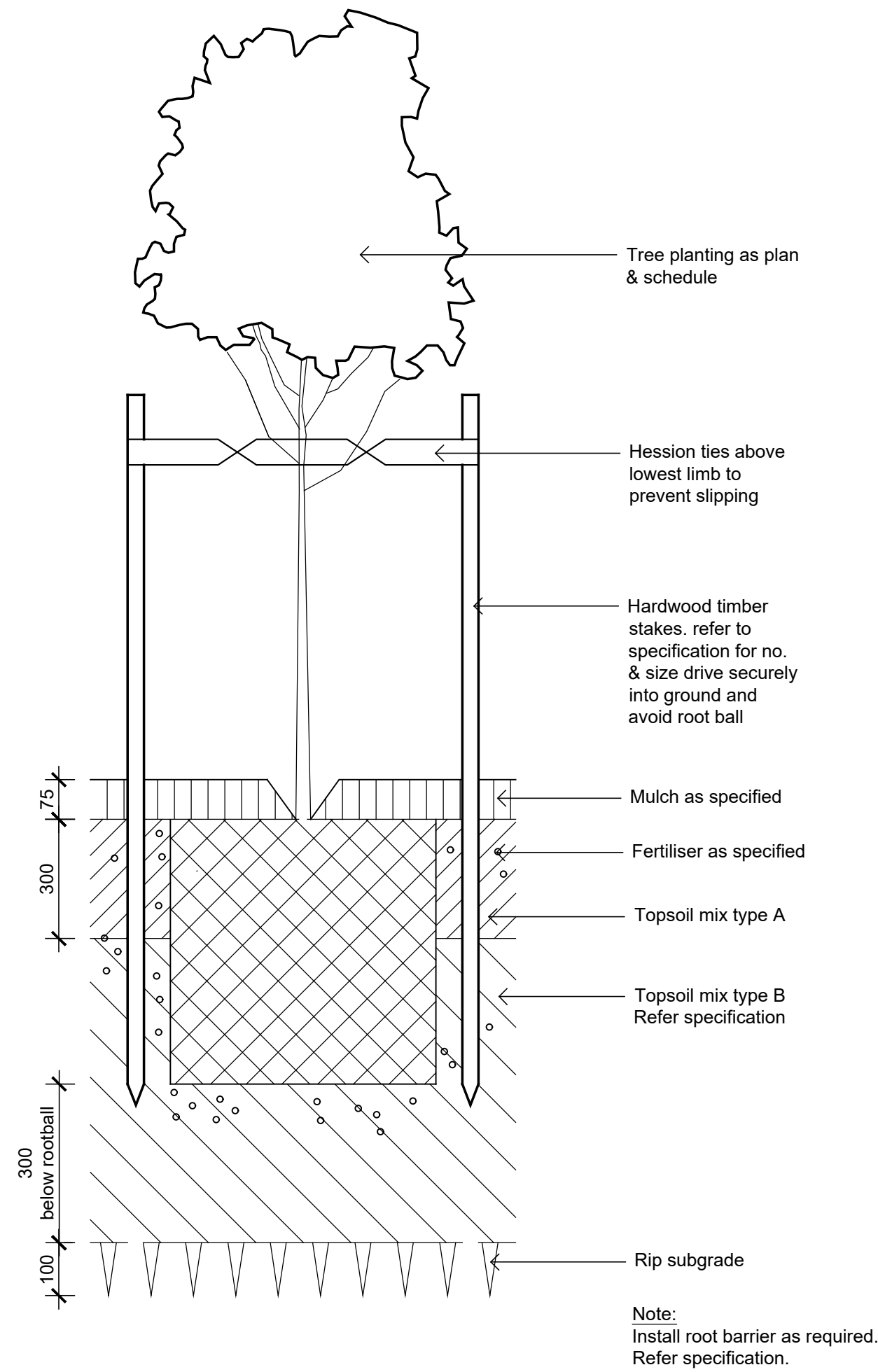

Detail 75-200L Tree Planting on Grade
1:10

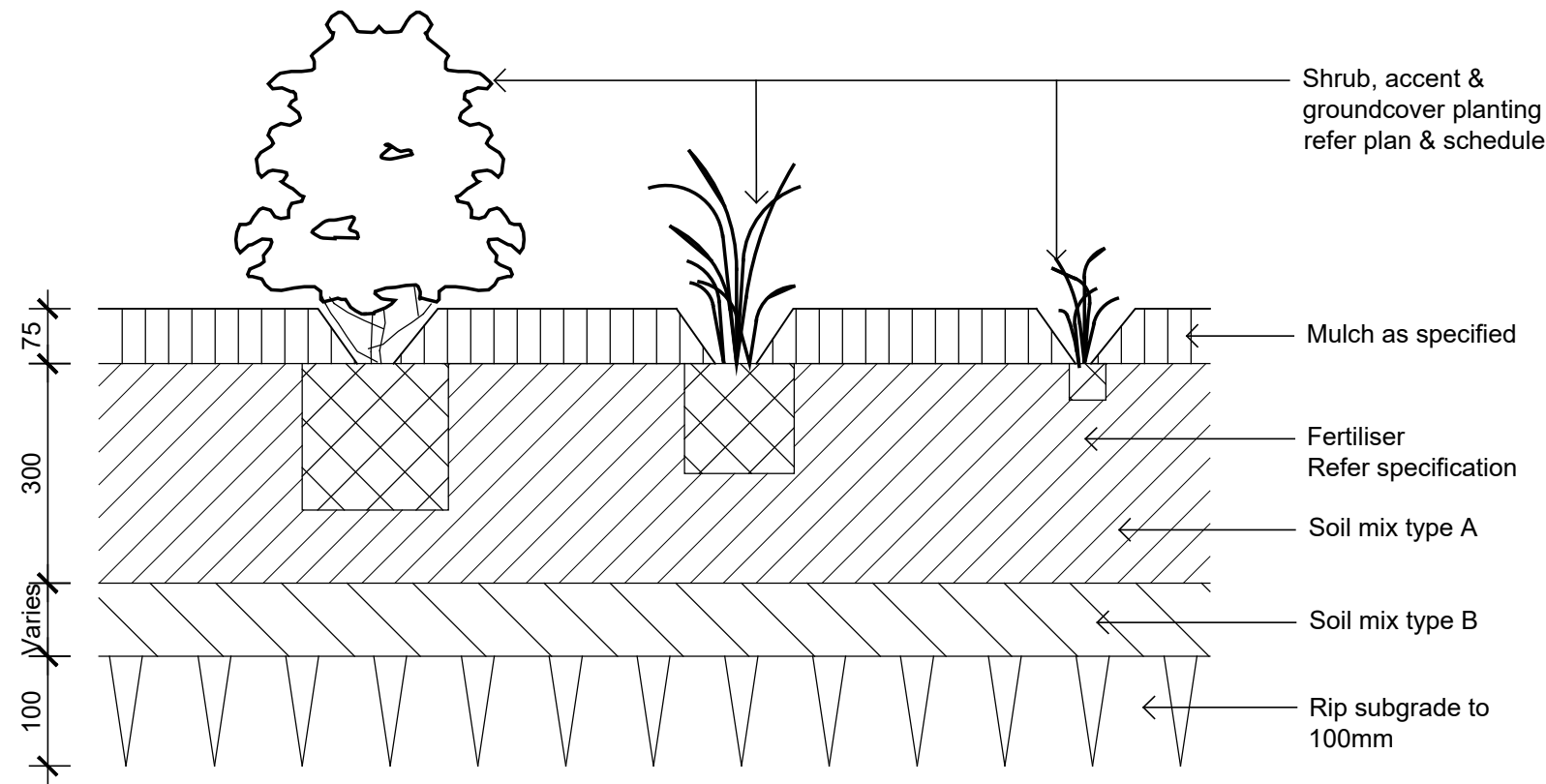

Detail Shrub Accent & Groundcover Planting on Grade
1:10

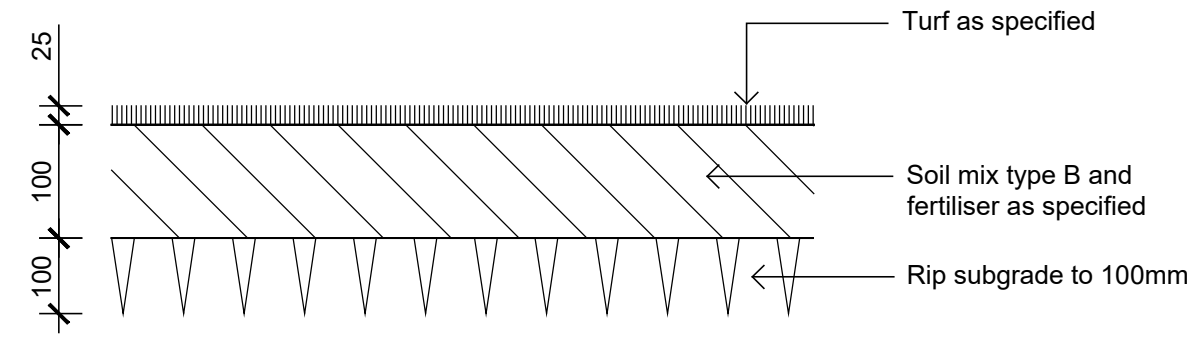

Detail Turf on Even Grade
1:10

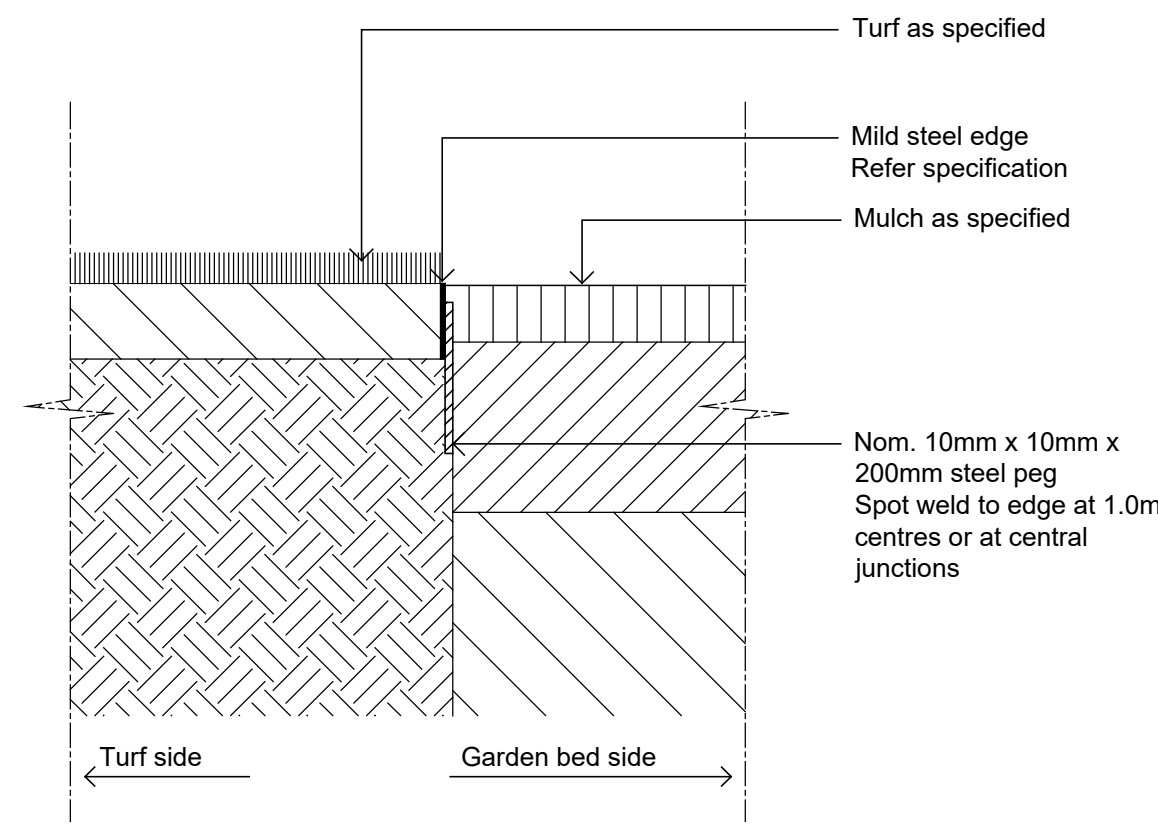

E1 Steel Edge
1:10

NOT FOR CONSTRUCTION

© 2021 Site Image (NSW) Pty Ltd. ABN 44 801 262 380 as agent for Site Image NSW Partnership. All rights reserved. This drawing is copyright and shall not be reproduced or copied in any form or by any means (graphic, electronic or mechanical including photocopy) without the written permission of Site Image (NSW) Pty Ltd. Any license, expressed or implied, to use this document for any purpose what so ever is restricted to the terms of the written agreement between Site Image (NSW) Pty Ltd and the instructing party.

The contractor shall check and verify all work on site (including work by others) before commencing the landscape installation. Any discrepancies are to be reported to the Project Manager or Landscape Architect prior to commencing work. Do not scale this drawing. Any required dimensions not shown shall be referred to the Landscape Architect for confirmation.

| | | | | |
|-------|-------------------------|-------|-------|------------|
| B | Development Application | LW | NM | 08.11.2021 |
| A | Development Application | KP | NM | 12.10.2021 |
| Issue | Revision Description | Drawn | Check | Date |



Client
Issac Property

Project
Mix Used Development
1 Renshaw Street, Cranebrook
NSW 2749

Drawing Name
Landscape Details

DEVELOPMENT APPLICATION

Scale
Job Number
SS21-4784

Drawing Number
Issue
501 A