

The stormwater design/layout which flows to the street/easement is in compliance with:

1. Building Code of Australia Vol. 2 (BCA) Sections 3.1 Site Preparation, and 3.5 Roof and Wall Cladding.
2. Council Stormwater DCP requirements (if applicable)
3. Using data from BCA Tables 3.5.2.1 and 3.5.2.2 the number of downpipes required based on a roof area of 300m<sup>2</sup> is 11.

Name \_\_\_\_\_

Signed \_\_\_\_\_ Date \_\_\_\_\_

→ → → → → STORMWATER LINES

**'H1' CLASS SITE ASSUMED**  
(AS PER THE BOREHOLE REPORT)

**SALINE AFFECTED**

**BAL 19 & BAL 29**

**Lot 342,**  
**AREA: 1008**

STORMWATER DRAINAGE TO STREET WATER TABLE.  
(SUBJECT TO CONTOUR SURVEY)

ANY RETAINING WALLS REQUIRED TO BE COMPLETED BY OWNERS TO MANUFACTURERS SPECIFICATIONS.

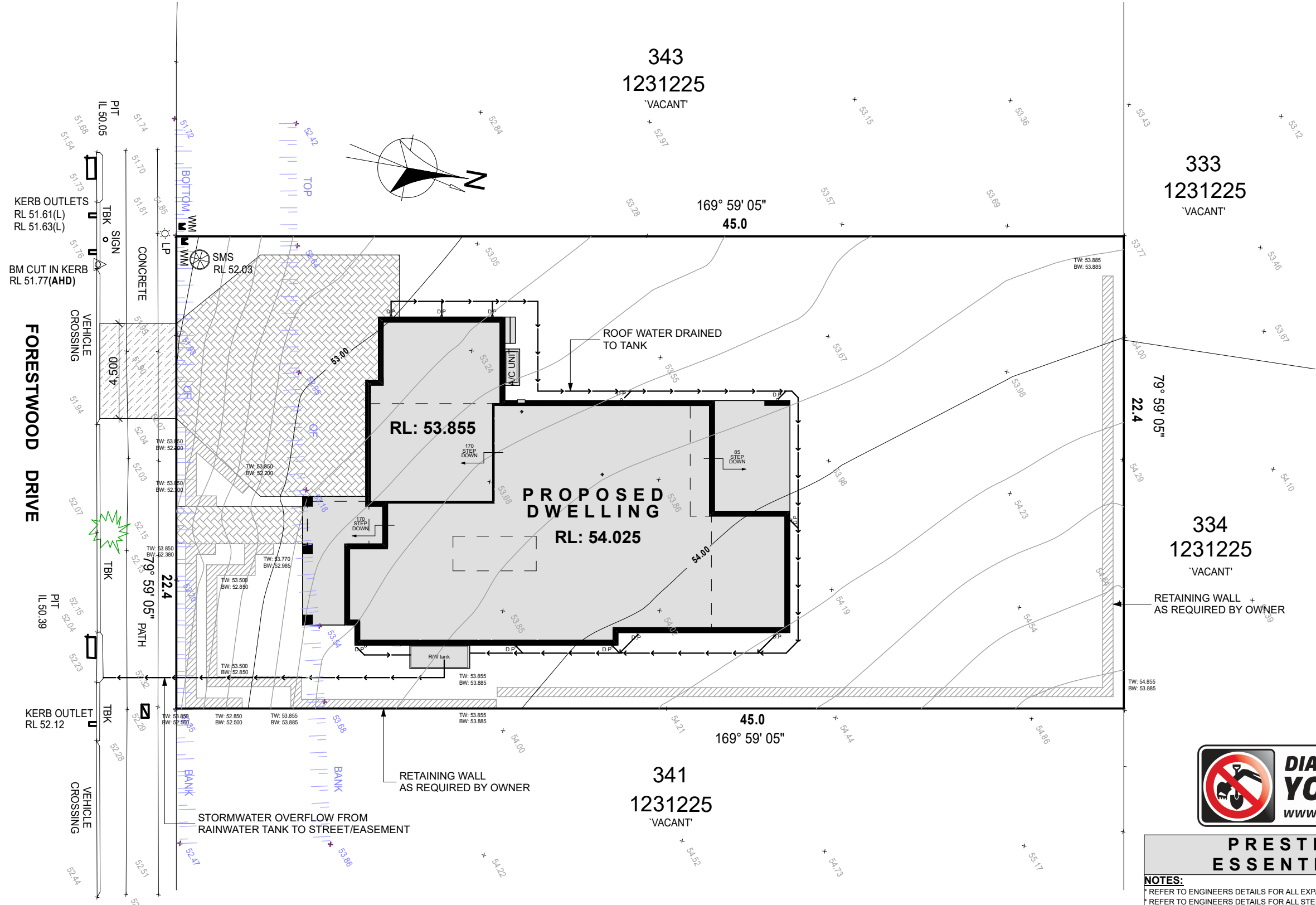

**STORMWATER CONCEPT PLAN**  
1:200

FILE PATH: T:\WISDOM HOMES\2021\207916\_SIELICKI\207916\_SIELICKI\_SUBMISSION\_PLANS.pln

1300 855 775  
wisdomhomes.com.au

PROJECT: PROPOSED BRICK VENEER DWELLING

CLIENT: Mr M SIELICKI

ADDRESS: Lot 342, Forestwood Drive, GLENMORE PARK, NSW

EXHAUST FAN

SMOKE ALARM AS 3786-1993

LODGEMENT: D.A/C.C

DP No: 1231225

\*COPYRIGHT OF PLANS AND DOCUMENTATION REMAIN THE EXCLUSIVE PROPERTY OF WISDOM PROPERTIES GROUP PTY LTD T/A WISDOM HOMES. BUILDERS LIC. No 131951C.

NOTES: BOUNDARY SETBACKS MUST BE VERIFIED BY A REGISTERED SURVEYOR BEFORE COMMENCEMENT OF ANY BUILDING WORK. ALL WORK TO BE CARRIED OUT IN ACCORDANCE WITH THESE DRAWINGS, COUNCIL REQUIREMENTS, RELEVANT CODES & STANDARDS. LEVELS SHOWN ARE BASED ON CONTOUR SURVEY PREPARED BY A REGISTERED SURVEYOR. DRAWINGS ARE TO BE READ IN CONJUNCTION WITH SPECIFICATIONS PROVIDED & ENGINEERS DETAILS. WHERE ENGINEERS STRUCTURAL DRAWINGS ARE REQUIRED THE ENGINEERS PLAN WILL TAKE PREFERENCE TO THESE DRAWINGS. IN THE EVENT OF ANY ALTERATIONS OR DISCREPANCIES, NOTIFY WISDOM HOMES IMMEDIATELY. FIGURED DIMENSIONS TO BE READ IN PREFERENCE TO SCALING & TO BE CHECKED & VERIFIED BEFORE WORK IS COMMENCED.

REVISION SCHEDULE			
ISSUE	DESCRIPTION	DRAWN	DATE
A	CONTRACT SET	JD	23/3/21
A-2	LIVE TENDER CHANGES	KB	30.03.21
A-3	CONSULTATION PLANS	WCL	13.4.21
A-4	MINOR AMENDMENT	WCL	3.05.21
B-5	SUBMISSION PLANS	KB	30.07.21
B-6	SUBMISSION PLAN AMENDMENTS	KB	3.08.21

JOB No: 207916

DRAWN: -

PLOT DATE: 3/08/2021

SLAB CLASS: 'H1' CLASS

SHEET: 4

MANHATTAN 47

AVANTI



**PRESTIGE ESSENTIALS**

**NOTES:**

- \* REFER TO ENGINEERS DETAILS FOR ALL EXPANSION JOINT LOCATIONS.
- \* REFER TO ENGINEERS DETAILS FOR ALL STEEL BEAM AND FLOOR JOIST LOCATIONS AND DIRECTIONS.
- \* REFER TO TRUSS MANUFACTURERS DETAILS FOR ALL FLOOR JOIST SIZES AND DIRECTIONS.
- \* REFER TO A/C DETAILS FOR A/C DUCT POSITIONS.
- \* A/C DUCT LOCATIONS MAY NEED TO CHANGE DUE TO CONSTRUCTION REQUIREMENTS (JOIST LOCATION, STRUCTURAL BEAMS ETC).
- \* FLOOR FINISHES AS SELECTED AS PER TENDER.
- \* STAIRS TO MEET THE MINIMUM SLIP RESISTANCE REQUIREMENT OF PART 3.9.1.3 OF BCA 2015 WHEN TESTED IN ACCORDANCE WITH AS4586-2013