



EAST ELEVATION TO COMMUNITY ROAD 1:200
FRONT ELEVATION SV24-SV37 + SIDE ELEVATION SV28+SV51
STREETSCAPE 5



WEST ELEVATION TO COMMUNITY ROAD 1:200
FRONT ELEVATION SV 5 + SV38-SV41
STREETSCAPE 6



SOUTH ELEVATION 1:200
REAR ELEVATION SV28-SV37
STREETSCAPE 7



NORTH ELEVATION 1:200
REAR ELEVATION SV42-SV51
STREETSCAPE 8

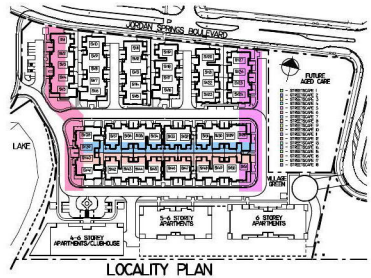

THIS DRAWING IS THE PROPERTY OF ABN DESIGN P/L. REPRODUCTION, COPYING OR USE IN PART OR WHOLE WITHOUT WRITTEN PERMISSION IS STRICTLY PROHIBITED. ANY UNLAWFUL USE WILL BE PROSECUTED AGAINST OFFENDERS. THIS DRAWING IS NOT TO BE USED FOR ANY OTHER DESIGN SIMILARITIES THAT MAY HAVE BEEN INCURRED.
Version: 1, Version Date: 13/07/2018

NO.	DATE	REVISION	BY	CHKD BY
A	02/18	ADVERTISING PLAN	DT	
MT			AMENDED BY	

PROJECT: **JORDAN SPRINGS CD SITE**

JHArchitects
 Notified Architect: Joseph Hobb
 Registration No. 9056
 4/150-150/5, Collins Court, Baulkham Hills NSW 263
 P. 042297000 E. joseph@jharchitects.com.au

JOB ADDRESS:
**JORDAN SPRINGS BOULEVARD
 JORDAN SPRINGS**

FOR: **LEND LEASE**

DATE: 05/18 DRAWING NO: AND-284/05 SHEET: SET OF:

LEVEL 2 SUITE 206 MACARTHUR POINT
 NO. 25-27 SOLENT CIRCUIT BULLHORN HILLS
 P.O. BOX 640 BULLHORN HILLS BUSINESS CENTRE
 NSW, 2623
 PHONE: (02) 8824 3533 FAX: (02) 8824 3544
 WWW.ANDDESIGNSYDNEY.COM.AU





NORTH ELEVATION TO COMMUNITY ROAD 1:200
FRONT ELEVATION SV28-SV38
STREETSCAPE 9



NORTH ELEVATION TO COMMUNITY ROAD 1:200
FRONT ELEVATION SV28-SV38
STREETSCAPE 10



WEST ELEVATION TO DRIVEWAY 1:200
FRONT ELEVATION SV20-SV23
STREETSCAPE 11



EAST ELEVATION TO DRIVEWAY 1:200
FRONT ELEVATION SV6-SV9
STREETSCAPE 13



EAST ELEVATION 1:200
REAR ELEVATION SV20-SV23
STREETSCAPE 12



WEST ELEVATION 1:200
REAR ELEVATION SV6-SV9
STREETSCAPE 14



EAST ELEVATION TO DRIVEWAY 1:200
FRONT ELEVATION SV6-SV10
STREETSCAPE 15



WEST ELEVATION 1:200
REAR ELEVATION SV24-SV27
STREETSCAPE 17



WEST ELEVATION 1:200
REAR ELEVATION SV6-SV10
STREETSCAPE 16



EAST ELEVATION 1:200
REAR ELEVATION SV1-SV5
STREETSCAPE 8

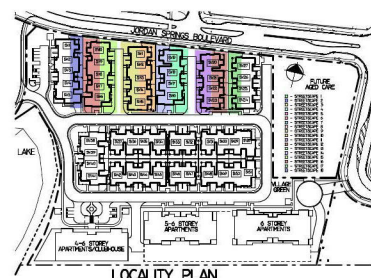

THIS DRAWING IS THE PROPERTY OF A&N DESIGN P/L. REPRODUCTION, COPYING OR USE IN PART OR WHOLE WITHOUT WRITTEN PERMISSION IS STRICTLY PROHIBITED. AGAINST OFFENDERS, PROSECUTION WILL BE SEVERELY PURSUED. DESIGN SIMILARITIES THAT MAY HAVE BEEN INCURRED, WILL BE AT THE USER'S RISK.
Version: 1, Version Date: 13/07/2018

NO.	DATE	REVISION	AMENDED BY
A	12/18	ADVERTISING PLAN	DT

PROJECT: **JORDAN SPRINGS CD SITE**

JHArchitects
 Registered Architect: Joseph Hobb
 Incorporated No. 9926
 R. Suite 202, 4 Columbia Court, Bullahm Hills NSW 2613
 P. 0422276006 E. joseph@jharchitects.com.au

JOB ADDRESS:
**JORDAN SPRINGS BOULEVARD
 JORDAN SPRINGS**

FOR: **LEND LEASE**

DATE: 15/18 DRAWING NO: AND-284/05 SHEET: SET OF:

LEVEL 2 SUITE 206 MACARTHUR POINT
 NO. 25-27 SOLENT CIRCUIT BULLAHM HILLS
 P.O. BOX 640 BULLAHM HILLS BUSINESS CENTRE
 NSW, 2613
 PHONE: (02) 8824 3533 FAX: (02) 8824 3544
 WWW.AANDSIGNSYDNEY.COM.AU

lendlease **bda** **A&N**
 BUILDING DESIGNERS ASSOCIATION OF AUSTRALIA DESIGN GROUP
 SYDNEY

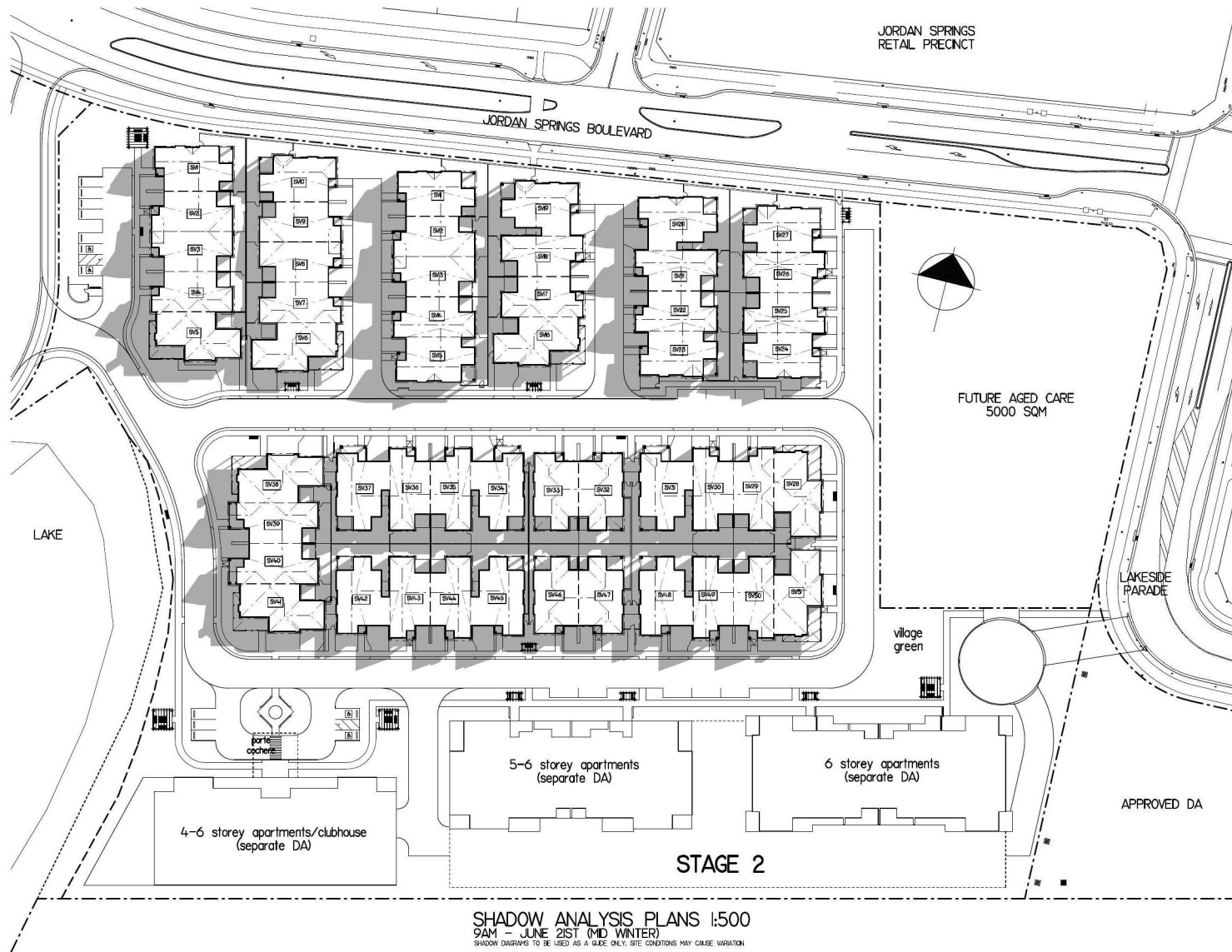

THIS DRAWING IS THE PROPERTY OF A&N DESIGN P/L. REPRODUCTION, COPYING OR USE IN PART OR WHOLE WITHOUT WRITTEN PERMISSION IS STRICTLY PROHIBITED. ANY UNLAWFUL USE WILL BE PROSECUTED AGAINST OFFENDERS. DESIGN GROUP HAS CONDUCTED VISUAL SIMILARITIES ANALYSIS THAT MAY HAVE BEEN INCORPORATED INTO THIS DESIGN. Version: 1, Version Date: 13/07/2018

NO.	DATE	REVISION	AMENDED BY
A	02/18	ADVERTISING PLAN	DT

PROJECT: JORDAN SPRINGS CD SITE

JHArchitects
 Registered Architect: Joseph Hobb
 Incorporated No. 9956
 A. Suite 205, 4 Collinsia Court, Baulkham Hills NSW 2653
 P. 0422976006 E. joseph@jharchitects.com.au

JOB ADDRESS:
 JORDAN SPRINGS BOULEVARD
 JORDAN SPRINGS

FOR: LEND LEASE
 DATE: 05/18 DRAWING NO: AND-284/05 SHEET: SET OF:

LEVEL 2 SUITE 206 MACARTHUR POINT
 NO. 25-27 SOLENT CIRCUIT BULLHORN HILLS
 P.O. BOX 640 BULLHORN HILLS BUSINESS CENTRE
 NSW, 2623
 PHONE: (02) 8824 3533 FAX: (02) 8824 3544
 WWW.ANDDESIGNSTUDY.COM.AU

lendlease **bda** **A&N**
 BUILDING DESIGNERS ASSOCIATION OF AUSTRALIA DESIGN GROUP
 B Y D E S I G N

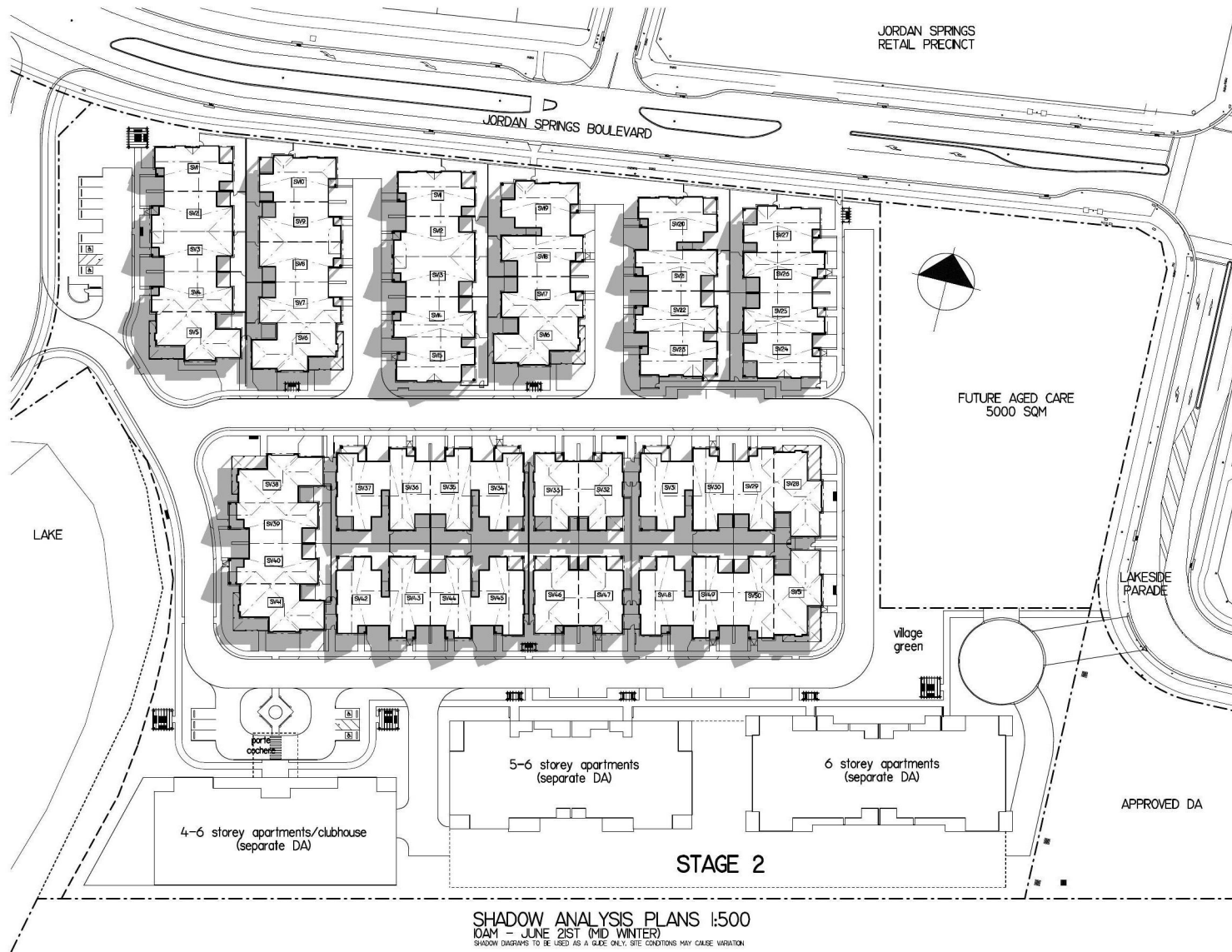

SHADOW ANALYSIS PLANS 1:500
 10AM - JUNE 21ST (MID WINTER)
 SHADOW DIAGRAMS TO BE USED AS A GUIDE ONLY. SITE CONDITIONS MAY CAUSE VARIATION

THIS DRAWING IS THE PROPERTY OF A&N DESIGN P/L. REPRODUCTION, COPYING OR USE IN PART OR WHOLE WITHOUT WRITTEN PERMISSION IS STRICTLY PROHIBITED. ANY UNLAWFUL USE WILL BE PROSECUTED AGAINST OFFENDERS. DESIGNERS ACCEPT NO LIABILITY FOR DESIGN SIMILARITIES THAT MAY HAVE BEEN INCURRED.
 Version: 1, Version Date: 13/07/2018

NO	DATE	REVISION	AMENDED BY
A	02/18	ADVERTISING PLAN	DT

PROJECT: JORDAN SPRINGS CD SITE

JHArchitects
 Notified Architect: Joseph Hobb
 Registration No. 9956
 P. 0422 27 0000 E. joseph@jhandesign.com.au

JOB ADDRESS:
 JORDAN SPRINGS BOULEVARD
 JORDAN SPRINGS

FOR: LEND LEASE
 DATE: 05/18 DRAWING NO: AND-284/05 SHEET: SET OF:

LEVEL 2 SUITE 206 MACARTHUR POINT
 NO. 25-27 SOLENT CIRCUIT BULLHORN HILLS
 P.O. BOX 640 BULLHORN HILLS BUSINESS CENTRE
 NSW, 2833
 PHONE: (02) 8824 3533 FAX: (02) 8824 3544
 WWW.ANDDESIGNSYDNEY.COM.AU



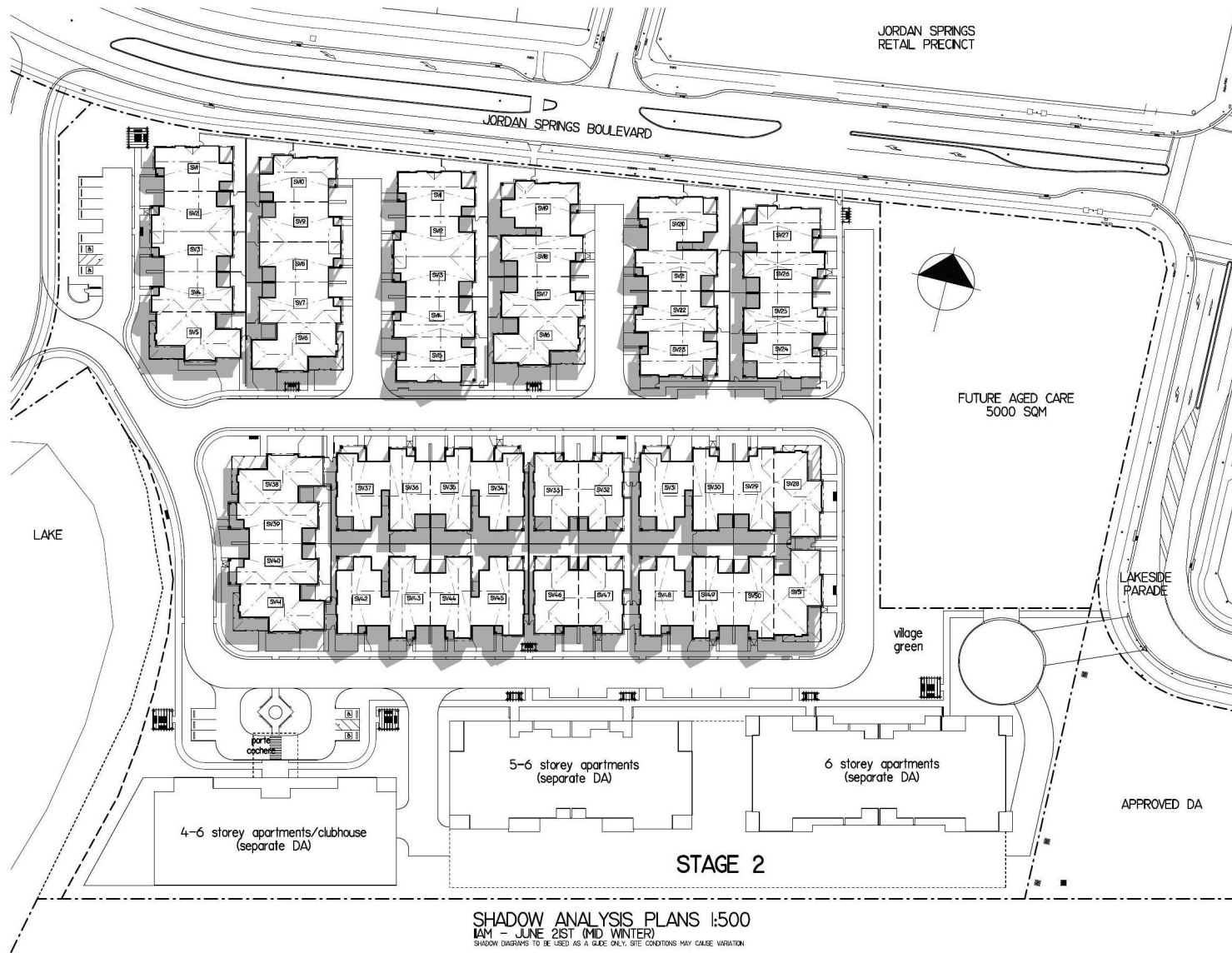

SHADOW ANALYSIS PLANS 1:500
 11AM - JUNE 21ST (MID WINTER)
 SHADOW DIAGRAMS TO BE USED AS A GUIDE ONLY. SITE CONDITIONS MAY CAUSE VARIATION

THIS DRAWING IS THE PROPERTY OF A&N DESIGN P/L. REPRODUCTION, COPYING OR USE IN PART OR WHOLE WITHOUT WRITTEN PERMISSION IS STRICTLY PROHIBITED. ANY UNLAWFUL USE WILL BE PROSECUTED AGAINST OFFENDERS. DESIGNERS ACCEPT NO LIABILITY FOR DESIGN SIMILARITIES THAT MAY HAVE BEEN INCURRED.
 Version: 1, Version Date: 13/07/2018

NO	DATE	REVISION	AMENDED BY
A	02/18	ADVERTISING PLAN	DT

PROJECT: JORDAN SPRINGS CD SITE

JHArchitects
 Nominated Architect: Joseph Hobb
 Registration No. 9956
 P. Suite 205, 4 Collins Court, Ballkamm Hills NSW 2653
 P. 0422276006 E. joseph@jhandesign.com.au

JOB ADDRESS:
 JORDAN SPRINGS BOULEVARD
 JORDAN SPRINGS

FOR: LEND LEASE
 DATE: 05/18 DRAWING NO: AND-284/05 SHEET: SET OF:

LEVEL 2 SUITE 206 MACARTHUR POINT
 NO. 25-27 SOLENT CIRCUIT BALLKAMM HILLS
 P.O. BOX 640 BALLKAMM HILLS BUSINESS CENTRE
 NSW, 2653
 PHONE: (02) 8824 3533 FAX: (02) 8824 3544
 WWW.ANDDESIGNSYDNEY.COM.AU

lendlease **bda** **A&N**
 BUILDING DESIGNERS ASSOCIATION OF AUSTRALIA DESIGN GROUP
 S Y D N E Y

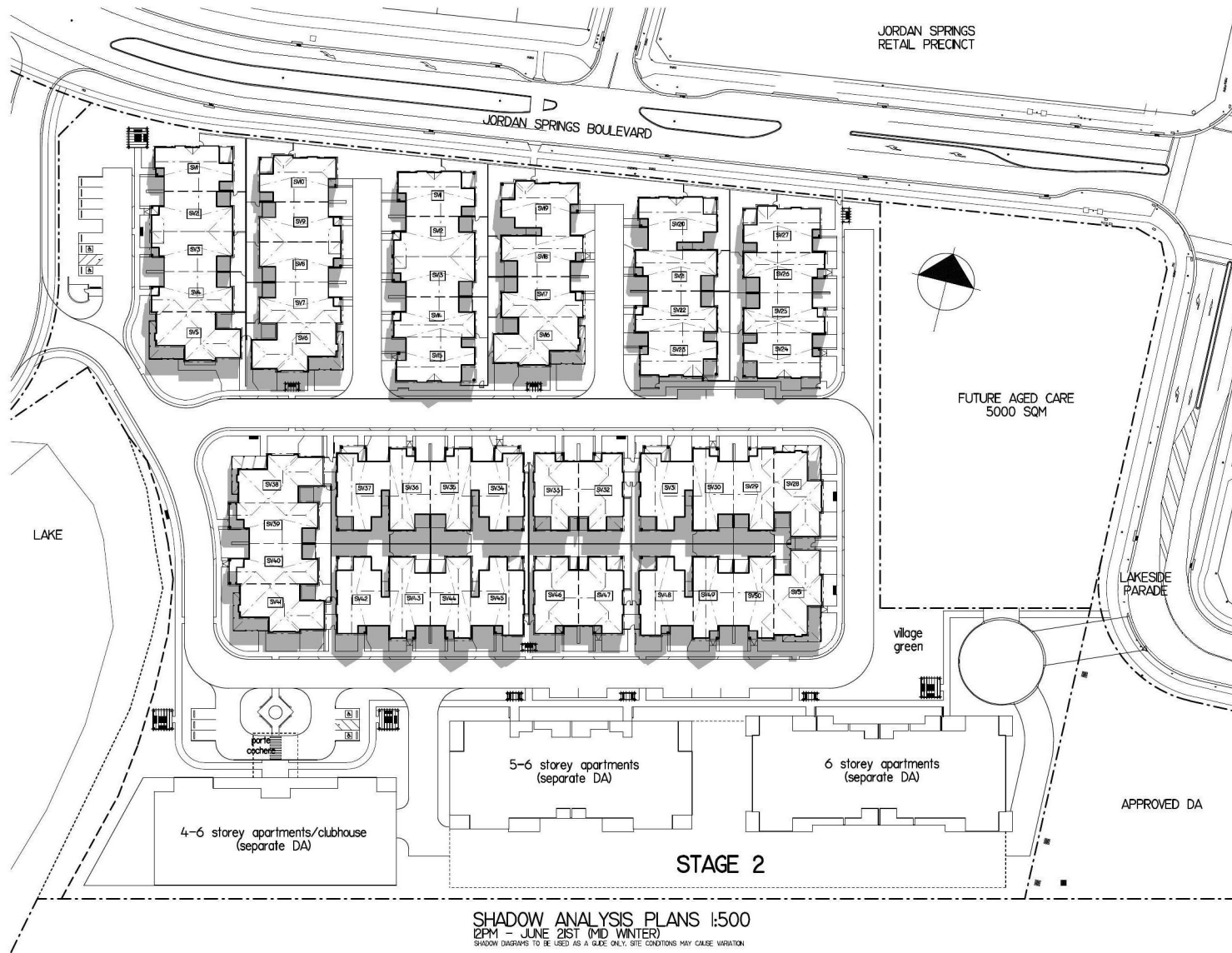

SHADOW ANALYSIS PLANS 1:500
 12PM - JUNE 21ST (MID WINTER)
 SHADOW DIAGRAMS TO BE USED AS A GUIDE ONLY. SITE CONDITIONS MAY CAUSE VARIATION

THIS DRAWING IS THE PROPERTY OF A&N DESIGN P/L. REPRODUCTION, COPYING OR USE IN PART OR WHOLE WITHOUT WRITTEN PERMISSION IS STRICTLY PROHIBITED. A&N DESIGN P/L ACCEPTS NO LIABILITY AGAINST OFFENDERS, CONTRACTORS OR OTHERS FOR ANY DESIGN SIMILARITIES THAT MAY HAVE BEEN INCURRED.
 Version: 1, Version Date: 13/07/2018

NO.	DATE	REVISION	AMENDED BY
A	12/18	ADVERTISING PLAN	DT

PROJECT: JORDAN SPRINGS CD SITE

JHArchitects
 Nominated Architect: Joseph Hobb
 Incorporated No. 9956
 A. Suite 205, 4 Collins Court, Ballkinn Hill NSW 2653
 P. 0422270000 E. joseph@jharchitects.com.au

JOB ADDRESS:
 JORDAN SPRINGS BOULEVARD
 JORDAN SPRINGS

FOR: LEND LEASE
 DATE: 15/18 DRAWING NO: AND-284/05 SHEET: SET OF:

LEVEL 2 SUITE 206 MACARTHUR POINT
 NO. 25-27 SOLENT CIRCUIT BALLKINN HILLS
 P.O. BOX 640 BALLKINN HILLS BUSINESS CENTRE
 NSW, 2653
 PHONE: (02) 8824 3533 FAX: (02) 8824 3544
 WWW.AANDDESIGNSTUDY.COM.AU

lendlease **bda** **A&N**
 BUILDING DESIGNERS ASSOCIATION OF AUSTRALIA DESIGN GROUP
 S Y D N E Y

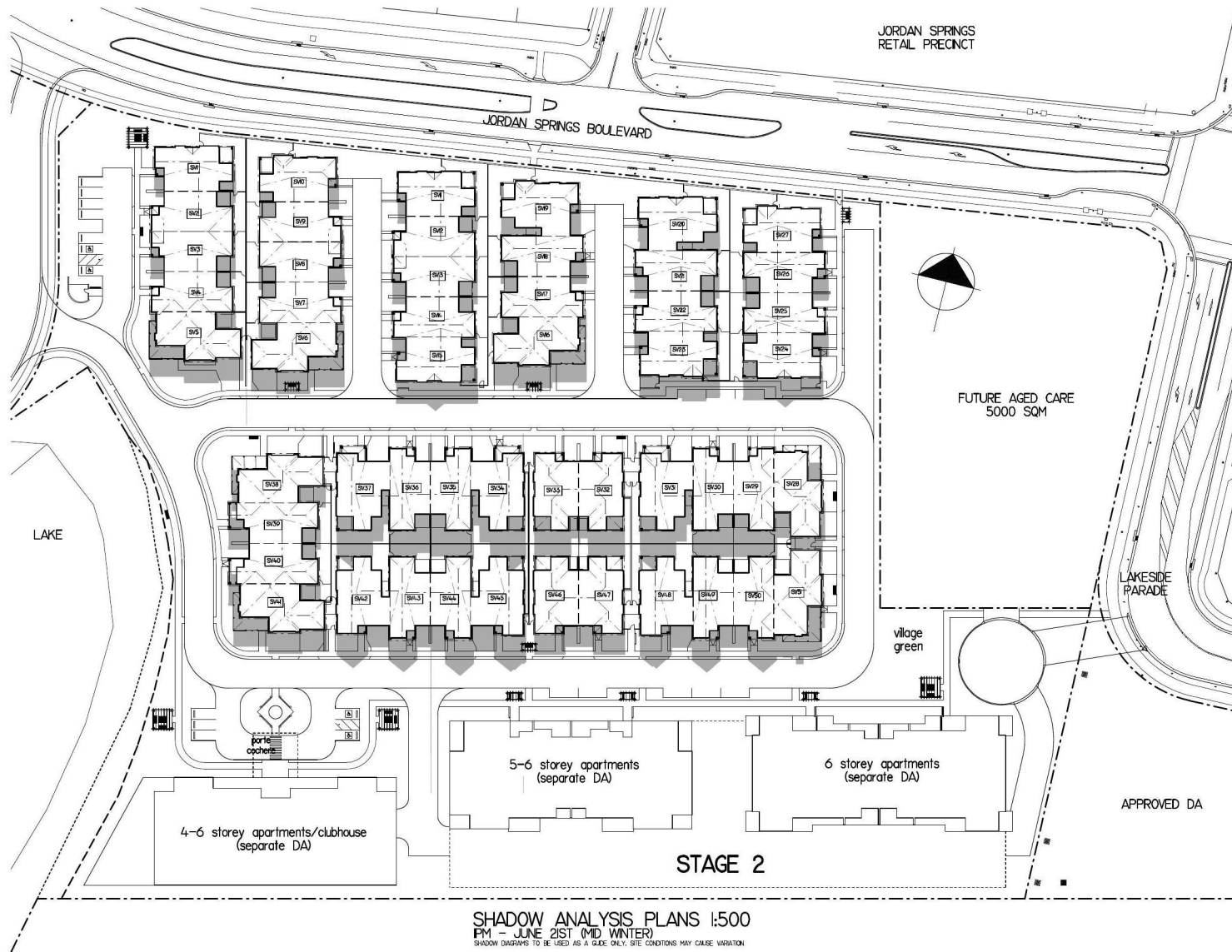

SHADOW ANALYSIS PLANS 1:500
 PM - JUNE 21ST (MID WINTER)
 SHADOW DIAGRAMS TO BE USED AS A GUIDE ONLY. SITE CONDITIONS MAY CAUSE VARIATION

THIS DRAWING IS THE PROPERTY OF A&N DESIGN P/L. REPRODUCTION, COPYING OR USE IN PART OR WHOLE WITHOUT WRITTEN PERMISSION IS STRICTLY PROHIBITED. A&N DESIGN P/L ACCEPTS NO LIABILITY AGAINST OFFENDERS, CONTRACTORS OR OTHERS FOR ANY DESIGN SIMILARITIES THAT MAY HAVE BEEN INCURRED.
 Version: 1, Version Date: 13/07/2018

NO	DATE	REVISION	AMENDED BY
A	02/18	ADVERTISING PLAN	DT

PROJECT: JORDAN SPRINGS CD SITE

JHArchitects
 Nominated Architect: Joseph Hobb
 Incorporated No. 9956
 A. Suite 203, 4 Collinsia Court, Ballkinnah Hills NSW 2653
 P. 0422276006 E. joseph@jharchitects.com.au

JOB ADDRESS:
 JORDAN SPRINGS BOULEVARD
 JORDAN SPRINGS

FOR: LEND LEASE
 DATE: 05/18 DRAWING NO: AND-284/05 SHEET: SET OF:

LEVEL 2 SUITE 206 MACARTHUR POINT
 NO. 25-27 SOLENT CIRCUIT BALLKINAH HILLS
 P.O. BOX 640 BALLKINAH HILLS BUSINESS CENTRE
 NSW, 2653
 PHONE: (02) 8824 3533 FAX: (02) 8824 3544
 WWW.AANDDESIGNSTUDY.COM.AU

lendlease **bda** **A&N**
 BUILDING DESIGNERS ASSOCIATION OF AUSTRALIA DESIGN GROUP
 B Y D H E Y

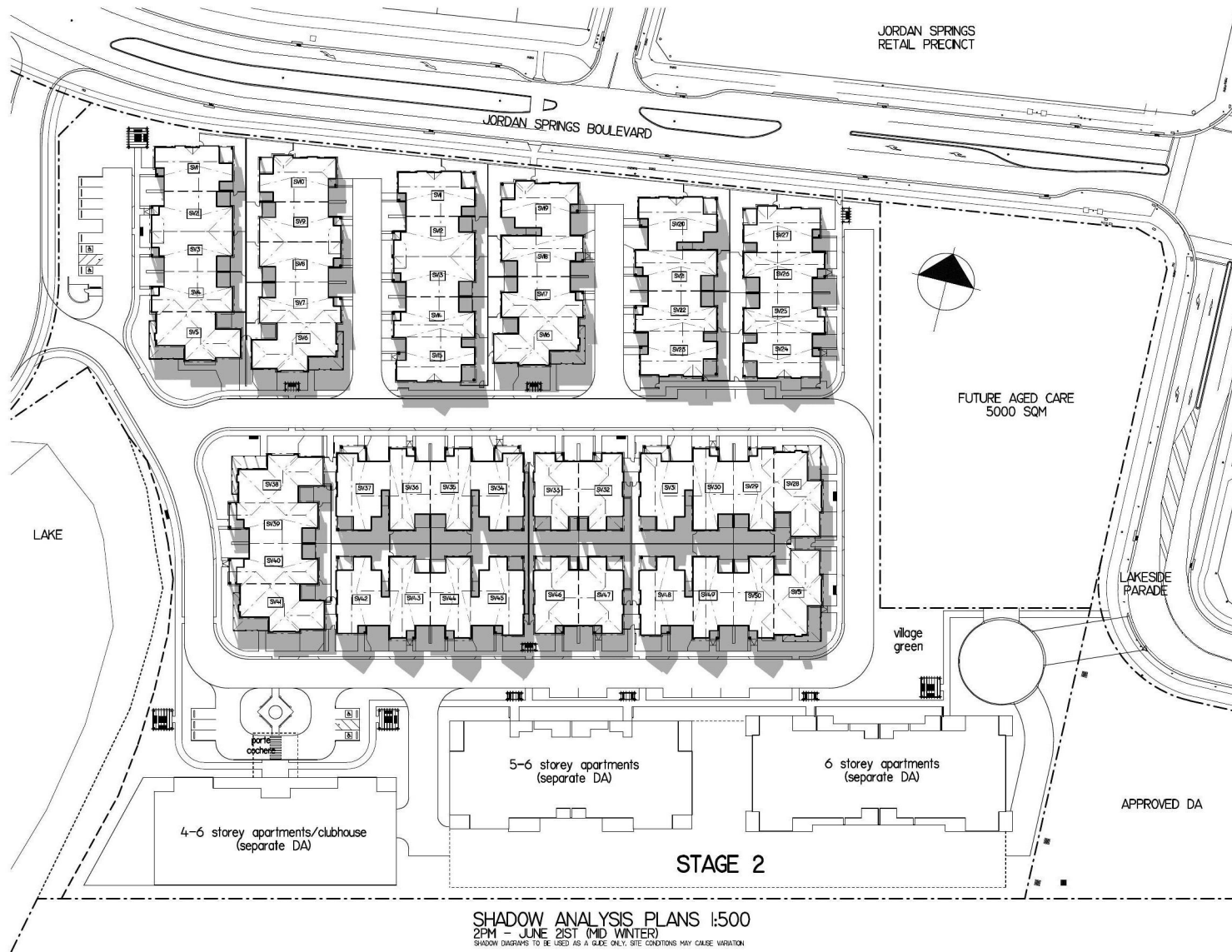

SHADOW ANALYSIS PLANS 1:500
 2PM - JUNE 21ST (MID WINTER)
 SHADOW DIAGRAMS TO BE USED AS A GUIDE ONLY, SITE CONDITIONS MAY CAUSE VARIATION

THIS DRAWING IS THE PROPERTY OF A&N DESIGN P/L. REPRODUCTION, COPYING OR USE IN PART OR WHOLE WITHOUT WRITTEN PERMISSION IS STRICTLY PROHIBITED. DESIGNERS ACCEPT NO LIABILITY FOR ANY LOSS OR DAMAGE, INCLUDING CONSEQUENTIAL DAMAGES, ARISING FROM THE USE OF THIS DRAWING. DESIGN SIMILARITIES THAT MAY HAVE BEEN INCURRED, ARE SOLELY THE RESPONSIBILITY OF THE CLIENT.
 Version: 1, Version Date: 13/07/2018

NO	DATE	REVISION	AMENDED BY
A	02/18	ADVERTISING PLAN	DT
1			

PROJECT: JORDAN SPRINGS CD SITE

JHArchitects
 Nominated Architect: Joseph Hobb
 Incorporated No. 9986
 A. Suite 203, 4 Collinsia Court, Ballham Hills NSW 2633
 P. 042297000 E. joseph@jhandesign.com.au

JOB ADDRESS:
 JORDAN SPRINGS BOULEVARD
 JORDAN SPRINGS

FOR: LEND LEASE
 DATE: 05/18 DRAWING NO: AND-284/05 SHEET: SET OF:

LEVEL 2 SUITE 206 MACARTHUR POINT
 NO. 25-27 SOLENT CIRCUIT BULLHORN HILLS
 P.O. BOX 640 BULLHORN HILLS BUSINESS CENTRE
 NSW, 2833
 PHONE: (02) 8824 3533 FAX: (02) 8824 3544
 WWW.ANDDESIGNSTUDY.COM.AU

lendlease **bda** **A&N**
 BUILDING DESIGNERS ASSOCIATION OF AUSTRALIA **DESIGN GROUP**
 S Y D N E Y

SOLAR ACCESS TO PRIVATE OPEN SPACE AREA'S (sqm)									
UNIT	P.O.S	9am	10am	11am	12 noon	1pm	2pm	3pm	
SV1	72.1	52	63	64	63	60	51	45	
SV2	38.9	25	29	30	28	23	9	0	
SV3	39.7	17	29	30	28	23	7	0	
SV4	39.7	26	29	30	28	23	8	0	
SV5	28.5	9	14	12	13	9	11	12	
SV6	25.5	20	15	13	14	11	14	3	
SV7	39.7	0	0	8	19	27	32	4	
SV8	39.7	0	0	5	15	26	32	3	
SV9	38.9	0	0	6	17	27	32	0	
SV10	73.6	44	49	53	66	78	79	58	
SV11	71.4	49	60	64	64	62	49	46	
SV12	38.9	11	26	28	28	23	9	0	
SV13	39.7	10	26	28	28	23	7	0	
SV14	39.7	10	26	28	28	26	8	0	
SV15	51.8	14	25	34	34	26	10	0	
SV16	25.5	19	18	18	18	16	13	6	
SV17	40.0	0	0	7	20	29	30	4	
SV18	40.0	0	0	8	18	27	30	4	
SV19	96.0	47	49	50	67	83	83	65	
SV20	83.0	50	65	66	72	64	55	48	
SV21	39.7	8	25	26	27	23	10	0	
SV22	39.7	9	26	26	29	23	11	0	
SV23	54.2	12	26	28	33	26	11	0	
SV24	51.6	0	0	4	18	31	36	18	
SV25	39.7	0	0	7	19	29	31	12	
SV26	39.7	0	0	4	15	28	31	8	
SV27	83.3	47	52	53	63	77	76	51	
SV28	26.4	32	31	30	24	19	20	20	
SV29	39.7	0	3	3	1	18	1	0	
SV30	39.7	0	0	0	0	12	16	0	
SV31	71.0	12	4	7	5	8	1	4	
SV32	59.4	8	14	18	13	8	6	0	
SV33	54.8	0	2	4	5	4	4	1	
SV34	66.4	13	8	9	10	2	0	0	
SV35	39.7	0	2	2	1	1	1	0	
SV36	39.7	0	0	0	0	1	1	0	
SV37	66.4	12	4	7	3	9	10	4	
SV38	27.8	15	17	17	30	33	33	33	
SV39	39.7	3	15	22	28	18	11	0	
SV40	39.7	15	25	26	29	18	11	0	
SV41	26.4	7	14	13	12	12	8	0	
SV42	66.4	26	34	36	36	37	32	18	
SV43	39.7	14	22	29	15	18	9	0	
SV44	39.7	7	12	17	15	12	8	0	
SV45	66.4	24	23	36	36	37	13	3	
SV46	54.8	15	23	32	30	25	15	3	
SV47	59.4	7	27	35	34	25	18	0	
SV48	71.0	18	25	29	29	33	25	0	
SV49	39.7	7	14	27	13	11	9	0	
SV50	39.7	5	11	17	13	11	9	0	
SV51	26.4	21	15	14	16	14	12	0	

UNIT	P.O.S	9am	10am	11am	12 noon	1pm	2pm	3pm	
SV1	72.1	#	#	#	#	#	#	#	#
SV2	38.9	#	#	#	#	#	#	#	#
SV3	39.7	#	#	#	#	#	#	#	#
SV4	39.7	#	#	#	#	#	#	#	#
SV5	28.5	#	#	#	#	#	#	#	#
SV6	25.5	#	#	#	#	#	#	#	#
SV7	39.7	#	#	#	#	#	#	#	#
SV8	39.7	#	#	#	#	#	#	#	#
SV9	38.9	#	#	#	#	#	#	#	#
SV10	73.6	#	#	#	#	#	#	#	#
SV11	71.4	#	#	#	#	#	#	#	#
SV12	38.9	#	#	#	#	#	#	#	#
SV13	39.7	#	#	#	#	#	#	#	#
SV14	39.7	#	#	#	#	#	#	#	#
SV15	51.8	#	#	#	#	#	#	#	#
SV16	25.5	#	#	#	#	#	#	#	#
SV17	40.0	#	#	#	#	#	#	#	#
SV18	40.0	#	#	#	#	#	#	#	#
SV19	96.0	#	#	#	#	#	#	#	#
SV20	83.0	#	#	#	#	#	#	#	#
SV21	39.7	#	#	#	#	#	#	#	#
SV22	39.7	#	#	#	#	#	#	#	#
SV23	54.2	#	#	#	#	#	#	#	#
SV24	51.6	#	#	#	#	#	#	#	#
SV25	39.7	#	#	#	#	#	#	#	#
SV26	39.7	#	#	#	#	#	#	#	#
SV27	83.3	#	#	#	#	#	#	#	#
SV28	26.4	#	#	#	#	#	#	#	#
SV29	39.7	#	#	#	#	#	#	#	#
SV30	39.7	#	#	#	#	#	#	#	#
SV31	71.0	#	#	#	#	#	#	#	#
SV32	59.4	#	#	#	#	#	#	#	#
SV33	54.8	#	#	#	#	#	#	#	#
SV34	66.4	#	#	#	#	#	#	#	#
SV35	39.7	#	#	#	#	#	#	#	#
SV36	39.7	#	#	#	#	#	#	#	#
SV37	66.4	#	#	#	#	#	#	#	#
SV38	27.8	#	#	#	#	#	#	#	#
SV39	39.7	#	#	#	#	#	#	#	#
SV40	39.7	#	#	#	#	#	#	#	#
SV41	26.4	#	#	#	#	#	#	#	#
SV42	66.4	#	#	#	#	#	#	#	#
SV43	39.7	#	#	#	#	#	#	#	#
SV44	39.7	#	#	#	#	#	#	#	#
SV45	66.4	#	#	#	#	#	#	#	#
SV46	54.8	#	#	#	#	#	#	#	#
SV47	59.4	#	#	#	#	#	#	#	#
SV48	71.0	#	#	#	#	#	#	#	#
SV49	39.7	#	#	#	#	#	#	#	#
SV50	39.7	#	#	#	#	#	#	#	#
SV51	26.4	#	#	#	#	#	#	#	#

■ ACHIEVES SUNLIGHT TO PRIVATE OPEN SPACE AREA'S
■ ACHIEVES NO SUNLIGHT TO PRIVATE OPEN SPACE AREA'S
■ ACHIEVES SUNLIGHT TO LIVING AREA'S

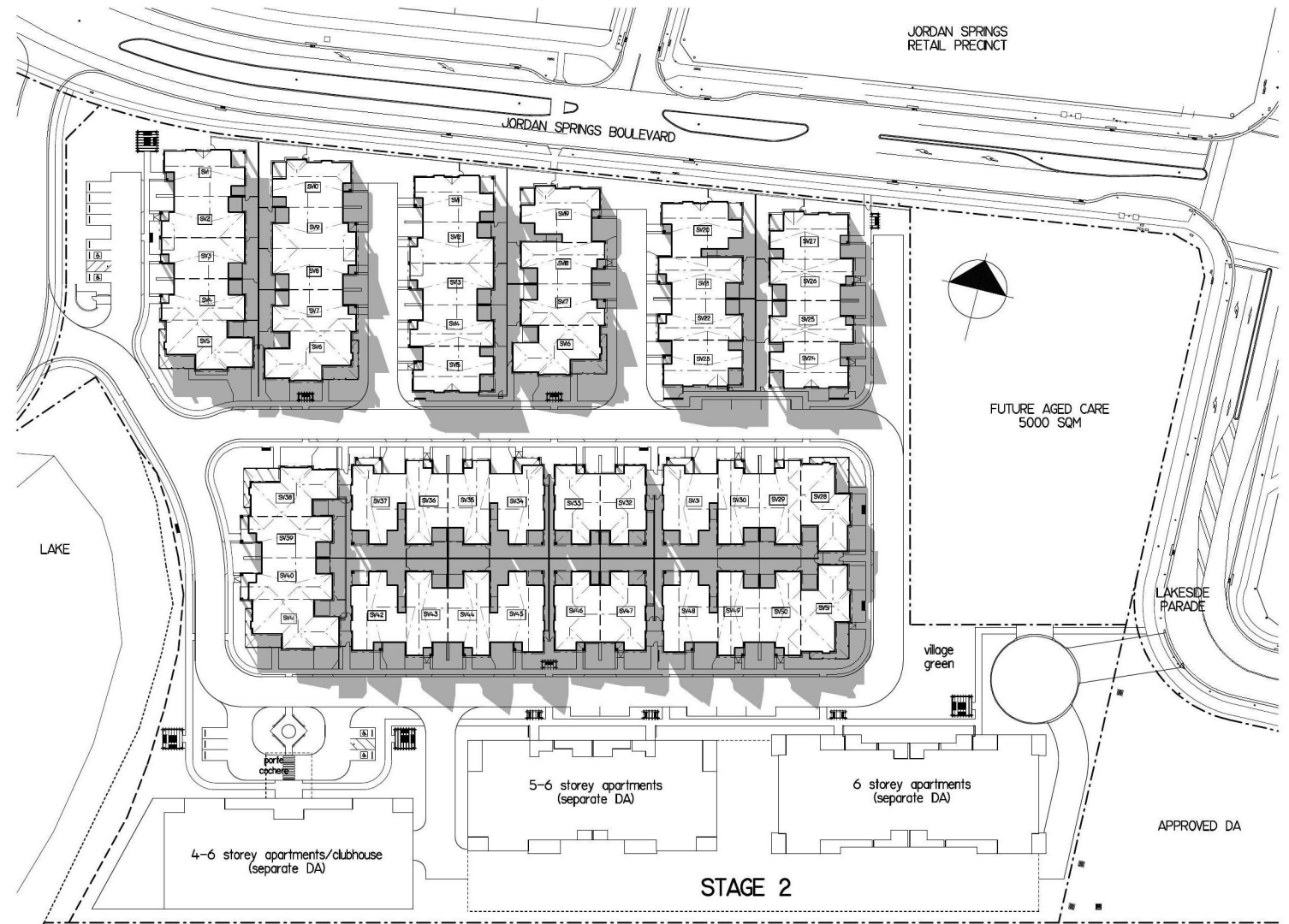

SHADOW ANALYSIS PLANS 1:500
 3PM - JUNE 21ST (MID WINTER)
SHADOW DIAGRAMS TO BE USED AS A GUIDE ONLY. SITE CONDITIONS MAY CAUSE VARIATION

THIS DRAWING IS THE PROPERTY OF ABN DESIGN P/L. REPRODUCTION, COPYING OR USE IN PART OR WHOLE WITHOUT WRITTEN PERMISSION, IS STRICTLY PROHIBITED. ANY UNLAWFUL USE WILL BE PROSECUTED.
 Document Set ID: 3290999
 Version: 1, Version Date: 13/07/2018

NO	DATE	REVISION	BY	DATE
1	13/07/2018	ISSUED FOR PERMIT	JH	

PROJECT: **JORDAN SPRINGS CD SITE**

JHArchitects
 Registered Architect: Joseph Hobb
 Incorporated No. 9556
 A. Suite 202, 4 Collins Court, Baulkham Hills NSW 263
 P. 042297600 E. joseph@jharchitects.com.au

JOB ADDRESS:
JORDAN SPRINGS BOULEVARD
JORDAN SPRINGS

FOR: **LEND LEASE**
 DATE: 15/08 DRAWING NO: AND-284/05 SHEET: SET OF:

lendlease **bda** **A&N**
 BUILDING DESIGNERS ASSOCIATION OF AUSTRALIA DESIGN GROUP BY D H E Y
 LEVEL 2 SUITE 206 MACARTHUR POINT
 NO. 25-27 SOLENT CIRCUIT BULLHORN HILLS
 P.O. BOX 640 BULLHORN HILLS BUSINESS CENTRE
 NSW, 2633
 PHONE: (02) 8824 3533 FAX: (02) 8824 3544
 WWW.LENDESIGNSTUDY.COM.AU