

ACCESS AND SAFETY

1. THE CONTRACTOR SHALL COMPLY WITH ALL STATUTORY AND INDUSTRIAL REQUIREMENTS FOR PROVISION OF A SAFE WORKING ENVIRONMENT INCLUDING TRAFFIC AND PEDESTRIAN CONTROL.
2. THE CONTRACTOR SHALL ENSURE THAT AT ALL TIMES ACCESS TO ALL BUILDINGS ADJACENT THE WORKS IS NOT DISRUPTED.
3. WHERE NECESSARY THE CONTRACTOR SHALL PROVIDE SAFE PASSAGE OF VEHICLES AND/OR PEDESTRIANS THROUGH OR BY THE SITE.

GENERAL

1. ALL WORKS TO BE CONSTRUCTED IN ACCORDANCE WITH PENRITH CITY COUNCIL GUIDELINES.
2. PENRITH CITY COUNCIL STANDARD DETAILS TO BE USED WHERE REQUIRED.
3. UTILITY ADJUSTMENTS AT DEVELOPERS EXPENSE.
4. CONDUITS TO BE PLACED WHERE REQUIRED BY THE RELEVANT AUTHORITIES.

SURVEY NOTES

THE EXISTING SITE CONDITIONS SHOWN ON THE FOLLOWING DRAWINGS HAVE BEEN INVESTIGATED BY CARDNO, BEING REGISTERED SURVEYORS AND SURVEY PREVIOUSLY PROVIDED BY LENDLEASE THE INFORMATION IS SHOWN TO PROVIDE A BASIS FOR DESIGN.

SHOULD DISCREPANCIES BE ENCOUNTERED DURING CONSTRUCTION BETWEEN THE SURVEY DATA AND ACTUAL FIELD DATA, CONTACT CARDNO.

NOTES

1. THIS PLAN IS PREPARED FOR LENDLEASE FROM A COMBINATION OF FIELD SURVEY AND EXISTING RECORDS FOR THE PURPOSE OF DESIGNING NEW CONSTRUCTIONS ON THE LAND AND SHOULD NOT BE USED FOR ANY OTHER PURPOSE.
2. VISIBLE SERVICES SHOWN HEREON HAVE BEEN LOCATED WHERE POSSIBLE BY FIELD SURVEY OR DIAL BEFORE YOU DIG INFORMATION. PRIOR TO ANY DEMOLITION, EXCAVATION OR CONSTRUCTION ON THE SITE, THE RELEVANT AUTHORITY SHOULD BE CONTACTED FOR POSSIBLE LOCATION OF FURTHER UNDERGROUND SERVICES AND DETAILED LOCATIONS OF ALL SERVICES.
3. SERVICES MARKED AS DYBD ARE BASED ON DIAL BEFORE YOU DIG DATA COLLECTED ON 08/07/2019.

LEGEND

	POWER POLE WITH LIGHT
	LIGHT POLE
	WATER METER
	SEWER MANHOLE
	SEWER LAMPHOLE
	UNCLASSIFIED PIT
	DRAINAGE PIT
	COMMUNICATIONS PIT
	CONTOUR MAJOR
	BOUNDARY SUBJECT
	BUILDING EDGE
	CROWN OF ROAD
	EDGE OF BITUMEN/FORMATION
	FENCE
	NATURAL SURFACE STRING
	TOE OF BANK
	TOP OF BANK
	DRAINAGE LINE
	SEWER
	POTABLE WATER (DYBD)
	ELECTRICAL OVERHEAD LINE
	UNDERGROUND ELECTRICAL CONDUIT (DYBD)
	EXISTING OPTUS LINE (DYBD)
	EXISTING TELSTRA LINE (DYBD)
	EXISTING NBN LINE (DYBD)

EROSION AND SEDIMENT CONTROL NOTES

GENERAL INSTRUCTIONS

1. THE CONTRACTOR SHALL BE SOLELY RESPONSIBLE FOR THE CONTROL OF EROSION AND SEDIMENTATION TO THE SATISFACTION OF COUNCIL, NSW OFFICE OF WATER AND OFFICE OF ENVIRONMENT AND HERITAGE, THE EROSION AND SEDIMENTATION CONTROLS SHOWN ON THE DRAWINGS SHALL ONLY BE USED AS A GUIDE BY THE CONTRACTOR, AND SHALL REPRESENT THE MINIMUM REQUIREMENT ONLY.
2. THE CONTRACTOR SHALL ENSURE THAT ALL SOIL AND WATER MANAGEMENT WORKS ARE LOCATED AS DOCUMENTED OR AS OTHERWISE DIRECTED BY THE SUPERINTENDENT. ALL WORK SHALL BE GENERALLY CARRIED OUT IN ACCORDANCE WITH:
 - a. LOCAL AUTHORITY REQUIREMENTS
 - b. EPA REQUIREMENTS
 - c. NSW DEPARTMENT OF HOUSING MANUAL "MANAGING URBAN STORMWATER, SOILS AND CONSTRUCTION", 4th EDITION, MARCH 2004.
3. MAINTAIN THE EROSION CONTROL DEVICES TO THE SATISFACTION OF THE SUPERINTENDENT AND THE LOCAL AUTHORITY.
4. WHEN STORMWATER PITS ARE CONSTRUCTED, PREVENT SITE RUNOFF ENTERING UNLESS SEDIMENT FENCES ARE ERECTED AROUND PITS.
5. CONTRACTOR IS TO ENSURE ALL EROSION & SEDIMENT CONTROL DEVICES ARE MAINTAINED IN GOOD WORKING ORDER AND OPERATE EFFECTIVELY. REPAIRS AND OR MAINTENANCE SHALL BE UNDERTAKEN AS REQUIRED, PARTICULARLY FOLLOWING STORM EVENTS.

LAND DISTURBANCE

6. WHERE PRACTICAL, THE SOIL EROSION HAZARD ON THE SITE WILL BE KEPT AS LOW AS POSSIBLE. TO THIS END, WORKS SHOULD BE UNDERTAKEN IN THE FOLLOWING SEQUENCE:
 - a. INSTALL A SEDIMENT FENCE ALONG THE BOUNDARIES AS SHOWN ON PLAN. REFER DETAIL.
 - b. CONSTRUCT STABILISED CONSTRUCTION ENTRANCE TO LOCATION AS DETERMINED BY SUPERINTENDENT/ENGINEER. REFER DETAIL.
 - c. INSTALL SEDIMENT TRAPS AS SHOWN ON PLAN.
 - d. UNDERTAKE SITE DEVELOPMENT WORKS IN ACCORDANCE WITH THE ENGINEERING PLANS. WHERE POSSIBLE, PHASE DEVELOPMENT SO THAT LAND DISTURBANCE IS CONFINED TO AREAS OF WORKABLE SIZE.

EROSION CONTROL

7. DURING WINDY WEATHER, LARGE, UNPROTECTED AREAS WILL BE KEPT MOIST (NOT WET) BY SPRINKLING WITH WATER TO KEEP DUST UNDER CONTROL.
8. FINAL SITE LANDSCAPING WILL BE UNDERTAKEN AS SOON AS POSSIBLE AND WITHIN 20 WORKING DAYS FROM COMPLETION OF CONSTRUCTION ACTIVITIES.
9. STOCKPILES WILL NOT BE LOCATED WITHIN 2 METRES OF HAZARD AREAS, INCLUDING LIKELY AREAS OF CONCENTRATED OR HIGH VELOCITY FLOWS SUCH AS WATERWAYS. WHERE THEY ARE BETWEEN 2 AND 5 METRES FROM SUCH AREAS, SPECIAL SEDIMENT CONTROL MEASURES SHOULD BE TAKEN TO MINIMISE POSSIBLE POLLUTION TO DOWNSLOPE WATERS, E.G. THROUGH INSTALLATION OF SEDIMENT FENCING.
10. ANY SAND USED IN THE CONCRETE CURING PROCESS (SPREAD OVER THE SURFACE) WILL BE REMOVED AS SOON AS POSSIBLE AND WITHIN 10 WORKING DAYS FROM PLACEMENT.
11. WATER WILL BE PREVENTED FROM ENTERING THE PERMANENT DRAINAGE SYSTEM UNLESS IT IS RELATIVELY SEDIMENT FREE, I.E. THE CATCHMENT AREA HAS BEEN PERMANENTLY LANDSCAPED AND/OR ANY LIKELY SEDIMENT HAS BEEN FILTERED THROUGH AN APPROVED STRUCTURE.

SEDIMENT CONTROL

12. TEMPORARY SOIL AND WATER MANAGEMENT STRUCTURES WILL BE REMOVED ONLY AFTER THE LANDS THEY ARE PROTECTING ARE REHABILITATED.
13. ACCEPTABLE RECEPTORS WILL BE PROVIDED FOR CONCRETE AND MORTAR SLURRIES, PAINTS, ACID WASHINGS, LIGHT-WEIGHT WASTE MATERIALS AND LITTER.
14. ANY EXISTING TREES WHICH FORM PART OF THE FINAL LANDSCAPING PLAN WILL BE PROTECTED FROM CONSTRUCTION ACTIVITIES BY:

OTHER MATTERS

- a. PROTECTING THEM WITH BARRIER FENCING OR SIMILAR MATERIALS INSTALLED OUTSIDE THE DRIP LINE
- b. ENSURING THAT NOTHING IS NAILED TO THEM
- c. PROHIBITING PAVING, GRADING, SEDIMENT WASH OR PLACING OF STOCKPILES WITHIN THE DRIP LINE EXCEPT UNDER THE FOLLOWING CONDITIONS:
 - (i) ENCROACHMENT ONLY OCCURS ON ONE SIDE AND NO CLOSER TO THE TRUNK THAN EITHER 1.5 METRES OR HALF THE DISTANCE BETWEEN THE OUTER EDGE OF THE DRIP LINE AND THE TRUNK, WHICHEVER IS THE GREATER
 - (ii) A DRAINAGE SYSTEM THAT ALLOWS AIR AND WATER TO CIRCULATE THROUGH THE ROOT ZONE (E.G. A GRAVEL BED) IS PLACED UNDER ALL FILL LAYERS OF MORE THAN 300 MILLIMETRES DEPTH
 - (iii) CARE IS TAKEN NOT TO CUT ROOTS UNNECESSARILY NOR TO COMPACT THE SOIL AROUND THEM.

STORMWATER DRAINAGE NOTES

1. STORMWATER DESIGN CRITERIA:
 - A. PUBLIC STORMWATER DESIGNED TO PENRITH COUNCIL'S STORMWATER MANAGEMENT POLICY, DESIGN GUIDELINES FOR ENGINEERING WORKS FOR SUBDIVISIONS AND DEVELOPMENTS, AND AUSTRALIAN RAINFALL AND RUNOFF 2019.
 - B. ANNUAL EXCEEDANCE PROBABILITY:
20% AEP PIPED DRAINAGE
1% AEP OVERLAND FLOW
2. PIPES 375 DIA. AND LARGER TO BE REINFORCED CONCRETE CLASS '2' APPROVED SPIGOT AND SOCKET WITH RUBBER RING JOINTS. U.N.O.
3. PIPES 300 DIA AND LESS SHALL BE DWV GRADE (CLASS SN8) uPVC WITH SOLVENT WELDED JOINTS.
4. EQUIVALENT STRENGTH FRC PIPES MAY BE USED.
5. ALL PIPES ARE TO BE UNIFORMLY SUPPORTED ALONG THE LENGTH OF THE BARREL BY SUITABLE FILL MATERIAL. REFER TO BEDDING SUPPORT TYPE.
6. PIPES WITH SOCKETS SHALL BE LAID IN BEDDING WHERE SUITABLE RECESSES HAVE BEEN PROVIDED TO ENSURE PIPES DO NOT BEAR ON THEIR SOCKETS.
7. ALL STORMWATER DRAINAGE LINES UNDER PROPOSED BUILDING SLABS TO BE uPVC PRESSURE PIPE GRADE 6, ENSURE ALL VERTICALS AND DOWNPIPES ARE uPVC PRESSURE PIPE, GRADE 6 FOR A MIN OF 3.0m IN HEIGHT.
8. PIPES TO BE INSTALLED TO TYPE HS1 SUPPORT IN ACCORDANCE WITH AS 3725 (2007) IN ALL CASES BACKFILL TRENCH WITH SAND TO 300mm ABOVE PIPE. WHERE PIPE IS UNDER PAVEMENTS BACKFILL REMAINDER OF TRENCH TO UNDERSIDE OF PAVEMENT WITH SAND OR APPROVED GRANULAR MATERIAL COMPACTED IN 150mm LAYERS TO MINIMUM 98% STANDARD MAXIMUM DRY DENSITY IN ACCORDANCE WITH AS 1289 5.2.1. (OR A DENSITY INDEX OF NOT LESS THAN 75).
9. REFER TO AS/NZS 3725:2007 TABLE B1 FOR REQUIRED FILL DEPTHS ABOVE PIPE BARREL PRIOR TO USE OF COMPACTION MACHINERY OR TRAVERSING OF PIPES BY GENERAL SITE EQUIPMENT.
10. WHERE WORKING METHODS REQUIRE HIGHER CLASS PIPE, THE CONTRACTOR SHALL REFER TO AS 3725 (2007) TO DETERMINE THE APPROPRIATE PIPE CLASS. PROPOSED PIPE CLASS SHALL BE REVIEWED BY CARDNO PRIOR TO INSTALLATION.
11. ALL INTERNAL WORKS WITHIN PROPERTY BOUNDARIES ARE TO COMPLY WITH THE REQUIREMENTS OF AS/NZS 3500.3:2018.
12. PRECAST PITS MAY BE USED EXTERNAL TO THE BUILDING SUBJECT TO APPROVAL BY PENRITH CITY COUNCIL.
13. ENLARGERS, CONNECTIONS AND JUNCTIONS TO BE PREFABRICATED FITTINGS WHERE PIPES ARE LESS THAN 300 DIA.
14. WHERE SUBSOIL DRAINS PASS UNDER FLOOR SLABS AND VEHICULAR PAVEMENTS, UNSLOTTED uPVC SEWER GRADE PIPE IS TO BE USED.
15. CARE IS TO BE TAKEN WITH LEVELS OF STORMWATER LINES. GRADES SHOWN ARE NOT TO BE REDUCED WITHOUT APPROVAL.
16. GRATES AND COVERS SHALL CONFORM TO AS 3996 AND PENRITH CITY COUNCIL GUIDELINES.
17. AT ALL TIMES DURING CONSTRUCTION OF STORMWATER PITS, ADEQUATE SAFETY PROCEDURES SHALL BE TAKEN TO ENSURE AGAINST THE POSSIBILITY OF PERSONNEL FALLING DOWN PITS.
18. ALL EXISTING STORMWATER DRAINAGE LINES AND PITS THAT ARE TO REMAIN ARE TO BE INSPECTED AND CLEANED. DURING THIS PROCESS ANY PART OF THE STORMWATER DRAINAGE SYSTEM THAT WARRANTS REPAIR SHALL BE REPORTED TO THE SUPERINTENDENT/ENGINEER FOR FURTHER DIRECTIONS.

EXISTING UNDERGROUND SERVICES NOTES

THE LOCATIONS OF UNDERGROUND SERVICES SHOWN IN THIS SET OF DRAWINGS HAVE BEEN PLOTTED FROM SURVEY INFORMATION AND SERVICE AUTHORITY INFORMATION. THE SERVICE INFORMATION HAS BEEN PREPARED ONLY TO SHOW THE APPROXIMATE POSITIONS OF ANY KNOWN SERVICES AND MAY NOT BE AS CONSTRUCTED OR ACCURATE. CARDNO CAN NOT GUARANTEE THAT THE SERVICES INFORMATION SHOWN ON THESE DRAWINGS ACCURATELY INDICATES THE PRESENCE OR ABSENCE OF SERVICES OR THEIR LOCATION AND WILL ACCEPT NO LIABILITY FOR INACCURACIES IN THE SERVICES INFORMATION SHOWN FROM ANY CAUSE WHATSOEVER.

CONTRACTORS SHALL TAKE DUE CARE WHEN EXCAVATING ON SITE INCLUDING HAND EXCAVATION WHERE NECESSARY. CONTRACTORS ARE TO CONTACT THE RELEVANT SERVICE AUTHORITY PRIOR TO COMMENCEMENT OF EXCAVATION WORKS. CONTRACTORS ARE TO UNDERTAKE A SERVICES SEARCH PRIOR TO COMMENCEMENT OF WORKS ON SITE. SEARCH RESULTS ARE TO BE KEPT ON SITE AT ALL TIMES.

SITWORKS NOTES

1. ORIGIN OF LEVELS: REFER SURVEY NOTES.
2. CONTRACTOR MUST VERIFY ALL DIMENSIONS AND EXISTING LEVELS ON SITE PRIOR TO COMMENCEMENT OF WORK. ANY DISCREPANCIES TO BE REPORTED TO CARDNO.
3. MAKE SMOOTH CONNECTION WITH EXISTING WORKS AND SURFACES.
4. ALL TRENCH BACKFILL MATERIAL SHALL BE COMPACTED TO THE SAME DENSITY AS THE ADJACENT MATERIAL.
5. ALL SERVICE TRENCHES UNDER VEHICULAR PAVEMENTS SHALL BE BACKFILLED WITH SAND TO 300mm ABOVE PIPE. WHERE PIPE IS UNDER PAVEMENTS BACKFILL REMAINDER OF TRENCH TO UNDERSIDE OF PAVEMENT WITH SAND OR APPROVED GRANULAR MATERIAL. COMPACTED IN 150mm LAYERS TO MINIMUM 98% MODIFIED MAXIMUM DRY DENSITY IN ACCORDANCE WITH AS 1289 5.2.1. (OR A DENSITY INDEX OF NOT LESS THAN 75)
6. PROVIDE 10mm WIDE EXPANSION JOINTS BETWEEN BUILDINGS AND ALL CONCRETE OR UNIT PAVEMENTS.
7. ASPHALTIC CONCRETE SHALL CONFORM TO R.M.S. SPECIFICATION R116.
8. ALL BASECOURSE MATERIAL SHALL BE IGNEOUS ROCK QUARRIED MATERIAL TO COMPLY WITH R.M.S. FORM 3051, AND COMPACTED TO MINIMUM 95% MODIFIED DENSITY IN ACCORDANCE WITH A.S. 1289 5.2.1. FREQUENCY OF COMPACTION TESTING SHALL NOT BE LESS THAN 1 TEST PER 50m² OF BASECOURSE MATERIAL PLACED.
9. ALL SUB-BASE COURSE MATERIAL SHALL BE IGNEOUS ROCK QUARRIED MATERIAL TO COMPLY WITH R.M.S. FORM 3051, AND COMPACTED TO MINIMUM 95% MODIFIED DENSITY IN ACCORDANCE WITH A.S. 1289 5.2.1. FREQUENCY OF COMPACTION TESTING SHALL NOT BE LESS THAN 1 TEST PER 50m² OF SUB-BASE COURSE MATERIAL PLACED.
10. AS AN ALTERNATIVE TO THE USE OF IGNEOUS ROCK AS A SUB-BASE MATERIAL IN (9) A CERTIFIED RECYCLED CONCRETE MATERIAL COMPLYING WITH R.M.S. FORM 3051 WILL BE CONSIDERED. SUBJECT TO MATERIAL SAMPLES AND APPROPRIATE CERTIFICATIONS BEING PROVIDED TO THE SATISFACTION OF CARDNO.
11. SHOULD THE CONTRACTOR WISH TO USE A RECYCLED PRODUCT THIS SHALL BE CLEARLY INDICATED IN THEIR TENDER AND THE PRICE DIFFERENCE BETWEEN AN IGNEOUS PRODUCT AND A RECYCLED PRODUCT SHALL BE CLEARLY INDICATED.
12. WHERE NOTED ON THE DRAWINGS THAT WORKS ARE TO BE CARRIED BY OTHERS, (eg. ADJUSTMENT OF SERVICES), THE CONTRACTOR SHALL BE RESPONSIBLE FOR THE CO-ORDINATION OF THESE WORKS.

BULK EARTHWORKS NOTES

1. ORIGIN OF LEVELS: REFER SURVEY NOTES
2. REFER TO GEOTECHNICAL REPORT PREPARED BY DOUGLAS PARTNERS PROVIDED BY LENDLEASE FOR SITE PREPARATION REQUIREMENTS
3. STRIP ALL TOPSOIL/ORGANIC MATERIAL FROM CONSTRUCTION AREA AND REMOVE FROM SITE OR STOCK PILE AS DIRECTED BY SUPERINTENDENT.
4. EXCAVATED MATERIAL TO BE USED AS STRUCTURAL FILL PROVIDED THE PLACEMENT MOISTURE CONTENT OF THE MATERIAL IS +/- 2% OF THE OPTIMUM MOISTURE CONTENT.
5. COMPACT FILL AREAS AND SUBGRADE TO NOT LESS THAN:

LOCATION	STANDARD DRY DENSITY (AS 1289 5.1.1.)
UNDER BUILDING SLABS	100%
LANDSCAPED AREAS	98%
6. FOR NON COHESIVE MATERIAL, COMPACT TO NOT LESS THAN 75% DENSITY INDEX
7. BEFORE PLACING FILL, PROOF ROLL EXPOSED SUBGRADE WITH AN 8 TO 10 TONNE (MIN) DEADWEIGHT THREE POINT STEEL WHEELED ROLLER TO DETECT THEN REMOVE SOFT SPOTS (AREAS WITH MORE THAN 2mm MOVEMENT UNDER ROLLER).
8. EARTHWORKS ARE TO BE INSPECTED AND TESTED BY AN INDEPENDENT GEOTECHNICAL TESTING AUTHORITY TO LEVEL 1 RESPONSIBILITY AS DEFINED IN AS 3798.
9. FILLING TO BE PLACED IN MAXIMUM 250mm - LOOSE LAYERS AND COMPACTED AS SPECIFIED.
10. NO FILLING SHALL TAKE PLACE TO EXPOSED SUBGRADE UNTIL THE AREA HAS BEEN PROOF ROLLED IN THE PRESENCE OF GEOTECHNICAL ENGINEER AND APPROVAL GIVEN IN WRITING THAT FILLING CAN PROCEED.

SEDIMENT AND EROSION CONTROL LEGEND

	TEMPORARY STABILISED SITE ACCESS AND TRUCK WASH DOWN
	STRAW BALE SEDIMENT FILTER
	SITE FENCE
	SEDIMENT FENCE
	DIVERSION BANK AND CHANNEL
	GEOTEXTILE FILTER FABRIC DROP INLET SEDIMENT TRAP
	SANDBAG SEDIMENT TRAP FOR KERB INLET ON GRADE
	MESH AND GRAVEL INLET FILTER
	INDICATIVE STOCKPILE LOCATIONS
	SITE ENTRANCE
	TEMPORARY SEDIMENT BASIN

ROOF WATER KERB OUTLETS

1. KERB OUTLETS TO BE PROVIDED IN ACCORDANCE WITH PENRITH CITY COUNCILS CIVIL WORKS SPECIFICATION AT EACH LOT WHERE INTERALLOTMENT DRAINAGE IS NOT PROVIDED
2. KERB OUTLETS ARE TO BE CONSTRUCTED AT THE SAME TIME KERBS ARE POURED.
3. ALIGNMENT OF KERB OUTLET PIPE TO BE ADJUSTED ON SITE TO AVOID SERVICE CLASHES.

TELSTRA - DUTY OF CARE NOTE

TELSTRA'S PLANS SHOW ONLY THE PRESENCE OF CABLES AND PLANT. THEY ONLY SHOW THEIR POSITION RELATIVE TO ROAD BOUNDARIES, PROPERTY FENCES ETC. AT THE TIME OF INSTALLATION AND TELSTRA DOES NOT WARRANT OR HOLD OUT THAT SUCH PLANS ARE ACCURATE. THEREAFTER DUE TO CHANGES THAT MAY OCCUR OVER TIME. DO NOT ASSUME DEPTH OR ALIGNMENT OF CABLES OR PLANT AS THESE VARY SIGNIFICANTLY. THE CONTRACTOR HAS A DUTY OF CARE WHEN EXCAVATING NEAR TELSTRA CABLES AND PLANT. BEFORE USING MACHINE EXCAVATORS TELSTRA PLANT MUST FIRST BE PHYSICALLY EXPOSED BY SOFT DIG POTHOLING TO IDENTIFY ITS LOCATION. TELSTRA WILL SEEK COMPENSATION FOR DAMAGES CAUSED TO ITS PROPERTY AND LOSSES CAUSED TO TELSTRA AND ITS CUSTOMERS.

PROPOSED WORKS LEGEND

	EXTENT OF WORK
	STAGE BOUNDARY
	PROPOSED CONTOUR
	BATTER
	STRUCTURAL RETAINING WALL
	KERB & GUTTER REFER PENRITH CITY COUNCIL STANDARD DETAIL.
	VEHICULAR CROSSING REFER PENRITH CITY COUNCIL STANDARD DETAIL.
	KERB RAMP AS PER COUNCIL STANDARDS
	SITE FENCE
	FLOW DIRECTION STORMWATER PIPE PIPE DIAMETER
	DRAINAGE CAP
	CONCRETE HEADWALL
	KERB INLET WITH LINTEL.
	JUNCTION PIT
	GRATED INLET PIT
	SURVEY BOUNDARY

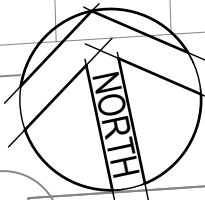

0 20 40 60 80 100m

SCALE 1:1000 @A1

© Cardno Limited All Rights Reserved.
This document is produced by Cardno Limited solely for the benefit of and use by the client in accordance with the terms of the retainer. Cardno Limited does not and shall not assume any responsibility or liability whatsoever to any third party arising out of any use or reliance by third party on the content of this document.



Drawn	Date
HLD	17/04/2020
Checked	Date
PL	17/04/2020
Designed	Date
HLD	17/04/2020
Verified	Date
PL	RIP
Approved	
AJG	RIP

Client	LENDLEASE COMMUNITIES
Project	CHAPMAN STREET WERRINGTON CIVIL WORKS DEVELOPMENT APPLICATION
Title	GENERAL ARRANGEMENT PLAN

Status				<div style="text-align: center; color: red; font-weight: bold;">FOR APPROVAL</div> <div style="text-align: center; color: red; font-weight: bold;">NOT TO BE USED FOR CONSTRUCTION PURPOSES</div>	
Date	Date	Scale	Size		
A.H.D	Mar' 2020	1:1000	A1		
Drawing Number				Revision	
80219053-DA004-SL-1031				1	

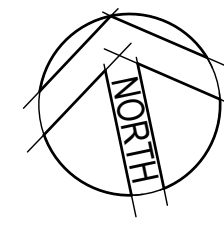

REFER DRG. 1011 FOR NOTES AND LEGEND.

0 20 40 60 80 100m

SCALE 1:1000 @A1

© Cardno Limited All Rights Reserved.
This document is produced by Cardno Limited solely for the benefit of and use by the client in accordance with the terms of the retainer. Cardno Limited does not and shall not assume any responsibility or liability whatsoever to any third party arising out of any use or reliance by third party on the content of this document.



Drawn HLD	Date 17/04/2020
Checked PL	Date 17/04/2020
Designed HLD	Date 17/04/2020
Verified PL	Date RIP
Approved	
AJG	RIP

Client	LENLEASE COMMUNITIES
Project	CHAPMAN STREET WERRINGTON CIVIL WORKS DEVELOPMENT APPLICATION
Title	EXISTING SERVICES AND SURVEY PLAN

Status				FOR APPROVAL			
NOT TO BE USED FOR CONSTRUCTION PURPOSES							
Datum		Date		Scale		Size	
A.H.D		Mar' 2020		1:750		A1	
Drawing Number						Revision	
80219053-DA004-SL-1051						1	

NOTE

REFER DRG. 1011 FOR NOTES AND LEGEND.

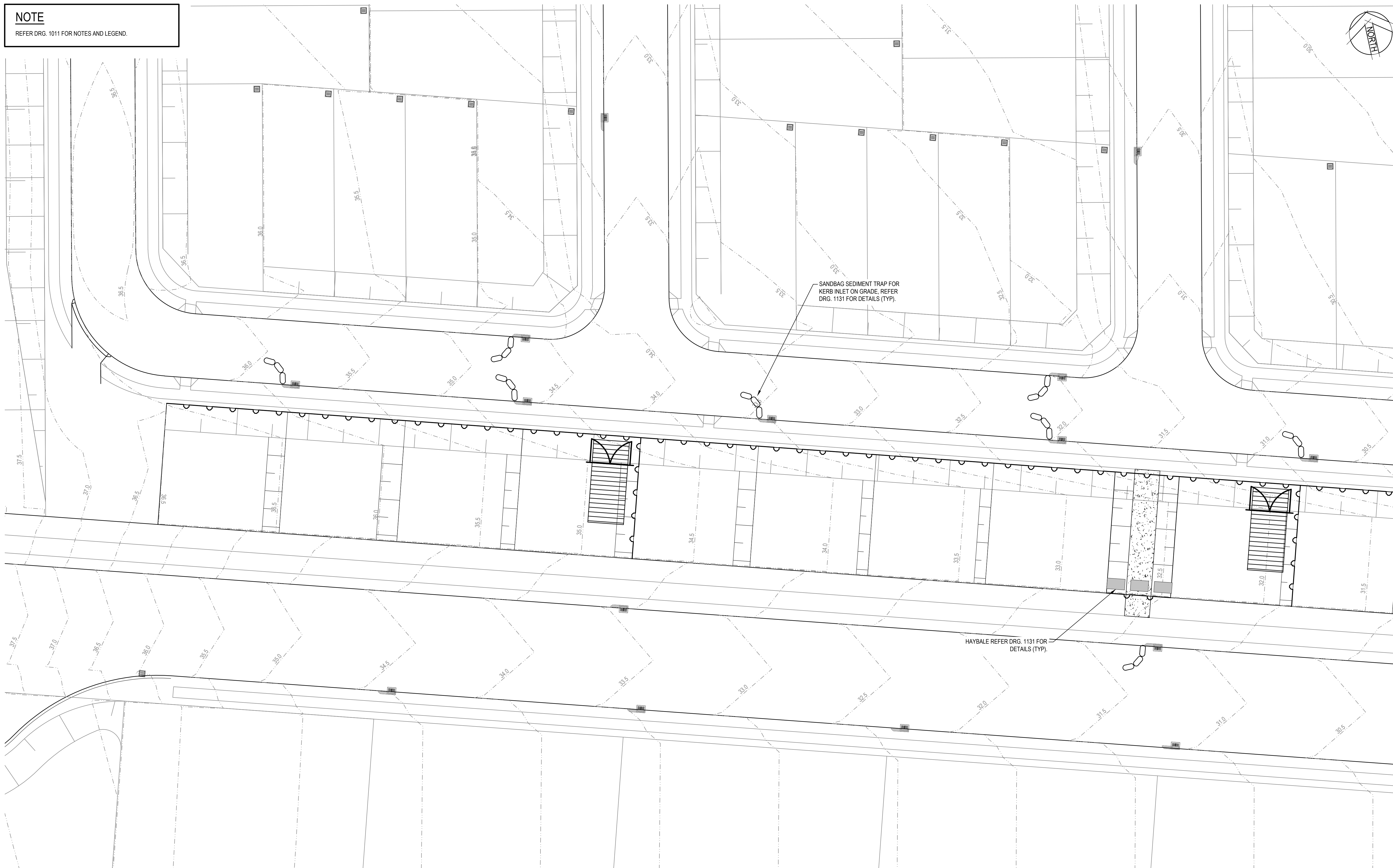

REFER 1102

[illegible]

© Cardno Limited All Rights Reserved

This document is produced by Cardno Limited solely for the benefit of and use by the client in accordance with the terms of the retainer. Cardno Limited does not and shall not assume any responsibility or liability whatsoever to any third party arising out of any use or reliance by third party on the content of this document.



Cardno (NSW/ACT) Pty Ltd | ABN 95 001 145 035
Level 9, The Forum, 203 Pacific Highway
St. Leonards, NSW 2065
Tel: 02 9496 7700 Fax: 02 9439 5170
Web: www.cardno.com.au

Drawn HLD	Date 17/04/2020
Checked PL	Date 17/04/2020
Designed HLD	Date 17/04/2020
Verified PL	Date RIP
Approved	
AJG	RIP

Client **LENDLEASE COMMUNITIES**

Project CHAPMAN STREET WERRINGTON

CIVIL WORKS	
DEVELOPMENT APPLICATION	
Title	EROSION AND SEDIMENT CONTROL PLAN
	SHEET 1 OF 3

Item	Status
1. Project Initiation	Completed
2. Requirements Gathering	In Progress
3. System Design	Not Started
4. Development	Not Started
5. Testing	Not Started
6. Deployment	Not Started
7. Maintenance	Not Started

FOR APPROVAL

NOT TO BE USED FOR CONSTRUCTION PURPOSES

Datum A.H.D	Date Mar' 2020	Scale 1:250	Size A1
Drawing Number 80219053-DA004-SL-1101			Revision 1

REFER DRG. 1011 FOR NOTES AND LEGEND.

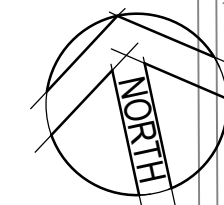

REFER 1101

REFER 1103

1	17/04/2020	ISSUED FOR INFORMATION	HLD	PL	A/JG
Rev.	Date	Description	Des.	Verif.	Appd.



© Cardno Limited All Rights Reserved.
This document is produced by Cardno Limited solely for the benefit of and use by the client in accordance with the terms of the retainer. Cardno Limited does not and shall not assume any responsibility or liability whatsoever to any third party arising out of any use or reliance by third party on the content of this document.



Cardno (NSW/ACT) Pty Ltd | ABN 95 001 145 035
Level 9, The Forum, 203 Pacific Highway
St. Leonards, NSW 2065
Tel: 02 9496 7700 Fax: 02 9439 5170
Web: www.cardno.com.au

Drawn HLD	Date 17/04/2020	Client LENLEASE COMMUNITIES				
Checked PL	Date 17/04/2020	Project CHAPMAN STREET WERRINGTON CIVIL WORKS DEVELOPMENT APPLICATION	Status FOR APPROVAL			
Designed HLD	Date 17/04/2020		NOT TO BE USED FOR CONSTRUCTION PURPOSES			
Verified PL	Date RIP		Title EROSION AND SEDIMENT CONTROL PLAN SHEET 2 OF 3			
Approved			A.H.D	Date Mar' 2020	Scale 1:250	Size A1
A/JG	RIP		Drawing Number 80219053-DA004-SL-1102			Revision 1

XREFs: XR-80219053-CI-STORMWATER; XR-80219053-CI-ROAD; XR-80219053-CI-SITEWORKS; XR-80219053-SL-LOT LAYOUT-SMART LOTS; XR-80219053-SL-SITEWORKS-SMART LOTS; XR-80219053-SL-SEDI-EROS-SMART LOTS; XR-80219053-SL-SEDI-EROS-SMART LOTS; XR-80219053-SL-SEDI-EROS-SMART LOTS; XR-80219053-SL-SEDI-EROS-SMART LOTS
 CAD File: N:\Projects\80219053-Chapman St\Werrington\Drawings\Build\004 SMART LOTS\DA004-SL-1101 EROSION AND SEDIMENTATION CONTROL PLAN.dwg

DATE PLOTTED: 17 April 2020 3:11 PM BY: HAYDEN DAVENPORT

REFER 1102

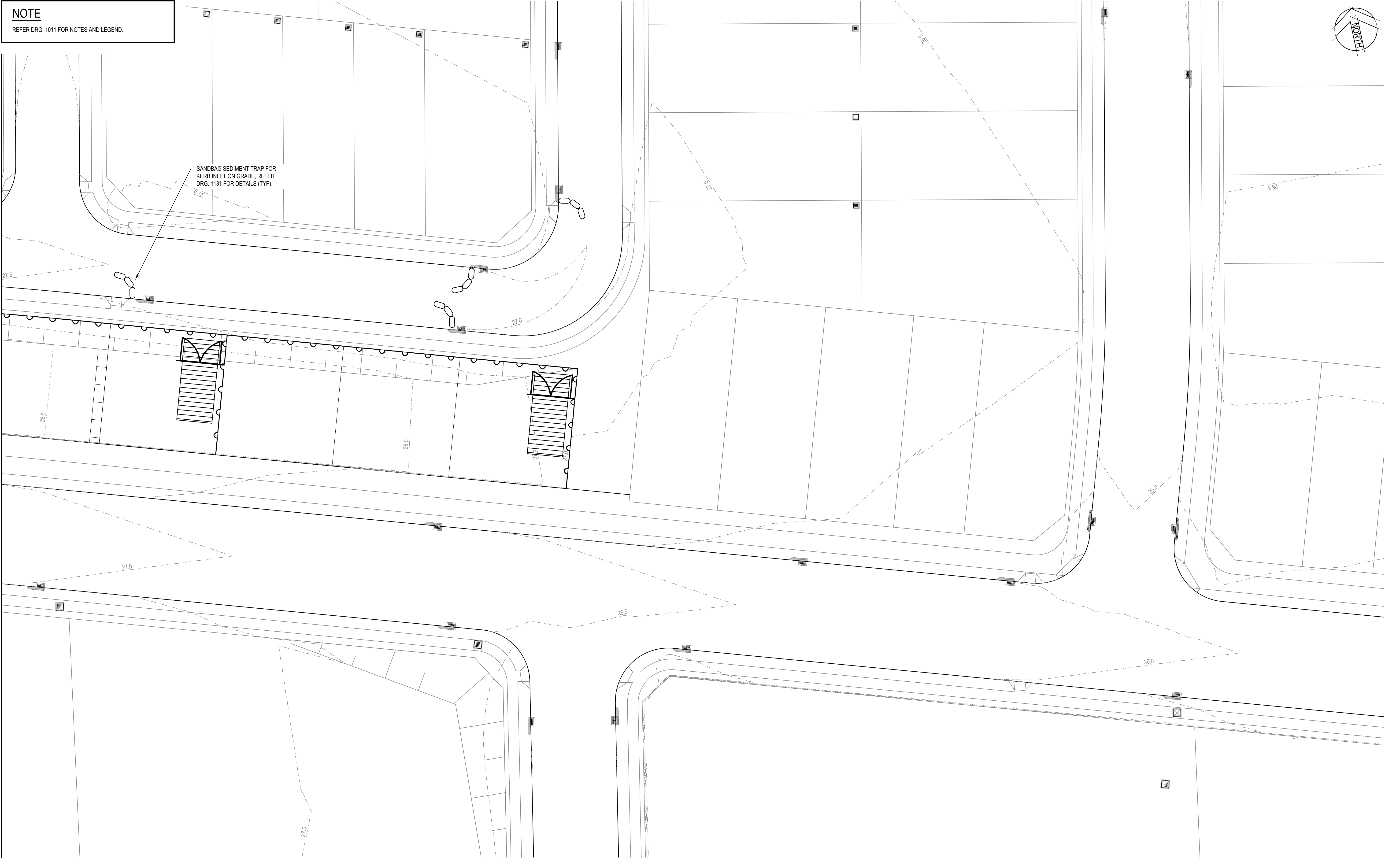

NOTE
REFER DRG. 1011 FOR NOTES AND LEGEND.

SANDBAG SEDIMENT TRAP FOR KERB INLET ON GRADE, REFER DRG. 1131 FOR DETAILS (TYP).

Rev.	Date	Description	Des.	Verif.	Appd.
1	17/04/2020	ISSUED FOR INFORMATION	HLD	PL	A/JG

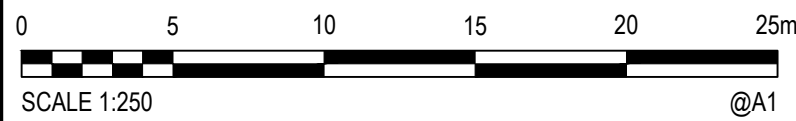

© Cardno Limited All Rights Reserved.
This document is produced by Cardno Limited solely for the benefit of and use by the client in accordance with the terms of the retainer. Cardno Limited does not and shall not assume any responsibility or liability whatsoever to any third party arising out of any use or reliance by third party on the content of this document.



Cardno
Shaping the Future

Cardno (NSW/ACT) Pty Ltd | ABN 95 001 145 035
 Level 9, The Forum, 203 Pacific Highway
 St. Leonards, NSW 2055
 Tel: 02 9496 7700 Fax: 02 9439 5170
 Web: www.cardno.com.au

Drawn	HLD	Date	17/04/2020
Checked	PL	Date	17/04/2020
Designed	HLD	Date	17/04/2020
Verified	PL	Date	RIP
Approved	A/JG	Date	RIP

Client	LENLEASE COMMUNITIES
Project	CHAPMAN STREET WERRINGTON
Title	CIVIL WORKS DEVELOPMENT APPLICATION EROSION AND SEDIMENT CONTROL PLAN SHEET 3 OF 3

Status				FOR APPROVAL			
NOT TO BE USED FOR CONSTRUCTION PURPOSES							
Datum		Date		Scale		Size	
A.H.D		Mar' 2020		1:250		A1	
Drawing Number						Revision	
80219053-DA004-SL-1103						1	

DATE PLOTTED: 17 April 2020 5:13 PM BY: HAYDEN DAVENPORT

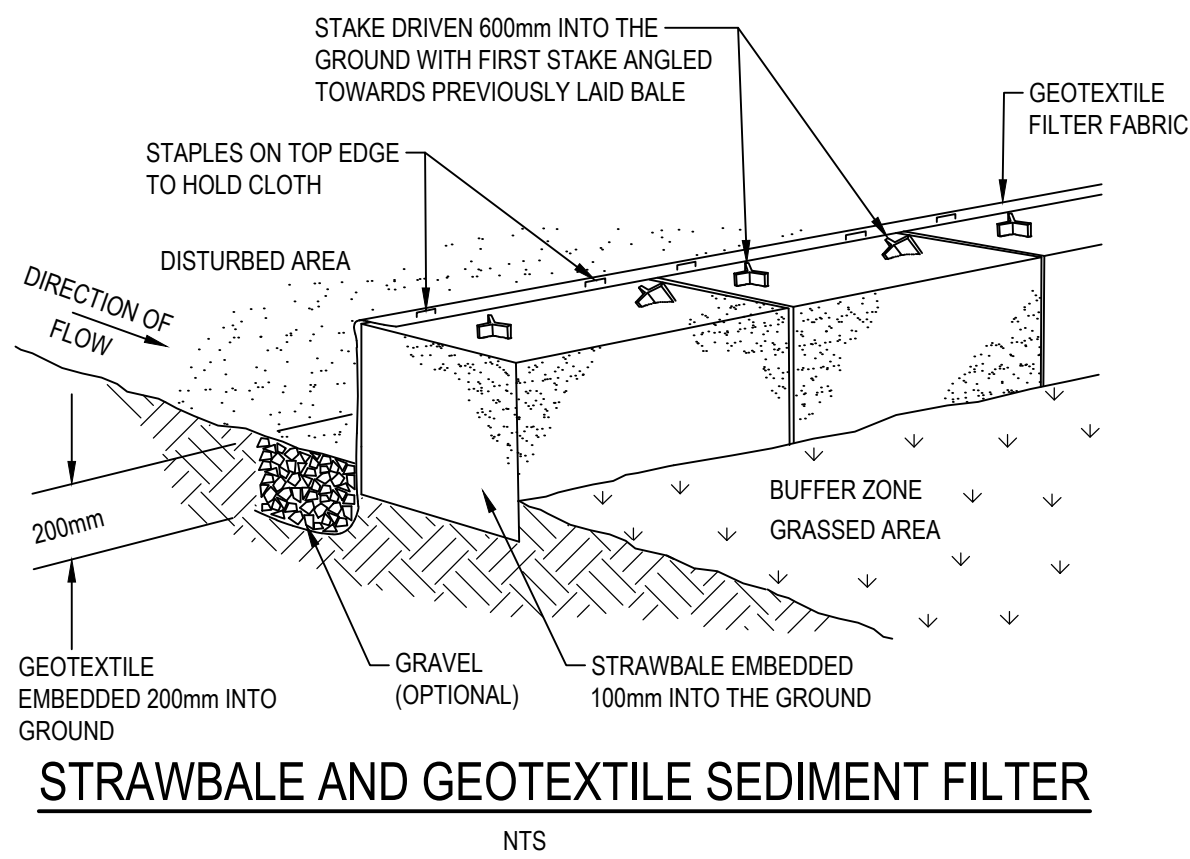
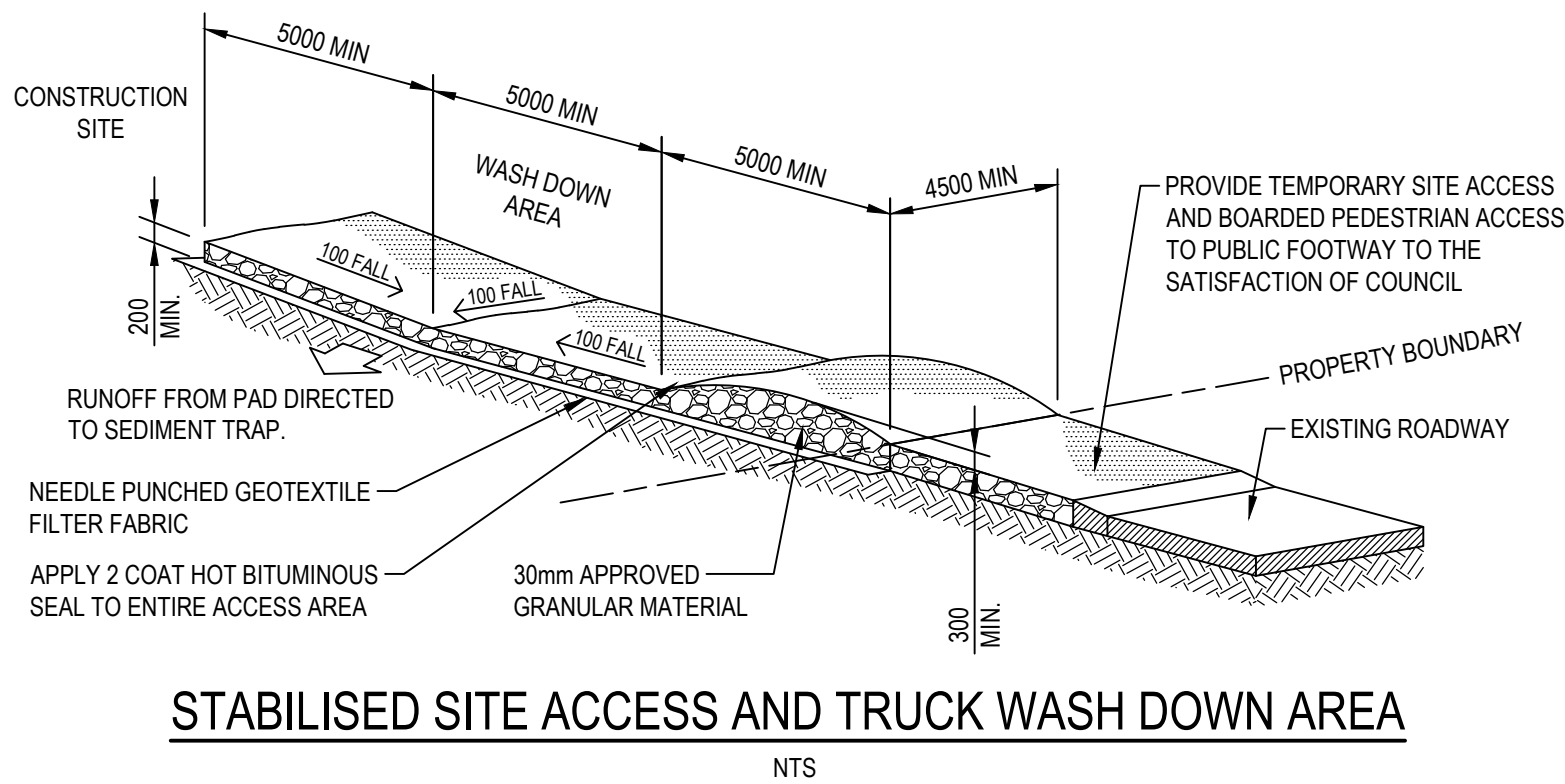
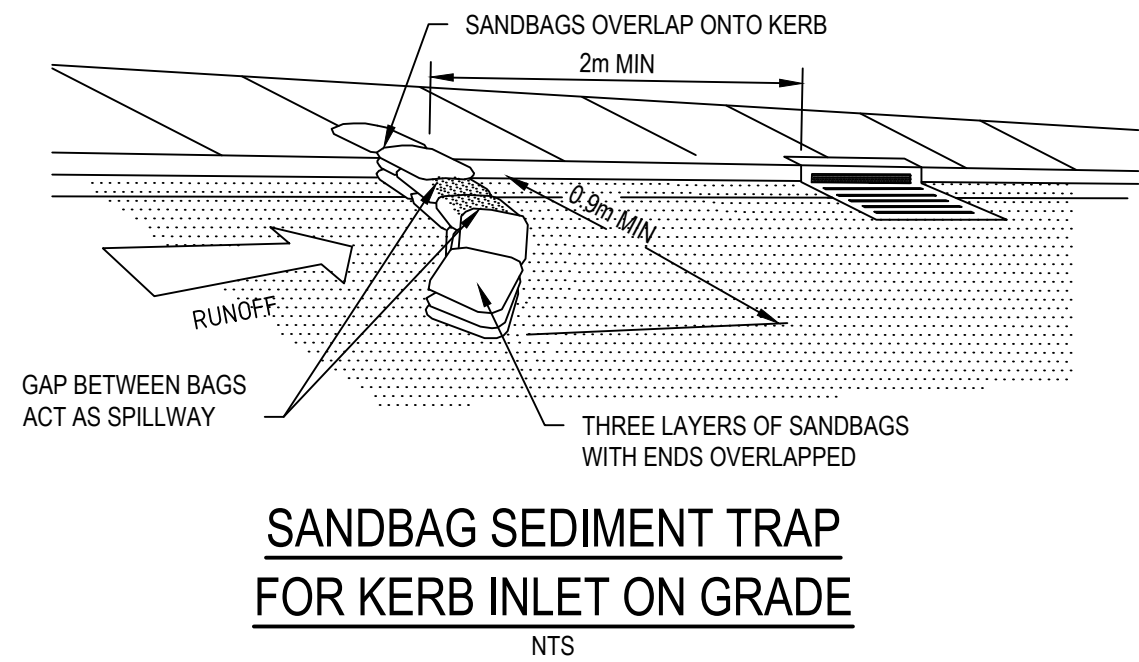
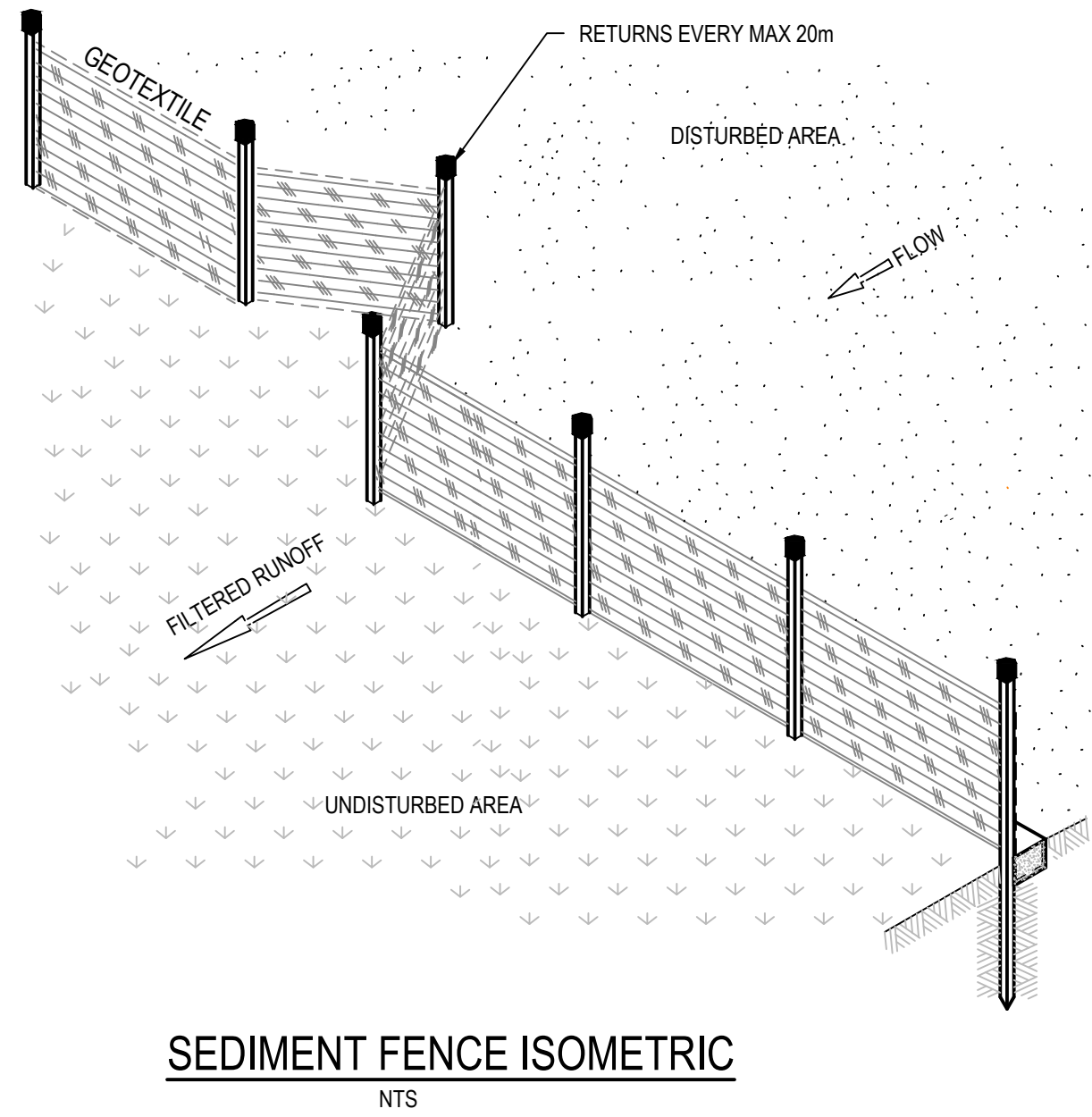
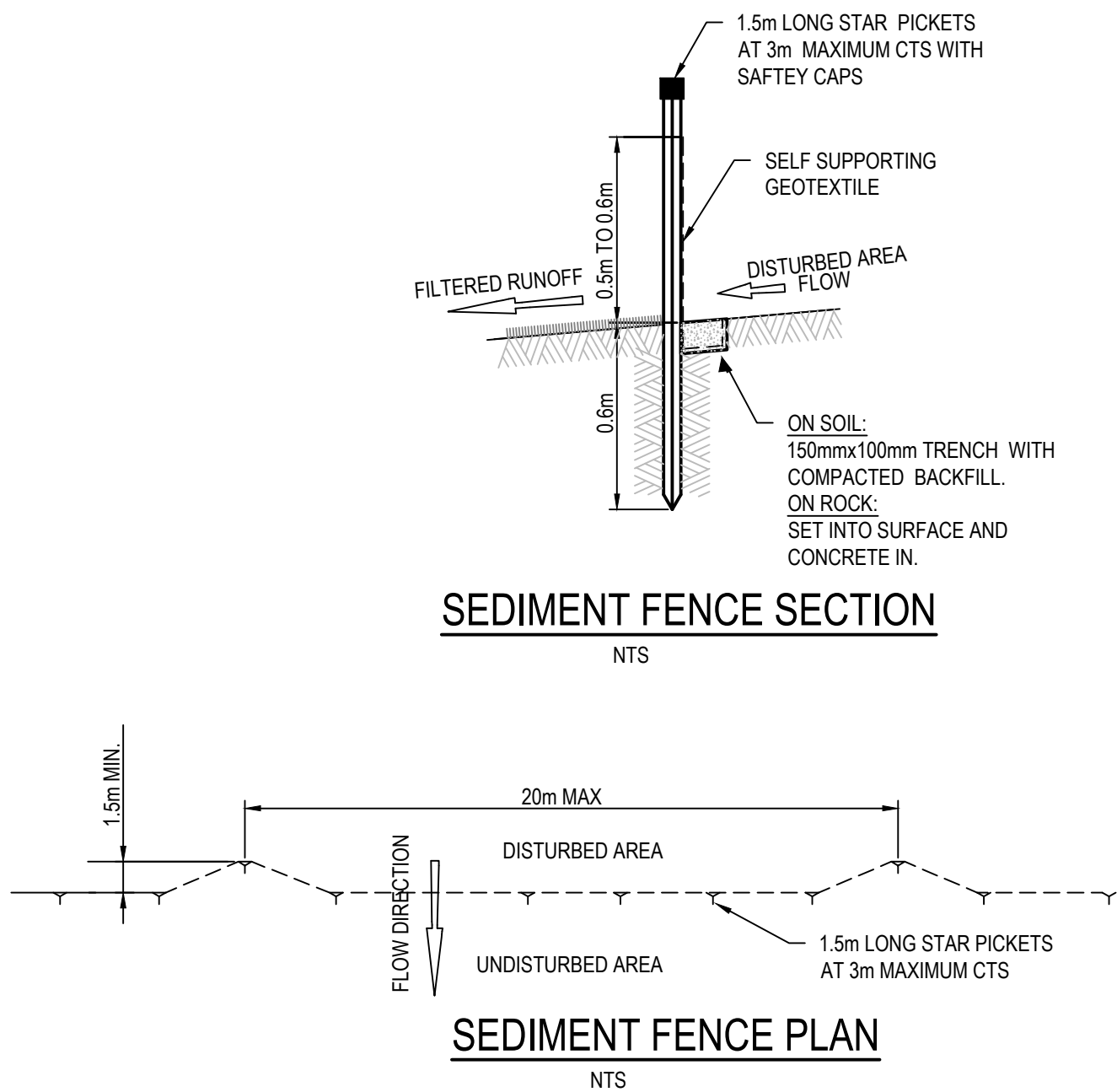
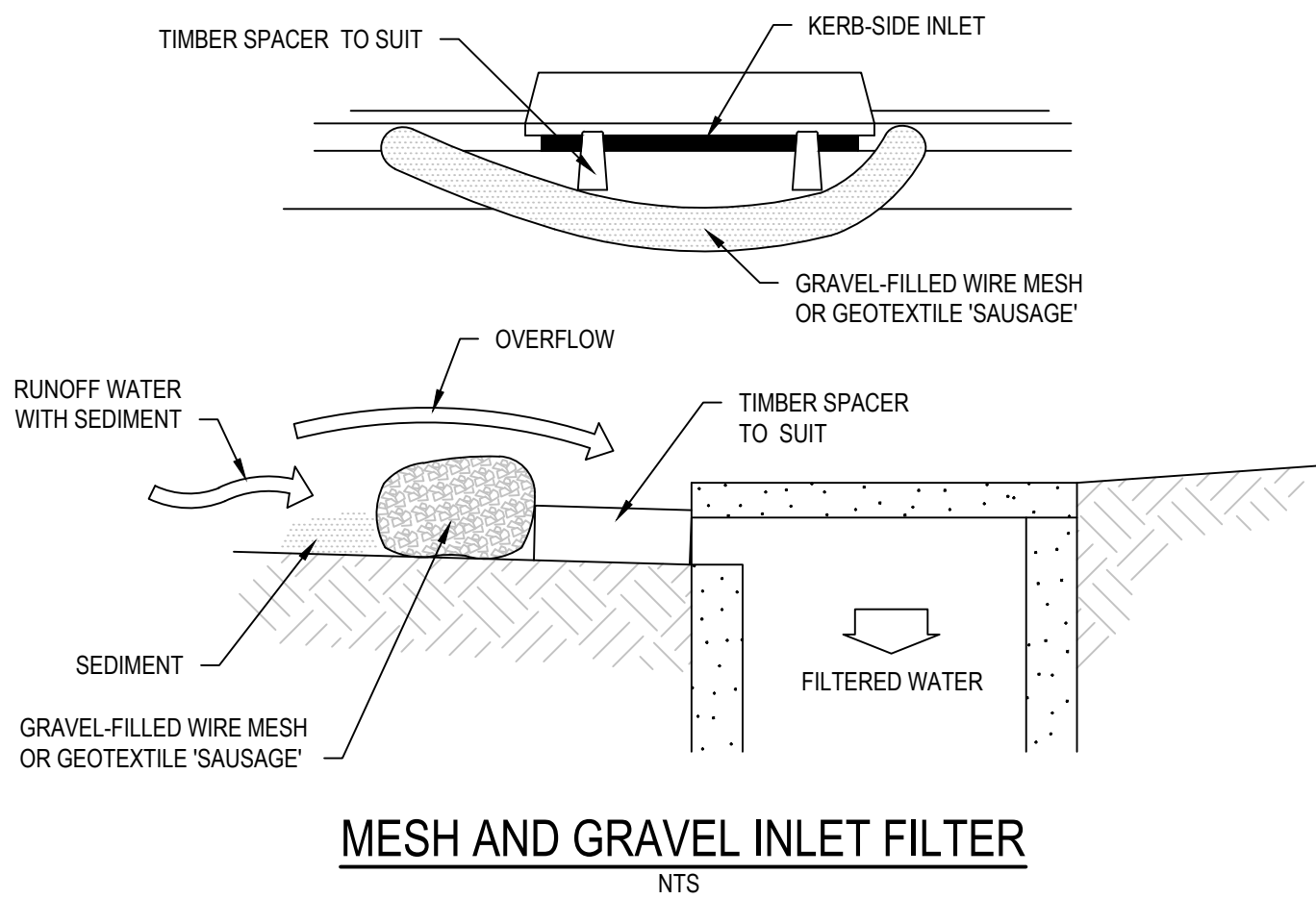

XREFs: CAD File: N:\Projects\2021\19053_Chapman St\Werrington\Drawings\Build\04 SMART LOTS\DA80219053-DA004-SL-1131 EROSION AND SEDIMENTATION CONTROL DETAILS.dwg

Rev.	Date	Description	Des.	Verif.	Appd.
1	17/04/2020	ISSUED FOR INFORMATION	HLD	PL	AJG

© Cardno Limited All Rights Reserved.
This document is produced by Cardno Limited solely for the benefit of and use by the client in accordance with the terms of the retainer. Cardno Limited does not and shall not assume any responsibility or liability whatsoever to any third party arising out of any use or reliance by third party on the content of this document.



Cardno (NSW/ACT) Pty Ltd | ABN 95 001 145 035
Level 9, The Forum, 203 Pacific Highway
St. Leonards, NSW 2055
Tel: 02 9496 7700 Fax: 02 9439 5170
Web: www.cardno.com.au

Drawn	Date	Client
HLD	17/04/2020	LENLEASE COMMUNITIES
Checked	Date	Project
PL	17/04/2020	CHAPMAN STREET WERRINGTON
Designed	Date	Civil Works
HLD	17/04/2020	DEVELOPMENT APPLICATION
Verified	Date	Title
PL	RIP	EROSION AND SEDIMENT CONTROL DETAILS
Approved	Date	Revision
AJG	RIP	1

Client	LENDLEASE COMMUNITIES
Project	CHAPMAN STREET WERRINGTON CIVIL WORKS DEVELOPMENT APPLICATION
Title	EROSION AND SEDIMENT CONTROL DETAILS

Status: **FOR APPROVAL**
NOT TO BE USED FOR CONSTRUCTION PURPOSES

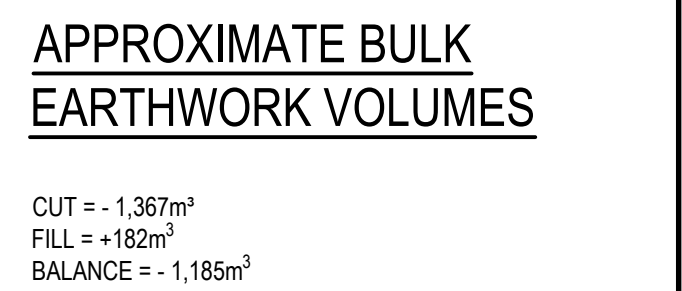

Status FOR APPROVAL NOT TO BE USED FOR CONSTRUCTION PURPOSES				
Date	Date	Scale	Size	
A.H.D	Mar' 2020	1:1750	A1	
Drawing Number			Revision	
80219053-DA004-SL-1141			1	

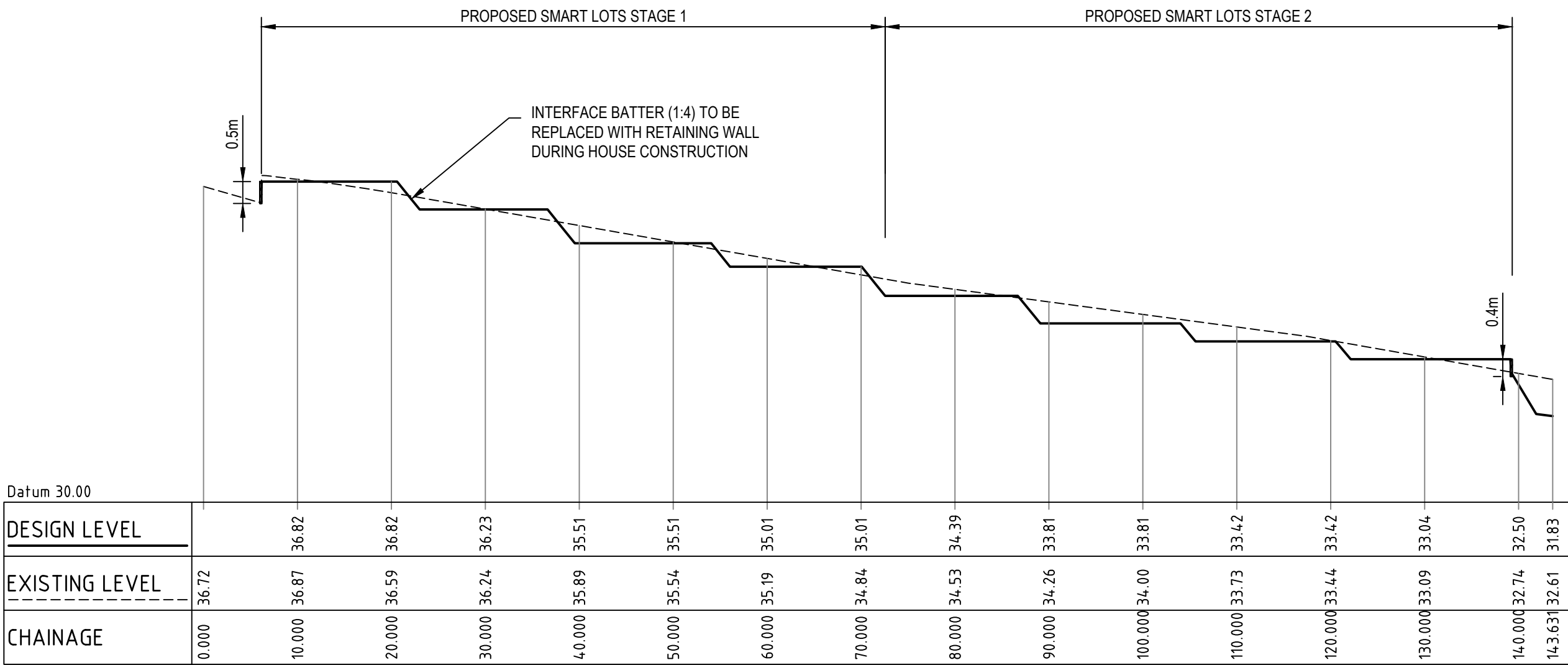

SECTION 1
SCALE 1:100V 1:500H

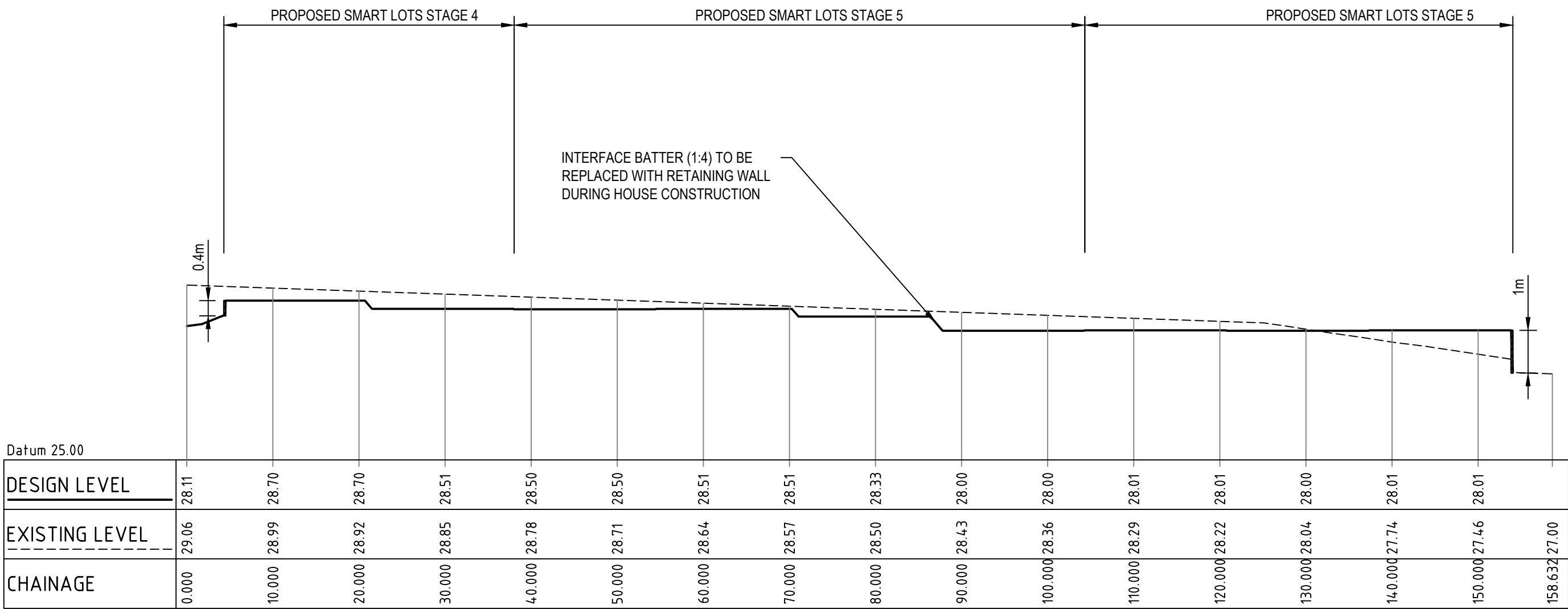

SECTION 3
SCALE 1:100V 1:500H

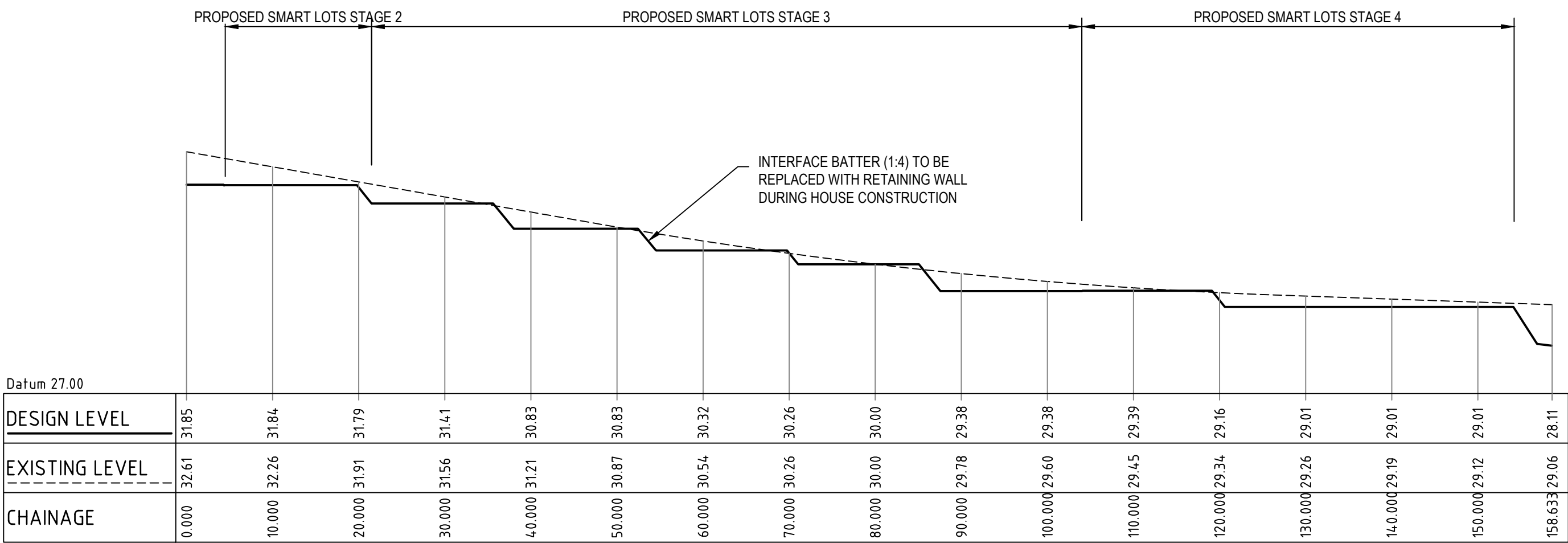

SECTION 2
SCALE 1:100V 1:500H

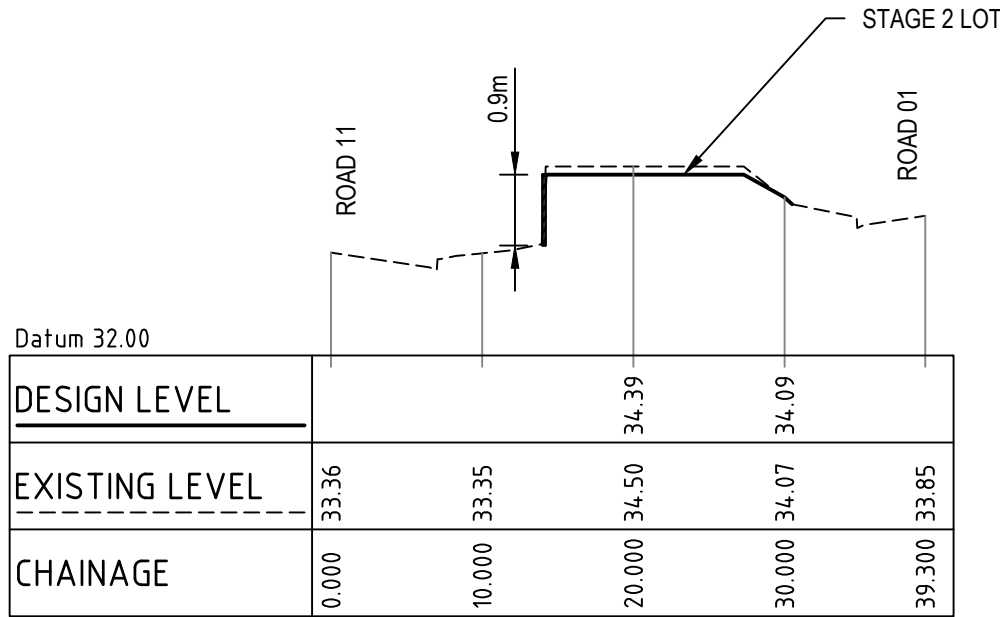

SECTION 4
SCALE 1:100V 1:500H

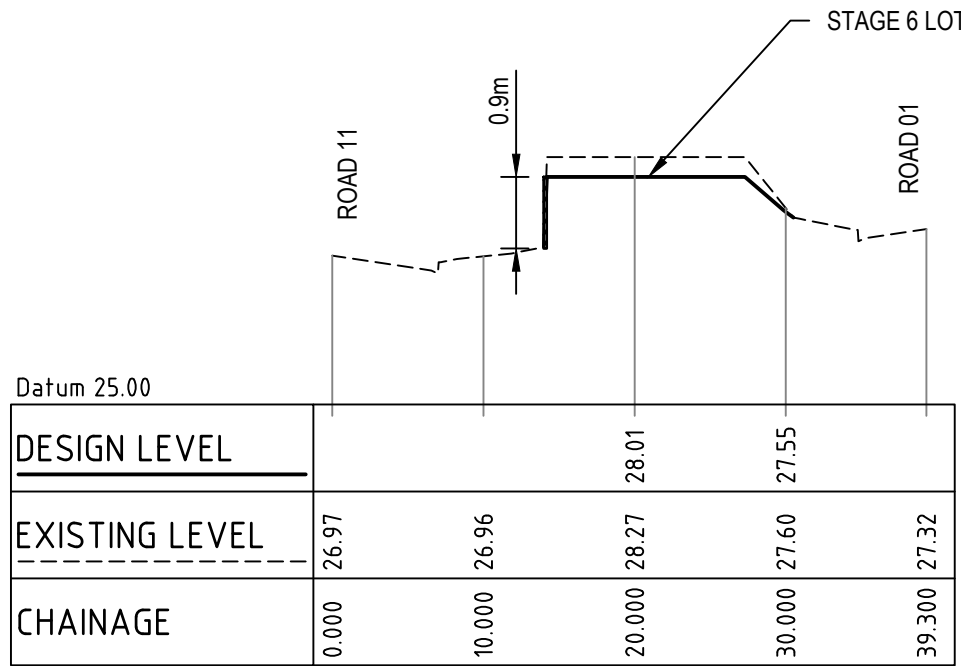

SECTION 6
SCALE 1:100V 1:500H

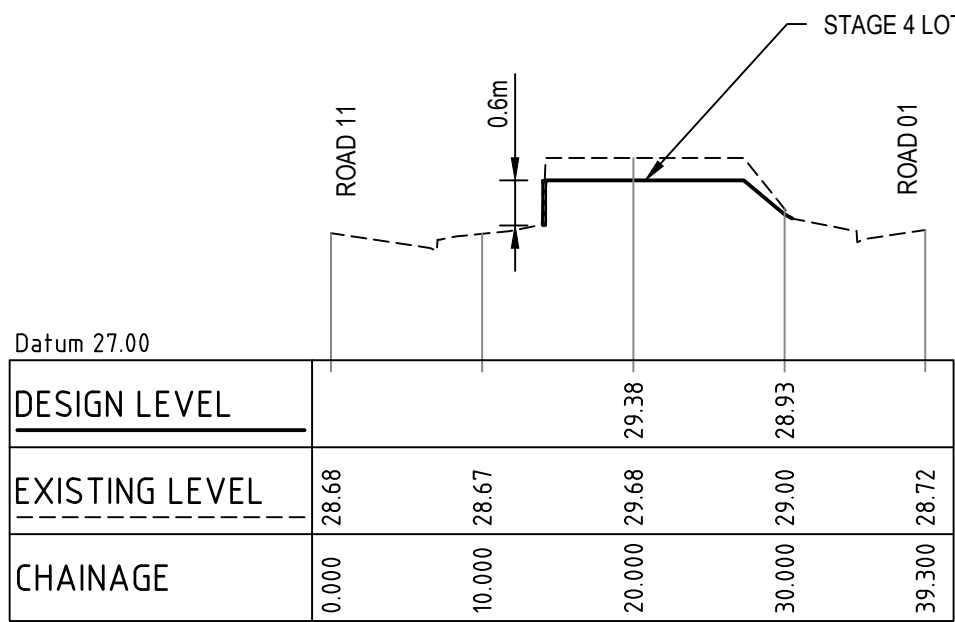

SECTION 5
SCALE 1:100V 1:500H

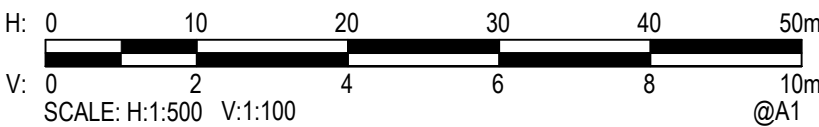

© Cardno Limited All Rights Reserved.
This document is produced by Cardno Limited solely for the benefit of and use by the client in accordance with the terms of the retainer. Cardno Limited does not and shall not assume any responsibility or liability whatsoever to any third party arising out of any use or reliance by third party on the content of this document.



Cardno (NSW/ACT) Pty Ltd | ABN 95 001 145 035
Level 9, The Forum, 203 Pacific Highway
St Leonards, NSW 2055
Tel: 02 9496 7700 Fax: 02 9439 5170
Web: www.cardno.com.au

Drawn HLD	Date 17/04/2020	Client LENLEASE COMMUNITIES
Checked PL	Date 17/04/2020	Project CHAPMAN STREET WERRINGTON
Designed HLD	Date 17/04/2020	CIVIL WORKS DEVELOPMENT APPLICATION
Verified PL	Date RIP	SITE SECTIONS SHEET 1 OF 2
Approved A/JG	Date RIP	

Status NOT TO BE USED FOR CONSTRUCTION PURPOSES	FOR APPROVAL
Datum A.H.D	Date Mar 2020
Scale AS SHOWN	Size A1
Drawing Number 80219053-DA004-SL-1151	Revision 1

1. REFER DRG. 1011 FOR NOTES AND LEGEND.
2. LOT RL. REFERS TO TOP OF COMPACTED MATERIAL AND ASSUMES SLAB THICKNESS OF 385mm.
3. SUBSOIL DRAINAGE LINES TO BE PROVIDED AS PER PENRITH CITY COUNCIL DESIGN GUIDELINES FOR ENGINEERING WORKS.

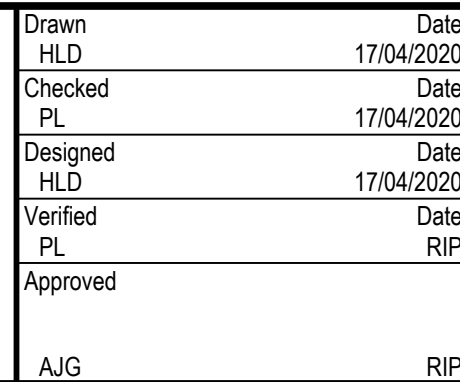
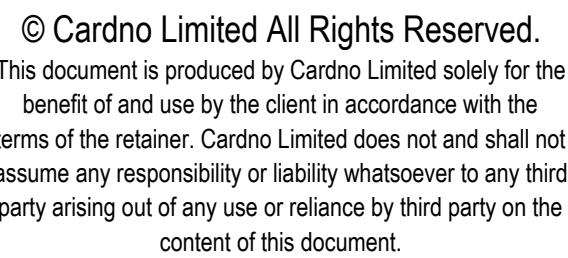

Status				<div style="text-align: center; color: red; font-weight: bold; font-size: 1.2em;">FOR APPROVAL</div> <div style="text-align: center; color: black; font-weight: bold;">NOT TO BE USED FOR CONSTRUCTION PURPOSES</div>			
Datum		Date					
A.H.D		Mar' 2020		1:200		A1	
Drawing Number						Revision	
80219053-DA004-SL-1301						1	

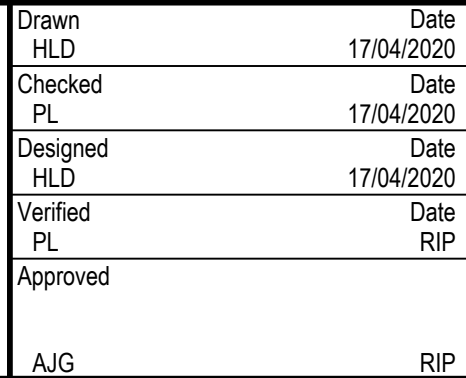
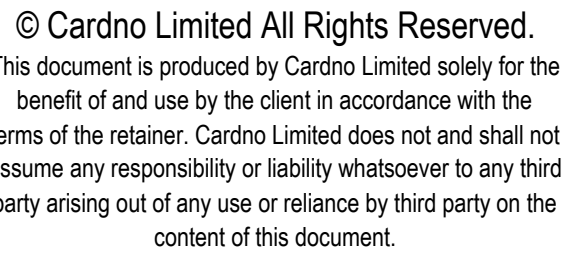
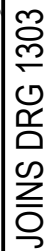

Status				FOR APPROVAL			
NOT TO BE USED FOR CONSTRUCTION PURPOSES							
Datum		Date		Scale		Size	
A.H.D		Mar' 2020		1:200		A1	
Drawing Number						Revision	
80219053-DA004-SL-1302						1	

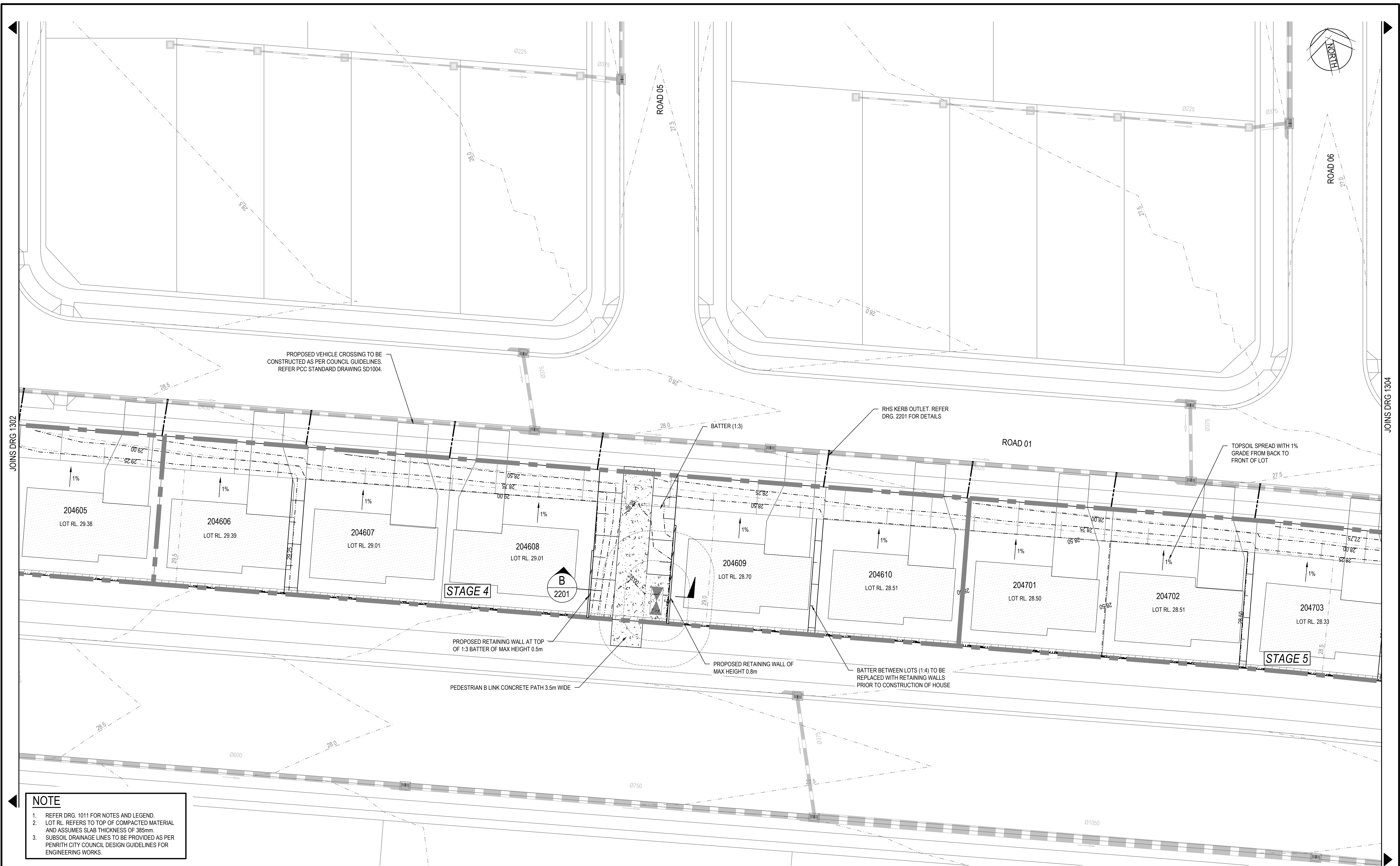
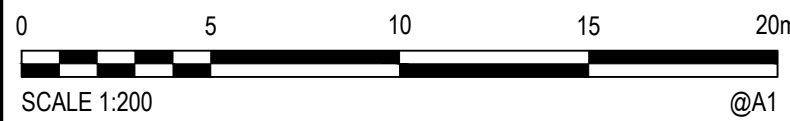
[illegible]

© Cardno Limited All Rights Reserved.
This document is produced by Cardno Limited solely for the benefit of and use by the client in accordance with the terms of the retainer. Cardno Limited does not and shall not assume any responsibility or liability whatsoever to any third party arising out of any use or reliance by third party on the content of this document.



Drawn	Date
HLD	17/04/2020
Checked	Date
PL	17/04/2020
Designed	Date
HLD	17/04/2020
Verified	Date
PL	RIP
Approved	
AJG	RIP

Client	LENDLEASE COMMUNITIES
Project	CHAPMAN STREET WERRINGTON CIVIL WORKS DEVELOPMENT APPLICATION
Title	SITWORKS AND STORMWATER PLAN SHEET 3 OF 4

Status				FOR APPROVAL			
NOT TO BE USED FOR CONSTRUCTION PURPOSES							
Datum		Date		Scale		Size	
A.H.D		Mar' 2020		1:200		A1	
Drawing Number						Revision	
80219053-DA004-SL-1303						1	

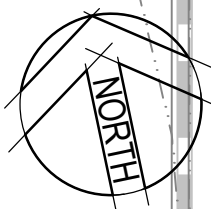

1. REFER DRG. 1011 FOR NOTES AND LEGEND.
2. LOT RL REFERS TO TOP OF COMPACTED MATERIAL AND ASSUMES SLAB THICKNESS OF 385mm.
3. SUBSOIL DRAINAGE LINES TO BE PROVIDED AS PER PENRITH CITY COUNCIL DESIGN GUIDELINES FOR ENGINEERING WORKS.

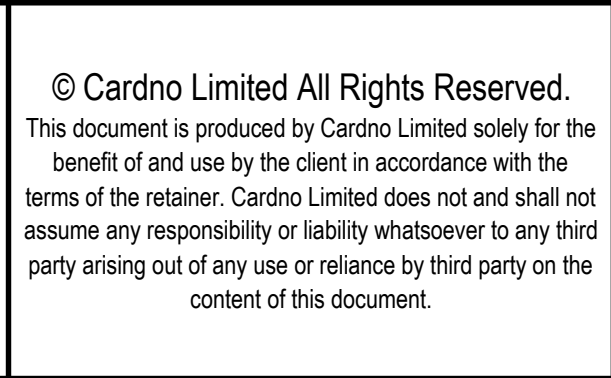
A hand-drawn sketch of a city block. The drawing shows several buildings of varying heights and widths, arranged along a street. A red square is drawn over one of the buildings, indicating a specific location. The drawing is simple, using black lines for outlines and red for the highlighted area.

Drawn	Date
HLD	17/04/2020
Checked	Date
PL	17/04/2020
Designed	Date
HLD	17/04/2020
Verified	Date
PL	RIP
Approved	
AJG	RIP

Status			
FOR APPROVAL			
NOT TO BE USED FOR CONSTRUCTION PURPOSES			
Date	Date	Scale	Size
A.H.D	Mar' 2020	1:200	A1
Drawing Number			Revision
80219053-DA004-SL-1304			1

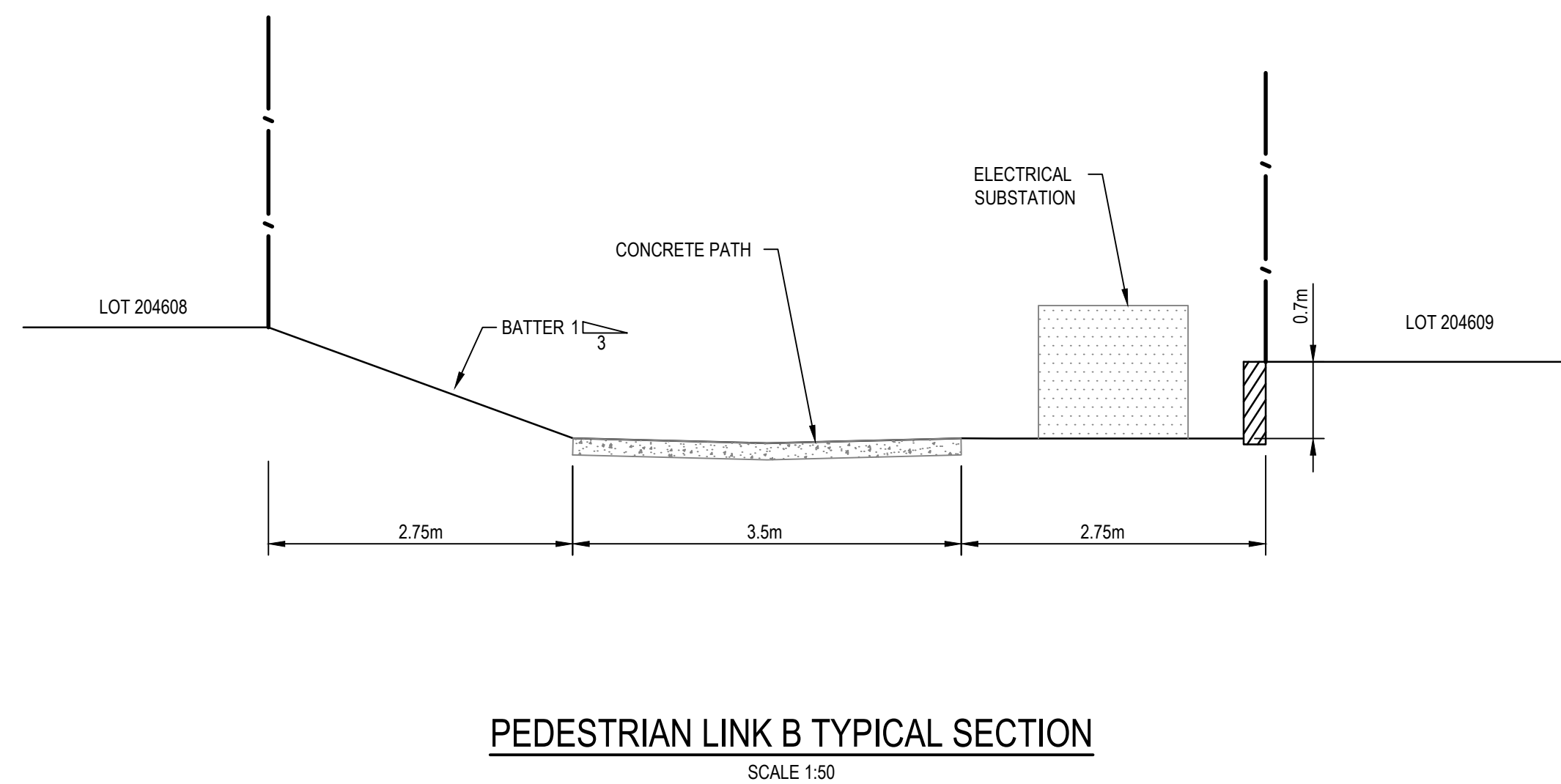
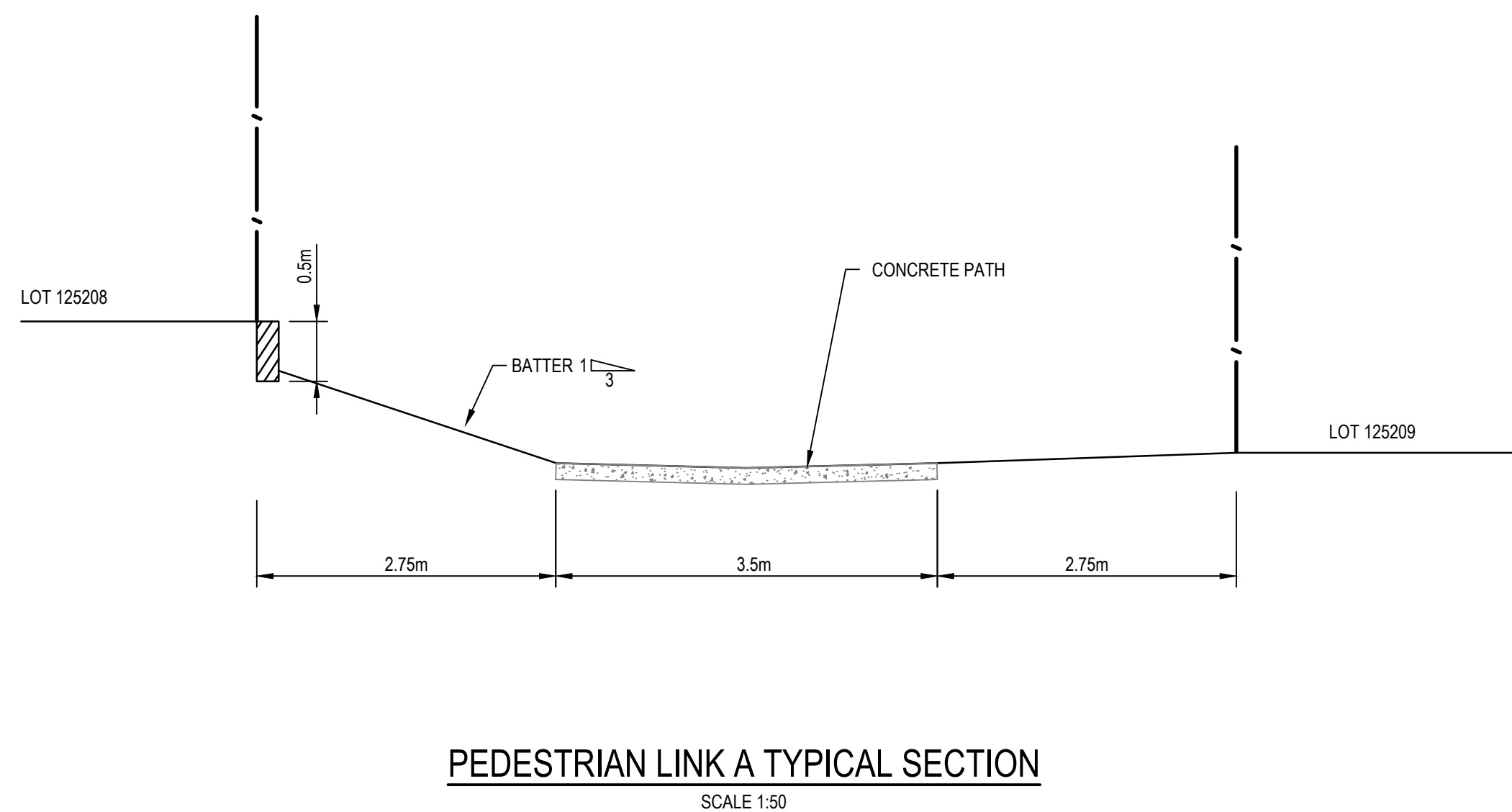
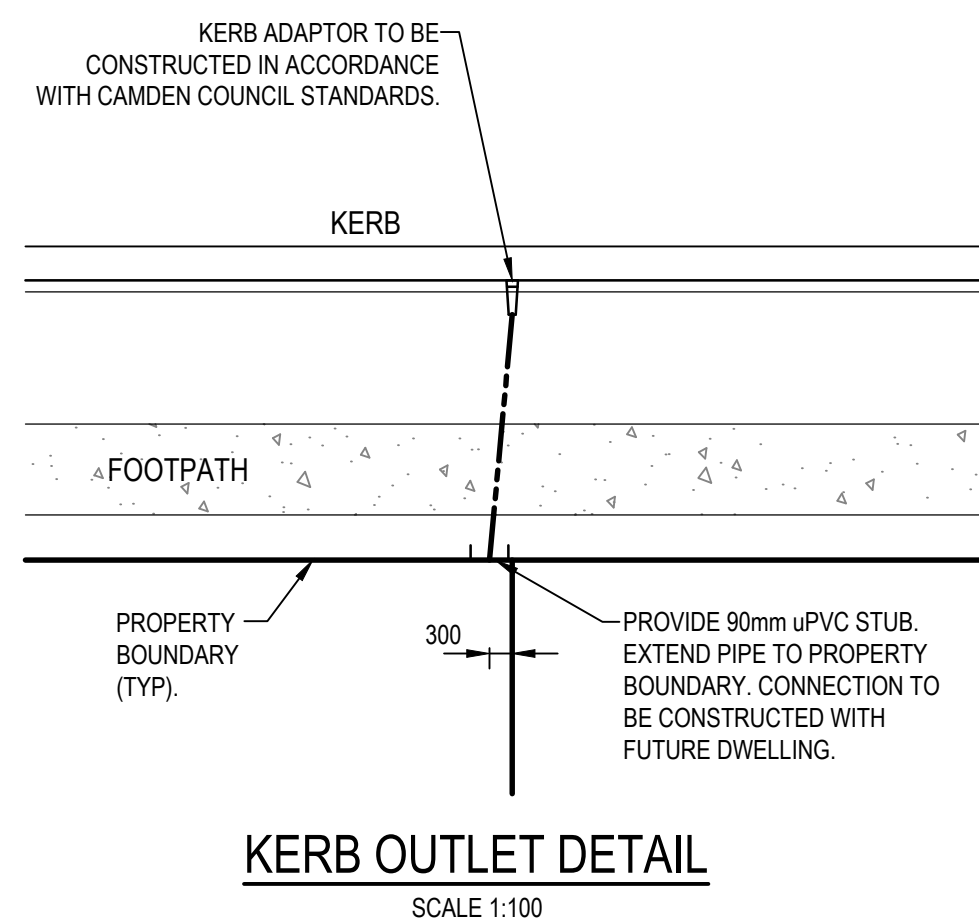
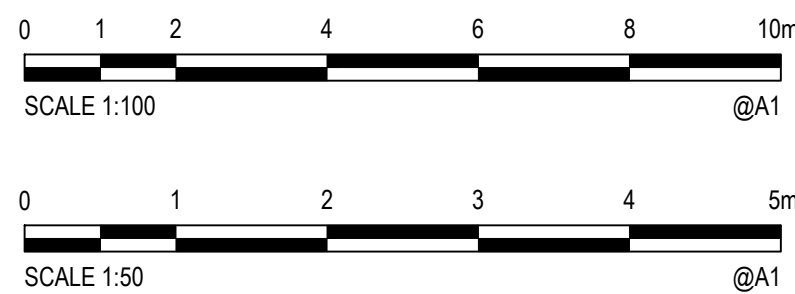
[illegible]

© Cardno Limited All Rights Reserved.
This document is produced by Cardno Limited solely for the benefit of and use by the client in accordance with the terms of the retainer. Cardno Limited does not and shall not assume any responsibility or liability whatsoever to any third party arising out of any use or reliance by third party on the content of this document.



Cardno (NSW/ACT) Pty Ltd | ABN 95 001 145 035
Level 9, The Forum, 203 Pacific Highway
St. Leonards, NSW 2065
Tel: 02 9496 7700 Fax: 02 9439 5170
Web: www.cardno.com.au

Drawn HLD	Date 17/04/2020	Client LENLEASE COMMUNITIES			
Checked PL	Date 17/04/2020	Project CHAPMAN STREET WERRINGTON CIVIL WORKS DEVELOPMENT APPLICATION	Status FOR APPROVAL		
Designed HLD	Date 17/04/2020		NOT TO BE USED FOR CONSTRUCTION PURPOSES		
Verified PL	Date RIP	Title SITeworks AND STORMWATER DETAILS	Datum A.H.D	Date Mar 2020	Scale AS SHOWN
Approved			Drawing Number 80219053-DA004-SL-2201		Size A1
A/JG	RIP				Revision 1