

UNDERGROUND SERVICES LEGEND

UNDERGROUND SEWER MAIN

UNDERGROUND WATER MAIN

UNDERGROUND GAS MAIN

UNDERGROUND TELSTRA COMMUNICATIONS CABLES

APPROXIMATE POSITION ONLY VIDE DIAL-BEFORE-YOU-DIG PLANS
JOB No. 7003558. WHERE CRITICAL TO DESIGN UNDERGROUND
SERVICES SHOULD BE LOCATED BY GROUND PENETRATING RADAR
PRIOR TO DESIGN OR EXCAVATION.

CAUTION: FIBRE OPTIC CABLES ARE PRESENT IN THIS AREA

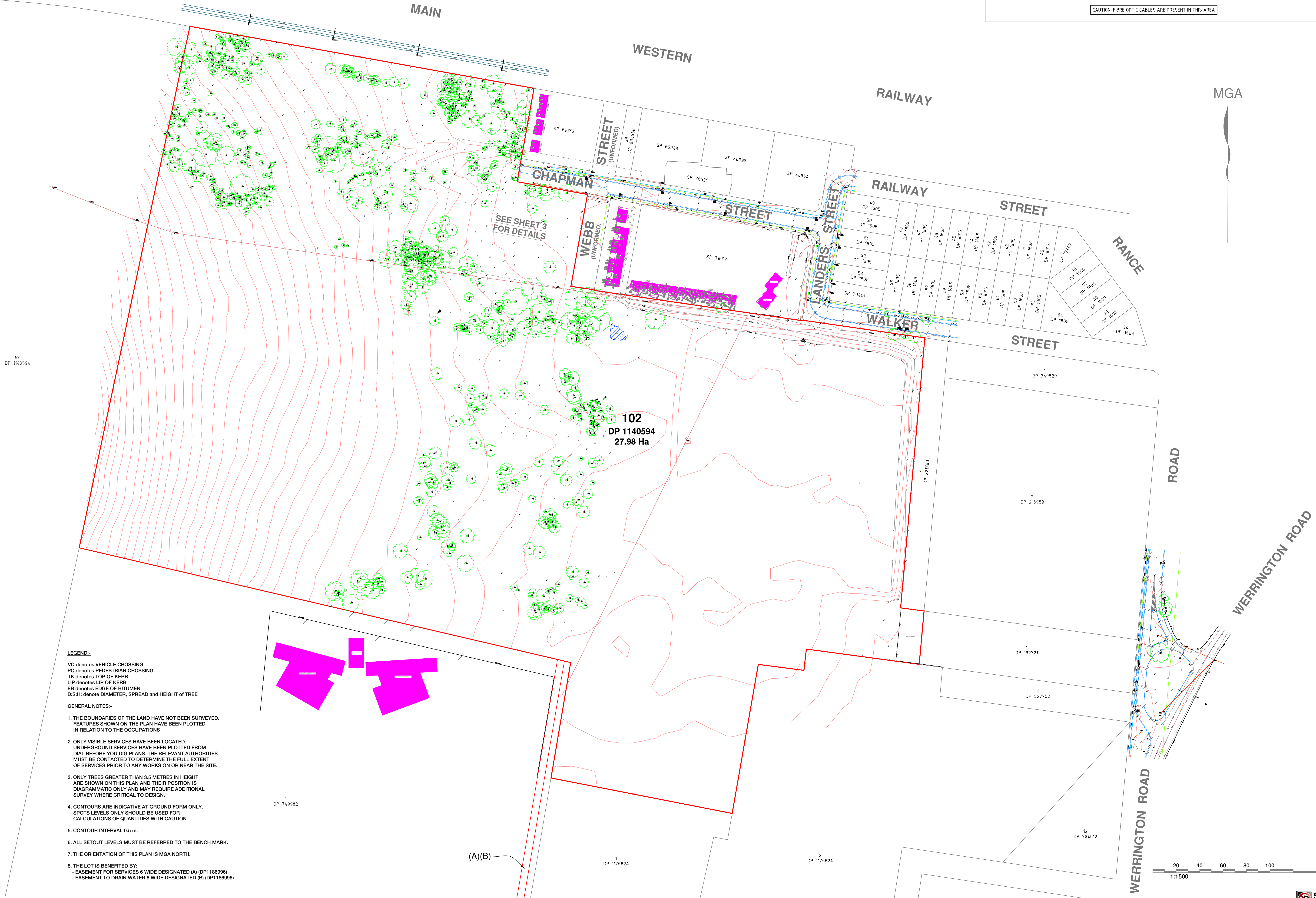

- LEGEND:-**
- VC denotes VEHICLE CROSSING
PC denotes PEDESTRIAN CROSSING
TK denotes TOP OF KERB
LIP denotes LIP OF KERB
EB denotes EDGE OF BITUMEN
D.S.H: denote DIAMETER, SPREAD AND HEIGHT of TREE
- GENERAL NOTES:-**
- THE BOUNDARIES OF THE LAND HAVE NOT BEEN SURVEYED. FEATURES SHOWN ON THE PLAN HAVE BEEN PLOTTED IN RELATION TO THE OCCUPATIONS
 - ONLY VISIBLE SERVICES HAVE BEEN LOCATED. UNDERGROUND SERVICES HAVE BEEN PLOTTED FROM DIAL BEFORE YOU DIG PLANS. THE RELEVANT AUTHORITIES MUST BE CONTACTED TO DETERMINE THE FULL EXTENT OF SERVICES PRIOR TO ANY WORKS ON OR NEAR THE SITE.
 - ONLY TREES GREATER THAN 3.5 METRES IN HEIGHT ARE SHOWN ON THIS PLAN AND THEIR POSITION IS DIAGRAMMATIC ONLY AND MAY REQUIRE ADDITIONAL SURVEY WHERE CRITICAL TO DESIGN.
 - CONTOURS ARE INDICATIVE AT GROUND FORM ONLY. SPOTS LEVELS ONLY SHOULD BE USED FOR CALCULATIONS OF QUANTITIES WITH CAUTION.
 - CONTOUR INTERVAL 0.5 m.
 - ALL SETOUT LEVELS MUST BE REFERRED TO THE BENCH MARK.
 - THE ORIENTATION OF THIS PLAN IS MGA NORTH.
 - THE LOT IS BENEFITED BY:
 - EASEMENT FOR SERVICES 6 WIDE DESIGNATED (A) (DP1186996)
 - EASEMENT TO DRAIN WATER 6 WIDE DESIGNATED (B) (DP1186996)

<div>©COPYRIGHT</div> <div>SDG is the owner of the copyright subsisting in these drawings, plans, designs and specifications. They must not be used, reproduced or copied in whole or in part without prior written consent of SDG</div>	ISSUE	DATE	AMENDMENT	ISSUE	DATE	AMENDMENT	CLIENT: <div>BATHLA INVESTMENTS PTY LTD</div>	SCALE 1:1500		REF.: 6050	PLAN A1 ISSUE D	DETAIL AND LEVEL SURVEY OF LOT 102 IN DP 1140594 16 CHAPMAN STREET WERRINGTON	<div><div>Unit 7 1B Kleins Road NORTHMEAD 2152 P.O.Box 2072 NORTH PARRAMATTA 1750 t: 02 9680 7855 e: office@sdg.net.au w: www.sdg.net.au</div><div>LAND DEVELOPMENT SOLUTIONS A.B.N. 85 513 523 821</div></div>
				A	01/01/14	PRELIMINARY ISSUE		ORIGIN OF LEVELS:	DATUM:	DATE: 07/02/2014			
				B	27/02/14	ORIGINAL ISSUE		PM13532	A.H.D.	SURV/CHK: EE/CT			
				C	15/05/14	AMMEND STREET NAME		RL 25.065					
				D	04/07/16	ADD ZOOMED IN AREA AS REQUESTED							

TREE TABLE			
Tag	Diam	Spread	Height
1	0.1	2	4
2	0.6	6	15
3	0.4	5	15
4	0.2	3	12
5	0.2	3	12
6	0.4	6	14
7	0.4	4	13
8	0.2	3	7
9	0.4	6	15
10	0.2	3	3
10	0.3	3	15
11	0.1	3	6
12	0.1	3	8
13	0.3	4	14
14	0.2	5	9
15	0.2	4	12
16	0.3	5	14
17	0.1	2	5
18	0.1	1	5
19	0.1	3	7
20	0.2	3	11
21	0.4	6	14
23	0.3	5	14
24	0.3	5	14
25	0.4	7	15
26	0.2	3	10
27	0.3	5	13
28	0.2	2	6
29	0.3	8	13
30	0.4	7	12
31	0.3	4	13
32	0.4	9	15
33	0.3	5	14
34	0.2	2	6
35	0.3	4	12
36	0.5	9	16
37	0.4	6	14
38	0.3	3	14
39	0.3	3	10
40	0.5	8	15
41	0.3	6	11
42	0.2	3	8
43	0.2	3	9
44	0.2	3	9
45	0.4	6	15
46	0.4	6	15
47	0.3	5	14
48	0.4	6	14
49	0.2	4	14
50	0.2	4	14
51	0.2	4	14
52	0.3	6	13
53	0.2	6	10
54	0.3	5	13
55	0.6	14	16
56	0.5	12	16
57	0.2	3	7
58	0.2	3	9
59	0.1	3	7
60	0.2	3	9
61	0.2	3	9
62	0.1	2	5
63	0.4	4	12
64	0.2	3	8
65	0.2	4	9
66	0.5	10	12
67	0.2	3	9
68	0.5	4	14
69	0.6	18	17
70	0.1	4	6
71	0.7	12	18
72	0.8	14	18
73	0.1	3	5
74	0.1	3	5
75	0.1	3	7
76	0.1	3	7
77	0.2	5	8
78	0.2	3	6
79	0.2	3	6
80	0.5	9	20
81	0.8	15	20
82	0.1	2	3
83	0.3	2	10
84	0.2	2	10
85	0.3	3	12
86	0.3	2	10
87	0.2	3	3
89	0.1	2	6
90	0.1	2	5
91	0.1	3	10
92	0.7	15	20
93	0.2	5	8
94	0.2	9	10
95	0.1	3	6
96	0.3	5	18
97	0.4	7	20
98	0.4	7	20
101	0.5	14	12
102	0.3	8	10
103	0.8	14	15
104	0.1	3	6
105	0.3	6	10
106	0.6	14	15
107	0.2	5	10

TREE TABLE			
Tag	Diam	Spread	Height
108	0.2	4	4
109	0.4	14	15
110	0.2	4	8
111	0.2	4	6
112	0.7	16	20
113	1	18	20
114	0.3	10	12
115	0.2	5	9
116	0.2	4	8
117	1	18	18
118	0.3	7	12
119	0.2	3	7
120	0.6	18	20
121	0.9	18	15
122	0.9	18	18
123	0.4	10	14
124	0.3	4	10
125	0.3	6	10
126	0.4	10	14
127	0.3	12	12
128	0.2	4	8
129	0.2	4	8
130	1	14	20
131	0.2	5	8
132	0.2	2	12
133	0.2	6	6
134	0.2	4	8
135	0.3	8	15
136	0.1	3	4
137	0.2	2	10
138	0.2	4	6
139	0.7	10	15
140	0.9	16	20
141	0.6	16	25
142	0.1	4	8
143	0.7	12	25
144	0.3	5	10
145	0.2	6	10
146	0.2	4	6
147	0.6	14	20
148	0.2	5	8
149	0.2	4	6
150	0.3	8	8
151	0.2	4	12
152	0.4	6	8
153	0.3	5	15
154	0.4	8	18
155	0.6	14	22
156	0.6	10	12
157	1.3	22	25
158	0.8	14	14
159	0.4	10	25
160	0.3	8	10
161	0.1	2	4
162	0.3	6	12
163	0.3	5	20
164	0.3	8	12
165	0.3	6	12
166	0.9	14	25
167	0.3	6	15
168	0.2	3	3
169	0.3	6	10
170	0.8	15	18
171	0.3	2	15
172	0.3	4	15
173	0.3	4	12
174	0.4	6	15
175	0.2	3	12
179	0.4	4	8
181	0.3	12	15
183	0.3	2	8
184	0.3	6	18
185	0.2	6	10
186	0.2	6	8
226	0.2	6	8
227	0.5	10	20
228	0.2	4	16
229	0.3	6	20
230	0.1	3	9
231	0.4	7	21
232	0.2	5	15
233	0.1	3	8
234	0.3	8	20
235	0.1	2	10
236	0.3	8	18
237	0.3	7	18
238	0.3	3	20
239	0.2	2	8
240	0.1	2	3
241	0.4	9	20
242	0.5	12	22
243	0.1	4	6
244	0.2	4	6
245	0.1	3	6
246	0.4	10	15
247	0.2	6	12
248	0.6	9	22
249	0.5	8	18
250	0.3	4	15
251	0.3	5	16
252	0.1	2	8
253	0.1	2	8
254	0.2	3	12
255	0.2	5	15

TREE TABLE			
Tag	Diam	Spread	Height
256	0.2	6	6
257	0.4	9	12
258	0.3	8	12
259	0.5	6	12
260	0.3	8	12
261	0.3	7	12
262	0.2	6	7
263	0.3	7	10
264	0.3	7	8
265	0.1	4	6
266	0.4	8	15
267	0.3	8	15
268	0.2	8	15
269	0.1	5	7
270	0.3	9	15
271	0.3	9	15
272	0.1	3	4
273	0.3	7	20
274	0.3	8	12
275	0.3	9	15
276	0.3	7	20
277	0.1	3	8
278	0.1	3	12
279	0.3	8	20
280	0.1	2	15
281	0.2	3	15
282	0.1	4	8
283	0.3	5	20
284	0.1	2	8
285	0.3	5	12
286	0.3	5	15
287	0.2	9	10
400	0.4	7	14
401	0.3	5	12
402	0.1	3	6
403	0.2	4	10
404	0.4	4	10
405	0.6	8	12
406	0.5	10	12
407	0.6	8	10
408	0.2	4	8
409	0.2	3	7
410	0.3	5	8
411	0.3	6	10
412	0.4	6	12
413	0.3	7	10
414	0.3	6	12
415	0.3	6	12
416	0.3	5	11
417	0.3	5	11
418	0.2	4	11
419	0.3	4	11
420	0.4	8	12
421	0.7	12	15
422	0.2	4	7
423	0.3	6	8
424	0.2	5	8
425	0.2	4	8
426	0.4	9	12
427	0.2	3	8
428	0.2	3	8
429	0.1	2	6
430	0.1	4	6
431	0.2	4	10
432	0.2	4	6
433	0.2	4	10
434	0.3	5	12
435	0.3	7	12
436	0.2	4	8
437	0.2	4	8
439	0.2	2	8
440	0.2	2	8
441	0.3	4	9
442	0.3	4	8
443	0.4	4	10
444	0.3	4	7
445	0.2	4	6
448	0.2	4	6
449	0.6	10	15
450	0.3	3	8
451	0.3	3	8
452	0.3	3	8
454	0.3	3	10
455	0.2	3	8
456	0.2	2	6
457	0.6	6	12
458	0.3	2	6
460	0.2	2	10
461	0.2	2	10
462	0.4	5	15
463	0.3	3	8
464	0.3	4	8
465	0.3	3	8
466	0.2	3	8
467	0.4	5	10
468	0.3	3	5
470	0.4	6	10
471	0.4	4	10
472	0.2	3	10
473	0.3	4	10
474	0.3	4	10
475	0.3	4	8
476	0.3	4	8
477	0.2	3	6

TREE TABLE			
Tag	Diam	Spread	Height
478	0.2	3	6
479	0.4	4	10
481	0.2	4	8
482	0.3	3	8
483	0.3	4	10
484	0.2	3	8
485	0.3	4	10
486	0.3	4	8
487	0.2	3	8
488	0.7	15	18
489	0.5	10	15
490	0.8	15	20
491	0.6	10	15
492	0.9	15	20
493	0.2	3	8
494	0.3	4	10
495	0.2	2	9
496	0.2	2	9
497	0.3	6	10
498	0.1	2	9
499	0.2	4	10
500	0.2	4	10
501	0.2	5	10
502	0.2	4	10
503	0.8	10	16
504	0.2	4	8
505	0.2	5	10
506	0.2	5	10
507	0.3	4	10
508	0.3	7	8
509	0.1	4	6
510	0.2	2	6
511	0.1	4	8
512	0.2	5	10
513	0.2	5	10
514	0.2	5	10
515	0.2	5	10
516	0.2	5	10
517	0.2	5	10
518	0.3	6	10
519	0.3	6	10
520	0.3	4	8
521	0.5	6	12
522	0.4	6	12
523	0.3	4	8
524	0.2	6	9
525	0.6	12	15
526	0.4	10	12
527	0.5	10	14
528	0.5	12	15
529	0.4	8	15
530	1.4	15	15
531	0.4	12	15
532	0.2	5	8
533	0.2	5	8
534	0.2	5	8
560	0.1	2	8
561	0.3	3	7
700	0.1	2	10
701	0.3	5	11
702	0.3	4	10
703	0.2	4	8
704	0.3	5	9
705	0.3	5	9
706	0.2	4	8
707	0.6	10	18
708	0.3	3	12
709	0.2	3	5
710	0.3	4	12
711	0.2	4	10
712	0.1	3	6
713	0.3	7	15
714	0.4	6	18
715	0.2	5	8
716	0.2	2	10
717	0.2	4	10
718	0.2	2	14
719	0.2	2	6
720	0.2	4	15
721	0.2	4	12
722	0.3	4	18
723	0.2	2	12
724	0.2	2	10
725	0.2	2	10
726	0.2	4	15
727	0.3	5	15
728	0.2	3	10
729	0.2	3	10
730	0.2	3	10
731	0.2	3	9
732	0.2	3	9
733	0.2	3	9
734	0.2	5	16
735	0.2	5	16
736	0.2	5	16
737	0.7	20	20
738	0.2	2	15
739	0.3	5	15
740	0.2	3	8
741	0.3	5	15
742	0.3	6	15
743	0.2	5	14
744	0.3	4	14
745	0.3	4	14