

16 CHAPMAN STREET, WERRINGTON
LANDSCAPE CONCEPT & STREET TREE MASTERPLAN

LANDSCAPE DEVELOPMENT APPLICATION

JULY 2020

REVISION 03

- Legend
- ① Eastern Park
 - ② Central Park
 - ③ VMP Area for Protection and Rehabilitation
 - ④ E2 Zone For Protection and Rehabilitation
 - ⑤ Pedestrian Through Site Link

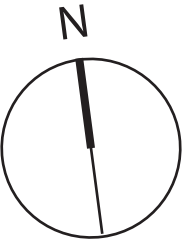

Landscape Circulation Legend

- Shareways
- Through Site Links
- Street Verges
- RFS Access
- Maintenance Access
- Proposed Bush Track
- Connection to Future Residential Lots

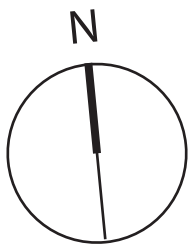

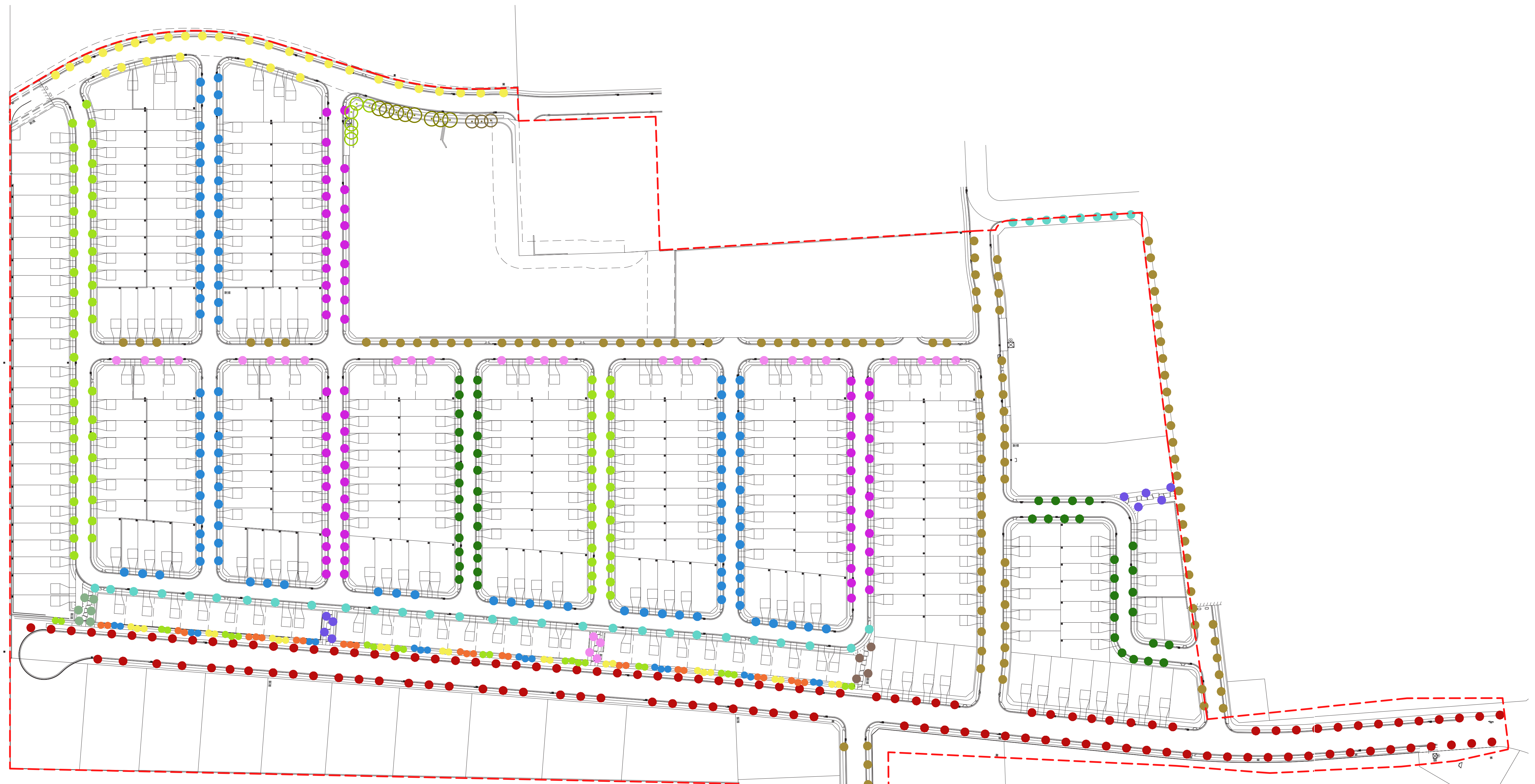

LEGEND

STREET TREES LEGEND

- E. sideroxylon rosea*
- Melaleuca linariifolia* 'Snow in Summer'
- Waterhousea floribunda* 'Green Avenue'
- Pyrus calleryana* 'Chanticlear'
- Tristaniopsis laurina* 'Luscious'

- Fraxinus pennsylvanica* 'Urbell' Urbanite
- Lophostemon confertus*
- Cupaniopsis anacardioides*
- East West Collector Road Options
 - *Liquidambar styraciflua*
 - *Jacaranda mimosifolia*
 - *Liriodendron tulipifera*

LANDSCAPE BUFFER ZONE

- E. sideroxylon rosea*
- Melaleuca linariifolia* 'Snow in Summer'
- Tristaniopsis laurina* 'Luscious'
- Callistemon viminalis*

TRANSITION PLANTING

- Eucalyptus tereticornis*
- Eucalyptus crebra*
- Eucalyptus moluccana*

PEDESTRIAN THROUGH SITE LINK

- Lagerstroemia indica x fauriei* 'Natchez'
- Fraxinus pennsylvanica* 'Urbell'
- Lagerstroemia indica x fauriei* 'Sioux'
- Ulmus parvifolia* 'Todd'

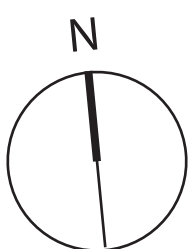

DATE	PROJECT NO.	REVISION	DWG NO.
22/07/2020	2519036	03	SK-4

0 10 20 30 40 50M

SCALE 1:1250 @ A1

BOTANICAL NAME	COMMON NAME	HEIGHT	SPACING	SIZE
STREET TREES				
<i>Lophostemon confertus</i>	Brushbox	7m	As Shown	100L
<i>Melaleuca linariifolia</i> ‘Snow in summer’	Snow in summer	10m	As Shown	100L
<i>Eucalyptus sideroxylon rosea</i>	Red Ironbark	15m	As Shown	100L
<i>Pyrus calleryana</i>	Callery Pear	11m	As Shown	100L
<i>Waterhousia floribunda</i> ‘Green avenue’	Weeping Lily Pilly	7m	As Shown	100L
<i>Fraxinus pennsylvanica</i> ‘Urbdel’	Urbanite Ash	11m	As Shown	100L
<i>Tristaniopsis laurina</i> ‘Luscious’	Kanooka Gum	8m	As Shown	100L
<i>Cupaniopsis anacardioides</i>	Tuckeroo	8m	As Shown	100L
<i>Liquidambar styraciflua</i>	American Sweetgum	15m	As Shown	100L
<i>Jacaranda mimosifolia</i>	Jacaranda	10m	As Shown	100L
<i>Liriodendron tulipifera</i>	Tulip Tree	20m	As Shown	100L
LANDSCAPE BUFFER ZONE				
<i>Melaleuca linariifolia</i>	Snow in Summer	3m	As Shown	200-400L*
<i>Tristaniopsis laurina</i> ‘Luscious’	Kanooka Gum	8m	As Shown	200-400L*
<i>Callistemon viminalis</i>	Weeping bottlebrush	8m	As Shown	200-400L*
<i>Eucalyptus sideroxylon rosea</i>	Red Flowering Ironbark	15m	As Shown	200-400L*
PEDESTRIAN THROUGH SITE LINK				
<i>Lagerstroemia indica x fauriei</i> ‘Natchez’	Crepe Myrtle (White)	6m	As Shown	100L
<i>Lagerstroemia indica x fauriei</i> ‘Sioux’	Crepe Myrtle (Hot musk pink)	5m	As Shown	100L
<i>Fraxinus pennsylvanica</i> ‘Urbdel’	Urbanite Ash	13m	As Shown	100L
<i>Ulmus parvifolia</i> ‘Todd’	Chinese Elm	10m	As Shown	100L
TRANSITION PLANTING				
<i>Eucalyptus tereticornis</i>	Forest Red Gum	30m	As Shown	100L
<i>Eucalyptus crebra</i>	Narrow leaved ironbark	35m	As Shown	100L
<i>Eucalyptus moluccana</i>	Grey Box	25m	As Shown	100L

*50L trees will be procured and grown inground in a secure location onsite or at a nursery. Trees will be maintained for the duration and removed from the ground to be planted where specified at a size between 200-400L.

STREET TREES



Melaleuca linariifolia 'Snow in summer'



Lophostemon confertus



Tristaniopsis laurina 'Luscious'



E. sideroxylon rosea



Fraxinus pennsylvanica 'Urbell' Urbanite



Ulmus parvifolia 'Todd'



Waterhousea floribunda 'Green Avenue'



Cupaniopsis anacardioides



Pyrus calleryana



Liquidambar styraciflua



Jacaranda mimosifolia



Liquidambar styraciflua

LANDSCAPE BUFFER ZONE TREE PLANTING ALONG EAST-WEST



Melaleuca linariifolia 'Snow in summer'



Tristaniopsis laurina 'Luscious'



Callistemon viminalis



E. sideroxylon rosea

PEDESTRIAN THROUGH SITE LINK



Lagerstroemia indica x fauriei 'Sioux'



Lagerstroemia indica x fauriei 'Natchez'



Ulmus parvifolia 'Todd'



Fraxinus pennsylvanica 'Urbell'

TRANSITION PLATING



Eucalyptus tereticornis



Eucalyptus crebra



Eucalyptus moluccana



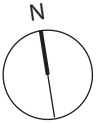
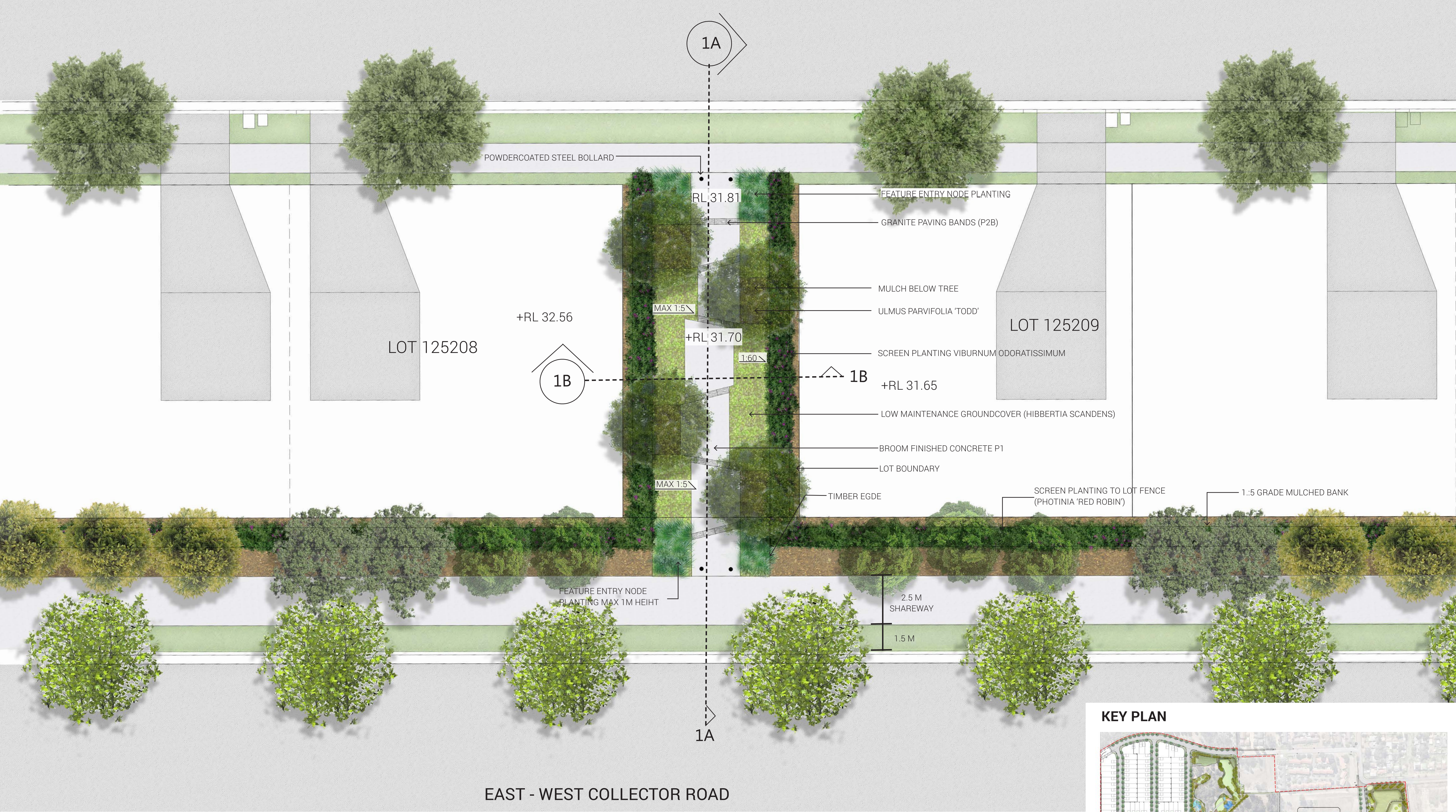

DATE	PROJECT NO.	REVISION	DWG NO.
22/07/2020	2519036	03	SK-8

0 1 2 3 4 5M/ 1:100@A1



SECTION 1A

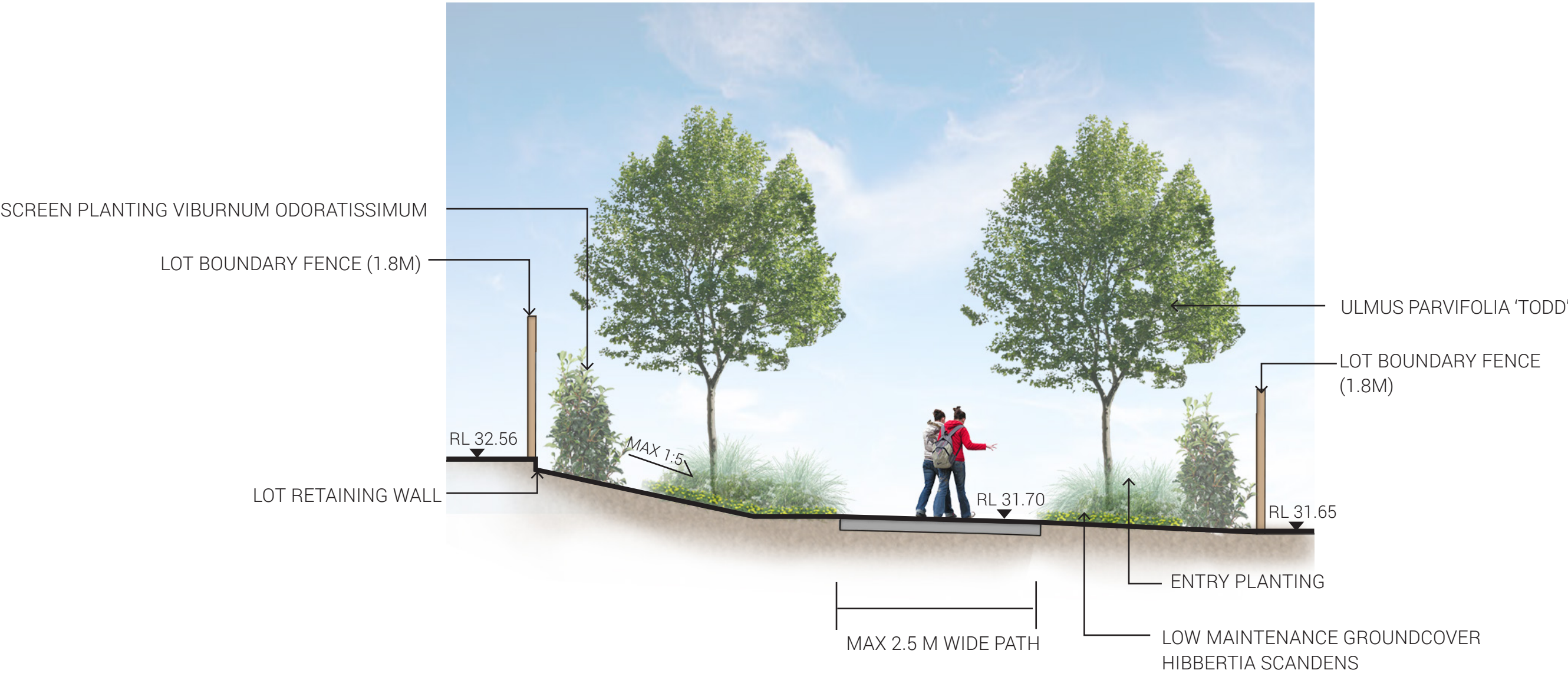

SECTION 1B

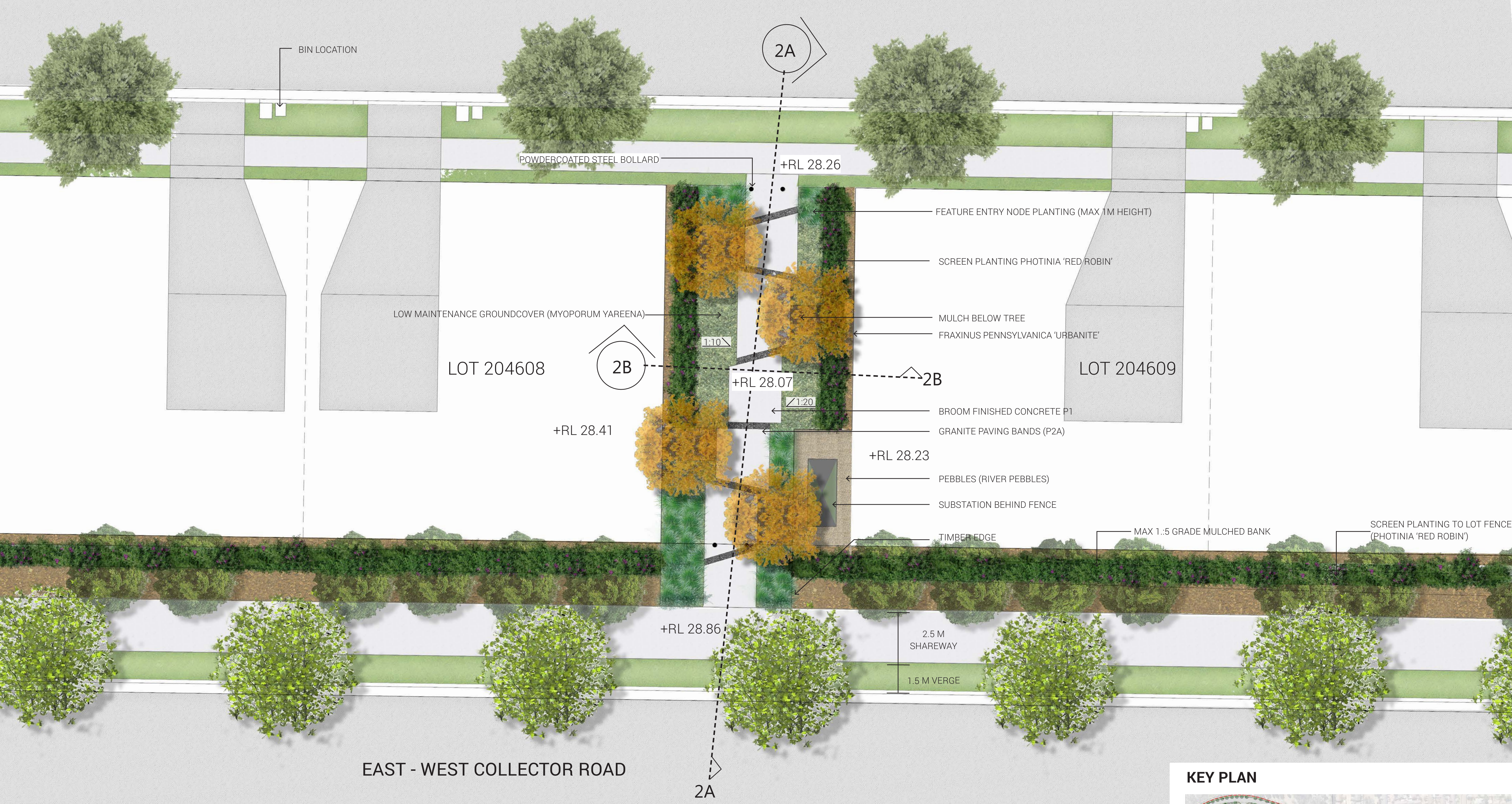

KEY PLAN

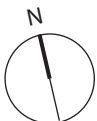

DATE	PROJECT NO.	REVISION	DWG NO.
22/07/2020	2519036	03	SK-10

0 1 2 3 4 5M/ 1:100@A1

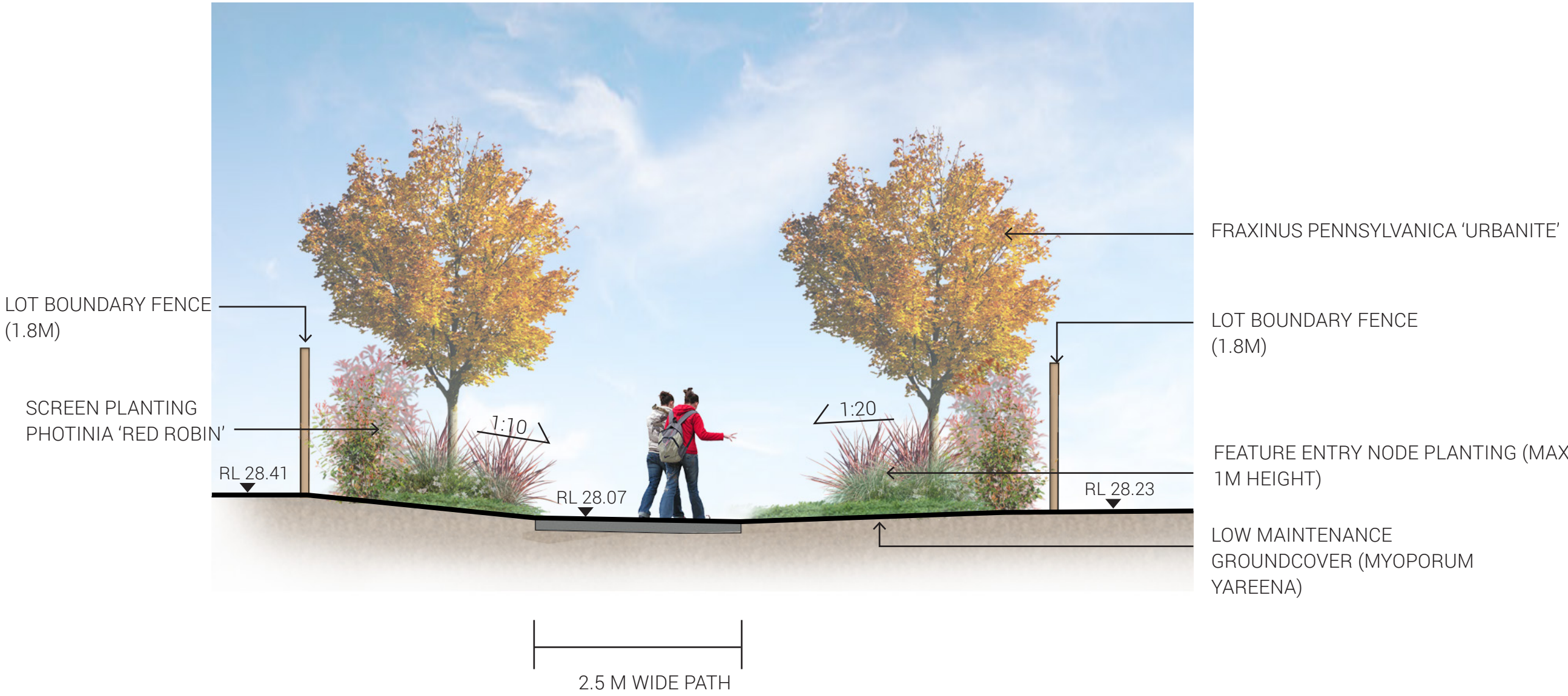

ENTRY MASS PLANTING BEDS



Lomandra longifolia 'Tanika'
Tanika



Westringia fruticosa 'Zena'
Coastal Rosemary



Phormium tenax 'Bronze Baby'
New Zealand Flax



Hardenbergia violacea 'Meema'
Purple coral pea

LOW MAINTENANCE GROUNDCOVERS



Myoporum Yareena
Yareena



Hibbertia scandens
Golden guinea vine

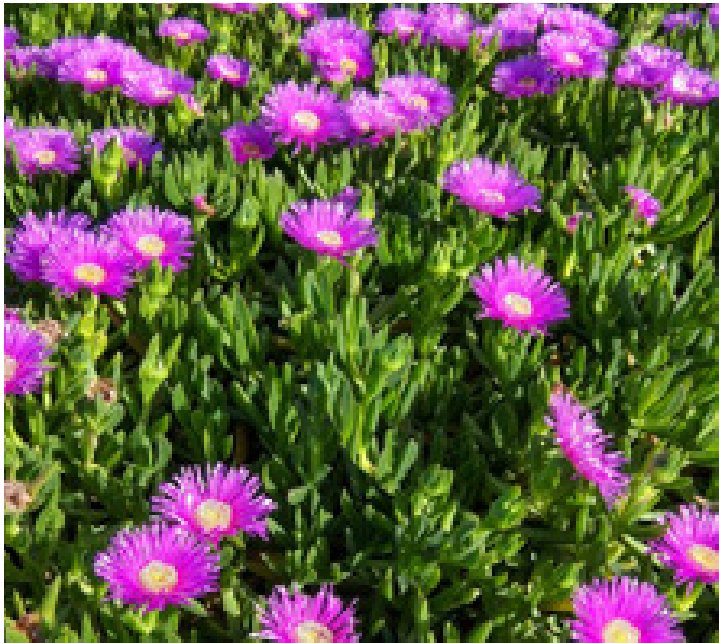

Carpobrotus rossii
Australian Pig Face



Billardiera scandens
Apple Berry

SCREEN HEDGING







Viburnum odoratissimum
sweet viburnum

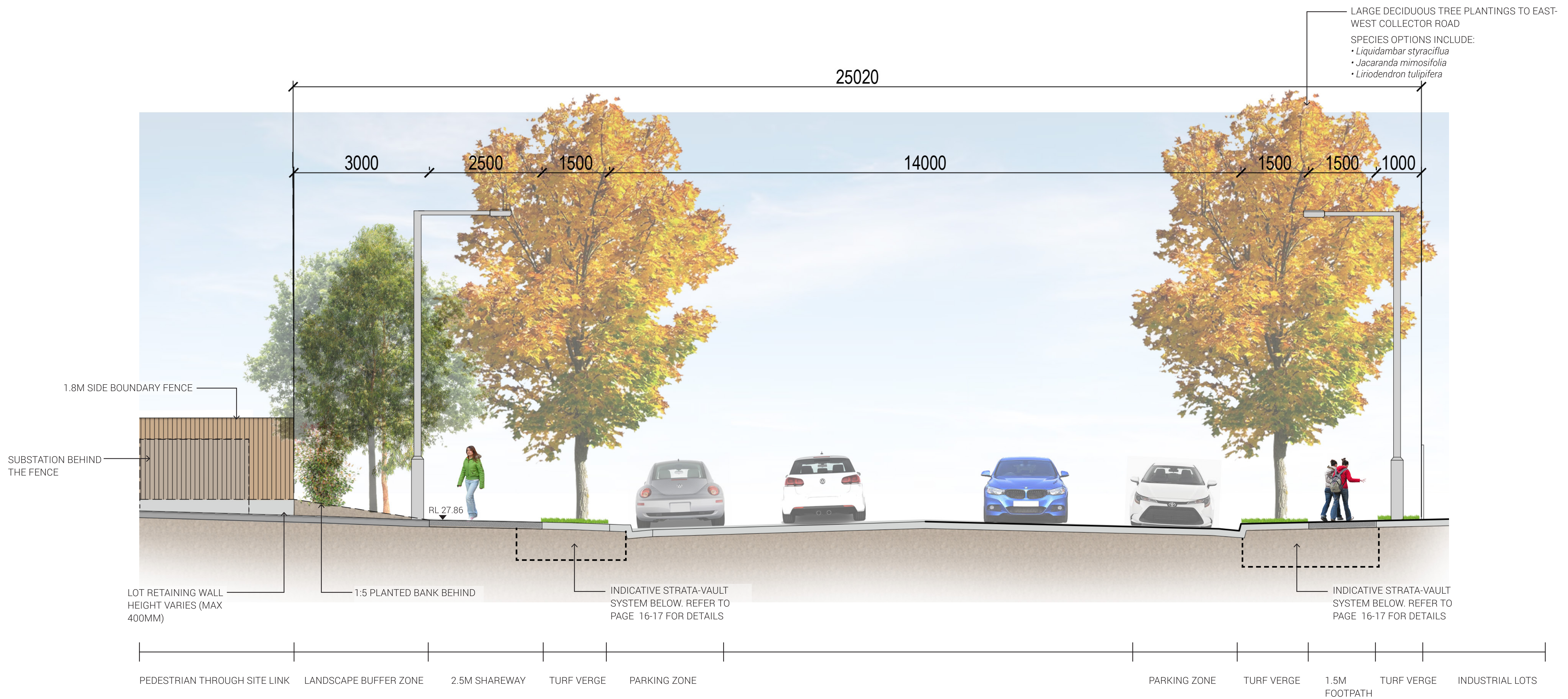

Photinia Red Robin
Red Tip Photinia



DESCRIPTION	DIMENSIONS	SPECIFICATION	IMAGE
FIXTURES AND BOLLARDS			
Steel Removable Bollard	H: 900mm	Description: Removable Bollard Finish: Powdercoated galvanised steel pipe Colour: Black Fixing: Sub-surface fixed as per manufacturers recommendations	
WALLS AND EDGES			
Timber Edge	W: 100mm H: 38mm	Description: Hardwood timber edge Size: 100 x 38mm Material: Hardwood timber Finish: Sealed and stained Staking: 75 x 25 x 300mm hardwood timber stakes screw fixed 20mm below top of finished level. Space stakes at 1500mm maximum centres and at 100mm from end of edging board	
PAVEMENTS AND SURFACES			
Concrete Pavement (P1)	W: 1500, 1800, 2500mm T: Min 125mm	Description: Standard Concrete Pavement. 2.5m wide shared path - 25MPa reinforced concrete; formwork; 1 layer of mesh reinforcement. Expansion joints @ 6m centres - Connolly joints to be used. Finish: Sandblasted; expansion joints @ 6m centres - Connolly joints to be used. 125mm thick with SL82 mesh	
Granite Paving Banding P2A	W:300mm L: 600mm T: 30mm	Description: Granite pavement banding Finish: Exfoliated finish Colour: P2A Buffalo	
Granite Paving Banding P2B	W:300mm L: 600mm T: 30mm	Description: Granite pavement banding Finish: Exfoliated finish Colour: P2B Fallow	

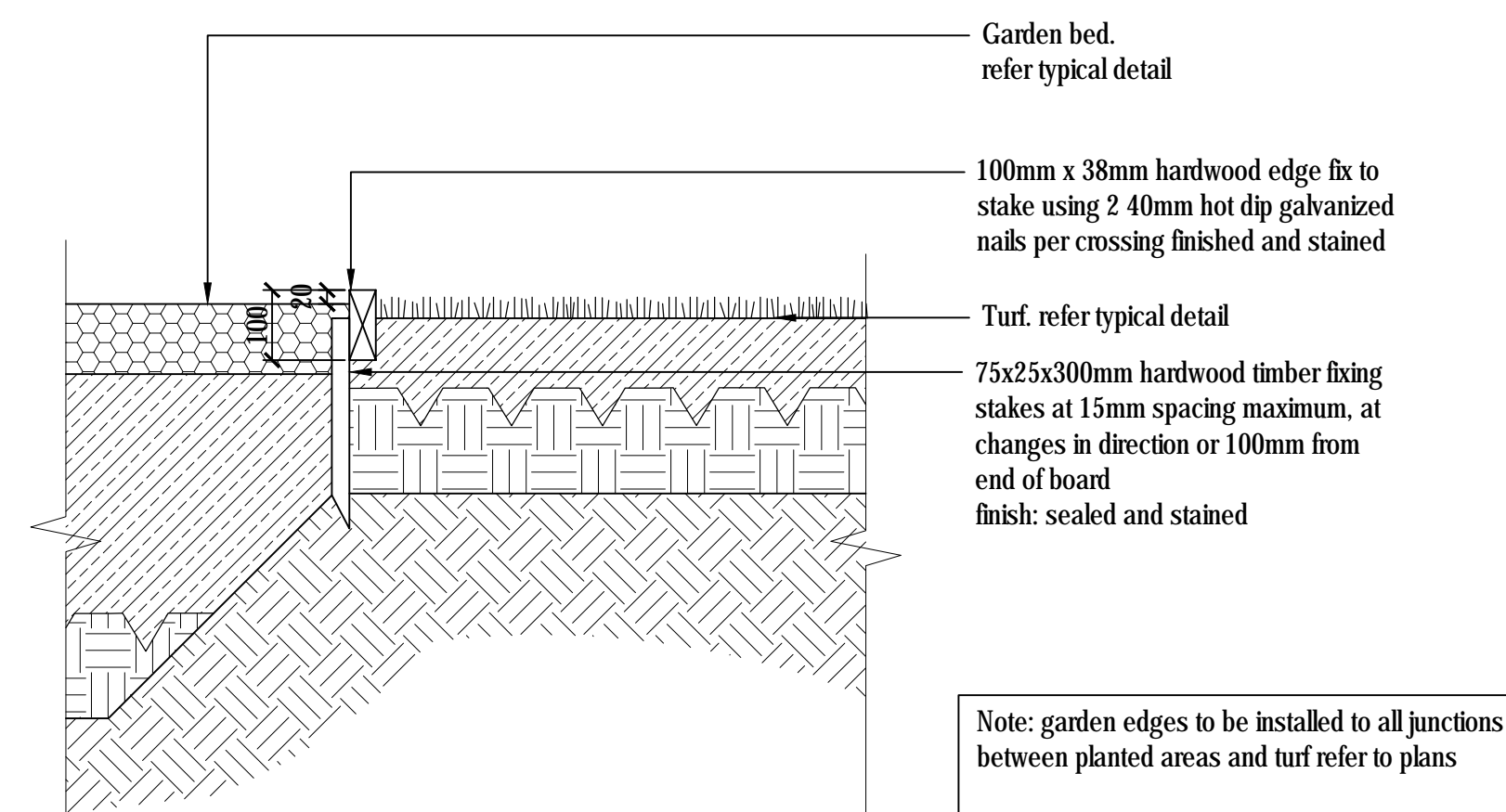
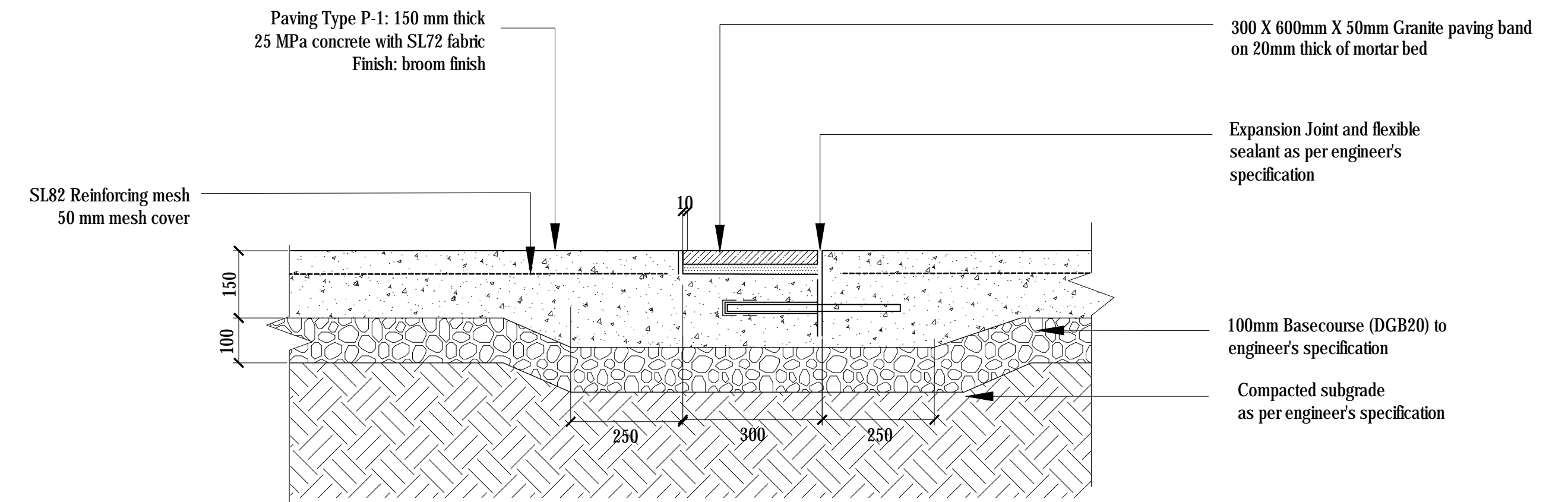
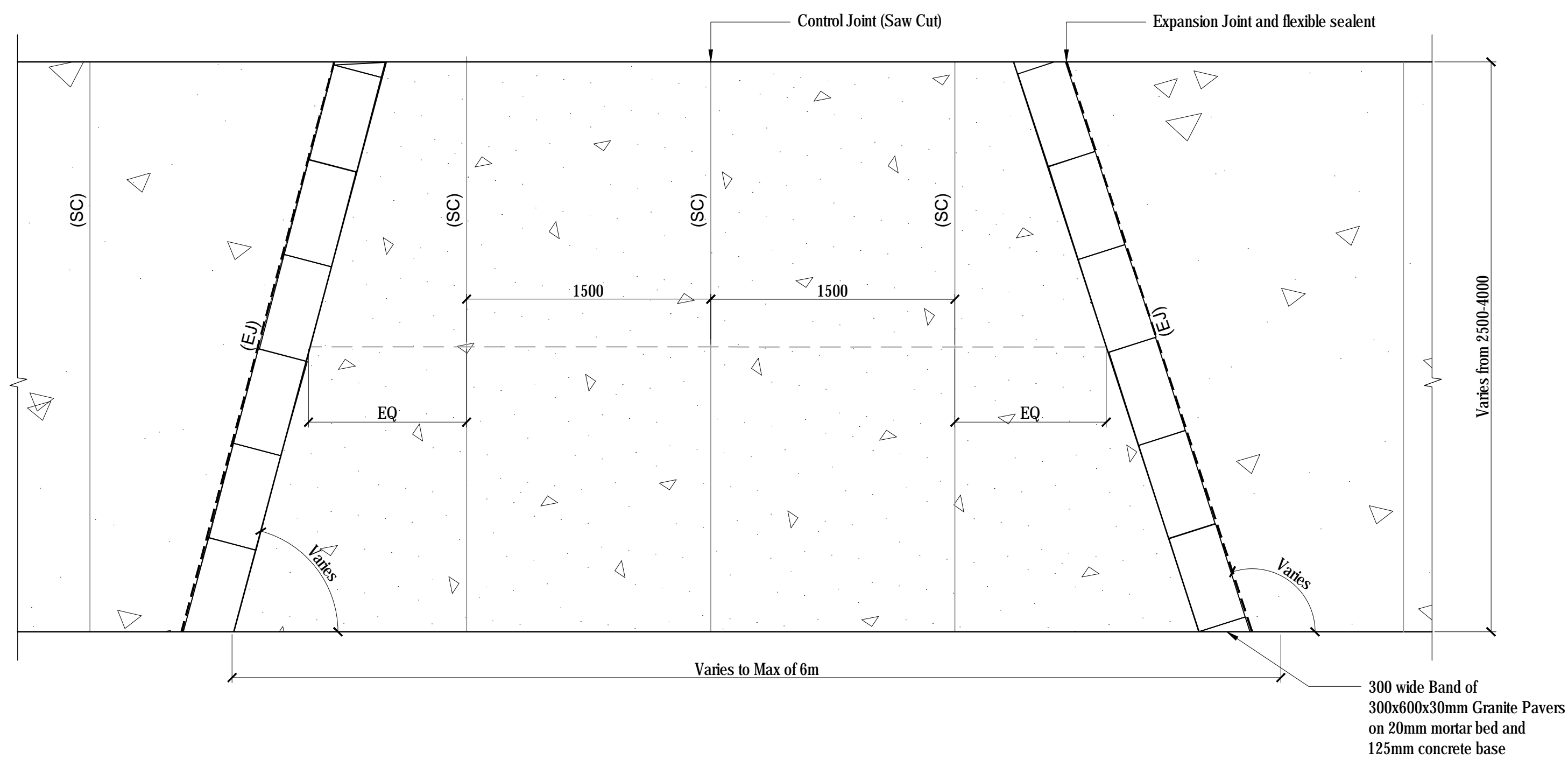

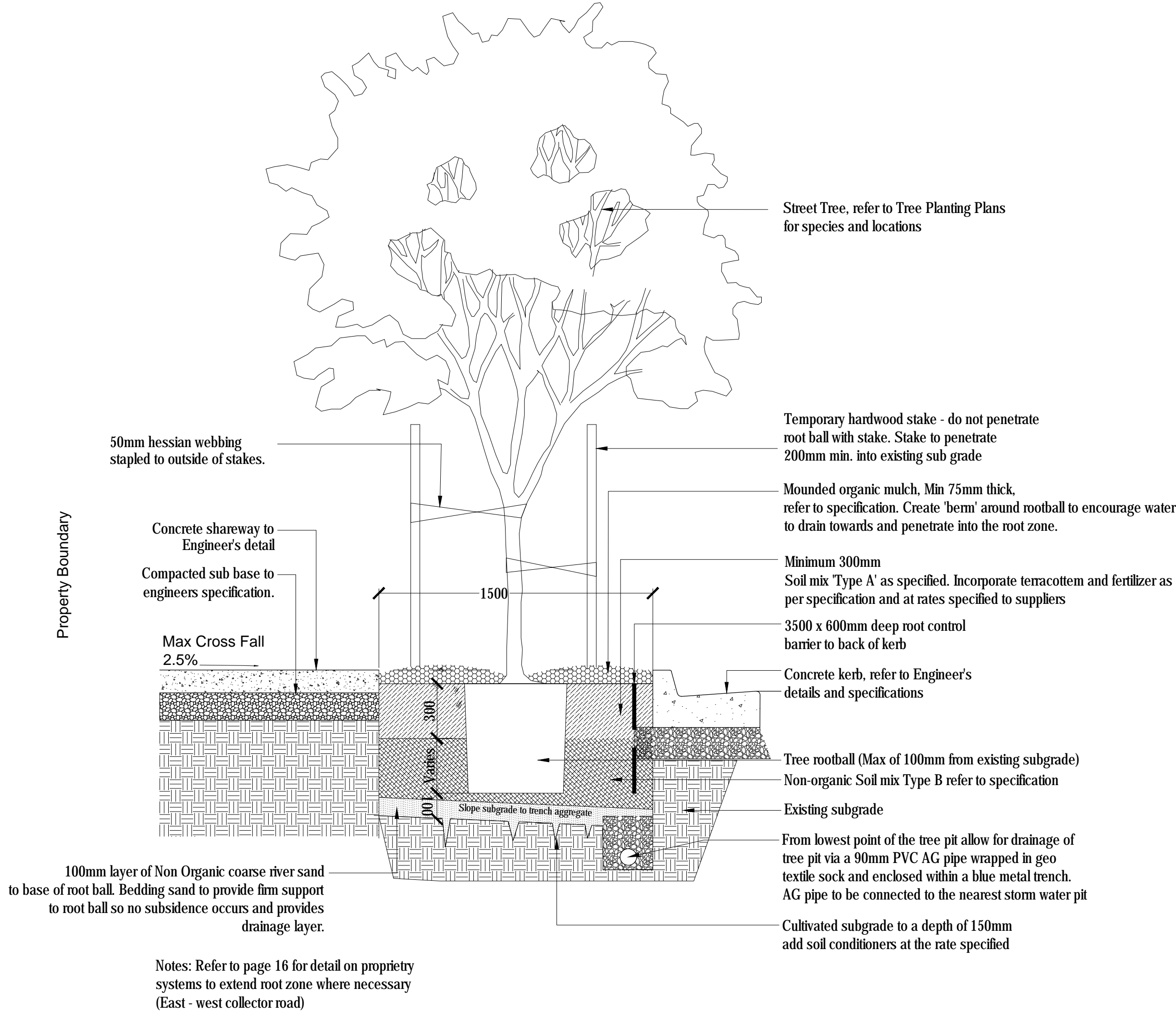

1 TYPICAL STREET TREE DETAIL
SCALE 1:25

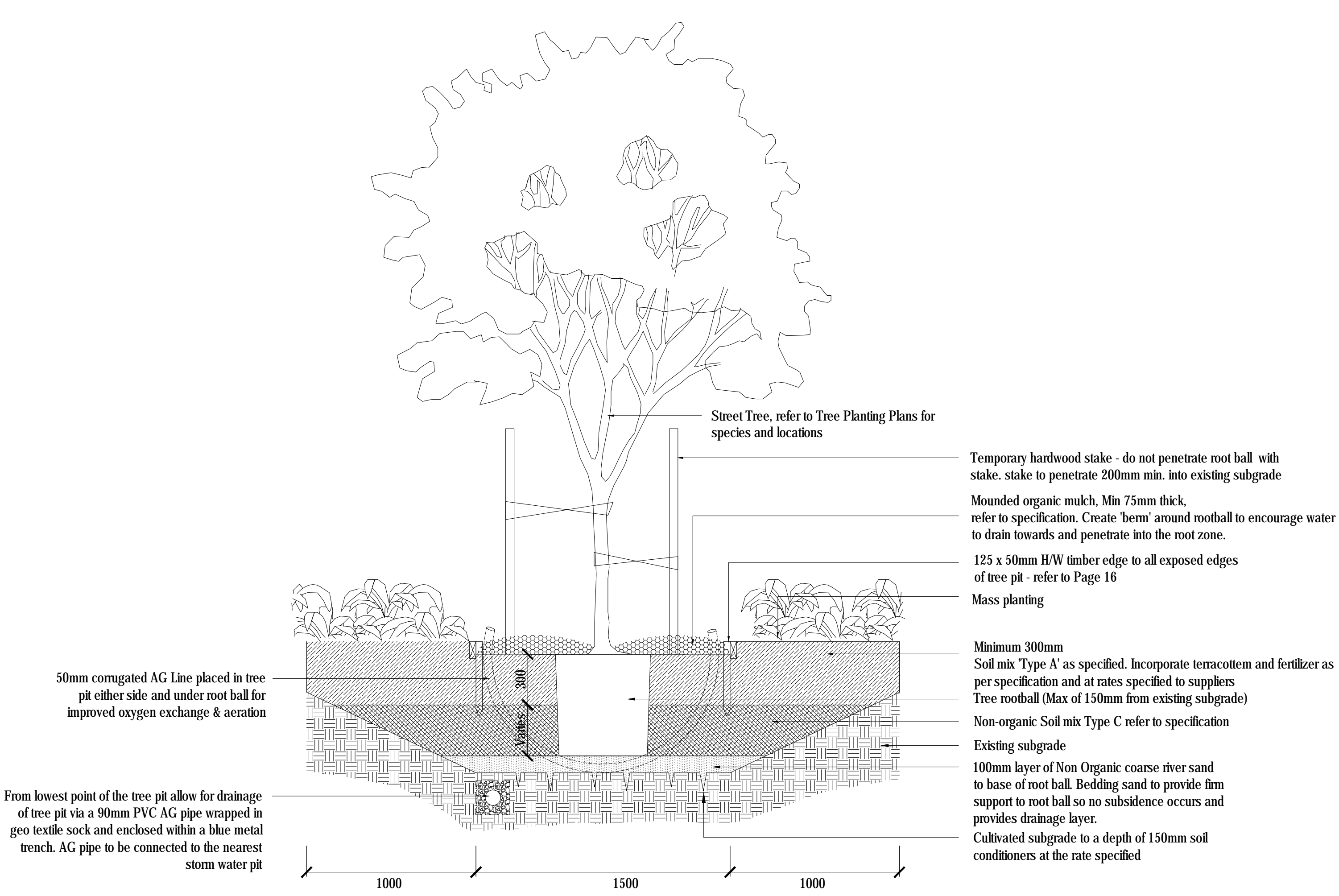

2 TYPICAL TREES IN MULCH DETAIL
SCALE 1:25

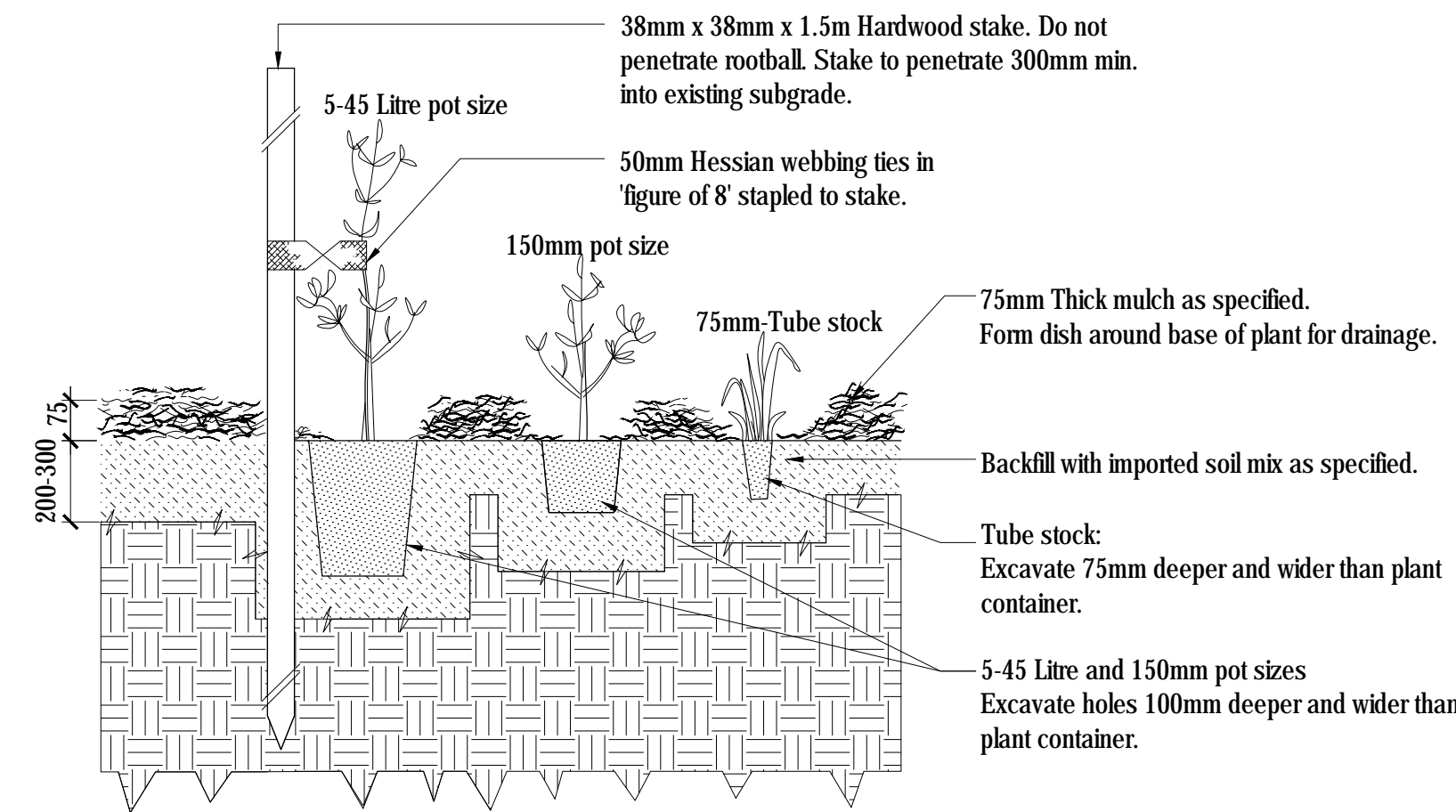

3 TYPICAL MASS PLANTING DETAIL
SCALE 1:25

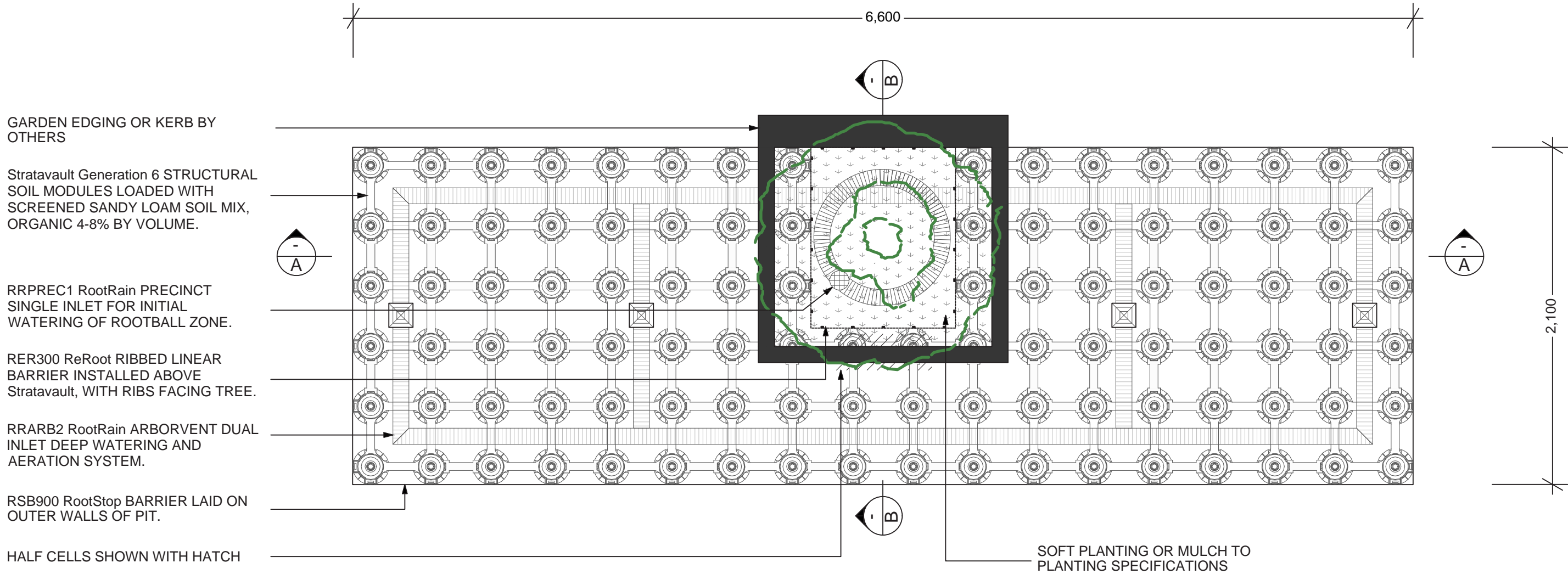

1 TYPICAL STRATAVAULT LINEAR OFFSET TREEPIT PLAN
SCALE 1:25

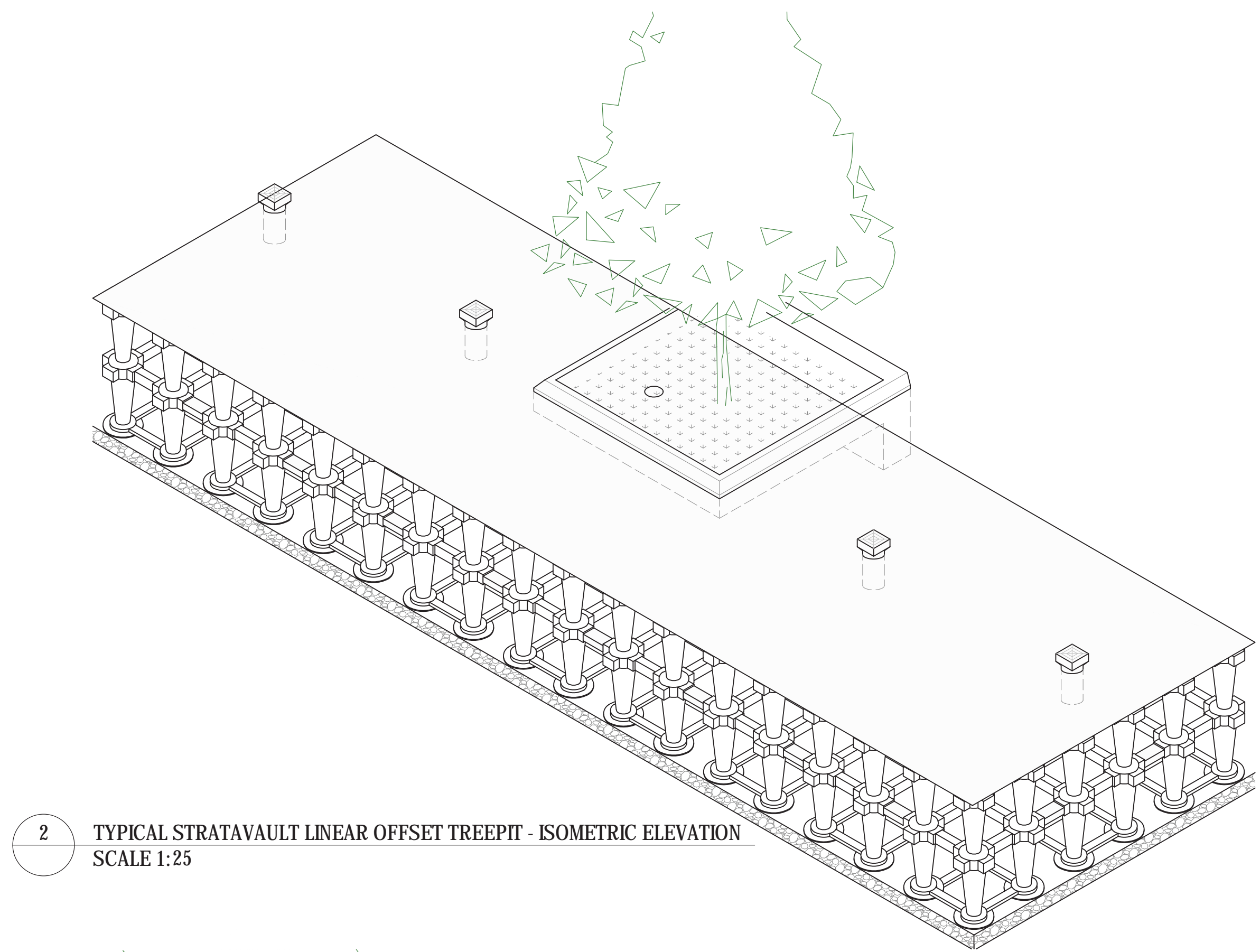

2 TYPICAL STRATAVAULT LINEAR OFFSET TREEPIT - ISOMETRIC ELEVATION
SCALE 1:25

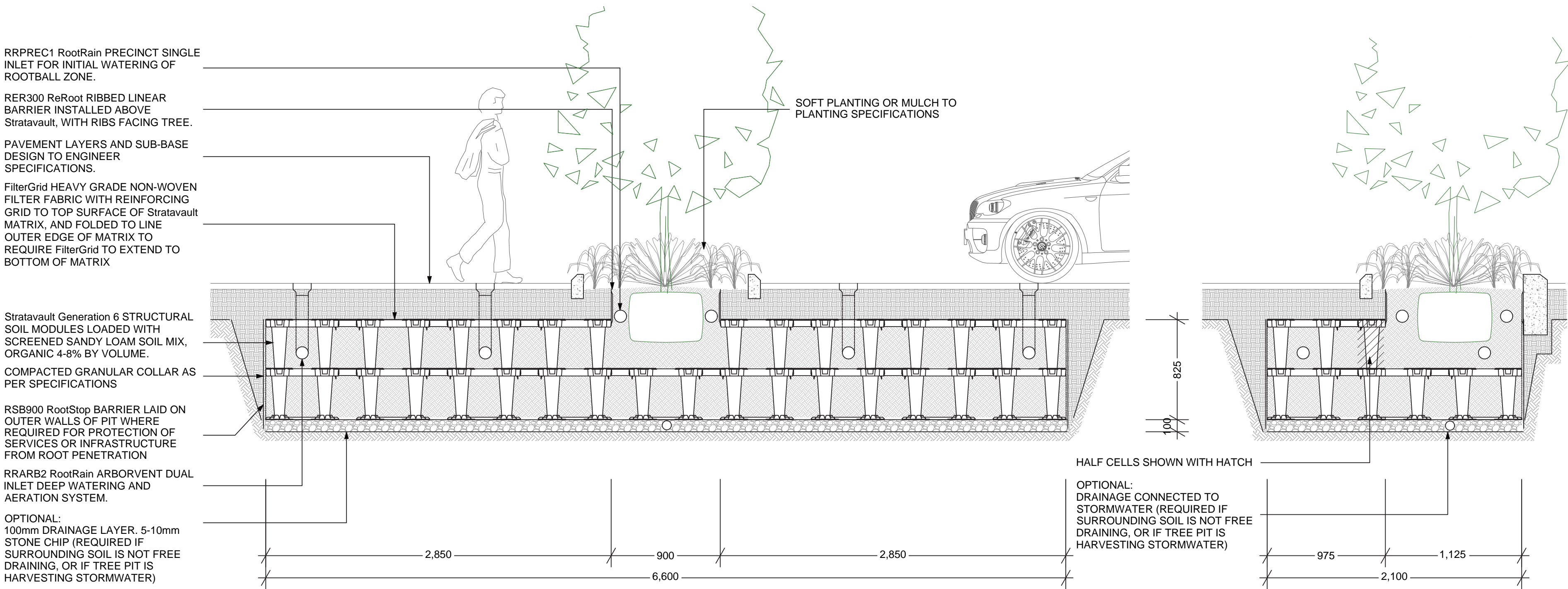

3 TYPICAL STATAVULT CROSS SECTION AA
SCALE 1:25

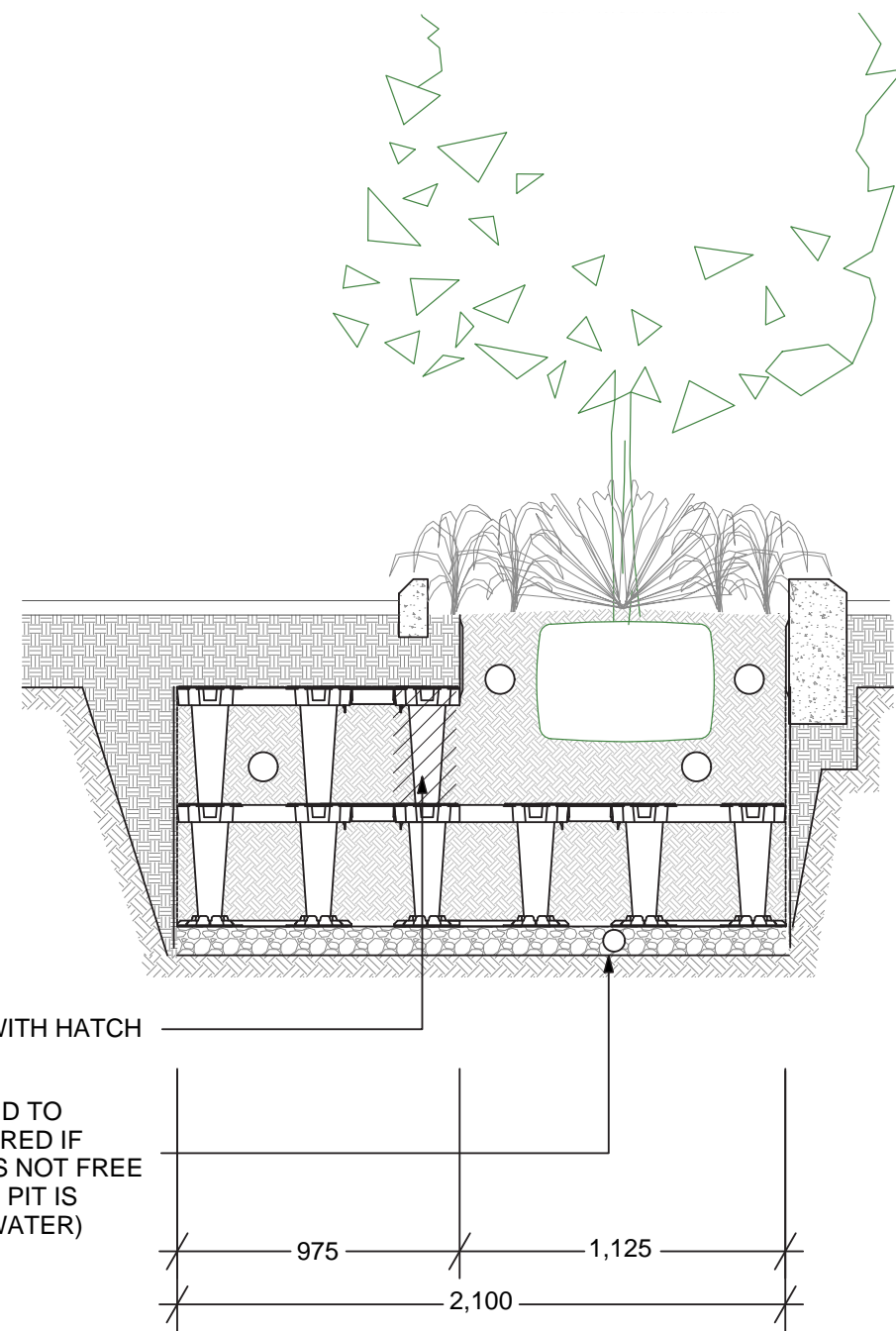

4 TYPICAL STATAVULT CROSS SECTION BB
SCALE 1:25

EAST-WEST COLLECTOR ROAD TREE PLANTING OPTIONS AND SOIL VOLUME REQUIREMENT

SPECIES	COMMON NAME	MATURE CANOPY WIDETH (mtrs) per sp.	IDEAL TARGET GROWING MEDIA (m3) per sp.	minimum growing media (m3) per sp.
<i>Liquidambar styraciflua</i>	American Sweetgum	7	23.09m3	18m3
<i>Jacaranda mimosifolia</i>	Jacaranda	8	30.16 m3	20m3
<i>Liriodendron tulipifera</i>	Tulip Tree	8	30.16m3	20m3

Note: Typical details provided by Citygreen